

acer

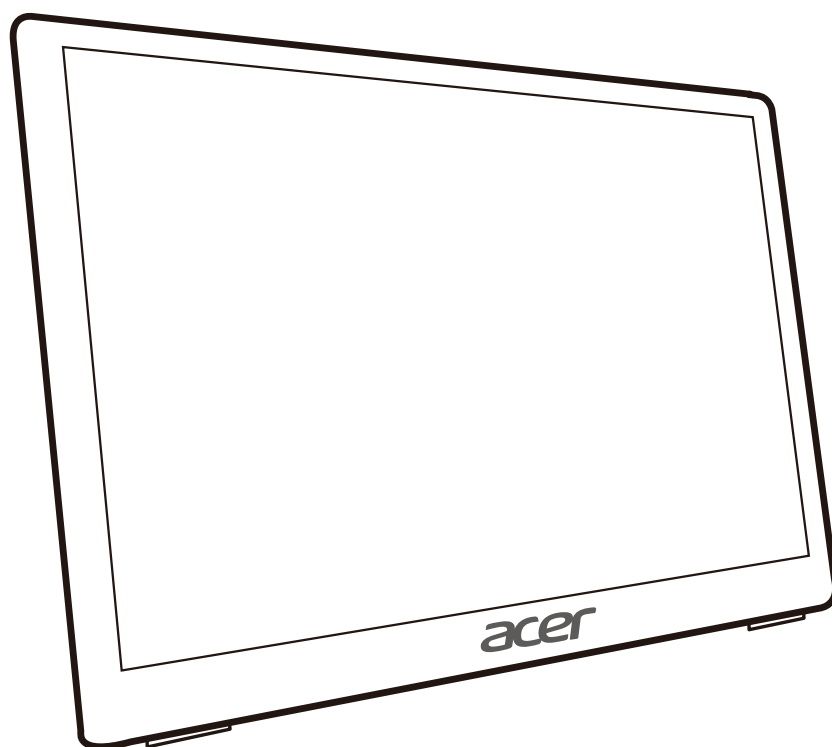

LCD monitor PM1 Series-PM161Q

USER GUIDE





Acer LCD Monitor Quick Start Guide (QSG)

Important safety instructions

Please read the following instructions carefully.

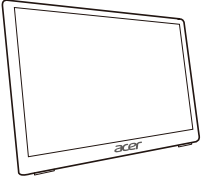
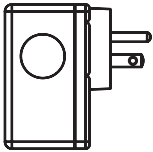
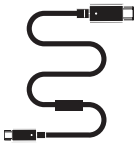
1. To clean the LCD monitor screen:
 - Turn off the LCD monitor and unplug the power cord.
 - Spray a non-solvent cleaning solution onto a rag and clean the screen gently.
2. Do not place the LCD monitor near a window. Exposing the monitor to rain, moisture or sunlight can severely damage it.
3. Do not apply pressure to the LCD screen. Excessive pressure may cause permanent damage to the display.
4. Do not remove the cover or attempt to service this unit yourself. An authorized technician should perform servicing of any nature.
5. Store the LCD monitor in a room with a temperature of -20° to 60°C (-4° to 140°F). Storing the LCD monitor outside this range may result in permanent damage.
6. Immediately unplug your monitor and call an authorized technician if any of the following circumstances occur:
 - Monitor-to-PC signal cable is frayed or damaged.
 - Liquid spills onto the LCD monitor or the monitor is exposed to rain.
 - The LCD monitor or case is damaged.

Package contents

LCD monitor	Power cord	micro-USB cable	Type-C cable	Cover	Quick start guide
					

Attaching the monitor to the base

1. Remove the monitor bracket and base from the packaging and place it on a stable and level workspace.
2. Open or close the rear bracket. The viewing angle of the monitor can be adjusted using the stand.
(As shown below)

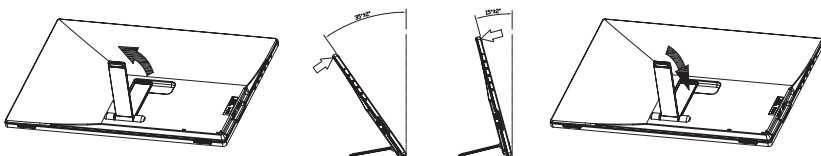

Connect the monitor to your computer

1. Connect the signal transmission cable (Thunderbolt 3 (USB-C) cable) to the monitor's Type-C jack and the Type-C output jack of the computer's display card.
2. The monitor does not require an external power supply via its micro USB port when it is connected to the computer; it only requires a single signal transmission cable (the Thunderbolt 3 (USB-C) cable).

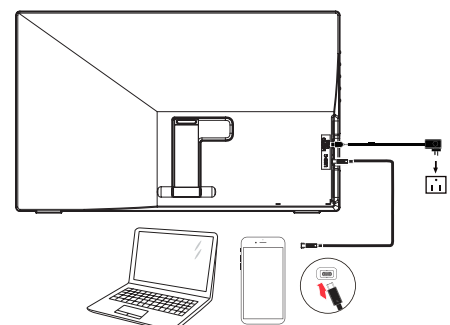

Connect the screen to your phone

1. Connect the signal transmission cable to the Type-C jack of the monitor and the Type-C output jack on your phone.
2. Some underpowered phones require an external power supply via the monitor's micro USB port when in use.

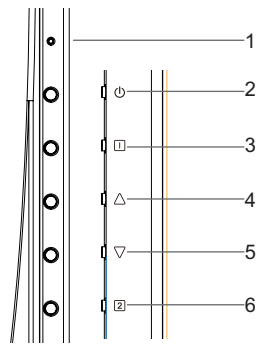

External controls

1 & 2		LED Indicator/ Power button	Turns the monitor on/off. Blue indicates power on. Amber indicates standby/power saving mode.
3		OSD functions Exit	a. Press to view the OSD. b. When the OSD menu is active, this button will act as the exit key (exit OSD menu).
4		Picture Mode Up/Right	a. Press this button to adjust the picture mode. b. Press this button to select the desired item when in OSD menu.
5		Down/Left	a. Press this button to select the desired item when in OSD menu.
6		Confirm	When the OSD menu is displayed, press this button to confirm the OSD selection.

Regulations and safety notices

FCC notices

This device has been tested and found to comply with the limits for a Class B digital device pursuant to Part 15 of the FCC rules. These limits are designed to provide reasonable protection against harmful interference in a residential installation. This device generates, uses, and can radiate radio frequency energy and, if not installed and used in accordance with the instructions, may cause harmful interference to radio communications. However, there is no guarantee that interference will not occur in a particular installation. If this device does cause harmful interference to radio or television reception, which can be determined by turning the device off and on, the user is encouraged to try to correct the interference by one or more of the following measures:

- Reorient or relocate the receiving antenna.
- Increase the separation between the device and receiver.
- Connect the device into an outlet on a circuit different from that to which the receiver is connected.
- Consult the dealer or an experienced radio/television technician for help.

CE declaration of conformity

Hereby, Acer Inc., declares that this LCD monitor is in compliance with the essential requirements and other relevant provisions of EMC Directive 2014/30/EU, Low Voltage Directive 2014/35/EU, and RoHS Directive 2011/65/EU and Directive 2009/125/EC with regard to establishing a framework for the setting of ecodesign requirements for energy-related product.

Notice: Shielded cables

All connections to other computing devices must be made using shielded cables to maintain compliance with EMC regulations.

Notice: Peripheral devices

Only peripherals (input/output devices, terminals, printers, etc.) certified to comply with the Class B limits may be attached to this equipment. Operation with non-certified peripherals is likely to result in interference to radio and TV reception.

Caution

Changes or modifications not expressly approved by the manufacturer could void the user authority, which is granted by the Federal Communications Commission, to operate this product.

Operation conditions

This device complies with Part 15 of the FCC Rules. Operation is subject to the following two conditions: (1) this device may not cause harmful interference, and (2) this device must accept any interference received, including interference that may cause undesired operation.

Notice: Canadian users

CAN ICES-3(B)/NMB-3(B)

Disposal of waste equipment by user in private household in the European Union



This symbol on the product or on its packaging indicates that this product must not be disposed of with your other household waste. Instead, it is your responsibility to dispose of your waste equipment by handing it over to a designated collection point for the recycling of waste electrical and electronic equipment. The separate collection and recycling of your waste equipment at the time of disposal will help to conserve natural resources and ensure that it is recycled in a manner that protects human health and the environment. For more information about where you can drop off your waste equipment for recycling, please contact your local city office, your household waste disposal service or the shop where you purchased the product.

*Acer monitor is purposed for video and visual display of information obtained from electronic devices.

SPECIFICATIONS

LCD Panel	Driving system	TFT Color LCD	
	Size	15.6"W (40cm)	
	Pixel pitch	0.17925 (H) x0.17925(V) mm	
	Brightness (cd/m ²)	220 (Typ)	
	Contrast	100,000,000:1 Max (ACM)	
	Viewable angle	CR=10, 170° (H), 170° (V)	
	Response time	7ms (G to G)	
	Panel Type	IPS (In-Plane Switching) Panel	
	Video	eDP interface	
	H-Frequency	30KHz-70KHz	
	V-Frequency	58Hz-62Hz	
Display Colors		262K (6bit)	
Dot Clock		148.5MHz	
Max. Resolution		1920 x 1080@60Hz	
Plug & Play		VESA DDC1/DC2B	
Power consumption (at 200 nits)	On Mode	10W (typical)	
	Sleep Mode	0.5W (typical)	
	Off Mode	0.5W (typical)	
Input Connector		Type-C	
Input Video Signal		Type-C	
Maximum Screen Size	Horizontal	344.16 mm	
	Vertical	193.59 mm	
Power Source		Model: ADS-12DA-05 05010EPC Input: 100-240V~50/60Hz Max.0.3A Output: 5V = 2A	
Environmental Considerations		Operating Temp: 0° to 40°C Storage Temp: -20° to 60°C Operating Humidity: 20% to 80%	
Dimensions (W x H x D)		37.7x23.47x2.0mm	
Weight (N. W.)		0.97kg (net)	
Mechanism specifications		Tilt: 15° to +35° Swivel: No Height adjustment: No	Pivot: No Detachable foot stand: No
External Controls	Buttons	Power Button MENU/Exit Down	Picture Mode/ Up Confirm
	Functions	Brightness Contrast Sharpness Over Drive Cool Normal Warm User Define Picture Mode	Language OSD H.position OSD V. Position OSD Background OSD Time Out Information Memory Recall

*All specifications are subject to change without notice.

Regulatory Compliance



Find manuals and other documents for your Acer product on the official Acer support website.

Free Manuals Download Website

<http://myh66.com>

<http://usermanuals.us>

<http://www.somanuals.com>

<http://www.4manuals.cc>

<http://www.manual-lib.com>

<http://www.404manual.com>

<http://www.luxmanual.com>

<http://aubethermostatmanual.com>

Golf course search by state

<http://golfingnear.com>

Email search by domain

<http://emailbydomain.com>

Auto manuals search

<http://auto.somanuals.com>

TV manuals search

<http://tv.somanuals.com>