

WEED EATER

® Trademark



Please do not return product to retailer.
Por favor, no devuelva el producto al lugar de compra.
Veuillez ne pas retourner le produit au détaillant.

1-855-378-6903

Register your product online at:
Registre su producto en línea en:
Enregistrez votre produit en ligne à l'adresse :
www.weedeater.com

Instruction Manual Manual de Instrucciones Manuel d'Instructions



20V 12" String Trimmer WE20VT



WARNING:

Read and follow all Safety Rules and Operating Instructions before using this product. Failure to do so can result in serious injury.

ADVERTENCIA:

Lea el manual de instrucciones y siga todas las advertencias e instrucciones de seguridad. El no hacerlo puede resultar en lesiones graves.

AVERTISSEMENT:

Lire le manuel d'instructions et bien respecter tous les avertissements et toutes les instructions de sécurité. Tout défaut de le faire pourrait entraîner des blessures graves.

WEED EATER
9335 Harris Corners Parkway
Charlotte, NC 28269

WEED EATER
850 Matheson Blvd. West
Mississauga, Ontario L5V 0B4

ENGLISH









ESPAÑOL

FRANÇAIS

TABLE OF CONTENTS



CONTENTS	2
IDENTIFICATION OF SAFETY SYMBOLS	3
SPECIFICATIONS	4
SAFETY RULES	5
ASSEMBLY	8
OPERATION.....	10
MAINTENANCE	12
SERVICE AND ADJUSTMENTS.....	14
TROUBLESHOOTING TABLE	15
LIMITED WARRANTY	16
EXPLODED VIEW	17
PARTS LIST	18

IDENTIFICATION OF SAFETY SYMBOLS

Symbol	Name	Designation/Explanation
V	Volts	Voltage
A	Amperes	Current
Hz	Hertz	Frequency (cycles per second)
W	Watts	Power
min	Minutes	Time
	Alternating Current	Type of current
	Direct Current	Type or a characteristic of current
/min	Per Minute	Revolutions, strokes, surface speed, orbits etc., per minute
	Safety Alert	Precautions that involve your safety
	Ricochet	Thrown objects can ricochet and result in personal injury or property damage.
	Keep Bystanders Away	Keep all bystanders at least 50' (15 m) away.
	No Blade Alert	Do not install or use any type of blade on a product displaying this symbol.
	Read The Operator's Manual	To reduce the risk of injury, user must read and understand instruction manual before using this product.
	Wear Eye Protection	Wear eye protection with side shields that are marked to comply with ANSI Z87.1 when operating this equipment.
	Wet Conditions Alert	Do not expose to rain or use in damp locations.

IDENTIFICATION OF SAFETY SYMBOLS

The following signal words and meanings are intended to explain the levels of risk associated with this product.

Symbol	Name	Designation/Explanation
	DANGER	Indicates an imminently hazardous situation, which, if not avoided, could result in death or serious injury.
	WARNING	Indicates a potentially hazardous situation, which, if not avoided, could result in death or serious injury.
	CAUTION	Indicates a potentially hazardous situation, which, if not avoided, may result in minor or moderate injury.
	CAUTION	(Without Safety Alert Symbol) Indicates a situation that may result in property damage.

SPECIFICATIONS

Motor:	20V
Speed:	8500 (±10%) RPM (no load)
Battery:	20V, 2Ah Lithium-Ion
Battery Run-Time	Up to 25 Minutes
Battery Charge-Time:	4 Hours
Cutting Path:	12" (30.5 cm)
Feed:	Automatic Single Line
Line Diameter:	0.065" (1.65 mm)
Unit Weight (without battery):	4.2 lb (1.91 kg)
Unit Weight (with battery):	5 lb (2.27 kg)

SAFETY RULES

⚠ WARNING: READ ALL SAFETY WARNINGS AND ALL INSTRUCTIONS. Failure to follow all instructions listed below may result in electric shock, fire and/or serious personal injury.

⚠ WARNING: When using this device, safety precautions must be followed. For your own safety and that of bystanders, please read these instructions before operating the device. Do not use the device without reading the instruction manual.

OPERATOR SAFETY

- This string trimmer is designed for cutting grass and soft vegetation, as well as edging in areas not accessible with a lawn mower.
- This string trimmer is not designed for cutting hedges, shrubs, bushes, flowers, or for composting purposes.
- **Keep work area clean and well lit. Cluttered or dark areas invite accidents.**
- **Do not operate string trimmer in explosive atmospheres, such as in the presence of flammable liquids, gases or dust.**
- **Keep children and bystanders away while operating string trimmer. Distractions can cause you to lose control.**
- **Do not expose string trimmer to rain or wet conditions.**
- Restrict the use of this unit to people who read, understand, and follow unit and manual warnings and instructions.
- Children should be supervised to ensure that they do not play with the device.
- Never allow children or people unfamiliar with the instructions use the device.
- Turn the string trimmer off while people, children, or pets are nearby.
- Only use the string trimmer in daylight or good artificial light.
- Before using the device and after any impact, check for signs of wear or damage and repair as necessary.
- Never operate without guard, or with damaged guard.
- Keep hands and feet away from trimmer cutting line at all times, especially when turning the unit on.
- Take care against injury from any device fitted for trimming the cutting line length. After extending new cutting line always return the device to its normal operating position before switching on.
- Never use replacement parts or accessories not provided or recommended by the manufacturer.
- **Disconnect battery pack from tool before making any adjustments, changing accessories, or storing the tool. Such preventative safety measures reduce the risk of starting the tool accidentally.**
- **Store idle tools out of reach of children and other untrained persons. Tools are dangerous in the hands of untrained users.**
- Always ensure that ventilation openings are kept clear of debris.
- Dress Properly. Do not wear loose clothing or jewelry. Contain long hair. Keep your hair, clothing, and hands away from moving parts. Loose clothes, jewelry, or long hair can be caught in moving parts.
- Always wear eye protection, that comply with ANSI Z87.1.
- Use personal protective equipment. Always wear eye protection. Protective equipment such as dust mask, non-skid safety shoes, hard hat, or hearing protection used for appropriate conditions will reduce personal injuries.
- Do not overreach. Keep proper footing and balance at all times. Proper footing and balance enable better control of the tool in unexpected situations.
- Stay Alert. Do not operate string trimmer when you are tired, ill, or under the influence of alcohol, drugs, or medication.
- Store the string trimmer indoors - out of reach of children.
- Do not charge or operate cordless tools in damp or wet locations or in the rain. Following this rule will reduce the risk of electric shock.
- Keep all bystanders, children, and pets at least 50 ft. away.
- Use Right Tool – Do not use tool for any job except that for which it is intended.
- Avoid Unintentional Starting – Do not carry string trimmer with fingers on the switch. Be sure the battery is removed while transporting.
- Do not force tool. Use the correct tool for your application. The correct tool will do the job better and safer at the rate for which it is designed.
- Maintain tool with care. Keep vents clean for best and safest performance. Follow instructions for proper maintenance. Do not attempt to clear clogs from tool without first disconnecting the battery.
- Check Damaged Parts – Before further use of the tool, a guard or other part that is damaged should be carefully checked to determine that it will operate properly and perform its intended function. Check for alignment of moving parts, binding of moving parts, breakage of parts, mounting,

SAFETY RULES

and any other condition that may affect its operation. A guard or other part that is damaged should be properly repaired or replaced by an authorized service center unless indicated elsewhere in this manual.

- For use only with WE20VRB battery and WE20VCH charger.
- Do not open or mutilate the battery. Released electrolyte is corrosive and may cause damage to the eyes or skin. It may be toxic if swallowed.
- Exercise care in handling batteries in order not to short the battery with conducting materials such as rings, bracelets, and keys. The battery or conductor may overheat and cause burns.

SERVICE

Tool service must be performed only by qualified repair personnel using only identical replacement parts. This will ensure that the safety of the tool is maintained. Service or maintenance performed by unqualified personnel may result in a risk of injury. Please call 1-855-378-6903 for customer support.

BATTERY AND CHARGER

Do not dispose of the battery in a fire. The cell may explode. Check with local codes for possible special disposal instructions.

⚠ DANGER: To avoid serious injury, risk of fire, explosion and danger of electric shock or electrocution:

- DO NOT probe the charger with conductive materials. The charging terminals hold 120V.
- If the battery pack case is cracked or damaged, DO NOT insert into the charger. Replace the battery pack.
- DO NOT charge these battery packs with any other type of charger.
- DO NOT allow liquid inside the charger.
- DO NOT try to use the charger for any other purpose than what is presented in this manual.

⚠ WARNING: Do not charge the battery pack in rain or in wet conditions. Do not immerse the tool, battery pack, or charger in water or other liquid.

- Do not allow the battery pack or charger to overheat. If they are warm, allow them to cool down. Recharge only at room temperature.
- Do not cover the ventilation slots on top of

the charger. Do not set the charger on a soft surface. Keep the ventilation slots of the charger clear.

- Do not allow small metal items or material such as steel wool, aluminum foil, or other foreign particles into the charger cavity.
- Unplug the charger before cleaning and when there is no battery pack in the cavity.
- Do not place the battery charger or the battery pack in the sun or in a warm environment. Keep at normal room temperature.
- Do not try to connect two chargers together.
- The battery pack cells may develop a small leak under extreme usage or temperature conditions. If the outer seal is broken and the leakage gets on your skin:
 - Use soap and water to wash immediately
 - Neutralize with lemon juice, vinegar, or other mild acid.
- If battery fluids gets in your eyes, flush immediately with water for at least 15 minutes. Get immediate medical attention.

⚠ WARNING: READ AND UNDERSTAND ALL INSTRUCTIONS. Failure to follow safety rules listed below may result in electric shock, fire, and/or personal injury.

- Do not abuse the cord. Never use the cord to carry the tool. Never pull on the cord to remove plug from the outlet. Keep cords away from heat, oil, sharp edges, or moving parts. Replace damaged cords immediately. They may create a fire. Do not use if damaged.
- Do not place the charger where the power cord might be stepped on, tripped on, or subjected to damage.
- A battery-operated tool with integral batteries or a separate battery pack must be recharged only with the specified charger for the battery. A charger that may be suitable for one type of battery may create a risk of fire when used with another battery.
- Use a battery-operated tool only with the specifically designated battery pack. Use of any other batteries may create a risk of fire.

⚠ WARNING: (PROPOSITION 65)

Some dust created by power sanding, sawing, grinding, drilling, and other construction activities contains chemicals known to cause cancer, birth defects or other reproductive harm. Some examples of these chemicals are:

- Lead from lead-based paints;

SAFETY RULES

- Crystalline silica from bricks and cement and other masonry products, and
- Arsenic and chromium from chemically treated lumber.

Your risk of exposure to these chemicals varies depending on how often you do this type of work. To reduce your exposure to these chemicals, work in a well-ventilated area, and work with approved safety equipment, such as dust masks that are specially designed to filter out microscopic particles.

BATTERY USE AND CARE

- Recharge only with the charger specified by the manufacturer. A charger that is suitable for one type of battery pack may create a risk of fire when used with another battery pack.
- Use string trimmer only with specifically designated battery packs. Use of any other battery packs may create a risk of injury and fire.
- When battery pack is not in use, keep it away from other metal objects, like paper clips, coins, keys, nails, screws or other small metal objects, that can make a connection from one terminal to another. Shorting the battery terminals together may cause burns or a fire.
- Under abusive conditions, liquid may be ejected from the battery; avoid contact. If contact accidentally occurs, flush with water. If liquid contacts eyes, additionally seek medical help. Liquid ejected from the battery may cause irritation or burns.

SAVE ALL WARNINGS AND INSTRUCTIONS FOR FUTURE REFERENCE

ASSEMBLY

PACKING LIST

This product requires assembly

- 20V String Trimmer
- Auxiliary Handle
- Guard
- 20V 2Ah Battery
- 20V Charger
- Instruction Manual

If any parts are damaged or missing, please call 1-855-378-6903.

BATTERY REMOVAL

1. Press in and hold the latch button (1) with firm grip.
2. Grasp the trigger handle (2) firmly. Pull the battery pack out of the handle.

BATTERY INSTALLATION

1. Align the tongue (3) of the battery pack with the cavity in the handle housing.
2. Grasp the trigger handle (2) firmly.
3. Push the battery pack into the handle until both sides lock. The latch button will click when locked into place.
4. Do not use force when inserting the battery pack. It should slide into place and click.

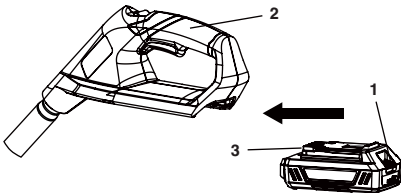

NOTE: The battery pack fits snugly into the handle to prevent accidental dislodging. It may require a strong pull to remove.

IMPORTANT: The battery is not shipped fully charged. It is recommended that the battery be fully charged before initial use. With regular use, the battery pack will take 4 hours or less to charge fully. It is recommended that the battery be charged every 3 months when the hedge trimmer is not in use. The battery's run time will improve after the third or fourth charge.

GUARD ASSEMBLY

1. Remove the battery pack.
2. Invert the string trimmer to access the bottom of the motor housing.
3. Place the guard (2) onto the bottom of the motor housing (3).
4. Align the screw holes on the guard with the screw holes on the motor housing.
5. Insert the 3 screws (1) into the guard connecting to the motor housing. Tighten the guard into place.

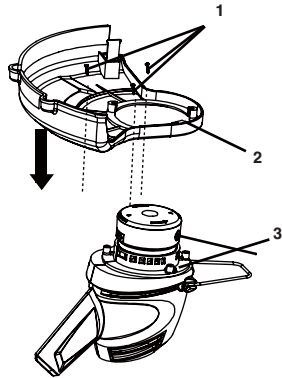

WARNING: To avoid injury and to reduce the risk of electric shock or fire:

- Replace the battery pack or charger immediately if the battery case or charger cord is damaged.
- Always make sure the string trimmer switch is OFF before inserting or removing the battery pack.
- Always make sure the battery pack is removed and the switch turned OFF before replacing spools or adjusting the line.
- Read, understand, and follow the battery charger instructions.

ASSEMBLY

SHAFT ASSEMBLY

1. Align lower tube groove with the groove inside the upper locking sleeve assembly. Push tubes together until they snap into place.

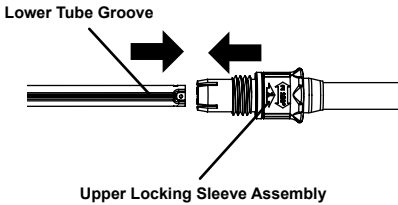

2. Try to pull tubes back apart. If the tubes do not come apart, they are properly snapped into place. If the tubes come apart, repeat step 1 and push until the tubes snap into place.
3. Slide lower locking sleeve assembly over upper locking sleeve assembly and tighten by turning clockwise.

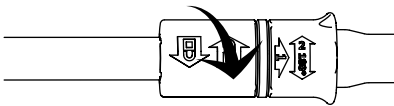
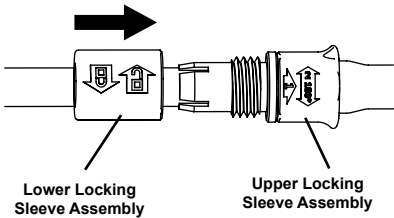

AUXILIARY HANDLE ASSEMBLY

1. Position auxiliary handle (1) onto the upper portion of the trimmer shaft.
2. Once the auxiliary handle is in the desired location, tighten the knob (2) until locked into position.
3. Before operating the string trimmer, make sure the auxiliary handle (1) is tightly locked into position.
4. Turn the auxiliary handle adjustment knob (2) clockwise to lock the handle securely into position.

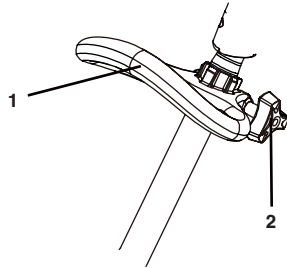

WARNING: To avoid injury, adjust the auxiliary handle for optimum control and balance. Do not overreach when operating the string trimmer. Keep proper balance at all times for better control of the tool in unexpected situations.

CUTTING LINE

A pre-wound spool is pre-installed on the string trimmer. When the cutting line needs to be replaced, insert a new spool.

OPERATION

KNOW YOUR STRING TRIMMER

The safe use of this product requires an understanding of the information in this instruction manual as well as a knowledge of the project you are attempting. Before use of this product, familiarize yourself with all operating features and safety rules.

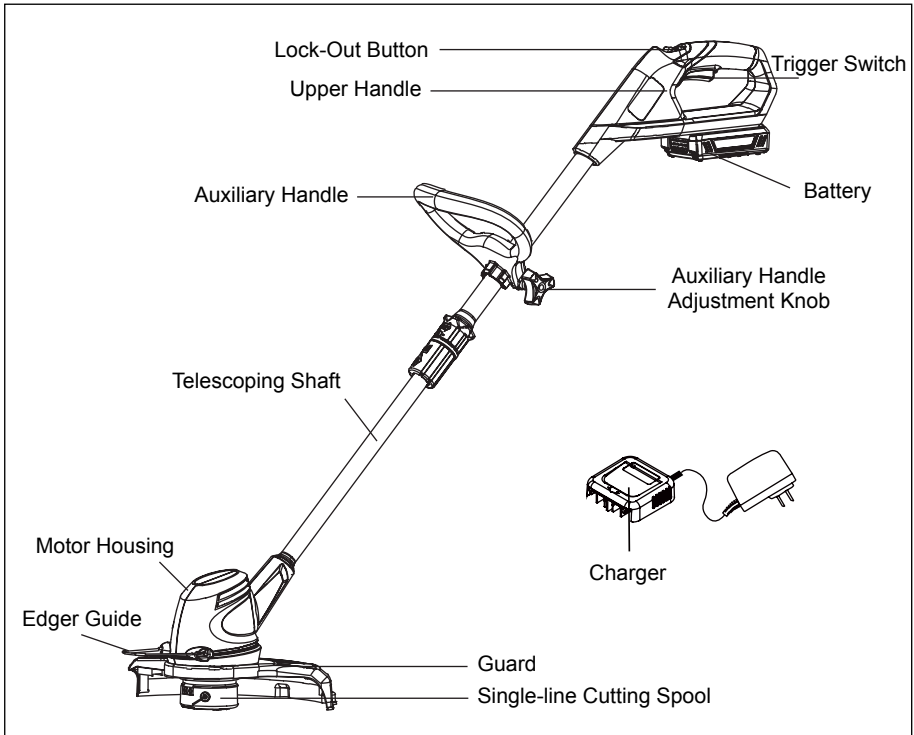

TO TURN ON/OFF

1. Place one hand on the trigger handle (3). Place the other hand on the auxiliary handle (4).
2. Slide the lock-out button (2) toward the rear of the handle and hold.
3. Squeeze trigger switch (1). The string trimmer will turn ON.
4. Release the lock-out button (2). The string trimmer will stay on as long as the trigger switch (1) is squeezed ON.
5. Release trigger switch (1) to stop.

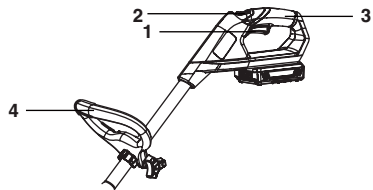

TELESCOPING SHAFT

The shaft can be extended or shortened for ease of use.

1. Unscrew shaft coupler and slide to desired position.
2. Tighten shaft coupler.

OPERATION

EDGING FUNCTION

The string trimmer is equipped with an edging feature for use on multiple surfaces. This includes sidewalks, walkways, patios, and driveways. It is great for clearing overgrown grass from manicured surfaces.

- Pull up Edging Coupler and turn handle end counter clockwise.

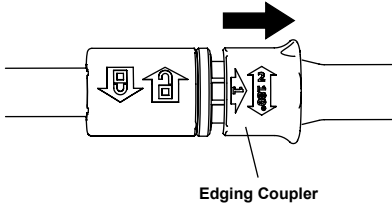

- Release Edging Coupler when handle has been rotated 180°.

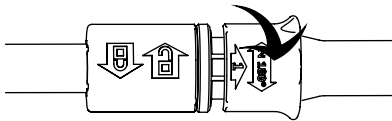

- Flip the edging guide down until it locks into place.

ADJUST THE CUTTING PATH

The cutting path can be adjusted from 10"-12" (25.5-30.5 cm). Philips Head Screwdriver (Not Supplied) is required. Loosen the screw and turn the cutter 180° then tighten the screw.

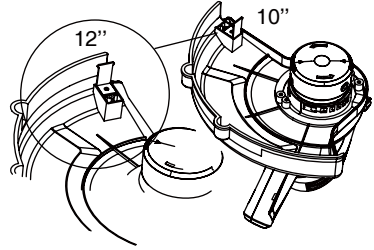

WARNING: To avoid injury:

- Do not squeeze the trigger while the string trimmer/edger is inverted.
- Do not carry the string trimmer/edger with your finger on the trigger switch. Avoid unintentional starting.

LENGTHENING THE LINE

While the string trimmer is operating, the cutting line gets worn down and becomes shorter. This trimmer is equipped with Automatic Line Advancement, which automatically feeds additional line to the correct length as it wears down. If the line does not automatically advance, the trimmer line may be tangled or empty. To advance the line, restart the trimmer. Upon starting, the line will automatically advance.

MAINTENANCE

CHARGING PROCEDURE

1. Plug the charger into an AC power outlet.
2. Slide Charger over Battery Pack Terminals. Make sure the Charger and Battery are fully connected.
3. When the battery is charging, the LED will blink; when the battery is fully charged, the LED will stop blinking but will remain illuminated.

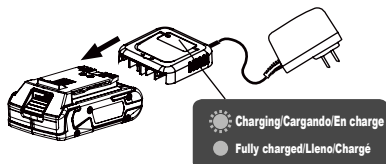

CHECKING BATTERY CAPACITY

Press the Battery Capacity Indicator (BCI) button. The lights will illuminate according to the battery's current power level. See chart below:

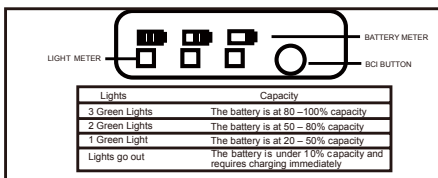

CHARGER MAINTENANCE

- Keep the charger clean and clear of debris. Do not allow foreign material to get into the recessed cavity or onto the contacts. Wipe the charger clean with a dry cloth. Do not use solvents or water, and do not place the charger in wet conditions.
- Unplug the charger when there is no battery pack in it.
- Fully charge the batteries before placing them in storage.
- Store the charger at normal room temperature. Do not store it in excessive heat. Do not use the charger in direct sunlight. Recharge at temperatures between 32°F and 104°F (0-40°C). If battery pack is hot, allow it to cool down before recharging.

BATTERY PACK

- Store the battery pack fully charged.
- Once the charging light turns green, remove the battery from the charger and disconnect the charger from the outlet.
- After charging, the battery pack may be stored on the charger, as long as the charger is not plugged in.

CUTTING LINE

- Use only .065" (1.65mm) diameter cutting line. Other sizes will not advance properly and could result in failure, or cause serious injury.
- Always wind the line in the same direction as the arrow on the spool.

CLEANING

1. Wipe the outside of the string trimmer with a dry, soft cloth. Do not hose down or wash with water.
2. Scrape the guard and spool area to remove dried clippings and mud.
3. Brush or blow dust, debris, and grass clippings out of the air vents. Keep them free of obstruction.

CAUTION: Do not use strong solvents or detergents on the plastic housing or plastic components. Certain household cleaners may cause damage and may also cause a shock hazard.

WARNING: To avoid risk of fire, electric shock, or electrocution:

- Do not use a damp cloth or detergent on the battery or battery charger.
- Always remove the battery pack before cleaning, inspecting, or performing any maintenance on the string trimmer.

MAINTENANCE

ENVIRONMENTALLY SAFE BATTERY DISPOSAL



The following toxic and corrosive materials are in the batteries used in this string trimmer battery pack: Lithium-Ion, a toxic material.

⚠ WARNING: All toxic materials must be disposed of in a specified manner to prevent contamination of the environment. Before disposing of damaged or worn out Lithium-Ion battery packs, contact your local waste disposal agency, or the local Environmental Protection Agency for information and specific instructions. Take the batteries to a local recycling and/or disposal center, certified for lithium-ion disposal.

⚠ WARNING: If the battery pack cracks or breaks, with or without leaks, do not recharge it and do not use. Properly dispose of it and replace with a new battery pack. **DO NOT ATTEMPT TO REPAIR IT!** To avoid injury and risk of fire, explosion, or electric shock, and to avoid damage to the environment:

- Cover the battery's terminals with heavy-duty adhesive tape.
- DO NOT attempt to remove or destroy any of the battery pack components.
- DO NOT attempt to open the battery pack.
- If a leak develops, the released electrolytes are corrosive and toxic. DO NOT get the solution in the eyes or on skin, and do not swallow it.
- DO NOT place these batteries in your regular household trash.
- DO NOT incinerate.
- DO NOT place them where they will become part of any waste landfill or municipal solid waste stream.
- Take them to a certified recycling or disposal center.

SERVICE AND ADJUSTMENTS

SPOOL REMOVAL

1. Remove battery from trimmer.
2. Invert string trimmer to access spool.
3. Remove spool cover. Press on the two tabs parallel to each other on the side of the cover (2).
4. Remove the spool from spool housing (3).

SPOOL REPLACEMENT

1. Replace the spool (1) with a new pre-wound spool.
2. Insert the end of line through the opening (4) in the spool housing (3).
3. Align the tabs on the spool cover with the slots in the spool housing on the trimmer head.
4. Push down on the spool cover, locking it to the spool housing.
5. To advance the line when initially installed, you must pull the line while pressing the line release button on the side of the spool housing (3).

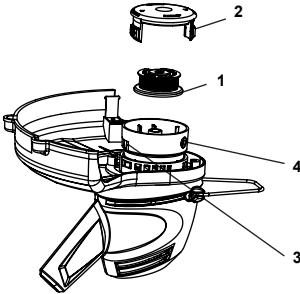

LINE REPLACEMENT

1. Cut the length of line to 20 ft (6m) total length.

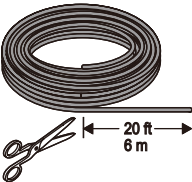

2. Bend one end of the Line 1/4 of an inch (6.4mm).



3. Take the end of the line that is bent 1/4 of an inch (6.4mm) and stick it in the hole in the spool head.

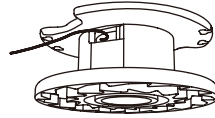

4. Once the 1/4 of the line is inserted in to the hole, wind the spool line clockwise evenly and overlapping the first row and continuing the process until complete.

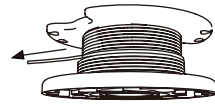
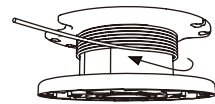

5. Once complete the last layer of line should be evenly wounded. To keep the line from unraveling hook the line as shown below.

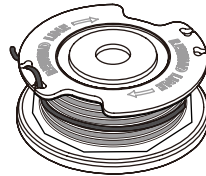

STORAGE

- Ensure the battery is removed from the string trimmer.
- Wipe any debris off of the string trimmer.
- Store in a dry cool place out of the reach of children.
- Position unit so that any sharp object cannot accidentally cause injury.

TROUBLESHOOTING TABLE



WARNING: Always stop unit and disconnect from the power source before performing all of the recommended remedies below except remedies that require unit to be operating.

TROUBLE	CAUSE	REMEDY
Motor fails to start when trigger switch is depressed.	<ol style="list-style-type: none"> 1. Battery is not secure. 2. Battery is not charged. 	<ol style="list-style-type: none"> 1. To secure the battery pack, make sure the latches on the top of the battery pack snap into place. 2. Charge the battery pack according to the instructions included with your model.
String trimmer smokes during operation.	String trimmer damaged.	Do not use string trimmer. Call for technical service 1-855-378-6903.
Cutting line does not advance.	<ol style="list-style-type: none"> 1. Line may be tangled on spool. 2. Line has run out. 	<ol style="list-style-type: none"> 1. Remove battery. Remove spool cover and spool. Unwind spool and rewind, ensuring that line is not tangled. 2. Replace spool or spool line.

LIMITED WARRANTY

WEED EATER, a division of Husqvarna Consumer Outdoor Products N.A., Inc., hereby warrants this product, to the original purchaser with proof of purchase, for a period of four (4) years against defects in materials, parts, or workmanship.

WEED EATER, at its own discretion will repair or replace any and all parts found to be defective, through normal use, free of charge to the customer. This warranty is valid only for units which have been used for personal use that have not been hired or rented for industrial/commercial use, and that have been maintained in accordance with the instructions in the owners manual supplied with the product.

Battery carries a two (2) year warranty against defects in workmanship and materials. Batteries must be charged in accordance with the operator's manuals directions and regulations in order to be valid.

This warranty is not transferable. This warranty does not cover damaged parts from improper handling, commercial use, abuse, neglect, accident, improper maintenance, alteration, or the use of accessories and/or attachments not specifically recommended by **WEED EATER** for this product. Additionally, this warranty does not cover parts that will wear from normal use, and normal deterioration of the exterior finish due to use or exposure. This warranty does not cover predelivery setup, or normal adjustments explained in the instruction manual.

Should you have any unanswered questions concerning this warranty, please contact: **WEED EATER**, a division of Husqvarna Consumer Outdoor Products N.A., Inc.
9335 Harris Corners Parkway
Charlotte, NC 28269
1-855-378-6903

In Canada, contact:

WEED EATER

850 Matheson Blvd. West
Mississauga, Ontario L5V 0B4
Giving the model number, serial number and date of purchase of your product and the name and address of the authorized dealer from whom it was purchased.

THIS WARRANTY GIVES YOU SPECIFIC LEGAL RIGHTS, AND YOU MAY HAVE OTHER RIGHTS WHICH VARY FROM STATE TO STATE.

NO CLAIMS FOR CONSEQUENTIAL OR OTHER DAMAGES WILL BE ALLOWED, AND THERE ARE NO OTHER EXPRESS WARRANTIES EXCEPT THOSE EXPRESSLY STIPULATED HERIN.

SOME STATES DO NOT ALLOW LIMITATIONS ON HOW LONG AN IMPLIED WARRANTY LASTS OR THE EXCLUSION OR LIMITATIONS OF INCIDENTAL OR CONSEQUENTIAL DAMAGES, SO THE ABOVE LIMITATIONS OR EXCLUSION MAY NOT APPLY TO YOU.

This limited warranty within the meaning of that term as defined in the Magnuson-Moss Act of 1975.

The policy of **WEED EATER** is to continuously improve its products. Therefore, **WEED EATER** reserves the right to change, modify, or discontinue models, designs, specifications, and accessories of all products at any time without notice or obligation to any purchaser.

EXPLODED VIEW

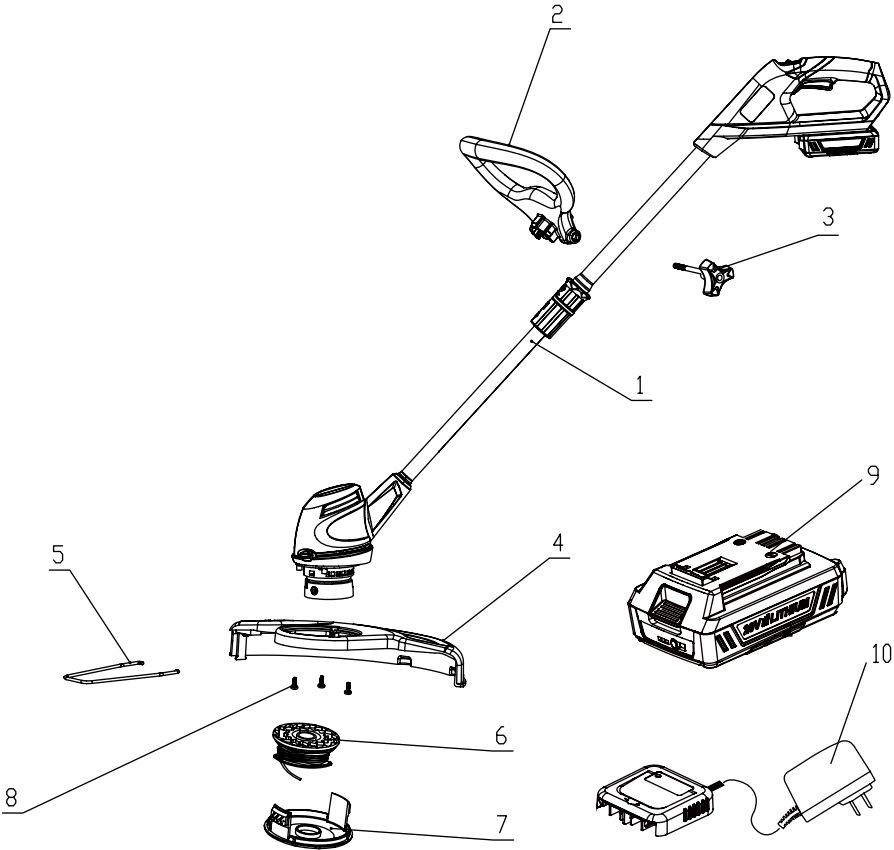

PARTS LIST

Item	Description	Drawing	Qty
1	Bare Tool Assembly	321011419	1
2	Auxiliary Handle Assembly	321021419	1
3	Auxiliary Handle Knob	34101185X	1
4	Guard Assembly	321031419	1
5	Edger Guide	33301720	1
6	Single Line Spool Assembly	321041419	1
7	Single Line Spool Cover	3411546X	1
8	Screw ST4×12-F	3220905B	3
9	20V, 2Ah Lithium-Ion Battery	31110905	1
10	Battery Charger	311011295	1

Free Manuals Download Website

<http://myh66.com>

<http://usermanuals.us>

<http://www.somanuals.com>

<http://www.4manuals.cc>

<http://www.manual-lib.com>

<http://www.404manual.com>

<http://www.luxmanual.com>

<http://aubethermostatmanual.com>

Golf course search by state

<http://golfingnear.com>

Email search by domain

<http://emailbydomain.com>

Auto manuals search

<http://auto.somanuals.com>

TV manuals search

<http://tv.somanuals.com>