

Foremost

**STEP-BY-STEP
ILLUSTRATED**

Instructions

REF: #1088-E

TL-2100-WL
One Piece Dual Flush Toilet

INSTALLATION PROCEDURE

7 STEPS

PARTS:

A	Push Button #R36131	x1
B	Complete Flush Valve #P2212	x1
C	Complete Fill Valve with Float #A2002	x1
D	Plastic Cap Covers & Washers	x2
E	Toilet Seat Includes Hardware #TSP2100H-PP	x1

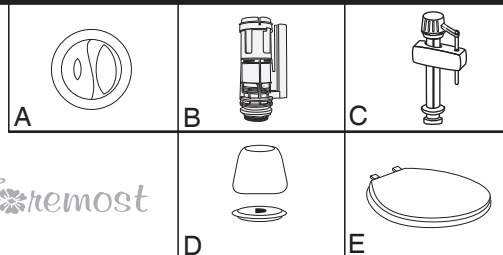

TOOLS AND MATERIALS REQUIRED:

A	Sealing Ring (3/4" Rubber or 11/16" Wax)	
B	Flange Closet Bolts	x2
C	Plastic Closet Bolt Washers	x2
D	Metal Washers	x2
E	Tightening Nuts	x2
F	Water Supply Kit	x1
	(Not needed if replacing existing toilet)	
G	Adjustable Wrench	
H	Flathead Screwdriver	
I	Level	
J	Nut Driver or Socket Set	
K	Putty Knife	
L	Tape Measure	

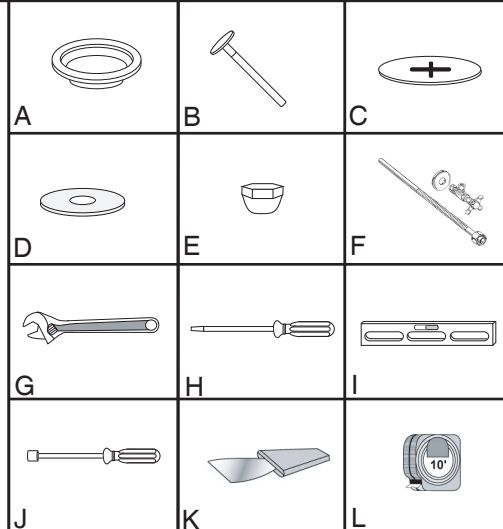

Foremost

Foremost

STEP-BY-STEP
ILLUSTRATED

Instructions

REF: #1088-E

TL-2100-WL
One Piece Dual Flush Toilet

REMOVING YOUR OLD TOILET

7 STEPS

- 1** Turn off the water supply.
- 2** Flush the toilet to empty the tank. Remove any water left in the tank or bowl.
- 3** Disconnect the supply line from tank.
- 4** Remove decorative caps. Unscrew nuts that attach the toilet to the floor.
- 5** Remove toilet.

INSTALLATION PROCEDURE

- 1** Make sure the water supply valve is shut off before installation.
- 2** Remove old closet bolts from closet flange. Clean any old wax, putty, etc. from base area.
- 3** Install new closet bolts into closet flange. (See Figure 1) You can pre-cut the closet bolts to the desired length to put on the bolt cap by doing the following: Temporarily install closet bolts and set the toilet and place the washers and nuts onto the bolts. Then mark the length needed. Take toilet out of the place and remove the closet bolts. Cut the closet bolts to the length and then turn the toilet on its side onto a soft surface to avoid scratches on the finish.
- 4** Place a new wax ring around the waste flange of toilet bowl. (See Figure 2)
- 5** Lower the toilet onto the closet bolts, so the bolts project through mounting holes in base of toilet. (See Figure 3) Using a rocking motion, press the bowl down to position the toilet onto the flange.
- 6** Install plastic cap washers, followed by metal washers and nuts onto the closet-bolts. (See Figure 4) Tighten the bolts alternately until toilet is firmly seated on the floor.
CAUTION: DO NOT OVERTIGHTEN NUTS
- 7** Install the flange bolt caps. (See Figure 4)

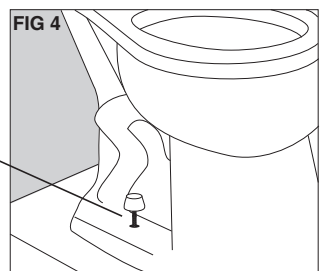
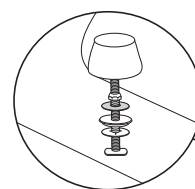
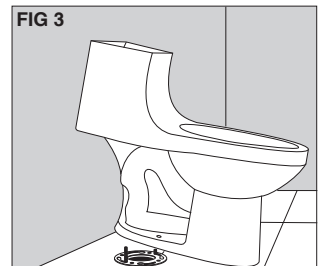
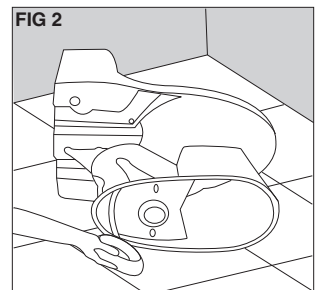
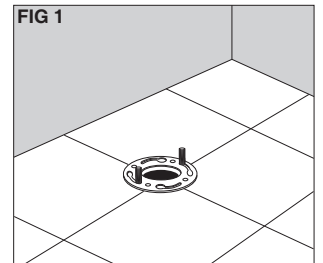

Foremost

STEP-BY-STEP
ILLUSTRATED

Instructions

REF: #1088-E

TL-2100-WL
One Piece Dual Flush Toilet

INSTALLATION OF PUSH BUTTON

3 STEPS

1 Unscrew the tightening nut which is attached to the handle mechanism.

2 Insert the push button body through the tank lid hole. Tighten with the large nut supplied. (See Figure 5)

3 Adjust threaded rods using locknuts so that the rods are positioned just over and slightly touching the top of the half flush and full flush mechanism. Note that the half flush is on the left, green tab and the full flush is on the right, white tab. (See Figure 6)

NOTE: All Foremost toilets come preset and do not need to be adjusted.

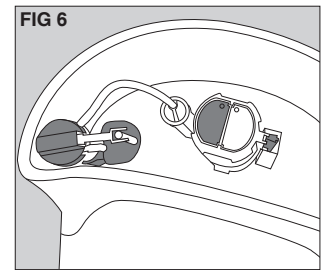
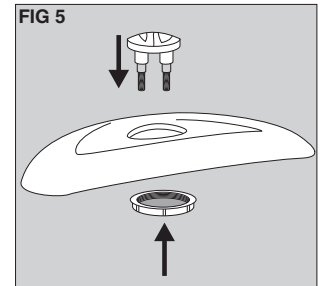

Foremost

STEP-BY-STEP
ILLUSTRATED

Instructions

REF: #1088-E

TL-2100-WL
One Piece Dual Flush Toilet

ADJUSTMENTS AND TROUBLE SHOOTING

WATER LEVEL ADJUSTMENTS (If Required)

- 1 Turn the fill valve counter clockwise and adjust it to proper height. Turn it clockwise to lock it. (See Figure 9)
- 2 Hold the threaded rod and turn it clockwise to increase the water level inside the tank. Turn it counter clockwise to lower the water level inside the tank.

WATER CONSUMPTION ADJUSTMENTS (If Required)

- 1 NOTE: This unit comes pre-set from the factory. Water consumption adjustments are possible by setting the adjusters located at the bottom and the side of the flush valve.

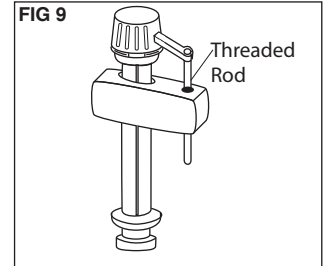

Please Note: Adjusting these settings may affect the performance and void any warranty.

TROUBLE SHOOTING

- Problem:** Water leaks from the tank to the bowl.
Solution: 1) Check for obstruction or breakage on the bottom. 2) Make sure that the threaded rod for the handle has not exceeded its standard operating length.
- Problem:** Water level is too low or too high.
Solution: Adjust the fill valve. (See: Water Level Adjustments)
- Problem:** Poor Flush, the water level is below water line mark.
Solution: The shut-off valve is not completely open; verify that the shut-off valve opens fully. The water supply line can be twisted, ensure that it is sitting in the tank properly. Fine tune adjustments are located on the side and bottom of the flush valve mechanism.
- Problem:** Water running-It may occur if the flush seal is not completely closed.
Solution: Verify if there is any obstruction with the flush seal.

Wipe the outside of the toilet gently with a damp cloth and blot dry with a soft towel.

Make sure that the complete surface is cleaned and completely dry.

NOTE: IMPROPER CARE MAY CAUSE THE WARRANTY TO BECOME INVALID.

Free Manuals Download Website

<http://myh66.com>

<http://usermanuals.us>

<http://www.somanuals.com>

<http://www.4manuals.cc>

<http://www.manual-lib.com>

<http://www.404manual.com>

<http://www.luxmanual.com>

<http://aubethermostatmanual.com>

Golf course search by state

<http://golfingnear.com>

Email search by domain

<http://emailbydomain.com>

Auto manuals search

<http://auto.somanuals.com>

TV manuals search

<http://tv.somanuals.com>