

Using the Heat Gun

Many variables affect heating applications, such as the material being heated, ambient temperature, the distance from the gun to the substrate and the heating technique. For this reason, Wagner has provided temperature guidelines for certain applications. Always start the heat gun at the lowest temperature in the range then raise the temperature until the optimum temperature is achieved. Always keep the heat gun in motion and at least 2" from the substrate when applying heat.

Use		Temp. Setting
Removing:	Floor coverings (adhesive backed)	350° - 750° F
	Paint	900° - 1200° F
Drying:	Paint	450° - 750° F
	Plaster	450° - 750° F
Heating:	Shrink-tube (electrical)	350° - 500° F
	Shrink-wrap (windows, crafts)	250° - 550° F
	Frozen locks	350° - 650° F
	Frozen water pipes	750° F - 1200° F
Loosening:	Rusted bolts/nuts	900° F - 1200° F
Molding and Bending:	Plastics	250° - 450° F
	Plexiglass and Formica	250° - 450° F
Waxing:	Skis and snowboards	250° - 450° F
Sealing:	Ends of nylon rope	450° - 650° F
Defrosting:	Refrigerator	450° - 750° F



Always read the safety information included in this manual before using the heat gun.

1. Plug the unit into a standard wall outlet.
2. Turn on the heat gun by sliding the switch to (2) (the 2 should be visible).

Note: Smoke may appear during the initial start up due to the burning of manufacturing oils. The smoke should disappear in less than a minute.

3. Press the temperature adjustment buttons until the display reads the desired temperature. Press the air flow adjustment buttons to increase (+) or decrease (-) the air flow.

IMPORTANT: If the blower motor in the heat gun does not turn on when the switch is activated, turn the switch OFF (0) immediately. The heating element will burn out if it is not cooled by the blower.

4. During rest periods or when you are finished with your project, slide the switch to Cool Down Mode (1), set the gun down in an upright position (nozzle pointing up), and allow to cool for a minimum of 15 minutes. After 15 minutes, turn the switch OFF (0) if you are finished, or turn switch to Usage setting (2) to continue.

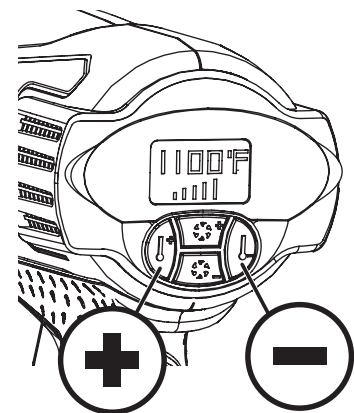

Note: Always set the heat gun upright (nozzle pointed up) after it is turned off, either for a short break or for storage. Avoid laying the unit on the side after shutdown. The heat will remain in the unit and cooling will take longer. Store the unit only after the nozzle is cool. Unplug the unit before storing to prevent accidental startup.

IMPORTANT: Always protect glass when working near windows.



Do not touch nozzle or the scraper blade when working. These become extremely hot and will cause severe burns. Wear gloves to protect hands from hot scrapings.

Stripping Paint

The heat gun heats up the surface and causes the paint to soften, at which time it can be scraped off easily without damaging the surface. Some paints may soften even though they do not blister; some may become rubbery, and some may require higher heat.

When working with several layers of paint, it speeds up the scraping process to heat the surface thoroughly, all the way to the wood. Then all the layers can be scraped at one time.

A soft wire brush may be the best tool to use for very intricate surfaces. Mineral paints and finishes, such as cement paint and porcelain, do not soften with heat, so using a heating tool will not work for paint removal.

The best method of paint removal

Move the gun slowly and steadily forward at an angle to the surface, pointing the nozzle in the direction of motion. This allows you to scrape safely outside the hot air stream and keeps the scraper and the scraped surface cooler.

- A. Warm air preheats the surface.
- B. Paint is softened by hot air.
- A + B. Deep penetration of heat over total area.
- C. Paint can be easily scraped off as soon as it is softened and the gun is moved forward.
- D. Stripped surface allowed to cool.

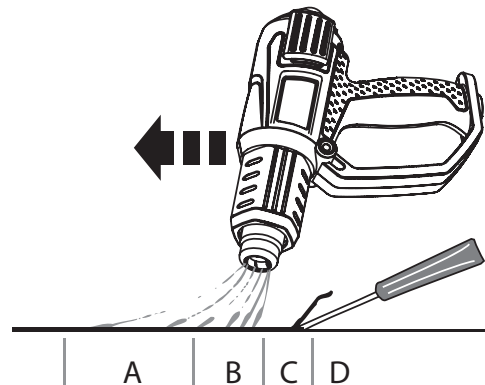

Note: Do not use the heat gun on surfaces that can be damaged by heat, such as vinyl-coated paneling, siding or window frames.

When removing paint from window frames, the heat gun will soften the putty. Be careful not to gouge the putty with the scraper. The putty will firm up after it cools.

Do not use the heat gun on insulating laminated window glass such as Thermopane. The glass edge expansion may break the edge seal.

When scraping fascia, do not overheat the edges of the asphalt shingles protruding over the edge of the sheathing. Too much heat will melt the asphalt.

IMPORTANT: The removal of paint by heat gun is safe if the above guidelines are used, but always keep either a container of water or an ABC fire extinguisher within reach.

IMPORTANT: Read the general operating and safety information sections of this owner's manual before using the heat gun.

Cleaning and Maintenance

Keep the intake openings on the housing clean and free of obstructions. Use a soft, dry brush to clean the openings periodically. Use only mild soap and a damp cloth to clean the heat gun. Many household cleaners contain chemicals which could seriously damage the housing.

Do not use gasoline, turpentine, lacquer or paint thinner, dry cleaning fluids or similar products when cleaning the heat gun. Never allow any liquid to get inside the tool or immerse any part of the tool into a liquid.

Storage

Allow the heat gun nozzle to cool to room temperature before placing in storage.

The nozzle will turn dark over time because of the high heat. This is normal and will not affect the performance or life of the unit.

Accessories

The following accessories may come with the gun or may be purchased separately by calling 1-800-727-4023.



Scraper tool with interchangeable blades

Scraper handle
P/N ORF601-SH



Paint scraper
P/N ORF601-SC



Three-blade set
P/N ORF601-TS

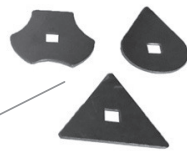

IMPORTANT: Always use gloves when handling the heat gun. Use of nozzle accessories will produce hotter gun temperatures which may result in decreased durability of the gun.

To attach an optional item to the gun:

1. Set the heat gun upright on a level surface until the tip is cool.
2. Set the item onto the tip of the heat gun and push firmly into place by hand.

To remove an optional item:

1. Set the heat gun upright on a level surface until the tip is cool.
2. Pull the item off of the tip.

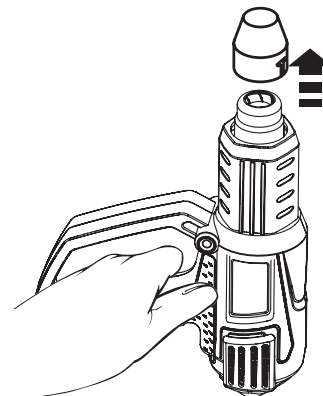

Free Manuals Download Website

<http://myh66.com>

<http://usermanuals.us>

<http://www.somanuals.com>

<http://www.4manuals.cc>

<http://www.manual-lib.com>

<http://www.404manual.com>

<http://www.luxmanual.com>

<http://aubethermostatmanual.com>

Golf course search by state

<http://golfingnear.com>

Email search by domain

<http://emailbydomain.com>

Auto manuals search

<http://auto.somanuals.com>

TV manuals search

<http://tv.somanuals.com>