

Canon

High Capacity Stacker-C1

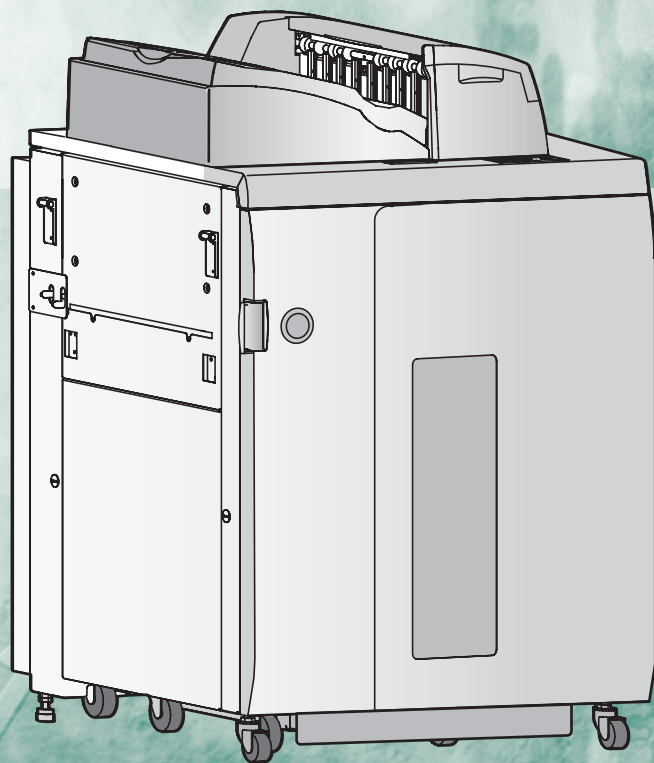

Please read this guide before operating this product.
After you finish reading this guide, store it in a safe place for future reference.

ENG



Structure of Users Guide

Chapter 1 Before You Begin

Read here first.

1

Chapter 2 Operating Procedures

2

Chapter 3 Troubleshooting

3

Chapter 4 Appendix

4

Important Information

- This manual is designed to help you to install, operate and maintain the stacker. Please read and understand this manual, and keep it in a safe and convenient place.
- Do not operate the stacker until you read and understand the instructions in this manual.
- Canon shall not be liable for incidental or consequential damages resulting from: improper or inadequate maintenance by the customer, unauthorized modification or misuse, or operation outside of the environmental specifications for the product.
- Canon pursues a policy of continuing improvement in design and performance of the product. Therefore, the product design and specifications are subject to change without prior notice and without our legal obligation.
- All rights are reserved. No part of this manual may be photocopied, reproduced or translated to another language without the prior written consent of your local authorized dealer.
- This product applies to the CE Marking.





- This manual describes the operating procedures for the stacker. For the functions and installing operation for the host machine (printer), see the operating manual of the host machine (printer.)

Safe Use of Machine

To use this machine safely, proper operation and periodical maintenance are indispensable. Read the safety precautions described in this manual thoroughly, and do not perform operations or maintenance procedures until you understand them completely.

The operating procedures and safety precautions described in this manual are valid only for proper use of this machine. Responsibility for any improper use or operation of this machine, lies with the user.

Safety precautions are indicated in this manual as follows:

 WARNING	Indicates a warning concerning operations that may lead to death or injury to persons if not performed correctly. In order to use the machine safely, always pay attention to these warnings.
 CAUTION	Indicates a caution concerning operations that may lead to injury to persons, or damage to property if not performed correctly. In order to use the machine safely, always pay attention to these cautions.



Important

This symbol indicates the range of acceptable values and operating conditions.







Note







This symbol indicates useful supplementary information for operational procedures.

Operating Safety Precautions

WARNING



	Do not remove the covers and screws unless instructed to do so in this manual. There are high voltages and moving parts which may cause electrical shock and injury in the machine.
	When moving the machine, be sure to turn off the power of operation section and the main power switch, then disconnect the power cord and contact your local authorized dealer. Otherwise, the cord may be damaged and may result in a fire or electric shock.
	Take care not to be caught between the top cover and the horizontal transport section.
	When you remove the sheets from the stacking section, take care not to be caught between the stack guide and the stack tray. Otherwise, it may lead to severe injury.
	Usually, the rollers do not rotate when any cover is opened. But by some chance such as machine breakdown, it may rotate with the cover opened. When you remove the sheets from the left turn-over section, take care not to be caught by the roller. Otherwise, it may lead to severe injury.

CAUTION

	This machine weighs about 200 kg (440 lb). When you operate the machine, consider the machine weight and use the machine safely.
	Turn off the power switch before connecting the power cable. It may cause damages on the machine.
	Do not use paper which does not meet the specifications. Poor quality paper can cause paper jams.
	Do not open the covers during the stacking operation. The machine will stop and cause a paper jam.
	If the power is turned off, wait at least 10 seconds before turning it on again.
	Do not place any object on or under the stack tray. It may cause damages on the machine.
	Use this machine at office or commercial environment. Do not use this machine at industrial environment.

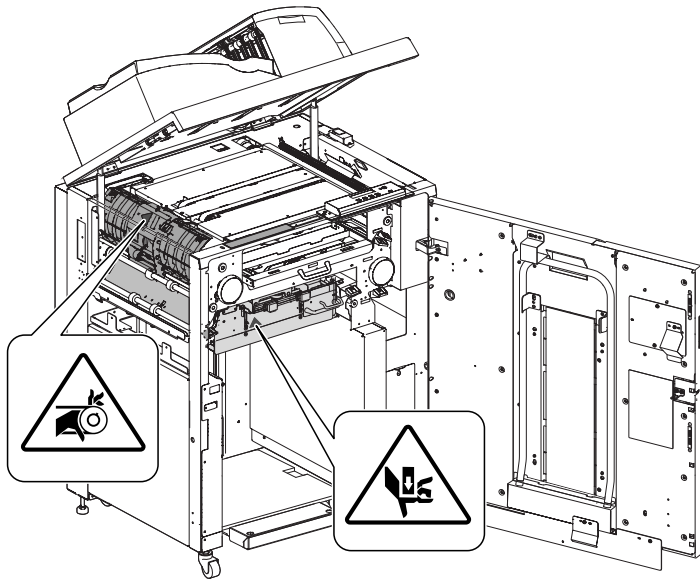
Warning Label Locations and Meanings



	<p>When you remove the sheets from the stacking section, take care not to be caught between the stack guide and the stack tray. Otherwise, it may lead to severe injury.</p>
	<p>Usually, the rollers do not rotate when any cover is opened. But by some chance such as machine breakdown, it may rotate with the cover opened. When you remove the sheets from the left turn-over section, take care not to be caught by the roller. Otherwise, it may lead to severe injury.</p>

FCC NOTICES

NOTICE

This equipment has been tested and found to comply with the limits for a Class A digital device, pursuant Part 15 of the FCC Rules. These limits are designed to provide reasonable protection against harmful interference when the equipment is operated in a commercial environment. This equipment generates, uses and can radiate radio frequency energy and, if not installed and used in accordance with the instruction manual, may cause harmful interference to radio communications. Operation of this equipment in a residential area is likely to cause harmful interference in which case the user will be required to correct the interference at this own expense.

FCC WARNING



Changes or modifications not expressly approved by the party responsible for compliance could void the user's authority to operate the equipment.

CONTENTS

Important Information	i
Safe Use of Machine	ii
Operating Safety Precautions.....	ii
Warning Label Locations and Meanings	iii
FCC NOTICES	iii

Chapter 1 Before You Begin

Features of the Machine	1-2
Machine Description	1-3
Section Descriptions	1-4
[1] Entrance Section	1-4
[2] Horizontal Transport Section	1-5
[3] Left Turn-Over Section	1-6
[4] Offset Section	1-7
[5] Right Turn-Over Section	1-8
[6] Stacking Section	1-9
[7] Top Cover-OUTPUT TRAY Section	1-10
[8] Control Panel	1-10
Paper Path	1-11
Single-Unit Operation	1-11
Control Displays	1-12

Chapter 2 Operating Procedures

Stacking Sheets	2-2
Removing Sheets	2-4

Chapter 3 Troubleshooting

Error Messages	3-2
Service Call Error	3-2
Error Message Chart	3-3
Clearing Paper Jams	3-5
Correcting Paper Curl.....	3-6
Powering Problem (Circuit Breaker Check).....	3-8

Chapter 4 Appendix

Specifications	4-2
Specifications	4-2
Index	4-3

Before You Begin

1

CHAPTER

Features of the Machine	1-2
Machine Description	1-3
Section Descriptions	1-4
[1] Entrance Section.....	1-4
[2] Horizontal Transport Section	1-5
[3] Left Turn-Over Section.....	1-6
[4] Offset Section	1-7
[5] Right Turn-Over Section	1-8
[6] Stacking Section	1-9
[7] Top Cover-OUTPUT TRAY Section	1-10
[8] Control Panel	1-10
Paper Path	1-11
Single-Unit Operation.....	1-11
Control Displays.....	1-12

Features of the Machine

OUTPUT TRAY

Ejecting prints such as sample or interrupt prints on the OUTPUT TRAY enables highly productive performance without interrupting the stacking operation. The maximum stack height is 100 mm (3.94").

Possible Configurations

You can use this machine as a stand-alone unit. Or you also can send the sheets straight through to the downstream unit without stacking.

Double-unit Operation

You can join two stackers together and use as double-unit. (To use as double-unit, it is necessary to purchase two stackers.)

Maximum Stacking Capacity

The maximum stack height in the main stack tray is 570 mm (22.44").

Offset Mechanism

The offset mechanism does offset stacking without slowing down the production speed.

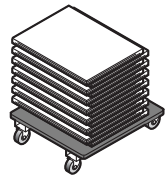

Machine Description

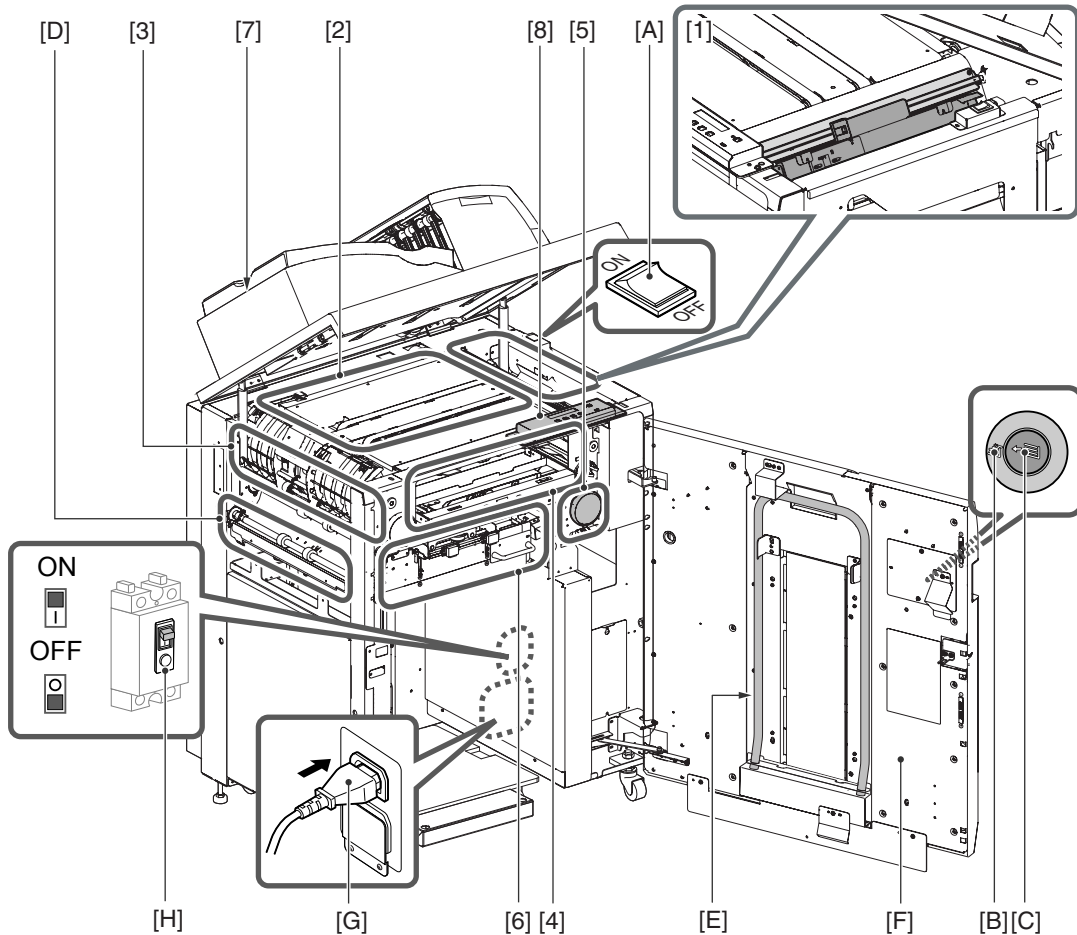

- [1] Entrance Section (See page 1-4).
- [2] Horizontal Transport Section (See page 1-5).
- [3] Left Turn-Over Section (See page 1-6).
- [4] Offset Section (See page 1-7).
- [5] Right Turn-Over Section (See page 1-8).
- [6] Stacking Section (See page 1-9).
- [7] Top Cover-OUTPUT TRAY Section (See page 1-10).
- [8] Control Panel (See page 1-10).

- [A] Power Switch
- [B] Stack Status LED
Lit :Stacker is full.
Blinking :Stacker is operating.

- [C] Front Cover Open Button (and LED)
Lit: Cover unlocked.
Blinking: Stack tray is moving up or down.
- [D] Downstream Exit Section (See page 1-11).
- [E] Handle
Use this handle to remove sheets from the stacking section.
- [F] Front Cover
Press the front cover open button to open. When the machine is running, press the button and wait until the lamp lights up, and then open the cover.
- [G] Power Cable
- [H] Circuit Breaker

Section Descriptions

1

Before You Begin

[1] Entrance Section

This section receives each sheet as it is delivered from the upstream machine (printer). The first gate sends the sheets to the stack tray or to the OUTPUT TRAY.

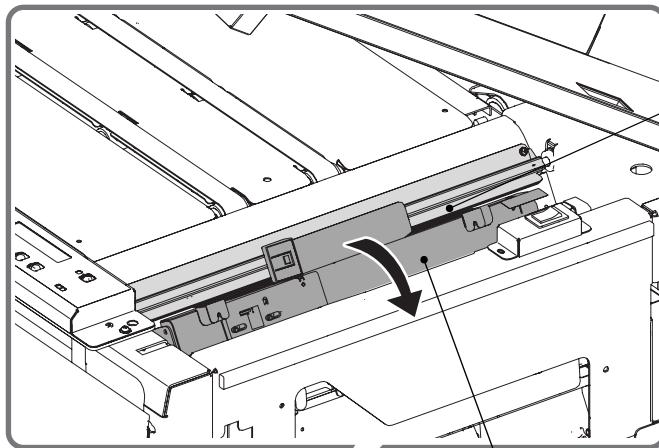

First Gate

This gate diverts the sheet transport path, to the stack tray/downstream unit, or to the OUTPUT TRAY.

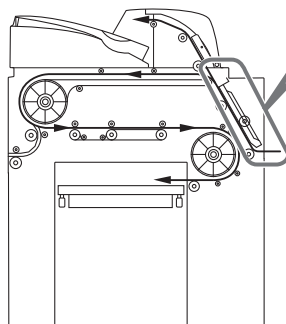
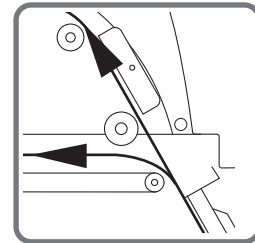

Entrance Transport Guide [S B]

If any sheets jam in the entrance section, open the top cover, hold the green handle and open this guide, and remove the jammed sheets.

[2] Horizontal Transport Section

Sheets delivered from the entrance section, pass here before being carried to the Left Turn-Over section.

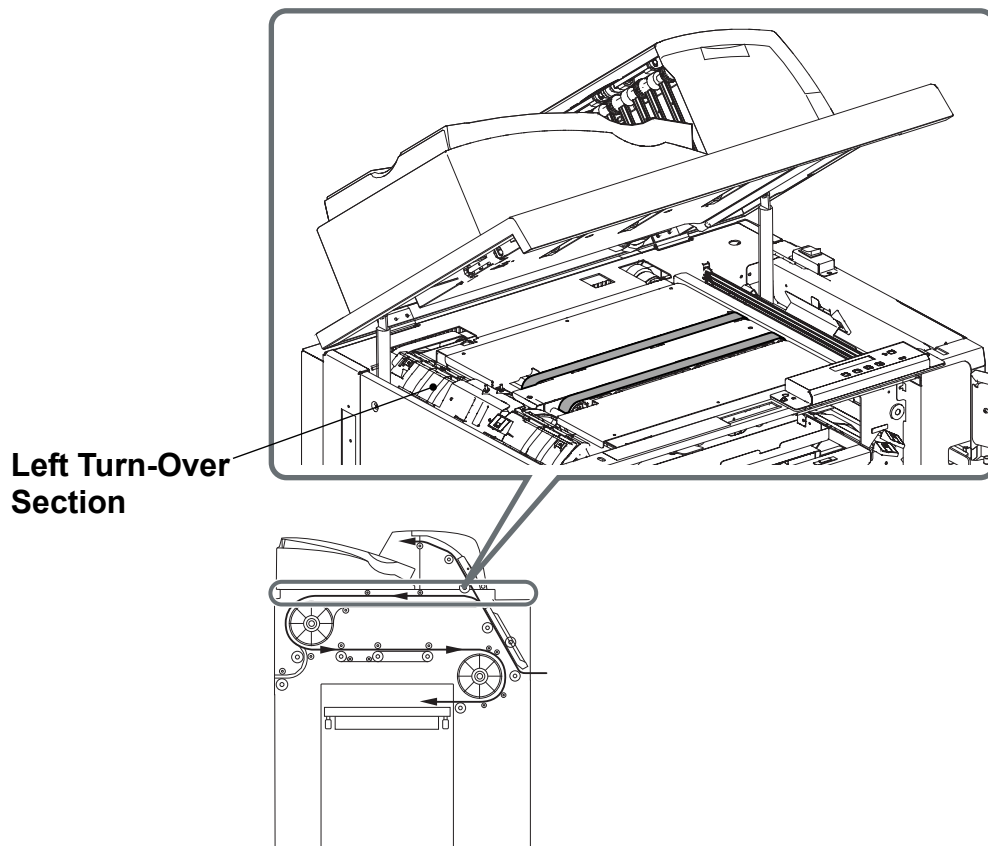

[3] Left Turn-Over Section

This section turns over sheets delivered from the horizontal transport section. The second gate sends the sheets to the stack tray or to the next machine in the line.

1

Before You Begin

Left Lower Guide

[S E1]

If any sheets jam in the downstream exit section, hold the green handle to open this guide, and remove the jammed sheets.

Downstream Exit Section

Any sheets which are sent to the downstream unit pass through this section.

Left Upper Guide

[S C]

If any sheets jam in the left turn-over section, hold the green handle to open this guide, and remove the jammed sheets.

Second Gate

This gate sends the sheets, to the stack tray of this machine, or to the connected downstream unit.

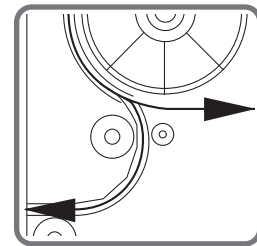

Left Dial [S D2 S E2]

If any sheets jam, turn this dial counterclockwise and move the sheets manually. Dial idles by turning it clockwise.

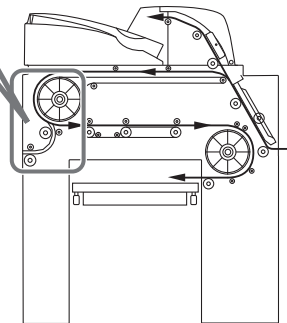
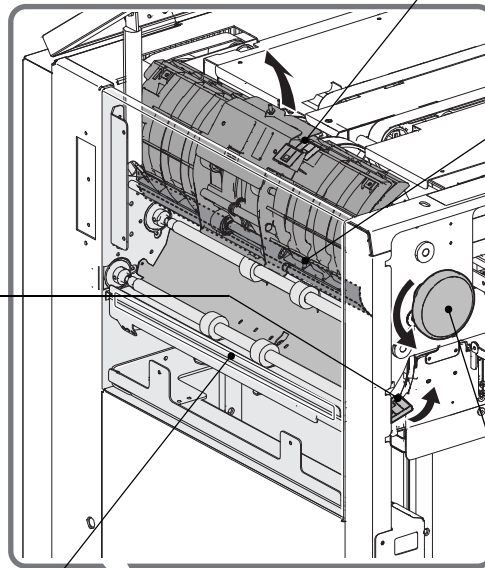

[4] Offset Section

In this section, sheets can be shifted during transport to enable offset stacking. As a result, the ejected sheets are offset on the stack tray.

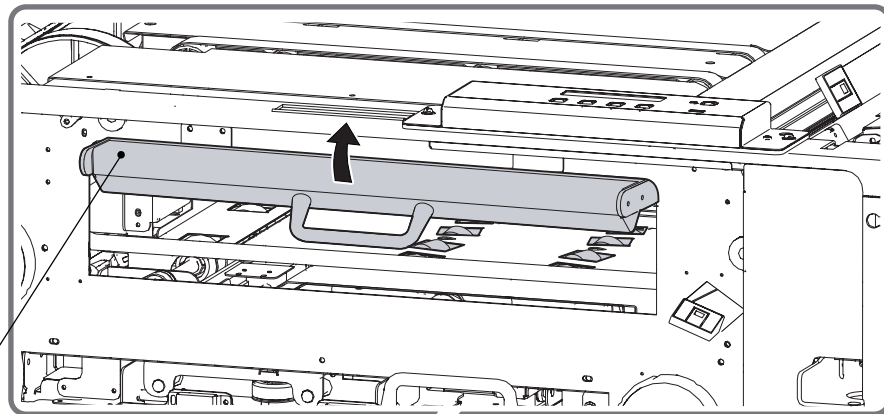

Offset Section Guide

[S D1]

If any sheets jam in the offset section, open this guide and remove the jammed sheets.

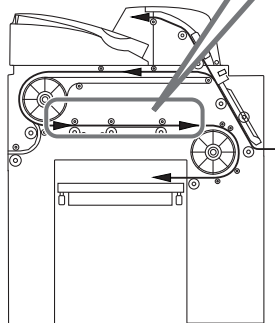

[5] Right Turn-Over Section

This section turns over each sheet after it is delivered from the offset section.

1

Before You Begin

Right Dial

[S D5]

If any sheets jam, turn this dial clockwise to move the sheets manually.

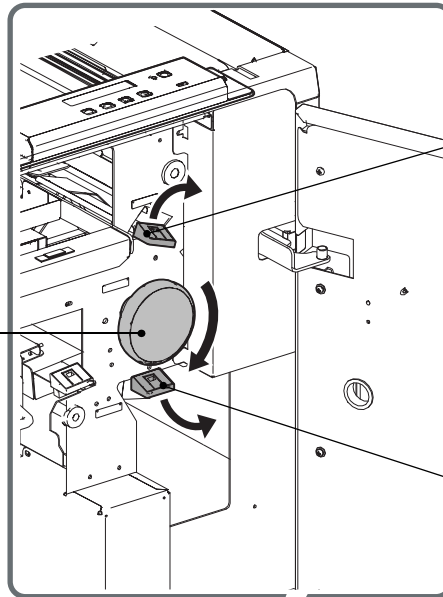

Right Upper Guide

[S D3]

If any sheets jam in the right turn-over section, hold the green handle to open this guide, and remove the jammed sheets.

Right Lower Guide

[S D4]

If any sheets jam in the right turn-over section or stacking section, hold the green handle to open this guide, and remove the jammed sheets.

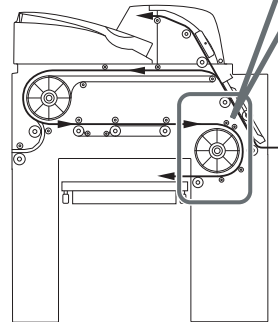

[6] Stacking Section

Sheets delivered from the offset section are transported to the stacking section, and then ejected on the stack tray. The maximum stack height is 570 mm (22.44").

Opening the Front Stack Guide

If the sheets stack height exceeded the stack height 550 mm (21.65"), open the front stack guide before pulling the stack tray.

Hold the blue handle shown in the illustration to the left and turn it upward. Make sure to close the front stack guide before closing the front cover.

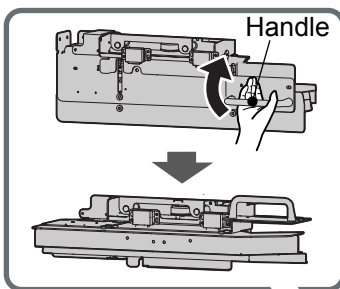

! WARNING

When you remove the sheets from the stacking section, take care not to be caught between the stack guide and the stack tray. Otherwise, it may lead to severe injury.

Front Stack Guide

This guide arranges the sheets which are ejected onto the stack tray. To enable offset stacking, the inner plate of the rear stack guide and front stack guide lift alternately, offsetting the sheets.

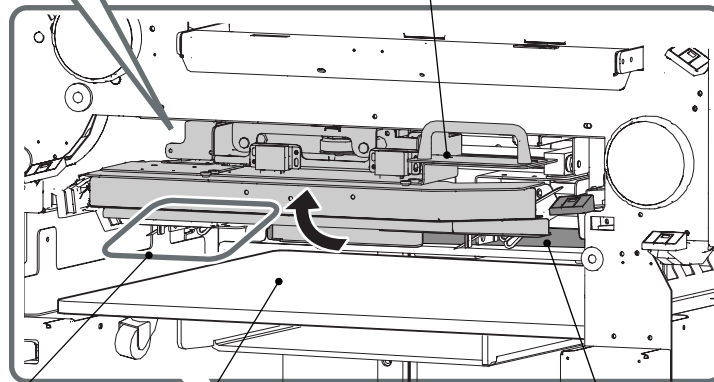

Stack Stopper

This stopper moves automatically to match the sheet size which has been set on the control panel.

Stack Tray

This tray can stack the sheets up to a maximum of 570 mm (22.44").

When the stack tray is full, it moves down automatically to the lowest point. Insert the handle, which is attached inside the front cover, and pull out the tray.

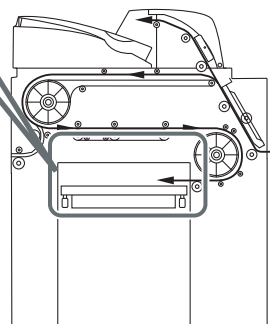

Rear Stack Guide

This guide arranges sheets which are ejected onto the stack tray.

It moves automatically to match the sheet size which has been set on the control panel.

[7] Top Cover-OUTPUT TRAY Section

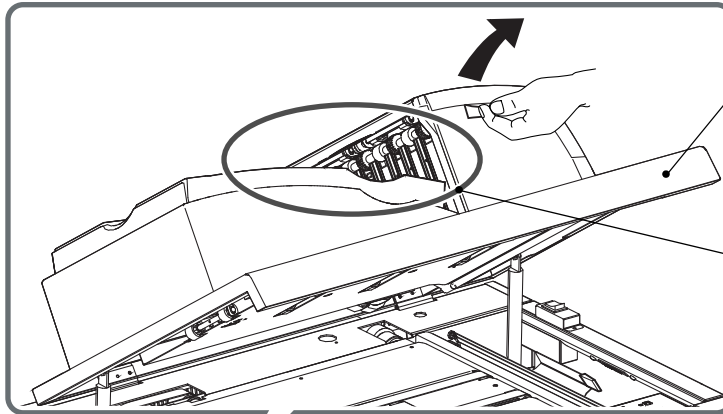

Top Cover

If any sheets jam in the entrance section or horizontal transport section, open this cover and remove the jammed sheets.

OUTPUT TRAY

By ejecting prints, such as sample or interrupt prints on this tray, it enables highly productive performance without interrupting the stacking operation. The maximum stack height is 100 mm (3.94").

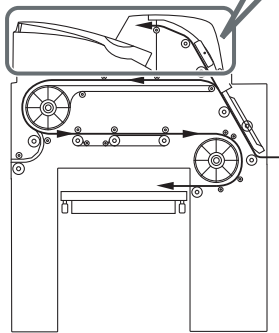

⚠ CAUTION

When you open the top cover, remove sheets on the OUTPUT TRAY first, then open the top cover. Otherwise, the top cover may fall because of the weight of the sheets on OUTPUT TRAY, and your finger may be caught.

[8] Control Panel

Perform settings and operations for the machine using the controls on this panel.

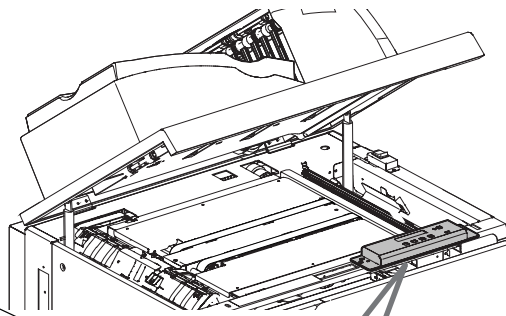

LCD Display

This displays status messages (See page 1-12 to 1-14) or error messages (See page 3-2 to 3-4).

Control Keys

These keys are used to switch the menu such as curl correction or indicated language select. (See page 1-13)

Stack ON/OFF Button

This button activates or deactivates stacking. This button is invalid during a job.

ON: Activate
OFF: Deactivate

When the LED on the left of the button lights up (green), the stacking function is active.

Error Lamp

This lamp lights up or blinks if an error occurs.

Blinking: An error (paper jam, cover open, stack tray full) occurs.

Lit: Service call error occurs.

Paper Path

Single-Unit Operation

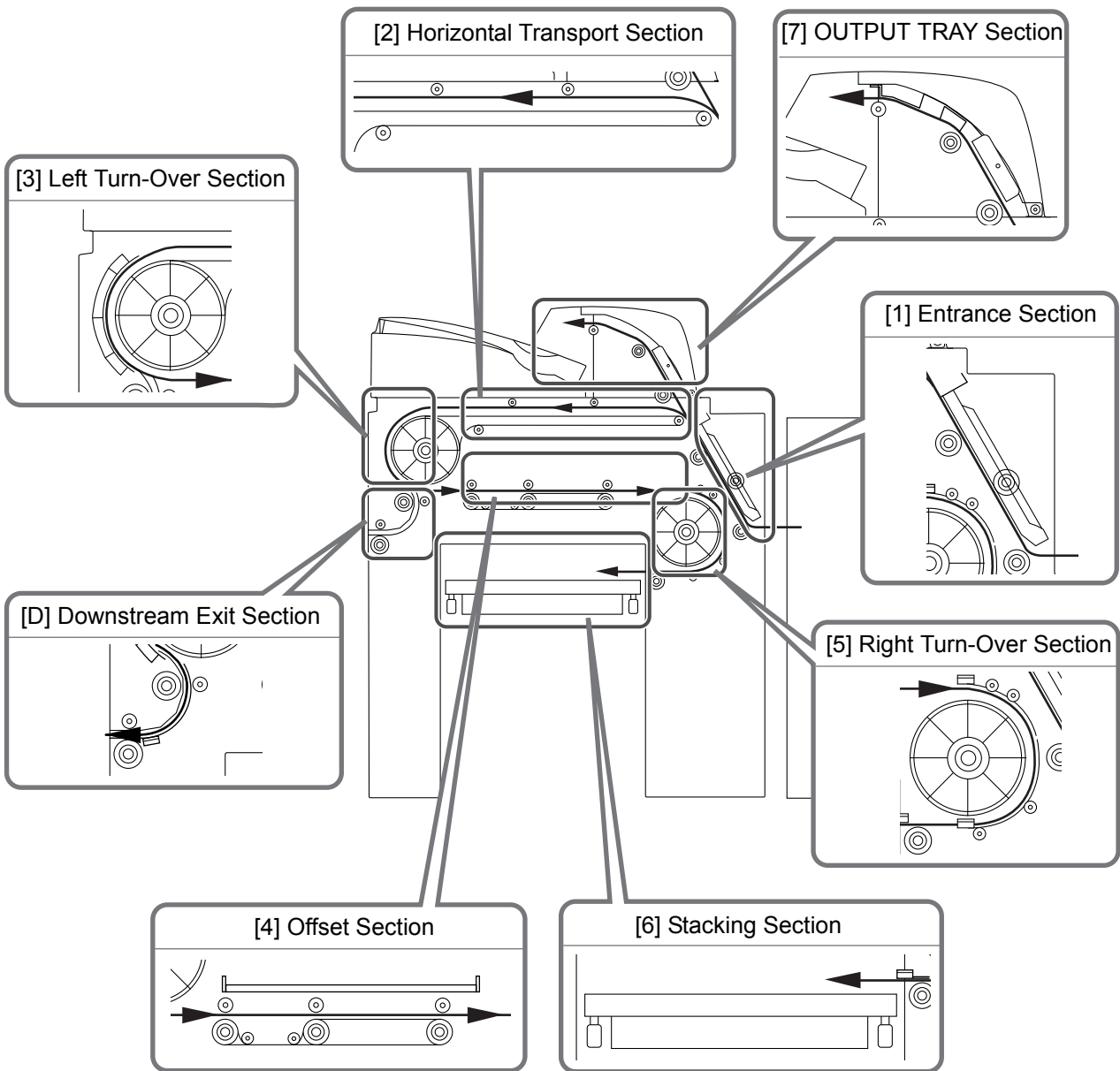

Control Displays

1

Before You Begin

Power On

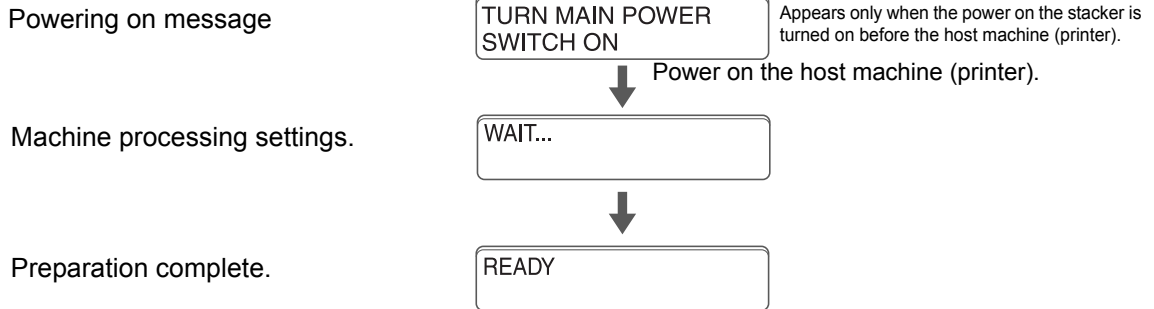

Ejecting to the OUTPUT TRAY

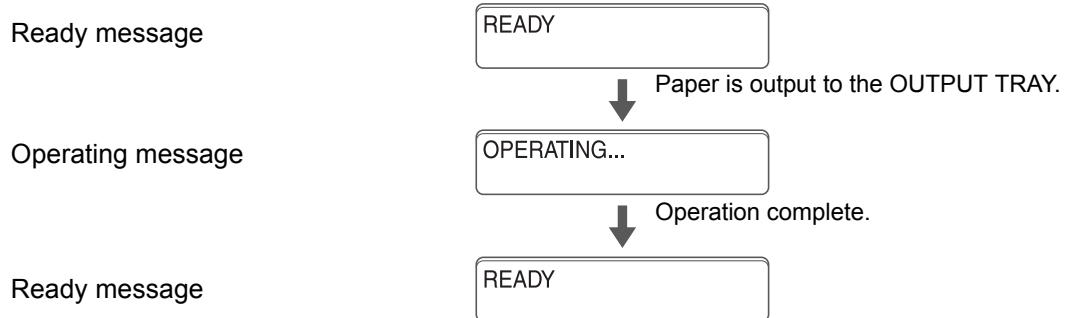

Ejecting to the Stack Tray

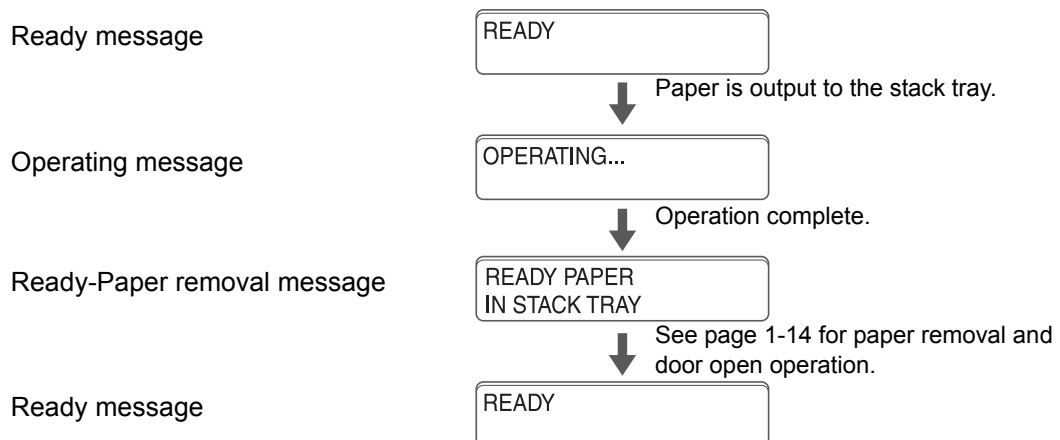

Curl Correction / Indicated Language Select

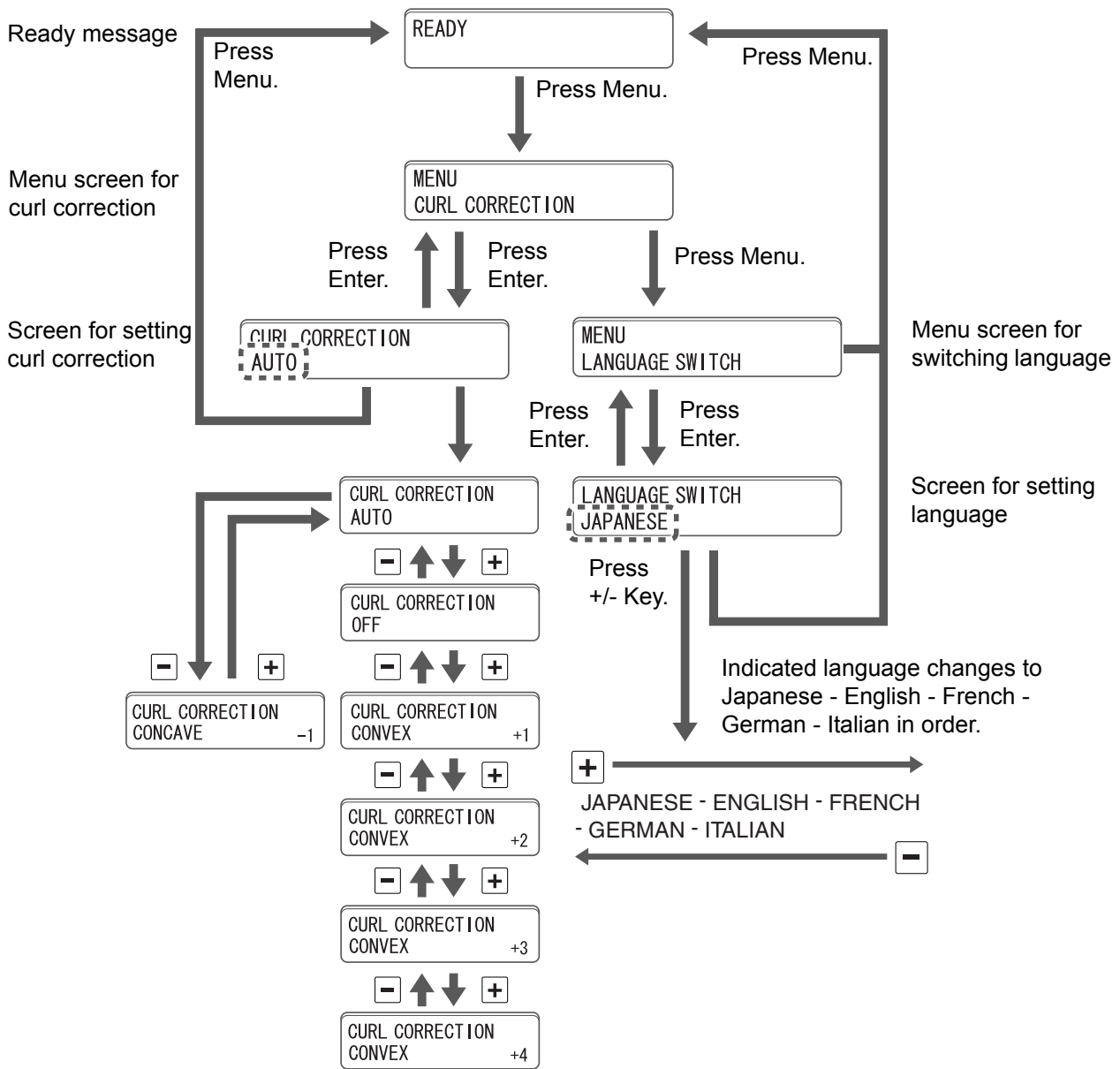

Important

- To correct the curl, perform the steps below in order.
 1. Set up the curl correction to [AUTO].
 2. If the sheets are still curled after step 1 is performed, change the curl correction amount on the printer.
 3. If the sheets are still curled after step 2 is performed, set up the curl correction to [CONVEX], [CONCAVE], or [OFF].
- If the curl correction function is set incorrectly, paper jam or stacking error may occur. Refer to 3-6 [Correcting Paper Curl] for details.
- Curl correction function is available only for the sheets delivered to the stack tray.

Paper Removal and Door Open Operation

1

Before You Begin

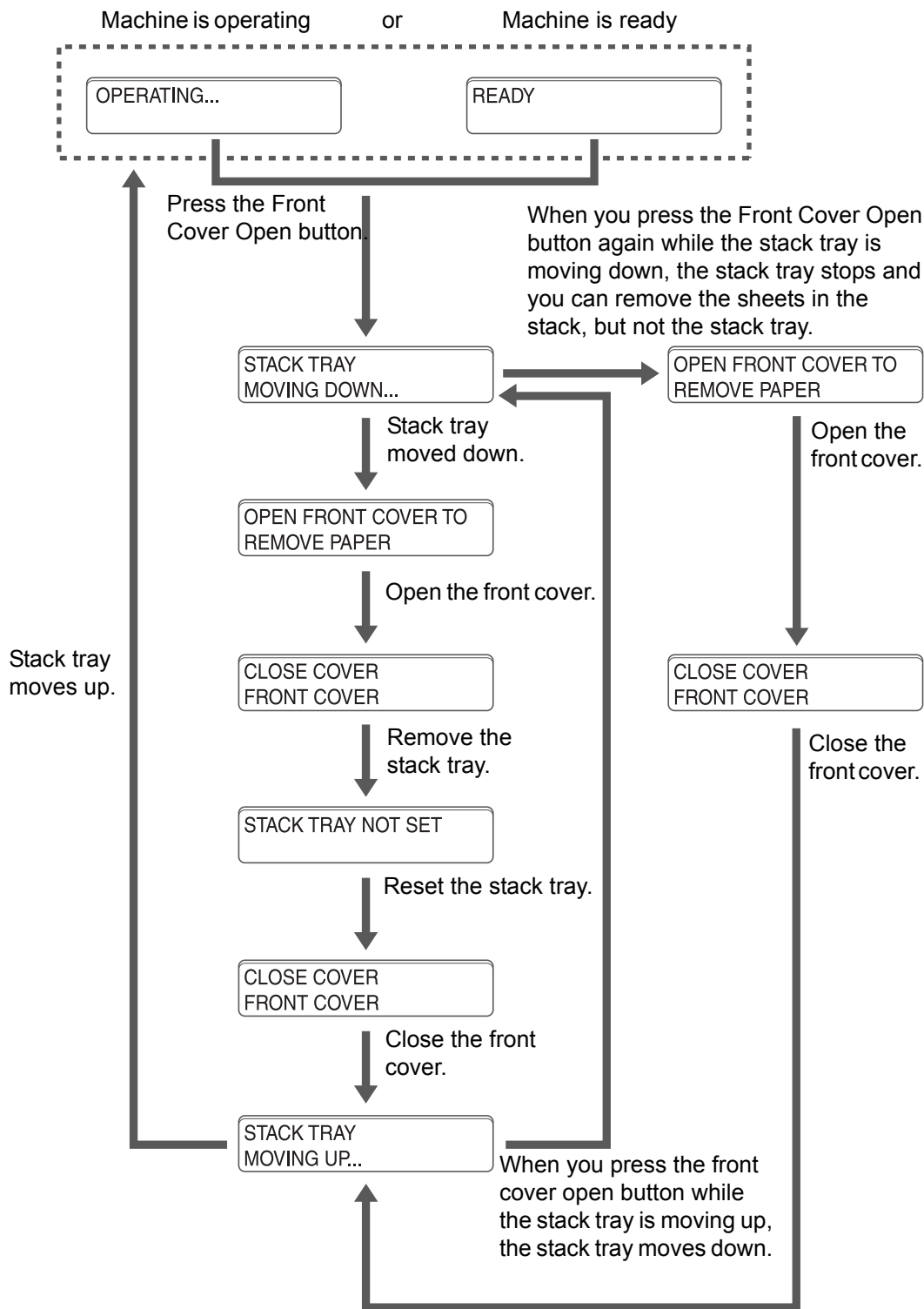

Operating Procedures

2

CHAPTER

Stacking Sheets	2-2
Removing Sheets.....	2-4

Stacking Sheets



Important

When different sizes paper are stacked together, the paper cannot be squared-up neatly. To square-up the paper neatly, stack only same size paper.

- 1 Turn on the power switch of the main unit, then turn on the power switch of the stacker.**

The LCD display presents the Wait screen.

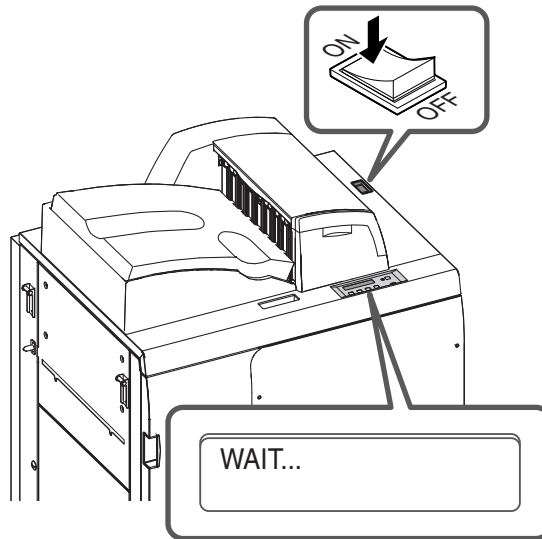

- 2 When the machine preparation completes, the LCD display changes to the Ready screen.**

▼ Wait Screen



▼ Ready Screen



Important

If the power switch on the machine is turned on while the power of the upstream machine (printer) is off, the message shown below appears. Turn on the power switch for the upstream machine (printer).

TURN MAIN POWER
SWITCH ON

- 3 Power on the host machine (printer.)**

4 Press the front cover open button and open the front cover.

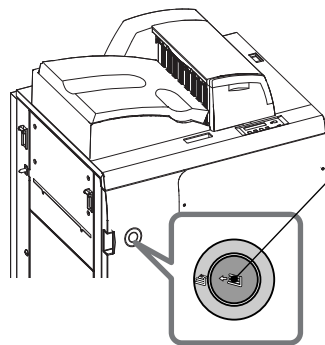

Front Cover Open Button

Lit: Front cover can be opened.
 Blinking: Do not open the front cover.

5 Place the stack tray and close the front cover.



Important

- Push the stack tray to the rear until it is held by the magnet of the support.
- If the tray is placed incorrectly, it will not move up when the front cover is closed.

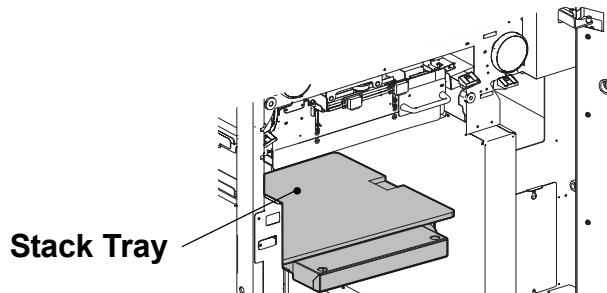

6 Turn on the stacking function.

Press the Stack ON/OFF button. When the LED to the left of the button lights up (green), the stacking function is active.



Note

If the stacking function is not turned on, you cannot select the stacker for the output, from the printer.

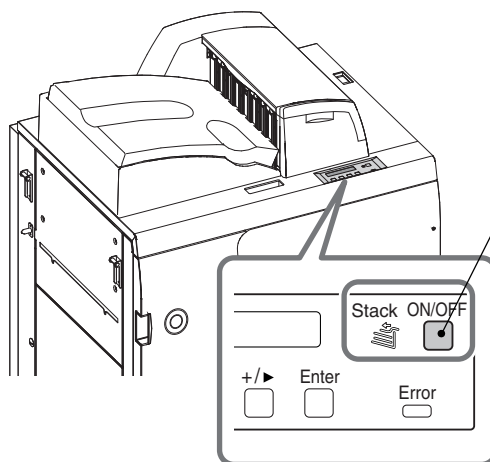

Stack ON/OFF Button

This button is invalid during a job.
 ON: Activate
 OFF: Deactivate

Set up the printer and start printing. See the operating manual for the printer.

Removing Sheets

2

- 1** When the stacking operation is complete, press the **Front Cover Open Button** and remove the stacked sheets.

While the stack tray is moving down, the button blinks.

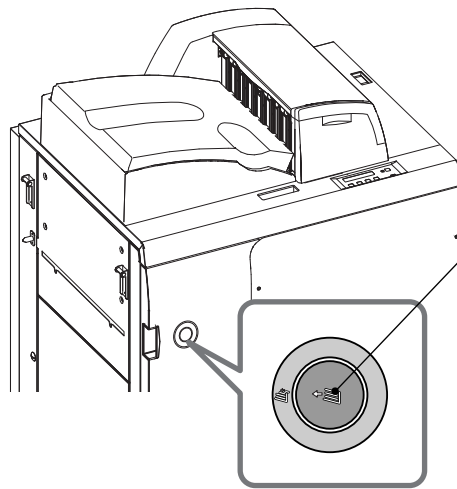

Front Cover Open Button

Lit: Front cover can be opened.

Blinking: Do not open the front cover.

CAUTION

When pressing Front Cover Open Button during the machine is running, wait until the lamp lights up, and then open the cover.

2 When the button lights up, open the front cover. Attach the handle to the stack tray and pull it out to the front.

The handle is mounted to the back of the front cover.

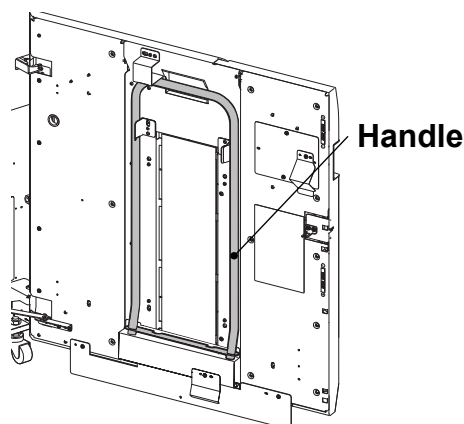

⚠ CAUTION

If the sheets stack height exceeded the stack height 550 mm (21.65"), the stack may fall over when pulling out the stack tray. In case when the sheets stack height exceeded 550 mm (21.65"), open the front stack guide before pulling the stack tray. Make sure to close the front stack guide before closing the front cover.

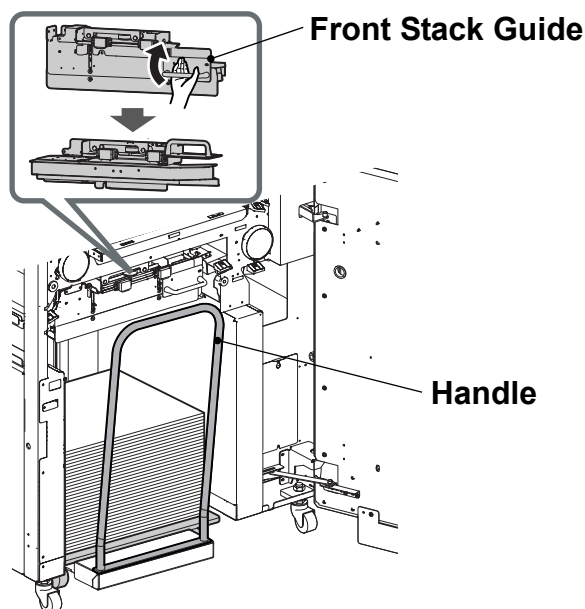

⚠ CAUTION

Use the handle to pull the tray straight forward. If you tilt the tray, the stack may fall over.

3 Replace the empty stack tray and close the front cover.

The stack tray will move up automatically.

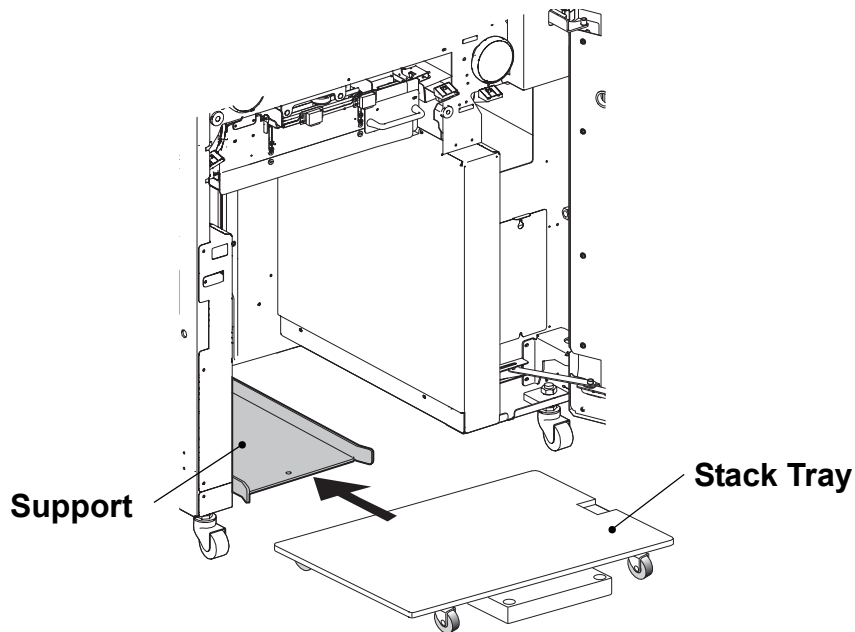

Note

- After you place the stack tray on the support, remove the handle. (If the handle is attached to the stack tray, you will not be able to close the front cover.)
- Push the stack tray to the rear until it is held by the magnet of the support. If the stack tray is placed incorrectly, it will not be able to move up.
- If the front stack guide is opened before pulling out the stack tray, make sure to close the front stack guide before closing the front cover. Stacking operation cannot be performed with the front stack guide opened.
- Mount the handle to the back of the front cover as shown in the illustration below.

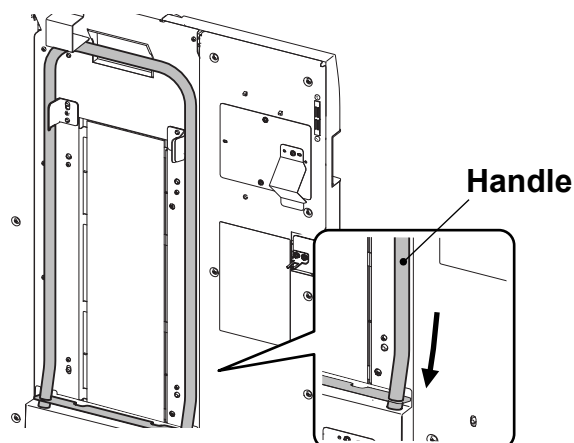

Troubleshooting

3

CHAPTER

This section explains how to identify problems and correct them.

Error Messages.....	4-2
Service Call Error.....	4-2
Error Message Chart.....	4-3
Clearing Paper Jams	4-5
Correcting Paper Curl	4-6
Powering Problem (Circuit Breaker Check)	4-8

Error Messages

When an error occurs and the machine does not work properly, the following screen will be shown. If the screen indicates the “SERVICE CALL ERROR”, perform as follows:

E000511-0080
SERVICE CALL ERROR

 **WARNING**

Do not plug in and out the power plug by wet hand.
It causes electrical shock.

 **CAUTION**

When you plug out the power plug, be sure to hold the plug. If you pull the power cable, it may expose or cut the core wires and cause a leak of electricity, and result in fire or electrical shock.

Service Call Error

When SERVICE CALL ERROR is shown on the LCD, turn off the power switch of the stacker and the upstream machine (printer). Wait about 10 seconds, and turn on the power switch of the stacker and then turn on the power switch of the upstream machine (printer) again. If the SERVICE CALL ERROR is still shown on the LCD, check the following items, turn off the main power, and disconnect the power plug. Then contact your local authorized dealer.

- Product Name
- State of trouble
- Code number indicated on the screen

Error Message Chart

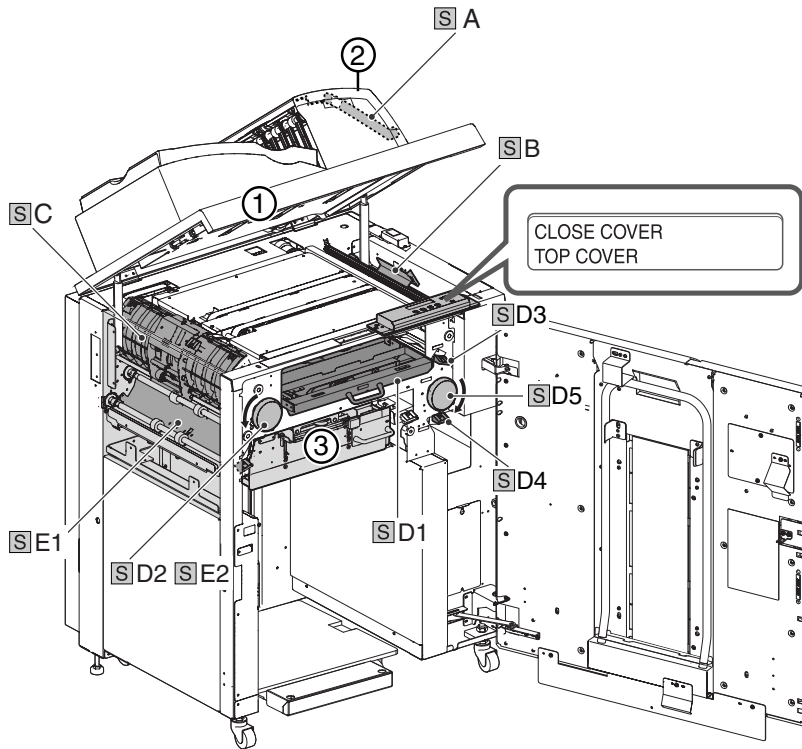

WARNING

When you remove the sheets from the left turn-over section, take care not to be caught by the roller. Otherwise, it may lead to severe injury.

When you remove the sheets from the stacking section, take care not to be caught between the stack guide and the stack tray. Otherwise, it may lead to severe injury.

Error Message	Cause	Remedy
CLOSE COVER TOP COVER	The top cover is open.	Close the top cover ①.
CLOSE COVER OUTPUT TRAY COVER	The OUTPUT TRAY cover is open.	Close the OUTPUT TRAY cover ②.
REMOVE PAPER FROM OUTPUT TRAY	The OUTPUT TRAY is full.	Remove the paper from the OUTPUT TRAY.
REMOVE PAPER FROM STACKER	The stack tray is full.	Remove the paper from the stack tray.
UNEVEN STACK REMOVE STACKER PAPER / IF PAPER IS CURLED PERFORM CURL ADJUST.	1. The paper is curled. 2. Paper on the stack tray is leant.	Check the message displayed on the host machine (printer) control panel.
STACK TRAY NOT SET	The stack tray is not placed correctly.	Place the stack tray correctly.
CLOSE GUIDE STACK GUIDE F. COVER	Front cover is closed without closing the front stack guide ③.	Open the front cover and close the front stack guide ③, then close the front cover.
REMOVE JAMMED PAPER B	A paper jam occurred in ❷ B section.	Open the top cover ① and open the ❷ B guide to remove the jammed paper. Close the guide and the cover, and the printing will be restarted. *1
REMOVE JAMMED PAPER A	A paper jam occurred in the ❷ A section.	Open the OUTPUT TRAY cover ② and open the ❷ A guide to remove the jammed paper. Close the guide and the cover, and the printing will be restarted.

Error Message	Cause	Remedy
REMOVE JAMMED PAPER C	A paper jam occurred in [S] C section.	Open the top cover ①, [S] C guide and remove the jammed paper. Close the guide and the cover, and the printing will be restarted. *1
REMOVE JAMMED PAPER D1 2	A paper jam occurred in [S] D1 and [S] D2 [S] E2 section.	Open the top cover ①, [S] C guide, front cover, [S] D1 guide and turn the [S] D2 [S] E2 dial counterclockwise to remove the jammed paper. Close the guide and the cover, and the printing will be restarted. *1
REMOVE JAMMED PAPER D1	A paper jam occurred in [S] D1 section.	Open the front cover, [S] D1 guide and remove the jammed paper. Close the guide and the cover, and the printing will be restarted.
REMOVE JAMMED PAPER D1 3	A paper jam occurred in [S] D1, [S] D3 section.	Open the front cover, [S] D1 guide, [S] D3 guide and remove the jammed paper. Close the guide and the cover, and the printing will be restarted.
REMOVE JAMMED PAPER D4 5	A paper jam occurred in [S] D4, [S] D5 section.	Open the front cover, [S] D1 guide, [S] D3 guide, [S] D4 guide and stack guide ③. Turn the [S] D5 dial clockwise and remove the jammed paper. Close the guide and the cover, and the printing will be restarted.
REMOVE JAMMED PAPER E1 2	A paper jam occurred in [S] E1 and [S] D2 [S] E2 section.	Open the top cover ①, [S] C guide, front cover, [S] E1 guide and turn the [S] D2 [S] E2 dial counterclockwise to remove the jammed paper. Close the guide and the cover, and the printing will be restarted. *1
REMOVE JAMMED PAPER *	A paper jam occurred in the stacking section.	Open the front cover, turn the [S] D5 dial clockwise to transport the jammed paper completely. Then open the front stack guide ③ to remove the jammed paper. Close the guide and the cover, and the printing will be restarted.

*1

**CAUTION**

When you open the top cover, remove sheets on the OUTPUT TRAY first, then open the top cover. Otherwise, the top cover may fall because of the weight of the sheets on OUTPUT TRAY, and your finger may be caught.

Clearing Paper Jams

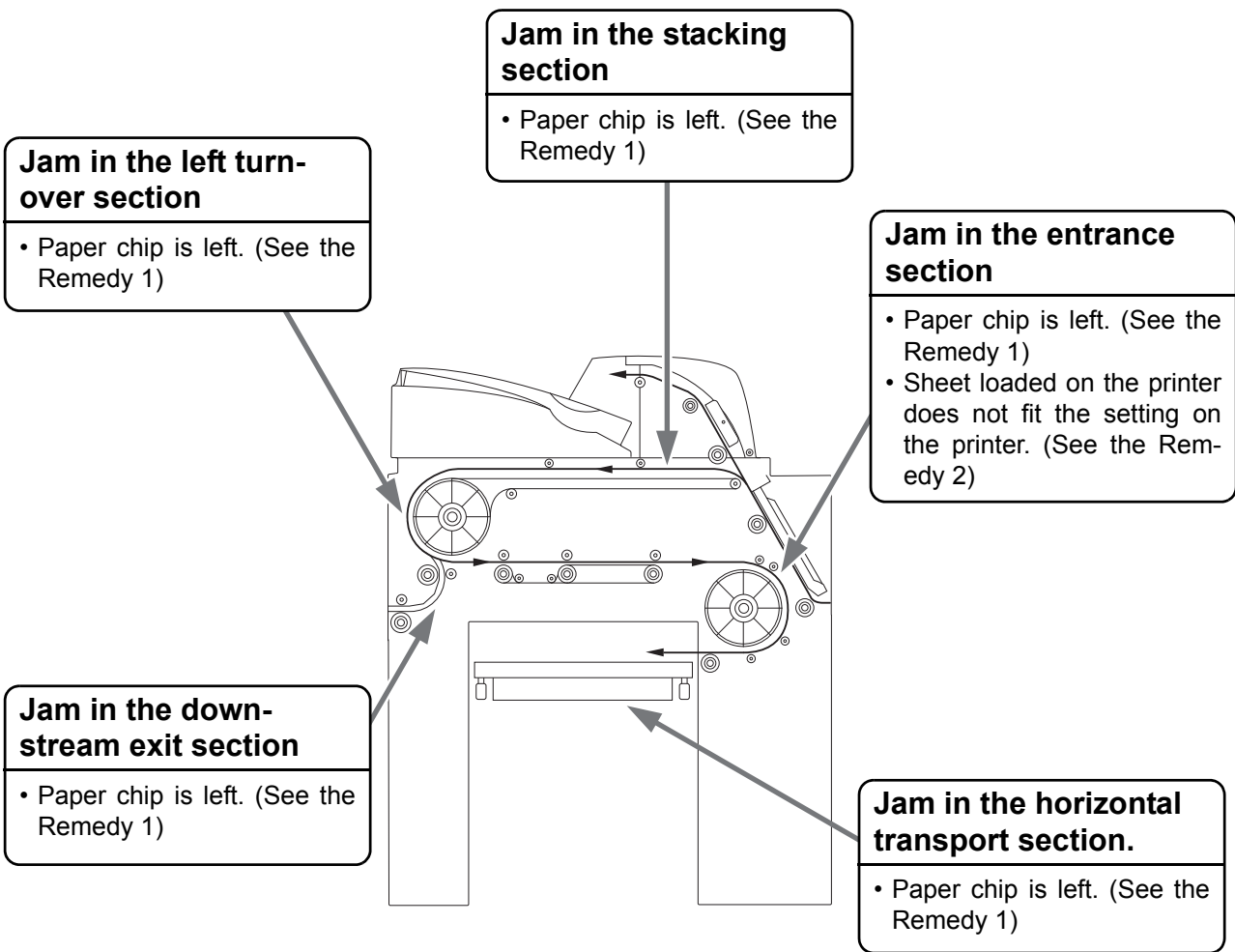

Remedy 1

Open the guides and check to see if any paper chips are left on the sheet transport path where paper jams frequently. (See page 4-3, 4-4)

Remedy 2

Load the correct sheet which fits the setting on the printer.

Correcting Paper Curl

If the stacked sheets are curled, correct the curl from the operation panel.



Important To correct the curl, perform the steps below in order.

1. Set up the curl correction to [AUTO].
2. If the sheets are still curled after step 1 is performed, change the curl correction amount on the printer.
3. If the sheets are still curled after step 2 is performed, set up the curl correction to [CONVEX], [CONCAVE], or [OFF].

3

Troubleshooting

1 Press the [Menu] on the Standby screen

[MENU CURL CORRECTION] will be displayed on LCD.

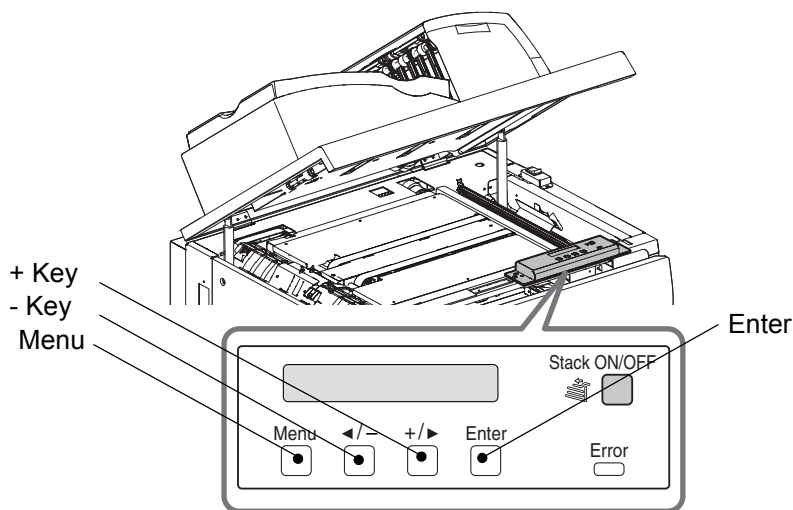

2 Press [Enter] on the operation panel.

3 Press the +/- key on the operation panel and setup the curl correction.

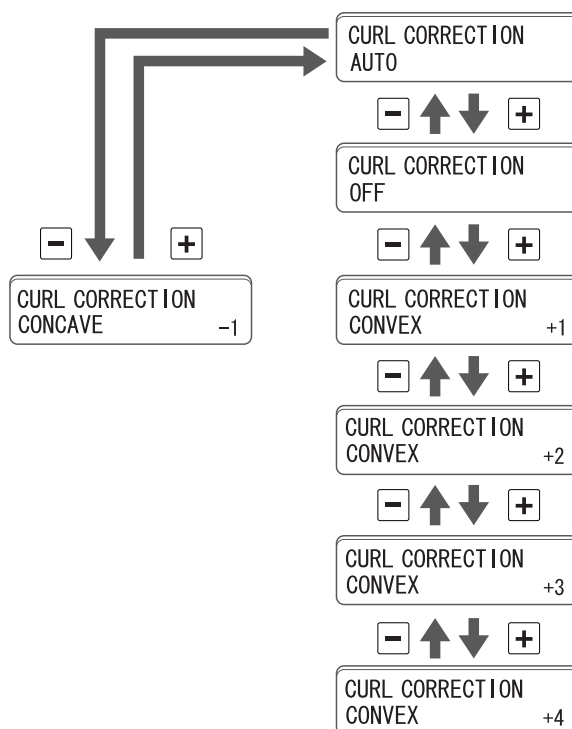

When + key is pressed, [AUTO] - [OFF] - [CONVEX +1] - [CONVEX +2] - [CONVEX +3] - [CONVEX +4] is displayed in order on LCD.

When - key is pressed, [AUTO] - [CONCAVE -1] is displayed on LCD.

If the stacked sheets are curled upward, select [CONCAVE].

If the stacked sheets are curled downward, select [CONVEX].

 **Note** Curl Correction and Sheet Condition



 **Important** - If the curl correction function is set incorrectly, paper jam or stacking error may occur.
- Curl correction function is available only for the sheets delivered to the stack tray.

4 Press [Enter] on the operation panel.

Powering Problem (Circuit Breaker Check)

If the machine does not operate although the power switch is turned on, check if the circuit breaker is turned off. If the circuit breaker is turned off, contact your local authorized dealer without turning on the circuit breaker.

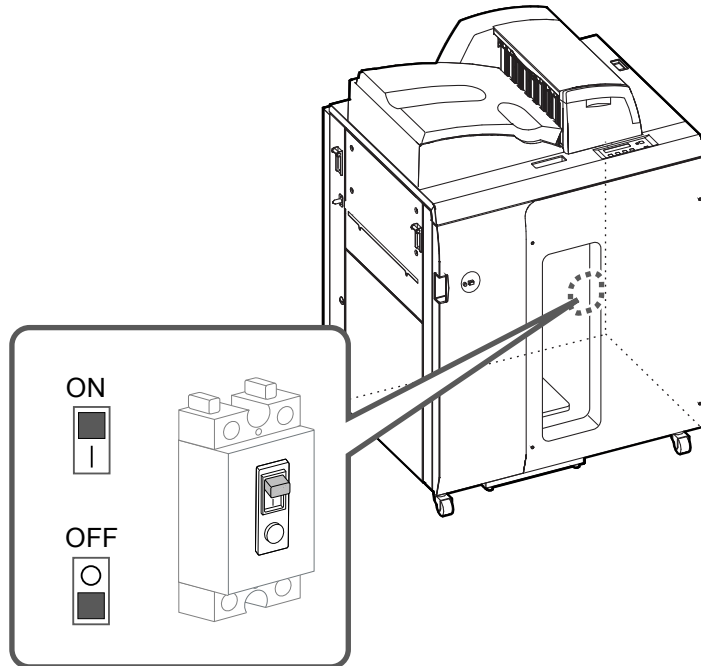

⚠ WARNING

If the circuit breaker is turned off, do not turn on it again. Otherwise, it may result in electrical shock, fire, fuming, or trip of the building circuit breaker.

Appendix

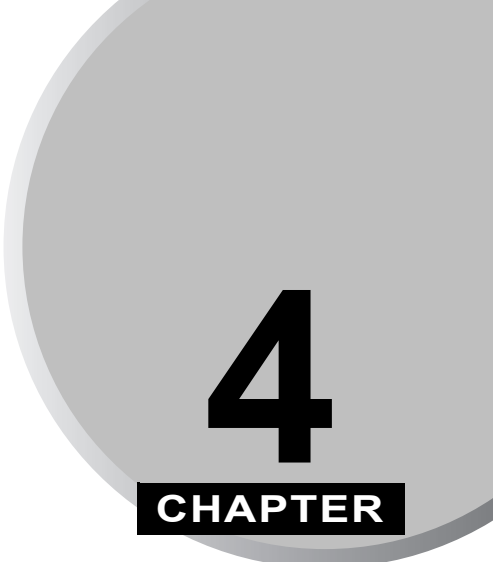

Specifications	4-2
Index	4-3

Specifications

Specifications

4

Appendix

Product Name		High Capacity Stacker-C1	
Sheet Size/Paper Weight Range		Stack Tray	A3, A4, B4, B5, 11" x 17", 12" x 18", 13" x 19", LGL, LTR, LTRR, EXEC, 8K (270 x 390 mm), 16K (270 x 195 mm), Tab Paper (A4, LTR) ^{*1} , 320 x 450 mm (SRA3), User custom size (Max: 330.2 x 487.7 mm, Min: 216 x 182 mm)
			64 to 325 gsm ^{*2}
		OUTPUT TRAY	A3, A4, A4R, A5R, B4, B5, B5R, 11" x 17", 12" x 18", 13" x 19", LGL, LTR, LTRR, EXEC, STMTR, Post card, 8K (270 x 390 mm), 16K (270 x 195 mm), Tab Paper (A4, LTR), User custom size (Max: 330.2 x 487.7 mm, Min: 139.7 x 182 mm)
			60 to 325 gsm ^{*2}
		Downstream Output	A3, A4, A4R, A5R, B4, B5, B5R, 11" x 17", 12" x 18", 13" x 19", LGL, LTR, LTRR, EXEC, STMTR, 8K (270 x 390 mm), 16K (270 x 195 mm), Tab Paper (A4, LTR), User custom size (Max: 330.2 x 487.7 mm, Min: 139.7 x 182 mm)
			60 to 325 gsm ^{*2}
Tray Capacity		Stack Tray	5000 sheets (All sizes / 80 gsm) ^{*3}
		OUTPUT TRAY	1000 sheets (All sizes / 80 gsm)
Machine Dimensions		860 (W) x 765 (D) x 1,240 (H) mm (33 7/8" x 30 1/8" x 48 7/8")	
Weight		Approximately 217 kg (478.5 lb)	
Installation Space with Host Machine		3,451 (W) x 1,152 (D) mm (135 7/8" x 45 3/8")	
Voltage / Power Consumption		120-127V AC, 50/60Hz, 7A / 300W max.	
Maximum Load Current		2.3 A	
Noise Level		70 dBA or less	
Environmental	Temperature in Use	20 to 27 °C (68 to 80.6 F)	
	Temperature in Storage	-30 to 50 °C (-22 to 122 F)	
	Temperature in Transportation	-30 to 50 °C (-22 to 122 F)	
	Relative Humidity	30 to 70% (RH)	
	Pressure	608 to 1013 hPa	

^{*1} When the tab paper is delivered to the stack tray, the paper cannot be squared-up neatly.

^{*2} Paper weight differs depending on the connected host machine.

^{*3} Depending on the content of the print or sheet type, the maximum stack capacity differs and stacked sheets may not be aligned.
Maximum stack capacity is limited to 2000 sheets when B5 or EXEC sheets are used.

Index

C

Circuit Breaker	1-3
Control Displays	1-12
Control Panel	1-10
Curl Correction	1-13, 3-6

D

Downstream Exit Section	1-3, 1-6
-------------------------------	----------

E

Entrance Section	1-4
Entrance Transport Guide	1-4
Error Lamp	1-10
Error Message Chart	3-3
Error messages	3-2

F

First Gate	1-4
Front Cover	1-3
Front Cover Open Button	1-3, 2-3, 2-4
Front Stack Guide	1-9

H

Handle	1-3, 2-5
Horizontal Transport Section	1-5

L

LCD Display	1-10
Left Dial	1-6
Left Lower Guide	1-6
Left Turn-Over Section	1-6
Left Upper Guide	1-6

O

Offset Section	1-7
Offset Section Guide	1-7
OUTPUT TRAY	1-10

P

Power Cable	1-3
Power Switch	1-3
Powering Problem	3-8

R

Rear Stack Guide	1-9
Right Dial	1-8
Right Lower Guide	1-8
Right Turn-Over Section	1-8
Right Upper Guide	1-8

S

Second Gate	1-6
Specifications	4-2
Stack ON/OFF Button	1-10, 2-3
Stack Status LED	1-3
Stack Stopper	1-9
Stack Tray	1-9, 2-3
Stacking Section	1-9
System Errors	3-2

T

Top Cover	1-10
-----------------	------

4

Appendix



CANON INC.

30-2, Shimomaruko 3-chome, Ohta-ku, Tokyo 146-8501, Japan

CANON U.S.A., INC.

One Canon Plaza, Lake Success, NY 11042, U.S.A.

CANON CANADA INC.

6390 Dixie Road Mississauga, Ontario L5T 1P7, Canada

CANON EUROPA N.V.

Bovenkerkerweg 59-61 1185 XB Amstelveen, The Netherlands
(See <http://www.canon-europe.com/> for details on your regional dealer)

CANON LATIN AMERICA, INC.

703 Waterford Way Suite 400 Miami, Florida 33126 U.S.A.

CANON AUSTRALIA PTY. LTD

1 Thomas Holt Drive, North Ryde, Sydney, N.S.W. 2113, Australia

CANON CHINA CO., LTD

15F Jinbao Building No.89 Jinbao Street, Dongcheng District, Beijing 100005, China

CANON SINGAPORE PTE. LTD.

1 HarbourFront Avenue #04-01 Keppel Bay Tower, Singapore 098632

CANON HONGKONG CO., LTD

19/F., The Metropolis Tower, 10 Metropolis Drive, Hunghom, Kowloon, Hong Kong

Free Manuals Download Website

<http://myh66.com>

<http://usermanuals.us>

<http://www.somanuals.com>

<http://www.4manuals.cc>

<http://www.manual-lib.com>

<http://www.404manual.com>

<http://www.luxmanual.com>

<http://aubethermostatmanual.com>

Golf course search by state

<http://golfingnear.com>

Email search by domain

<http://emailbydomain.com>

Auto manuals search

<http://auto.somanuals.com>

TV manuals search

<http://tv.somanuals.com>