

Canon

IXUS 175

IXUS 177

Getting Started

ENGLISH

Package Contents

Before use, make sure the following items are included in the package. If anything is missing, contact your camera retailer.



Camera



Battery Pack
NB-11L

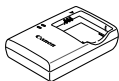

Battery Charger
CB-2LFE

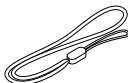

Wrist Strap*

* For attachment instructions, refer to the *Camera User Guide* that can be downloaded from the Canon website.

- Printed matter is also included.
- A memory card is not included.

Compatible Memory Cards

No memory card is included. Purchase one of the following kinds of card as needed. These memory cards can be used, regardless of capacity. For details on the number of shots and recording time per memory card, see “Specifications” in the downloadable *Camera User Guide*.

- SD memory cards*
- SDHC memory cards*
- SDXC memory cards*
- FlashAir cards
- Eye-Fi cards



* Cards conforming to SD standards. However, not all memory cards have been verified to work with the camera.

Eye-Fi/FlashAir Cards

This product is not guaranteed to fully support functions of Eye-Fi/FlashAir cards (including wireless transfer). In case of any card related issues, please check with the card manufacturer.

Also note that approval is required to use Eye-Fi/FlashAir cards in many countries or regions. Without approval, the use of Eye-Fi/FlashAir cards is not permitted. If it is unclear whether your card is approved for use in your area, please check with the card manufacturer.

Availability of Eye-Fi/FlashAir cards also varies by region.

Manuals and Software



You can download the manuals and software from the following URL.

<http://www.canon.com/icpd/>

- With a computer connected to the Internet, access the above URL.
- Access the site for your country or region.
- Adobe Reader is required to view the manuals.
- You can also download software from the above URL. For instructions on downloading and installing the software, refer to the *Camera User Guide* available for download.

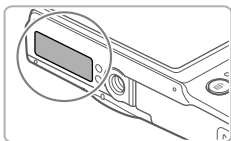

- You may be requested to enter the serial number (body number) when downloading the manuals or software. In this case, enter the number printed on the bottom of the camera.

Initial Preparations

Charging the Battery Pack

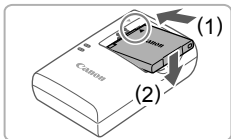

1 Insert the battery pack.

- After aligning the ▲ marks on the battery pack and charger, insert the battery pack by pushing it in (1) and down (2).

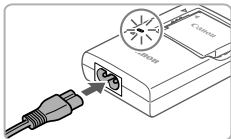

2 Charge the battery pack.

- Plug the power cord into the charger, then plug the other end into a power outlet.
- The charging lamp turns orange, and charging begins.
- When charging is finished, the lamp turns green. Remove the battery pack.
- For details on charging time and the number of shots or recording time available with a fully charged battery pack, refer to “Specifications” in the downloadable *Camera User Guide*.

Inserting the Battery Pack and Memory Card

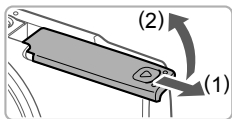

1 Open the cover.

- Slide the cover (1) and open it (2).

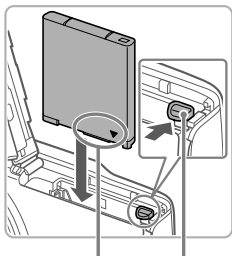

2 Insert the battery pack.

- While pressing the battery lock in the direction of the arrow, insert the battery pack as shown and push it in until it clicks into the locked position.
- To remove the battery pack, press the battery lock in the direction of the arrow.

Terminals Battery Lock

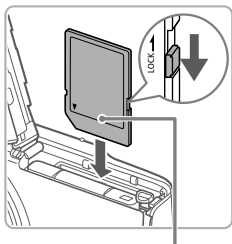

3 Check the card's write-protect tab and insert the memory card.

- Recording is not possible on memory cards with a write-protect tab when the tab is in the locked position. Slide the tab to the unlocked position.
- Insert the memory card facing as shown until it clicks into the locked position.
- To remove the memory card, push it in until you feel a click, and then slowly release it.

Label

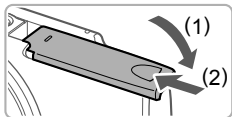

4 Close the cover.

- Lower the cover (1) and hold it down as you slide it, until it clicks into the closed position (2).
- If the cover will not close, make sure you inserted the battery pack facing the right way in step 2.

Setting the Date and Time

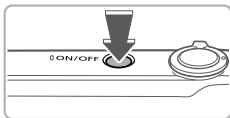

1 Turn the camera on.

- Press the ON/OFF button.
- The [Date/Time] screen is displayed.

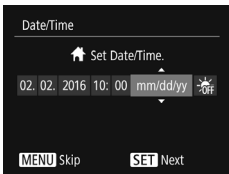

2 Set the date and time.

- Press the [◀][▶] buttons to choose an option.
- Press the [▲][▼] buttons to specify the date and time.
- When finished, press the [FUNC/SET] button.

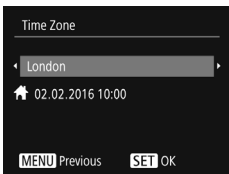

3 Set the home time zone.

- Press the [◀][▶] buttons to choose your home time zone.
- Press the [FUNC/SET] button when finished. After a confirmation message, the setting screen is no longer displayed.
- To turn off the camera, press the ON/OFF button.



■ Changing the Date and Time

To adjust the date and time once you have set it, do the following.

- 1 Press the [MENU] button.
- 2 Move the zoom lever to choose the [↑↓] tab.
- 3 Press the [▲][▼] buttons to choose [Date/Time], and then press the [FUNC SET] button.
- 4 Follow step 2 in “Setting the Date and Time” to adjust the settings.
- 5 Press the [MENU] button.

■ Display Language

Change the display language as needed.



1 Enter Playback mode.

- Press the [▶] button.



2 Access the setting screen.

- Press and hold the [FUNC SET] button, and then press the [MENU] button.
- Press the [▲][▼][◀][▶] buttons to choose a language, and then press the [FUNC SET] button.



Trying the Camera Out

Shooting

For fully automatic selection of the optimal settings for specific scenes, simply let the camera determine the subject and shooting conditions.

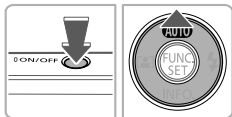

1 Turn the camera on and enter [AUTO] mode.

- Press the ON/OFF button.
- Press the [▲] button several times until [AUTO] is displayed.

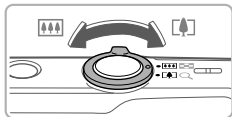

2 Compose the shot.

- To zoom in and enlarge the subject, move the zoom lever toward [▲] (telephoto) as you watch the screen, and to zoom away from the subject, move it toward [▼] (wide angle).

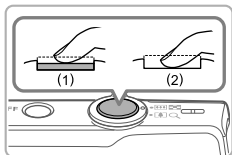

3 Shoot.

Shooting Still Images

- Press the shutter button lightly (1).
- The camera beeps twice after focusing, and AF frames are displayed to indicate image areas in focus. Press the shutter button all the way down (2).

Shooting Movies

- Press the movie button to start shooting, and press it again to stop.



Viewing



1 Enter Playback mode.

- Press the [▶] button.



2 Browse through your images.

- To view the previous or next image, press the [◀][▶] buttons.
- Movies are identified by a [SET▶] icon. To play movies, go to step 3.



3 Play movies.

- Press the [FUNC SET] button, press the [▲][▼] buttons to choose [▶], and then press the [▶] button again.
- Playback now begins, and after the movie is finished, [SET▶] is displayed.
- To adjust the volume, press the [▲][▼] buttons.

Erasing Images

To erase the image you chose in step 2, do the following. Note that erased images cannot be recovered.

1 Press the [Erase] button.

2 After [Erase?] is displayed, press the [◀][▶] buttons to choose [Erase], and then press the [FUNC SET] button.

Trademarks and Licensing

- Microsoft and Windows are trademarks or registered trademarks of Microsoft Corporation in the United States and/or other countries.
- Macintosh and Mac OS are trademarks of Apple Inc., registered in the U.S. and other countries.
- The SDXC logo is a trademark of SD-3C, LLC.
- All other trademarks are the property of their respective owners.
- This device incorporates exFAT technology licensed from Microsoft.
- This product is licensed under AT&T patents for the MPEG-4 standard and may be used for encoding MPEG-4 compliant video and/or decoding MPEG-4 compliant video that was encoded only (1) for a personal and non-commercial purpose or (2) by a video provider licensed under the AT&T patents to provide MPEG-4 compliant video. No license is granted or implied for any other use for MPEG-4 standard.

Disclaimer

- Unauthorized reproduction of this guide is prohibited.
- All measurements based on Canon testing standards.
- Information subject to change without notice, as are product specifications and appearance.
- Illustrations and screenshots in this guide may differ slightly from the actual equipment.
- The above items notwithstanding, Canon cannot be held liable for any loss arising from the use of this product.

Only for European Union and EEA (Norway, Iceland and Liechtenstein)



These symbols indicate that this product is not to be disposed of with your household waste, according to the WEEE Directive (2012/19/EU), the Battery Directive (2006/66/EC) and/or national legislation implementing those Directives.

If a chemical symbol is printed beneath the symbol shown above, in accordance with the Battery Directive, this indicates that a heavy metal (Hg = Mercury, Cd = Cadmium, Pb = Lead) is present in this battery or accumulator at a concentration above an applicable

threshold specified in the Battery Directive.

This product should be handed over to a designated collection point, e.g., on an authorized one-for-one basis when you buy a new similar product or to an authorized collection site for recycling waste electrical and electronic equipment (EEE) and batteries and accumulators. Improper handling of this type of waste could have a possible impact on the environment and human health due to potentially hazardous substances that are generally associated with EEE. Your cooperation in the correct disposal of this product will contribute to the effective usage of natural resources.

For more information about the recycling of this product, please contact your local city office, waste authority, approved scheme or your household waste disposal service or visit www.canon-europe.com/weee, or www.canon-europe.com/battery.

CAUTION

RISK OF EXPLOSION IF BATTERY IS REPLACED BY AN INCORRECT TYPE.

DISPOSE OF USED BATTERIES ACCORDING TO LOCAL REGULATION.

To ensure proper operation of this product, use of genuine Canon accessories is recommended.

- Interface Cable IFC-400PCU
- AV Cable AVC-DC400

Some logos for technical standards the camera has met can be viewed on the screen by choosing MENU > [Y/T] tab > [Certification Logo Display].

CANON EUROPA N.V. Bovenkerkerweg 59, 1185 XB Amstelveen, The Netherlands
CANON INC. 30-2, Shimomaruko 3-chome, Ohta-ku, Tokyo 146-8501, Japan

© CANON INC. 2016

Free Manuals Download Website

<http://myh66.com>

<http://usermanuals.us>

<http://www.somanuals.com>

<http://www.4manuals.cc>

<http://www.manual-lib.com>

<http://www.404manual.com>

<http://www.luxmanual.com>

<http://aubethermostatmanual.com>

Golf course search by state

<http://golfingnear.com>

Email search by domain

<http://emailbydomain.com>

Auto manuals search

<http://auto.somanuals.com>

TV manuals search

<http://tv.somanuals.com>