

Save This Manual
For Future Reference

Owner's Manual

MODEL NO.
678-29202
678-29203
678-29204
678-29460

Model Number 678-29460

The model number may be found on the nameplate. You should record the model number in a safe place for future use.

CAUTION: Before using this vacuum, read this manual and follow all its Safety Rules and Operating Instructions.

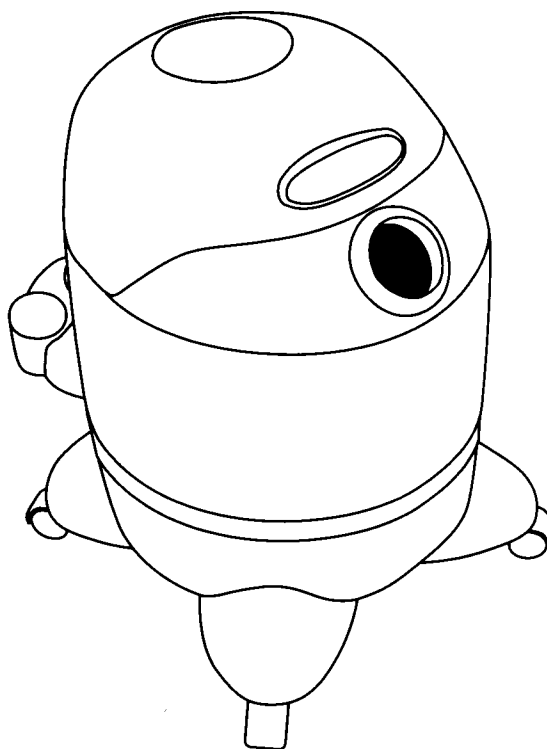

CRAFTSMAN[®]

WET/DRY VACUUM

- Safety
- Assembly
- Operating
- Repair parts

OWNER'S MANUAL CONTENTS

Item	Page
Warranty Information	2
Safety Instructions	2,3
Unpacking Carton Contents	3
Assembly	3
Operation	4
Storage	5
Troubleshooting	5
Repair Parts	See Insert

WARRANTY

LIMITED 2-YEAR WARRANTY ON CRAFTSMAN® WET/DRY VAC

If this Craftsman Wet/Dry Vac fails due to a defect in material or workmanship within 2 years of the date of purchase, Sears will repair it, free of charge.

WARRANTY SERVICE IS AVAILABLE BY CONTACTING THE NEAREST SEARS STORE OR SERVICE DEPARTMENT IN CANADA.

This warranty gives you specific legal rights, and you may also have other rights which vary from province to province.

Sears Canada Inc.
Toronto, Canada
M5B 2B8

SAFETY INSTRUCTIONS

When using an electrical appliance, basic precautions should always be followed, including the following:
Read all instructions before using this product.

 **WARNING:** To reduce the risk of fire, electric shock or injury.

- Do not leave appliance when plugged in. Unplug from outlet when not in use and before servicing. Connect to a properly grounded outlet only. See Grounding Instructions.
- Do not expose to rain – store indoors.
- Do not allow to be used as a toy. Close attention is necessary when used by or near children.
- Use only as described in this manual. Use only Craftsman attachments.
- Do not use with damaged cord or plug. If appliance is not working as it should, has been dropped, damaged, left outdoors or dropped into water, return it to a Sears Canada service centre.
- Do not pull or carry by cord, use cord as a handle, close a door on cord or pull cord around sharp edges or corners. Do not run appliance over cord. Keep cord away from heated surfaces.
- Do not unplug by pulling on cord. To unplug, grasp the plug, not the cord.
- Do not handle plug or appliance with wet hands.

- Do not put any object into openings. Do not use with any openings blocked; keep free of dust, lint, hair and anything that may reduce air flow.
- Keep hair, loose clothing, fingers and all parts of body away from openings and moving parts.
- Do not pick up anything that is burning or smoking, such as cigarettes, matches or hot ashes.
- Do not use without dust bag and/or filters in place.
- Turn off all controls before unplugging.
- Use extra care when cleaning on stairs.
- Do not use to pick up flammable or combustible liquids such as gasoline or use in areas where they may be present.
- Do not use your cleaner as a sprayer of flammable liquids such as oil base paints, lacquers, household cleaners, etc.
- Do not vacuum toxic, carcinogenic, combustible or other hazardous materials such as asbestos, arsenic, barium, beryllium, lead, pesticides or other health endangering materials. Specially designed units are available for these purposes.
- Do not pick up soot, cement, plaster or drywall dust without HEPA cartridge filter and High Efficiency collection filter bag in place. These are very fine particles that may pass through the foam and affect the performance of the motor or be exhausted back into the air. Additional collection filter bags are available from Sears.
- Do not leave the cord lying on the floor once you have finished the cleaning job. It can become a tripping hazard.
- Use special care when emptying heavily loaded tanks.
- To avoid spontaneous combustion, empty tank after each use.
- The operation of a utility vac can result in foreign objects being blown into eyes, which can result in eye damage. Always wear safety goggles when operating vacuum.
- **STAY ALERT.** Watch what you are doing and use common sense. Do not use vacuum cleaner when you are tired, distracted or under the influence of drugs, alcohol or medication causing diminished control.

GROUNDING INSTRUCTIONS

This vacuum cleaner is equipped with a cord having an equipment-grounding conductor and grounding plug. If vacuum cleaner should malfunction or breakdown, grounding provides a path of least resistance for electric current to reduce the risk of electric shock. The plug must be inserted into an appropriate outlet that is properly installed and grounded in accordance with all local codes and ordinances.

 **WARNING:** Improper connection of the equipment-grounding conductor and grounding plug can result in a risk of electric shock. Check with a qualified electrician or service person if you are in doubt as to whether the outlet is properly grounded. Do not modify the plug provided with the vacuum cleaner – if it will not fit the outlet, have a proper outlet installed by a qualified electrician.

This appliance is for use on a nominal 120-volt circuit, and has a grounded plug that looks like the plug illustrated.

NOTE: In Canada, the use of a temporary adapter is not permitted by the Canadian Electrical code.

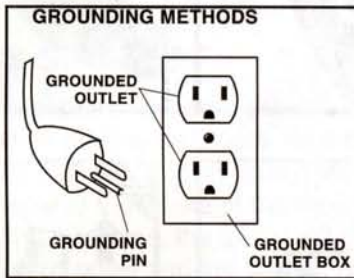

EXTENSION CORDS

When using the vacuum cleaner at a distance where an extension cord becomes necessary, a 3-conductor grounding cord of adequate size must be used for safety, and to prevent loss of power and overheating. Use the table below to determine A.W.G. wire size required. To determine ampere rating of your vacuum, refer to nameplate located on rear of motor cover.

Before using vacuum cleaner, inspect power cord for loose or exposed wires and damaged insulation. Make any needed repairs or replacements before using your vacuum cleaner. Use only three-wire outdoor extension cords which have three-prong grounding-type plugs and three-pole receptacles which accept the extension cord's plug. When vacuuming liquids, be sure the extension cord connection does not come in contact with the liquid.

Volts	Total length of cord in feet			
	25	50	100	150
120V				
Ampere Rating More Than	AWG			
Not More Than				
0.....6	18	16	16	14
6.....10	18	16	14	12
10.....12	16	16	14	12
12.....16	14	12	Not recommended	

NOTE: Static shocks are common in dry areas or when the relative humidity of the air is low. This is only temporary and does not affect the use of the appliance. To reduce the frequency of static shocks in your home, the best remedy is to add moisture to the air with a console or installed humidifier.

ASSEMBLY

1. Pull tank cover latches in an outward motion and remove tank cover and any accessories which may have been shipped in the tank. **(Figure 1)**

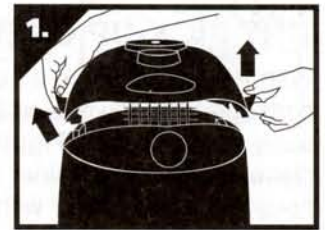

2. Before replacing tank cover, refer to Dry Pick-Up or Wet Pick-Up Operation in this manual to ensure you have the proper filters installed and inlet deflector is positioned correctly for your cleaning operation.

3. Your vacuum comes with the filters already installed for dry pick-up. For filters recommended for wet pick-up refer to wet pick-up operation.

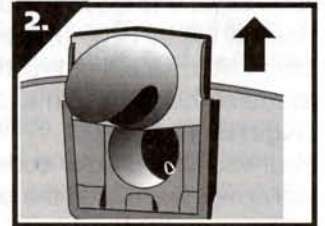

4. Be sure inlet deflector **(Figure 2)** is in proper position. Opening up for wet, down for dry vacuuming.

5. You will find four casters, four caster supports and four screws with your wet/dry vacuum. Model 29202 includes four casters only.

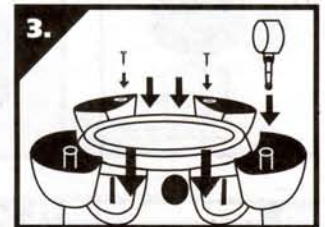

6. With tank cover removed, invert tank so that the bottom is facing up.

7. Insert caster supports into slots and secure with screws. **(Figure 3)**

8. Insert caster stems into supports by applying pressure until you feel the casters are firmly in place.

9. On model 29202, insert casters directly into holes provided in the bottom of the tank.

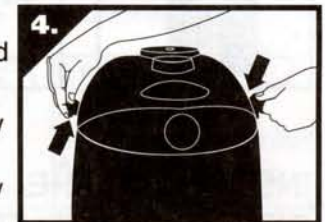

10. Replace tank cover and apply pressure with thumbs to each latch until it snaps tightly in place. Make sure both lid latches are clamped securely. **(Figure 4)**

11. Insert hose end with locking-nut into inlet of tank and tighten. Do not over-tighten.

12. Attach the extension wands to the accessory end of the hose.

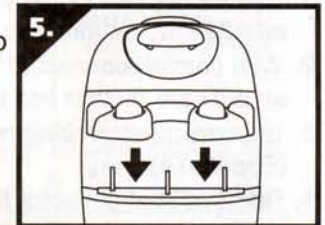

13. Attach one of the cleaning accessories (depending on your cleaning requirements) on the extension wands.

14. Tool holder attachment. Align tool holder with the lugs near bottom of tank. Slide tool holder down until it snaps into place **(Figure 5)** Your vacuum is now equipped for tool storage **(Figure 6)**. Please review illustrations for tool placement.

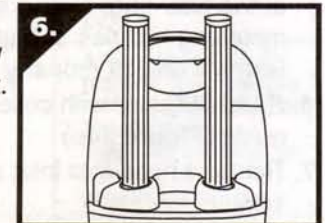

15. Plug the cord into the wall outlet. Your cleaner is ready for use. I = ON, O = OFF

OPERATION

DRY PICK-UP OPERATION

With the tank cover in an upside down position, slide the cartridge filter down over the lid cage, pushing until the filter seals against cover (**Figure 7**). Foam sleeve will remain in place. Place filter retainer into the top of the cartridge filter, holding the tank cover with one hand, turn the handle on the filter retainer clockwise to tighten, locking the filter into place (**Figures 8 & 9**). To remove the filter for cleaning, again hold the tank cover and turn the filter retainer counterclockwise to loosen and remove, then slide the cartridge filter off the lid cage (**Figures 10 & 11**). To clean the cartridge filter, shake or brush off excess dirt or rinse (from the inside of the filter) with water. Dry completely and re-install (**Figures 12 & 13**).

Your vac filter is color coded with a black stripe. When replacing, just match the color.

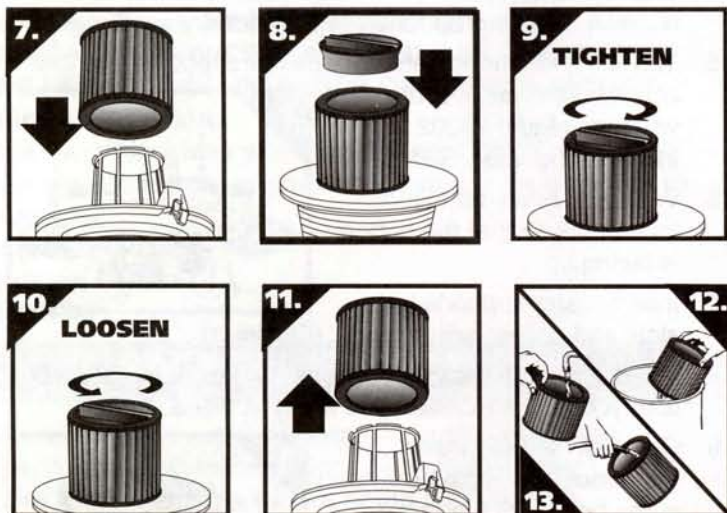

INSTALLING THE DISPOSABLE FILTER BAG

(Not standard with all models)

1. Use for dry pick-up only. Use only when cartridge filter is installed on wet/dry vacuum.
2. With cord disconnected from receptacle, pull latches in an outward motion and remove tank cover.
3. Unscrew hose locking-nut and remove hose from inlet. (**Figure 14**)
4. Remove inlet deflector from deflector guide. (**Figure 14a**) **NOTE:** Hose must be removed before inlet deflector can be taken out.
5. With the opening of the inlet deflector facing the bottom of the filter bag, slide collection bag collar over deflector, matching notches of bag collar to tabs on inlet deflector. Bag will only fit properly one way. (**Figure 14b**)
6. Slide deflector with collection bag attached into deflector guide (**Figure 14c**)
7. Reinsert hose into inlet and tighten locking-nut. (**Figure 14d**)

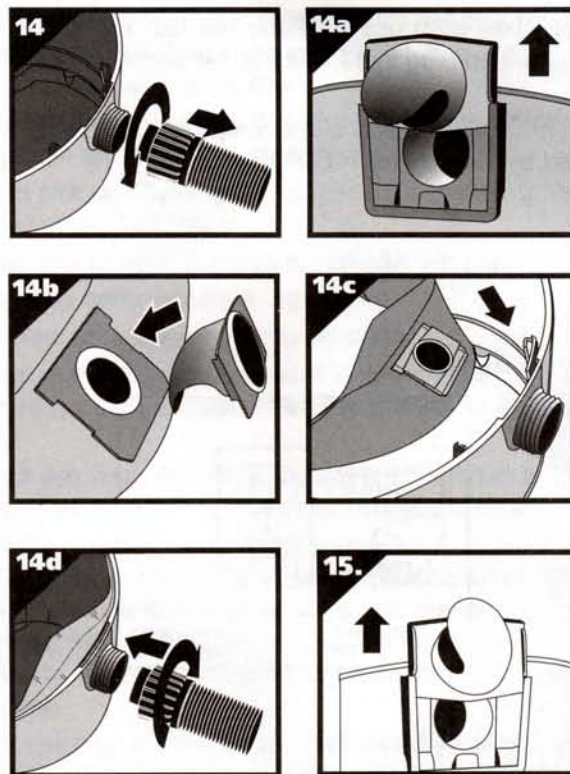

WET PICK-UP OPERATION

For best results for wet pick-up remove cartridge filter and utilize the foam sleeve (already in place over the lid cage). For wet pick-up remove inlet deflector from deflector guide sliding in an upward motion. **NOTE:** Hose must be removed before inlet deflector can be taken out. Be sure the opening of the inlet deflector is facing the top of the tank (**Figure 15**). Misting may occur if inlet deflector is not inserted properly. Misting in exhaust air may occur if the foam sleeve becomes saturated during wet pick-up. If misting occurs, remove and dry the saturated foam sleeve or replace with another dry foam sleeve to eliminate the misting and possible dripping of liquid around the lid. Turn the unit off immediately upon completing a wet pick-up job, or when tank is full and ready to be emptied. Raise the hose to drain any excess liquid into the tank. The vacuum suction will shut-off automatically when the tank is full. The interior of the tank should be periodically cleaned. The foam sleeve should be cleaned periodically as described in the following steps:

1. Always disconnect the plug from the wall receptacle before removing the tank cover. Remove foam sleeve by sliding it up and off the lid cage.
2. Shake excess dust off foam sleeve with a rapid up and down movement.
3. Hold sleeve under running water, rinsing from the inside. A water wash is not always required, depending on the condition of the sleeve.
4. Gently wring out excess water, and blot sleeve with a clean towel. The foam sleeve is now ready to be reinstalled on the lid cage. **NOTE:** Bottom of sleeve should be TUCKED in groove between lid cage and tank lid. (**Figure 16**)

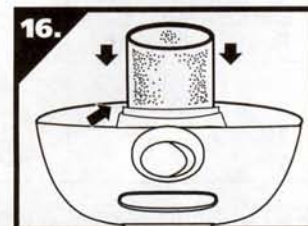

EMPTYING LIQUID WASTE FROM THE TANK

Your Craftsman Wet/Dry Vac can be emptied of liquid waste by removing the drain cap. To empty, turn unit off and remove plug from wall receptacle. Remove the drain cap and deposit the liquid waste contents into a suitable drain. After the tank is empty, return the drain cap to its original position. To continue use, plug the cord into the wall receptacle and turn unit on. Model No. 29202 does not have a drain cap. To empty, remove lid, and pour water out into a suitable drain.

AUTOMATIC SHUT-OFF

The vacuum is equipped with an automatic suction shut-off that operates when picking up liquids. As the level of the liquid rises in the tank, an internal float rises until it seats itself against a seal at the intake of the motor, shutting off suction. When this happens, the motor will develop a higher than normal pitch noise and the suction is drastically reduced. If this occurs, turn unit off immediately. Failure to turn unit off after float rises and shuts off suction will result in extensive damage to the motor. To continue use, empty the liquid waste from the tank as outlined in the previous paragraph.

NOTE: If accidentally tipped over, the vacuum could lose suction. If this occurs, place vac in upright position and turn switch off. This will allow the float to return to its normal position, and you will be able to continue operation.

BLOWER FEATURE

This vacuum can be used as a powerful blower. To use your unit as a blower unscrew blower port cover located on the backside of the motor housing (Figure 16). The blower port cover is equipped with a retaining strap to prevent loss of the port cover while blower is in use. Insert hose end with locking-nut into blower port of tank and tighten. Caution should be used when using as a blower due to the powerful force of air when using certain attachments.

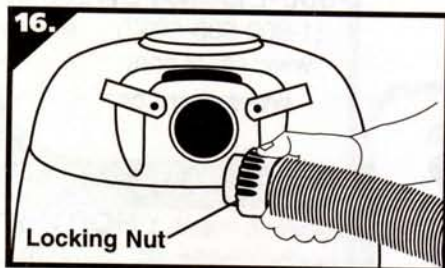

WARNING: Always wear eye protection to prevent rocks or debris from being blown or ricocheting into the eyes or face which can result in serious injury.

ATTACHING SQUEEGEE TO 14" FLOOR NOZZLE

Align squeegee with brush insert, push firmly at one end and continue to other end until brush side is completely engaged. Repeat process on front side of squeegee (Figure 17).



STORAGE

Before storing your vacuum cleaner the tank should be emptied and cleaned. The power cord can be wrapped around the cord wraps provided on the rear of the tank (Figure 18). A hose holder has been provided for easy storage of the hose. Install hose holder end with fastener onto hose. Slide or snap fastener into notch, securing it in place. Remove extension wands and/or accessory from end of hose and place hose end into open end of hose holder to secure hose in place for easy storage (Figure 19).

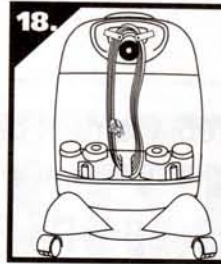

TROUBLESHOOTING GUIDE: FOR CRAFTSMAN 6, 8, 12 & 16 Gallon

SYMPTOM	POSSIBLE CAUSE (S)	CORRECTIVE ACTION
Parts/accessories are missing	1. Packed in the tank	1. Check in tank
Dust discharging from the exhaust	1. Filter not installed/ not installed properly 2. Filter is damaged 3. Filter is clogged or dust is too fine 4. Filter is not functional	1. Properly install the filter 2. Replace the filter 3. Use a more efficient filter 4. Clean or replace the filter
Loss of suction/ performance	1. Loose hose connection. 2. Lid/motor air leak 3. Drain air leak (not all models) 4. Filter clogged 5. Full tank 6. Hole in hose 7. Obstruction in hose or nozzle	1. Tighten hose connection 2. Check lid latches 3. Tighten drain cap 4. Clean or replace filter 5. Empty tank 6. Replace hose 7. Remove obstruction if present
Water misting out exhausted air	1. Saturated or missing foam sleeve	1. Check that foam sleeve is in place or replace with a clean dry filter
Water spraying out exhausted air	1. Inlet deflector shield is not installed properly	1. Check to make sure the inlet deflector is installed properly. Facing up for wet pick-up. Facing down for dry pick-up.
Static shock	1. Dry environment 2. Relative humidity of air is low	1. Add moisture to air (if practical, use a console or installed dehumidifier.) 2. This situation is temporary and does not effect the use of the vacuum cleaner.

Get it fixed, at your home or ours!

For repair of major brand appliances in **your own home...**
no matter who made it, no matter who sold it!

1-800-4-MY-HOME®
(1-800-469-4663)

Anytime, day or night
(U.S.A. and Canada)

www.sears.com

www.sears.ca

For repair of carry-in products like vacuums, lawn equipment,
and electronics, call for the location of your nearest
Sears Parts and Repair Center.

1-800-488-1222 Anytime, day or night (U.S.A. only)

www.sears.com

For the replacement parts, accessories and owner's manuals
that you need to do-it-yourself, call **Sears PartsDirectSM!**

1-800-366-PART 6 a.m. – 11 p.m. CST, 7 days a week
(1-800-366-7278) (U.S.A. only)

www.sears.com/partsdirect

To purchase or inquire about a Sears Service Agreement
or Sears Maintenance Agreement:

1-800-827-6655 (U.S.A.)
7 a.m. – 5 p.m. CST, Mon. – Sat.

1-800-361-6665 (Canada)
9 a.m. – 8 p.m. EST, M – F, 4 p.m. Sat.

Para pedir servicio de reparación a
domicilio, y para ordenar piezas:

1-888-SU-HOGARSM
(1-888-784-6427)

Au Canada pour service en français:

1-800-LE-FOYER^{MC}
(1-800-533-6937)
www.sears.com
www.sears.ca

SEARS
HomeCentral®

® Registered Trademark / ™ Trademark / SM Service Mark of Sears, Roebuck and Co.

® Marca Registrada / ™ Marca de Fábrica / SM Marca de Servicio de Sears, Roebuck and Co.

^{MC} Marque de commerce / ^{MD} Marque déposée de Sears, Roebuck and Co.

© Sears, Roebuck and Co.

Free Manuals Download Website

<http://myh66.com>

<http://usermanuals.us>

<http://www.somanuals.com>

<http://www.4manuals.cc>

<http://www.manual-lib.com>

<http://www.404manual.com>

<http://www.luxmanual.com>

<http://aubethermostatmanual.com>

Golf course search by state

<http://golfingnear.com>

Email search by domain

<http://emailbydomain.com>

Auto manuals search

<http://auto.somanuals.com>

TV manuals search

<http://tv.somanuals.com>