

**DEFIANT®**

Item #xxxxxxxxxxxx  
xxxxxxxxxxxx  
Model : HD-1895-BZ  
HD-1895-WH

# USE AND CARE GUIDE

---

## Battery-Operated Motion Sensor Light

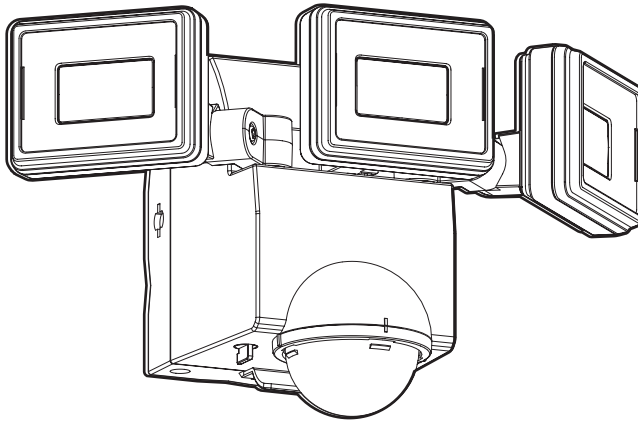

Questions, problems, missing parts? Before returning to the store,  
call Defiant Customer Service  
8 a.m. - 7 p.m., EST, Monday - Friday, 9 a.m. - 6 p.m., EST, Saturday

1-866-308-3976

HOMEDEPOT.COM

---

### THANK YOU

*We appreciate the trust and confidence you have placed in Defiant through the purchase of this motion security light. We strive to continually create quality products designed to enhance your home. Visit us online to see our full line of products available for your home improvement needs. Thank you for choosing Defiant!*

# Table of Contents

Table of Contents .....	2	Tools That May Be Required.....	3
Safety Information .....	2	Hardware Included.....	4
Precautions .....		Package Contents .....	4
Warranty .....	3	Installation .....	5
3-Year Warranty .....	3	Operation .....	7
Specifications .....	3	Care and Cleaning .....	9
Pre-Installation .....	3	Troubleshooting .....	10
Planning Installation .....	3		

# Safety Information

## PRECAUTIONS

Please read and understand this entire manual before attempting to assemble, install, or operate this light fixture.

For proper operation, this light fixture should be:

- This product can be used indoors, for example in a garage or shed, or outdoors. It can be wall or ceiling/eave mounted.
- Installed 6 ft. - 8 ft. above the ground (if the light fixture is mounted higher than recommended, aiming the sensor down will reduce the coverage area).
- Do not immerse components in liquid.

**NOTICE:** When replacing batteries, recycle used batteries or dispose of them in accordance with local regulations.



**WARNING:** To prevent possible **SERIOUS INJURY** or **DEATH** never allow small children near batteries. If battery is swallowed, immediately notify a doctor.



**WARNING:** "THIS PRODUCT MUST BE INSTALLED IN ACCORDANCE WITH THE APPLICABLE INSTALLATION CODE BY A PERSON FAMILIAR WITH THE CONSTRUCTION AND OPERATION OF THE PRODUCT AND THE HAZARDS INVOLVED"



**WARNING:** This device complies with Part 15 of the FCC Rules. Operation is subject to the following two conditions: (1) this device may not cause harmful interference, and (2) this device must accept any interference received, including interference that may cause undersired operation.



**WARNING:** **DO NOT** mix old and new batteries. **DO NOT** mix battery types - such as alkaline, heavy duty, and rechargeable - in a single device. Battery leakage may occur.



**WARNING:** **DO NOT DISPOSE OF BATTERIES IN FIRE.** BATTERIES MAY EXPLODE OR LEAK.



**CAUTION:** Please note that changes or modifications not expressly approved by the party responsible for compliance could void the user's authority to operate the equipment.



**WARNING:** This equipment has been tested and found to comply with limits for a Class B digital device, pursuant to Part 15 of the FCC Rules. These limits are designed to provide reasonable protection against harmful interference in a residential installation. This equipment generates, uses and can radiate radio frequency energy and, if not installed and used in accordance with the instructions, may cause harmful interference to radio communications.

However, there is no guarantee that interference will not occur in a particular installation. If this equipment does cause harmful interference to radio or television reception, which can be determined by turning the equipment off and on, the user is encouraged to try to correct the interference by one or more of the following measures:

- Reorient or relocate the receiving antenna.
- Increase the separation between the equipment and the receiver.
- Connect the equipment into an outlet on a circuit different from that to which the receiver is connected.
- Consult the dealer or an experienced radio/TV technician for help.

# Warranty

## 3-YEAR WARRANTY

Contact the Customer Service Team at 1-866-308-3976 or visit [www.homedepot.com](http://www.homedepot.com).

# Specifications

Detection Range	Up to 33 ft.
Sensing angle	Up to 180°
LED Lumens	1050 lm
Operating temperature	-13°F to +113°F
Power requirements	4 Alkaline "D" cell batteries - 1.5V (not included)

# Pre-Installation

## PLANNING INSTALLATION

Before installing the light fixture, ensure that all parts are present (see Hardware Included on page 4). If any part is missing or damaged, do not attempt to assemble, install, or operate this light fixture.

Estimated installation time: 15 - 20 minutes

## TOOLS THAT MAY BE REQUIRED

Depending on your particular installation, you may need these tools.



Phillips  
screwdriver



Flathead  
screwdriver

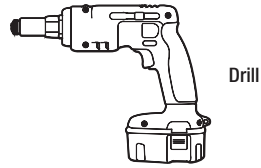

Drill



Drill bits



Ladder



Safety goggles



Level

# Pre-Installation (continued)

## HARDWARE INCLUDED



**NOTE:** Hardware shown is not to scale



\_\_\_\_\_ AA



\_\_\_\_\_ BB



\_\_\_\_\_ CC

Part	Description	Quantity
AA	Screws	2
BB	Screw pegs	2
CC	Diffuser panels	3

## PACKAGE CONTENTS

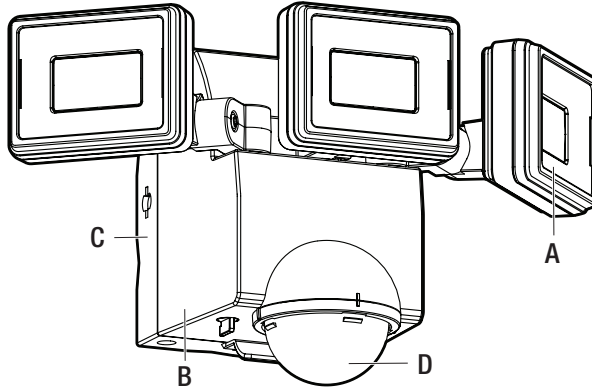

Part	Description	Quantity
A	Lamp head	3
B	Main body	1
C	Mounting plate	1
D	Motion sensor	1

# Installation

## 1 Determining the Mounting Location

- Determine the mounting location - wall or eave mount.

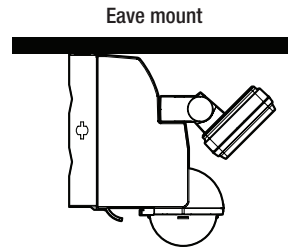
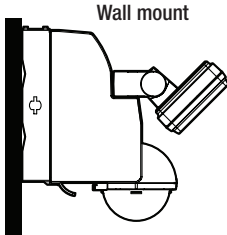

## 2 Removing the Mounting Plate



**NOTE:** This fixture comes with a mounting plate (C). It is pre-assembled on the light fixture (B) for shipping.

- Gently pull the bottom tab (1) of the wall mounting plate (C) away from the light body (B).

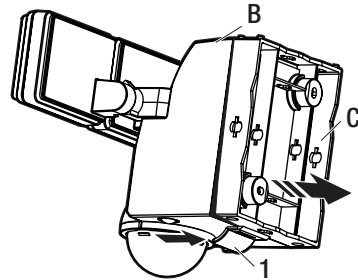

## 3 Installing the Batteries



**NOTE:** Ensure the ribbon inside the battery compartment is located behind the batteries and the loose end of the ribbon is accessible to help remove the batteries when needed.

- Install 4 x Alkaline "D" 1.5V batteries (3) (not included) into the battery compartment. Make sure the polarity (+ & -) of the batteries is correct as shown in the battery compartment.

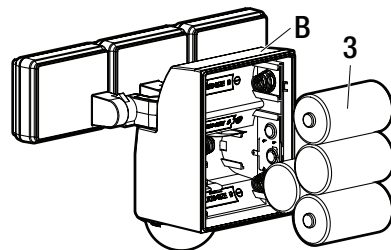

## Installation (continued)

### 4 Installing the Mounting Plate

#### A. Wall Mount

- Remove the two rubber gaskets (2) from mounting plate (C).
- Place the mounting plate (C) against the wall with the word "UP" facing you (see illustration). Ensure the mounting plate (C) is level. Mark the hole locations.

- If mounting to a wooden surface like a deck, you can install the mounting screws (AA) through the mounting plate (C) and into the wood with a screwdriver, or with a drill and bit driver.

You can also drill two pilot holes into the wood mounting surface with a 1/8 inch drill bit and then install the screws. Reinstall the rubber gaskets (2) over the screws to keep the unit weatherproof.

- If mounting to wall board or brick, drill two pilot holes into the mounting surface, using a 7/32 inch drill bit.

Insert the wall pegs (BB) and attach the mounting plate (C) using the two mounting screws (AA) and install the rubber gaskets (2) over the screws to keep the unit weatherproof.

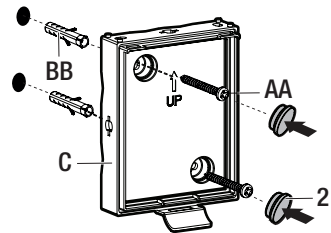
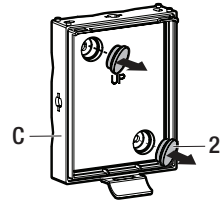

### 5 Mounting the Light Fixture

- Attach the light fixture (B) to the mounting plate (C).

- Press the unit on the bottom to the mounting plate. You should hear a "Click" sound. This indicates that the device is securely attached to the mounting plate.

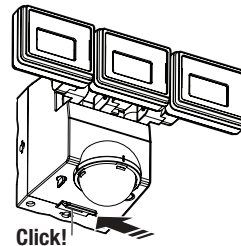
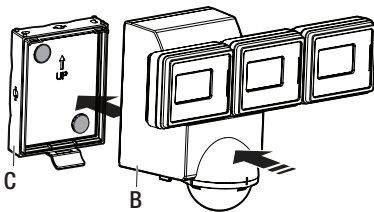

## Installation (continued)

### 6 Installing the Mounting Plate B. Eave or Ceiling Mount

- Place the mounting plate (C) against the ceiling. Mark the hole locations.
  - If mounting to a wooden surface like a deck, you can install the mounting screws (AA) through the mounting plate (C) and into the wood with a screwdriver, or with a drill and bit driver.
- You can also drill two pilot holes into the wood mounting surface with a 1/8 inch drill bit and then install the screws.
- If mounting to wall board or brick, drill two pilot holes into the mounting surface, using a 7/32 inch drill bit.

Insert the wall pegs (BB) and attach the mounting plate (C) using the two mounting screws (AA) with a very long Phillips screwdriver.

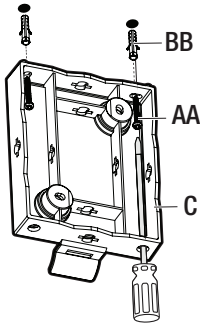

### 7 Mounting the Light Fixture

- Attach the light fixture (B) to the mounting plate (C). Support the back-plate from behind with one hand and push the light onto the back-plate with the other hand.

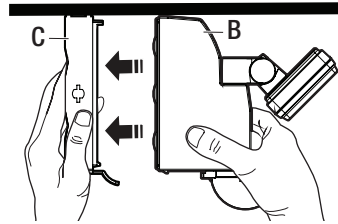

- Press the unit on the bottom to the mounting plate (C). You should hear a "Click" sound. This indicates that the device (B) is securely attached to the mounting plate.

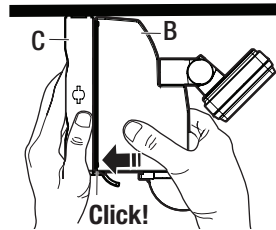

## Operation

### 1 Adjusting the Lamp Heads

- If needed, gently grasp the lamp head (A), it can be tilted down by 60° and upward by 30°. It also can be panned out 90° and panned in 40°.
- Hinge (4) can pan the lights in and out. Hinge (5) can tilt the lamps up and down.

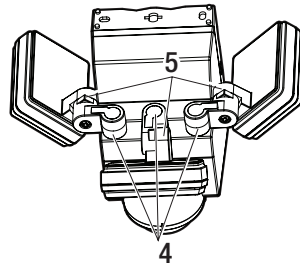
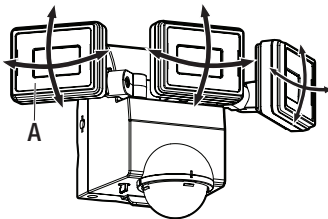

### 2 Adjusting the Sensor Head

- The motion sensor gets a full 180° of coverage, so it senses from wall to wall. However, if the sensor is mounted on a corner and you would like additional coverage on one side or the other, the sensor (D) can be rotated left and right.

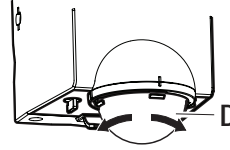

### 3 Adjusting the Control Settings

Adjusting The Selector Switch



**OFF** - Select OFF to completely switch off the device.

**15 S** - This is the normal AUTOMATIC motion sensing mode. The lights will stay as long as unit detects motion. After the unit no longer senses motion, it will turn off after 15 seconds. Any re-triggers will extend the time for another 15 seconds.

**XTEN** - The lights will stay on at 100% brightness for 12 seconds and then drop to about 20% for another 48 seconds, if it no longer detects motion. If motion is detected again, the lights will go back up to 100% for 12 seconds and then drop to about 20% for 48 more seconds. Any re-trigger will extend the on time for the same period.

**ECO** - This is energy saving mode. The lights will come on at 70% brightness and stay on as long as motion is detected. After the unit no longer senses motion, it will turn off after 15 seconds. Any re-triggers will extend the time for another 15 seconds. This setting will extend your battery life by up to 30%.

Adjusting The DUSK LEARN

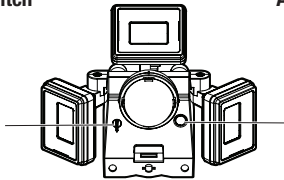

#### DUSK LEARN

Your motion sensor light is factory preset to only work after dusk. For most people, this will be the best setting and you will not need to make any adjustment.

However, if desired, you can set your own “dusk” level; which will determine how dark it needs to be before the motion sensor works.

- Press the DUSK LEARN button once to recalibrate the dusk level to the **current** light level. The motion sensor will now activate at this light level from now on. If you want the lights to work day and night, regardless of the light level, push the DUSK LEARN button while the unit is outdoors during the day, or hold the unit up to a light and push the dusk learn button. Now, the motion sensor will turn on the lights day or night, regardless of the surrounding light level. The lights will blink once to let you know it has reset the dusk level.

- To return the default factory setting, press the DUSK LEARN button twice within 2 seconds, the lights will blink twice to indicate that you have returned to default factory setting.



## Operation (continued)

### 4 Using the Diffuser Panels

If you want to reduce the glare of the lights, attach the diffuser panels to the lamp heads as shown below.

This also prevents the LEDs from being seen during daylight hours. Some people may prefer the appearance of the light fixture with the diffuser panels in place.

You can remove the diffuser panels by using a small flathead screwdriver. Insert screwdriver into tab and gently twist to pop the diffuser panels out of the lamp heads.

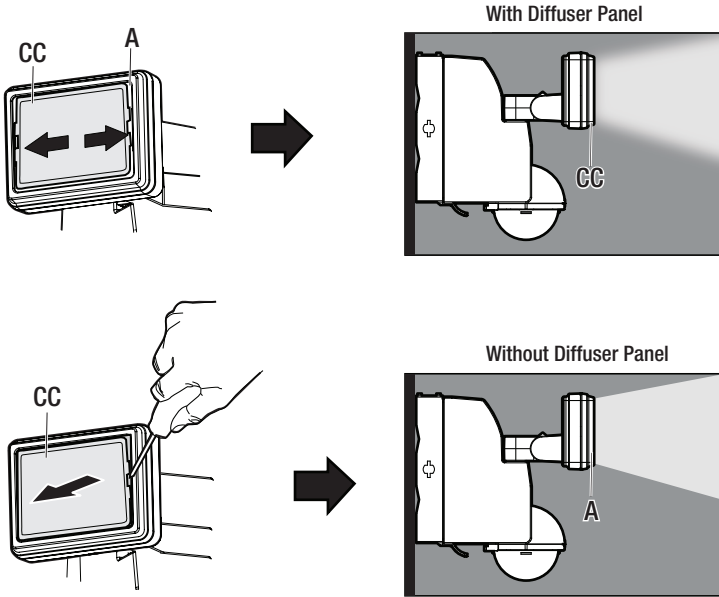

## Care and Cleaning

- To prolong the original appearance, clean with clear water and soft, damp cloth only.
- Do not use paints, solvents, or other chemicals on this light fixture. They could cause a premature deterioration of the finish. This is not a defect in the finish and will not be covered by the warranty.
- Do not spray with a hose or power washer.

## Troubleshooting

Problem	Possible Cause	Solution
The light will not come on.	<ul style="list-style-type: none"> <li><input type="checkbox"/> Daylight turn-off (photocell) is in effect.</li> <li><input type="checkbox"/> The motion sensor is out of coverage area.</li> <li><input type="checkbox"/> Batteries are dead.</li> <li><input type="checkbox"/> Batteries may be incorrectly installed</li> </ul>	<ul style="list-style-type: none"> <li><input type="checkbox"/> Set the DUSK LEARN at desired lux level.</li> <li><input type="checkbox"/> Reposition the unit within your desired detecting range.</li> <li><input type="checkbox"/> Recheck with new batteries.</li> <li><input type="checkbox"/> Recheck and make sure batteries are installed with the correct polarity (+ &amp; -), as shown in the battery compartment.</li> </ul>
The light comes on during the day.	<ul style="list-style-type: none"> <li><input type="checkbox"/> The motion sensor may be installed in a relatively dark location.</li> <li><input type="checkbox"/> DUSK LEARN was set in daylight conditions.</li> </ul>	<ul style="list-style-type: none"> <li><input type="checkbox"/> The light fixture is operating normally under these circumstances.</li> <li><input type="checkbox"/> Reset the DUSK LEARN setting by pushing once at the desired level of darkness, or return to the factory setting by pushing the DUSK LEARN button twice within 2 seconds.</li> </ul>
The light comes on for no apparent reason.	<ul style="list-style-type: none"> <li><input type="checkbox"/> The motion sensor may be sensing small animals or automobile traffic, or other heat sources.</li> <li><input type="checkbox"/> Strong wind may activate the sensor.</li> </ul>	<ul style="list-style-type: none"> <li><input type="checkbox"/> Re-aim the motion sensor.</li> <li><input type="checkbox"/> The light fixture is operating normally under these circumstances.</li> </ul>
The lights stay on continuously.	<ul style="list-style-type: none"> <li><input type="checkbox"/> Another regular light is positioned too close to the motion sensor or pointed at nearby objects that cause heat to trigger the motion sensor.</li> <li><input type="checkbox"/> The motion sensor may be picking up a heat source like an air vent, dryer vent, or brightly painted, heat-reflective surface.</li> </ul>	<ul style="list-style-type: none"> <li><input type="checkbox"/> Reposition the motion sensor away from the light or nearby objects.</li> <li><input type="checkbox"/> Same as above.</li> </ul>

# DEFIANT®

Questions, problems, missing parts? Before returning to the store,  
call Defiant Customer Service  
8 a.m. - 7 p.m., EST, Monday-Friday, 9 a.m. - 6 p.m., EST, Saturday

**1-866-308-3976**

**HOMEDEPOT.COM**

Retain this manual for future use.

## Free Manuals Download Website

<http://myh66.com>

<http://usermanuals.us>

<http://www.somanuals.com>

<http://www.4manuals.cc>

<http://www.manual-lib.com>

<http://www.404manual.com>

<http://www.luxmanual.com>

<http://aubethermostatmanual.com>

Golf course search by state

<http://golfingnear.com>

Email search by domain

<http://emailbydomain.com>

Auto manuals search

<http://auto.somanuals.com>

TV manuals search

<http://tv.somanuals.com>