



STEREO SPEAKER

EBT2001



User Guide

In the box



Location of controls

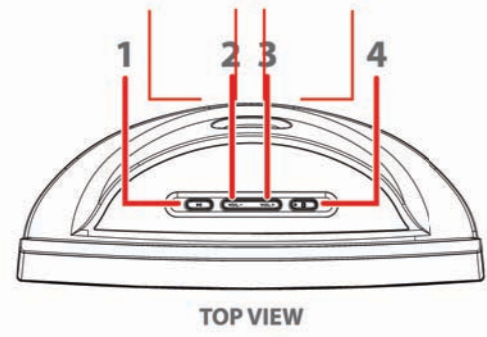

TOP VIEW

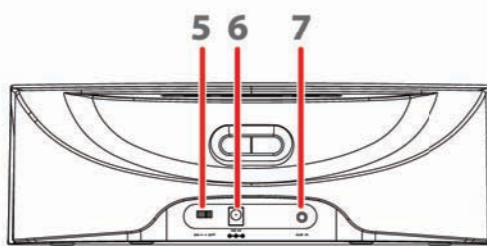

BACK VIEW

- [▶||] button
Quickpress = Pause
Quickpress again = Play
- [VOL-] button
Quickpress = previous song
Press & Hold = volume down
- [VOL+] button
Quickpress = next song
Press & Hold = volume up
- [BLUETOOTH CONNECT] button / LED indicator light.
Answer/end a call
- [POWER ON/OFF] switch
- DC IN jack
- 3.5 mm Auxiliary Cord jack

Powering ON / OFF

To turn ON:

- Connect the pin of the included AC adaptor to the **DC IN** jack on the back of the **Bluetooth Speaker**.
- Plug the AC adaptor into a wall outlet.
- Move the **[POWER ON/OFF]** switch to the ON position, the blue LED indicator light will remain lit indicating the speaker is turned on.

To turn OFF:

- Move the **[POWER ON/OFF]** switch to the OFF position, the blue LED indicator light will turn off indicating the speaker is turned off.

NOTE: When not using the speaker for extended periods of time it is recommended to unplug the AC adaptor from the wall outlet.

Pairing the speaker with a bluetooth enabled device

- Make sure the **Bluetooth Speaker** is plugged in and turned ON.
- Keep your **Bluetooth Speaker** and bluetooth enabled device within 3 feet of each other during the pairing process.

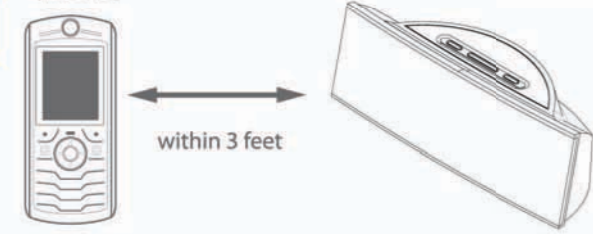

3. Press and HOLD the **[BLUETOOTH CONNECT]** button until you hear a beep and the blue LED indicator light starts flashing quickly. The **Bluetooth Speaker** is now in pairing mode.

4. Set your mobile phone or other Bluetooth enabled device to search for Bluetooth devices.

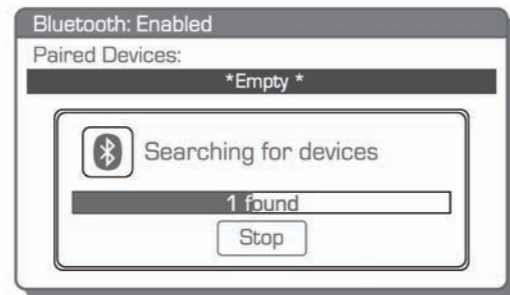

5. When the device finds the **Bluetooth Speaker**, confirm by selecting EBT2001 from the list.

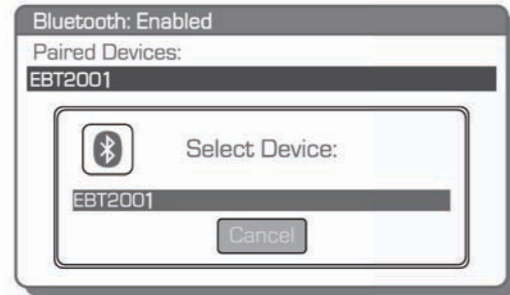

6. Select "Pair" to connect the **Bluetooth Speaker** to your bluetooth enabled device.

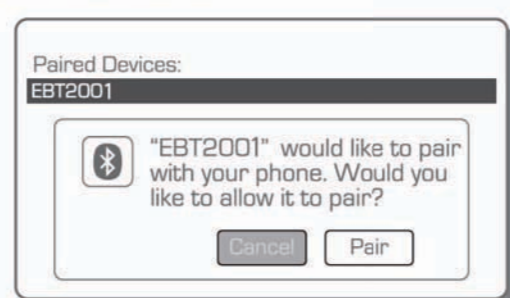

NOTE: Depending on which model device you are trying to connect the speaker to, it may not be necessary to enter a passcode and the following message (or similar) may appear on your device's display.

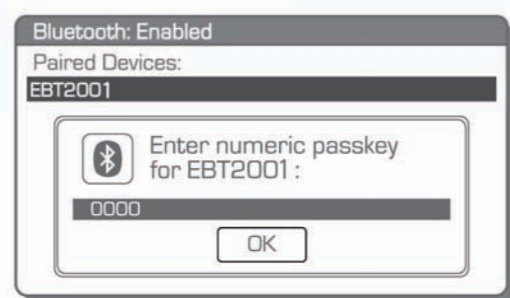

Enter passcode "0000" if prompted by the device.

7. Your Bluetooth enabled device will confirm that the pairing was completed, and prompt you to accept the connection. Please respond **YES** to connect the **Bluetooth Speaker** to your Bluetooth enabled device. If the pairing was successful, the **Bluetooth Speaker's** indicator light will begin flashing blue every two seconds.

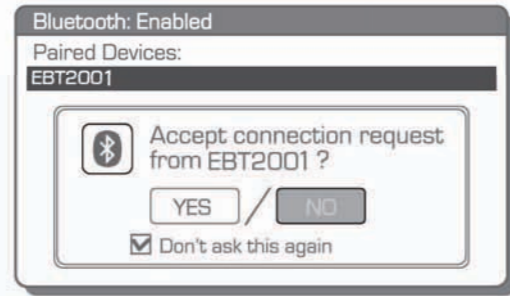

9. When attempting to reconnect the **Bluetooth Speaker** to your Bluetooth enabled device, you may see the message below, and your phone will prompt you to accept the connection request to the EBT2001 speaker, and an option not to ask this again. Please accept the connection, and if you select "Don't ask this again", your phone will automatically accept future connection requests from your **Bluetooth Speaker**.

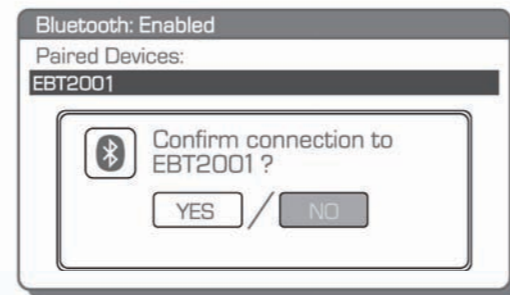

NOTE: The screenshots above are typical of many Bluetooth enabled device in the market today, and are used to assist in the explanation of the pairing process. Your Bluetooth enabled device's interface and interaction with the **Bluetooth Speaker** may slightly differ from the illustrations above.

Pairing with multiple devices

The **Bluetooth Speaker** can be paired with up to 8 devices. Once the number of paired devices exceeds 8, the first one will be replaced.

NOTE: It is only possible to use one paired device at a time.

Stereo Bluetooth

This **Bluetooth Speaker** allows you to listen (in full stereo) and control* the music on your Bluetooth enabled mobile phone, computer or mp3 player and supports the following Bluetooth profiles:

- **A2DP - Advanced Audio Distribution Profile**
- **AVRCP - Audio/Video Remote Control Profile**

To use the **Bluetooth Speaker** to listen to and/or control music, your Bluetooth enabled device must support the A2DP and AVRCP profiles. Please refer to the user guide of your Bluetooth enabled device for more information.

***The Emerson Bluetooth Speaker is compatible with any brand of Bluetooth-enabled phone or music device that supports Advanced Audio Distribution Profile (A2DP) and Audio Video Remote Control Profile (AVRCP).**

In order for Bluetooth devices to communicate with one another properly, they must utilize the same Bluetooth profile. To determine the profiles supported by your device (mobile phone, gaming console, computer or mp3 player), please refer to the device's user guide.

Certain Bluetooth features including those listed may not be supported by all compatible Bluetooth-enabled devices, and/or the functionality of such features may be limited in certain devices.

Playing music

To enjoy wireless music on your **Bluetooth Speaker**, press the **[PLAY]** button of your Bluetooth enabled device to begin music playback. Once playback has begun, you can control the music from the control buttons of the Bluetooth Speaker (Not all Bluetooth enabled devices support the control of music using Bluetooth).

NOTE: Some phones, Bluetooth enabled media players, and/or applications require that your first press the **[PLAY/PAUSE]** button on your device before you can control the music with the **Bluetooth Speaker**.

Play/Pause*

Press the **[▶||]** button to pause the music. To resume music playback, press the **[▶||]** button again.

Adjusting the volume

Press and HOLD the **[VOL+]** or **[VOL-]** button to adjust the volume to the desired level.

NOTE: You may also adjust the volume from your Bluetooth enabled device's volume control.

Skipping or searching songs* (Dependent on your phone supporting this feature)

Quickpress the **[VOL-]** button to go to the previous song.

Quickpress the **[VOL+]** button to go to the next song.

Music Controls

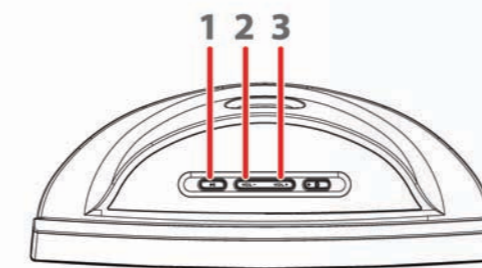

- [▶||] button
Quickpress = Pause
Quickpress again = Play
- [VOL-] button
Quickpress = previous song
Press & Hold = volume down
- [VOL+] button
Quickpress = next song
Press & Hold = volume up

Troubleshooting tips

I Can pair the Bluetooth Speaker with my Bluetooth device, but I cannot hear any music?

- Make sure your Bluetooth device supports A2DP profile.

I cannot get the Bluetooth Speaker into Pairing Mode.

- Make sure the **Bluetooth Speaker** is plugged in and turned ON before beginning the pairing process.
- Press and hold the **[BLUETOOTH CONNECT]** button until the **BLUE** indicator light flashes quickly, this will signal that the speaker is in **Pairing Mode**, and ready to connect to your Bluetooth enabled device.

My mobile phone is not able to pair with the Bluetooth Speaker.

- Make sure that the speaker is plugged in and turned on before pairing.
- Keep your **Bluetooth Speaker** and Bluetooth enabled device within 3 feet of each other during the pairing process.
- Check that your device's Bluetooth feature is turned ON.
- Try repeating the pairing process, see "Pairing the Speaker with a Bluetooth enabled device."

After successfully pairing my Bluetooth enabled device and Bluetooth Speaker, when I shut my device off and turn it on again, the speaker did not automatically connect.

- Try turning the speaker **OFF**, and then turning it **ON** again.
- Many Bluetooth enable devices have an auto reconnect option when first attempting to reconnect to a newly paired Bluetooth device. Make sure you accept this option, so that your **Bluetooth Speaker** automatically reconnects to your Bluetooth enabled device; check the user guide of your Bluetooth enabled for more information regarding this option.
- Try unpairing the speaker from your Bluetooth enabled device, and repeat the pairing procedure.

The sound is very low.

- Try adjusting the volume by using the **[VOL]** buttons on your speaker; make sure the volume on your Bluetooth enabled device is turned up as well.

Using as a wired speaker

The EBT2001 can be used as a wired speaker by using the included 3.5mm Auxiliary Cord.

- Make sure the Bluetooth Speaker is plugged in and turned on.
- Plug one end of the Auxiliary Cord into the **DC IN** jack located on the back of the Speaker.
- Plug the other end of the Auxiliary Cord into the headphone jack of any media device which has a 3.5mm headphone jack (this is a standard headphone-out jack).
- Use your media device's music controls to control the music and volume (the controls on the speaker will not function when using it as wired speaker).

Safety Information

- Observe all signs in the designated areas where some electronic devices or RF radio products are required to be switched off. These could include airplanes, hospitals, blasting areas, and potentially explosive atmospheres.

FCC and telephone company information

FCC Part 15: This device complies with Part 15 of the FCC Rules. Operation is subject to the following two conditions:

- (1) this device may not cause harmful interference, and
- (2) this device must accept any interference received, including interference that may cause undesired operation.

Warning: Changes or modifications to this equipment not expressly approved by the party responsible for compliance could void the user's authority to operate the equipment.

NOTE: This equipment has been tested and found to comply with the requirements for a Class B digital device under Part 15 of the Federal Communications Commission (FCC) rules. These requirements are intended to provide reasonable protection against harmful interference in a residential installation. This equipment generates, uses and can radiate radio frequency energy and, if not installed and used in accordance with the instructions, may cause harmful interference to radio communications.

However, there is no guarantee that interference will not occur in a particular installation. If this equipment does cause harmful interference to radio or television reception, which can be determined by turning the equipment off and on, the user is encouraged to try to correct the interference by one or more of the following measures:

- Reorient or relocate the receiving antenna.
- Increase the separation between the equipment and receiver.
- Connect the equipment into an outlet on a circuit different from that to which the receiver is connected.
- Consult the dealer or an experienced radio/TV technician for help.

Warranty Information

Limited Warranty

In the unlikely event that this product is defective, or does not perform properly, you may within one (1) year from your original date of purchase return it to the authorized service center for repair or exchange.

TO OBTAIN WARRANTY SERVICE:

- Provide proof of the date of purchase within the package (Dated bill of sale).
- Prepay all shipping costs to the authorized service center, and remember to insure your return.
- Include a return shipping address (no P.O. Boxes), a telephone contact number, and the defective unit within the package.
- Describe the defect or reason you are returning the product.

Your product will be repaired or replaced, at our option, for the same or similar model of equal value if examination by the service center determines this product is defective. Products received damaged as a result of shipping will require you to file a claim with the carrier.

The shipping address of the authorized service center is:

Southern Telecom, Inc.
ATTN: Customer Service - 2nd Floor
14-C 53rd Street
Brooklyn, NY 11232

Should you have any questions or problems concerning this product, please contact our customer service department at:

1-877-768-8483 (Toll Free)
Monday - Thursday: 9AM - 5PM (EST)
Friday: 9AM - 3PM (EST)
or
via e-mail at
cs@southern telecom.com

Warranty information (Cont.)

Warranty service not provided

This warranty does not cover damage resulting from misuse, abuse, improper installation or operation, lack of reasonable care, and unauthorized modification. This warranty is void in the event any unauthorized person opens, alters or repairs the product. All products being returned to the authorized center for repair must be suitably packaged.

Limitation of Warranty:

• THE WARRANTY STATED ABOVE IS THE ONLY WARRANTY APPLICABLE TO THIS PRODUCT. ALL OTHER WARRANTIES EXPRESS OR IMPLIED (INCLUDING ALL IMPLIED WARRANTIES OF MERCHANTABILITY OR FITNESS FOR A PARTICULAR PURPOSE) HEREBY DISCLAIMED. NO VERBAL OR WRITTEN INFORMATION GIVEN BY SOUTHERN TELECOM INC. IT'S AGENTS, OR EMPLOYEES SHALL CREATE A GUARANTY OR IN ANY WAY INCREASE THE SCOPE OF THIS WARRANTY.

• REPAIR OR REPLACEMENT AS PROVIDED UNDER THIS WARRANTY IS THE EXCLUSIVE REMEDY OF THE CONSUMER. SOUTHERN TELECOM INC. SHALL NOT BE LIABLE FOR INCIDENTAL OR CONSEQUENTIAL DAMAGES RESULTING FROM THE USE OF THIS PRODUCT OR ARISING OUT OF ANY BREACH OF ANY EXPRESS OR IMPLIED WARRANTY ON THIS PRODUCT. THIS DISCLAIMER OF WARRANTIES AND LIMITED WARRANTY ARE GOVERNED BY THE LAWS OF THE STATE OF NEW YORK, EXCEPT TO THE EXTENT PROHIBITED BY APPLICABLE LAW, ANY IMPLIED WARRANTY OF MERCHANTABILITY OR FITNESS FOR A PARTICULAR PURPOSE ON THIS PRODUCT IS LIMITED TO THE APPLICABLE WARRANTY PERIOD SET FORTH ABOVE.

Some states do not allow the exclusion nor limitation of incidental or consequential damages, or limitations on how long an warranty lasts so the above limitations or exclusions may not apply to you. This warranty gives you specific legal rights, and also may have other rights that vary from state to state.



Distributed by Southern Telecom Inc. Brooklyn, NY 11232

© 2012 Southern Telecom Inc. All rights reserved.

Emerson and the G-Clef logo are registered trademarks of Emerson Radio Corp. Parsippany, New Jersey USA.

The Bluetooth® word mark and logos are owned by the Bluetooth SIG, Inc.

All other trademarks are trademarks of their respective owners.

www.emersonphones.com

Free Manuals Download Website

<http://myh66.com>

<http://usermanuals.us>

<http://www.somanuals.com>

<http://www.4manuals.cc>

<http://www.manual-lib.com>

<http://www.404manual.com>

<http://www.luxmanual.com>

<http://aubethermostatmanual.com>

Golf course search by state

<http://golfingnear.com>

Email search by domain

<http://emailbydomain.com>

Auto manuals search

<http://auto.somanuals.com>

TV manuals search

<http://tv.somanuals.com>