

Charging the Bluetooth Headset

1. Connect the charging pin of the USB cable to the charging socket of the headset.
2. Connect the other end of the USB cable to either the:
 - AC Charger, and plug into a wall (A/C) outlet.
 - Computer's USB port.
 - Car Charger
3. The RED LED indicator light turns on.
4. The RED LED indicator light shuts off when the headset is fully charged (approximately 2 hours).

NOTE: When the battery is running low, the RED indicator light starts to flash.

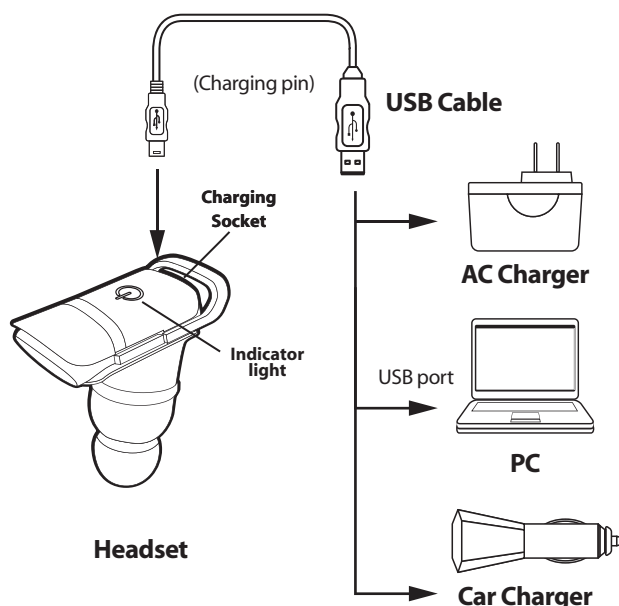

NOTE: Make sure you charge your headset for 2 hours before using it for the first time.

Pairing the headset with a Bluetooth enabled phone

1. Make sure the Bluetooth Headset is turned off.
2. Keep your Bluetooth Headset and mobile phone within 3 feet of each other during the pairing process.
3. Press and HOLD the [POWER] button until the RED and BLUE lights flash alternately.

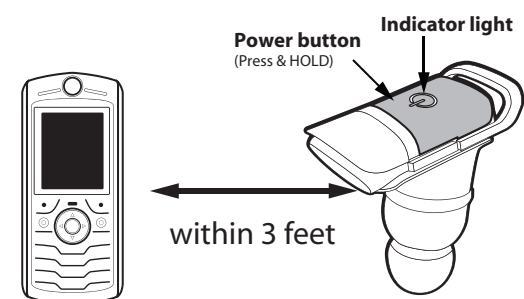

NOTE: To enter the pairing mode, you must press and HOLD the power button for approximately 10 seconds.

4. Set your mobile phone to search for Bluetooth devices.

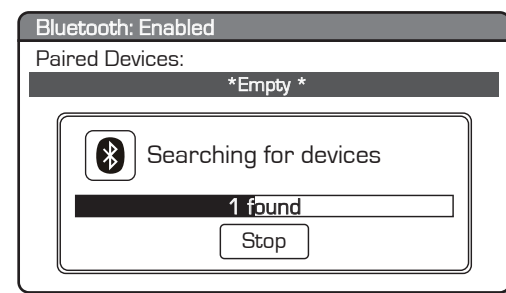

5. When the phone finds the headset, confirm by selecting EM700 from the list.

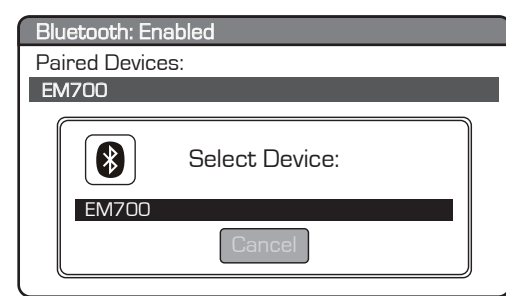

6. Enter passcode "0000" when prompted by the phone.

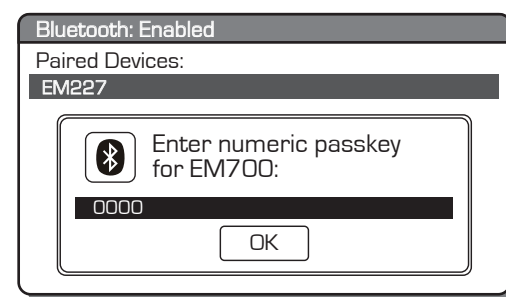

7. Your mobile phone will confirm that the pairing was completed, and prompt you to accept the connection. Please respond YES to connect the headset to your mobile phone. If the pairing was successful, the headset's indicator light flashes a steady blue.

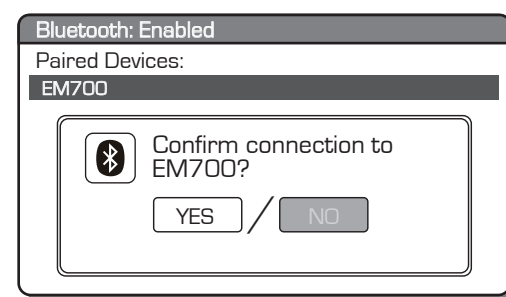

8. When attempting to reconnect the headset to your mobile phone, you may see the message below, and your mobile phone will prompt you to accept the connection request to the EM700 headset, and an option not to ask this again. Please accept the connection, and if you select "Don't ask this again", your phone will automatically accept future connection requests from your Bluetooth Headset.

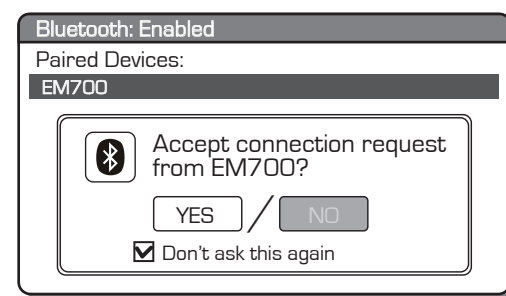

NOTE: The screenshots above are typical of many Bluetooth enabled phones in the market today, and are used to assist in the explanation of the pairing process. Your mobile phone's interface and interaction with the Bluetooth Headset may slightly differ from the illustrations above.

Using your Bluetooth Headset

Powering ON/OFF

- To turn ON, press and hold the [POWER] button until the BLUE LED indicator light turns on.
- To turn OFF, press and hold the [POWER] button until the BLUE LED indicator light changes to RED, and then shuts off.

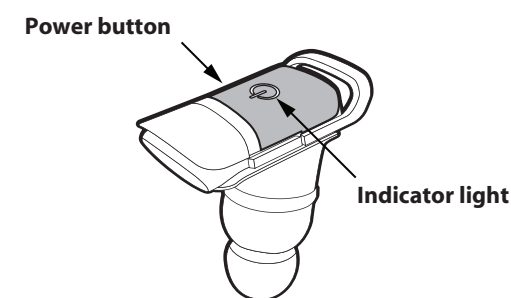

Answering/Ending a call

- To answer a call, press and release the [POWER] button.
- To end a call, press and release the [POWER] button.

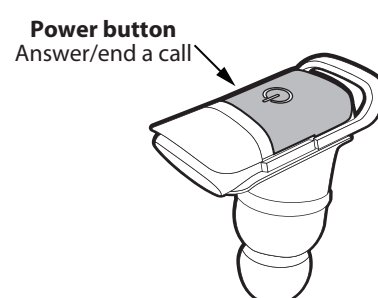

To make a call

Dial the number and press the send button on your mobile phone, the call is automatically transferred to the headset.



Redialing the last number called (Dependent on your phone supporting this feature)

Press the [VOLUME UP] button for 3 seconds, and release. The last number called will be redialed.

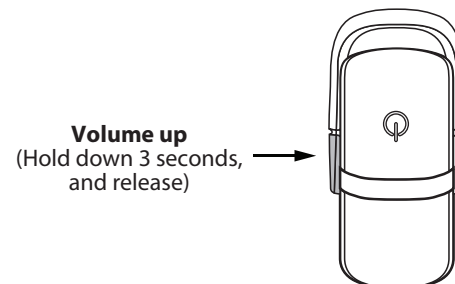

Adjusting the volume

Press the [VOLUME UP] or [VOLUME DOWN] button to adjust the volume to the desired level.

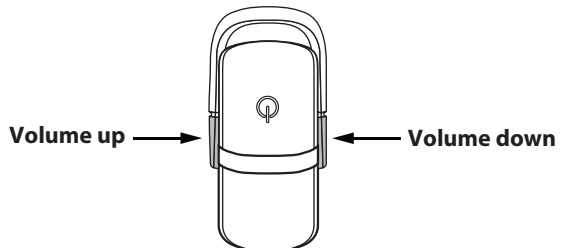

NOTE: You may also adjust the volume from your mobile phone's volume control.

Wearing your Bluetooth Headset

For added comfort and noise suppression, 3 silicone tips are included with your Bluetooth Headset. Choose one of the provided silicone tips (S) (M) (L), which fits most comfortably in your ear, and insert it on the Bluetooth Headset as shown in the diagram below

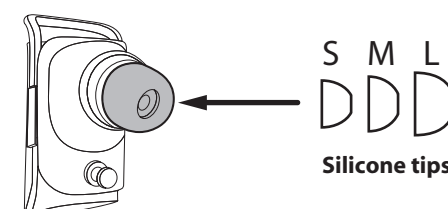

You may wear your headset with or without the provided earhook. If you choose to wear your headset with the earhook, connect it to the headset as shown in the diagram below.

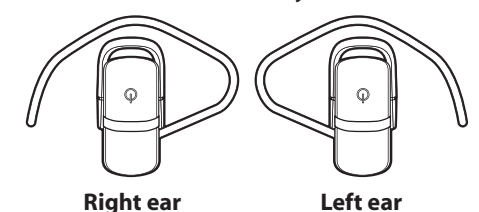
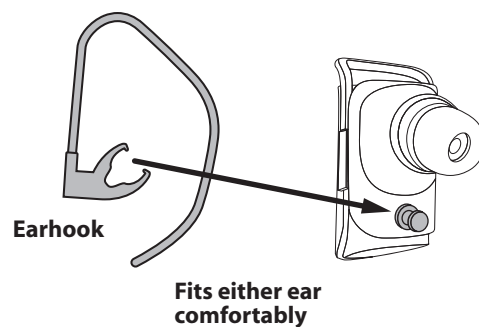

NOTE: For the best audio quality, always wear your Bluetooth Headset on the same side of the body as your mobile phone

Troubleshooting tips

I cannot get the Bluetooth Headset into "Pairing" mode

- Make sure the Bluetooth Headset is turned off before beginning the pairing process.
- Press and hold the [Power] button until the RED and BLUE lights flash alternately, this will signal that the headset is in "Pairing" mode, and ready to connect to your mobile phone.

My mobile phone is not able to pair with the Bluetooth Headset

- Make sure that you fully charged the headset before pairing.
- Keep your Bluetooth Headset and mobile phone within 3 feet of each other during the pairing process.
- Check that your phone's Bluetooth feature is turned ON.
- Try repeating the pairing process, see "Pairing the headset with a Bluetooth enabled phone."

After successfully pairing my mobile phone and Bluetooth Headset, when I shut my phone and turn it on again, my headset did not automatically connect

- Try turning the headset OFF, and then turning it ON again.

- Many mobile phones have an auto reconnect option when first attempting to reconnect to a newly paired Bluetooth device. Make sure you accept this option, so that your Bluetooth Headset automatically reconnects to your mobile phone; check the user guide of your mobile phone for more information regarding this option.

- Try unpairing the headset from your phone, and repeat the pairing procedure

I hear distortion, and the sound quality is poor

- For the best audio quality, always wear your Bluetooth Headset on the same side of the body as your mobile phone.

- Check that the battery is charged enough.

The sound is very low

- Try adjusting the volume by using the [Volume] button on your headset; make sure the volume on your mobile phone is turned up as well.

Safety information

- Check local laws regarding use of a mobile handset and wireless headset while driving. If you use the Bluetooth Headset while driving, ensure your attention and focus remains on your driving.
- Observe all signs in the designated areas where some electronic devices or RF radio products are required to be switched off. These could include airplanes, hospitals, blasting areas, and potentially explosive atmospheres.

CAUTION: Although this device enables drivers to conduct handsfree conversations, it is still dangerous to drive and use a mobile phone at the same time. Always keep your full attention on your driving.

Product maintenance

- Power off this product when not in use.
- DO NOT expose this product to water or other liquids.
- DO NOT use abrasive cleaning solvents to clean the Bluetooth Headset.
- If you will not use the Bluetooth Headset for long periods, be sure to store it in a dry place, free from extreme temperature, humidity and dust.

FCC and telephone company information

FCC Part 15
This equipment has been tested and found to comply with the requirements for a Class B digital device under Part 15 of the Federal Communications Commission (FCC) rules. These requirements are intended to provide reasonable protection against harmful interference in a residential installation. This equipment generates, uses and can radiate radio frequency energy and, if not installed and used in accordance with the instructions, may cause harmful interference to radio communications. However, there is no guarantee that interference will not occur in a particular installation. If this equipment does cause harmful interference to radio or television reception, which can be determined by turning the equipment off and on, the user is encouraged to try to correct the interference by one or more of the following measures:

- Re-orient or relocate the receiving antenna.
- Increase the separation between the equipment and receiver.
- Connect the equipment into an outlet on a circuit different from that to which the receiver is connected.
- Consult the dealer or an experienced radio/TV technician for help.

Do not attempt to repair or modify this equipment.

Warning: Changes or modifications to this equipment not expressly approved by the party responsible for compliance could void the user's authority to operate the equipment.

Industry Canada

Operation is subject to the following two conditions: (1) This device may not cause interference and (2) This device must accept any interference, including interference that may cause undesired operation of the device.

The term "IC:" before the certification/registration number only signifies that registration was performed based on a Declaration of Conformity indicating that Industry Canada technical specifications were met. It does not imply that Industry Canada approved the equipment.

Warranty information

1 Year Limited Warranty

In the unlikely event that this product is defective, or does not perform properly, you may within one (1) year from your original date of purchase return it to the authorized service center for repair or exchange.

TO OBTAIN WARRANTY SERVICE:

- Provide proof of the date of purchase within the package (Dated bill of sale).
- Prepay all shipping costs to the authorized service center, and remember to insure your return.
- Include a return shipping address (no P.O. Boxes), a telephone contact number, and the defective unit within the package.
- Describe the defect or reason you are returning the product.

Your product will be repaired or replaced, at our option, for the same or similar model of equal value if examination by the service center determines this product is defective. Products received damaged as a result of shipping will require you to file a claim with the carrier.

The shipping address of the authorized service center is:

Southern Telecom Inc.
ATTN: Returns Department
14-C 53rd Street
Brooklyn, NY 11232

Should you have any questions or problems concerning this product, please contact our customer service department at:

1-877-768-8483 (Toll Free)
Monday - Thursday: 9AM - 5PM (EST)
Friday: 9AM - 3PM (EST)
or
via e-mail at
cs@southern telecom.com

Warranty service not provided

This warranty does not cover damage resulting from accident, misuse, abuse, improper installation or operation, lack of reasonable care, and unauthorized modification. This warranty is voided in the event any unauthorized person opens, alters or repairs this product. All products being returned to the authorized service center for repair must be suitably packaged.

Limitation of Warranty:

THE WARRANTY STATED ABOVE IS THE ONLY WARRANTY APPLICABLE TO THIS PRODUCT. ALL OTHER WARRANTIES, EXPRESS OR IMPLIED (INCLUDING ALL IMPLIED WARRANTIES OF MERCHANTABILITY OR FITNESS FOR A PARTICULAR PURPOSE) ARE HEREBY DISCLAIMED. NO VERBAL OR WRITTEN INFORMATION GIVEN BY SOUTHERN TELECOM INC. ITS AGENTS, OR EMPLOYEES SHALL CREATE A GUARANTEE OR IN ANY WAY INCREASE THE SCOPE OF THIS WARRANTY.

REPAIR OR REPLACEMENT AS PROVIDED UNDER THIS WARRANTY IS THE EXCLUSIVE REMEDY OF THE CONSUMER. SOUTHERN TELECOM INC. SHALL NOT BE LIABLE FOR INCIDENTAL OR CONSEQUENTIAL DAMAGES RESULTING FROM THE USE OF THIS PRODUCT OR ARISING OUT OF ANY BREACH OF ANY EXPRESS OR IMPLIED WARRANTY ON THIS PRODUCT. THIS DISCLAIMER OF WARRANTIES AND LIMITED WARRANTY ARE GOVERNED BY THE LAWS OF THE STATE OF NEW YORK. EXCEPT TO THE EXTENT PROHIBITED BY APPLICABLE LAW, ANY IMPLIED WARRANTY OF MERCHANTABILITY OR FITNESS FOR A PARTICULAR PURPOSE ON THIS PRODUCT IS LIMITED TO THE APPLICABLE WARRANTY PERIOD SET FORTH ABOVE.

Some states do not allow the exclusion nor limitation of incidental or consequential damages, or limitations on how long an implied warranty lasts so the above limitations or exclusions may not apply to you. This warranty gives you specific legal rights, and you also may have other rights that vary from state to state.



Distributed by: AIT Inc. Brooklyn, NY 11232
© 2009 AIT Inc. All rights reserved.
www.emersonphones.com

Emerson and the G-Clef logo are registered trademarks of Emerson Radio Corp. Parsippany, New Jersey USA.

The Bluetooth® word mark and logos are owned by the Bluetooth SIG, Inc.



Bluetooth®
Wireless Headset

Model: EM-700

In the box

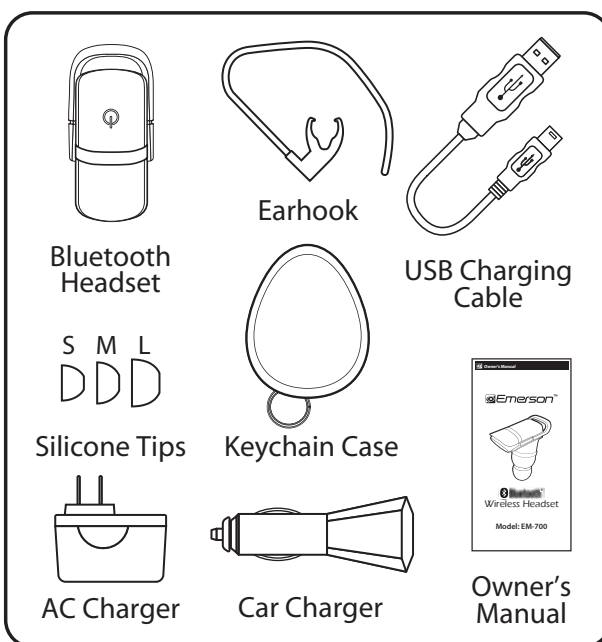

Drive Safe

Driving while talking on your mobile phone is dangerous, and illegal in many states. Although this device enables drivers to conduct handsfree conversations, it is still dangerous to drive and use a mobile phone at the same time. We recommend pulling over before making or answering calls, especially during adverse driving conditions. Please use your mobile phone, and our product responsibly while driving!

Free Manuals Download Website

<http://myh66.com>

<http://usermanuals.us>

<http://www.somanuals.com>

<http://www.4manuals.cc>

<http://www.manual-lib.com>

<http://www.404manual.com>

<http://www.luxmanual.com>

<http://aubethermostatmanual.com>

Golf course search by state

<http://golfingnear.com>

Email search by domain

<http://emailbydomain.com>

Auto manuals search

<http://auto.somanuals.com>

TV manuals search

<http://tv.somanuals.com>