

IN2100 (SERIES)

InFocus
Bright Ideas Made Brilliant



Reliable Workhorse

Ease of Use - Maximum Functionality
Essential Features - Brilliant Image Quality

IN2100 (SERIES)

Maximum functionality, maximum affordability

Bring the big picture to everyday environments. The new IN2100 series combines functionality and affordability like never before. The first InFocus product line to offer networking functionality for a low cost, the IN2100 series also has LitePort™ – a PC-free presenter, multiple VGA and assignable audio inputs, giving it a variety of connectivity options. The IN2100 series boasts a high brightness of 3000 lumens, and a brightness of 2400 lumens in Eco Mode.

Compatible with resolutions of up to WUXGA (1920 × 1200) using DLP® technology with the InFocus BrilliantColor™ implementation gives the IN2100 series industry-leading picture quality. The IN2100 series also has a unique “Blue Iris” Glow Ring, which lets users know when the projector is powering up or powering down. Get the big picture in any environment with the IN2100 series.



IN2112

SVGA (800 × 600) RESOLUTION
3000 LUMENS/2400 LUMENS IN ECO MODE

The InFocus IN2112 brings high-quality projection to everyday environments.

IN2114

XGA (1024 × 768) RESOLUTION
3000 LUMENS/2400 LUMENS IN ECO MODE

The IN2114 offers network connectivity options at a low cost while providing maximum functionality in a portable package.

IN2116

WXGA (1280 × 800) RESOLUTION
3000 LUMENS/2400 LUMENS IN ECO MODE

With a high-quality picture, ease-of-use, and expanded network connectivity, the IN2116 is an ideal solution for smaller environments.

Resolution Options

Choose from SVGA, cost-leading XGA, or widescreen WXGA resolution. WXGA (1280 × 800) is the standard resolution in most technology devices today and has been widely adopted in business and education.



“We’ve improved the performance of our best selling IN2100 series to meet the demands of next generation media and control. This makes information and content more accessible for the classroom or office.”

Robert Detwiler
InFocus Product Manager



SVGA 800 x 600 PIXELS XGA 1,024 x 768 PIXELS WXGA 1,280 x 800 PIXELS

24/7 Non-Stop Projection

The new IN2100 series has no duty cycle limitations. It is filter-free and rated for 24/7 operation, resulting in less maintenance and hours of worry-free use.

Low Power Consumption

The new IN2100 series is an easy choice for your wallet and the environment. Though it boasts a maximum brightness at full power, an eco-friendly Eco Mode allows for a lower power setting and a 20% reduction in brightness. In addition, while in standby mode, the series is designed to consume less than 1 watt of power.

Designed for Long Life

The new IN2100 series is designed for reliable and low cost operation. The IN2100's dust-resistant design means there is no filter or screen to replace, and the InFocus warranty reduces the risk of repair or replacement cost.

Clean, Installation-friendly Design

No need to remove the projector from the ceiling to check assets or replace a lamp – the new IN2100's design allows for easy access to lamp doors, serial numbers and I/O panels. In addition, the LiteTouch™ keypad gives the projector a clean look once it is installed.

LiteTouch Touchsense Keypad

The sleek backlit LiteTouch control panel provides one-touch access to the most commonly used projector functions.



Expanded Connectivity

Connect to a network or present without a PC with the LitePort USB port feature (IN2114 & IN2116). The new IN2100 series gives options for hassle-free connecting and presenting. Both models also offer two computer and two assignable audio inputs, making them convenient for multiple users.

Projector Management

The IN2114 and IN2116 have imbedded network services with web browser control. This projector model is also compatible with ProjectorNet™ 3.0, our free asset management software that enables you to conserve the projector's lamp life by scheduling On/Off times, presenting maintenance events and anti-theft security alerts.

Dynamic Messaging System

Send dynamic messages for instant display to InFocus projectors using the InFocus Dynamic Messaging System (DMS). Perfect for general and important announcements such as schedule changes, weather warnings, breaking news and emergency notifications.

PC-Free Presentations

The IN2114 and IN2116 feature LitePort, an embedded PC-free JPEG Reader that enables users to project images directly from a standard USB flash drive – no computer needed.

LiteShow III™

Connect the InFocus LiteShow III wireless adaptor to any projector or other display to quickly and easily share data, audio and video over a secure wireless connection. Plus, its Moderator and Quadview features make it easier to collaborate by allowing multiple computers to connect to the display simultaneously.



LiteShow III



IN2114 & IN2116 Back Panel



Bright and Brilliant

A high brightness of 3000 lumens means the new IN2100 series is bright enough in environments with high ambient light. The InFocus BrilliantColor implementation brings rich, realistic color to any presentation.

Intuitive and Easy to Use Interface

Over 20 years of customer feedback has gone into designing the new IN2100 series best-in-class menu system. It is easy to navigate, has 17 standard languages and a unique intuitive flow.

Security

The new IN2100 series has a Kensington® lock compatible slot along with a user assigned PIN feature for maximum security.

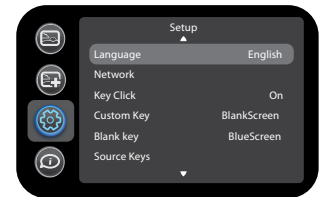

Optional Accessories

Replacement Lamp (SP-LAMP-057)
 LiteShow III (INLITESHOW3)
 Universal Ceiling Mount (SP-CEIL-UNIV)
 Extension Arms (SP-EXTARM-01, 02, 03, 04)
 Alternate Remote (HW-COMMANDER-2)
 Alternate Remote (HW-PRESENTER-RF-R)
 Projector Screen (SC-PD-80, 100, 120)
 Cables & Adapters

For more information, please visit:
www.infocus.com/Accessories.aspx

Warranty

Providing the highest quality products and support is very important to InFocus. The new IN2100 series digital projectors come standard with a 5 year limited factory warranty (including parts¹ and labor²), a 6 month limited lamp replacement warranty, and 5 year DLP warranty. Extended product and lamp warranty programs are also available.

For more information, please visit:
www.infocus.com/Support/Warranty.aspx

IN2100^(SERIES) FEATURES

- 10 W Audio
- BrilliantColor
- Built-In Network Services and ProjectorNet 3.0 Ready (IN2114 & IN2116)
- Closed Captioning
- Dust Resistant Design
- Dynamic Messaging System (DMS)
- InFocus User Interface
- LitePort USB JPEG Player (IN2114 & IN2116)
- Lens Cap Slider
- LiteSwitch Instant On/Off
- LiteShow III Wireless Ready
- LiteTouch Touchsense Keypad
- Logo Capture
- Low Power Standby (<1 W)
- RJ45 (IN2114 & IN2116)
- Sleep Timer



InFocus
 Bright Ideas Made Brilliant

www.infocus.com

INFOCUS CORPORATE HEADQUARTERS
 13190 SW 68th Parkway
 Portland, Oregon 97223-8368, USA
 Phone: (1) 503-207-4700
 Toll Free: (1) 877-388-8385
 Fax: (1) 503-207-1937

INTERNATIONAL HEADQUARTERS
 4 Teck Lim Road
 Singapore 088382
 Phone: (65) 6513-9600
 Fax: (65) 6238-0535

Specifications*

IN2112 IN2114 IN2116

Native Resolution	IN2112 – SVGA 800 × 600 IN2114 – XGA 1024 × 768 IN2116 – WXGA 1280 × 800
Maximum Resolution	WXGA (1920 × 1200)
Display Technology - DMD	IN2112 & IN2114 – DLP Technology .55" LVDS DDP2430 with BrilliantColor IN2116 – DLP Technology .65" LVDS DDP2431 with BrilliantColor
Brightness	3000 ANSI lm (2400 lm Eco Mode)
Lamp Life**	4000 Hrs Eco Mode (3000 Hrs Normal)
Contrast Ratio	3000:1
Audible Noise	28 dB Eco Mode (32 dB High Power)
Computer Compatibility	PC, MAC
Keystone Correction	+/-30 degrees
Number of Colors	16.7 Million, True Color
Aspect Ratio	IN2112 & IN2114 – Native 4:3 (5:4, 16:9, 16:10 Supported) IN2116 – Native 16:10 (4:3, 5:4, 16:9 Supported)
Lamp Power	185 W
Power Supply	100 – 240 Vac, 50/60 Hz
Zoom Ratio	1.2:1
Throw Ratio	IN2112 & IN2114 – 1.62 ~ 1.95
(Distance/Image Width)	IN2116 – 1.5 ~ 1.8
Video Compatibility	NTSC / NTSC4.43 / PAL / PAL-M / PAL-N / SECAM SDTV: 480i, 576i EDTV: 480p, 576p HDTV: 720p, 1080i, 1080p
Audio	10 W (2 × 5 W)
Input Sources	VGA (HD15) × 2, S-Video × 1, Composite Video × 1, Audio × 2 (3.5 mm), IN2114 & IN2116: LitePort × 1
Output Sources	VGA (HD15) × 1, Audio × 1 (3.5 mm), Wireless Ready × 1
Control	IN2112: RS232, USB IN2114 & IN2116: LAN (RJ45), RS232, USB
Projection Distance	3.94 ft ~ 32.8 ft / 1.2 m ~ 10 m
Image Offset	15%
Projection Methods	Front, Rear, Ceiling Front, Ceiling Rear
Product Weight	7 lbs / 3.17 kg
Product Dimensions - W×D×H	12.4 × 9.5 × 4.6 in / 315 × 241 × 117 mm
Product Color	Black
Shipping Dimension - W×D×H	8.8 × 18.8 × 13.1 in / 223 × 477 × 332 mm
Shipping Weight	14.3 lbs / 6.48 kg
Maximum Altitude	10,000 ft / 3,000 m
Remote Control	Navigator - 3
Ships With - Accessories	Remote, VGA Cable, Power Cord, USB Cable, Carry Case, Safety Instructions, Projector User's Guide
Menu Languages	English, French, German, Italian, Korean, Norwegian, Portuguese, Russian, Spanish, Traditional Chinese, Simplified Chinese, Swedish, Finnish, Danish, Dutch, Polish, Turkish
Lamp (particle) Containment	Tested to contain particles larger than 0.8 mm ***
Accessories Warranty	90 days
Approvals	C-Tick (Australia), NOM (Mexico), CE (Europe), cMETus (USA & Canada), FCC (USA), IRAM (Argentina), GOST (Russia), MIC & eK (South Korea), CCC (China), PSB (Singapore)
Security	Kensington Lock

* Product specifications, terms, and offerings are subject to change at any time without notice.
 ** Actual lamp life may vary based on the ambient environment and projector usage. Conditions that may affect lamp life include temperature, altitude, and rapidly switching the projector on and off.
 *** Tested to contain particles larger than the specified size in any dimension



LiteSwitch



©2011 InFocus Corporation. All rights reserved. Specifications are subject to change without further notice. InFocus and InFocus Bright Ideas Made Brilliant are either trademarks or registered trademarks of InFocus Corporation in the United States and other countries. DLP, the DLP logo, and the DLP medallion are trademarks of Texas Instruments. All trademarks are used with permission or are for identification purposes only and are the property of their respective companies.
¹Excludes power supply, fans, color wheel and light tunnel which are covered for two (2) years.
²Labor is covered for two (2) years from date of proof of purchase.
 InFocus_IN2100_NEW_DS_EN_20FEB11. Part Number: MMINFOCUS-0204

Free Manuals Download Website

<http://myh66.com>

<http://usermanuals.us>

<http://www.somanuals.com>

<http://www.4manuals.cc>

<http://www.manual-lib.com>

<http://www.404manual.com>

<http://www.luxmanual.com>

<http://aubethermostatmanual.com>

Golf course search by state

<http://golfingnear.com>

Email search by domain

<http://emailbydomain.com>

Auto manuals search

<http://auto.somanuals.com>

TV manuals search

<http://tv.somanuals.com>