

5010cs, 6010cs, 6810cs

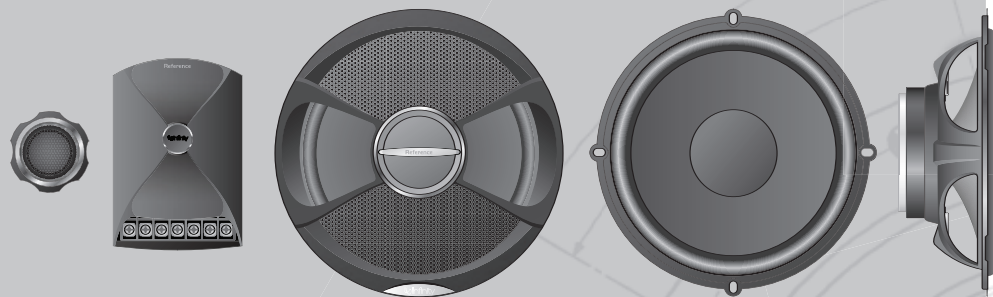

 Infinity®

instructions

reference series

THANK YOU for purchasing Infinity's Reference Series automotive loudspeaker components. We've organized this manual to make your installation as simple and trouble-free as possible. Please read it thoroughly before proceeding.

Remember to keep your sales receipt with this manual in a safe place so both are available for future reference.

IMPORTANT: Installation of automotive stereo components can require extensive experience with a variety of mechanical and electrical procedures. Although these instructions explain how to install Reference Series speakers in a general sense, they do not show the exact installation methods for your particular vehicle. If you do not feel you have the experience, do not attempt the installation yourself; instead, ask your authorized Infinity car audio dealer about professional installation options.

WARNING: Playing loud music in an automobile can permanently damage your hearing, as well as hinder your ability to hear traffic. The maximum volume levels achievable with Infinity speakers, combined with high power amplification, may exceed safe levels for extended listening. We recommend using low volume levels when driving. Infinity accepts no liability for hearing loss, bodily injury, or property damage as a result of use or misuse of this product.

INSTALLATION WARNINGS AND TIPS

- Always wear protective eyewear when using any tools.
- Turn off all audio systems and other electrical devices before you start. Disconnect the (-) negative lead from your vehicle's battery.
- Keep speakers in their package until final installation. When moving a speaker, always rest it with the cone or dome facing up. Never use force to install any speaker.
- Check clearances on both sides of a planned mounting surface before drilling any holes or installing any screws. Remember that the screws can extend behind the surface.
- At the installation sites, locate and make a note of all fuel lines, hydraulic brake lines, vacuum lines, and electrical wiring. Use extreme caution when cutting or drilling in and around these areas.

CAUTION: In some cars, fuel tanks may be located directly beneath the rear deck. Check for adequate speaker basket clearance before considering this location!

- Before drilling or cutting holes, use a utility knife to remove unwanted fabric or vinyl, to keep material from snagging in a drill bit or saw.
- For door installations, check the clearance with the windows throughout the range of the window's travel, and verify that a mounted speaker will not interfere with the window crank or power window mechanism.
- If mounting speakers elsewhere, check for clearance around rear deck torsion bars, glove box, or other structural elements.
- Do not mount speakers where they will get wet.

INSTALLATION

Figure 1. Mounting the 5010cs woofer with the grille.

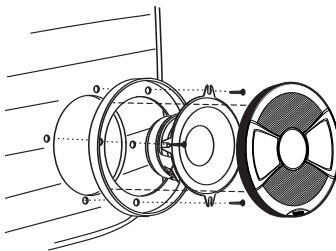
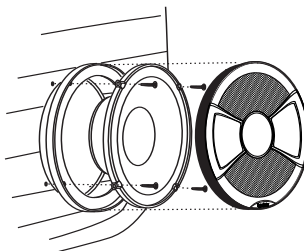
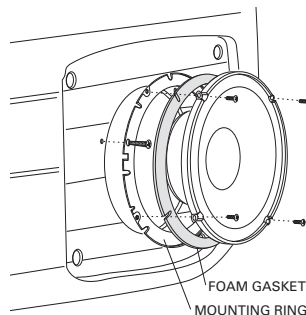

Figure 2. Mounting the 6010cs woofer with the grille.



Note: The 6810cs is designed to replace 5" x 7" and 6" x 8" speakers installed behind existing vehicle grilles, and does not include grilles.

Figure 3. Mounting the 6010cs in 165mm speaker locations.



INTERMOUNT III (PATENT NO. 6,505,705)

The 6010cs is packaged with two different speaker adaptor rings. These are used to install the 6-1/2" speakers in various vehicles. The metal ring can be mounted in many European vehicles, while the plastic ring can be mounted in many vehicles using 6-3/4" speaker locations or three-point mounting frames.

Figure 4. Mounting the 6010cs woofer in standard speaker locations.

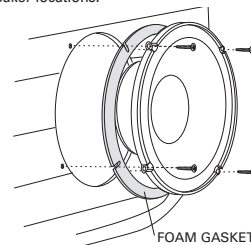

INSTALLATION

FLUSH-MOUNT

Figure 5A. Mounting the tweeter using the I-Mount™ (patent no. 5,859,917) flush-mounting kit.

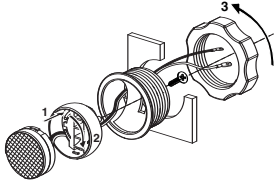

Note: Aim the tweeter at the listening position by sliding the stud in the groove on the back of the tweeter cup and rotating the entire assembly in the mounting surface. Lock the tweeter in place, using the small retaining screw.

SURFACE-MOUNT

Figure 5B. Mounting the tweeter using the I-Mount™ surface-mounting kit.

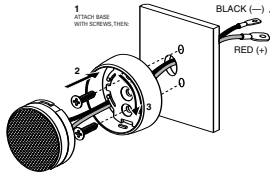

TWEETER ANGLE

Figure 6.

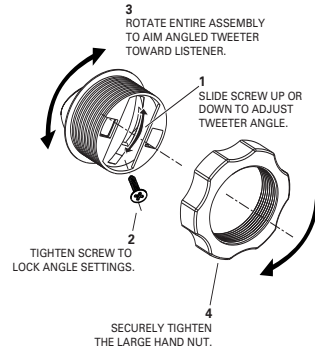

Figures 7A through 7D. The Starfish™ tweeter mount is intended to be used when the tweeter will be installed behind a factory grille (e.g., replacing the factory tweeter behind a door panel). The Starfish will allow you to mount the component tweeter directly to the panel itself or to the area behind the panel. The six mounting tabs can be removed easily to create a number of custom configurations. The tabs of the Starfish can be screwed or glued to the mounting surface for secure installation.

Note: Check screw clearance before installing. Use glue if clearance is an issue.

Note: Not all possible mounting configurations are shown.

Figure 7A. Behind grille panel.

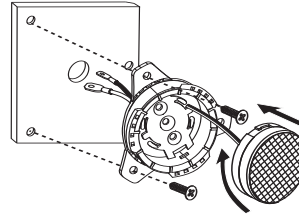

Figure 7B. Mounted to surface behind grille panel.

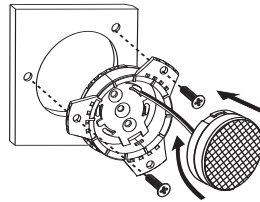

Figure 7C. Mounted to grille panel.

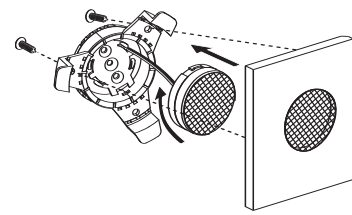
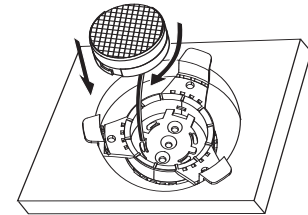

Figure 7D. In-dash location (may require gluing).



CONNECTIONS

Connect the speakers to the crossover and the crossover to the amplifier, observing proper polarity.

Figure 8A.

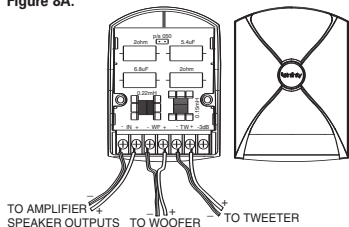

Note: To reduce tweeter output level, connect the positive (+) tweeter wire to the -3dB terminal.

Figure 8B.

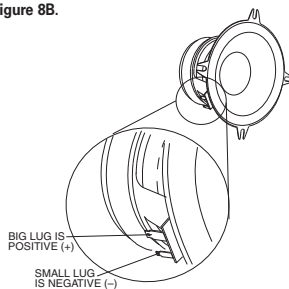

Infinity Systems • 250 Crossways Park Drive, Woodbury, NY 11797 USA
 516.674.4463 • FAX 516.682.3523 • www.infinitysystems.com
 © 2005 Harman International Industries, Incorporated • Part No. REFCSOM1/05
H A Harman International Company

SPECIFICATIONS

5010cs

Type: 5-1/4" 2-Way Component System
 Speaker Impedance: 4 Ohms
 Power Handling: 75W RMS, 225W Peak
 Frequency Response: 67Hz – 21kHz
 Sensitivity (2.83V, 1m): 91dB
 Crossover Frequency: 3.5kHz
 Mounting Depth: Woofer: 2-1/4" (58mm)
 Tweeter: 5/8" (16mm)
 Woofer: 4-11/16" (120mm)
 Tweeter: 1-3/4" (45mm)
 Cut-out Diameter:

6010cs

Type: 6-1/2" 2-Way Component System
 Speaker Impedance: 4 Ohms
 Power Handling: 90W RMS, 270W Peak
 Frequency Response: 53Hz – 21kHz
 Sensitivity (2.83V, 1m): 92dB
 Crossover Frequency: 3.5kHz
 Mounting Depth: Woofer: 2-1/16" (53mm)
 Tweeter: 5/8" (16mm)
 Woofer: 5" (127mm)
 Tweeter: 1-3/4" (45mm)
 Cut-out Diameter:

6810cs

Type: 6" x 8" 5" x 7" 2-Way Component System
 Speaker Impedance: 4 Ohms
 Power Handling: 90W RMS, 270W Peak
 Frequency Response: 49Hz – 21kHz
 Sensitivity (2.83V, 1m): 92dB
 Crossover Frequency: 3.5kHz
 Mounting Depth: Woofer: 2-7/16" (62mm)
 Tweeter: 5/8" (16mm)
 Woofer: 5" x 7-1/4" (127mm x 185mm)
 Tweeter: 1-3/4" (45mm)
 Cut-out Diameter:

A valid serial number is required for warranty coverage.

Features, specifications and appearance are subject to change without notice.

Declaration of Conformity



We, Harman Consumer Group International
 2, route de Tours
 72500 Chateau-du-Loir
 France

declare in own responsibility that the products described in this owner's manual are in compliance with technical standards:

EN 61000-6-3:2001
 EN 61000-6-1:2001

Klaus Leberz
 Harman Consumer Group International
 Chateau-du-Loir, France 1/05



Free Manuals Download Website

<http://myh66.com>

<http://usermanuals.us>

<http://www.somanuals.com>

<http://www.4manuals.cc>

<http://www.manual-lib.com>

<http://www.404manual.com>

<http://www.luxmanual.com>

<http://aubethermostatmanual.com>

Golf course search by state

<http://golfingnear.com>

Email search by domain

<http://emailbydomain.com>

Auto manuals search

<http://auto.somanuals.com>

TV manuals search

<http://tv.somanuals.com>