

# OPERATOR'S MANUAL

# 612112-D

INCLUDING: SERVICE KITS, GENERAL DESCRIPTION & TROUBLESHOOTING  
ALSO INCLUDE MANUALS: 72760-D BASIC PUMP, 635142 METER, 635392 CONTROL  
HANDLE, 640057 DOLLY, FORM 3637-2 GENERAL INFORMATION SHEET.

RELEASED:6-3-74  
REVISED:07-29-93  
(REV. B) IPP/PSE

**3" AIR MOTOR**  
**2:1 RATIO**  
**2 1/4" STROKE**

**GEAR OIL PUMP**  
**16 GALLON**

**IMPORTANT: READ THIS MANUAL CAREFULLY BEFORE INSTALLING,  
OPERATING OR SERVICING THIS EQUIPMENT.**

## SERVICE KITS

- 637066-B for repair of Air Motor section.
- Use only genuine ARO® replacement parts to assure compatible pressure rating and longest service life.

## GENERAL DESCRIPTION

This model is designed for high volume delivery of low viscosity fluids from standard containers. The model covered by this manual includes an outlet swivel, material supply hoses and airline lubricator. Material dispensing accessories and supply lines and fittings must be capable of withstanding pressures developed by the pump.

- The ARO® 2:1 ratio basic pump assembly consists of 3" air motor and flat check lower pump end.

**RATIO x REGULATED AIR PRESSURE TO AIR MOTOR = MAXIMUM FLUID PRESSURE.**

- The 2:1 ratio is an expression of the relationship between the air motor area and the lower pump end area. When 150 PSI (10 Bar) air pressure is supplied to the air motor, the lower pump end will develop a maximum of 300 PSI (21 Bar) fluid pressure (at no flow) – as the fluid control is opened, the flow rate will increase as the air motor cycle rate increases to keep up with the demand.

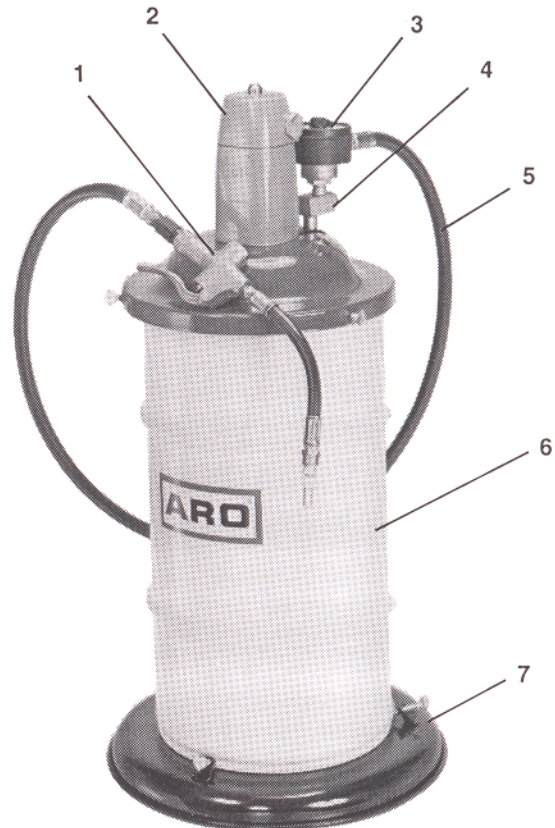

## AIR AND LUBE REQUIREMENTS

**⚠ WARNING** HAZARDOUS PRESSURE. Do not exceed maximum inlet air pressure of 150 psi (10 bar). Operating pump at higher pressure may cause pump damage and/or personal injury and/or property damage.

**⚠ WARNING** Refer to general information sheet for additional safety precautions and important information.

- Excessive air pressure will shorten the life of the pump.
- For maximum operating efficiency, the following air supply specifications should be maintained to this pump.
  - AIR PRESSURE – Up to 150 P.S.I. (10 Bar)
  - AIR FILTRATION – 50 micron
  - LUBRICATED AIR SUPPLY
  - AIR INLET SIZE – 1/4" NPTF

## ACCESSORIES LIST

ITEM	Description	Qty	Part No.
1	Control Handle ★	1	635399
2	Basic Pump ★	1	72760-D
3	Meter★	1	635142
4	Outlet Assembly	1	72547
5	Material Hose	1	622553-6
6	16 Gallon Drum	1	Not Included
7	Dolly ★	1	640057

★ SEE OPERATOR'S MANUAL

THE ARO CORPORATION • ONE ARO CENTER • BRYAN, OHIO 43506-0151  
PH: (419) 636-4242 • FAX (419) 636-2115  
©1993 THE ARO CORPORATION • PRINTED IN U.S.A.



Part of worldwide Ingersoll-Rand

# 612112-D PUMP ASSEMBLY

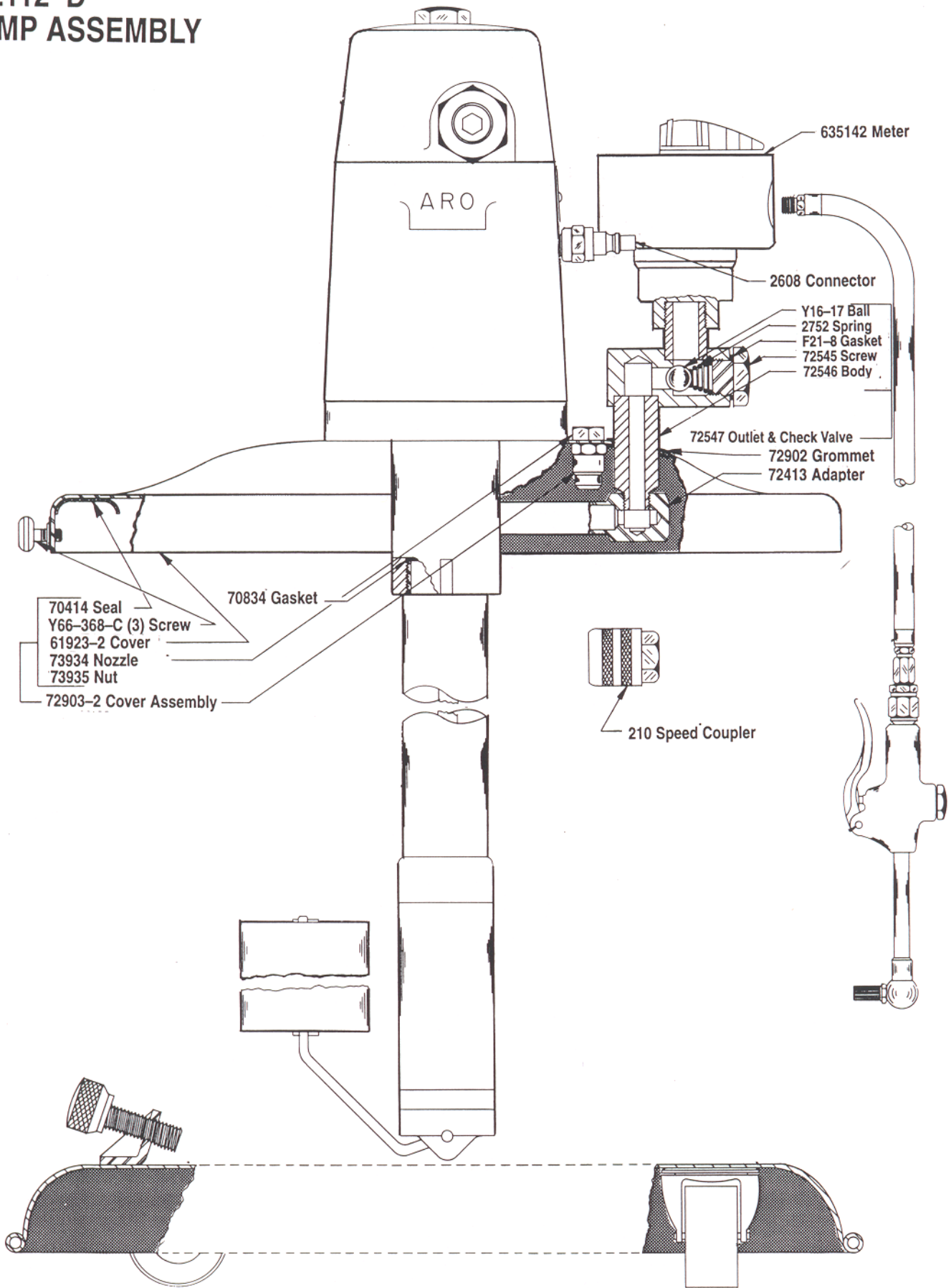

Part of worldwide Ingersoll-Rand

-PN 97999-318

## Free Manuals Download Website

<http://myh66.com>

<http://usermanuals.us>

<http://www.somanuals.com>

<http://www.4manuals.cc>

<http://www.manual-lib.com>

<http://www.404manual.com>

<http://www.luxmanual.com>

<http://aubethermostatmanual.com>

Golf course search by state

<http://golfingnear.com>

Email search by domain

<http://emailbydomain.com>

Auto manuals search

<http://auto.somanuals.com>

TV manuals search

<http://tv.somanuals.com>