

# OPERATOR'S MANUAL

# 612805

INCLUDING: OPERATION, INSTALLATION & MAINTENANCE

RELEASED:10-17-68  
REVISED: 8-24-10  
(REV.D) IPP/PSE

4 1/4" AIR MOTOR  
50:1 RATIO  
4" STROKE

CHASSIS GREASE PUMP  
400 LB. DRUM

**IMPORTANT: READ THIS MANUAL CAREFULLY BEFORE INSTALLING,  
OPERATING OR SERVICING THIS EQUIPMENT.**

## SERVICE KITS

- 61268 for repair of Air Motor section.
- 61052 for repair of entire pump
- 65130 for repair of Base Packing
- Use ARO® replacement parts to assure compatible pressure rating.

## GENERAL DESCRIPTION

This model is designed for chassis lubrication. The model covered by this manual includes an outlet swivel, material supply hoses and airline lubricator. Material dispensing accessories and supply lines and fittings must be capable of withstanding pressures developed by pump.

- The Aro® 50:1 ratio basic pump assembly consists of 4 1/4" air motor, and ball-check lower pump end.

**RATIO x REGULATED AIR PRESSURE TO AIR MOTOR = MAXIMUM FLUID PRESSURE**

- The 50:1 ratio is an expression of the relationship between the air motor area and the lower pump end area. When 150 PSI (10 Bar) air pressure is supplied to the air motor, the lower pump end will develop a maximum of 7500 PSI (517 Bar) fluid pressure (at no flow)—as the fluid control is opened, the flow rate will increase as the air motor cycle rate increases to keep up with the demand.

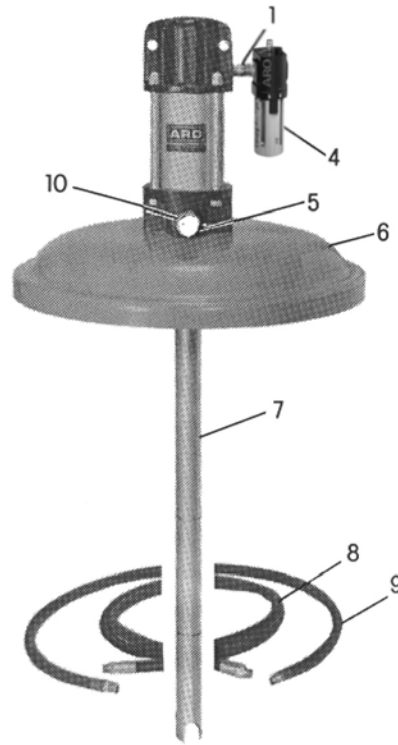

## AIR AND LUBE REQUIREMENTS

- **WARNING: DO NOT EXCEED MAXIMUM INLET AIR PRESSURE OF 150 PSI (10 BAR). OPERATING PUMP AT HIGHER PRESSURE MAY CAUSE PUMP DAMAGE AND/OR PERSONAL INJURY AND/OR PROPERTY DAMAGE.**
- Excessive air pressure will shorten the life of the pump.
- For maximum operating efficiency. The following air supply specification should be maintained to this pump.
  - AIR PRESSURE – up to 150 P.S.I. (10 bar)
  - AIR FILTRATION – 50 micron
  - LUBRICATED AIR SUPPLY
  - AIR INLET SIZE – 1/2" NPTF

## ACCESSORIES LIST

REF.	DESCRIPTION	(SIZE)	PART NO.
1	Nipple		Y27-154-C
4	Lubricator		L36341-110
5	Union & Check Valve		2453
6	Drum Cover		60898
7	Basic Pump★		662400-C
8	Material Hose		622401-8
9	Air Hose		621501-5
10	Nipple		Y27-154-C

### Not Shown

11	Bushing(Connects Check to Mat'l Hose)		Y45-306-C
12	Bung Adapter		4148
13	Screw		Y6-67-C(2)
14	Screw (Fastens Drum Cover to Pump)		Y6-63-C(4)
15	Washer		Y14-616(4)

★SEE OPERATOR'S MANUAL

## INGERSOLL RAND COMPANY LTD

209 NORTH MAIN STREET – BRYAN, OHIO 43506

☎ (800) 495-0276 • FAX(800) 892-6276

© 2010 CCN 81378663

www.ingersollrandproducts.com

Download from Wwww.Somanuals.com. All Manuals Search And Download.

# ARO

**IR** Ingersoll Rand  
Industrial Technologies

- Filtered and oiled air will allow the pump to operate more efficiently and yield a longer life to operating parts and mechanisms.
- Lack of or an excessive amount of lubrication will affect the performance and life of this pump. Use only recommended lubricants.
- DAILY Fill air line lubricator reservoir with a good grade of S.A.E. NO. 90W non-detergent gear oil, adjust to 1 to 2 drops per minute.
- If pump is to be Inoperative for more than a few hours at a time, disconnect air supply and relieve all pressure from the system.

It is recommended that an oiler be installed in the air line as close as possible to the pump. This increases the service life of the pump by reducing wear of the air motor's internal parts.

## TROUBLE-SHOOTING

Should pump operate, but dispense little or no material, check for:

- \_\_\_ Inadequate supply of material or possible malfunctioning of 65872 Foot Valve which would prevent material from feeding into suction tube.
- \_\_\_ Improper feeding of lubricant into pump. This condition is known as "channeling" and is often indicated by light-colored frothy grease coming from control handle. Also, grease in container will not be level, but will cling to side of container and slope down to suction tube inlet. It usually occurs at cool temperatures and can be corrected by using follower plate.
- \_\_\_ Dirt or foreign matter in 65872 Foot Valve or other cause which may be preventing it from closing on downstroke of piston.

If unit should fail to operate, the following procedure will be helpful in determining the cause:

- \_\_\_ Check air pressure at pump to insure air line is not obstructed and air is being supplied to pump.
- \_\_\_ If insufficient air is not the trouble, disconnect 310 Speed Coupler at pump and then detach Hose and Gun at 2453 Check Valve. **REMOVE SLOWLY AS PRESSURE MAY BE BUILT UP IN PUMP.** Hold rag at this point and apply air to pump. If pump now operates, there is obstruction in material line, reel, or control handle. If, however, pump will still not operate, consult local dealer.

### 2453 CHECK VALVE PARTS LIST

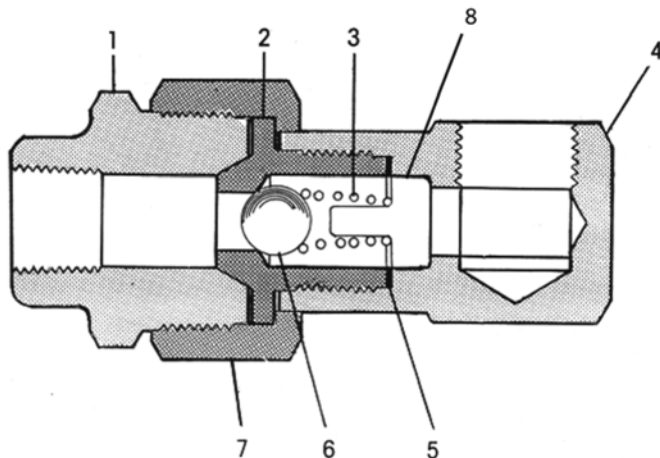

REF.	DESCRIPTION	(SIZE)	PART NO.
1	Seat .....		4616
2	Seat .....		4618
3	Spring .....		4620
4	Elbow .....		4619
5	Gasket .....		F21-57
6	Ball .....		Y16-14
7	Nut .....		4615
8	Retainer .....		2707

## Free Manuals Download Website

<http://myh66.com>

<http://usermanuals.us>

<http://www.somanuals.com>

<http://www.4manuals.cc>

<http://www.manual-lib.com>

<http://www.404manual.com>

<http://www.luxmanual.com>

<http://aubethermostatmanual.com>

Golf course search by state

<http://golfingnear.com>

Email search by domain

<http://emailbydomain.com>

Auto manuals search

<http://auto.somanuals.com>

TV manuals search

<http://tv.somanuals.com>