

INCLUDED ACCESSORIES

Remote control and two AAA batteries

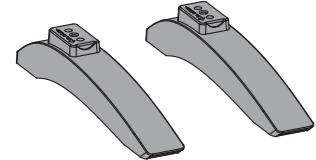

TV stands



M4 screws (14 mm length) (4 pcs.)

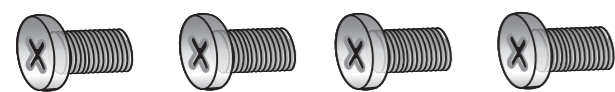

Power adapter

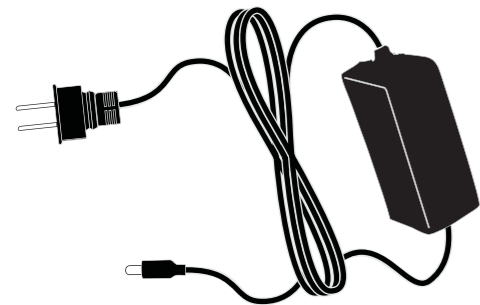

FIND YOUR USER GUIDE ONLINE!
Go to www.insigniaproducts.com, then click **Support & Service**. Enter **NS-32D420NA16** in the box under **Manual, Firmware, Drivers & Product Information**, then click ▶.

STOP
Do not plug your power cord in until all other devices have been connected.

1 START HERE

How do I attach the stand to my TV? (not for wall mounting)
You'll need: Soft surface and Phillips screwdriver

A Carefully place your TV face-down on a cushioned, clean surface.

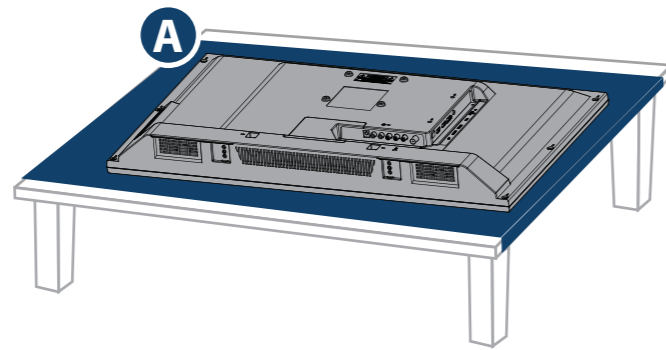

B Align the screw holes on the TV stands with the holes on the back of your TV, then secure each stand to your TV with two of the provided screws.

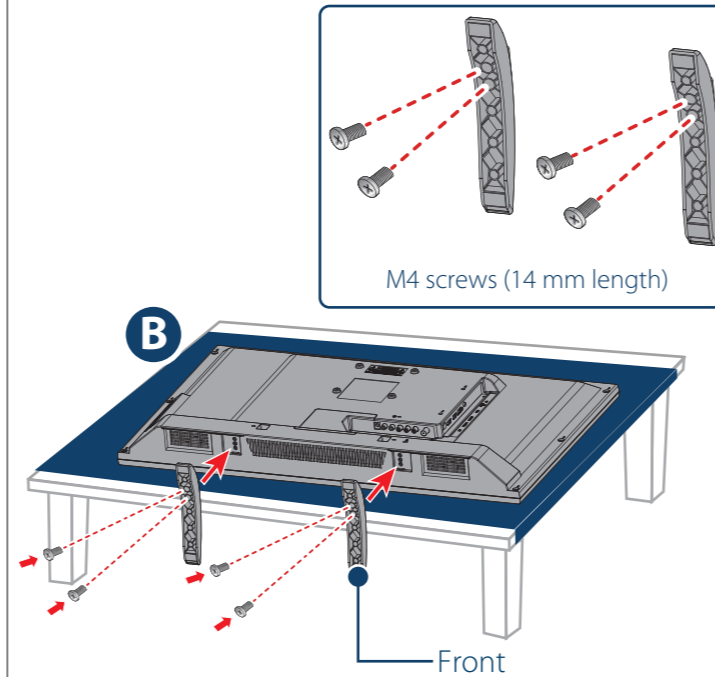

WALL MOUNT

How do I prepare my TV for wall mounting? (not for use with a TV stand)
You'll need: Soft surface and Phillips screwdriver

A Carefully place your TV face-down on a cushioned, clean surface.

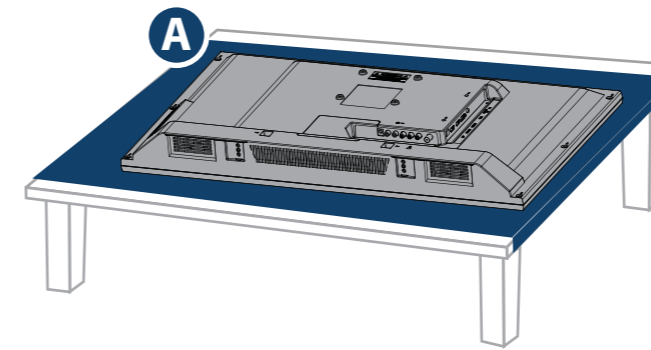

B See the instructions that came with your wall mount for more information about how to correctly mount your TV.

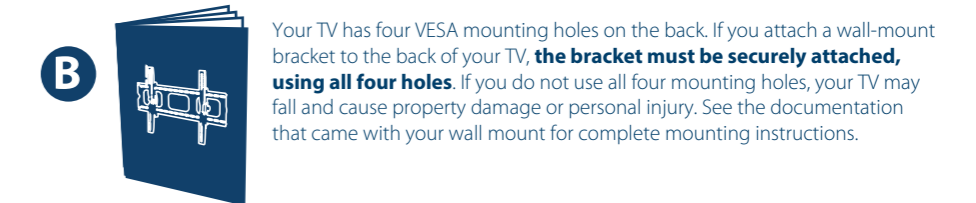

FEATURES

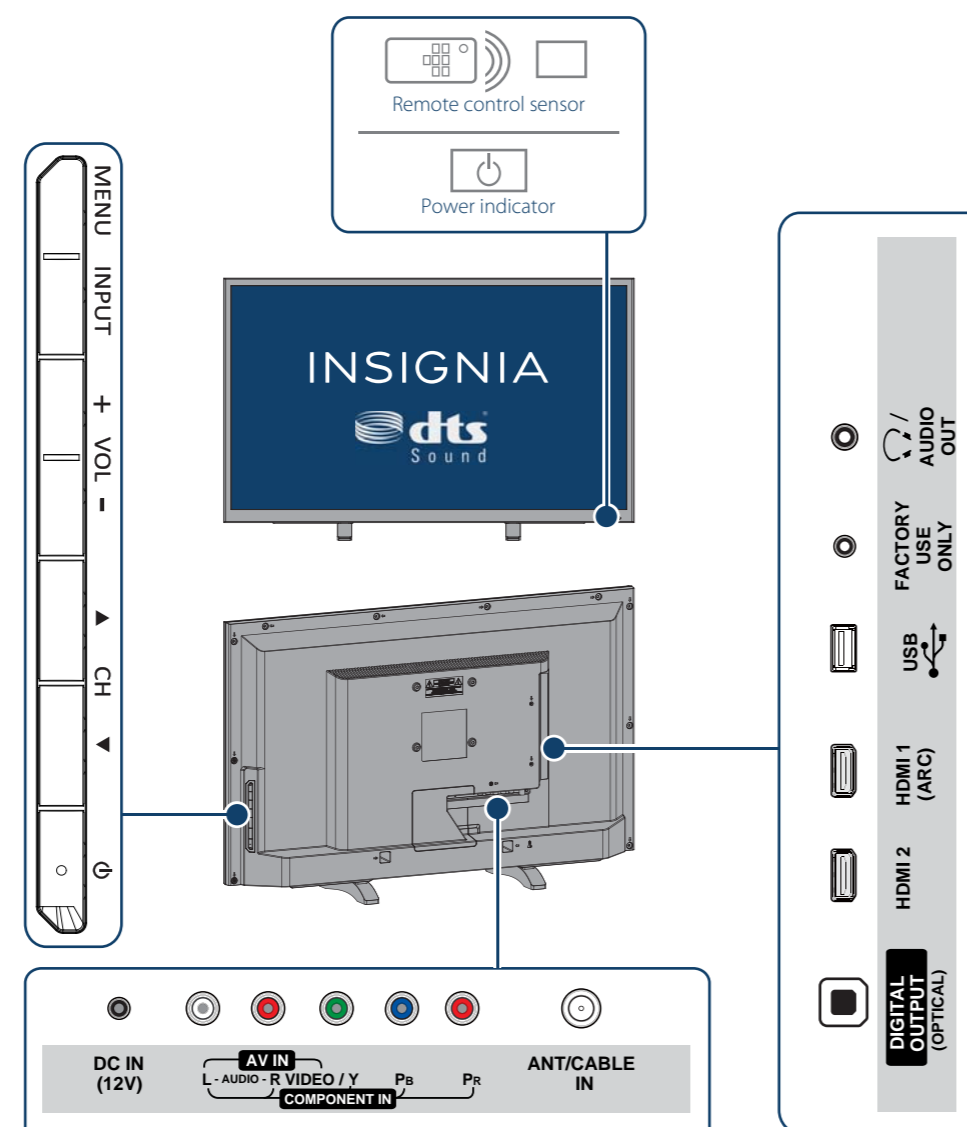

Note: Images do not necessarily represent the exact design of your television.

Before using your new product, please read these instructions to prevent any damage.

2 MAKING CONNECTIONS

How do I watch TV (cable, satellite, or antenna) or connect a device such as a DVD or Blu-ray disc player, game console, or tablet?

WHICH CABLES DO YOU HAVE?

HDMI (BEST)
Best video quality

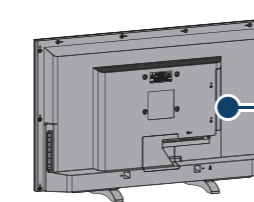

Multi-purpose jacks: You can plug any device that uses HDMI into either HDMI jack. However, certain devices must be connected to the **ARC** jack. See the instructions that came with your ARC device for more information.

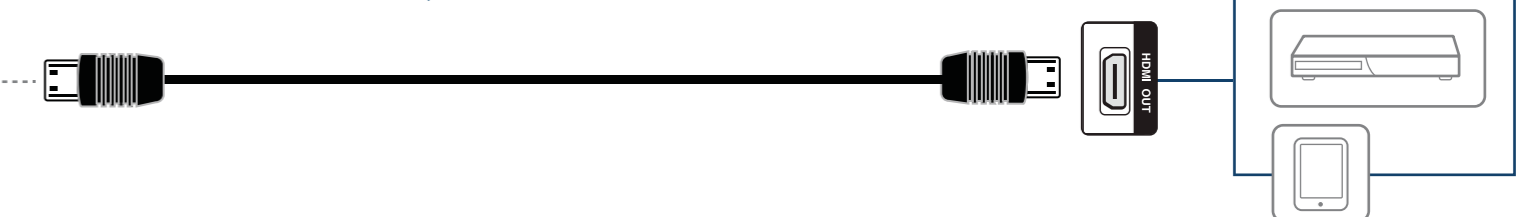

COMPONENT (BETTER)

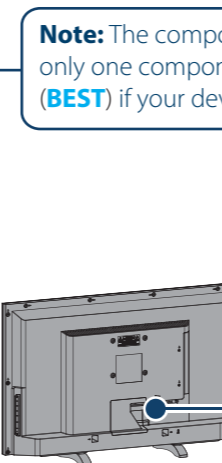
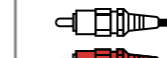
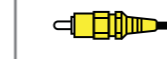
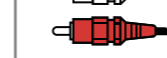
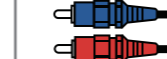
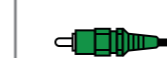

Note: The component and AV jacks are shared. This means you can connect only one component or AV device at a time. We suggest upgrading to HDMI (BEST) if your device supports it.

Note: Connect the yellow video cable to the green VIDEO/Y jack.

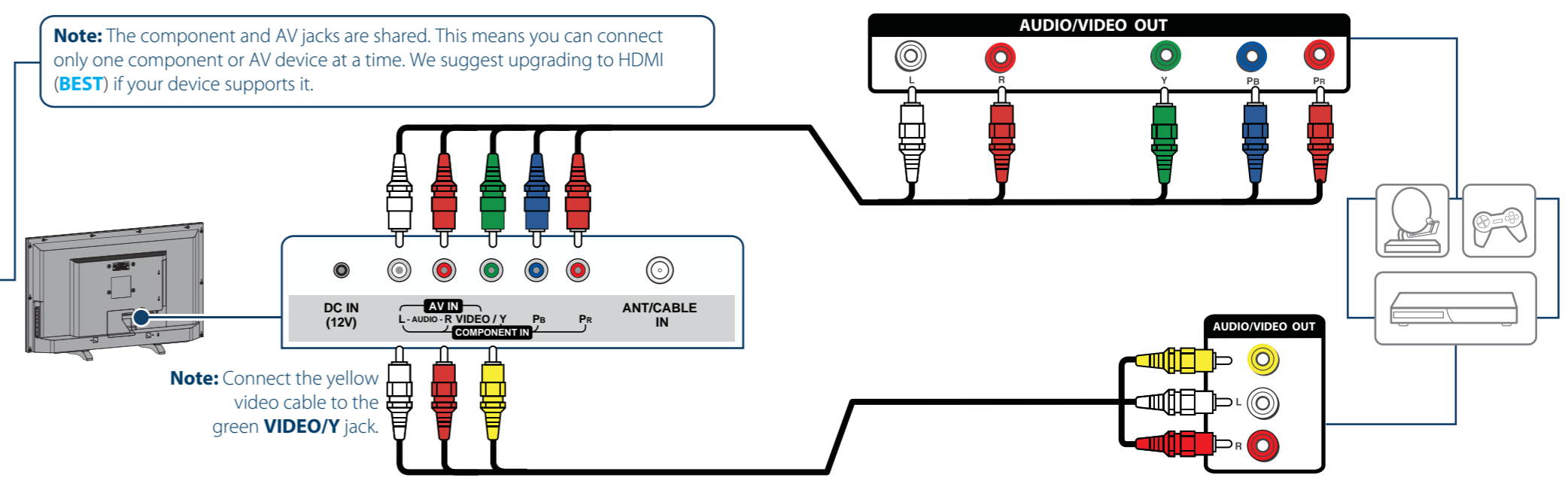

COAXIAL (GOOD)

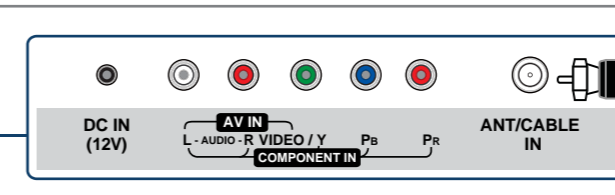
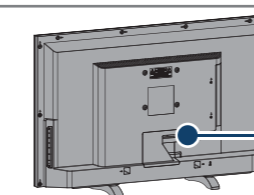

3

CONNECTING AUDIO DEVICES

How do I connect my TV to external speakers?

USING DIGITAL AUDIO

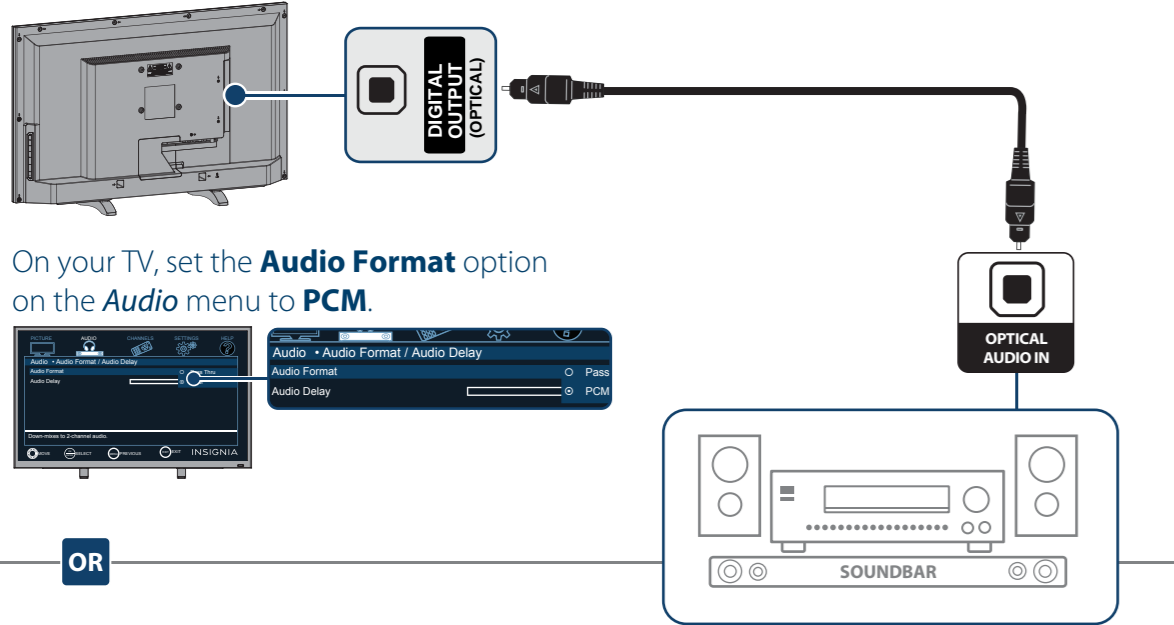

Note: See the instructions that came with your speakers for more information.

USING ANALOG AUDIO

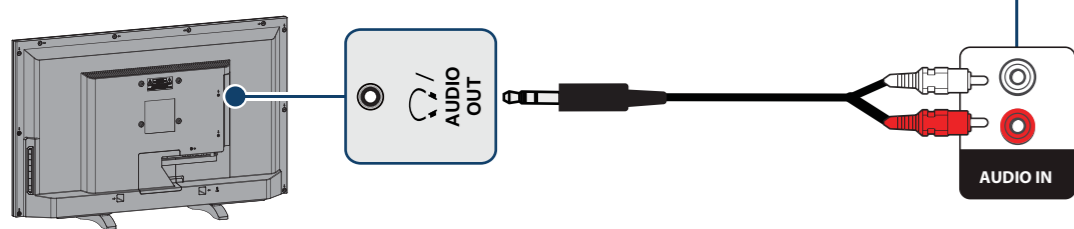

4 TURNING ON MY TV

When can I turn on my TV?

WHEN YOUR TV IS IN PLACE:

- 1 Plug one end of the power cord into the **DC IN** connector on the back of your TV and the other end into a power outlet.

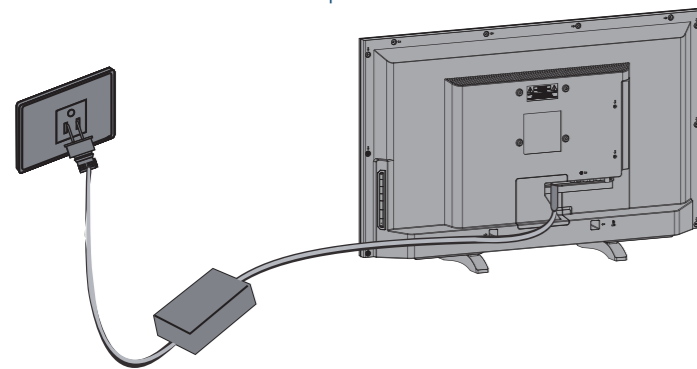

- 2 Remove the remote control cover and install the batteries.

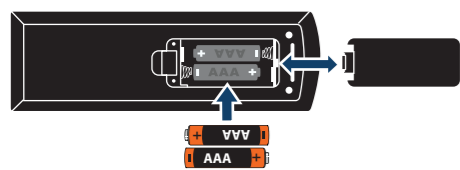

- 3 Press (power) on your remote control.

- 4 Follow the on-screen instructions.

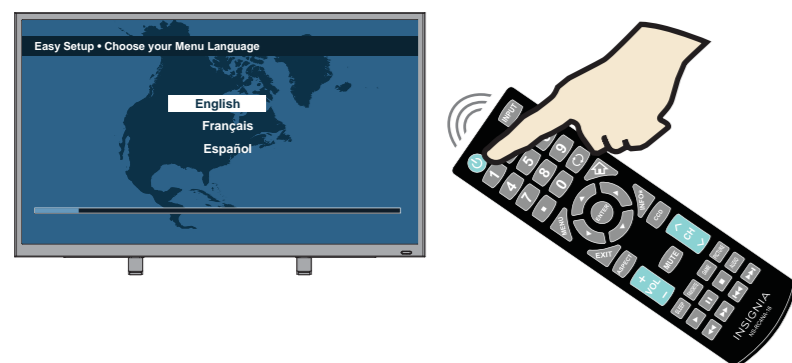

USING YOUR REMOTE CONTROL

INPUT SOURCE

- TV
- HDMI1
- HDMI2
- Component/AV
- USB(Photos)

- Power**: Turns your TV on or off.
- INPUT**: Opens the **INPUT SOURCE** list.
- Recall**: Returns to the previous channel.
- Arrows**: Navigate in TV menus.
- Home**: Opens the TV menus.
- INFO***: Opens a TV status banner.
- CCD**: Turns closed captioning on or off.
- MUTE**: Mutes the sound.
- Channel**: Changes the TV channels.
- Game**: Adjusts the picture for the ultimate gaming experience.
- PICTURE**: Selects the video mode.
- AUDIO**: Selects the audio mode.
- Numbers**: Enter channel numbers.
- MENU**: Opens the TV menu.
- ENTER**: Confirms selections or changes.
- EXIT**: Closes the TV menu.
- ASPECT**: Changes how the picture is displayed on the screen.
- Volume**: Changes the volume.
- FAVORITE**: Opens the Favorite Channel List.
- SLEEP**: Sets the sleep timer.
- Media Controls**: USB: Control the photo slideshow. INlink: Control HDMI-CEC devices connected to your TV.

What are my screen-size options?

- NORMAL**: Original aspect ratio is preserved. You might see black bars if the original content is not widescreen (16:9).
- ZOOM**: Expands the image to fill the screen. The top and bottom of the image may be cropped.
- WIDE**: Use to watch content that was recorded in widescreen (16:9).
- CINEMA**: Stretches the image at the edges, but keeps a clear image in the center.
- AUTO**: Automatically adjusts the image based on the screen size and the TV program. Select this option if you don't know which aspect ratio to choose.

Note: **Auto** is only available when **Auto Aspect Ratio** in the **Channels** menu is set to **On**.

I already have a universal remote control. How do I make it control this TV?

If you already have a universal remote control that you would like to program to work with your TV and don't want to use the included Insignia remote control, see the table for common codes.

UNIVERSAL REMOTE TV CODES	
CABLE BOX, SATELLITE BOX, OR OTHER SET-TOP BOX	
Cablevision	068, 069, 078, 096, 100, 164, 168, 229, 026
Charter	2002, 1204, 1423, 1517, 0171, 1963, 0463, 1463, 0842, 1326, 167, 415, 424, 450, 456, 461, 507, 523, 567, 577, 586
Comcast	10171, 11204, 11326, 11463, 11517, 11641, 11780, 11785, 11892, 11963, 12002
Cox	1326, 1463
Direct TV	10171, 11204, 11326, 11517, 11564, 11641, 11963, 12002
Dish Network	720
Time Warner	400, 450, 461, 456, 10463, 1463, 0463
Tivo	0091
Verizon	0198, 0490
UNIVERSAL REMOTE CONTROLS	
One for All	0054
Philips	0198, 0490
RCA	135
Sony	068, 069, 078, 096, 100, 164, 168, 229, 026



For an up-to-date list of codes for other cable providers and universal remote brands, scan this **QR code** or visit www.insigniaproducts.com/remotecodes

INSIGNIA™

ONE-YEAR LIMITED WARRANTY
Visit www.insigniaproducts.com for details.

NEED ADDITIONAL HELP?
See your online **User Guide!** This comprehensive guide includes everything from basic how-to steps to more advanced features. A copy of your **User Guide** is not provided in the box but is available online. Go to www.insigniaproducts.com, then click **Support & Service**. Enter **NS-32D420NA16** in the box under **Manual, Firmware, Drivers & Product Information**, then click ▶.

Check out our **Support Community** <http://community.insigniaproducts.com/> for helpful information from other Insignia TV owners.

WE'RE HERE FOR YOU
www.insigniaproducts.com
For customer service, call:
877-467-4289 (U.S./Canada)

INSIGNIA is a trademark of Best Buy and its affiliated companies. Registered in some countries. Distributed by Best Buy Purchasing, LLC 7601 Penn Ave South, Richfield, MN 55423 U.S.A. ©2014 Best Buy. All rights reserved. Made in China

Free Manuals Download Website

<http://myh66.com>

<http://usermanuals.us>

<http://www.somanuals.com>

<http://www.4manuals.cc>

<http://www.manual-lib.com>

<http://www.404manual.com>

<http://www.luxmanual.com>

<http://aubethermostatmanual.com>

Golf course search by state

<http://golfingnear.com>

Email search by domain

<http://emailbydomain.com>

Auto manuals search

<http://auto.somanuals.com>

TV manuals search

<http://tv.somanuals.com>