

User Guide

Digital FM Clock Radio with Dock for iPhone5

NS-CLLT01

INSIGNIA™

Insignia NS-CLLT01

Digital FM Clock Radio with Dock for iPhone5

Contents

Introduction	2
Important Safety Instructions.....	3
Features	4
Set up your clock radio	8
Use your clock radio.....	10
Clean your clock radio.....	14
Troubleshooting	14
Specifications	15
Legal notices.....	15
One-year limited warranty - Insignia	17

Introduction

Congratulations on your purchase of high-quality Insignia Digital FM Clock Radio with Dock for iPhone5. This system represents the state of the art in clock radio design and is designed for reliable and trouble-free performance.

This *User Guide* explains how to correctly set up, operate, and get the best performance from your Insignia clock radio. Read this guide carefully before setting up your clock radio, then keep it handy for quick reference.

Important Safety Instructions

Electric shock warning



CAUTION
Risk of Electric Shock
Do Not Open



Warning

To reduce the risk of electric shock, do not remove the cover or back. There are no user-serviceable parts inside. Refer servicing to qualified service personnel.



This lightning flash with arrowhead symbol within an equilateral triangle is intended to alert the user to the presence of uninsulated dangerous voltage within your clock radio's enclosure that may be of sufficient magnitude to constitute a risk of electric shock to persons.



The exclamation point within an equilateral triangle is intended to alert the user to the presence of important operating and maintenance (servicing) instructions in the literature accompanying your clock radio.

- Read these instructions.
- Keep these instructions.
- Heed all warnings.
- Follow all instructions.
- Do not use this apparatus near water.
- Clean only with a dry cloth.
- Do not install near any heat sources such as radiators, heat registers, stoves, or other apparatus (including amplifiers) that produce heat.
- Do not defeat the safety purpose of the polarized or grounding-type plug. A polarized plug has two blades with one wider than the other. A grounding type plug has two blades and a third grounding prong. The wide blade or the third prong is provided for your safety. If the provided plug does not fit into your outlet, consult an electrician for replacement of the obsolete outlet.
- Protect the power cord from being walked on or pinched particularly at plugs, convenience receptacles, and the point where they exit from the apparatus.
- Only use attachments or accessories specified by the manufacturer.
- Unplug this system during lightning storms or when unused for long periods of time.

- Refer all servicing to qualified service personnel. Servicing is required when the system has been damaged in any way, such as power-supply cord or plug is damaged, liquid has been spilled or objects have fallen into the system, the system has been exposed to rain or moisture, does not operate normally, or has been dropped.
- To reduce the risk of fire or electric shock, do not expose this system to rain or moisture.
- The shock hazard marking and associated graphical symbol are provided on the supplied AC adapter.
- The system shall not be exposed to dripping or splashing and objects filled with liquids should not be placed on the system.
- The AC plug or AC adapter is used as the disconnect device. The disconnect device shall remain readily available.
- Batteries (battery pack and batteries installed) should not be exposed to excessive heat such as sunshine or fire.

Features

Package contents

Your clock radio includes the following items:

- Clock radio with dock for iPhone5® (iPhone is not included)
- AC adapter
- "AA" batteries (2)
- *User Guide*

LCD Front Panel display

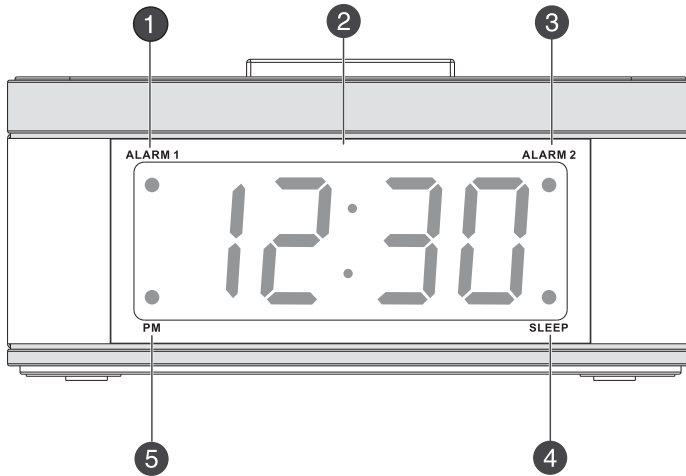

#	Item	Description
1	ALARM 1 indicator	When lit, indicates that alarm 1 is set.
2	TIME/ALARM display	In standby mode, shows the current time. In radio mode, shows the current frequency.
3	ALARM 2 indicator	When lit, indicates that alarm 2 is set.
4	SLEEP indicator	When lit, indicates that the sleep timer is set.
5	PM indicator	When lit, indicates that time shown on display is PM.

INSIGNIA™

Top panel

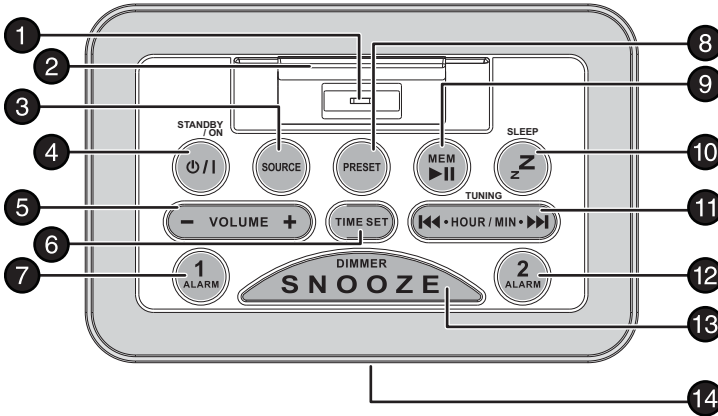

#	Item	Description
1	Lightning connector	Connect your iPhone here to listen to it on the clock radio speakers.
2	iPhone® docking pad	Holds your iPhone while it's connected to the clock radio.
3	SOURCE button	Press repeatedly to cycle through the available sound sources (FM(rAd, iPhone(doc), and AUX IN(Au.).
4	⏻/ (STANDBY/ON) button	In alarm mode, press to silence the alarm for 24 hours. In radio mode, press to turn the radio on or off.
5	VOLUME +/- button	Press to increase or decrease volume.
6	TIME SET button	Press to set the time.
7	ALARM 1 button	Press to set Alarm 1. The Alarm 1 indicator lights.
8	PRESET button	When presetting stations, press to select the preset number. When listening to the radio, press to select a preset station.
9	▶ (play/pause)/ MEM (memory) button	During iPhone playback, press to pause playback. Press again to resume playback. When presetting FM stations, press to memorize a station.
10	SLEEP button	Press to set the sleep timer. You can select 90, 60, 45, 30, 15 , or OFF . The time appears on the display.
11	◀◀ - HOUR/MIN - ▶▶ TUNING button	In time set mode, press to set the hours and minutes. In FM mode, press to tune the radio to the next or previous station. Press and hold to search for a station. In iPhone mode, press to skip to the next or previous track. Press and hold to go to a specific point on a track.
12	ALARM 2 button	Press to set Alarm 2. The Alarm 2 indicator lights.
13	SNOOZE/DIMMER button	When the alarm sounds, press to mute the alarm for nine minutes. Press and hold to adjust the display brightness.
14	LCD display	Shows the time, radio station, and indicator lights.

Back panel

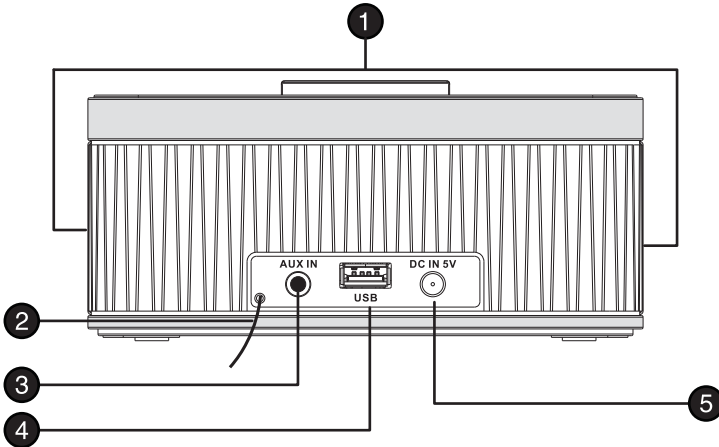

#	Item	Description
1	Stereo speakers	Provide sound for playback.
2	FM antenna wire	Improves FM radio reception.
3	AUX IN jack	Plug an external sound source, such as an MP3 player, into this connector using a 3.5mm plug.
4	USB jack	Plug a USB device into this connector to charge it (use for charging only - Max. 500 mA).
5	DC IN 5V jack	Plug the AC adapter into this connector.

Set up your clock radio

Install the backup batteries

The clock radio uses a backup battery system to provide continuous alarm operation and clock settings in the event of a power failure. If the backup batteries have been installed and a power failure occurs or the AC cord is accidentally disconnected, the display will not remain lit, but the current time and alarm time settings will be temporarily maintained. Otherwise, you must reset the time and alarm settings.

Make sure that the AC cord is connected. Otherwise all settings may be lost during battery replacement.

- 1 Turn your clock radio over so the bottom is facing up, then open the battery compartment cover located on the bottom of your clock radio by inserting your fingernail and lifting up on the cover.

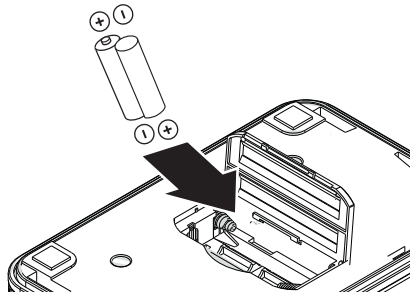

- 2 Insert two "AA" batteries (included) into the battery compartment. Make sure that the + and – symbols on the batteries align with the + and – symbols inside the battery compartment.
- 3 Close the battery compartment.

Caution

- Do not recharge, short, disassemble, or heat the batteries, or dispose of in a fire.
- Dispose of batteries in the proper manner, according to federal, state, and local regulations.
- Remove the batteries when the charge is depleted or if your clock radio will be left unplugged for an extended period.
- Battery chemicals can cause a rash. If the batteries leak, clean the battery compartment with a cloth. If chemicals touch your skin, wash immediately.
- Do not use a mixture of old and new batteries.
- Do not mix alkaline, standard (carbon-zinc), and rechargeable batteries.

Connect the AC adapter

Make sure that the AC power outlet matches the AC adapter's power specifications (120 V ~ 60 Hz) prior to plugging in the adapter.

- 1 Plug the small DC power connector into the **DC IN 5V** jack on the back of your clock radio.

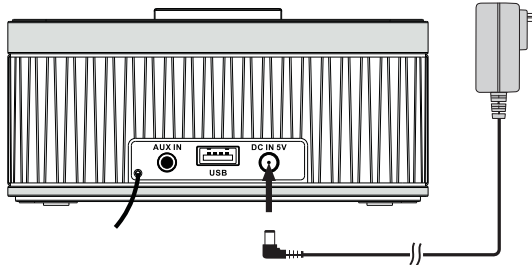

- 2 Plug the other end of the AC power adapter into a power outlet.

Set the clock

- 1 In standby mode (the time is shown on the display), press and hold the **TIME SET** button on the top of your clock radio for three seconds. The hour and minutes digits blink.

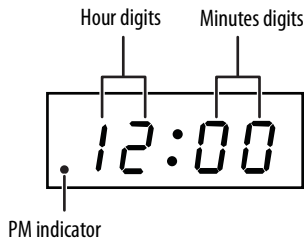

- 2 Press the **⏪ - HOUR** button to set the correct hour.
- 3 Press the **MIN - ⏩** button to set the correct minutes.
- 4 Press the **TIME SET** button to confirm.

Use your clock radio

Before using your clock radio, make sure that all connections are secure, then plug the AC adapter into your clock radio and an AC power outlet.

Turn your clock radio on and off

- 1 Press ⏻/⏮ (STANDBY/ON). Your clock radio turns on.
- 2 Press the **SNOOZE/DIMMER** button repeatedly to cycle through the available brightness levels (high, medium, and low) of the LCD.
- 3 Press ⏻/⏮ (STANDBY/ON) again to switch your clock radio to standby mode.

Set and use the alarm

Note

- Your clock radio must be in standby mode to set the alarm.
- Your clock radio can be set to activate twice a day by setting different times in ALARM 1 and ALARM 2.

- 1 Press and hold the **ALARM 1** or **ALARM 2** button. The "ALARM 1" or "ALARM 2" indicator and the hours and minutes digits start to blink.

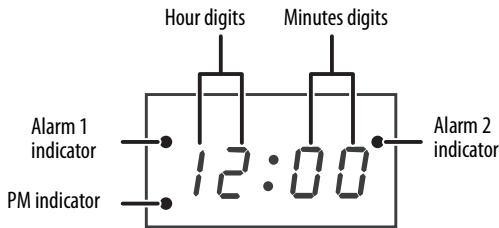

- 2 Press the ⏮ - **HOUR** button to set the hour.
- 3 Press the **MIN** - ⏭ button to set the minutes.
- 4 Press the **VOLUME +/-** button to set the volume of the alarm.
- 5 Press the **SOURCE** button to set the alarm to wake to radio (rAd), iPhone (doc), or Buzzer (bU).
- 6 Press **ALARM 1** or **ALARM 2** to confirm and save the alarm settings. The alarm indicator lights.

Mute, turn off, or cancel the alarm

- 1 Press the **SNOOZE/DIMMER** button to mute the alarm for nine minutes.

- 2 Press any button (except **SNOOZE**) to turn the alarm off for 24 hours.
- 3 Press **ALARM 1** or **ALARM 2** to deactivate the alarm. The alarm indicator on the display goes off.

Use the sleep timer

- 1 When listening to the radio or your iPhone®, press the **SLEEP** button repeatedly to set the sleep timer. Settings include **90, 60, 45, 30, 15** minutes, or **OFF**. The radio or iPhone® automatically turns off after the specified amount of time.
- 2 To stop listening at any time, press the $\odot/|$ (STANDBY/ON) button.

Play the radio

- 1 Press the $\odot/|$ (STANDBY/ON) button to turn on your clock radio, then press the **SOURCE** button repeatedly to select **FM** (rAd).
- 2 Stretch out the FM antenna on the back of your clock radio and move it around to improve reception.
- 3 Press **◀◀ - HOUR** or **MIN - ▶▶** to tune the radio to a higher or lower frequency.
- 4 Press and hold **◀◀ - HOUR** or **MIN - ▶▶** to search for the next available higher or lower station.

Note

The search may not stop at a station with a very weak signal.

- 5 Press the **VOLUME +/-** buttons to increase or decrease the volume. Adjust the volume to a comfortable level.
- 6 Press the $\odot/|$ (STANDBY/ON) button to turn off your clock radio.

Use radio station presets

Your clock radio can store 10 station presets.

- 1 Turn on your clock radio, then press the **SOURCE** button repeatedly to select **FM** (rAd).
- 2 Briefly press **◀◀ - HOUR** or **MIN - ▶▶** to tune the clock radio to the next lower or higher frequency, or press and hold (until the display changes) **◀◀ - HOUR** or **MIN - ▶▶** to tune the clock radio to the next lower or higher station you want to save.
- 3 Press **▶||** (play/pause)/**MEM** (memory) button. The preset number flashes.
- 4 Press the **PRESET** button to select the preset number you want.

- 5 Press **▶||** (play/pause)/**MEM** (memory) button again to store the station as a preset.
- 6 Repeat steps 1 through 5 to save additional stations as presets.

Recall radio station presets

- 1 Turn on your clock radio, then press the **SOURCE** button repeatedly to select **FM** (rAd).
- 2 Press the **PRESET** button repeatedly to select the preset station you want.

Listen to an external sound source

You can listen to an external sound source, such as a CD, MP3 player, or an iPhone®, Android, or Windows phone on your clock radio.

Listen to an iPhone® (iPhone® 5, iPhone® 5s, or iPhone® 5c)

- 1 Make sure that your clock radio is turned off.
- 2 Carefully connect your iPhone® to the lightning connector in the iPhone® dock (you may need to remove your iPhone case or skin). Make sure that the connector plug is firmly inserted into the connector port of your iPhone®.

Notes

- Always set the volume to the minimum when connecting or disconnecting other equipment.
- Both your player and the clock radio have volume controls, both should be set to a comfortable listening level (if either is set too low you won't be able to hear your music).
- When you connect your iPhone® to your clock radio, make sure that you insert it all the way.
- Refer to the User Guide that came with your iPhone® for additional information.

- 3 Press the **⏻/|** (Standby/On) button to turn on your clock radio.
- 4 Press the **SOURCE** button repeatedly to select an iPhone® (**doc**). Your iPhone® starts playback automatically.
 - Press the **▶||** (play/pause)/**MEM** (memory) button to pause playback, then press it again to resume playback.
 - Press the **VOLUME +/-** buttons on the clock radio to adjust the system volume.
 - Press the **◀◀ - HOUR or MIN - ▶▶** button to go to the next or previous track.
 - Press and hold the **◀◀ - HOUR or MIN - ▶▶** button to locate a specific point on a track.

- 5 Press the $\odot/|$ (STANDBY/ON) button to turn your clock radio off. The iPhone® will continue charging while in the dock.

Charge your iPhone®

The iPhone® charged while it is docked and your clock radio is powered on.

- Make sure that the AC adapter is connected to your clock radio.
- The iPhone® is charged regardless of the sound source selected on your clock radio.

Note

- Do not carry the clock radio with your iPhone® connected. You might drop it and damage the connector.
- Do not touch or hit the iPhone® terminal pins or the connector pins directly. It might cause damage to the connector.
- If the iPhone® does not play correctly, update your iPhone® software to the latest version. For details about updating your iPhone®, check on the Apple web site: <<http://www.apple.com>>.
- iPhone® is a trademark of Apple Inc., registered in the U.S. and other countries.
- Lightning® is a trademark of Apple Inc.
- Insignia is not responsible for any loss of or damage to your iPhone® that might result from the use of this product.

Listen to a CD or MP3 player

- 1 Make sure that your clock radio is turned off.
- 2 Connect the external sound source to the **AUX IN** jack on the back of your clock radio using a 3.5 mm audio cable (not included).
- 3 Press the $\odot/|$ (STANDBY/ON) button to turn on your clock radio.
- 4 Press the **SOURCE** button repeatedly to select **AUX IN** (Au.).
- 5 Start playback on the external sound source, then adjust the volume to a comfortable level.
- 6 Use your external sound source to control playback.

Clean your clock radio

- Use a soft, dry, clean cloth to clean the exterior of your clock radio.
- Do not let liquid drip into the inside of your clock radio.
- For stubborn stains, use a soft cloth dampened with a weak solution of mild detergent and water. Dry your clock radio immediately afterwards with a clean cloth. Do not use abrasive clothes, thinners, alcohol, or other chemical solvents, because they may damage the finish or remove the panel lettering.

Troubleshooting

Problem	Cause/Solution
No power	<ul style="list-style-type: none"> • Make sure the AC power adapter is connected securely and correctly to your clock radio and the power outlet. • Make sure that the power outlet is working.
Cannot play an iPhone®	<ul style="list-style-type: none"> • Make sure that the iPhone® is firmly connected to the lightning connector on your clock radio. • Make sure that the iPhone® is working. Test it before trying to connect it to the clock radio. • Make sure that the firmware in your iPhone® is current. For more information, go to www.apple.com. • Try turning up the volume. If either the clock radio or the iPhone is set to minimum volume, you may not be able to hear your music.
Cannot charge an iPhone®	<ul style="list-style-type: none"> • Make sure that the iPhone® is firmly connected to the lightning connector on your clock radio. • Make sure the AC power adapter is connected securely and correctly to your clock radio and the power outlet.
No sound from the speakers	<ul style="list-style-type: none"> • Use the VOLUME +/- button to increase the volume. • If you are using an external sound source, turn up the volume on the playback device. • Make sure that the correct sound source has been selected. • Make sure that the AC power adapter is connected securely and correctly to your clock radio and the power outlet. • Make sure that your clock radio is turned ON.
Static or noise when playing the radio	<ul style="list-style-type: none"> • Make sure that the station is tuned correctly and that the station has a good signal. • Try another station. • Extend the antenna wire to improve the reception.
The sound is distorted	<ul style="list-style-type: none"> • Make sure that the volume level is not set too high. • If you are using an external sound source, make sure that the material on the sound source is not distorted. Try a different external sound source. • Make sure that the station is tuned correctly and that the station has a good signal.
The clock radio gets warm after extended play at high volume levels	<ul style="list-style-type: none"> • Turn down the volume.

Specifications

Specifications are subject to change without notice.

Power requirement	5V DC, 2.0 A
Power consumption	Max. 7 W - Standby <1W
Dimensions	2.9 x 6.5 x 4.2 in. (7.3 x 16.5 x 10.7 cm)
Tuner	Band: FM Range: FM - 87.5~107.9 MHz Presets: 10
Speaker	8 ohm
Speaker output	1 W x 2
AUX input sensitivity	750 mV

Legal notices

FCC Information:

This device complies with Part 15 of the FCC Rules. Operation is subject to the following two conditions: (1) this device may not cause harmful interference, and (2) this device must accept any interference received, including interference that may cause undesired operation.

Note: This equipment has been tested and found to comply with the limits for a Class B digital device, pursuant to Part 15 of the FCC Rules. These limits are designed to provide reasonable protection against harmful interference in a residential installation. This equipment generates, uses and can radiate radio frequency energy and, if not installed and used in accordance with the instructions, maybe cause harmful interference to radio communications. However, there is no guarantee that interference will not occur in a particular installation. If this equipment does cause harmful interference to radio or television reception, which can be determined by turning the equipment off and on, the user is encouraged to try to correct the interference by one or more of the following measures:

- Reorient or relocate the receiving antenna.
- Increase the separation between the equipment and receiver.
- Connect the equipment into an outlet on a circuit different from that to which the receiver is connected.
- Consult the dealer or an experienced radio/TV technician for help.

Warning: Changes or modifications not expressly approved by the party responsible for compliance could void the user's authority to operate this equipment.

IC Information:

CAN ICES-3 (B)/NMB-3 (B)

European Union

Note

This symbol is only valid in the European Union.



This symbol indicates that the electrical and electronic equipment should not be disposed as general household waste at its end-of-life. Instead, the product should be handed over to the applicable collection point for the recycling in accordance with your national legislation.

By disposing of this product correctly, you will help to conserve natural resources and will help prevent potential negative effects on the environment and human health that could otherwise be caused by inappropriate waste handling of this product. For more information about collection point and recycling of this product, please contact your local municipal office, your household waste disposal service or the shop where you purchased the product.

Penalties may be applicable for incorrect disposal of this waste, in accordance with national legislation.

Other Countries Outside the European Union

If you wish to dispose of this product, please do so in accordance with applicable national legislation or other rules in your country for the treatment of old electrical and electronic equipment.

One-year limited warranty - Insignia

Definitions:

The Distributor* of Insignia branded products warrants to you, the original purchaser of this new Insignia-branded product ("Product"), that the Product shall be free of defects in the original manufacturer of the material or workmanship for a period of one (1) year from the date of your purchase of the Product ("Warranty Period").

For this warranty to apply, your Product must be purchased in the United States or Canada from a Best Buy branded or Future Shop branded retail store or online at www.bestbuy.com, www.bestbuy.ca, or www.futureshop.ca and is packaged with this warranty statement.

How long does the coverage last?

The Warranty Period lasts for one year (365 days) from the date you purchased the Product. Your purchase date is printed on the receipt you received with the Product.

What does this warranty cover?

During the Warranty Period, if the original manufacture of the material or workmanship of the Product is determined to be defective by an authorized Insignia repair center or store personnel, Insignia will (at its sole option): (1) repair the Product with new or rebuilt parts; or (2) replace the Product at no charge with new or rebuilt comparable products or parts. Products and parts replaced under this warranty become the property of Insignia and are not returned to you. If service of Products or parts are required after the Warranty Period expires, you must pay all labor and parts charges. This warranty lasts as long as you own your Insignia Product during the Warranty Period. Warranty coverage terminates if you sell or otherwise transfer the Product.

How to obtain warranty service?

If you purchased the Product at a Best Buy or Future Shop retail store location, please take your original receipt and the Product to any Best Buy or Future Shop store. Make sure that you place the Product in its original packaging or packaging that provides the same amount of protection as the original packaging. If you purchased the Product from a Best Buy or Future Shop online web site (www.bestbuy.com, www.bestbuy.ca, or www.futureshop.ca), mail your original receipt and the Product to the address listed on the web site. Make sure that you put the Product in its original packaging or packaging that provides the same amount of protection as the original packaging.

To obtain warranty service, in the United States call 1-888-BESTBUY, Canada call 1-866-BESTBUY for Future Shop call 1-800-663-2275. Call agents may diagnose and correct the issue over the phone.

Where is the warranty valid?

This warranty is valid only in the United States and Canada at Best Buy or Future Shop branded retail stores or websites to the original purchaser of the product in the county where the original purchase was made.

What does the warranty not cover?

This warranty does not cover:

- Customer instruction/education
- Installation
- Set up adjustments
- Cosmetic damage
- Damage due to weather, lightning, and other acts of God, such as power surges
- Accidental damage
- Misuse
- Abuse

- Negligence
- Commercial purposes/use, including but not limited to use in a place of business or in communal areas of a multiple dwelling condominium or apartment complex, or otherwise used in a place of other than a private home.
- Modification of any part of the Product, including the antenna
- Display panel damaged by static (non-moving) images applied for lengthy periods (burn-in).
- Damage due to incorrect operation or maintenance
- Connection to an incorrect voltage or power supply
- Attempted repair by any person not authorized by Insignia to service the Product
- Products sold "as is" or "with all faults"
- Consumables, including but not limited to batteries (i.e. AA, AAA, C etc.)
- Products where the factory applied serial number has been altered or removed
- Loss or Theft of this product or any part of the product
- Display panels containing up to three (3) pixel failures (dots that are dark or incorrectly illuminated) grouped in an area smaller than one tenth (1/10) of the display size or up to five (5) pixel failures throughout the display. (Pixel based displays may contain a limited number of pixels that may not function normally.)
- Failures or Damage caused by any contact including but not limited to liquids, gels or pastes.

REPAIR OR REPLACEMENT AS PROVIDED UNDER THIS WARRANTY IS YOUR EXCLUSIVE REMEDY FOR BREACH OF WARRANTY. INSIGNIA SHALL NOT BE LIABLE FOR ANY INCIDENTAL OR CONSEQUENTIAL DAMAGES FOR THE BREACH OF ANY EXPRESS OR IMPLIED WARRANTY ON THIS PRODUCT, INCLUDING, BUT NOT LIMITED TO, LOST DATA, LOSS OF USE OF YOUR PRODUCT, LOST BUSINESS OR LOST PROFITS. INSIGNIA PRODUCTS MAKES NO OTHER EXPRESS WARRANTIES WITH RESPECT TO THE PRODUCT, ALL EXPRESS AND IMPLIED WARRANTIES FOR THE PRODUCT, INCLUDING, BUT NOT LIMITED TO, ANY IMPLIED WARRANTIES OF AND CONDITIONS OF MERCHANTABILITY AND FITNESS FOR A PARTICULAR PURPOSE, ARE LIMITED IN DURATION TO THE WARRANTY PERIOD SET FORTH ABOVE AND NO WARRANTIES, WHETHER EXPRESS OR IMPLIED, WILL APPLY AFTER THE WARRANTY PERIOD. SOME STATES, PROVINCES AND JURISDICTIONS DO NOT ALLOW LIMITATIONS ON HOW LONG AN IMPLIED WARRANTY LASTS, SO THE ABOVE LIMITATION MAY NOT APPLY TO YOU. THIS WARRANTY GIVES YOU SPECIFIC LEGAL RIGHTS, AND YOU MAY ALSO HAVE OTHER RIGHTS, WHICH VARY FROM STATE TO STATE OR PROVINCE TO PROVINCE.

Contact Insignia:

For customer service please call 1-877-467-4289

www.insigniaproducts.com

INSIGNIA is a trademark of Best Buy and its affiliated companies.

Registered in some countries.

Distributed by Best Buy Purchasing, LLC

7601 Penn Ave South, Richfield, MN 55423 U.S.A.

©2014 Best Buy. All rights reserved.

Made in China

INSIGNIA™

INSIGNIA is a trademark of Best Buy and its affiliated companies.

Registered in some countries.

Distributed by Best Buy Purchasing, LLC

7601 Penn Ave South, Richfield, MN 55423 U.S.A.

©2014 Best Buy. All rights reserved.

Made in China

1-877-467-4289 (U.S. and Canada) or 01-800-926-3000 (Mexico)

www.insigniaproducts.com

V4 ENGLISH
14-0316

Free Manuals Download Website

<http://myh66.com>

<http://usermanuals.us>

<http://www.somanuals.com>

<http://www.4manuals.cc>

<http://www.manual-lib.com>

<http://www.404manual.com>

<http://www.luxmanual.com>

<http://aubethermostatmanual.com>

Golf course search by state

<http://golfingnear.com>

Email search by domain

<http://emailbydomain.com>

Auto manuals search

<http://auto.somanuals.com>

TV manuals search

<http://tv.somanuals.com>