



Animal Clippers ZTS 10 B1



 **Animal Clippers**
 Operating instructions

KOMPERNASS GMBH
BURGSTRASSE 21 · D-44867 BOCHUM
www.kompernass.com
ID-Nr.: ZTS 10 B1-01/11-V2
IAN:63807

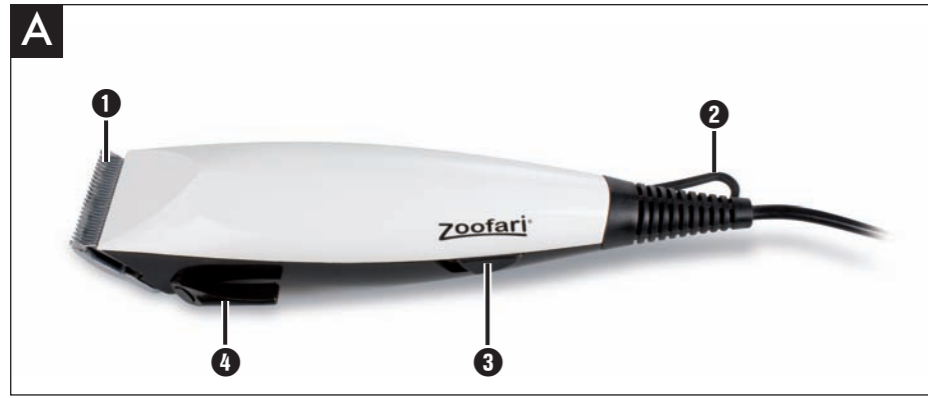

Read these operating instructions carefully before using this appliance for the first time and preserve this booklet for later reference. Pass this booklet on to whoever might acquire the appliance at a later date.

Animal Clippers

Intended use

These animal clippers are intended exclusively for the cutting and trimming of animal hair in domestic households. This appliance is not intended for use in commercial/industrial applications. Usage other than as described here is not permitted and may cause damage or injury. For damage resulting from misuse or improper handling, the use of force or unauthorized modification, no liability will be assumed.

Safety instructions

To avoid the risk of accidents and injuries:

- This appliance is not intended for use by individuals (including children) with restricted physical, physiological or intellectual abilities or deficiencies in experience and/or knowledge unless they are supervised by a person responsible for their safety or receive from this person instruction in how the appliance is to be used.
- Children should be supervised to ensure that they do not play with the appliance.
- Use only the original accessory parts for this device.
- Check the cutting head for proper function before using the appliance.
- Never use the appliance with a damaged or broken trimming guide. The absence of teeth on the trimming guide can lead to injury.
- Switch the appliance off before you put it down.

To avoid the risk of an electric shock:

- Connect the appliance only to correctly installed and earthed mains sockets that are easily accessible. Ensure that the rating of the local power supply tallies completely with the details given on the rating plate of the device.
- Ensure that the power cable does not become damaged. Protect the power cable from sources of heat and ensure that it cannot be damaged.
- To avoid risks, arrange for defective plugs and/or cables to be replaced at once by qualified technicians or our Customer Service Department.
- Do not use the appliance in the close vicinity of a bath/shower or a sink filled with water. The proximity of moisture presents a danger, even when the appliance is switched off.
- NEVER submerge the appliance in water or other liquids.
- Should the appliance be dropped into water, ABSOLUTELY disconnect the plug from the mains socket before extracting the appliance.
- After use or when cleaning it, ALWAYS remove the plug from the mains power socket. Do not pull on the power cable directly, pull the plug.
- The appliance is suitable for use only in dry areas.
- Attention! Keep the appliance dry.
- Do not use the unit while the animal is being bathed or when the fur is wet.

Items supplied

Animal clippers with blade guard
6 Trimming guides
Cleaning brush
Blade oil
This operating manual

Technical Data

Power supply:	230 V~/50 Hz
Power consumption:	10 W
Protection class:	II/□
Operating temperature:	+5 °C.-+40 °C
Storage temperature:	0 °C.-+40 °C

CE- Conformity

This device complies, in regards to conformance with the basic requirements and other relevant regulations, with the EMC Directive 2004/108/EC, as well as the Directive for Low Voltage Devices 2006/95/EC.

Description of the appliance

Appliance (Fig. A)

- ❶ Cutting head
- ❷ Suspension loop
- ❸ On/Off switch
- ❹ Adjusting lever

Trimming guides and accessories (Fig. B)

- ❶ 1/8" (3 mm Cutting length)
- ❷ 1/4" (6 mm Cutting length)
- ❸ 3/8" (9 mm Cutting length)
- ❹ 1/2" (13 mm Cutting length)
- ❺ Trimming guide for side step cut (right)
- ❻ Trimming guide for side step cut (left)
- ❼ Blade cover
- ❽ Cleaning brush
- ❾ Blade oil

Operation

The fur to be cut must be dry and clean. Brush the fur through to remove any knots.

- Remove the blade guard ❷ from the cutting head ❶.
- Place the required trimming guide (❶ - ❻) with the prongs facing upwards on the cutting head ❶ and thereby press the flap of the trimming guide down firmly onto the lower metal edge of the cutting head (see illustration).

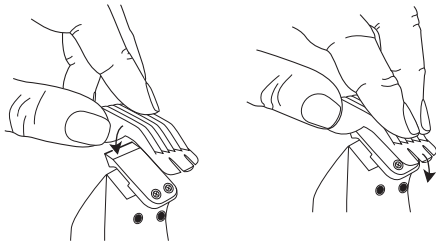

- Ensure that the trimming guide has properly engaged and is secured before starting to cut/trim the fur.

ⓘ Note:

It is recommended that you begin by trimming a small area to test the individual trimming guides. Start with a trimming guide for long fur and, if necessary, change to a shorter one. The trimming guides allow an average cutting length from 3-13 mm.

- Switch the appliance on by sliding the On/Off switch ❸ to the position „ON“.
- Slowly run the appliance through the fur against the direction of hair growth. Hold the appliance so that the trimming guide is as flat as possible against the animal.
- Additionally, using the adjusting lever ❹, the cutting depth of the cutting head ❶ can be adjusted stepwise (approx. 2 mm) without changing the trimming guide. To do this, press the adjusting lever ❹ backwards to increase the cutting length in steps. Through this, the cutting length of the respective attached trimming guide will also be increased by up to 2 mm. Press the adjusting lever ❹ forwards to reduce the cutting length or to bring the trimming guide back into its original position.
- Through removal of the individual trimming guide, i.e. using only the cutting head ❶ itself, you can cut clean contours.
- After use, switch the appliance off by sliding the On/Off switch ❸ to the position „OFF“.

Cleaning and Care

⚠ Risk of electric shock

Before cleaning, remove the plug from the mains power socket.

NEVER submerge the appliance in water or other liquids.

- Take the respective trimming guide, if fitted, off.
- Using exclusively the cleaning brush ❽, remove the hairs from the cutting head ❶. The cutting head ❶ may not be cleaned with water or other liquids, except medical alcohol!
- If in regular use, the cutting head ❶ should be oiled occasionally. For this, use the supplied blade oil ❾.
- Remove excess oil with a dry cloth.
- Clean the housing with a soft, dry lint-free cloth.
- Store the appliance in a dry and dust free location. When it is in storage, place the blade guard ❷ on the cutting head ❶.

Disposal



Do not dispose of the device in your normal domestic waste. This product is subject to the provisions of European Directive 2002/96/EC.

Dispose of the appliance over a registered waste disposal firm or at your local community waste disposal facility. Observe the currently applicable regulations. In case of doubt, please contact your waste disposal centre.



Dispose of all packaging materials in an environmentally friendly manner.

Warranty and Service

You receive a 3-year warranty for this device as of the purchase date. This appliance has been manufactured with care and meticulously examined before delivery.

Please retain your receipt as proof of purchase.

In the case of a warranty claim, please make contact by telephone with our service department.

Only in this way can a post-free despatch for your goods be assured.

The warranty covers only claims for material and manufacturing defects, not for transport damage, worn parts or for damage to fragile components, e.g. switches or batteries. This product is for private use only and is not intended for commercial applications.

In the event of misuse and improper handling, use of force and interference not carried out by our authorized service branch, the warranty will become void.

Your statutory rights are not restricted in any way by this warranty.

The warranty period is not extended by repairs effected under warranty. This applies also to replaced and repaired parts. Damages or defects discovered after purchase are to be reported directly after unpacking, at the latest two days after the purchase date. Repairs carried out after lapse of the warranty period are subject to charge.

(GB) Service Great Britain

Tel.: 0871 5000 720 (£ 0.10 / minute)

E-Mail: kompernass@lidl.gb

(IE) Service Ireland

Tel: 1890 930 034

(0,082 EUR/Min., (peak))

(0,064 EUR/Min., (off peak))

E-Mail: kompernass@lidl.ie

Importer

KOMPERNASS GMBH
BURGSTRASSE 21
44867 BOCHUM, GERMANY

www.kompernass.com

Free Manuals Download Website

<http://myh66.com>

<http://usermanuals.us>

<http://www.somanuals.com>

<http://www.4manuals.cc>

<http://www.manual-lib.com>

<http://www.404manual.com>

<http://www.luxmanual.com>

<http://aubethermostatmanual.com>

Golf course search by state

<http://golfingnear.com>

Email search by domain

<http://emailbydomain.com>

Auto manuals search

<http://auto.somanuals.com>

TV manuals search

<http://tv.somanuals.com>