



KONICA MINOLTA

magicolor 4690MF

Quick Guide

1760616-001A

A0FD-9605-00

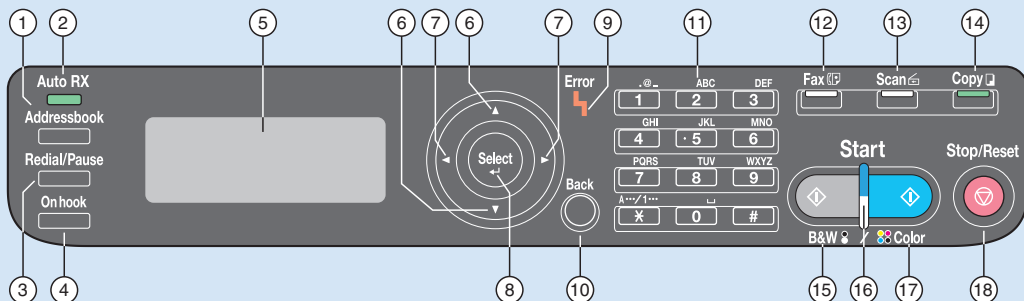

Item	Name	Function
1	Addressbook key	Displays the information registered in the favorite list, speed dial destinations and group dial destinations
2	Auto RX indicator	Lights up when the automatic reception function is selected
3	Redial/Pause key	Recalls the last number dialed Inserts a pause when a number is dialed
4	Onhook key	Sends and receives transmissions with the receiver on the hook
5	Message Window	Displays settings, menus, and messages
6	▲/▼ keys	Moves up and down through menus, options, or choices
7	◀/▶ keys	Moves left and right through menus, options, or choices
8	Select key	Press to select the setting that is currently displayed
9	Error indicator	Indicates an error condition
10	Back key	Clears the specified number of copies and entered text Press to return to the previous screen Press to cancel the setting that is currently displayed
11	Keypad	Enters desired number of copies Enters fax numbers, E-mail addresses, and names of recipients
12	Fax key/LED	Enters Fax mode Lights up in green to indicate that the machine is in Fax mode
13	Scan key/LED	Enters Scan mode (Scan to E-mail, Scan to FTP, Scan to SMB, Scan to PC, or Scan to USB Memory) Lights up in green to indicate that the machine is in Scan mode
14	Copy key/LED	Enters Copy mode Lights up in green to indicate that the machine is in Copy mode
15	Start (Color) key	Starts a fax or color copy
16	Start indicator	Lights up in green when copying and fax transmission are possible Lights up in orange when copying and fax transmissions are not possible, for example, during warm-up or if an error has occurred
17	Start (B&W) key	Starts a fax or monochrome copy
18	Stop/Reset key	Returns the settings to their defaults and stops functions

Copy

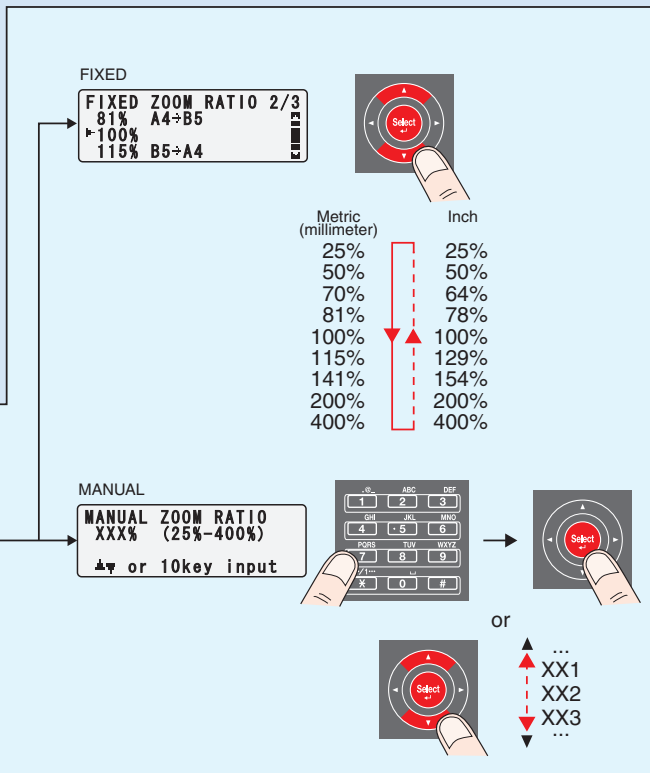
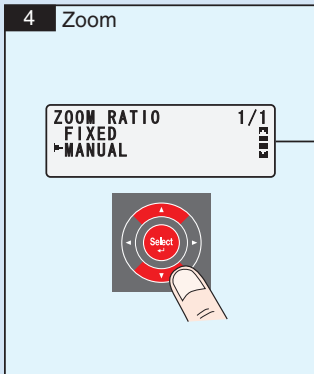
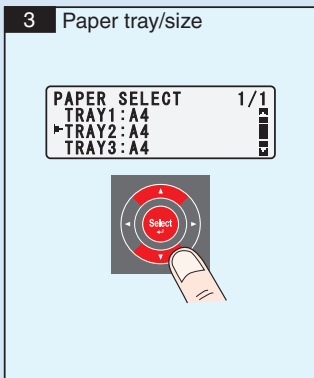
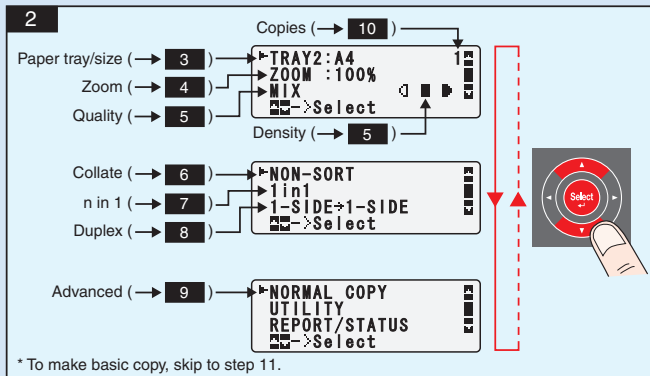
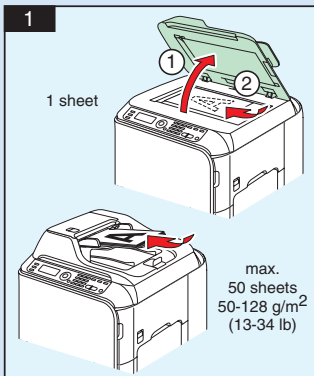
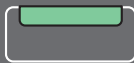

Copy

(cont.)

5 Quality

QUALITY 1/1
MODE
DENSITY

MODE 1/2
MIX
TEXT
PHOTO

DENSITY
DENSITY (TEXT)
AUTO
MANUAL

MIX
TEXT
PHOTO
FINE/MIX
FINE/TEXT
FINE/PHOTO

(-3) (+3)

6 Collate

COPY FINISHING 1/1
NON-SORT
SORT

7 n in 1

COMBINE ORIGINAL 1/1
1 in 1
2 in 1
4 in 1

8 Duplex

SIMPLEX/DUPLEX 1/2
1-SIDE → 1-SIDE
1-SIDE → 2-SIDE
2-SIDE → 1-SIDE
2-SIDE → 2-SIDE

9 Advanced

COPY FUNCTION 1/2
NORMAL COPY
ID CARD COPY
REPEAT COPY

NORMAL COPY
ID CARD COPY
REPEAT COPY
POSTER COPY

10 Copies

TRAY2: A4
ZOOM: 100%
MIX
Select

2 digits

11

Start

B&W / Color

or

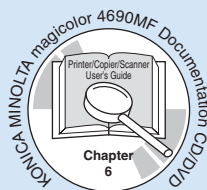

Scan from TWAIN (Windows)
Scan from WIA (Windows)
Scan from TWAIN (Macintosh)

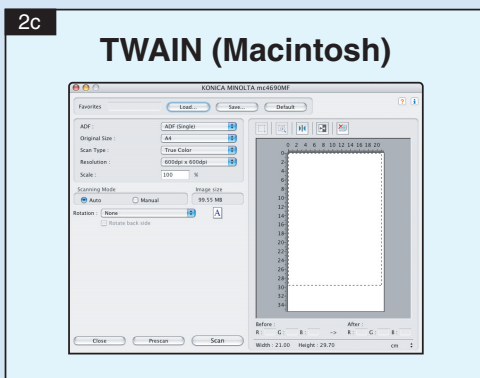
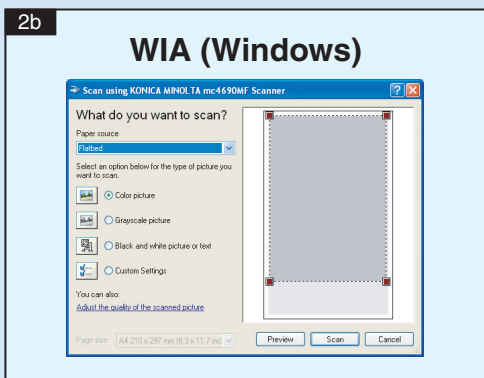
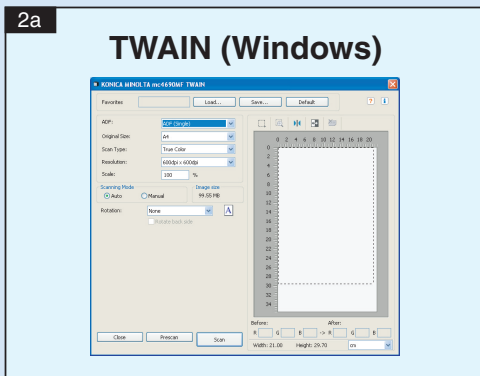
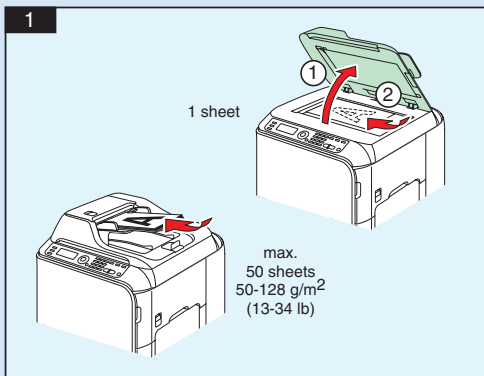

Note : Refer to the Printer/Copier/Scanner User's Guide (PDF manual on the CD/DVD) for details on how to use the scanner driver.

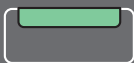

Scan to E-mail / FTP / SMB

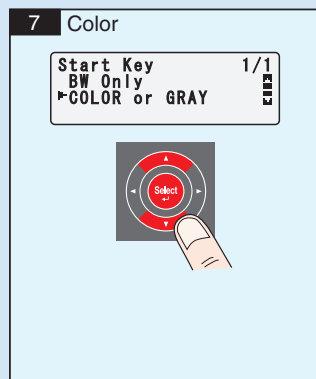
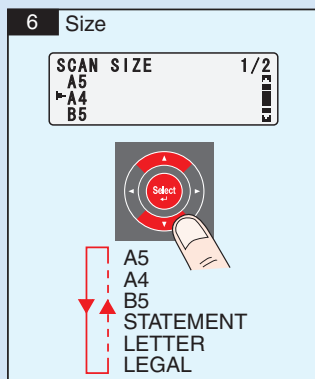
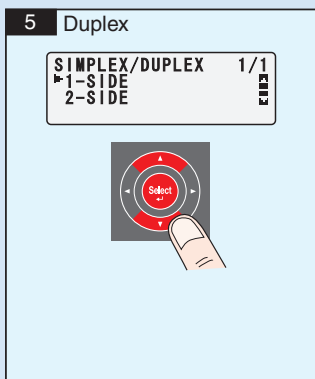
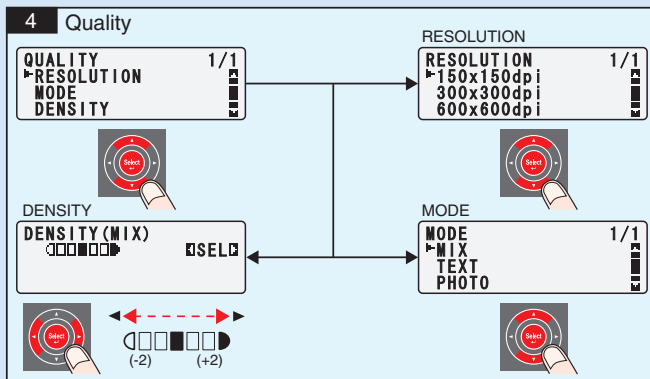
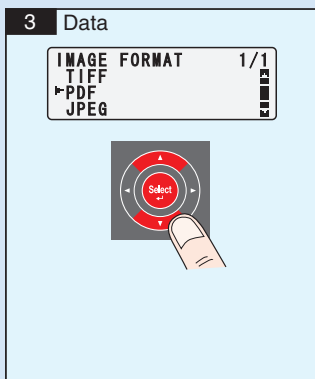
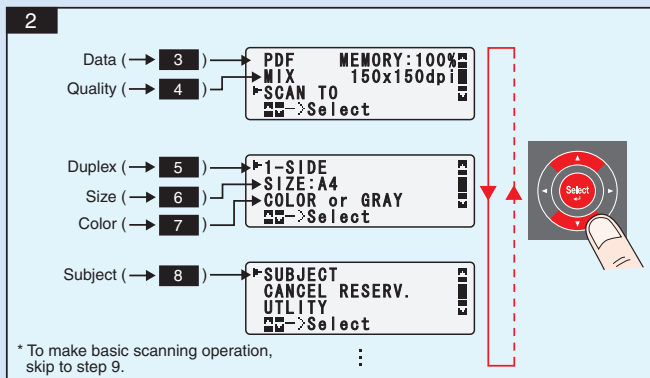
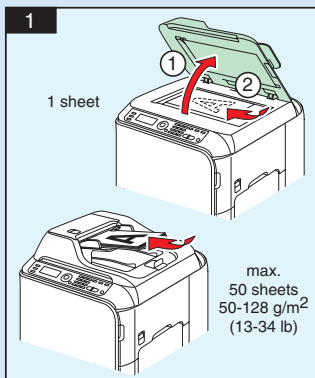

Scan to E-mail / FTP / SMB (cont.)

8 Subject

SUBJECT
:XXXXXXXXXX [A...]

9a DIRECT

DESTINATION X/XXX
:XXXXXXXXXX [A...]
EDIT=Select

* Direct input is not applied for Scan to FTP/SMB.

9b FAVORITE

Addressbook

FAVORITE X/X
▶XXXXX
YYYYY
ZZZZZ

9c SPEED DIAL

Addressbook Press 2x

DESTINATION X/XXX
SPEED DIAL:XXX
-PRESS SELECT KEY-

3 digits

9d GROUP DIAL

Addressbook Press 3x

DESTINATION X/XXX
GROUP DIAL:XX
-PRESS SELECT KEY-

2 digits

9e PHONE BOOK

Addressbook Press 4x

PHONE BOOK 1/1
▶LIST
SEARCH
LDAP SEARCH

10

Start

or

BOOK
(Original glass)
Step 11

11

NEXT PAGE? 1
SCAN=Select
SEND=Start

SCAN or **SEND**

Note : Refer to Printer/Copier/Scanner User's Guide (PDF manual on the CD/DVD) for details on Scan to E-mail/FTP/SMB.

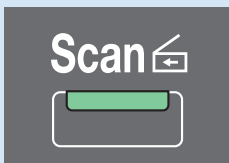
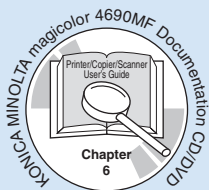

Scan to PC

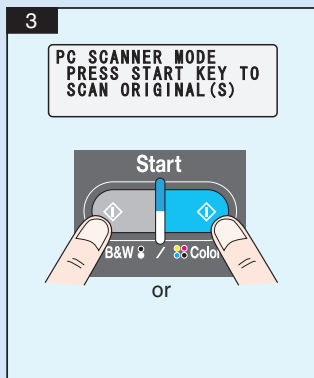
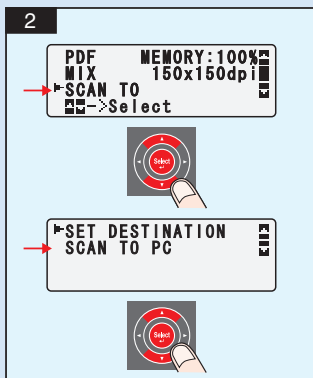
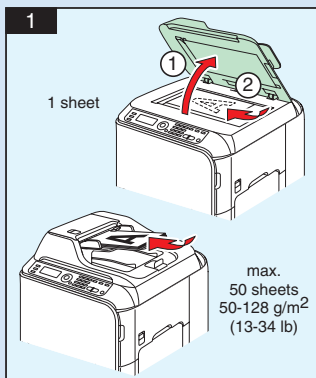

Note : The Scan-to-PC function can be used when the TWAIN Scanner driver, Printer driver, and KONICA MINOLTA LinkMagic (Windows only) are installed on your PC. Make sure that KONICA MINOLTA LinkMagic is started first. Refer to Printer/Copier/Scanner User's Guide (PDF manual on the CD/DVD) for details on Scan to PC.

Scan to USB Memory

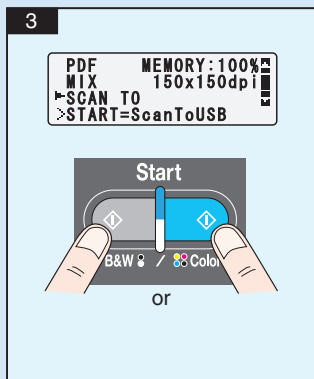
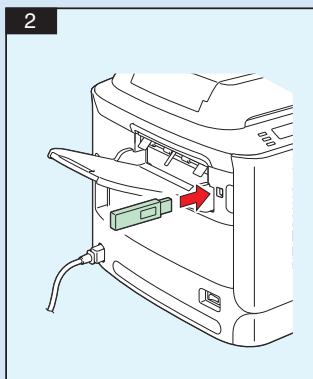
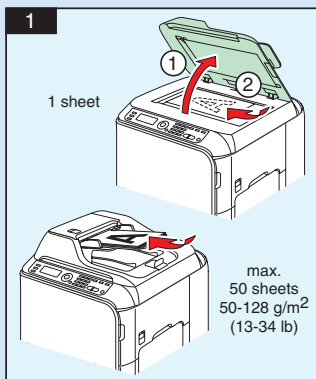

Note : Refer to Printer/Copier/Scanner User's Guide (PDF manual on the CD/DVD) for details on Scan to USB Memory.

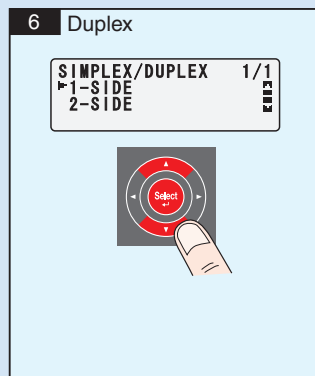
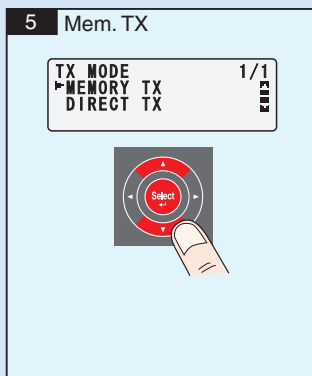
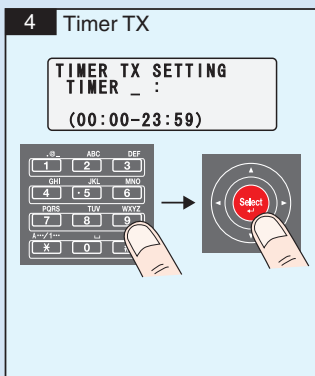
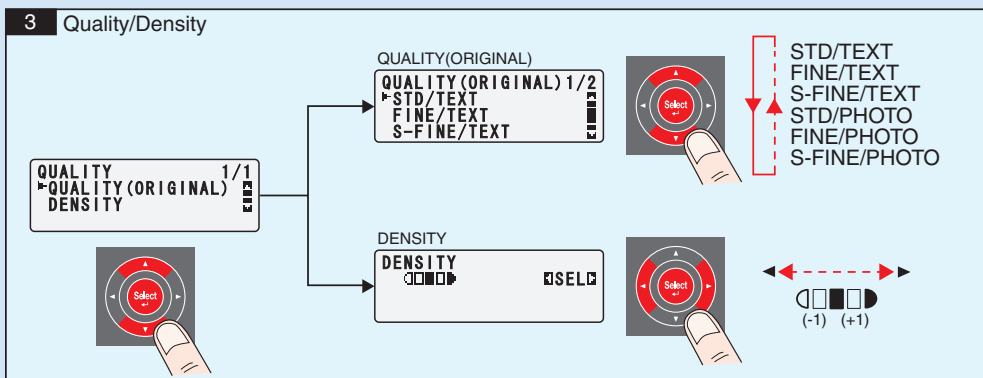
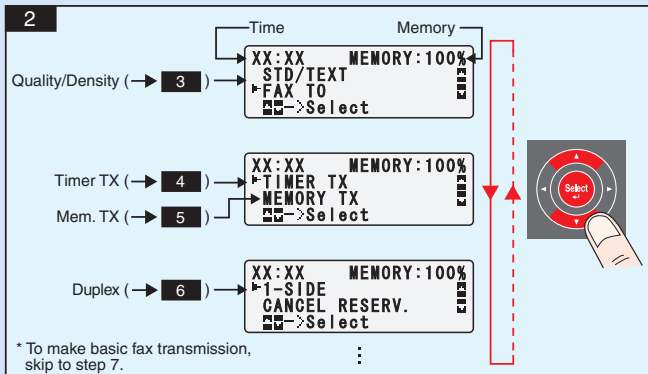
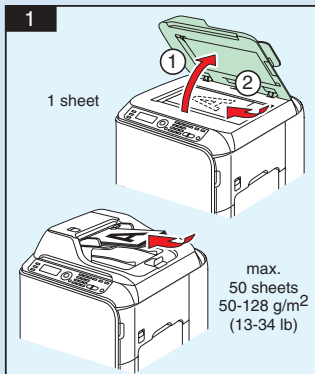
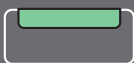



(cont.)

7a DIRECT

DESTINATION X/XXX
:XXXXXXXXXX [1...]
EDIT>Select

7b FAVORITE

Addressbook

FAVORITE X/X
▶XXXXX
YYYYY
ZZZZZ

7c SPEED DIAL

Addressbook Press 2x

DESTINATION X/XXX
SPEED DIAL:XXX
-PRESS SELECT KEY-

3 digits

7d GROUP DIAL

Addressbook Press 3x

DESTINATION X/XXX
GROUP DIAL:XX
-PRESS SELECT KEY-

2 digits

7e PHONE BOOK

Addressbook Press 4x

PHONE BOOK 1/1
▶LIST
SEARCH

7f REDIAL

Redial/Pause

DESTINATION X/XXX
:XXXXXXXXXX_ [1...]
EDIT>Select

8

Start

B&W or Color

or

BOOK
(Original glass)
Step 9-10

9

SCAN SIZE 1/1
A5
▶A4

10

XX:XX MEMORY: 99%
STD/TEXT
▶NEXT PAGE? (XX) d1
TX=Start

NEXT PAGE TX

or

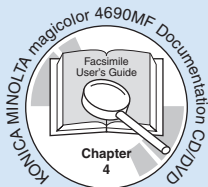

FAX from PC

1

PC-FAX (Windows)

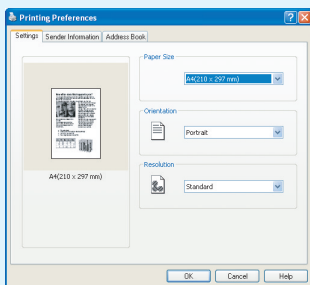

Note : Refer to the Facsimile User's Guide (PDF manual on the CD/DVD) for details on how to use the PC-FAX driver.

REPLACING CONSUMABLES

TONER CARTRIDGE

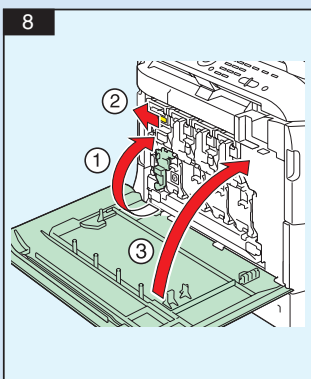
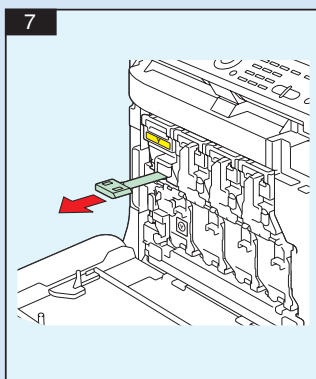
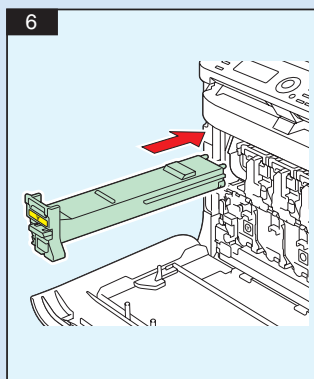
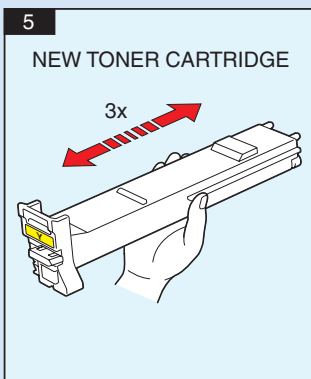
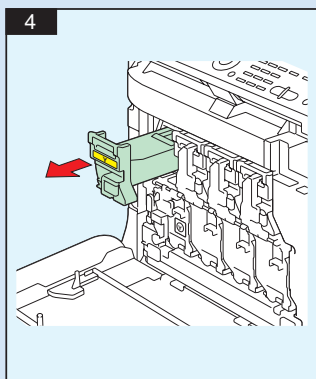
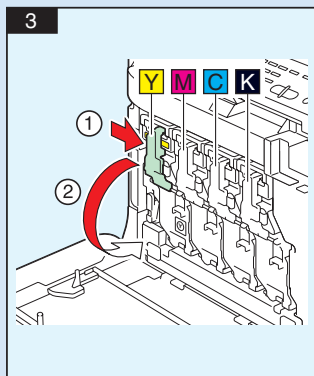
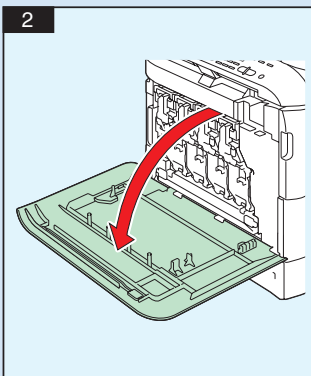
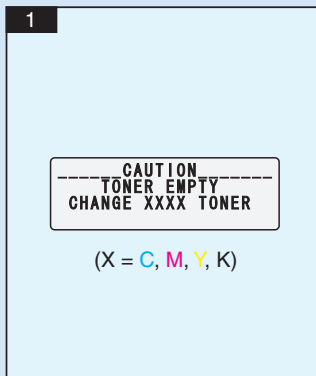

REPLACING CONSUMABLES

IMAGING UNIT

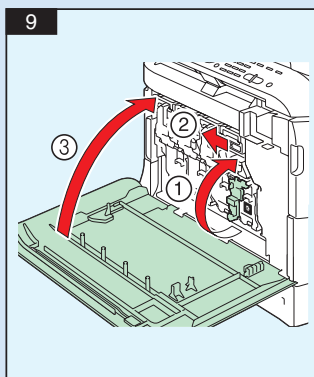
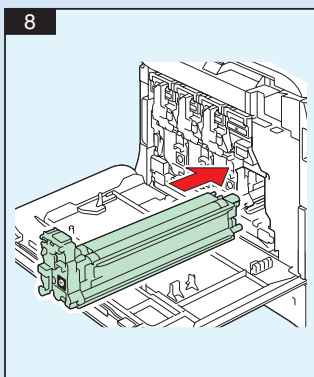
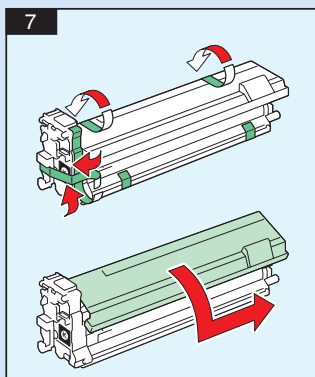
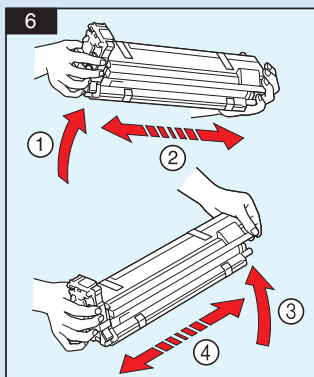
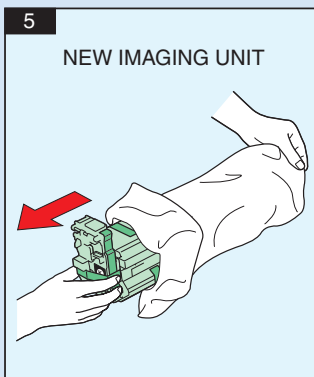
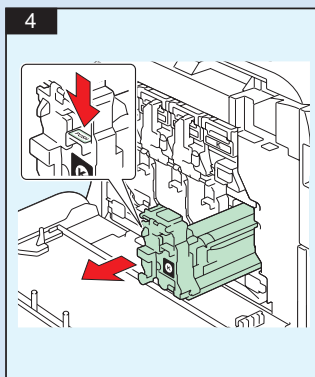
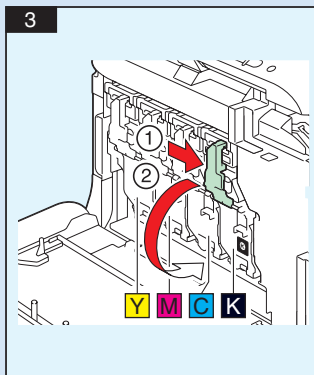
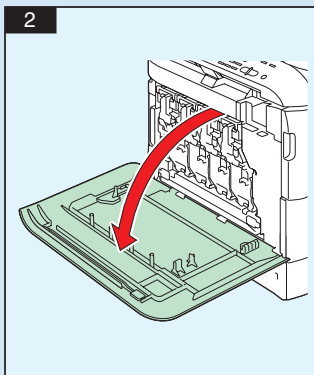
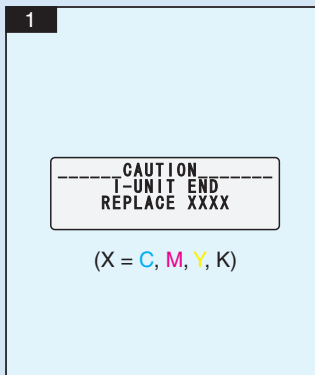

Free Manuals Download Website

<http://myh66.com>

<http://usermanuals.us>

<http://www.somanuals.com>

<http://www.4manuals.cc>

<http://www.manual-lib.com>

<http://www.404manual.com>

<http://www.luxmanual.com>

<http://aubethermostatmanual.com>

Golf course search by state

<http://golfingnear.com>

Email search by domain

<http://emailbydomain.com>

Auto manuals search

<http://auto.somanuals.com>

TV manuals search

<http://tv.somanuals.com>