

PACKAGE CONTENTS

- PS4™ headset audio controller
- AAA batteries (2)
- *Quick Setup Guide*

FEATURES

- Power button
- MIC mute
- Volume control
- LED indicator

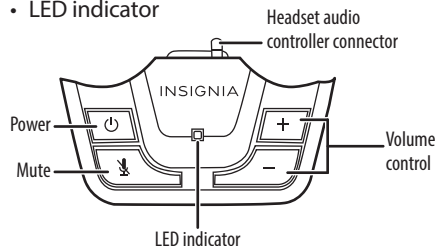

LIGHT STATUS	DESCRIPTION
Green	Power on
Red	Mute
Flashing	Low batteries

INSTALLING THE BATTERIES

Note: Insert two AAA batteries into the battery compartment. Make sure that you match the + and - symbols on the batteries with the + and - symbols in the battery compartment.

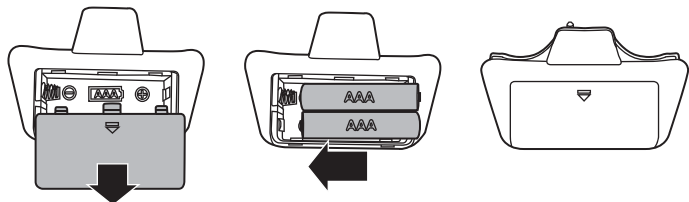

USING YOUR PS4 HEADSET AMPLIFIER

1 Align the headset audio controller connector with the jack on the PS4 controller, then firmly slide them together.

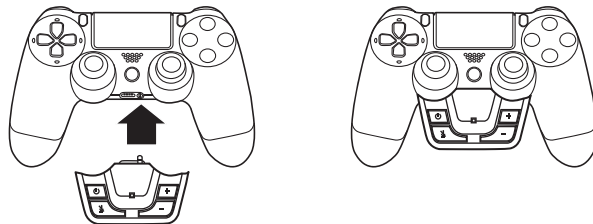

2 Connect your headphone plug to the 3.5 mm jack on the headset audio controller.

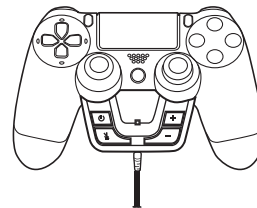

3 Turn on your PS4 and controller, then press the power button on the headset audio controller to turn it on.

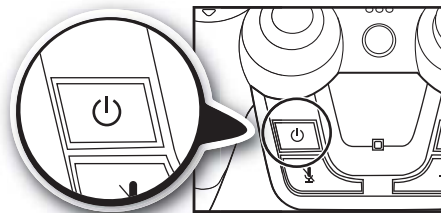

4 In the PS4 menu, select **Settings > Sound and Screen > Audio Output Settings > Output to Headphones > All Audio**.

Using your PS4 Headset Amplifier

- 1 Using a DUALSHOCK® 4 controller, press and hold the “PS” button. Select “Adjust Devices”.

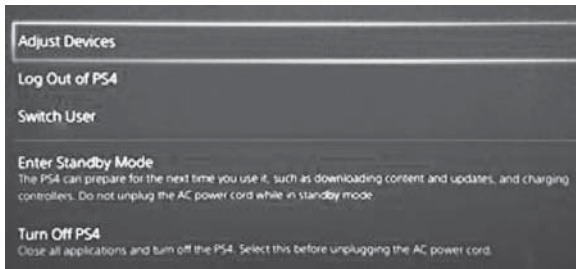

- 2 Select the type of audio output you want to your headphones (**All audio** for stereo headsets, **Chat audio** for Chat headsets, or **none**).
- 3 Select **Volume Control (Headsets)** to increase or decrease the volume output to the controller audio port.

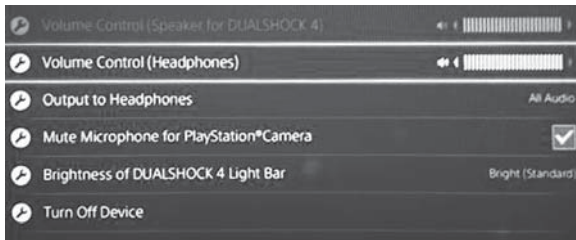

- 4 Press the “PS” button to exit.

Muting the microphone

- Press the **MIC mute** button to mute the microphone. Press the button again to un-mute the microphone.

TROUBLESHOOTING

- If the volume in your headset is too low and the headset audio controller volume is set to maximum, increase the volume through the console.

SPECIFICATIONS

Amplifier specs - Supported Impedance: 16-32 #

Max Output Power: 20mW (THD+N=0.1%;F=1kHz;RL=16#)

LEGAL NOTICES

FCC Information

This device complies with part 15 of the FCC Rules. Operation is subject to the following two conditions: (1) This device may not cause harmful interference, and (2) this device must accept any interference received, including interference that may cause undesired operation.

Caution: Changes or modifications not expressly approved by the party responsible for compliance could void the user's authority to operate this equipment.

Note: This equipment has been tested and found to comply with the limits for a Class B digital device, pursuant to part 15 of the FCC Rules. These limits are designed to provide reasonable protection against harmful interference in a residential installation. This equipment generates, uses and can radiate radio frequency energy and, if not installed and used in accordance with the instructions, may cause harmful interference to radio communications. However, there is no guarantee that interference will not occur in a particular installation. If this equipment does cause harmful interference to radio or television reception, which can be determined by turning the equipment off and on, the user is encouraged to try to correct the interference by one or more of the following measures:

- Reorient or relocate the receiving antenna.
- Increase the separation between the equipment and receiver.
- Connect the equipment into an outlet on a circuit
- Consult the dealer or an experienced radio/TV technician for help.

ICES-003 statement

CAN ICES-3 (B)/NMB-3 (B)

ONE-YEAR LIMITED WARRANTY

Visit www.insigniaproducts.com for details.

CONTACT INSIGNIA:

For customer service, call 1-877-467-4289 (U.S. and Canada) or 01-800-926-3000 (Mexico)

www.insigniaproducts.com

Other parties' marks are the property of their respective owners.

INSIGNIA is a trademark of Best Buy and its affiliated companies.

Registered in some countries.

Distributed by Best Buy Purchasing, LLC

7601 Penn Ave South, Richfield, MN 55423 U.S.A.

©2014 Best Buy. All rights reserved.

Free Manuals Download Website

<http://myh66.com>

<http://usermanuals.us>

<http://www.somanuals.com>

<http://www.4manuals.cc>

<http://www.manual-lib.com>

<http://www.404manual.com>

<http://www.luxmanual.com>

<http://aubethermostatmanual.com>

Golf course search by state

<http://golfingnear.com>

Email search by domain

<http://emailbydomain.com>

Auto manuals search

<http://auto.somanuals.com>

TV manuals search

<http://tv.somanuals.com>