

STRATOS™ Portable Plus Battery Pack

Model No. - IRC 1731



Yes, you can.

SAVE THESE INSTRUCTIONS

NOTE: Check all parts for shipping damage. In case of damage, DO NOT use. Contact the Carrier/ Invacare for further instruction.

Safety Summary

⚠ WARNING

DO NOT use this product or any available optional equipment without first completely reading and understanding these instructions, Stratos Portable Plus Compressor Operator's Manual and any additional instructional material such as service manuals or instruction sheets supplied with this product or optional equipment. If you are unable to understand the warnings, cautions or instructions, contact a healthcare professional, dealer or technical personnel before attempting to use this equipment - otherwise, injury or damage may occur.

To charge battery, use only the original power cable (AC) or AC adapter and cable provided with your Stratos Portable Plus Compressor. Use of non-original equipment may result in damage to the battery.

DO NOT dispose of battery pack in household waste. Proper disposal at an appropriate collection site in your local area is strongly recommended and may be required by some local ordinances.

DO NOT dispose of batteries in fire, as they could explode.

⚠ ACCESSORIES WARNING

Invacare products are specifically designed and manufactured for use in conjunction with Invacare accessories. Accessories designed by other manufacturers have not been tested by Invacare and are not recommended for use with Invacare products.

CAUTION

DO NOT attempt to open the plastic case or replace any components.

DO NOT short circuit battery contacts. Make sure battery contacts **DO NOT** come in contact with keys, coins or other metal objects.

Charging of the battery requires at least six hours. Failure to condition the battery prior to its first use may result in a reduced battery life expectancy.

The battery has protection from overheating and will not operate if temperature is 104°F (40°C) or higher. Allow the battery to cool before restarting.

For more information regarding Invacare products, parts, and services, please visit www.invacare.com

Conditioning the Battery

NOTE: The definition of conditioning the battery is simply charging the battery for a full six hour cycle before the initial use of the product.

1. Disconnect the battery from the compressor.
2. Connect the power cable (AC) or auto adapter cable (DC) to the battery.
3. Charge the battery for a full six hour cycle.

The orange light will indicate if the battery is properly charging. Battery charging to full capacity is dependent upon many factors. Conditioning the battery requires at least 6 hours. Failure to condition the battery prior to its first use may result in a reduced battery life expectancy. To assure maximum life performance of the battery after conditioning, leave the battery connected to a power source when not in use.

The battery operation time depends upon the charge condition of the battery, the temperature, the storage time of the battery prior to use, the amount of medication used for treatment, and the number of charge/discharge cycles. **The manufacturer of the battery recommends the battery be conditioned every one or two months.**

Charging the Battery

NOTE: For this procedure, refer to FIGURE 1.

1. Press in the release button on the front of the battery pack and separate the battery from the compressor (Detail "A").
2. Connect the power cable (AC) to the AC adapter and cable provided with your STRATOS Portable Plus Compressor (Detail "B").
3. Connect the AC adapter and cable to the battery (Detail "A").
4. Plug the power cable into the appropriate power source.

The ORANGE light will turn on indicating that the charging cycle has begun. The battery will reach full charge after at least six hours. Completion of the charge cycle is indicated by a GREEN battery light. Full charge will provide up to ninety minutes of operation.

NOTE: In order to ensure maximum performance of the battery, keep the battery plugged in and charging when not in use. This will not overcharge or damage the battery.

NOTE: The battery must be plugged into a power source for the battery to charge. The battery will not charge when it is attached to the compressor nebulizer system.

NOTE: Never leave the battery connected to either power cable when the cable is disconnected from the power source. This will cause the battery to discharge.

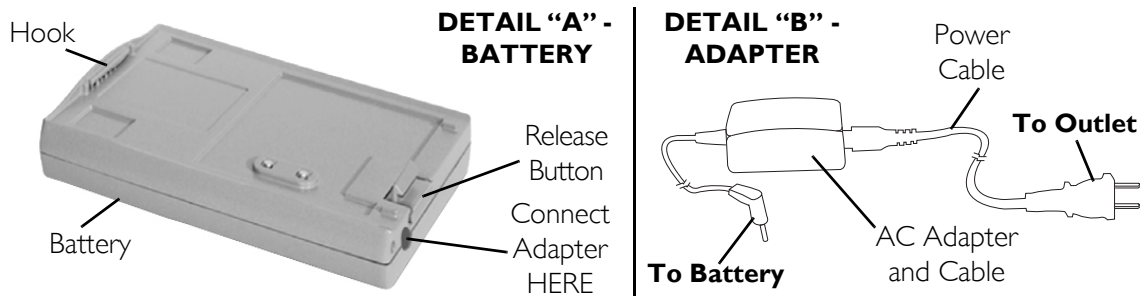

FIGURE 1 Charging the Battery

Using the Battery

1. Before connecting the battery pack, shift the grey contacts cover located on the bottom of the compressor to the side, following the direction arrow. Refer to [Contact Cover](#) on page 3.

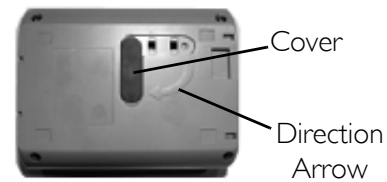

FIGURE 2 Contact Cover

2. Fit the front hook on the battery top into the recess on the bottom of the compressor. Refer to [Using the Battery](#) on page 3.
3. Press the battery and compressor together until the release button on the front of the battery clicks.

NOTE: For operation of the Stratos Portable Plus Compressor, refer to the owner's manual.

4. Gently pull the compressor and battery pack in opposite directions to ensure the tabs have seated properly.
5. To remove the battery pack, press the release button on the front of the battery pack while pulling the battery and compressor apart.

NOTE: The GREEN light on the battery will not illuminate while the nebulizer is being powered. The ORANGE light flashes when the battery power level is low. When the ORANGE light flashes, immediately find an alternative power source (i.e. a wall socket).

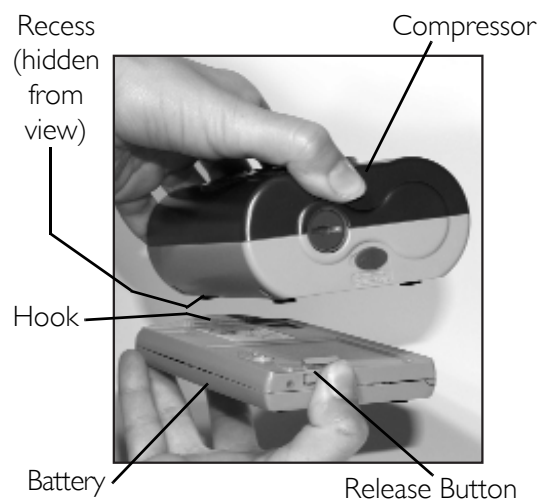

FIGURE 3 Using the Battery

Cleaning the Battery and Cables

CAUTION

Unplug the battery and power cables before cleaning.

DO NOT submerge the battery pack, AC adapter or auto adapter in water to clean. **NEVER** hold under running water or spray with water or other liquids. Clean outer case with a damp cloth.

DO NOT clean using abrasive cleaners.

DO NOT remove outer case of this unit. **Electrical shock hazard. All disassembly and maintenance of this unit MUST be done by a qualified technician.**

Routine Care

CAUTION

DO NOT subject the battery to any strong shocks such as dropping the unit on the floor.

DO NOT store the battery in extreme hot or cold temperatures, high humidity or under direct sunlight.

NOTE: To optimize battery performance, the battery should be replaced after 250 cycles of charge/discharge. To replace the battery, refer to STEP 4 in Using the Battery.

1. Store the battery FULLY CHARGED in a cool, dry place.

LIMITED WARRANTY

PLEASE NOTE: THE WARRANTY BELOW HAS BEEN DRAFTED TO COMPLY WITH FEDERAL LAW APPLICABLE TO PRODUCTS MANUFACTURED AFTER JULY 4, 1975.

This warranty is extended only to the original purchaser who purchases this product when new and unused from Invacare Corporation or a dealer. This warranty is not extended to any other person or entity and is not transferable or assignable to any subsequent purchaser or owner. Coverage under this warranty will end upon any such subsequent sale or other transfer of title to any other person. This warranty gives you specific legal rights and you may also have other legal rights which vary from state to state.

Invacare warrants this product when purchased new and unused to be free from defects in materials and workmanship for a period of six months with a copy of the seller's invoice required for coverage. If within such warranty periods any such product shall be proven to Invacare's satisfaction to be defective, such product shall be repaired or replaced, at Invacare's option. This warranty does not apply to normal wear and tear or failure to adhere to the product instructions, nor does it include shipping charges incurred in replacement part installation or repair of any such product. Invacare's sole obligation and your exclusive remedy under this warranty shall be limited to such repair and/or replacement.

For warranty service, please contact the Invacare service department during normal business hours at the toll-free telephone number identified on the back cover of this manual.

Upon receiving notice of an alleged defect in a product, Invacare will issue a serialized return authorization. It shall be the responsibility of the purchaser to pack the product(s) or part(s) in an appropriate manner to avoid shipping damage and return the product(s) or part(s), at the purchaser's expense, to either Invacare's plant or service center as specified by Invacare in advance. The defective product(s) or component part(s) must be returned for warranty inspection using the serial number as identification within 30 days of the return authorization date. **DO NOT** return any product(s) or part(s) to our factory or service center without prior consent. C.O.D. shipments will be refused - please pre-pay shipping charges.

LIMITATIONS AND EXCLUSIONS: THE FOREGOING WARRANTY SHALL NOT APPLY TO SERIAL NUMBERED PRODUCTS IF THE SERIAL NUMBER HAS BEEN REMOVED OR DEFACED; PRODUCTS SUBJECTED TO NEGLIGENCE, ACCIDENT, IMPROPER OPERATION, MAINTENANCE, OR STORAGE; PRODUCTS MODIFIED WITHOUT INVACARE'S EXPRESS WRITTEN CONSENT (INCLUDING, BUT NOT LIMITED TO, MODIFICATION THROUGH THE USE OF UNAUTHORIZED PARTS OR ATTACHMENTS); PRODUCTS DAMAGED BY REASON OF REPAIRS MADE TO ANY COMPONENT WITHOUT THE SPECIFIC CONSENT OF INVACARE; PRODUCTS DAMAGED BY CIRCUMSTANCES BEYOND INVACARE'S CONTROL; OR PRODUCTS REPAIRED BY ANYONE OTHER THAN INVACARE OR AN INVACARE SERVICE CENTER. SUCH EVALUATION SHALL BE SOLELY DETERMINED BY INVACARE.

THE FOREGOING EXPRESS WARRANTY IS EXCLUSIVE AND IN LIEU OF ANY OTHER WARRANTIES WHATSOEVER, WHETHER EXPRESSED OR IMPLIED, INCLUDING THE IMPLIED WARRANTIES OF MERCHANTABILITY AND FITNESS FOR A PARTICULAR PURPOSE, AND THE SOLE REMEDY FOR VIOLATIONS OF ANY WARRANTY WHATSOEVER, SHALL BE LIMITED TO REPAIR OR REPLACEMENT OF THE DEFECTIVE PRODUCT PURSUANT TO THE TERMS CONTAINED HEREIN. THE APPLICATION OF ANY IMPLIED WARRANTY WHATSOEVER SHALL NOT EXTEND BEYOND THE DURATION OF THE EXPRESS WARRANTY PROVIDED HEREIN. INVACARE SHALL NOT BE LIABLE FOR ANY CONSEQUENTIAL OR INCIDENTAL DAMAGES WHATSOEVER.

SOME STATES DO NOT ALLOW THE EXCLUSION OR LIMITATION OF INCIDENTAL OR CONSEQUENTIAL DAMAGE, OR LIMITATION OF HOW LONG AN IMPLIED WARRANTY LASTS, SO THE ABOVE EXCLUSION AND LIMITATION MAY NOT BE APPLICABLE.

THIS WARRANTY SHALL BE EXTENDED TO COMPLY WITH STATE/PROVINCIAL LAWS AND REQUIREMENTS.

Invacare Corporation www.invacare.com



Yes, you can.®

USA

One Invacare Way
Elyria, Ohio USA
44036-2125
800-333-6900

2101 E. Lake Mary Blvd.
Sanford, FL USA
32773
800-832-4707

All rights reserved. Trademarks are identified by the symbols ™ and ®. All trademarks are owned by or licensed to Invacare Corporation unless otherwise noted.

© 2008 Invacare Corporation

Free Manuals Download Website

<http://myh66.com>

<http://usermanuals.us>

<http://www.somanuals.com>

<http://www.4manuals.cc>

<http://www.manual-lib.com>

<http://www.404manual.com>

<http://www.luxmanual.com>

<http://aubethermostatmanual.com>

Golf course search by state

<http://golfingnear.com>

Email search by domain

<http://emailbydomain.com>

Auto manuals search

<http://auto.somanuals.com>

TV manuals search

<http://tv.somanuals.com>