

Natural-Fit Handrims

Assembly and Installation Instructions

Part Numbers: 1145545, 1145546, 1145547, 1145548, 1145549,
1145550, 1145551, 1145552, 1145553, 1145554



Yes, you can.

NOTE: Check all parts for shipping damage. In case of shipping damage, DO NOT use. Contact Invacare for further instruction.

Safety Summary

To ensure the safe and proper installation of the handrims, these instructions **MUST** be followed:

⚠ WARNING

DO NOT install this equipment without first reading and understanding this instruction sheet. If you are unable to understand the warnings, cautions and instructions, contact Invacare, before attempting to install this equipment - otherwise, injury or damage may occur.

Invacare products are specifically designed and manufactured for use in conjunction with Invacare accessories. Accessories designed by other manufacturers have not been tested by Invacare and are not recommended for use with Invacare products.

⚠ INSTALLATION WARNING

This procedure **MUST** be performed by a qualified technician.

After any adjustments, repair or service and before use, make sure that all attaching component parts are secure.

Proper installation is critical to the performance of the handrim.

Removing/Installing Handrims with Rivnuts®

NOTE: For this procedure, refer to FIGURE 1 on page 2.

Tool Needed:

- Phillips® head screwdriver
1. Remove the wheel from the wheelchair. Refer to the wheelchair owner's manual.
 2. Remove the mounting screws that secure the existing handrim to the wheel.
 3. Place the Natural Fit handrim on a flat surface with the rivnuts facing up.
 4. Place the thumb guard on top of the handrim.

NOTE: The thumb guard is installed on the outside of the wheelchair with wider edge making contact with the wheel.

5. Place the wheel on top of the thumb guard and handrim.

NOTE: The outside of the wheel should be facing down.

**For more information regarding Invacare products, parts, and services,
please visit www.invacare.com**

6. Insert the new mounting screws through the wheel and the new spacers.
7. Thread the mounting screw into the rivnuts on the handrim.

NOTE: DO NOT tighten the screws.

NOTE: Screws and spacers are provided. DO NOT use the old screws and spacers, you may damage the thumb guard and void the warranty.

8. Center the handrim on the wheel.

NOTE: The thumb guard should not spin when pushed on and should be centered on the wheel. If the thumb guard tilts to one side, loosen the mounting screws and readjust the thumb guard.

9. Secure the handrim to the wheel by tightening the screws.
10. Reinstall the wheel onto the wheelchair. Refer to wheelchair owner's manual.
11. Repeat STEPS 1-10 for the other wheel.

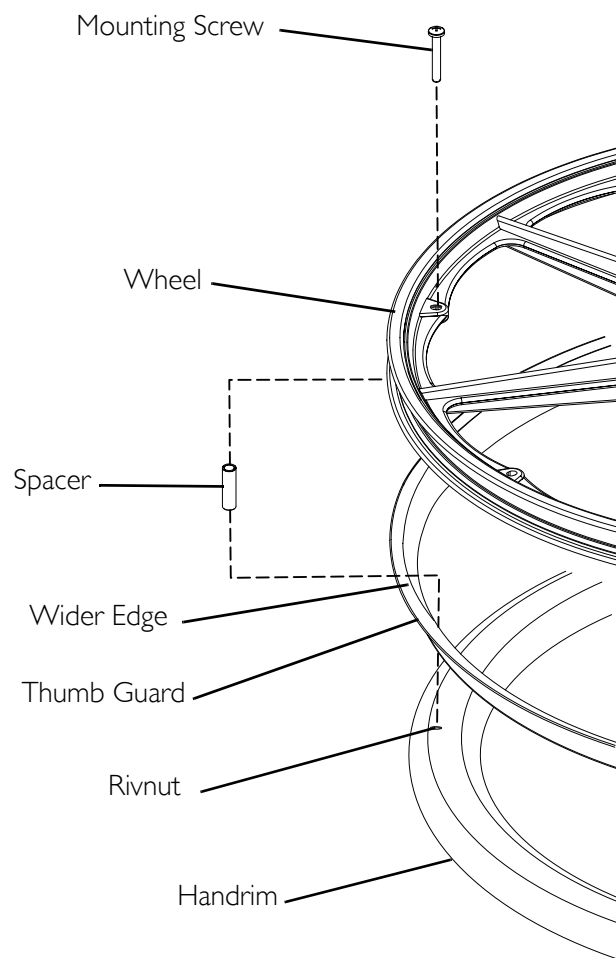

FIGURE I Removing/Installing Handrims with Rivnuts®

Removing/Installing Handrims with Tabs

NOTE: For this procedure, refer to FIGURE 2 on page 4.

Tools Needed:

- Phillips head screwdriver
- 3/8" wrench
- Air pump
- Tire irons (tools to remove the tire) - if necessary
- Pliers - if necessary

1. Remove the wheel from the wheelchair. Refer to wheelchair owner's manual.
2. Deflate and remove the tire from the wheel.
3. Using a Phillips screwdriver and a 3/8" wrench, remove the six mounting screws and locknuts that secure the old handrim to the wheel. Discard the old handrim.
4. Inspect the tabs on the handrim of the Natural-Fit for proper placement inside the wheel.

NOTE: It is important to evenly bend the tabs so the oval handrim will mount symmetrically to the wheel.

5. Place the handrim on a flat surface with the tabs facing up.
6. Place the thumb guard around the tabs and on top of the handrim.

NOTE: The thumb guard is installed on the outside of the wheelchair with wider edge making contact with the wheel.

7. Place the wheel on top of the thumb guard and handrim.

NOTE: Make sure the holes on the tabs match up with the holes on the wheel.

NOTE: The outside of the wheel should be facing down.

8. Secure the wheel to the handrim and thumb guard with the six mounting screws and locknuts (Detail "A" of FIGURE 2).

NOTE: DO NOT tighten the locknuts.

9. Position hook and loop straps at opposite ends of the wheel (Detail "B" of FIGURE 2).
10. Tighten the assembly together by securing the two hook and loop straps.

NOTE: The thumb guard should not spin when pushed on and should be centered on the wheel. If the thumb guard tilts to one side, loosen the straps and readjust the thumb guard.

11. Secure the handrim by tightening the six locknuts.
12. Remove the hook and loop straps.
13. Reinstall the tire and inflate to the correct pressure.
14. Reinstall the wheel on the wheelchair. Refer to the wheelchair owner's manual.
15. Repeat STEPS 1-14 for the other wheel.

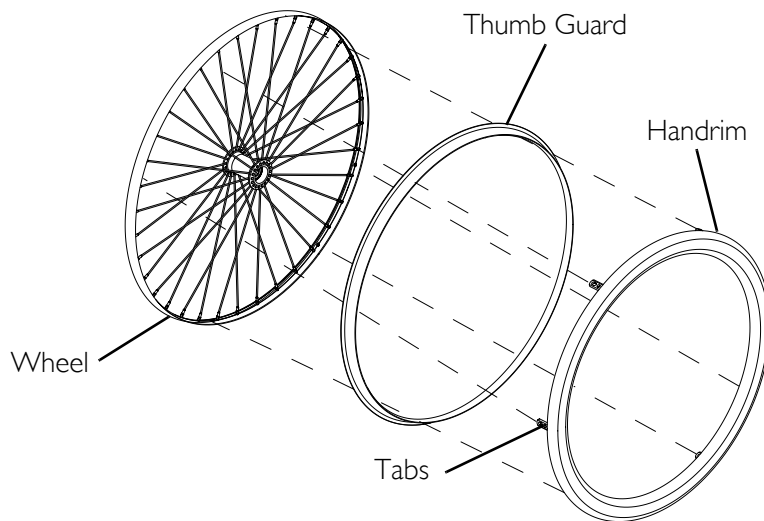

DETAIL "A" - ATTACHING THE HANDRIM

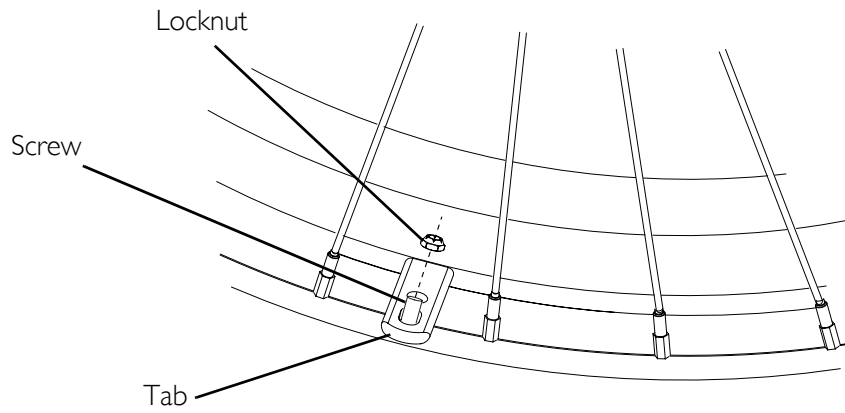

DETAIL "B" - SECURING THE HANDRIM

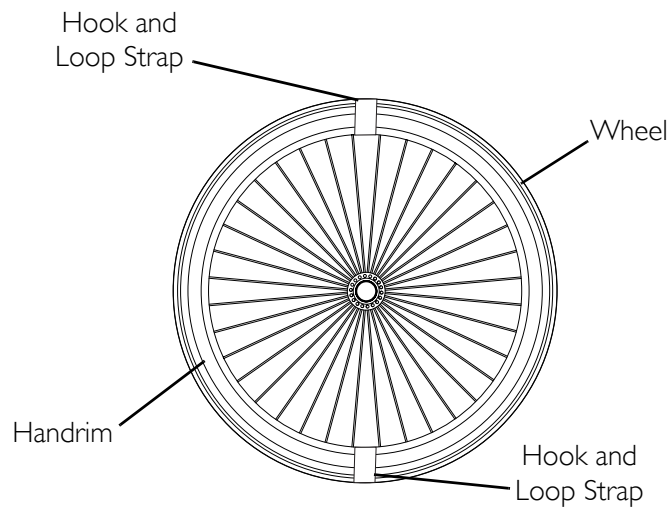

FIGURE 2 Removing/Installing Handrims with Tabs

NOTES

NOTES

LIMITED WARRANTY

PLEASE NOTE: THE WARRANTY BELOW HAS BEEN DRAFTED TO COMPLY WITH FEDERAL LAW APPLICABLE TO PRODUCTS MANUFACTURED AFTER JULY 4, 1975.

This warranty is extended only to the original purchaser/user of our products.

This warranty gives you specific legal rights and you may also have other legal rights which vary from state to state.

Invacare warrants its product to be free from defects in materials and workmanship for the period of one year of use by original purchaser. If within such warranty period any such product shall be proven to be defective, such product shall be repaired or replaced, at Invacare's option. This warranty does not include any labor or shipping charges incurred in replacement part installation or repair of any such product. Invacare's sole obligation and your exclusive remedy under this warranty shall be limited to such repair and/or replacement.

For warranty service, please contact the dealer from whom you purchased your Invacare product. In the event you do not receive satisfactory warranty service, please write directly to Invacare at the address on the back cover. Provide dealer's name, address, model number, and the date of purchase, indicate nature of the defect and, if the product is serialized, indicate the serial number.

Invacare Corporation will issue a return authorization. The defective unit or parts must be returned for warranty inspection using the serial number, when applicable, as identification within thirty days of return authorization date. **DO NOT** return products to our factory without our prior consent. C.O.D. shipments will be refused; please prepay shipping charges.

LIMITATIONS AND EXCLUSIONS: THE FOREGOING WARRANTY SHALL NOT APPLY TO SERIAL NUMBERED PRODUCTS IF THE SERIAL NUMBER HAS BEEN REMOVED OR DEFACED, PRODUCTS SUBJECT TO NEGLIGENCE, ACCIDENT, IMPROPER OPERATION, MAINTENANCE OR STORAGE, COMMERCIAL OR INSTITUTIONAL USE, PRODUCTS MODIFIED WITHOUT INVACARE'S EXPRESS WRITTEN CONSENT INCLUDING, BUT NOT LIMITED TO, MODIFICATION THROUGH THE USE OF UNAUTHORIZED PARTS OR ATTACHMENTS; PRODUCTS DAMAGED BY REASON OF REPAIRS MADE TO ANY COMPONENT WITHOUT THE SPECIFIC CONSENT OF INVACARE, OR TO A PRODUCT DAMAGED BY CIRCUMSTANCES BEYOND INVACARE'S CONTROL, AND SUCH EVALUATION WILL BE SOLELY DETERMINED BY INVACARE. THE WARRANTY SHALL NOT APPLY TO PROBLEMS ARISING FROM NORMAL WEAR OR FAILURE TO ADHERE TO THESE INSTRUCTIONS.

THE FOREGOING EXPRESS WARRANTY IS EXCLUSIVE AND IN LIEU OF ANY OTHER WARRANTIES WHATSOEVER, WHETHER EXPRESS OR IMPLIED, INCLUDING THE IMPLIED WARRANTIES OF MERCHANTABILITY AND FITNESS FOR A PARTICULAR PURPOSE, AND THE SOLE REMEDY FOR VIOLATIONS OF ANY WARRANTY WHATSOEVER, SHALL BE LIMITED TO REPAIR OR REPLACEMENT OF THE DEFECTIVE PRODUCT PURSUANT TO THE TERMS CONTAINED HEREIN, THE APPLICATION OF ANY IMPLIED WARRANTY WHATSOEVER SHALL NOT EXTEND BEYOND THE DURATION OF THE EXPRESS WARRANTY PROVIDED HEREIN. INVACARE SHALL NOT BE LIABLE FOR ANY CONSEQUENTIAL OR INCIDENTAL DAMAGES WHATSOEVER.

THIS WARRANTY SHALL BE EXTENDED TO COMPLY WITH STATE/PROVINCIAL LAWS AND REQUIREMENTS.



Yes, you can.

Invacare Corporation www.invacare.com

USA
One Invacare Way
Elyria, Ohio USA
44036-2125
800-333-6900

Invacare, Yes, you can. and the Medallion Design are registered trademarks of Invacare Corporation.
Phillips is a registered trademark of The Phillips Screw Co.
Rivnut is a registered trademark of Bollhoff.
© 2006 Invacare Corporation

Part No. 1144492

Rev A - 8/16/06

Free Manuals Download Website

<http://myh66.com>

<http://usermanuals.us>

<http://www.somanuals.com>

<http://www.4manuals.cc>

<http://www.manual-lib.com>

<http://www.404manual.com>

<http://www.luxmanual.com>

<http://aubethermostatmanual.com>

Golf course search by state

<http://golfingnear.com>

Email search by domain

<http://emailbydomain.com>

Auto manuals search

<http://auto.somanuals.com>

TV manuals search

<http://tv.somanuals.com>