

# I.V./O<sub>2</sub> Cylinder Holder Accessory Kit



## Assembly, Installation and Operating Instructions

Model Nos. I487, I496 and T1496

Yes, you can.™

*NOTE: Check all parts for shipping damage. If shipping damage is noted, DO NOT use. Contact Dealer/Invacare for further instructions.*

### SAFETY SUMMARY

The following recommendations are made for the safe installation of the IV/O<sub>2</sub> Cylinder Holder Accessory Kit:

#### WARNING

DO NOT assemble or use this equipment without first reading and understanding this instruction sheet. If you are unable to understand the Warnings, Cautions or Instructions, contact a healthcare professional, dealer or technical personnel if applicable before attempting to install this equipment - otherwise, injury or damage may occur.

After ANY adjustments, repair or service and BEFORE use, make sure all attaching hardware is tightened securely.

Follow the Oxygen Cylinder manufacturer's guidelines for proper usage of the oxygen cylinder.

### INSTALLING IV/O<sub>2</sub> CYLINDER HOLDER (FIGURE 1)

*NOTE: IF rear step tube is 7/8-inch diameter tubing, install the long tube guide insert into the rear step tube before installing the IV/O<sub>2</sub> cylinder holder.*

1. Place the IV/O<sub>2</sub> cylinder holder and slide it onto the rear step tube of the wheelchair.

*NOTE: IF rear upright tubing is 7/8-inch diameter tubing, install the short tube guide insert over the rear upright before installing and securing the IV/O<sub>2</sub> cylinder holder bracket.*

2. Push the bracket of the IV/O<sub>2</sub> cylinder holder over the rear upright of the wheelchair and secure in place with the hex screw, spacer and locknut.
3. Secure IV/O<sub>2</sub> cylinder holder to push handle using a ty-wrap.
4. Loosen the short adjustment knob to move IV/O<sub>2</sub> cylinder holder to desired height and then retighten.
5. Use the long adjustment knob on the IV/O<sub>2</sub> cylinder holder bracket to secure the oxygen cylinder in place.

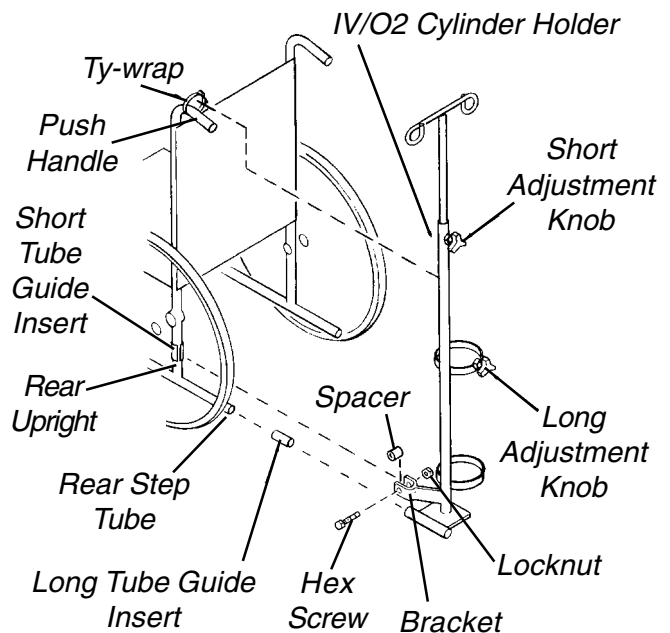

FIGURE 1 - INSTALLING IV/O<sub>2</sub> CYLINDER HOLDER



Invacare Corporation [www.invacare.com](http://www.invacare.com)

**USA**  
One Invacare Way  
Elyria, Ohio USA  
44036-2125  
800-333-6900

**Canada**  
5970 Chedworth Way  
Mississauga, Ontario  
L5R 3T9, Canada  
905-890-8838

Invacare® and Yes, you can. are trademarks of Invacare Corporation.  
© 2000 Invacare Corporation  
Form No. 91-201 Part No. 1027931 Rev E (1) 12/00

## Free Manuals Download Website

<http://myh66.com>

<http://usermanuals.us>

<http://www.somanuals.com>

<http://www.4manuals.cc>

<http://www.manual-lib.com>

<http://www.404manual.com>

<http://www.luxmanual.com>

<http://aubethermostatmanual.com>

Golf course search by state

<http://golfingnear.com>

Email search by domain

<http://emailbydomain.com>

Auto manuals search

<http://auto.somanuals.com>

TV manuals search

<http://tv.somanuals.com>