

Back 4"

1. Welcome

Thank you for purchasing IOGEAR's WiFi HotSpot Explorer, GWF001, "There Is No Better Way To Find WiFi Hotspot".

IOGEAR® only manufactures high quality connectivity devices so we are sure you will be satisfied with your purchase.

Note:
Your order has been carefully packaged and inspected, and we hope you are pleased with the IOGEAR product you purchased. Please inspect the contents of the package to ensure that you have received all items and that nothing has been damaged. If you discover a problem, please contact your dealer immediately for assistance.

Contact Information:
866-946-4327
23 Hubble
Irvine, CA 92618
USA
www.iogear.com
support@iogear.com

2. Product Overview

IOGEAR's HotSpot Explorer takes the guesswork out of finding a wireless connection to the Internet. This portable tool not only finds HotSpots but indicates the signal strength before you even unpack your computer. All it takes is once click on the "Detect" button and easy-to-read LEDs let you know if a HotSpot is within 500 feet. Nothing could be simpler!

Note: The WiFi signal strength level does not mean that the user can properly link to the detected WiFi service. The link quality still depends on the congestion of the WiFi service in the Hotspot, the working condition of the computer, and the actual interface between the WiFi site and the computer.

3. Features

- Eliminates need to boot your computer to find out whether you are within range of a hot spot
- Detects 802.11 b/g signals up to 500 feet away in open space
- High accuracy: Filters out other 2.4GHz RF signals, such as 2.4GHz Cordless phone, Bluetooth device, Microwave Oven and A/V sender
- Tiny - carry in a pocket, purse or on a keychain
- Easy to use: one-click technology, no software required
- Easy to read: Five LED indicators will show you the result
- Power indicator minimizes misreading signal

4. Pictorial Introduction

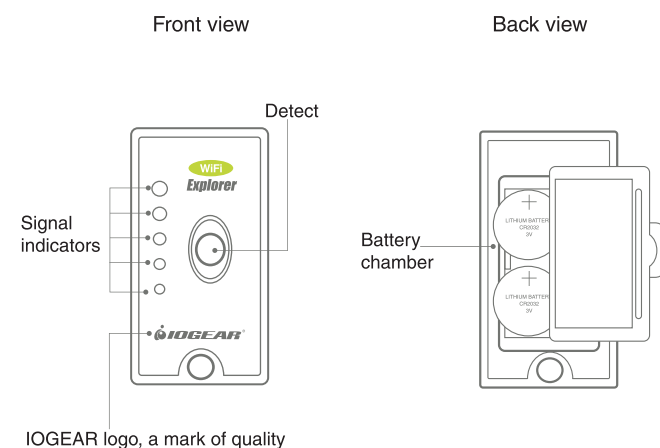

5. How to use your Hotspot Explorer

Step. 1

Setting Up

Open the battery cover on the back and insert the batteries with the positive side facing up.

Notes: Do not insert batteries into the WiFi HotSpot Explorer in the wrong direction. WiFi HotSpot Explorer is software free; put the batteries in and the device is ready.

Understanding the Button & Indicators

Button/Indicator	Functions
Detect button	Click this button to find out if you are within a WiFi signal coverage area.
Signal indicator	<ul style="list-style-type: none"> • Five LEDs on top indicate the signal strength (e.g., One green LED is low signal; four green LEDs mean very good signal) • If there is no WiFi signal or the signal is too weak, the lowest positioned LED lights up in red.

Front

5. How to use your Hotspot Explorer

Step. 2

Using WiFi HotSpot Explorer

Click the "DETECT" button, the LEDs will start blinking and verify the WiFi signal in the vicinity.

If there is a WiFi signal, the signal strength indicators will light up in green (1-4 LEDs).

If there is no WiFi signal or the signal is too weak, the lowest positioned LED lights up in red.

Note: The LED(s) remains lit up for 2-3 seconds to show the verification results.

6. Specification

Frequency range	2400-2483 MHz(802.11 b/g)
Detecting range	Approx. 500 feet (150 meters) in open space
Operating voltage	2.5 V ~3.3V
Power	CR2032 battery x 2
Current	Current: Scanning 35 mA ; Sleep< 10uA
Size	68(l) x 42(w) x 9(h) millimeters
Weight:	Approx. 17.8 grams (two CR2032 batteries)
Environmental Requirements	
Temperature	Operation: 0°C(32°F)-60°C(140°F) Non-operation: -20°C(-4°F)-80°C(176°F)
Humidity(non-condensing)	Operation: 0°C(32°F)-60°C(140°F) Non-operation: -20°C(-4°F)-80°C(176°F)

Care and Maintenance

- For cleaning, you are advised to use a soft, slightly moistened cloth.
- Avoid using solvents or abrasive substances.
- Do not open the device for maintenance, consult qualified staff only.

Note: Design and specifications are subject to change without notice.

7. Radio and TV Interference Statement

WARNING!!! This equipment generates, uses and can radiate radio frequency energy and, if not installed and used in accordance with the instruction manual, may cause interference to radio communications. This equipment has been tested and found to comply with the limits for a Class B computing device pursuant to subpart J of Part 15 of FCC Rules, which are designed to provide reasonable protection against such interference when operated in a commercial environment. Operation of this equipment in a residential area is likely to cause interference, in which case the user at their own expense will be required to take whatever measures may be required to correct the interference.

8. Limited Warranty

IN NO EVENT SHALL THE DIRECT VENDOR'S LIABILITY FOR DIRECT, INDIRECT, SPECIAL, INCIDENTAL OR CONSEQUENTIAL DAMAGES RESULTING FROM THE USE OF THE PRODUCT, DISK, OR ITS DOCUMENTATION EXCEED THE PRICE PAID FOR THE PRODUCT.

The direct vendor makes no warranty or representation, expressed, implied, or statutory with respect to the contents or use of this documentation, and especially disclaims its quality, performance, merchantability, or fitness for any particular purpose.

The direct vendor also reserves the right to revise or update the device or documentation without obligation to notify any individual or entity of such revisions, or updates. For further inquiries please contact your direct vendor.

WiFi HotSpot Explorer

Quick Start Guide (GWF001)

Read this guide thoroughly and follow the installation and operation procedures carefully to prevent any damage to the unit and/or any of the devices it connects to.

Package contains:
(1) GWF001 WiFi HotSpots Explorer
(2) CR2032 batteries
(1) Quick Start Guide
(1) Warranty/Registration Card

Copyright © 2005 IOGEAR
All brand names and trademarks are the registered property of their respective owners
Part No. Q0327



Free Manuals Download Website

<http://myh66.com>

<http://usermanuals.us>

<http://www.somanuals.com>

<http://www.4manuals.cc>

<http://www.manual-lib.com>

<http://www.404manual.com>

<http://www.luxmanual.com>

<http://aubethermostatmanual.com>

Golf course search by state

<http://golfingnear.com>

Email search by domain

<http://emailbydomain.com>

Auto manuals search

<http://auto.somanuals.com>

TV manuals search

<http://tv.somanuals.com>