

MP3 DIGITAL AUDIO FM TUNER

iRiver SHOCK FREE

Plays Windows Media™

COMPACT disc DIGITAL AUDIO

Instruction Manual

MULTI - CODEC CD PLAYER / FM TUNER

Model iMP-900

iRiver SlimX™

Model iMP-900

<http://www.iRiver.com>

iRiver



Firmware Upgradable

Thank you for purchasing the product.
Please read the manual carefully before use.

<http://www.iRiver.com>

Welcome

Welcome to iRiver Website

Thank you for your iRiver purchase.
The iMP-900 comes complete with a long list of advanced features.
It is important that you read the manual to ensure that you get the most out of your new player.



<http://www.iRiver.com>

- URL : www.iRiver.com
- Find information on our company, products, and customer and technical support.
- Update your player with firmware downloads. Firmware upgrades offer
- Consult the product FAQ.
- Register your iRiver product online so that our Customer Service is able to provide support as efficiently as possible.
- All contents contained in this manual subject to change without notice to improve ability of this player or according to changing of specification.

Copyrights / Certification / Trademarks / Limited Liability

Copyrights

- iRiver Limited has all the rights of the patent, trademark, literary property and intellectual property related to this manual. You may not reproduce any part of this manual unless authorized by iRiver Limited. You can be punished by using any part of this manual illegally.
- The software, audio and video which have an intellectual property are protected by copyright and international laws. It is user s responsibilities when he/she reproduce or distribute the contents created by this product.
- The companies, institutions, products, people and events used in examples are not real data. We don t have any intension to be related with any companies, institutions, products, people and events through this manual and should not draw inferences. Users are responsible for observing the copyrights and intellectual properties.

©1999~2004 iRiver Limited, All right reserved

Certification

- CE, FCC

Trademarks

- Windows, Windows 98 SE, Windows ME, Windows 2000, Windows XP and Windows Media Player are the registered trademarks of Microsoft Corp.

Limited Liability

- Neither the Manufacturer, importers nor dealers is responsible for any accidental damage including bodily injury or any damage resulting from misuse or unsuitable operation by you.
- The information on this manual is prepared with the current product specifications. The manufacturer, iRiver Limited, is adding new features to the product and may persistently apply new technologies hereafter. All standards may be changed at any time without notice.

Handling Notices for Safety

Power

Do not overload a single power circuit.
• Overheating or fire can result.

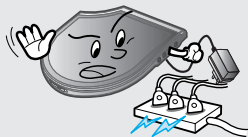

Do not kink or crease the power cable or place heavy objects on the power cable.
• Fire can result from damaged power cables.

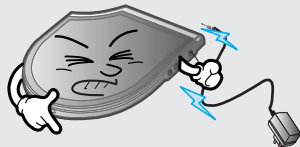

Use only the supplied AC adapter. Use of non-authorized power adapters is not recommended.
• Damage to your player may result from improper use.



Do not handle power plug and adapter with wet hands.
• Electrical Shock may result.

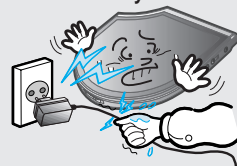

Unplug the AC adapter during electrical storms.
• Electrical Shock may result.



Firmly plug the adapter into the wall socket.
• Fire can result from improper use.

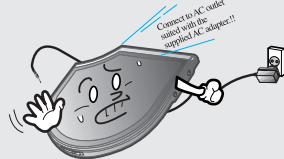

Immediately power off the player and unplug the AC adapter if smoke or odors emit from the player or adapter.
• Electrical Shock or fire can result from improper use.



Unplug adapter when it is not in use.
• Overheating or fire can result from improper use.



Handling Notices for Safety

Player

Keep out of direct sunlight and extreme heat and cold.
• Damage to your player may result from improper use.



Do not use excessive force on the buttons or attempt to disassemble the device.
• Damage to your player may result from improper use.



Keep the player away from strong magnets or excessive vibration or dropping any material.
• Damage to your player may result from improper use.

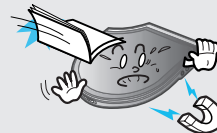

Do not place objects inside the device other than CD's.
• Damage to your player may result from improper use.



Do not use water or chemicals to clean the player.
Clean the surface with a soft cloth.
• Damage to your player may result from improper use.



Keep away from harsh environments including humid, dusty, and smoky areas.
• Damage to your player may result from improper use.



Do not place heavy objects on the device.
• Damage to your player may result from improper use.



Do not drop or subject the device to impact.
• Damage to your player may result from improper use.



Handling Notices for Safety

Player

Do not disassemble or modify.

- Damage to your player may result from improper use.



Avoid contacting the player with water or chemicals.

- Damage to the internal parts of the player may occur. If your player gets wet, dry the outside with a soft cloth as soon as possible.



Battery (for using external battery)

Do not use a new battery with a discharged battery in the device. Always replace all batteries at the same time.

- Damage to your player may result from improper use.



Do not use different types of batteries together.

- Damage to your player may result from improper use.



Handling Notices for Safety

Others

Do not use headphones / earphones while cycling, driving, or operating any motorized vehicle.

- It is dangerous and is illegal in some areas.



Reduce volume while walking, especially at pedestrian crosswalk.

- It is dangerous and is illegal in some areas.



Do not use at high volume for continuous listening.

- Hearing experts advise against listening to continuous, loud and extended play.



Reduce volume or stop using the player if you experience a ringing in your ears.

- Hearing experts advise against listening to continuous, loud and extended play.



Keep headphones / earphones cords under control at all times.

- Cords may get caught on a variety of objects and cause damage or injury.



Included earphones include soft covers for your comfort. They may be used with or without covers at your preference.



Features of iMP-900

- ◆ Slim Design - Depth : 13.7 mm
- ◆ Multi-Codec CD Player
Supports MP3, WMA, OGG and ASF formats as well as Standard Audio CD.
- ◆ Enhanced Battery Life
With MP3 or WMA files, the iMP-900 can play for up to 120 hours (Using the internal batteries and external battery pack). (External Battery Pack : AA Size x 4)
(When using internal battery : 30hours)
- ◆ Firmware Upgradeable
Provides the latest updated features via firmware upgrade.
- ◆ Graphic LCD supporting Multiple Languages- support 40 languages
iMP-900 comes with 4 line graphic LCD which can support multiple languages (40 languages) including traditional and simplified Chinese.
- ◆ Built-in Recharging with Over Charge Protection Circuit
Over Charge protection circuit prevents over powering the batteries.
Discharging function helps to maximize battery life.
- ◆ iRiver Shock Free Anti-Shock System+ESP function
Using exclusive iRiver anti-skip technology, the iMP-900 provides maximum skip protection by buffering your music before playback.
- ◆ Built in 6 Preset EQ
Normal, Rock, Jazz, Classic, U Bass, Metal
- ◆ Xtreme EQ and Xtreme 3D
Customize your own EQ with Xtreme EQ and enhance bass and surround sound with Xtreme 3D.
- ◆ FM Tuner
Auto scanning and frequency memory function make it easy for you to listen to the FM Radio.
- ◆ Recognize Discs in Packet Write or Multi session Format
- ◆ WinAmp Playlist support.
iMP-900 supports Winamp M3U Playlists. (maximum 20 lists)
- ◆ GUI (Graphic User Interface) Menu System

Components

1 iMP-900 Player

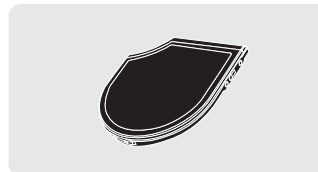

2 Remote Control

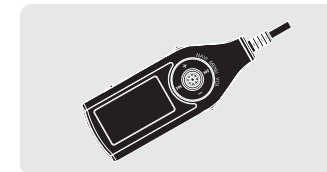

3 User Manual/Warranty card Quick Start Guide



4 Earphones/ Earphone covers

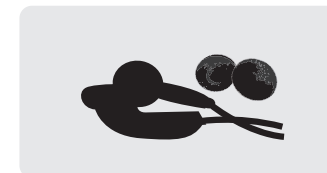

5 AC Adapter (4.5V)



6 Carrying Case

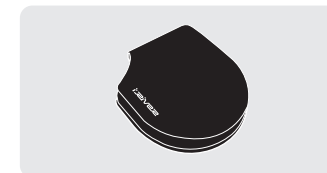

7 Rechargeable Batteries (Stick Type x 2)

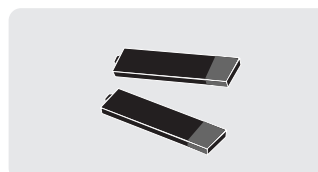

8 External Battery Pack

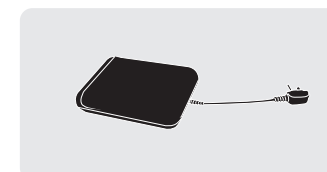

※ Accessories subject to change without notice and may vary from image shown.

Locating the controls

Player-Front View

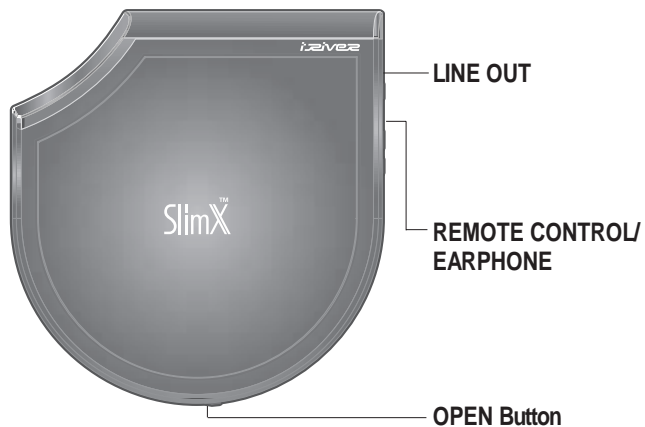

Locating the controls

Player-Inside View

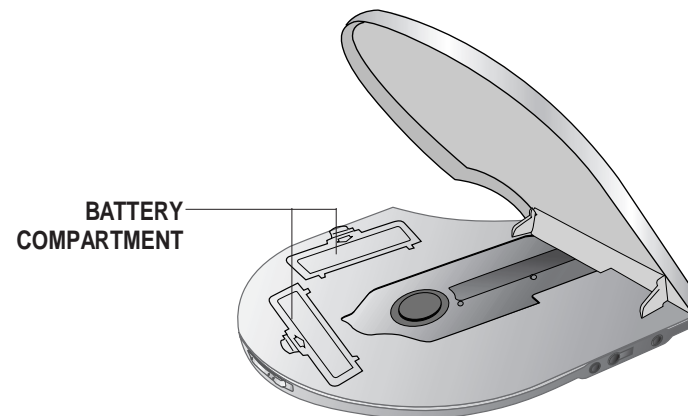

Player-Rear View

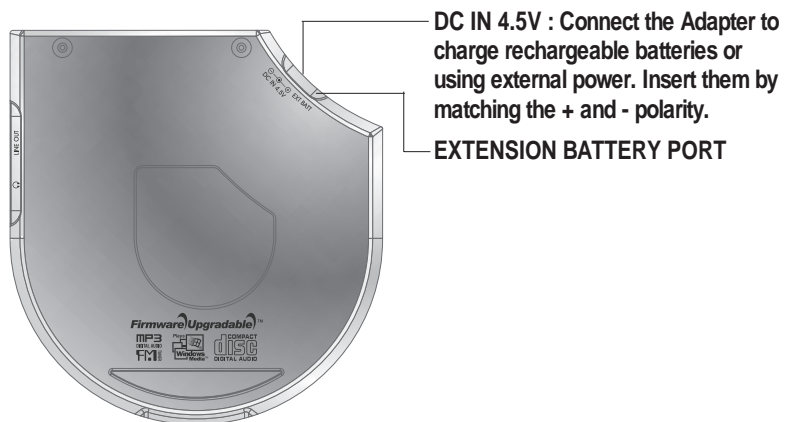

Locating the controls

Remote Control

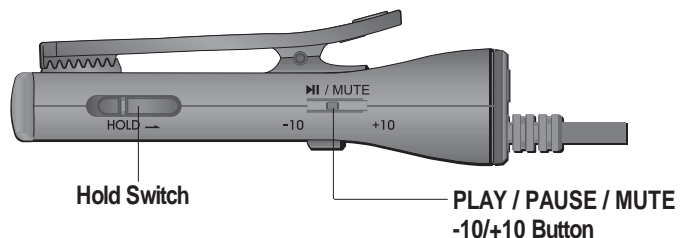

POWER ON,
NAVI / MENU,
PRESET Button

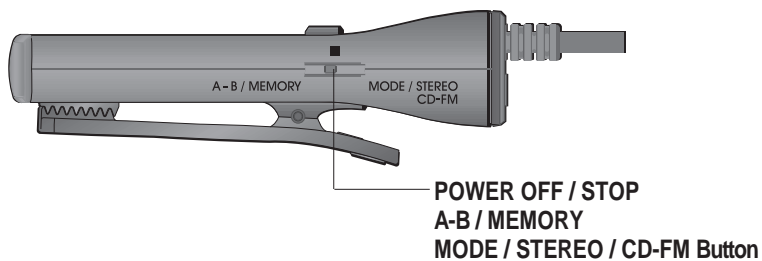
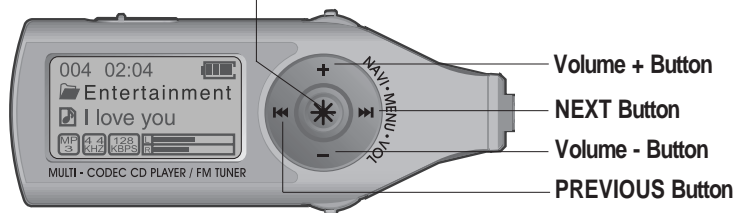

LCD screen display

Music Mode

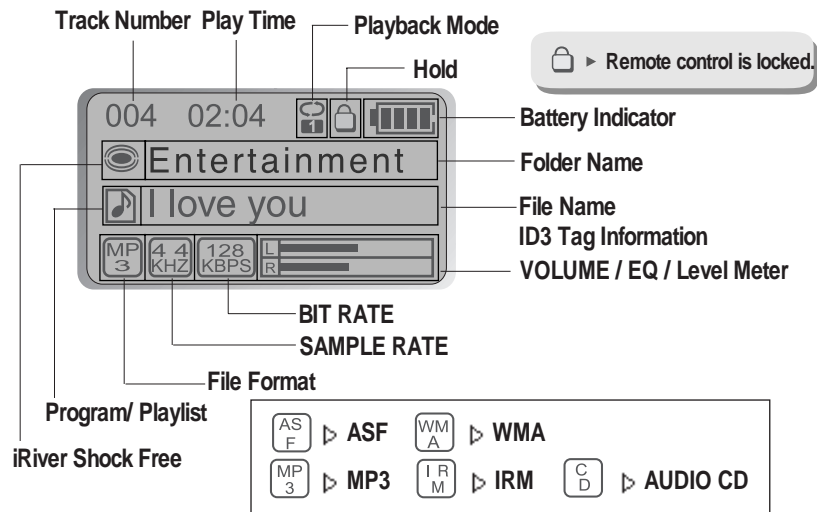

※ IRM (iRiver Rights Management)

iRiver Rights Management is a digital music format.
Please visit our web site for details about this music format.

FM Mode

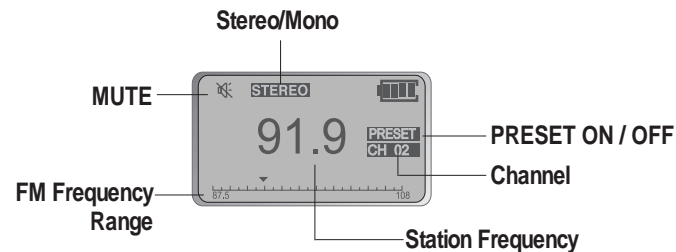

Connecting player

Charging with AC Adapter

- 1 Use only the AC Power Adapter supplied with the player for safety.
- 2 Connect the AC adapter to the 5.0V DC jack on the player first and then into AC outlet. (AC adapter of this player is for 100~240V, 50~60Hz.)
- 3 The player will charge automatically when the player turns on after connecting the AC adapter to the player. (Refer to page 17~18 for details)



Using the rechargeable Batteries

- 1 Open the battery cover on the inside of the player.
- 2 Insert rechargeable batteries (Stick type x 2ea) matching + and - and close the battery cover.

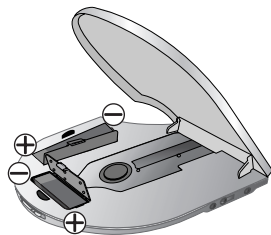

Tip

- When the battery level is low
 - It beeps every 10 minutes. (Beep sound can be on/off. For details, please refer to page 54)
 - iMP-900 may not function properly. Replacing battery or charging is recommended

Connecting player

Using the External Battery Pack

- 1 Open the battery cover on the external battery pack as below figure.

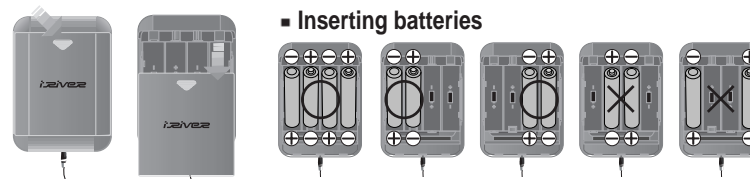

Inserting batteries

- 2 Connect the external battery pack as shown in the right figure.



AA size battery x 4EA

CAUTION!

- Do not use mixed with new batteries and used batteries.
- Do not use different types of batteries together.
- When the batteries are not to be used for a long time, remove them.
- If battery leaks, remove them.
- If battery leaks, wipe off any residue in the battery compartment and insert new batteries.
- Do not recharge a normal battery.
- The internal and external batteries are used simultaneously, the batteries can be charged according to batteries' condition.

Connect Remote control / Earphones

- 1 Connect remote control cable to the player as shown on below diagram.
- 2 Connect earphone to the earphones jack of remote control.

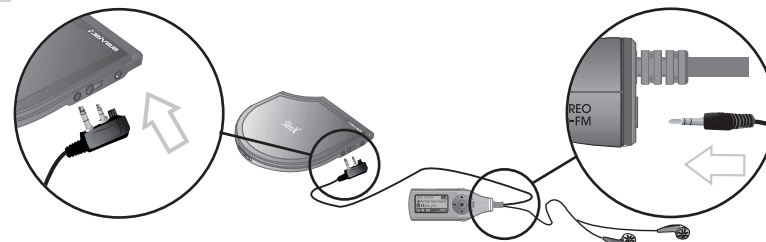

Connecting player

Recharging Method

- 1 Insert rechargeable batteries into the battery compartment of the player
- 2 Connect the AC adapter to the player.
- 3 Press **▶▶** button to power on the player and then it starts to charge.
It may be necessary to set the CHARGE FUNCTION to "CHARGE ON".(Refer to page 41)
- 4 **◀◀** → **◀◀◀** → **◀◀◀◀** is scrolled when charging during playback.
- 5 Press and hold the **■** button during playback to enter the standard charging mode (see below image)

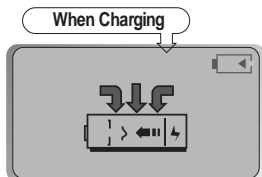

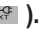
- 6 Once fully charged, charging is automatically stopped.
- After charging is completed during playback mode, charging indicator (**◀◀◀◀**) is changed to adapter indicator ().
 - The player automatically powers off when done charging. (except when charging during playback.)
 - Once fully charged, the player will not try and charge the batteries.

Tip

- Charging/Discharging time (Estimated with the rechargeable stick batteries provided)
Charging : Approx. 4 hours (At full discharge)
Discharging : Approx. 5 hours (At full charge)
- For long duration of battery life, we recommend selecting the Discharge/Charge function once a month.

Connecting player

Discharge & Charge

- 1 Install rechargeable batteries.
- 2 Connect the AC adapter to the player.
- 3 Press **▶▶** button to power on the player and set the "CHARGE FUNCTION to DISCHARGE & CHARGE" to charge after discharging.(Refer to page 41)
- 4 **▶▶** → **▶▶▶** → **▶▶▶▶** is scrolled when discharging during playback.
- 5 Press and hold the **■** button during playback to enter the standard discharging mode (see below image)

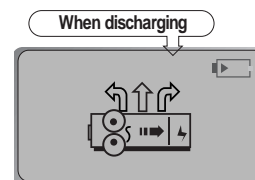

- 6 After discharging is complete the player will switch to CHARGE mode and CHARGE function in the menu is changed to "CHARGE ON".
- 7 Once fully charged, charging is automatically stopped.

- After charging is completed at the playback mode, charging indicator(**◀◀◀◀**) is changed to adapter indicator().
- The player automatically powers off when done charging. (except during playback.)

Tip

- To make your batteries last longer.
 - Set the SORT to "PHYSICAL ADDR"
 - Set the TAG INFORMATION to "OFF".
 - Set the EQ mode to NORMAL, ROCK, JAZZ or CLASSIC.
 - Set the BACK-LIGHTING time to the shortest possible.
 - Set the SHUFFLE mode to OFF.

Listening to Music

Basic Operation

- 1 Slide the open button on the side of the player and insert the disc with the disc label facing out. Close the lid.

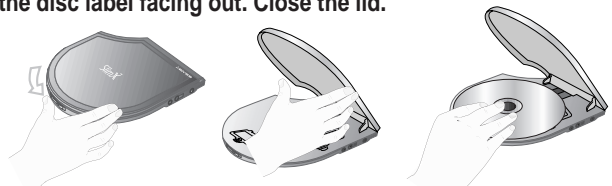

- 2 Connect Remote Control and Earphones.

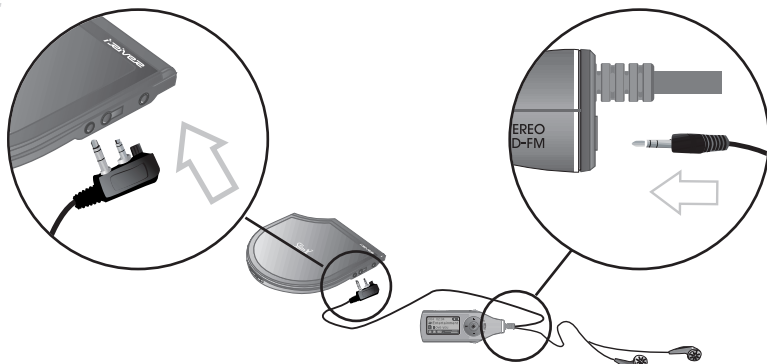

- 3 Slide the HOLD switch on the remote to the Off position.

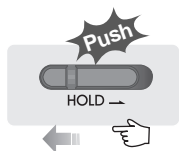

- 4 Press the NAVI/MENU button to play.
After powering on, the disc will play automatically.



- ◆ To play while in stop mode



Listening to Music

Basic Operation

- 5 Press the **▶||** button to play music for pause and press it again to resume playback.

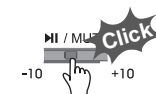

- 6 Push the NAVI/MENU switch toward + or - to adjust the volume.

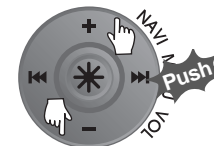

- 7 Push the NAVI/MENU switch toward **◀◀** or **▶▶** to skip to previous or next track.

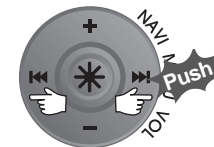

- 8 Push and hold the NAVI/MENU switch toward **◀◀** or **▶▶** to play fast-backward or fast-forward within a track.

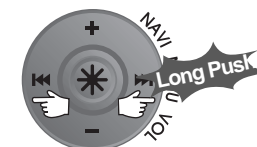

- 9 Push and hold after pushing the NAVI/MENU switch toward **◀◀** or **▶▶** to skip to the previous or next folder.

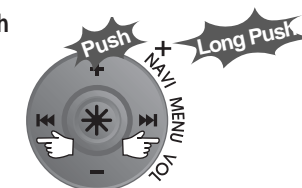

NOTE

- ◆ Refer to page 27 for details about searching the music.

Operating the FM Tuner

Listen to FM radio (Frequency Range 87.5MHz ~ 108 MHz)

- 1 Press the NAVI / MENU button to power on the player. To switch to the FM Tuner, push and hold  switch toward MODE/STEREO/CD-FM.



- 2 Push the NAVI/MENU switch toward  or  to select your desired station.



- 3 Push  switch toward MODE/STEREO/CD-FM to select Stereo or Mono.

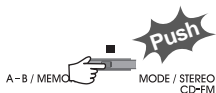

- 4 Push the NAVI/MENU switch toward + or - to adjust the volume.

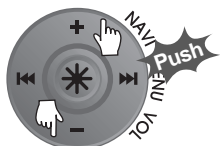





- 5 Press the  button to Mute the radio. and press it again to release.



Operating the FM Tuner

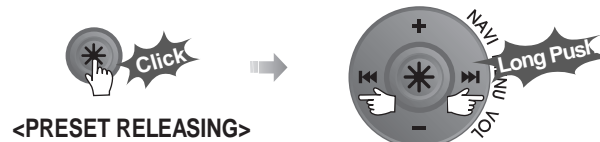

Auto Scan function

To Auto Scan for a station, release the PRESET mode by pressing the NAVI/MENU button. Push and hold the NAVI/MENU switch toward  or . Find the station by scrolling  or .



<PRESET RELEASING>

Finding a Station using PRESET Mode

To select a station saved in memory, press the NAVI/MENU button to enter PRESET mode then find a saved station by pushing the NAVI/MENU switch toward  or .



<PRESET SETTING>

Example)



- ▶ FM tuner reception will be affected in weak reception areas.
- ▶ When player does not have any preset channels, EMPTY will be displayed at preset mode then fade out.

Operating the FM Tuner

Memory function (Store favorite stations)

- 1 Push the NAVI button to release PRESET mode, select the station by pushing the NAVI/MENU switch toward **◀◀** or **▶▶**.
- 2 Push the **■** switch toward A-B/MEMORY to select a channel number to assign to the frequency. Push it toward A-B/MEMORY to save the station again.

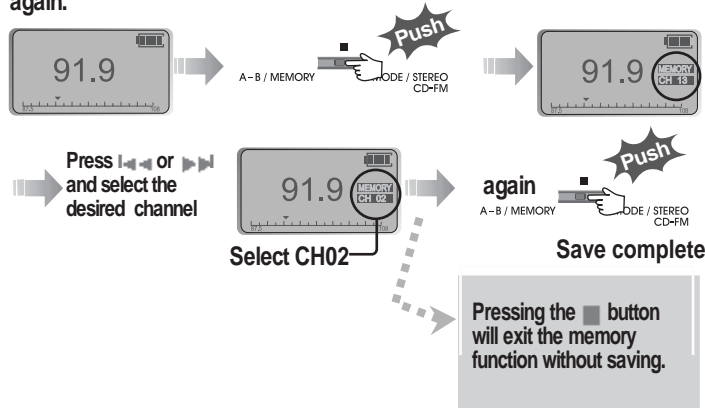

- 3 Up to 20 channels can be memorized.

Auto memory function : (To save the Channels automatically)

Push the NAVI button to release PRESET, push the **■** switch toward A-B/MEMORY. CH01 to CH20 will be saved automatically with the first 20 stations the player finds.



NOTE

- It may not be saved in weak reception areas.

Operating the FM Tuner

Memory delete function (Delete saved channels)

- 1 Select channel to be deleted by pushing the NAVI/MENU switch toward **◀◀** or **▶▶** at preset mode.

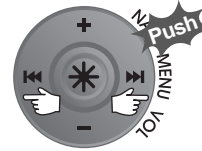

- 2 Push and hold the **■** switch toward A-B/MEMORY to delete the selected station.

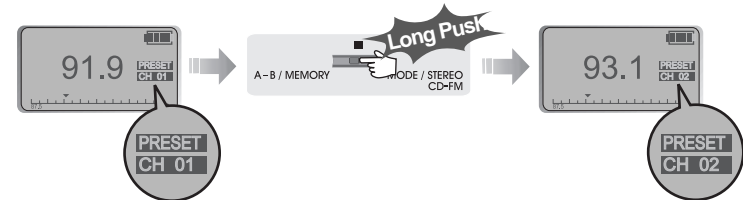

- 3 The next channel will appear when channel delete is completed. Push and hold the **■** switch toward A-B/MEMORY. if you want to delete the next channel also.

Navigation mode

Navigation Mode

1 Press the NAVI/MENU button to display the list of audio tracks. The current track will also be displayed.

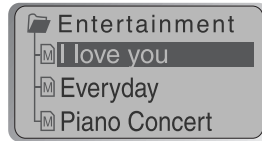

2 Push the NAVI/MENU button toward \lll or \ggg to select a track or folder to play. You can easily select a track using the \ggg switch toward -10/+10 in case there are many tracks on the CD.

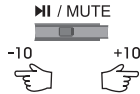
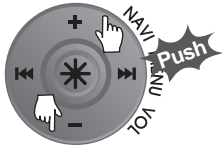

3 Press the NAVI/MENU, \ggg button or the NAVI/MENU switch toward \ggg to move to the upper folder and toward \lll to move the lower folder.

4 Press the NAVI/MENU, \ggg button or the NAVI/MENU switch toward \lll or \ggg to play the selected file.



or



or



File format



▷ ASF



▷ WMA



▷ IRM



▷ MP3



▷ CD

※ IRM (iRiver Rights Management)

iRiver Rights Management is a digital music format.

Please visit our web site for details about this music format.

EQ Mode

EQ Mode

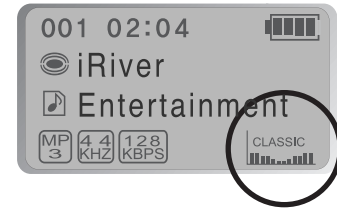
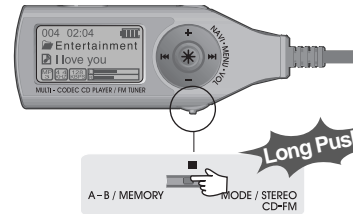

Push and hold the \blacksquare switch toward A-B/MEMORY to display the current EQ. Every time you push this button, the EQ mode scrolls in sequential order.

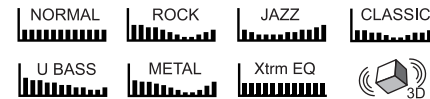

NOTE Xtreme EQ and 3D are set in the MENU, refer to page 51 through 52 for details.

NOTE With EQ SELECT MENU, user can set only desired EQ function. Refer to page 54 for setting the EQ SELECT.

Playback Mode



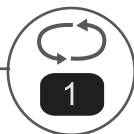
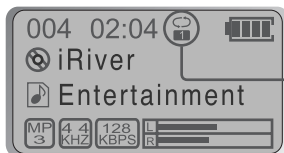

Setting the Playback Mode

You can set various Repeat and Shuffle options by choosing these selections under Mode. Change the Repeat or Shuffle mode by pushing the  switch toward MODE/STEREO/CD-FM. Please refer to the MENU-MODE function controls (page 48) for user-defined configuration.









◀ Whenever the  switch is pushed toward MODE/STEREO/CD-FM, the icon in the playback mode indicator is changed.



REPEAT

	Play a selected track repeatedly.
	Play all tracks in the selected folder and stop.
	Play all tracks in the selected folder repeatedly.
	Play all tracks stored in the CD repeatedly.

SHUFFLE

SFL	Randomly play all tracks in the player and stop.
SFL 	Play a single track repeatedly. Press  or  to select a new random track.
SFL 	Randomly play all tracks in the selected folder and stop.
SFL 	Randomly play all tracks in the selected folder repeatedly.
SFL 	Randomly play all tracks in the CD repeatedly.

INTRO

	INTRO: Plays the beginning 10 seconds of each track in sequential order.
	INTRO HIGHLIGHT: Plays 10 seconds from 1 minute into each track in sequential order. You can set this function in the MENU function.

Interval Repeat / Reservation

Interval Repeat (A-B)

Play a selected interval repeatedly during play.

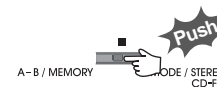
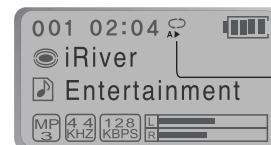

Push the button toward A-B/MEMORY once to select the beginning <A> point.

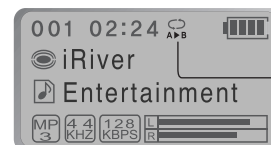

Press the button toward A-B/MEMORY again to select the ending point.

▲ A-B interval will be repeated.

Reservation

Press the NAVI/MENU button during playback to select the next song to be played, then push the  switch toward A-B/MEMORY to queue that song.

Ex)
Press NAVI/MENU
button during playback,



After selecting the song to play next by using Volume + or Volume - button, then push the  switch toward A-B/MEMORY.



Program Playback

Activating Program mode

Program Mode allows you to program a list of songs to play.

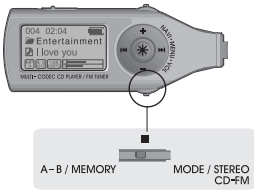

1 While in Stop Mode, push the **■** switch toward A-B/MEMORY to enter Program Mode.



Change to Program mode ▶

NOTE

- Program mode is activated while in Stop Mode.
- Repeat A-B is activated while in Play Mode.



2 Press the NAVI/MENU button again to display the file list. After selecting the desired track using the Volume +, Volume - or -10, +10 button, push the **■** switch toward A-B/MEMORY.

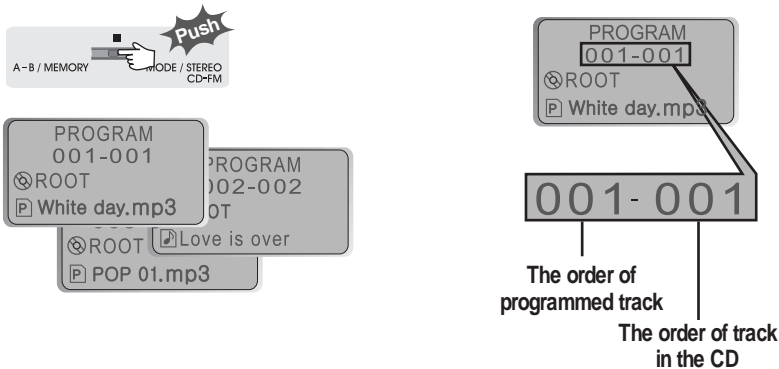

Program Playback

NOTE

- To add all the songs in a certain folder, use the NAVI/MENU button and select the folder using **◀◀** or **▶▶** button and then push the **■** switch toward A-B/MEMORY. (Subfolders can not be added.)
- To remove a programmed song Push the **■** switch toward MODE/STEREO/CD-FM. The program list will be updated automatically.

Program Playback

After programming, press **HI / MUTE** to play the tracks in sequential order.



The program mode icon appears ▶

Cancel Program Mode

■ While Playing

Press the **■** button twice to cancel the program.

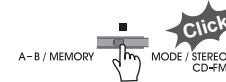

■ While in Stop Mode

Press the button twice to cancel the program.



-10/+10 function

-10/+10 function

During playback, press the **▶||** switch toward -10 (+10) to go backward (forward) 10 tracks.

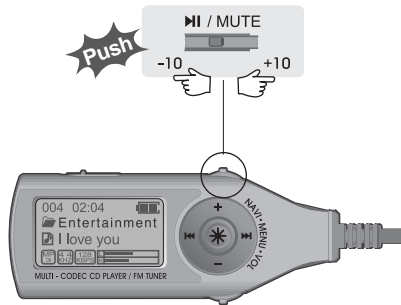

iRiver Shock Free

Push and hold the **▶||** switch toward +10 to activate or release the iRiver Shock Free Mode.

NOTE

iRiver Shock Free

This is the function to prevent skipping when playing a Standard Audio CD. In case the CD is dirty or defective, iRiver Shock Free may skip more than normal operation. In this case, use the player after cancelling the iRiver Shock Free.

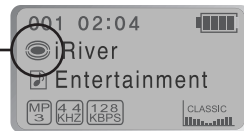

Pressing the Mode button for a few seconds while playing will set the Enhanced Anti-shock on and off.

BOOKMARK feature

BOOKMARK

This function allows you to BOOKMARK parts of a track for easier searching of long audio segments.

Bookmark function is activated under the Study mode. (Refer to page 49 for Study mode.)

Long pushing of the **▶||** switch toward -10 will add / delete / move the bookmark.

Bookmarks can be reserved up to 20 per disc. A beep will represent the number of the indicated bookmark. (One beep for 1, two beeps for 2, etc.).

- **Bookmark Add** : After long pushing the **▶||** switch toward A-B/MEMORY and push the **▶||** switch toward A-B/MEMORY to add the present location into the bookmark.

- **Bookmark Delete** : After long pushing the **▶||** switch toward -10 and push the **▶||** switch toward MODE/STEREO/CD-FM to delete the present location from the bookmark.

Whenever you push the **▶||** switch toward MODE/STEREO/CD-FM, the bookmark will be deleted in backward sequence.

- **Moving to next bookmark** : After long pushing the **▶||** switch toward -10 and push the NAVI/MENU switch toward **▶▶** to move to the next bookmark.

Moving to previous bookmark : After long pushing the **▶||** switch toward -10 and push the NAVI/MENU switch toward **◀◀** to move to the previous bookmark.

Other features (Playlist)

How to use WINAMP PLAYLIST

The player can play a Playlist (*.M3U) file on the disk.

1 Make a PLAYLIST (*.M3U) using WINAMP.

Note : WINAMP software is not included with the player.

▼ Winamp execution picture

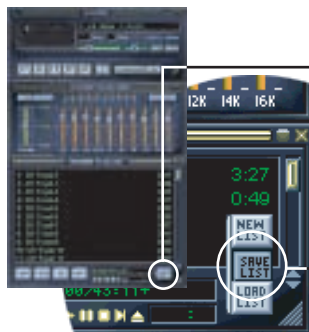

1. Launch WINAMP and add songs to make a list.

2. Click "LIST OPTS" located on the right bottom and click "SAVE LIST"

▲ Click the SAVE LIST button.

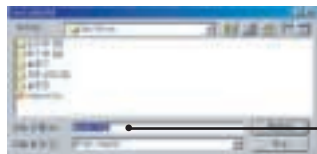

3. Name the file name (ex: iriver.m3u) and click "SAVE" to save the list.

2 Burn the disc with WinAmp play list and related files.

3 Load the disc into iMP-900.

4 Push the  switch toward A-B/MEMORY at stop mode and LCD displays a list of M3U playlist files on the disk. You can find the playlist you want to play by using the Volume + or Volume - button.

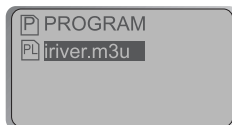

Other features (Playlist)

How to use WINAMP PLAYLIST

5 Press the NAVI/MENU or  button to play the tracks in the order of the playlist.



PL icon indicates PLAY LIST. ▶



6 A total of 20 playlists can be recognized.

Menu

Configuration



Function Control is subject to change with different firmware versions. You can configure your own settings.

GENERAL

- resume
- language
- cd esp
- sort
- charge function
- multi session
- password
- load default

DISPLAY

- back light
- lcd contrast
- visualization
- tag information
- time
- battery indicator

TIMER

- sleep
- pwr off

CONTROL

- FF/RW scan
- FF/RW skip
- FF/RW scan speed
- scroll speed
- +/-10 button
- auto pause

MODE

- repeat
- shuffle
- intro
- study
- name

User EQ

- Xtreme EQ
- Xtreme 3D
- DBE setting
- 3D EQ setting
- adapter volume
- sound volume
- EQ limit
- auto EQ setting
- EQ select
- beep volume
- fade in

Menu Operation

- Press and hold the NAVI button to display the menus.
- It is composed of 6 main menus with sub-menus.

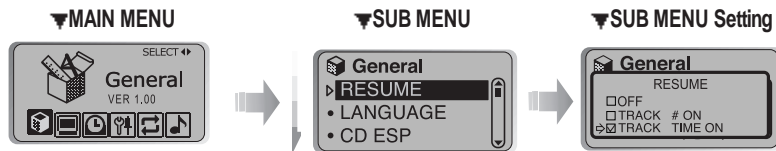

- When you select a sub menu, you can set your preference to be displayed.

Menu operation

To select Main Menu

- Shift between Main Menus

Press the button to move to previous menu, press the button to move to next menu.

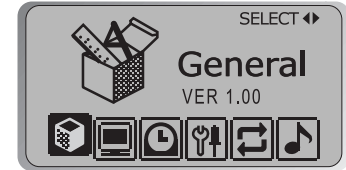
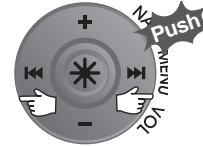

- From Main Menu to Sub Menu

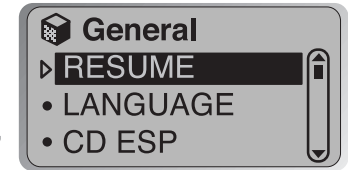
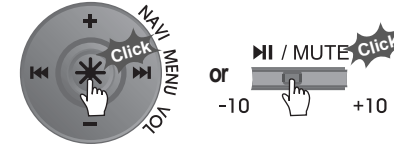

- Push the NAVI/MENU switch toward or (or Volume +, Volume -) to scroll between Sub Menu.

To select Sub Menu

- From Sub Menu to Sub Menu settings

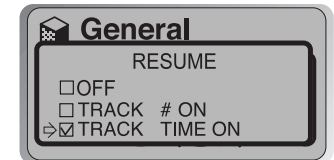
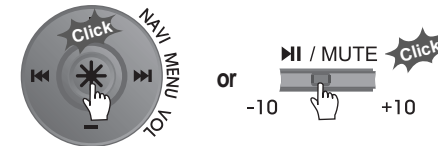

- Push the NAVI/MENU switch toward or (or Volume +, Volume -) to scroll between Sub Menu settings.



Menu operation

Exit Main Menu

◆ To exit Main Menu

Press the STOP(■) button at the initial setting menu to exit Function Control Mode.

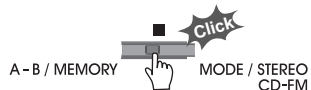

Exit Sub Menu

◆ To exit Sub Menu

Press the STOP(■) button to exit the sub menu and to display the initial setting menu.

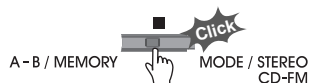

Exit Sub Menu Settings

◆ To save and exit Sub Menu Settings

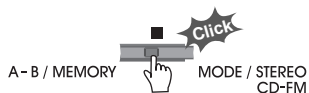

MENU-General

GENERAL



Resume

You can select how to resume the last track played. "Track #" plays the beginning of the last track played, while "Track Time" resumes to the exact position in the song.

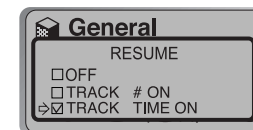

Language

Song title and ID3 tag information for the CD is dependent on the version of the PC operating system that was used to create it.

(For example, if a CD is created in a Korean version of Windows, the language setting should be Korean for proper title display)

(supports 40 languages)

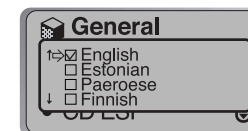

CD ESP

This is the function to prevent skipping when playing a Standard Audio CD.

For best sound quality, it is recommended to use the 40 SEC option, for maximum skip protection, 160 SEC option is suggested.

If 160 SEC is selected, the sound quality of the music will be degraded due to higher compression of the music in comparison with 40 SEC.

MP3 CD (128Kbps, 44KHz) is always operated 480sec option.

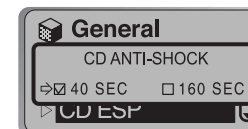

MENU-General

SORT

SORT

You should set sort while the player is stopped.
If directory structure is like as right picture, the setting order is like as follows.

BREADTH FIRST : ROOT → A → B → C → D

DEPTH FIRST : ROOT → A → C → D → B

PHYSICAL ADDR. : It is sorted as the sequence of recording order independent of directory structure.

* You should set sort at stop mode.

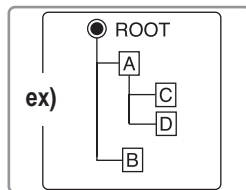
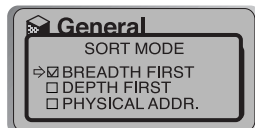

CHARGE FUNCTION

Select Charging or discharging for rechargeable batteries.

OFF : The player will not charge.

CHARGE ON : Select to enable the player to charge the internal batteries.

DISCHARGE & CHARGE : Charge after full discharging the internal batteries.

When discharging is completed, this setting will change to CHARGE ON.
(Refer to page 17~18)

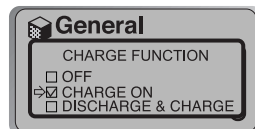

MULTI SESSION

OFF : the player will not read Multi Session written disks.

ON : the player will read Multi Session disks.

If you are not using audio CD's created in Multi Session format, set this feature to OFF to shorten the access time of your CDs.

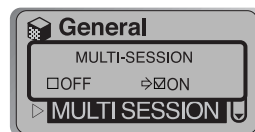

MENU-General

PASSWORD

OFF : Password function is not activated.

ON : Password function is activated.

CHANGE : To change the Password

- Refer to page 55~56.

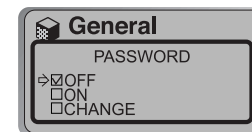

LOAD DEFAULT VALUE

Initialize to original factory setting.

Select "YES", then push the NAVI/MENU or ► button to initialize.

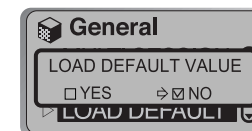

MENU-Display

Display

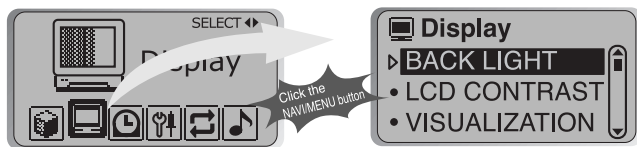

BACK-LIGHT

Select the back-lighting time.
Adjust the lighting time (1~20Sec) by using **⏪** and **⏩** (or Volume +, Volume -) button.
0 : Backlight is off.
21 : Backlight is always on.

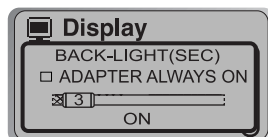

ADAPTER ALWAYS ON : Select it by using **▶** button. If the adapter is connected, backlight is always on.

LCD CONTRAST

Adjust LCD contrast of remote control.
Contrast can be adjusted by using the **⏪** and **⏩** (or Volume +, Volume -) buttons.

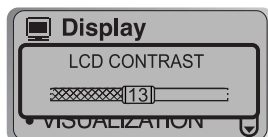

VISUALIZATION

Visualizes audio signal at play mode.

- LEVEL METER 1 ▶
- LEVEL METER 2 ▶
- WAVEFORM ▶
- PROGRESSIVE ▶ 3%

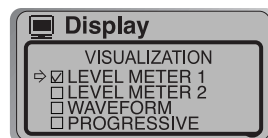

MENU-Display

TAG INFORMATION

ON : Displays track with ID3 tag information or with lyrics if there are lyrics.
OFF : Displays track with file name.

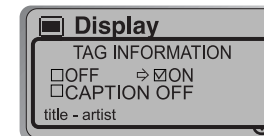

You can select OFF/ON using **▶** button and tag information display preference using **⏪** or **⏩** button.

CAPTION OFF : You can turn off lyric display of synchronized MP3.

PLAY TIME INFO

Normal : display elapsed time of the current track.
Remain : display remaining time of the current track.

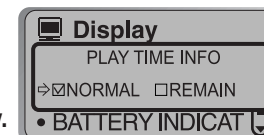

Note : In case of VBR MP3 file, the remaining time may not display accurately.

BATTERY INDICATOR

Adjust the level of the battery indicator to compensate for different style of batteries. Lower numbers will make the battery indicator higher, higher numbers will make the battery indicator lower.

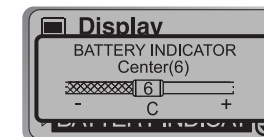

Menu-Timer)

Timer



SLEEP POWER OFF

Automatically powers off after fixed time
(Time range can be set from 0 to 99 minutes).

Use **⏮** or **⏭** button (or Volume +, Volume -) to adjust time.

By using the NAVI/MENU or **⏸** button, you can select beep sound to ON or OFF.

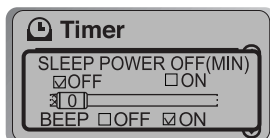

NOTE

- ▷ This function works in both CD and FM modes.
- ▷ When the power is off, the sleep power off setting goes back to Zero setting.

STOP POWER OFF

Automatically turns power off at stop mode.
(Time range can be set from 1 to 60 minutes by one minute increments.)

Use **⏮** or **⏭** button (or Volume +, Volume -) to adjust time.

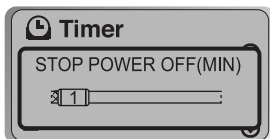

NOTE

- ▷ This function only works in CD function.

MENU-Control

Control

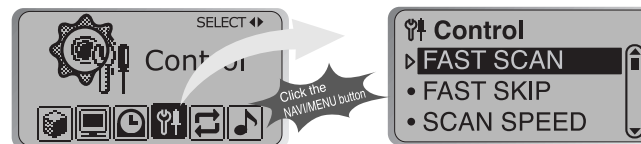

FF/ RW SCAN

ON : Long click of **⏮** or **⏭** button for fast scan within the track.

Short click of **⏮** or **⏭** button for next or previous track.

OFF : Fast Scan through songs in a folder.

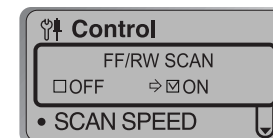

NOTE

As typical with MP3 files, particularly VBR (Variable Bit Rate) files, fast scan may not be as smooth as conventional audio CD.

FF/ RW SKIP

FAST SKIP allows skipping 10 songs or 1 folder forward or backward by pressing and holding the **⏮** or **⏭** buttons.

OFF : Disables the fast skip feature.

10 : Fast skip ahead 10 tracks or back 10 tracks.

Directory : Jump to the Previous/Next folder.

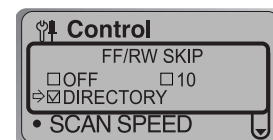

FF/ RW SCAN SPEED

The fast scan speed can range from 1x / 2x / 4x / 6x.

⏮ and **⏭** button can be used for this setting.

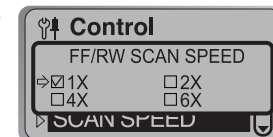

MENU-Control

SCROLL SPEED

Adjust scroll speed of character displayed on the LCD (Title or Singer name) by 1x/2x/4x.

Vertical : The scroll goes from up to down

Horizontal : The scroll goes from the left to the right.

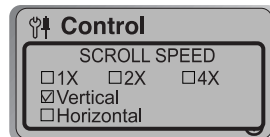

-10/ +10 Button

-/+10 : During playback, go back to the previous 10th track, and push it to +10 to go forward to the next 10th track.

Directory : -/+10 button works as folder skip.

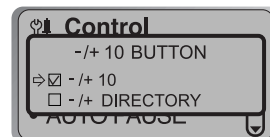

AUTO PAUSE

When Auto Pause is on, the player will automatically pause after a disc loads and after every song is played. you will need to press Play button to resume the playback again.

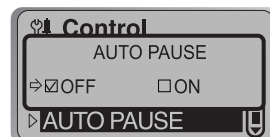

MENU-Mode

PLAYBACK MODE



REPEAT MODE/ SHUFFLE MODE

Allows you to select the modes available when pressing the MODE button during playback.(Multi selection capable)

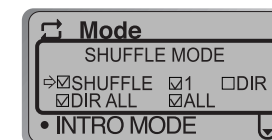
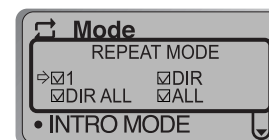

▶ Only the selected play mode will be applied when you press the MODE button (For details, please refer to page 29)

INTRO MODE

Intro : Plays the beginning 10 seconds of each track.

Intro Highlight : Plays 10 seconds at the 1 minute mark of each track in sequential order.



STUDY MODE

STUDY MODE

When click the +/-10 button, it is operated as the set status.

OFF : Skip ahead 10 tracks.

5 SEC : Pushing of the >|| switch toward -10 (+10) will skip the current track 5 seconds ahead or backward.

10 SEC : Pushing of the >|| switch toward -10 (+10) will skip the current track 10 seconds ahead or backward.

BEEP : A beep sound will be played when the buttons are operated.

▷ If it is set to 5 Sec, 10 Sec, BEEP, it is operated as STUDY Mode.

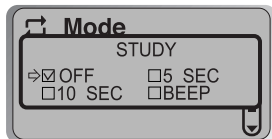

BEEP VOLUME MODE

This mode is for blind persons. A beep sound will be played when the buttons are operated. It is operated as 5 SEC MODE.

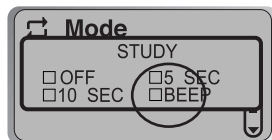

NAME

You can input your name or custom text. (maximum 12 characters in English)

▼ Button Operation



Select the character by using <<< and >>> button and press NAVI/MENU button to input the character.



To move the cursor in the name window, use + and - on Volume button.



To scroll between English and your preferred language, use MODE button

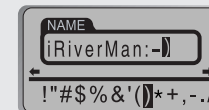

To delete the character, push MODE/STEREO/CD-FM.



To save the text and exit, use PLAY button.

NOTE Chinese and Chinese characters are not supported in the Name feature.

◆ The saved text is displayed during initial loading of disc and at stop mode during play.

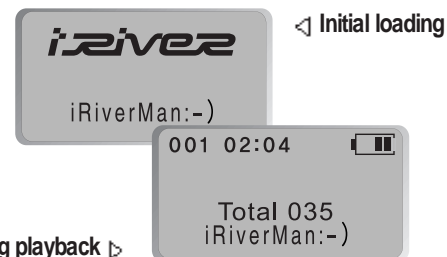

Stop during playback ▷

MENU-Sound

SOUND



Xtreme EQ

You can adjust the sound to your preference. There are 5 band frequency steps, set from -15dB to +15dB by 3dB step.

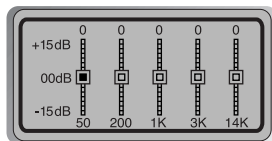

How to set Xtreme EQ

1. Select the Frequency step to set using the **◀◀** , **▶▶** switch.
2. Adjust the level using the **VOL +** or **VOL -** switch.
3. To exit Xtreme EQ setting, press **■** or **NAVI/MENU** button.

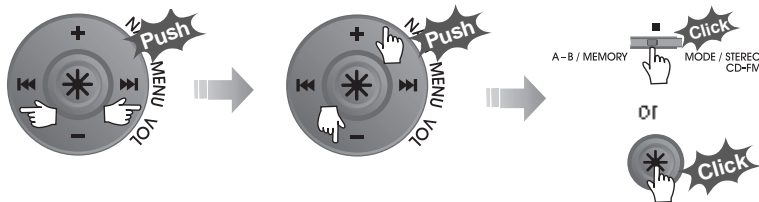

MENU-Sound

Xtreme 3D

You can adjust the level of 3D sound (minimum, Natural, and Maximum). You can extend 3D sound by selecting Bass Boost or 3D EQ. You can also adjust the level of 3D sound with the **◀◀** or **▶▶** (or **VOL +**, **VOL -**) lever. Select **DBE** or **3D EQ** with the **NAVI/MENU** button.

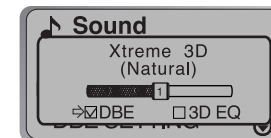

DBE Setting

You can select the Bass Center Band level from Band 1 to 4. You can also set the Bass Boost gain from 0 dB to 15dB by 3dB step.

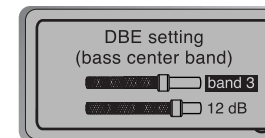

Select band 3 or 12dB with **Volume +** or **Volume -** button (If selected character is highlighted.) and adjust the level with the **◀◀** or **▶▶** (or **VOL +**, **VOL -**) button.

3D EQ Setting

You can adjust the sound to your preference. There are 5 band frequency steps, set from -15dB to +15dB by 3dB step.

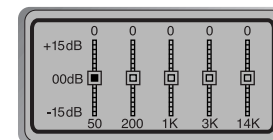

NOTE Operation method is as same as it of Xtreme EQ.

ADAPTER VOLUME

35 ON : Volume will set to 35 when the AC adapter is attached.
OFF : This function is not activated.

This feature is useful when connecting the player to your car or home stereo system.

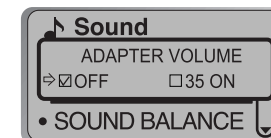

SOUND BALANCE

When Sound Balance bar is moved to L (Left, 0), the sound outputs at the left earphone. When the lever is moved to R (Right, 40) the sound outputs at the right earphone. The default value is 20 and the sound outputs the same level at both earphones.

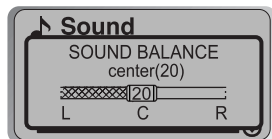

EQ LIMIT

ON : Limit the control of equalizer frequency to prevent distortion of sound.
 OFF : You can enjoy original sound though distortion may occur.

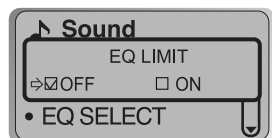

TAG AUTO EQ

Automatically changes EQ by reading the genre of TAG Information.
 ON : Can automatically change EQ by reading the genre of ID3 TAG information.
 OFF : EQ is set by the user.

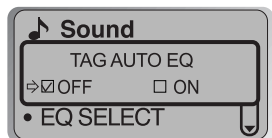

EQ is selected by genre as follows :

- Rock : Classic Rock, Rock, Altern Rock, Instrumental Rock, Southern Rock, Rock & Roll, Hard Rock, Folk Rock, Gothic Rock, Progressive Rock, Psychedelic Rock, Symphonic Rock, Slow Rock, Punk Rock
- Jazz : Jazz, Jazz+Funk, Acid Jazz
- Classic : Classical, Opera, Chamber Music, Sonata, Symphony
- Metal : Metal, Heavy Metal, Death Metal
- Ubass : Bass, Booty Bass

NOTE Tag information saved as Dance and Pop is operated as Normal EQ.

EQ SELECT

You can select various EQ modes. Press NAVI/MENU button after selecting EQ by using **◀◀** or **▶▶** (or VOL +, VOL -) switch.

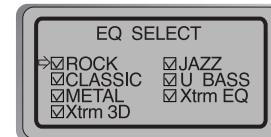

- NOTE**
- You can not select NORMAL EQ.
 - The adjusted EQ is automatically selected when you adjust the EQ setting even though you do not select Xtrm EQ or Xtrm 3D.

BEEP SOUND VOLUME

Set beep volume ON/OFF or level.
 Set to "0" for OFF.

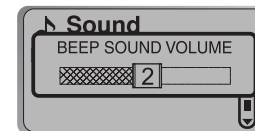

SOUND FADE IN

When activated, volume increases gradually at playback mode to prevent sudden loudness.

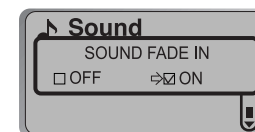

Setting the Password

- 1 Select the menu you want on the "MENU → GENERAL → Password".
(Refer to page 40)

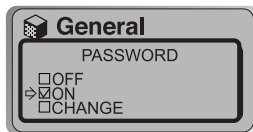

- 2 If you select "ON" on the MENU → GENERAL → Password, the right screen is displayed after loading screen when you turn the player on.



- 3 Press **⏪**, **⏩** (or Volume +, Volume -) to move the numeral and press the **⏩** or NAVI/MENU button to select it. The screen as below is displayed.

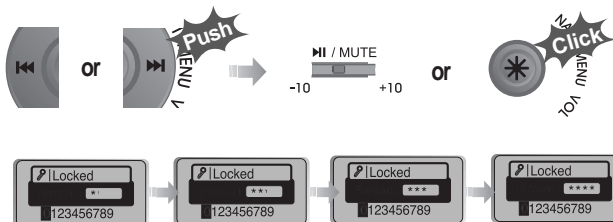

When the input password is correct, the above screen disappears and changes to Total screen. Press the PLAY button to start the playback.

If the password is wrong, the screen goes back to the input screen.

⚠ CAUTION!

- The Password must input as 4 digits.
- The Password is initialized as "0000" when the firmware is upgraded.

Changing the Password

- 1 Select "CHANGE" on the "MENU → GENERAL → Password".
- 2 Input the old password. (The initial password is "0000")

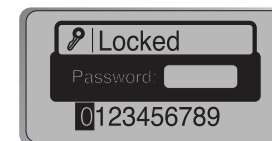
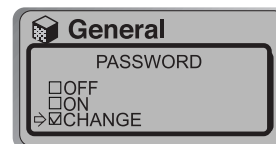

- 3 Input the new password of 4 digits.
- 4 Input the new password of 4 digits to confirm once more.



NOTE

- If the password to change and the password to confirm are the same, the password is automatically changed to the new one and the playback screen is displayed on the LCD.
If you select "ON" on the password menu, you must input the new password to turn on the player.
- If the password to confirm is different from the changed password, the password screen goes back to the Confirm screen.
- Press the STOP button to exit changing the password, and the old password is preserved.
- The Password is initialized as "0000" when the firmware is upgraded.

Firmware Upgradable

Upgrade your firmware at www.iRiver.com.

What is FIRMWARE?

It is the operating system that works in the iMP-900. iRiver provides you with the latest and best features through Firmware Upgrade. Visit www.iRiver.com to upgrade your Firmware.

How to UPGRADE?

1. Download the latest firmware upgrade file from www.iRiver.com.
2. Execute the file after extraction.
3. Burn the iMP-900 HEX file to a CD (be sure there are no other files on this CD).
4. Connect the power adapter to the iMP-900.
(Note : Upgrade the firmware after connecting the adapter)
5. Insert the CD into the iMP-900 and play the CD.
6. Check whether your LCD window shows "Firmware Upgrade"
7. When the power goes off automatically, the upgrade is done.
8. Play your Music Disc and confirm the firmware version information displayed during loading.

Q How long does Anti-Shock last?

A With MP3 files (128Kbps, 44.1Khz), Anti-Shock lasts up to 480 seconds. With Audio CD, you can set it up to 40 or 160 seconds.

Q Mechanical noise is heard from the player.

A When loading a CD or searching music, CD Pick-up makes noise moving at high speed. This is not a malfunction. But if you hear mechanism noise through earphones or hear excessive noise from the player, contact iRiver Customer Service.

Q Does using CD's created on a computer reduce the life of the Lens?

A There is no connection between using a disk created on a home computer and the lifetime of the lens.

Q Why doesn't the player recognize a CD created at high speed?

A In general, it is recommended to record the CD with 1~2 level lower than the highest speed if you are experiencing playback difficulties.

Recording

Q How do I copy MP3 files on to a CD?

A You need to record MP3 files onto a CD-R or CD-RW disc to play in the iMP-900.

In general, there are two kinds of blank CDs.

CD-R (CD Recordable): Recordable but not erasable.

CD-RW (CD-ReWritable) : Recordable and can be used again after erasing.

There are several ways to burn a CD. A CD is created in sessions.

Single session: Close session after burning once.

Multi session: Do not close session after burning. More data can be written to the disk later.

This iRiver player can play packet-written CD RW's as well.

Q What do I need to burn MP3 files?

A You need a CD recorder, recording software program, and a blank CD. For details, refer to the "SUPPORT" at iRiver's homepage.

Q How do I make a CD from a tape or record?

A To convert the tape's information into CD requires many items, including:

A player to play the tape or record, a stereo cable to attach the player to your computer, and third party recording software to capture and edit the audio.

Connect the stereo cable from the source to the line-in input on your computer sound card; then use the third party software to record and edit the audio on the tape or record.

Once the music is recorded onto your computer, use a program to copy the music in Audio or MP3 format to a CD.

Q I recorded an MP3 CD but I only see less than 20 songs.

A The CD was probably created as an Audio CD's will only hold about 15~20 songs. To record a CD full of MP3's be sure to set your CD creation software to record Data.

Recording

Q The player can't read songs and I get 'No disc' message.

A CD readability depends on several factors:

1. CD-Media
2. The Burning/Recording Speed
3. The CD surface

When you create a CD, burning speed does matter as well as CD surface. When you create a CD at a high speed, the data writing may not be reliable. In that case, it is recommended to create a CD at a lower speed or to use brand name media.

Q Can I add songs to the CD I already burned?

A Using multi-session or packet writing allows you to add songs to the CD.

Questions and Answers

Playing

- Q** How do I listen to a spot on the track I last listened to?
- A** The iMP-900 provide a RESUME function. Go to Function, General and enter into RESUME menu. You can set Track Time or Track #.
The iMP-900 can remember the last 10 CDs you played.
- Q** How many playlists can the iMP-900 play?
- A** The iMP-900 can play up to 20 playlists(*.m3u)
- Q** How many songs can the iMP-900 play?
- A** The iMP-900 can recognize 999 songs (20 Playlist included) and 255 folders including subfolders.
- Q** Does the iMP-900 play “.ra”and “.wav” formats?
- A** The playable formats on the iMP-900 are MP3, WMA, and ASF files.
RA, WAV, and other formats can not be played in this player.
Supporting formats such as “.ra”and “.wav”are under consideration for the future.
- Q** I don't see the title and it only displays Audio Track.
- A** The iMP-900 can display the information that the song contains. With MP3 files, the tag information may not be correct and with Standard Audio CD, it displays only Audio Track.
To see the song title, you need to burn the CD using CD-TEXT function.
See your CD Creation software.
- Q** The sound cuts out when the player skips.
- A** If the player is shaken in a sudden or violent manner, or shaken excessively, skipping may occur. Under normal circumstances, skipping will not occur.
Please carry and handle the player under normal circumstances (i.e., without excessive shaking).

Questions and Answers

Playing

- Q** It takes a long time to load a CD.
- A** Using Multi-sessioned or Packet Written CD may affect the loading time rather than using Single sessioned CD because the data is scattered in the CD.
To reduce the loading time, it is recommended you to burn in Single-session.
You may contact Customer Service if it takes longer than 1 minute to load a single-sessioned CD or a Standard Audio CD.
- Q** It always stops after playing one song.
- A** Check that the "Auto Pause" feature is turned off.
Also check that your player is not set to "SFL 1" mode.
- Q** I hear a 'hiccup' sound while the song is playing.
- A1** Check the status of the file. What is likely happening is that the file is corrupted, especially if you hear the same sound in the same spot. In this case, the music file is maybe corrupted.
- A2** Check whether the sampling frequency and bitrate of the music file is too high or low. iMP-900 supports from 8KHz, 8Kbps to 44.1KHz, 320Kbps. (In case of 48KHz, supports up to 256Kbps.)
- Q** Can I change the playing order?
- A** The iMP-900 supports m3u file lists. Also, the Program function allows you to select your preferred songs.
- Q** Is the sound better if I convert an MP3 file into WAV?
- A** MP3 is a compressed a audio format. Audio quality is lost when converting sound into MP3 format. Changing MP3 to WAV files will not restore data lost in compression and will therefore not improve audio quality.

Playing

Q What kind of media can the iMP-900 support?

A Standard Audio CD (8Cm, 12 Cm), CD-R, CD-RW DATA CD with MP3, ASF and WMA.

The iMP-900 also supports Mixed CD (Data Track + Audio Track), CD-Extra (Audio Track + Data Track), Multi-sessioned and packet written CD.

Q What is VBR?

A VBR is "Variable Bit Rate". Some MP3 encoders support VBR. When enabled, the compressor will use a bit rate that will fit the actual passage. If it is a complex part, having much more variation in the sound, it will use a high bit rate. If there is less variation in sound, it will use a lower bit rate. Usually, the average bit rate will not be as high as a same-quality MP3 with CBR (Constant Bit Rate). However, there is shortcoming that it's hard to keep track of the actual position that may not be favorable when studying language.

Should any problem continue after you have checked these symptoms, please contact iRiver customer support.

Player will not power on	<ul style="list-style-type: none"> ▪ Check whether the batteries have been inserted in proper polarity (+ and -). ▪ Check whether the HOLD switch on remote is ON (Switch to OFF position) ▪ Check whether the player door is opened. ▪ Check whether the rechargeable batteries are not charged or the batteries ran out.
Loading stopped or 'No DISC' displayed on LCD	<ul style="list-style-type: none"> ▪ Check whether the CD is dirty or defective (clean it or change to new CD). ▪ Check whether the CD is inserted properly. ▪ Check to be sure the optical lens is clean. (Gently wipe with soft cloth.) ▪ Check whether moisture condensation has occurred (leave the CD player aside for several hours until the moisture evaporates). ▪ Make sure there is a CD in the player. ▪ Problems can be caused by the CD creation process on your PC. Re-record the disk at a slower speed. ▪ Use Full Format when creating packet a written disk.
No Sound or noise is heard	<ul style="list-style-type: none"> ▪ Check whether VOLUME is set to '0'. ▪ Connect the earphone/remote plug firmly. ▪ Check whether the plug is dirty (clean the plug with a dry and soft cloth). ▪ Corrupted MP3, WMA file may have distortion or not play. Try playing another music file. ▪ Excessive jolting may affect MP3, WMA, and audio CD disks during playback.

Troubleshooting!

Should any problem continue after you have checked these symptoms, please contact iRiver customer support.

AC adapter does not work.	<ul style="list-style-type: none"> Check whether the plug is connected to the proper jack on the player.
Remote control does not work.	<ul style="list-style-type: none"> Check whether the HOLD switch is ON. (Switch to OFF position.) Connect the earphones/remote plug firmly.
Battery Life is short	<ul style="list-style-type: none"> Ensure the rechargeable batteries are fully charged. Avoid the excessive operation of remote control.
Characters in LCD are corrupted.	<ul style="list-style-type: none"> Check out Menu → General → Language and confirm whether the right language has been selected. (Refer to page 40.)
Poor FM Reception	<ul style="list-style-type: none"> Adjust the position of the player and remote control. Electronic equipment can cause interference with the FM reception. Turn off any nearby electronics or move the player away from the source.
charging and discharging does not work.	<ul style="list-style-type: none"> Check whether the adapter plug is properly connected. Check whether the batteries inserted are rechargeable. Check whether 2 rechargeable batteries are inserted. The batteries are charged and discharged when 2 batteries are inserted.

Precautions

On Handling Disc

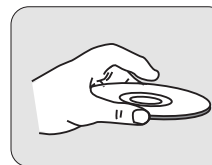

- On handling Disc
Avoid touching the surface (bright side) where data is stored.

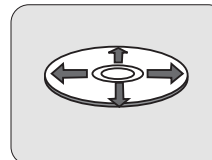

- Disc Cleaning
Avoid cleaning the disc surface. If necessary, clean the disc surface with a soft cloth following the directions described.

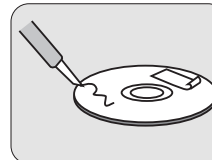

- Do not stick papers or tape labels onto the surface (bright side).

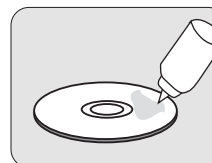

- Avoid using chemicals to clean the surface.

On safety

- Should any solid objects or liquid fall into the player, unplug it and have it checked by qualified personnel before operating it any further.
- Do not put objects in the DC IN 4.5V jack (External Power output).
- Use only the adapter provided with the player.

Precautions

- During playback, dirty or scratched CD's may cause audio distortion or skipping.
- Tracks with damaged or corrupted parts are skipped or forwarded to next track.
- Supported file types will have the extension MP3, WMA and ASF.
- Folders and files are sorted in alphabetical order.
Use Navigation mode to select the tracks wanted.
- Total 255 folders and 999 tracks (Including 20 playlist) within a disc can be recognized.
- Track information displayed is either filename or ID3 TAG information.
- CD-TEXT discs are displayed with track names within the TOC (Table of Contents) of the disc.
- Maximum playback time is 120 hours with fully charged internal batteries and the external battery pack attached.
(When playing Audio CDs, maximum playback time is 50 hours.)
(Reference : MP3, 44.1KHz, 128kbps, Volume Center)
- Battery level indicator may vary depending on battery type and operation mode.



Tip

- To shorten the reading time of CD...
 - Set the "MULTI SESSION" to "OFF".
 - Create CDs at a slower speed.

Product Specifications

Category	Item	Specifications
Audio (CD)	Frequency/Range	20Hz~20KHz
	Headphone output	9mW (L) + 9mW (R)(32Ω) Max. Volume
		16mW (R) + 16mW (R) (16Ω) Max. Volume
	Line output level	0.57V rms(47KΩ) Max. Volume
	S/N ratio	90dB(CD-DA), 90dB(MP3 CD)
	Frequency Characteristics	± 3dB (Line Out)
	No. of Channels	STEREO (L+R)
FM TUNER	FM Frequency range	87.5MHz~108MHz
	S/N ratio	50dB
	Antenna	Headphone/Earphone-Cord Antenna
CD Support	CD Type	CD-DA, CD-Text(8cm / 12cm)
		CD-ROM Mode 1, Mode 2 Form1
		Enhanced CD, Mixed CD
CD-R/RW Readability	Packet Write, ISO9660, Joliet, Romeo, Multi-Session	
File Support	File Type	MPEG 1/2/2.5 Layer 3, WMA ,ASF, OGG
	Bit Rate	8Kbps ~ 320 Kbps
	Tag	ID3 V1 , ID3 V2 2.0, ID3 V2 3.0
Power Supply	AC Adapter	DC 4.5V , 1.2A
	Rechargeable Battery	Stick Type Ni-MH Rechargeable Battery x 2ea
	External Battery Pack	1.5V AA x 4ea
General	Dimension	Approx. 128(W) x 135.5(D) x 13.7(H)mm
	Weight	Approx. 160g(without Battery)
	Operational Temperature	0℃ ~ 40℃
	Maximum Playback Time	30hrs (with External Battery Pack : 120hrs) (Ref : MP3, 128Kbps, 44.1KHz)

Regulatory Information

Federal Communications Commission (FCC)

The device manufactured and found to comply with limits for a Class B computing device according to the specifications in FCC rules Part 15. Operation is subject to the following two conditions;

1. This device may not cause harmful interference, and
2. This device must accept any interference received, including interference that may cause undesired operation.
3. If your device needs repairs, you must arrange for the manufacturer to make them if you are to keep the device's FCC registration valid.

This equipment, like other electronic equipment, generates and uses radio frequency energy. If not installed and used according to the instructions in this manual, this equipment may cause interference with your radio and television reception.

If you think this equipment is causing interference with your radio or television reception, try turning the equipment off and on. If the interference problems stop when the equipment is switched off, then the equipment is probably causing the interference. You may be able to correct the problem by doing one or more of the following:

- Adjust the position of the radio or TV antenna
- Move away the device from the radio or TV

If necessary, consult your dealer or an experienced radio or television technician. You may find this booklet helpful: "How to Identify and Resolve Radio and TV Interference Problems" (Stock No. 004-000-00345-4), prepared by the FCC and available from the U.S Government Printing Office, Washington, DC 20402. See individual devices FCC ID and registration numbers.

For the customers in Europe



The CE mark on the CD player is valid only for products marketed in the European Union.

Safety Warning

Safety Warning

**CLASS 1 LASER PRODUCT
KLASSE 1 LASER PRODUKT
LUOKAN 1 LASER LAITE
KLASS 1 LASER APPARAT
PRODUCTO LASER CLASE 1**

Use of controls, adjustments or performance of procedures other than those specified herein may result in hazardous radiation exposure. **CAUTION-INVISIBLE LASER RADIATION WHEN OPEN AND INTERLOCKS DEFEATED, AVOID EXPOSURE TO BEAM.**

WARNING

- To prevent fire or shock hazard, do not expose the unit to rain or moisture.
- To avoid electrical shock, do not open the cabinet. Refer servicing to qualified personnel only.
- Certain countries may regulate disposal of the battery used to power this product. Please consult with your local authority.
- Listening for many hours at maximum volume may damage your hearing.

Free Manuals Download Website

<http://myh66.com>

<http://usermanuals.us>

<http://www.somanuals.com>

<http://www.4manuals.cc>

<http://www.manual-lib.com>

<http://www.404manual.com>

<http://www.luxmanual.com>

<http://aubethermostatmanual.com>

Golf course search by state

<http://golfingnear.com>

Email search by domain

<http://emailbydomain.com>

Auto manuals search

<http://auto.somanuals.com>

TV manuals search

<http://tv.somanuals.com>