

Fisher-Price®

Go and Play Stroller™

Instructions for Model No. FP3330, FP3345

Your Fashion May Vary



Please save these instructions for future reference,
as they contain important information.

Adult assembly is required. (Tools are not needed for assembly.)

Maximum weight of child: Not to exceed 40 lbs (18 kg).

Intended for use by children who are able to hold
their head up unassisted in a supported sitting position.

Maximum storage weight for lower storage basket: 8 lbs (3.6 kg).

Message To Parents

Thank you for purchasing the Fisher-Price® Go and Play Stroller, a lightweight stroller designed to comfortably accommodate one child. We hope you will find the features and styling of this product a perfect fit in satisfying the needs of both you and your child.

Occasionally a consumer may experience a problem with one of our products. If this should happen, please call us, toll-free, rather than returning it to the store. Usually we can solve the problem over the telephone or by sending you replacement parts.

If you have a question or a problem, call J. Mason Customer Service at 800-242-1922 (or 818-993-6800) from 8:30am. to 5:00pm PST for quick service. You can also reach us by e-mail at: customerservice@jmason.com



WARNING

Failure to follow these warnings and assembly instructions could result in serious injury or death. The safety of your child while in the stroller depends on you! Please read and understand the following warnings and instructions before use.

- **NEVER** leave child unattended. Always keep child in view.
- Avoid serious injury from falling or sliding out. **ALWAYS** use seat belt.
- The stroller may become unstable if items are hanging from or placed on the handle. **DO NOT** hang shopping bags, purses or accessories on the handle.
- Read any caution labels on the frame before setting child in seat.
- Remove and destroy all packing materials including silica gel bags.
- When making adjustments to the stroller, **ALWAYS ENSURE** that all parts of your child's body are clear of moving parts.
- This stroller is to be used by one child only, weighing less than 40 lbs. (18 kg). Excessive weight may cause a hazardous, unstable condition to exist.
- **ALWAYS** use the brakes when the stroller is stopped! **DO NOT** leave stroller unattended on a hill or incline even when brakes are latched. The stroller may roll down hill.
- **DO NOT** allow child to climb unassisted into stroller, or to play with or hang onto stroller, as stroller may tip over.
- **DO NOT** use stroller on stairs or escalators with child in it. Child could fall out and become injured.
- The stroller may become unstable if the maximum weight of the storage area is exceeded. **DO NOT** exceed the maximum weight limit of 8 lbs. (3.6 kg) in the storage basket. Excessive weight may cause a hazardous, unstable condition to exist.
- To avoid burns, **NEVER** put hot liquids in tray.
- **NEVER** lift stroller by front bar!
- Before each usage or assembly, inspect product for damaged hardware, loose joints, missing parts or sharp edges. **DO NOT** use product if any parts are missing or broken. Ask your dealer or contact J. Mason for replacements parts and instructional literature if needed. **DO NOT** use substitute parts.

Parts

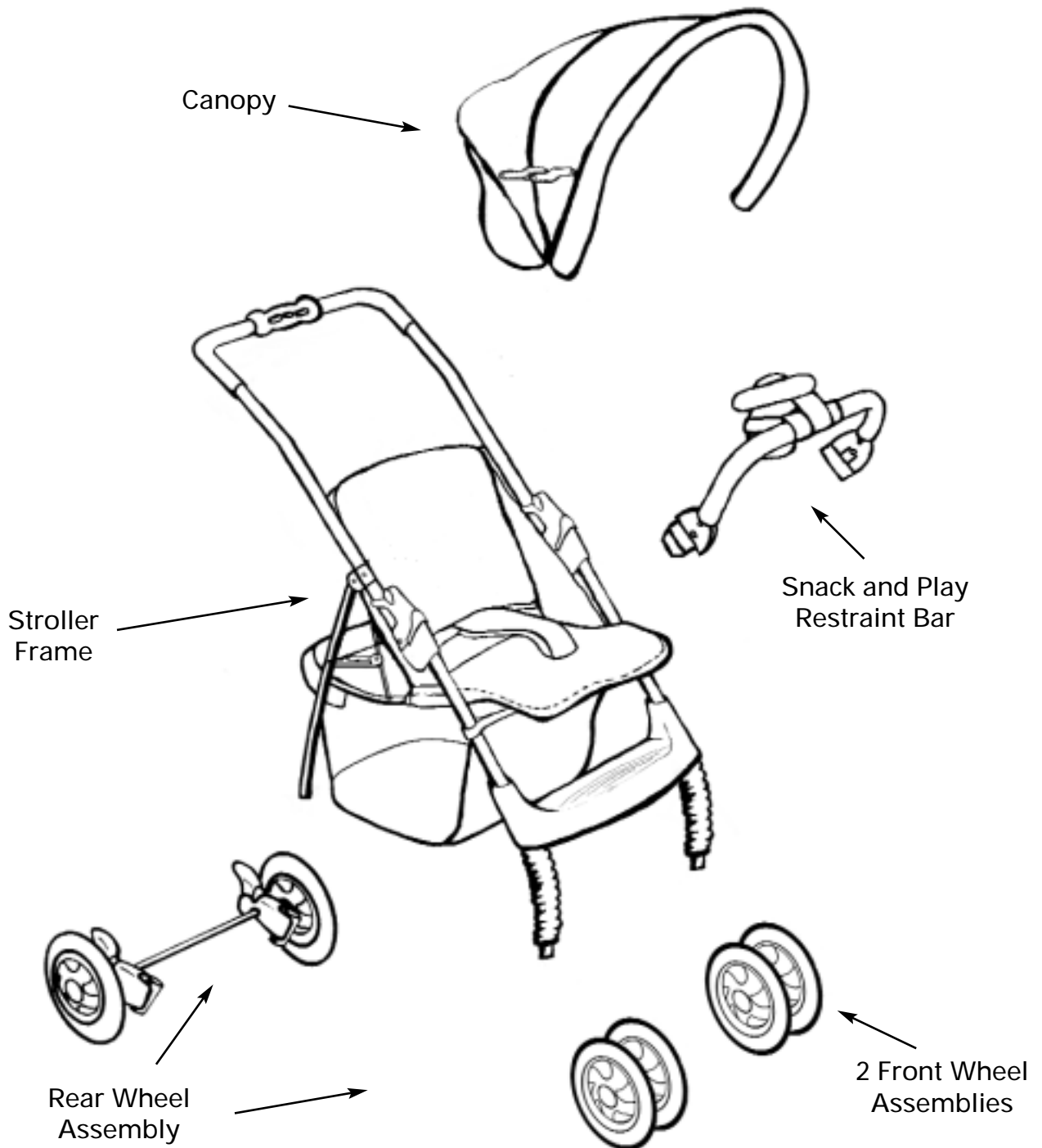

WARNING

Please keep plastic bags out of children's reach.
Dispose of plastic bags properly.

Assembly & Use:



WARNING

When making adjustments to your stroller, always ensure that all parts of your child's body are clear of moving parts.



Lift storage clip.



Place your foot on the rear frame tube and lift the handle until the frame locks snap into position.

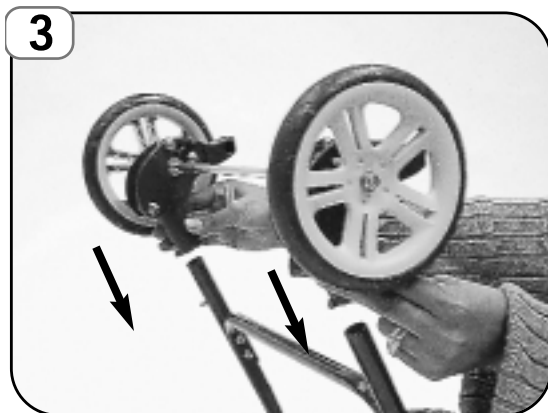

Turn the frame face down. Position rear axle assembly so brakes are pointed toward you. Push rear axle assembly firmly onto each leg so that the buttons "snap" into the holes in the wheel brackets.

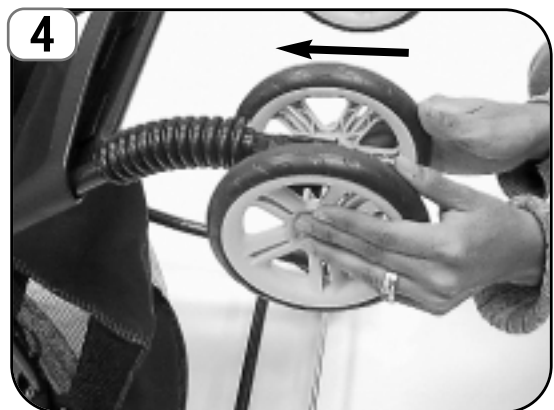

Position each front wheel assembly onto each of the front legs. Slide wheel into position. Tabs should click out between rings.



Snap canopy assembly onto frame. Secure by looping fabric fastener strips around frame. Push side brackets down to open canopy.

IMPORTANT:

Pull firmly on all wheel assemblies to be sure that they are securely attached.

Adjustments:



Safety Brakes

Press down on each rear brake lever with your foot until each clicks into position. Lift brake levers with foot to release.

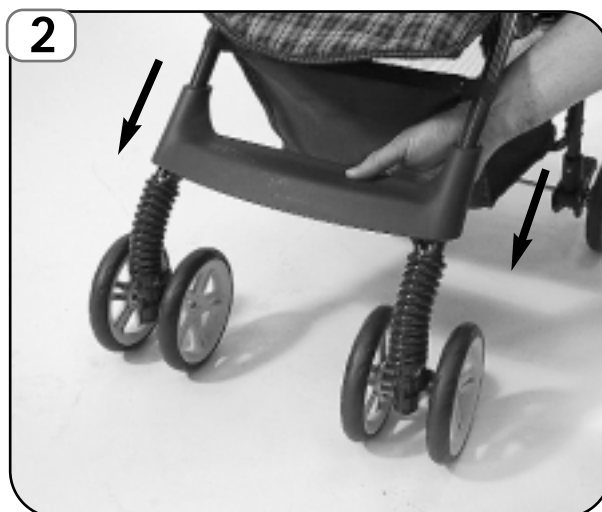

Footrest

Push down footrest until it "snaps" into place.

Warning

To prevent serious injury or death from or sliding out, always use the restraint belts.

Warning

Always set brake when stroller is stopped! Do not leave stroller unattended on hill or incline even with brakes engaged. The stroller may slide down hill.



Restraint Bar

Snap restraint bar onto stroller frame.



Reclining Seat

To adjust the seat, face the back of the stroller. To recline, lift up on release levers on both sides of the stroller. To raise seat, push up on seat back until pins are secure in lever slots on both sides.

Adjustments: (Continued)

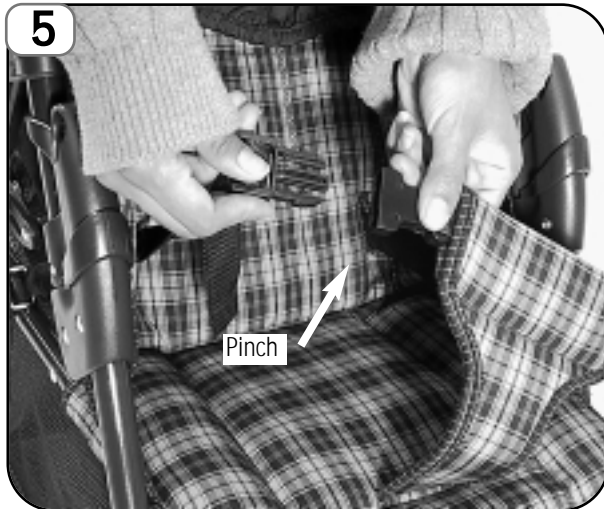

Restraint Belts

Place your child in the stroller. Pull the crotch belt up between your child's legs. Fasten both waist belts to the crotch belt. **Make sure you hear a "click" on both sides.**

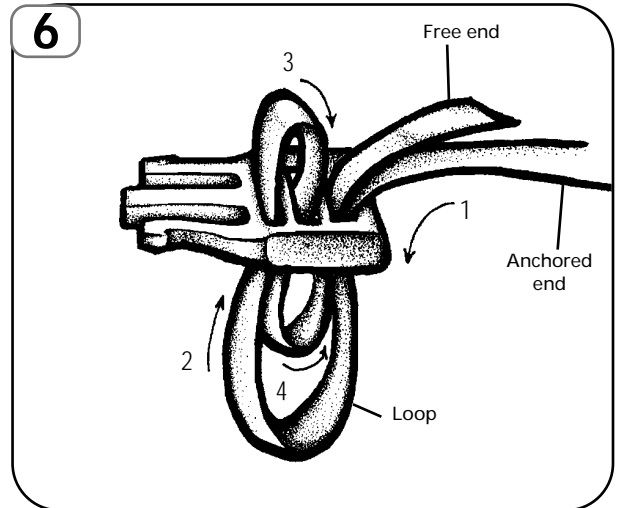

To tighten waist belt, feed the anchored end of the waist belt up through the buckle to form a loop. Pull the free end of the waist belt through.

To loosen waist belt, feed the free end of the waist belt down through the buckle to form a loop. Pull the anchored end of the waist belt.

Toy Operation

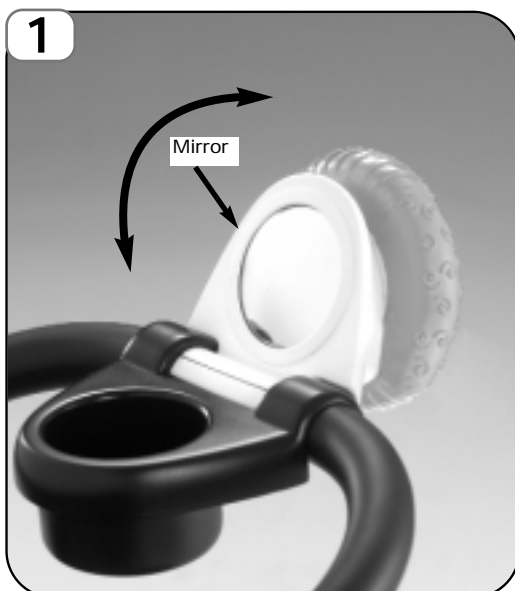

Opening

To access the child tray flip open until you feel it stop in position. To close, flip down to its closed position.

NOTE: Mirror can be used to observe child while parent is pushing stroller.

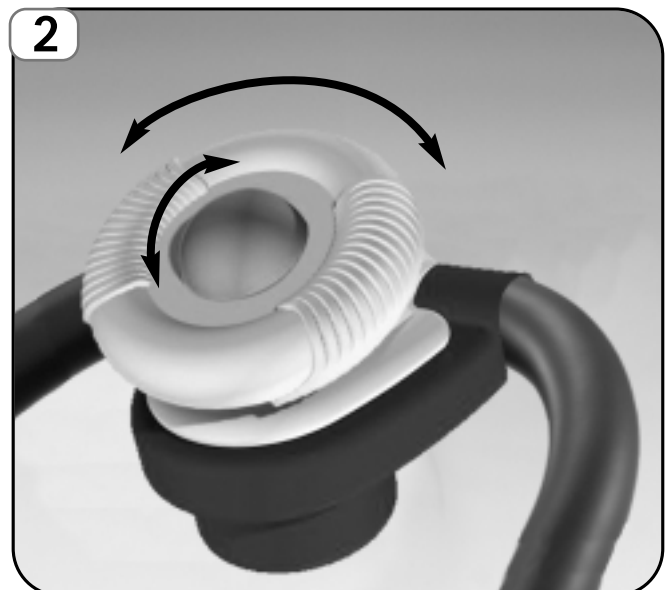

Functions

Steering wheel turns in any direction. Ball turns forward and reverse.

To Fold:

IMPORTANT!

Before folding stroller for storage, remove all objects from storage basket



1 To fold your stroller, push the red button toward the center and twist forward on grip until side latches disengage. **Seat must be reclined.**

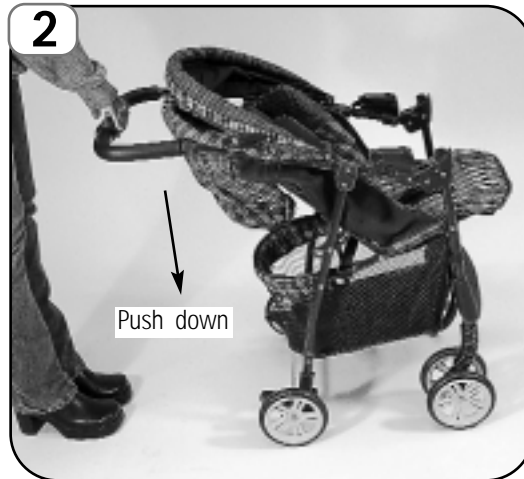

2 Push handle down to fold stroller.

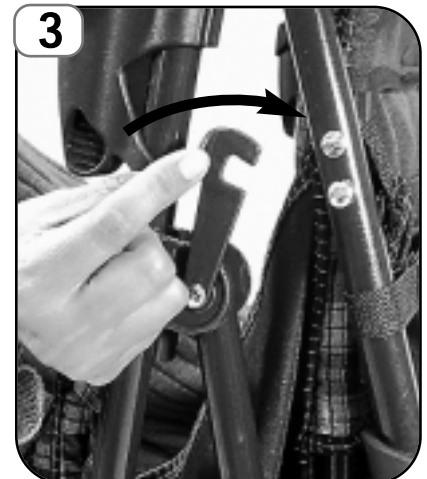

3 Lower the clip located on the side of the stroller frame.

Maintenance:

- To clean fabric and plastic surfaces, wipe gently with soft damp cloth. Luke warm water and mild detergent may be used. Air dry. **Do not machine wash!**
- Wipe metal parts clean with a soft damp cloth, then wipe down with a soft dry cloth. **Do not use abrasives or solvents.**
- Periodically lubricate the wheels and metal parts to keep your stroller running smoothly.
- Dry off stroller with a soft cloth if used in inclement weather to assure longer life.

J. Mason Warranty

We would like to thank you for your purchase of this product and welcome you to our growing family of satisfied owners. We are very proud of our fine quality products and are confident that you will find the same in our workmanship. However, we recommend you retain this warranty so that should a problem arise, we will be able to respond quickly and efficiently.

J. Mason warrants the original components of our products. J. Mason will repair, or at its option, replace any original parts due to defects in material and workmanship. This warranty is limited to the original retail purchaser only, and under ordinary usage. This warranty is further limited to replacing the defective part without charge. The company shall not be responsible for consequential or special damages or damages resulting from use in any activities outside the realm of normal use.

This warranty will remain in effect for five (5) years on the frame and ninety (90) days on parts (excluding wearable parts), from the date of purchase as shown on the original bill of sale.

This warranty does not apply to any J. Mason product that has been abused, misused, altered by parts substitution, or used for daycare, rental and/ or other commercial purposes.

Transportation expenses are not covered in this warranty. This warranty gives you specific legal rights and you may also have other rights which vary from state to state. Proof of purchase is required to validate protection under this limited warranty.

Be a safe parent. NEVER leave child unattended!



19401 Business Center Drive, Northridge, CA 91324
Toll Free: 1-800-242-1922 Outside USA: (818) 993-6800
www.jmason.com

Fisher-Price and related trademarks and copyrights are used under license from Fisher-Price, Inc., a subsidiary of Mattel, Inc., East Aurora, NY 14052. U.S.A. ©2002 Mattel, Inc.
All Rights Reserved. Manufactured for and distributed by J. Mason.
Printed in China

REV. 11/02

Free Manuals Download Website

<http://myh66.com>

<http://usermanuals.us>

<http://www.somanuals.com>

<http://www.4manuals.cc>

<http://www.manual-lib.com>

<http://www.404manual.com>

<http://www.luxmanual.com>

<http://aubethermostatmanual.com>

Golf course search by state

<http://golfingnear.com>

Email search by domain

<http://emailbydomain.com>

Auto manuals search

<http://auto.somanuals.com>

TV manuals search

<http://tv.somanuals.com>