

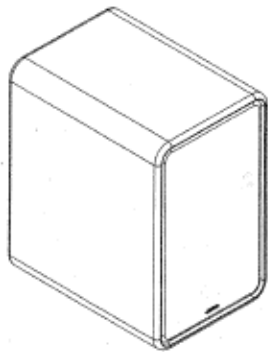

Jamo®

1 Packing contents



P 404 Left

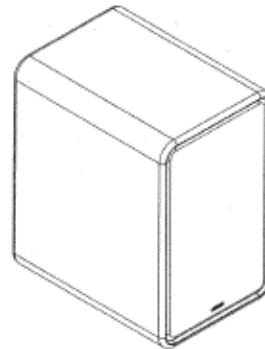

P 404 Right



1 x Remote Control
incl. Battery



8 x Feet



1 Meter RCA - 3,5mm stereo cable



4 Meter Speaker wire



1 x Detachable Power Cord

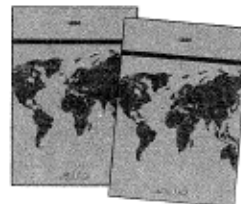

Manual / Safety instructions

2 Setup

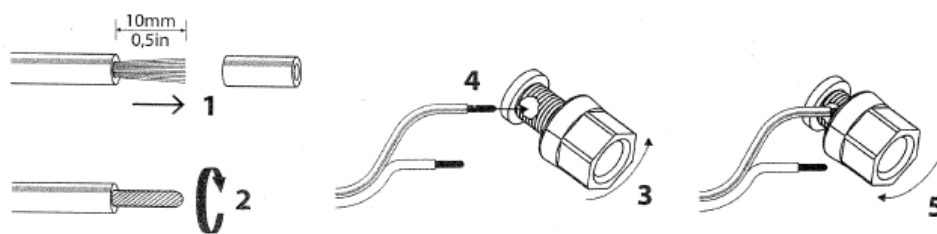
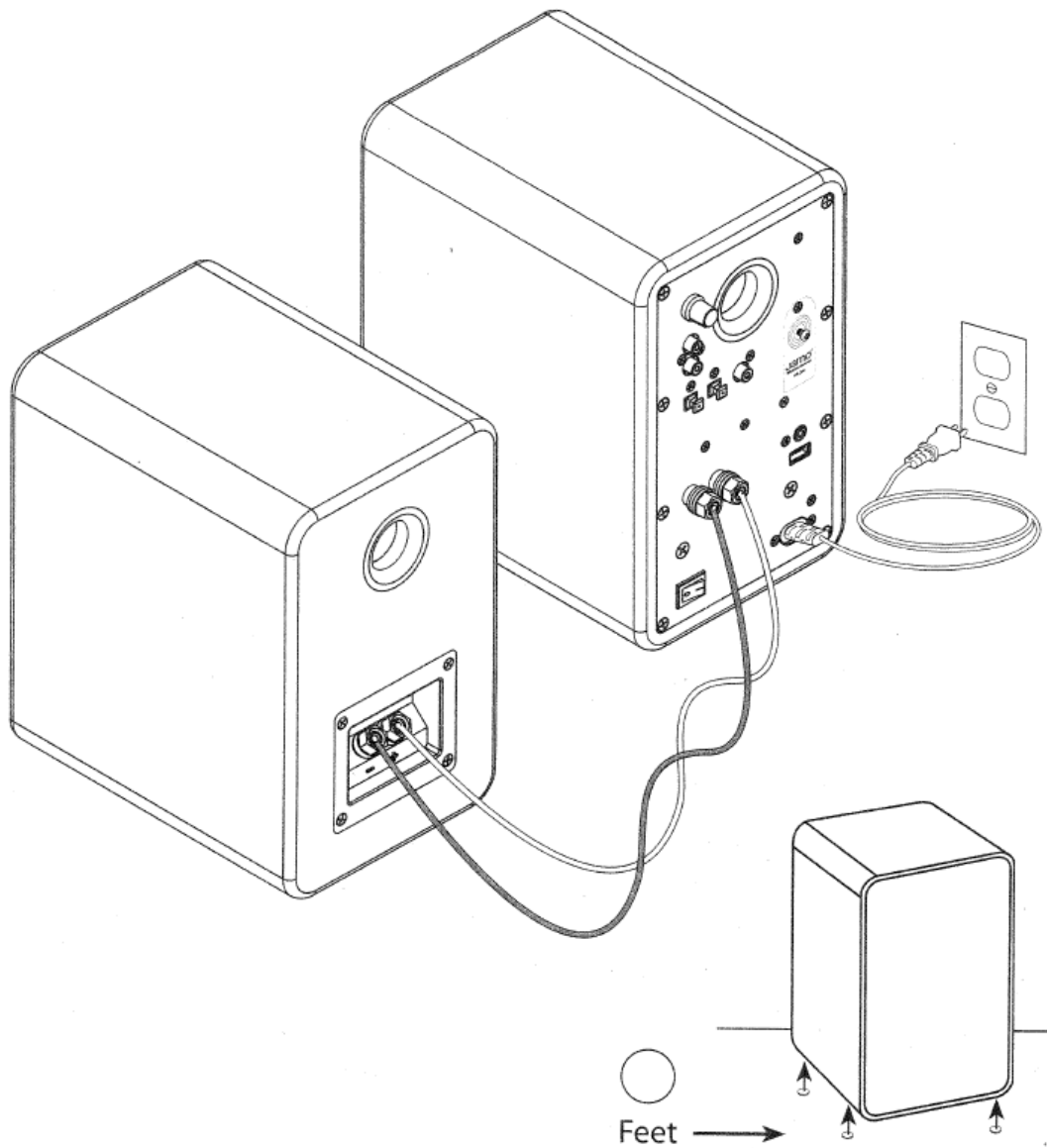

3 Connection P 404 Left

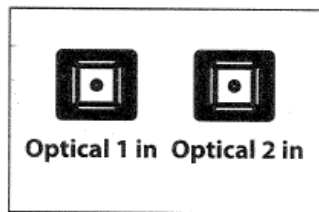
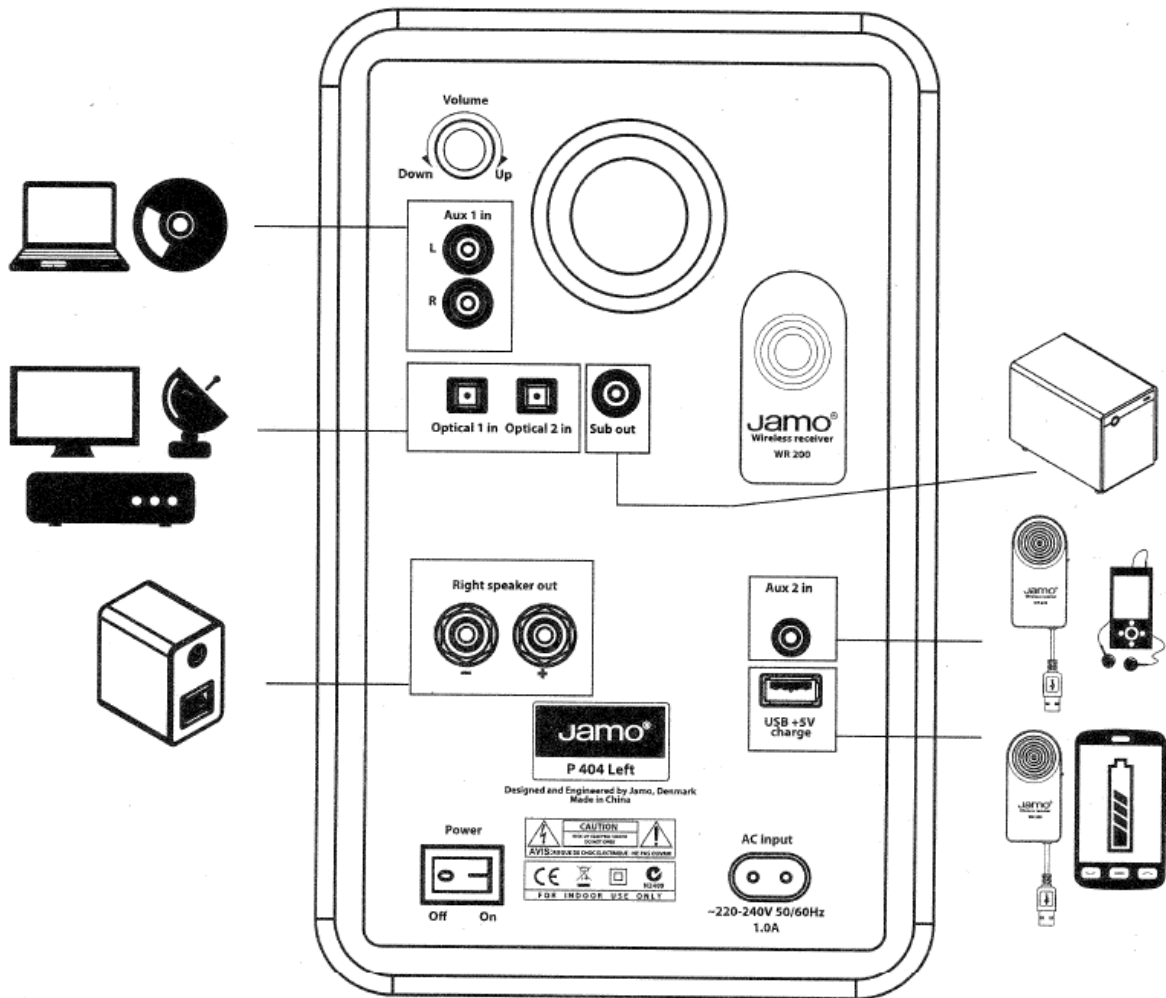

PCM



RAW /Bitstream
Dolby Digital / DTS



4 Operation

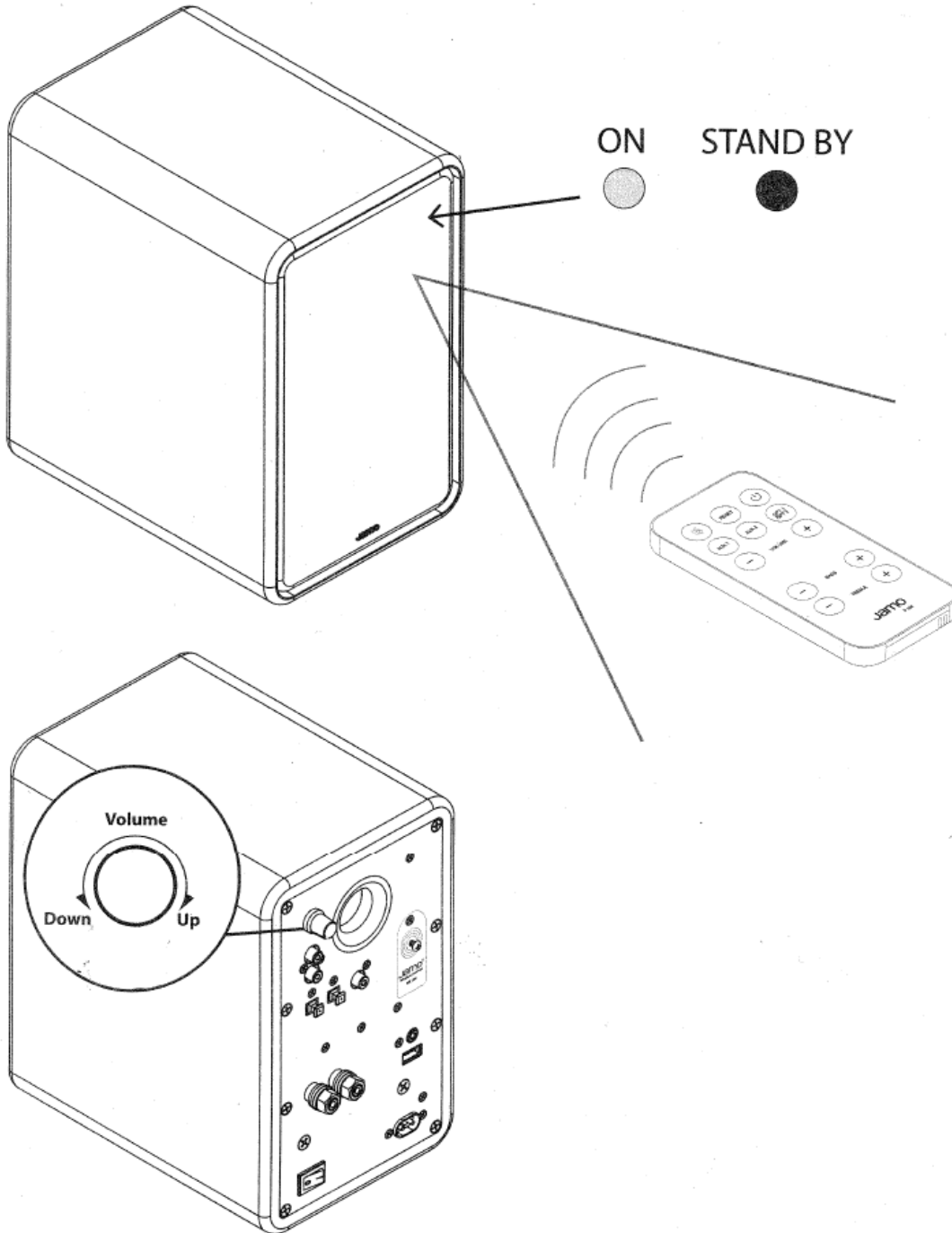

5 Remote

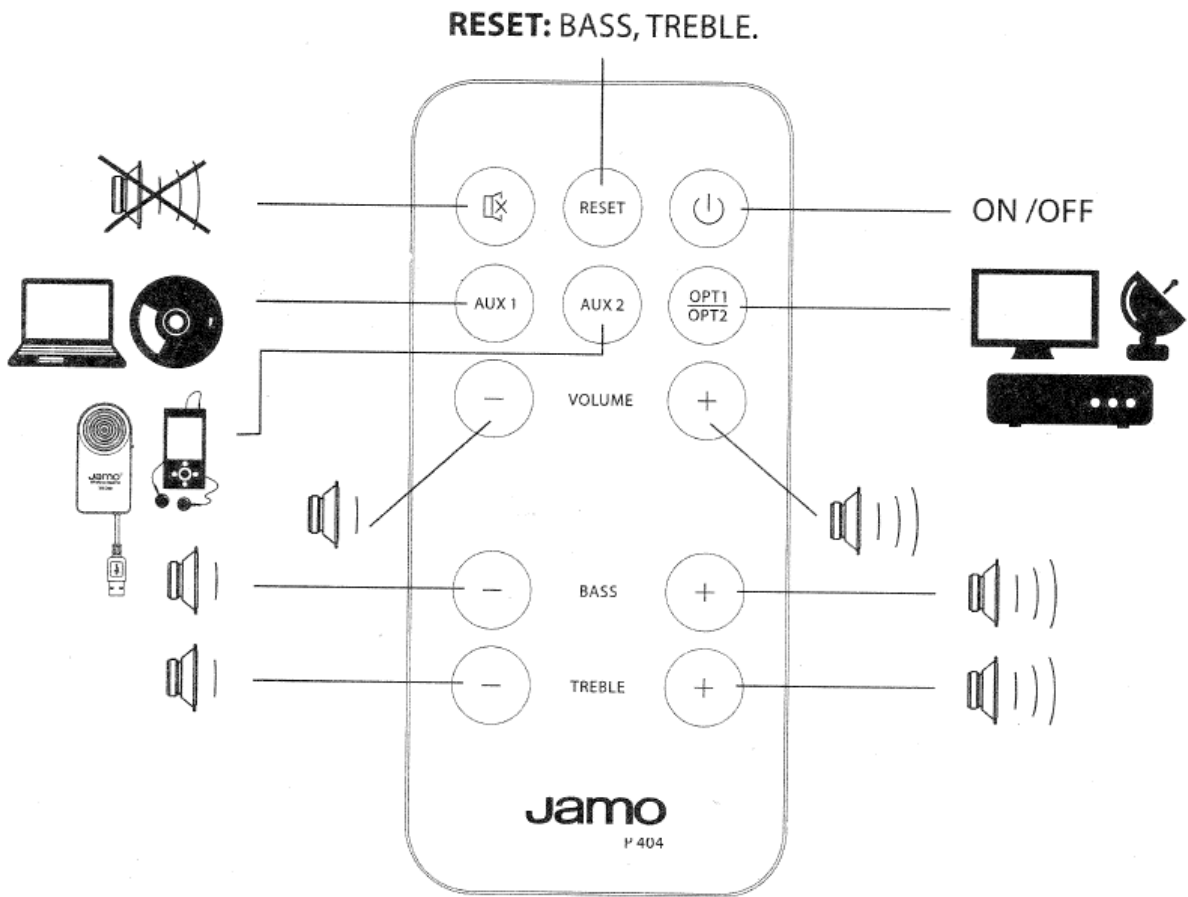

6 Specification

Type	P 404
System.....	2.0 Active Bassreflex (Left Active + Right Passive)
Amplifier Rated Output (Watt).....	2x30W @40hm @1%THD
Woofer (mm / in).....	140 / 5½
Tweeter (mm / in).....	25 / 1 Soft dome
Frequency Range (Hz).....	50 - 20.000 @ +/- 3dB
Input: Optical.....	2
Input: AUX1 (RCA).....	1
Input: AUX2 (3,5mm Minijack).....	1
Output: Sub out.....	1
LED Indicator.....	On/Signal Blue Off/Standby Red (Switches off after 10 min.) Mute Red (Flashing) RC operation is valid (Blue flickering)
Tone Control.....	Bass: +/-6dB @ 100Hz, default 0dB Treble: +/-6dB @ 1000kHz, default 0dB Reset: Bass and Treble return to 0dB
USB 5V Charge.....	1
Stand-by power (Watt).....	<1.0
Weight P 404 Left (kg/lb).....	5,1 / 11.24
Weight P 404 Righth (kg/lb).....	3,6 / 7.93
Dimensions P 404 (mm / in).....	240 x 162 x 218 / 9.44 x 6.37 x 8.58
Finishes.....	HG Black or HG White



7 Accessories

Wireless kit - Jamo WK 200



Jamo WR 200



Jamo WT 200



1 x 80 cm 3,5mm stereo cable



1 x 15 cm 3,5mm stereo cable

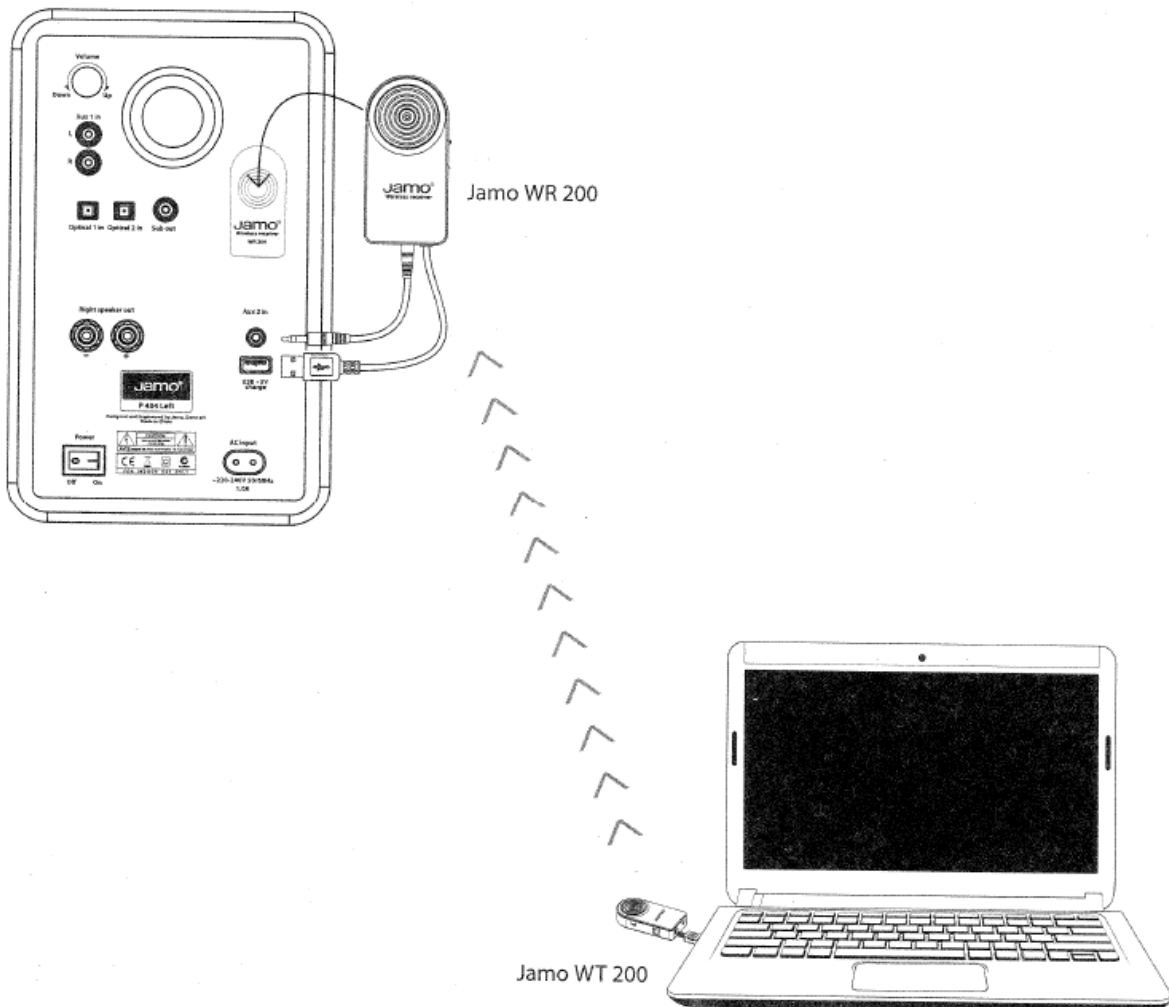

EU DECLARATION OF CONFORMITY

We Klipsch Group, Inc.
Of 3502 Woodview Trace, Suite 200
Indianapolis, IN 46268 USA
Declare that
Equipment: Powered Audio/Video Speaker System
Model Name: Jamo P 404

In accordance with the following Directives:

2006/95/EC	The Low Voltage Directive and its amending Directives
2004/108/EC	The Electromagnetic Compatibility Directive and its amending Directives
2009/125/EC	Eco-design requirements for energy related products and its amending directives
2006/121/EC	Registration, Evaluation, Authorization and Restriction of Chemicals (REACH)

has been designed and manufactured to comply with the following specifications:

EN60065: 2002	Audio, Video and Similar Electronic Apparatus – Safety requirements
EN55013: 2001	Sound and television broadcast receivers and associated equipment – Radio disturbance characteristics – Limits and methods of measurements
EN55020: 2002	Sound and television broadcast receivers and associated equipment –Immunity Characteristics – Limits and methods of measurements
EN61000-3-2: 2000	Electromagnetic Compatibility Part 3. Limits Section 2. Limits for harmonic current emissions (equipment input current #16A per phase)
EN61000-3-3: 1995	Electromagnetic Compatibility Part 3. Limits Section 3. Limits for voltage fluctuations and flicker in low-voltage supply systems for equipment with rated current #16A

I hereby declare that the equipment named above has been designed to comply with the relative sections of the above reference specifications. The unit complies with all essential requirements of the Directives.

Signature: 

Name: Kerry Geist

Position: Vice President of Engineering

Klipsch Group, Inc.
3502 Woodview Trace, Suite 200
Indianapolis, IN 46268 USA

Revised: April 4, 2011



KLIPSCH GROUP, INC.
3502 WOODVIEW TRACE, SUITE 200
INDIANAPOLIS, IN 46268 USA

KLIPSCH GROUP EUROPE, B.V.
INDUSTRIESTRAAT 1
7041 GD 's-HEERENBERG, NETHERLANDS

Free Manuals Download Website

<http://myh66.com>

<http://usermanuals.us>

<http://www.somanuals.com>

<http://www.4manuals.cc>

<http://www.manual-lib.com>

<http://www.404manual.com>

<http://www.luxmanual.com>

<http://aubethermostatmanual.com>

Golf course search by state

<http://golfingnear.com>

Email search by domain

<http://emailbydomain.com>

Auto manuals search

<http://auto.somanuals.com>

TV manuals search

<http://tv.somanuals.com>