

**POWER  
SERIES**

*p550c*

*p650c*

component  
systems  
owner's  
manual

**THANK YOU**

for purchasing a JBL Power Series® automotive loudspeaker component system. We've organized this manual to make your installation as simple and trouble-free as possible. Please read it thoroughly before proceeding. Remember to keep your sales receipt and this manual in a safe place so both are available for future reference.



**JBL**

THE OFFICIAL BRAND  
OF LIVE MUSIC.



Designed and  
Engineered  
in the U.S.A.

## INSTALLATION WARNINGS AND TIPS

### ABOUT THESE INSTRUCTIONS

Installation of automotive stereo components can require extensive experience with a variety of mechanical and electrical procedures. Although these instructions explain how to install Power Series Component Systems in a general sense, they do not show the exact installation methods for your particular vehicle. If you do not feel you have the experience, do not attempt the installation yourself, but instead ask your authorized JBL car audio dealer about professional installation options.

### LOUD MUSIC AND HEARING

Playing loud music in an automobile can hinder your ability to hear traffic, as well as permanently damage your hearing. The maximum volume levels achievable with JBL speakers, combined with high power amplification, may exceed safe levels for extended listening. We recommend using low volume levels when driving. JBL accepts no liability for hearing loss, bodily injury or property damage as a result of use or misuse of this product.

### REAR DECK PRECAUTION

In some cars, fuel tanks may be located directly beneath the rear deck. Before installation, make sure there is adequate speaker basket clearance before considering this location!

### ABOUT THE CONTENTS

The Power Series Component System includes:

- 5-1/4" or 6-1/2" or 165mm woofer
- Grille and mounting adapter(s)
- 1" tweeter with surface/flush I-Mount™ (patent no. 5,859,917) kits
- Crossover network with mounting screws

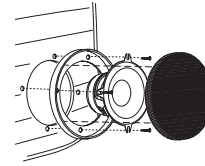
**NOTE:** The supplied crossover network is designed to work with the above-listed transducers. Do not substitute another crossover network or use other speakers when connecting the system (see Figure 7A).

### INSTALLATION TIPS

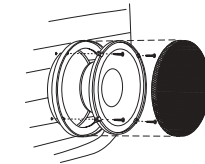
- Always wear protective eyewear when using any tools.
- Turn off all audio components and other electrical devices before you start. Disconnect the (-) negative lead from your vehicle's battery.
- Keep speakers in their package until final installation. When moving a speaker, always rest it with the cone or dome facing up. Never use force to install any speaker.
- Check clearances on both sides of a planned mounting surface before drilling any holes or installing any screws. Remember that the screws can extend behind the surface.

## INSTALLATION

**Figure 1.** Mounting the P550c woofer with the grille.

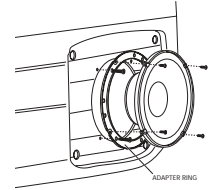


**Figure 2.** Mounting the P650c woofer with the grille.

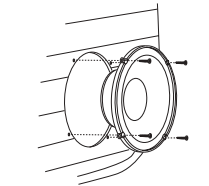


**Figure 3.** Mounting the P650c in a standard 6" opening.

**NOTE:** The P650c uses an adapter to fit a variety of different 6" openings. Select an appropriate adapter ring and secure it to the vehicle using the sheet-metal screws provided, then attach the speaker to the ring with the machine screws.



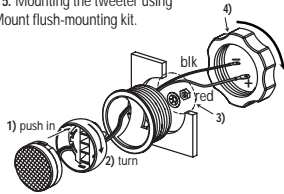
**Figure 4.** Mounting the P650c in a 165mm speaker location.



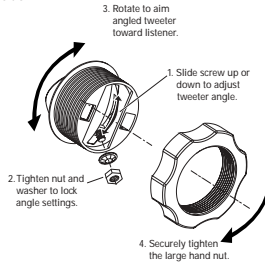
**JBL**

## INSTALLATION

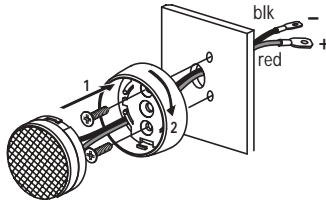
**Figure 5.** Mounting the tweeter using the I-Mount flush-mounting kit.



**Figure 6.** Aiming the tweeter at a desired listening position.



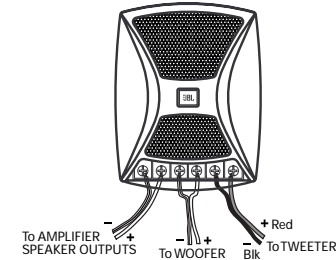
**Figure 7.** Mounting the tweeter using the I-Mount surface-mounting kit.



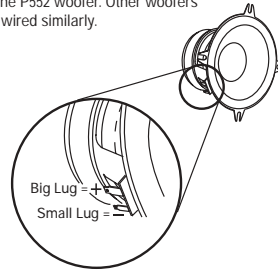
## CONNECTIONS

Open the crossover housing by firmly squeezing the sides of the top half and lifting it away from the bottom. Using screws or a wire tie, mount the crossover using the holes provided. Observing proper polarity, connect the speakers and amplifier as shown in Figures 8A and 8B. Replace the cover when you are finished making the connections and adjustments (see following section).

**Figure 8A.** Wiring connections on the crossover network (shown with cover on).

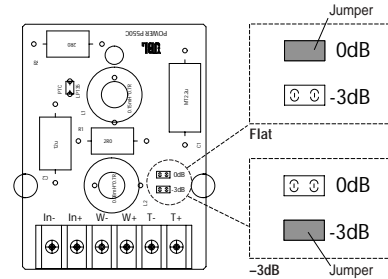


**Figure 8B.** Locating wiring connections on the P552 woofer. Other woofers are wired similarly.



The Power Series component crossover features a tweeter-level adjustment. The tweeter level may be set to 0dB (flat response), or it may be attenuated by approximately 3dB to suit the listener's preference. The factory default position is 0dB; if this is the desired setting, it is not necessary to make any changes.

If a reduced tweeter output level is desired, carefully remove the small plastic jumper from the pins marked "0dB" and place it across the two pins marked "-3dB" (refer to drawings below).



## SPECIFICATIONS

	<b>P550c</b>	<b>P650c</b>
Type:	5-1/4" two-way component system	6-1/2" two-way component system
Speaker Impedance:	4 ohms	4 ohms
Power Handling:	70W RMS, 210W Peak	90W RMS, 270W Peak
Sensitivity (2.83V, 1m):	89dB	90dB
Frequency Response:	55Hz – 23kHz	45Hz – 23kHz
Mounting Depth:	2-3/16" (56mm)	2-1/4" (58mm)
Cut-Out Diameter:	4-11/16" (120mm)	5-1/16" (129mm)

### GENERAL CARE

The loudspeaker grilles may be cleaned with a damp cloth. Do not use any cleaners or solvents on the grilles or the speaker cones.

A valid serial number is required for warranty coverage.

Features, specifications and appearance are subject to change without notice.

### Declaration of Conformity



We, Harman Consumer International  
2, route de Tours  
72500 Chateau-du-Loir  
France

declare in own responsibility that the products  
described in this owner's manual are in compliance  
with technical standards:

EN 50081-1:1992  
EN 50082-1:1997

Emmanuel Millot  
Harman Consumer International  
Chateau-du-Loir, France. 2/03

### JBL Consumer Products

250 Crossways Park Drive, Woodbury, NY 11797 USA

1.800.336.4JBL (4525) • FAX 1.516.682.3523 • [www.jbl.com](http://www.jbl.com)

© 2003 Harman International Industries, Incorporated

JBL is a registered trademark of  
Harman International Industries, Incorporated.

Part No. P550C/P650COM2/03

**H** A Harman International Company

## Free Manuals Download Website

<http://myh66.com>

<http://usermanuals.us>

<http://www.somanuals.com>

<http://www.4manuals.cc>

<http://www.manual-lib.com>

<http://www.404manual.com>

<http://www.luxmanual.com>

<http://aubethermostatmanual.com>

Golf course search by state

<http://golfingnear.com>

Email search by domain

<http://emailbydomain.com>

Auto manuals search

<http://auto.somanuals.com>

TV manuals search

<http://tv.somanuals.com>