



# Simply Cinema™



## ESC550 simple setup guide

## Table of Contents

Safety Precautions	3
1. Speaker Placement	5
Mounting Options	5
2. Connections	6
Connect TV or VCR to The Source™	6
Connect Antennas to The Source	6
Connect Optional Cassette Deck to The Source	6
Connect The Source to a Subwoofer	6
Speaker Connection Tips	7
Remote Control Battery Installation	7
3. Operation	8
Volume	8
Mute	8
Bass	8
Treble	8
CD Operation	11
To Skip to a Different Track	11
To Scan Within the Same Track	11
To Pause the CD	11
To Stop the CD	11
To Play the Tracks of a CD in Random Order	12
To Repeat the Disc	12
Tuner Operation	12
To Switch Between AM and FM	12
To Tune to a Particular Station	12
If a Selected FM Station is a Little Noisy	14
To Have the Tuner Search for the Next Strong Station	14
Preset Operation	14
Surround Mode Operation	17
Test Tone	18
Balance	18
Center Channel Volume	18
Rear Channel Volume	20
Delay Time	20
Troubleshooting	22
Specifications	23

**thank you** for choosing JBL. For over 50 years, JBL has been involved in every aspect of musical and film recording and reproduction, from live performances to monitoring the recordings you play in your home, car, or office.

We're confident that the **JBL system** you have chosen will provide every note of enjoyment that you expected – and that when you think about purchasing additional audio equipment for your home, car, or office, you will once again choose JBL.

Please take a moment to complete the enclosed profile card. It enables us to keep you posted on our latest advancements, and helps us to better understand our customers and build products that meet your needs and expectations.

JBL Consumer Products

# read first! Important Safety Precautions!

**CAUTION**  
**RISK OF ELECTRIC SHOCK**  
**DO NOT OPEN**

CAUTION: To prevent electric shock, do not remove the grounding plug on the power cord, or use any plug or extension cord that does not have a grounding plug provided.

Make certain that the AC outlet is properly grounded. Do not use an adapter plug with this product.

The lightning flash with arrowhead symbol, within an equilateral triangle, is intended to alert the user to the presence of uninsulated "dangerous voltage" within the product's enclosure that may be of sufficient magnitude to constitute a risk of electric shock to persons.

The exclamation point within an equilateral triangle is intended to alert the user to the presence of important operating and maintenance (servicing) instructions in the literature accompanying the appliance.

- 1. Read Instructions.** All the safety and operating instructions should be read before the product is operated.
- 2. Retain Instructions.** The safety and operating instructions should be retained for future reference.
- 3. Heed Warnings.** All warnings on the product and in the operating instructions should be adhered to.
- 4. Follow Instructions.** All operating and use instructions should be followed.
- 5. Cleaning.** Unplug this product from the wall outlet before cleaning. Do not use liquid cleaners or aerosol cleaners. Use a damp cloth for cleaning.
- 6. Attachments.** Do not use attachments not recommended by the product manufacturer, as they may cause hazards.
- 7. Water and Moisture.** Do not use this product near water – for example, near a bathtub, wash bowl, kitchen sink or laundry tub; in a wet

basement; or near a swimming pool; and the like.

**8. Accessories.** Do not place this product on an unstable cart, stand, tripod, bracket, or table. The product may fall, causing serious injury to a child or adult, and serious damage to the product. Use only with a cart, stand, tripod, bracket, or table recommended by the manufacturer, or sold with the product. Any mounting of the product should follow the manufacturer's instructions, and should use a mounting accessory recommended by the manufacturer.

**9. A Product and Cart Combination Should Be Moved with Care.** Quick stops, excessive force, and uneven surfaces may cause the product and cart combination to overturn.

**10. Ventilation.** Slots and openings in the cabinet are provided for ventilation and to ensure reliable operation of the product and to protect it from overheating, and these openings must not be blocked or covered. The openings should never be blocked by placing the product on a bed, sofa, rug, or other similar surface. This product should not be placed in a built-in installation such as a bookcase or rack unless proper ventilation is provided or the manufacturer's instructions have been adhered to.

**11. Power Sources.** This product should be operated only from the type of power source indicated on the marking label. If you are not sure of the type of power supply to your home, consult your

product dealer or local power company. For products intended to operate from battery power, or other sources, refer to the operating instructions.

**12. Grounding or Polarization.** This product may be equipped with a polarized alternating-current line plug (a plug having one blade wider than the other). This plug will fit into the power outlet only one way. This is a safety feature. If you are unable to insert the plug fully into the outlet, try reversing the plug. If the plug should still fail to fit, contact your electrician to replace your obsolete outlet. Do not defeat the safety purpose of the polarized plug.

**13. Power-Cord Protection.** Power-supply cords should be routed so that they are not likely to be walked on or pinched by items placed upon or against them, paying particular attention to cords at plugs, convenience receptacles, and the point where they exit from the product.

**14. Nonuse Periods.** The power cord of the product should be unplugged from the outlet when left unused for long periods of time.

**15. Outdoor Antenna Grounding.** If an outside antenna or cable system is connected to the product, be sure the antenna or cable system is grounded so as to provide some protection against voltage surges and built-up static charges. Article 810 of the National Electrical Code, ANSI/NFPA 70, provides information with regard to proper grounding of the mast and

supporting structure, grounding of the lead-in wire to an antenna discharge unit, size of grounding conductors, location of antenna-discharge unit, connection to grounding electrodes, and requirements for the grounding electrode. See Figure 1.

**16. Lightning.** For added protection for this product during a lightning storm, or when it is left unattended and unused for long periods of time, unplug it from the wall outlet and disconnect the antenna or cable system. This will prevent damage to the product due to lightning and power-line surges.

**17. Power Lines.** An outside antenna system should not be located in the vicinity of overhead power lines or other electric light or power circuits, or where it can fall into such power lines or circuits. When installing an outside antenna system, extreme care should be taken to keep from touching such power lines or circuits, as contact with them might be fatal.

**18. Overloading.** Do not overload wall outlets, extension cords, or integral convenience receptacles, as this can result in a risk of fire or electric shock.

**19. Object and Liquid Entry.** Never push objects of any kind into this product through openings, as they may touch dangerous voltage points or short-out parts that could result in a fire or electric shock. Never spill liquid of any kind on the product.

**20. Servicing.** Do not attempt to service this product yourself, as opening or removing covers may expose you to dangerous voltage or other hazards. Refer all servicing to qualified service personnel.

**21. Damage Requiring Service.** Unplug this product from the wall outlet and refer servicing to qualified service personnel under the following conditions:

- a. The power-supply cord or the plug has been damaged;
- b. Objects have fallen onto, or liquid has been spilled into, the product;
- c. The product has been exposed to rain or water;
- d. The product does not operate normally when following the operating instructions. Adjust only those controls that are covered by the operating instructions, as an improper adjustment of other controls may result in damage and will often require extensive work by a qualified technician to restore the product to its normal operation;
- e. The product has been dropped or damaged in any way; or

f. The product exhibits a distinct change in performance – this indicates a need for service.

**22. Replacement Parts.** When replacement parts are required, be sure the service technician has used replacement parts specified by the manufacturer or that have the same characteristics as the original part. Unauthorized substitutions may result in fire, electric shock or other hazards.

**23. Safety Check.** Upon completion of any service or repairs to this product, ask the service technician to perform safety checks to determine that the product is in proper operating condition.

**24. Wall or Ceiling Mounting.** The product should be mounted to a wall or ceiling only as recommended by the manufacturer.

**25. Heat.** The product should be situated away from heat sources such as radiators, heat registers, stoves, or other products (including amplifiers) that produce heat.

Figure 1.  
Example of Antenna Grounding as per National Electrical Code, ANSI/NFPA 70

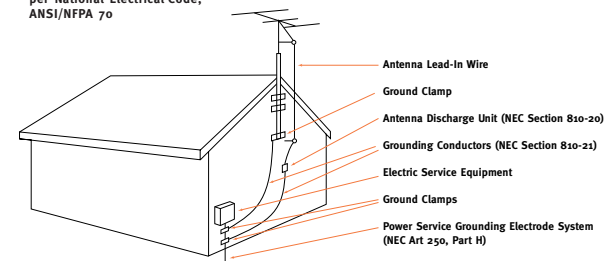

Part No. JBULBL 6/96

## included

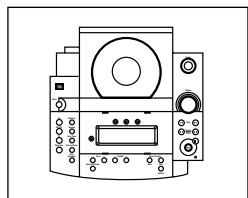

The Source.

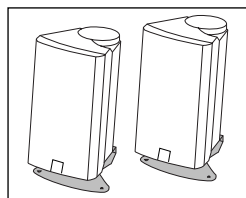

Two sat10/550 front satellite speakers (with removable shelf stands and wall-mounting brackets).

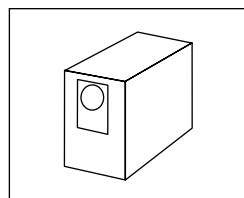

Powered subwoofer containing all amplification.

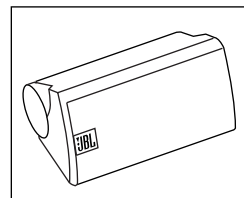

One sat10/550 center speaker.

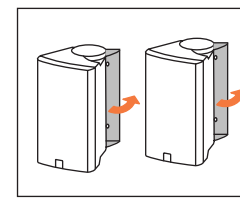

One pair of sat10 surround speakers with removable wall-mounting brackets.

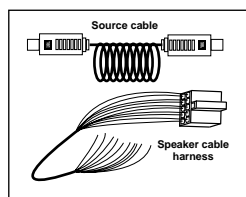

Cables.

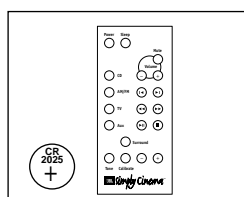

Remote with battery.

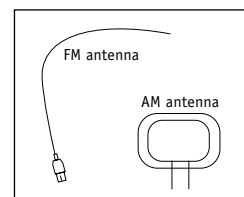

FM and AM antennas.

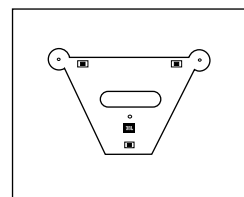

Wall bracket for Source.

## features

- Built-in CD player with
  - Random play
  - Repeat play
  - 8x oversampling
- AM/FM tuner with
  - 32 presets
  - Auto-preset function
- 250 watts total amplification
  - 100 watts – subwoofer
  - 35 watts each front channel
  - 23 watts each surround channel
- 2-way front satellite speakers with 3/4" titanium composite dome high-frequency drivers
- Powered bass reflex subwoofer with 2 x 6-1/2" woofers
- Adjustable, removable wall-mounting brackets for all speakers
- Video-shielded front satellite speakers
- Recessed wire channels on satellites and surrounds

# one. Speaker Placement

## Satellites

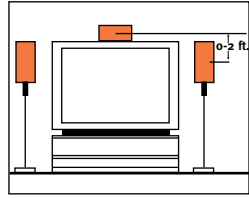
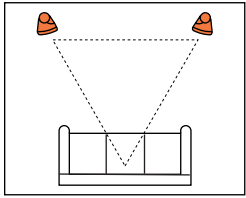

## Subwoofer

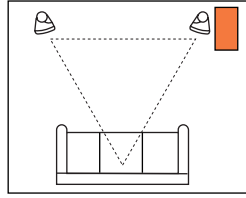

## Surround Speakers

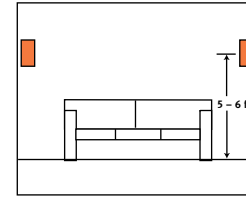
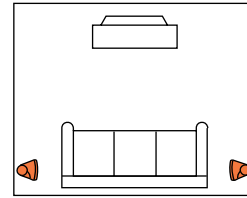

## Mounting Options

### Front

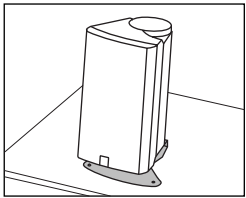

On shelves. Shelf stands included.

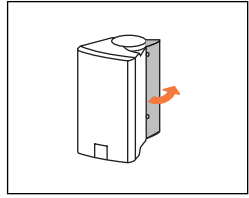

On the wall. Brackets and hardware included.

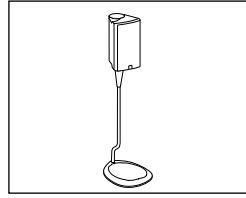

On optional stands.  
Part No. FS10/20.  
FS10/20WHT (white).

### Surrounds

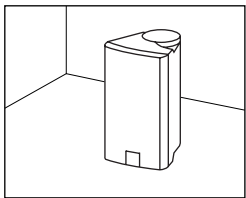

On shelves.

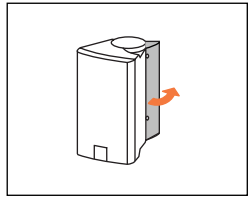

Wall-mounted. Brackets and hardware included.

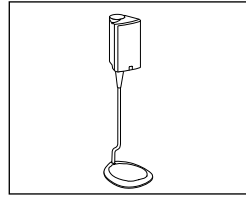

On optional stands.

## two. Connections

The ESC550 System's Main Power Switch, located on the Subwoofer, must be "Off" when making any connections. After all connections are com-

pleted the Main Power Switch should be set to "On" and remain "On" at all times unless the user is going on an extended vacation or changing

the connections. The Source's "Power" button will be used to turn the system on and off during normal operation.

### Connect TV or VCR to The Source

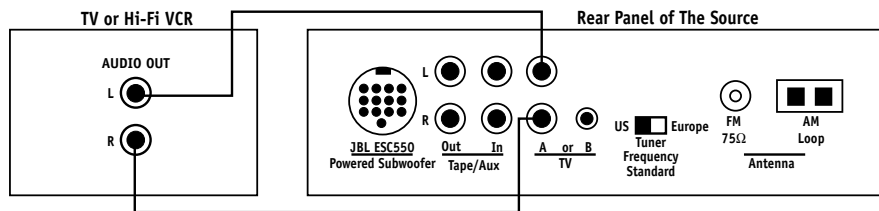

Note: The Source also provides a stereo mini-jack (B) to provide an easy connection to devices that have a stereo mini-jack audio output.

### Connect Antennas to The Source

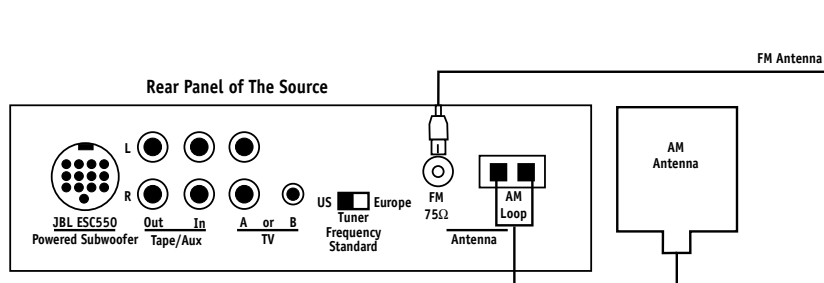

### Connect Optional Cassette Deck to The Source

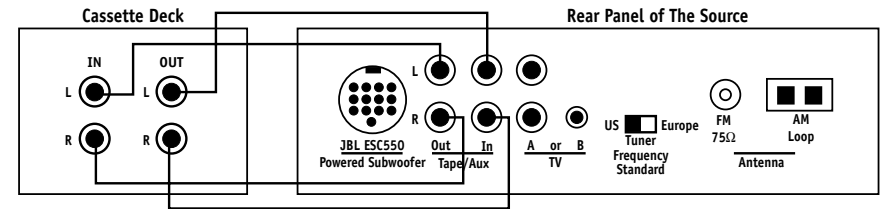

### Connect The Source to a Subwoofer

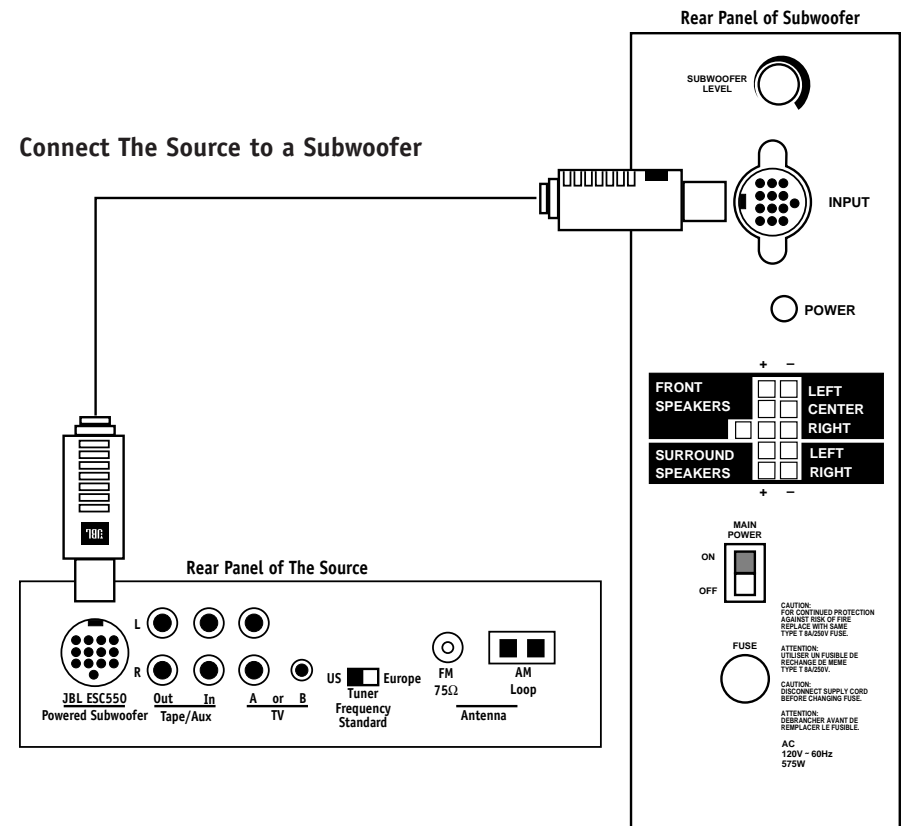

## Speaker Connection Tips

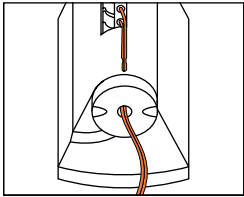

For satellites, thread speaker wire through the hole in the bottom of the speaker, then feed it through the recessed wire channel.

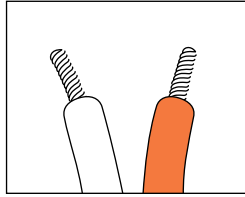

Separate and strip the ends of the speaker wire as shown. Speakers and electronics terminals have corresponding “+” and “-” terminals. It is important to connect both speakers identically: “+” on the speaker

to “+” on the amplifier and “-” on the speaker to “-” on the amplifier. Wiring “out of phase” results in thin sound, weak bass and a poor stereo image.

## Remote Control Battery Installation

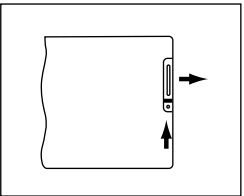

Push small tab towards battery slot and pull battery drawer out.

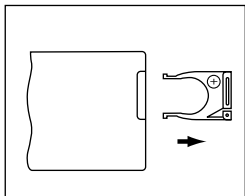

Remove old battery.

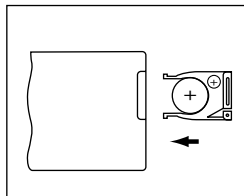

Insert new battery with “+” side up, and slide battery drawer back into remote.

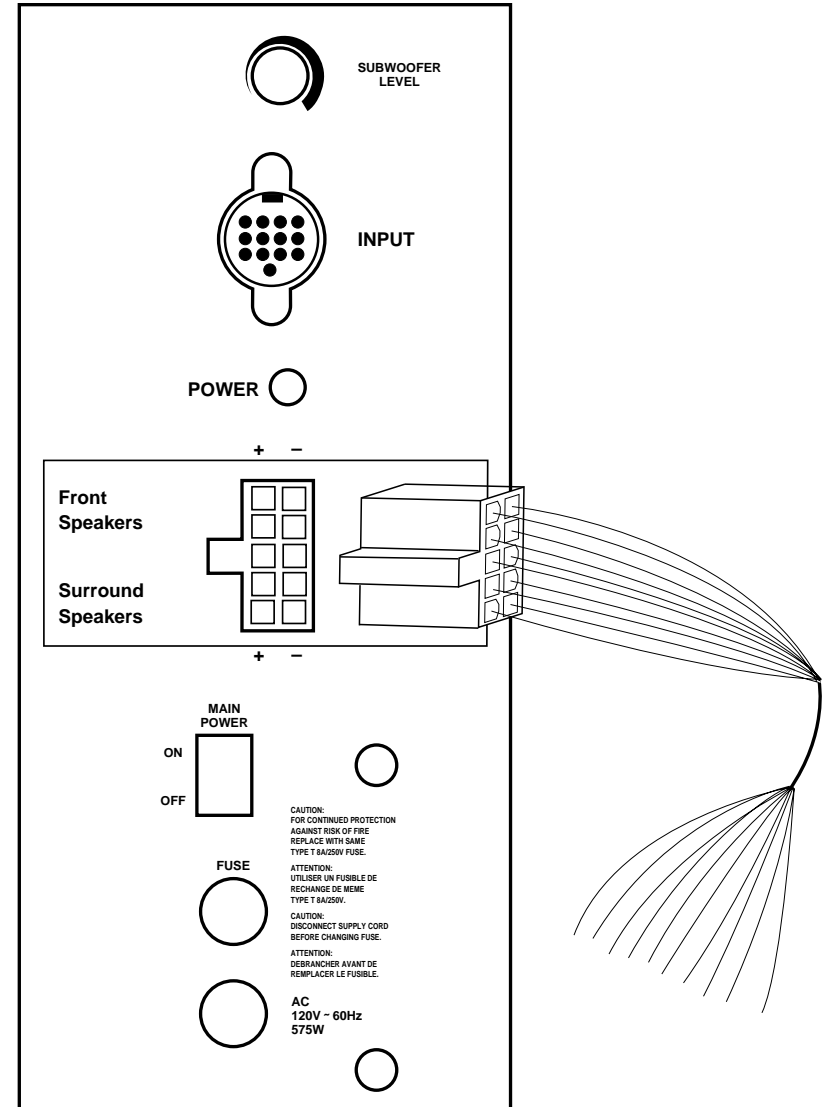

The speaker cables are clearly labeled for proper hook up to the corresponding speaker. Connect the “+” portion of the

cable to the red terminal on the speaker and the “-” portion of the cable to the black terminal on the speaker.

# three. Operation

## Volume

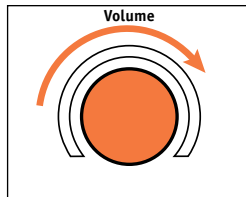

To raise volume: Turn control on The Source clockwise or

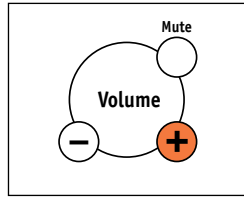

push "+" on the remote control.

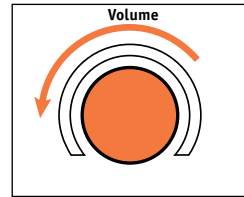

To lower volume: Turn volume control on The Source counterclockwise or

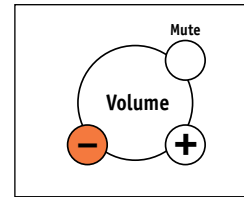

push "-" on the remote control.

## Mute

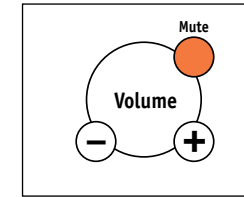

To lower volume completely: Push "Mute" on the remote control. When "Mute" is pushed again, the volume will return to its original level.

## Bass

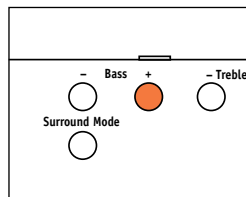

To raise the bass level: Push "+" on The Source or

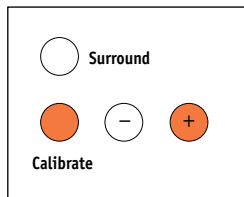

push "Calibrate" on the remote control until "Bass" illuminates in The Source display. Push "+" until you reach the desired level.

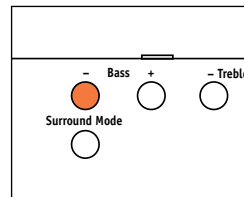

To lower the bass level: Push "-" on The Source or

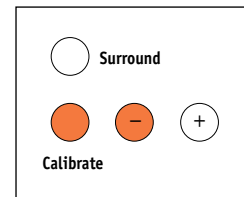

push "Calibrate" on the remote control until "Bass" illuminates in The Source display. Push "-" until you reach the desired level.

## Treble

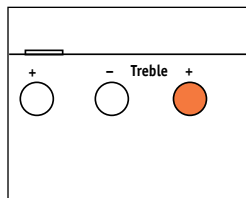

To raise the treble level: Push "+" on The Source or

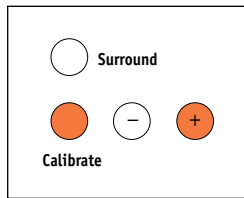

push "Calibrate" on the remote control until "Treble" illuminates in The Source display. Push "+" until you reach the desired level.

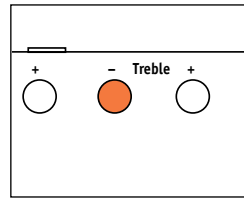

To lower the treble level: Push "-" on The Source or

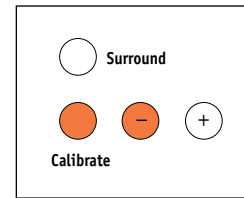

push "Calibrate" on the remote control until "Treble" illuminates in The Source display. Push "-" until you reach the desired level.





# The Source

## Remote Control

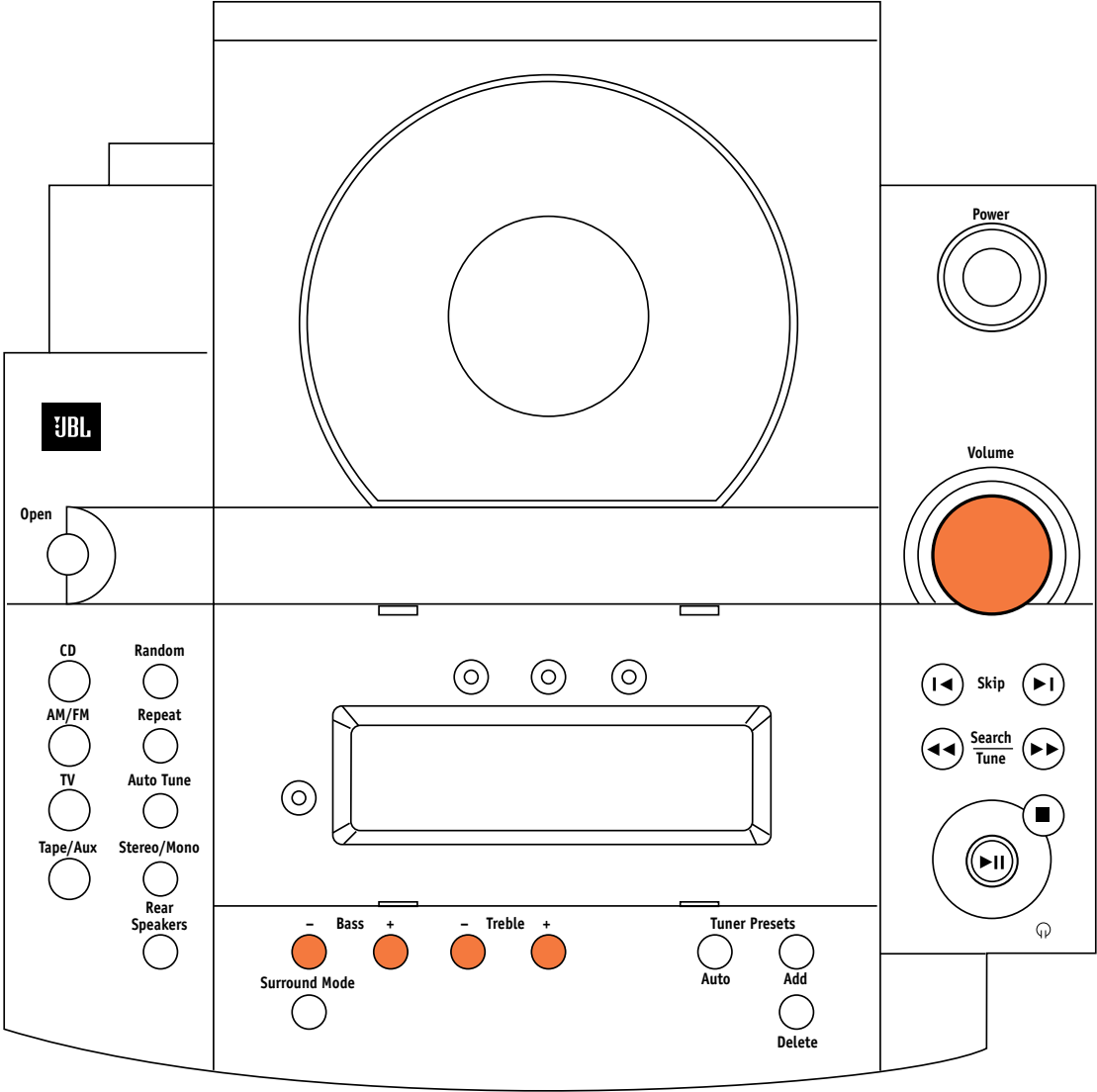
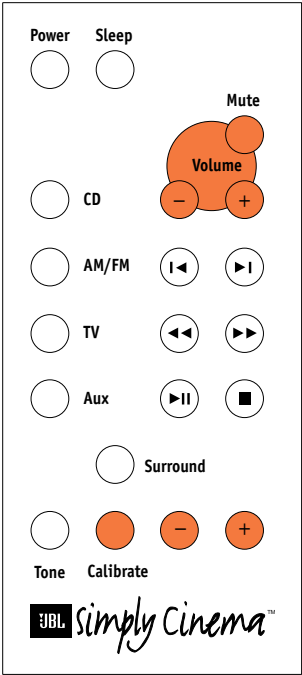



### The Source

### Remote Control

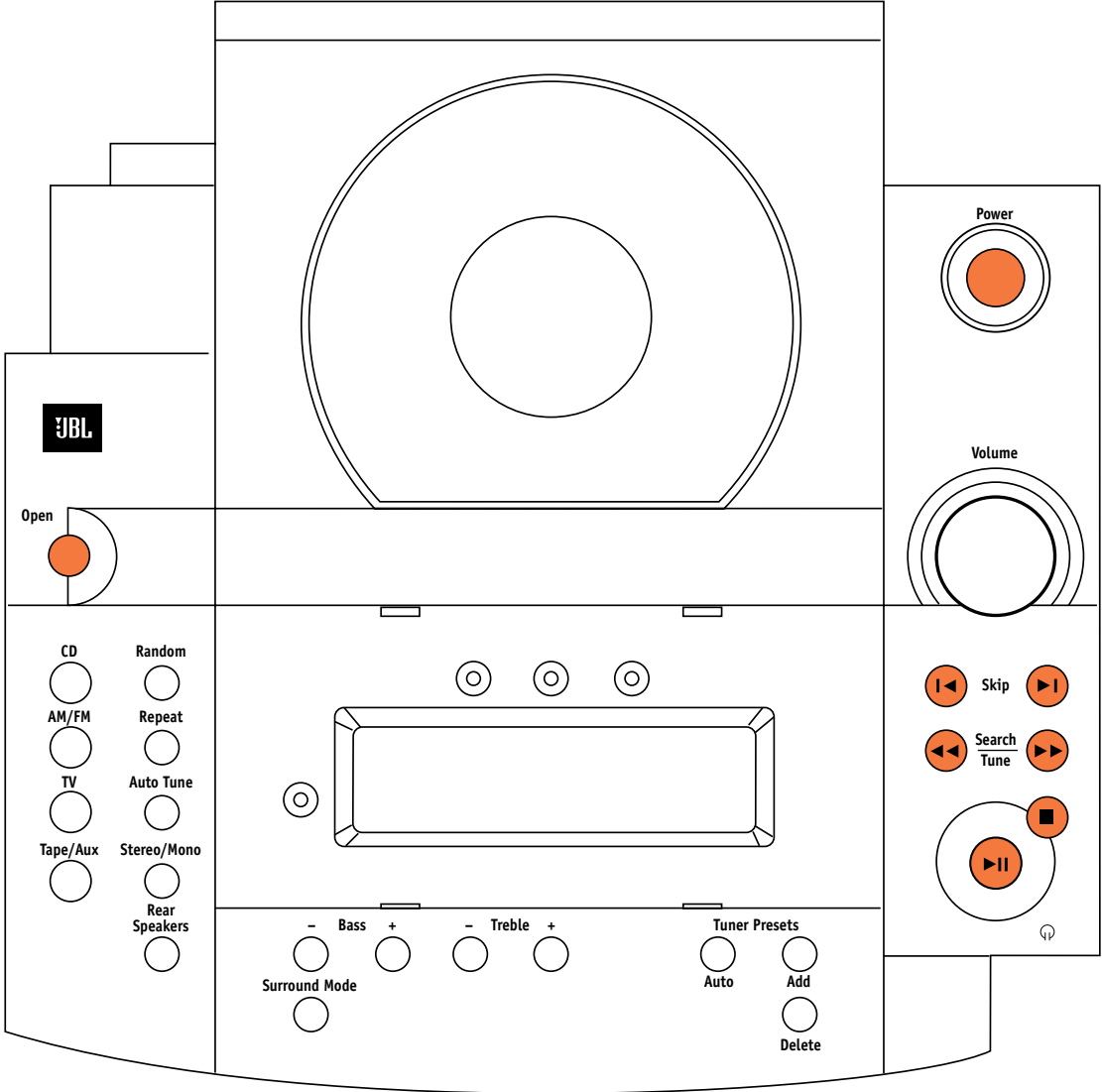
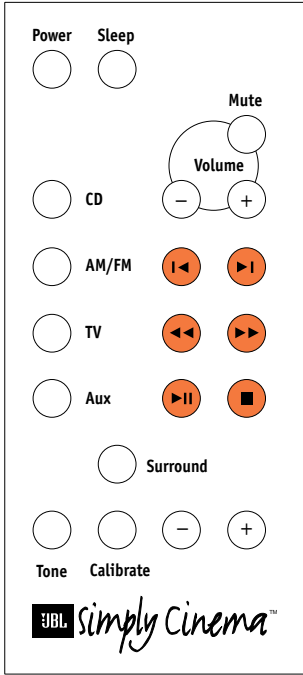

## CD Operation

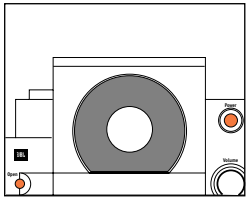

1. Push "Power" and/or "Open" on The Source.

2. Insert CD.

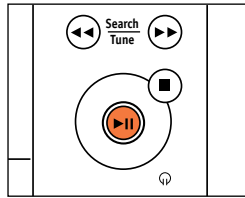

3. Push "Play" on The Source or

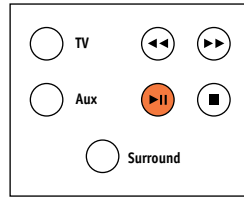

the remote control. (The door will close automatically.)

### To Skip to a Different Track:

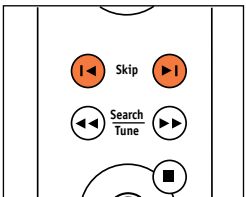

Push "Back" or "Forward," on The Source or

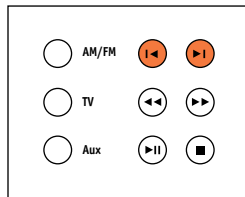

the remote control, until the number of the desired track appears on the display.

### To Scan Within the Same Track:

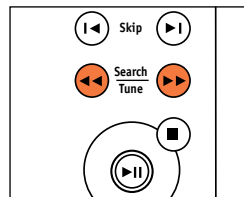

Push left arrow or right arrow on The Source or

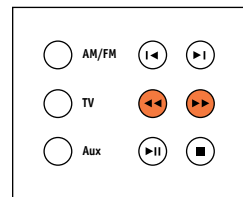

the remote control.

### To Pause the CD:

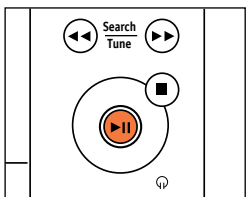

Push "Pause" on The Source or

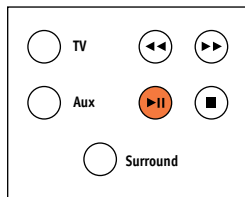

the remote control. Push again to resume play.

### To Stop the CD:

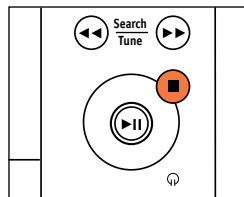

Push "Stop" on The Source or

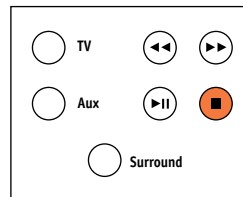

the remote control.

### To Play the Tracks of a CD in Random Order:

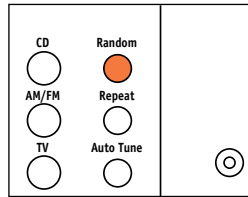

Push "Random" on The Source. The Source will automatically delete each track it has played from the "Random" operation.

### To Repeat the Disc:

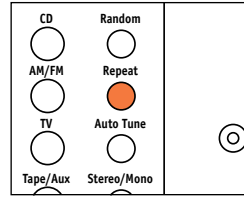

*Note:* If "Random" and "Repeat" are both engaged the CD player will randomly play the disc, deleting all played tracks, until the disc is finished. It will then randomly play the disc again.

Push "Repeat" on The Source.

### Tuner Operation

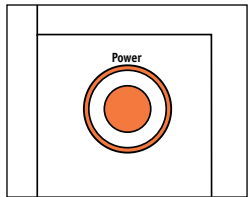

Push "Power" or "AM/FM" on The Source or the remote control.

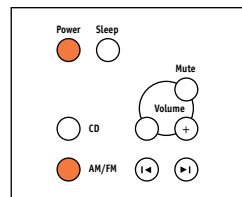
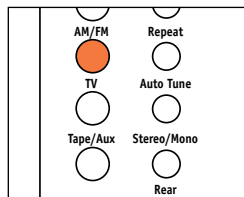

### To Switch Between AM and FM:

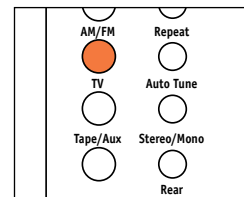

Push "AM/FM" on The Source or

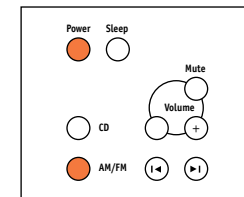

the remote control.

### To Tune to a Particular Station:

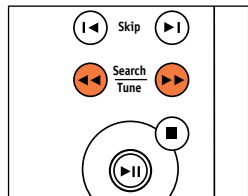

Push "<<" or ">>" on The Source or

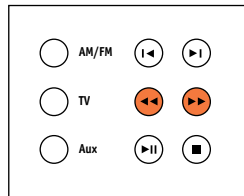

the remote control. To search rapidly, hold down the "<<" or ">>" button.



# The Source

## Remote Control

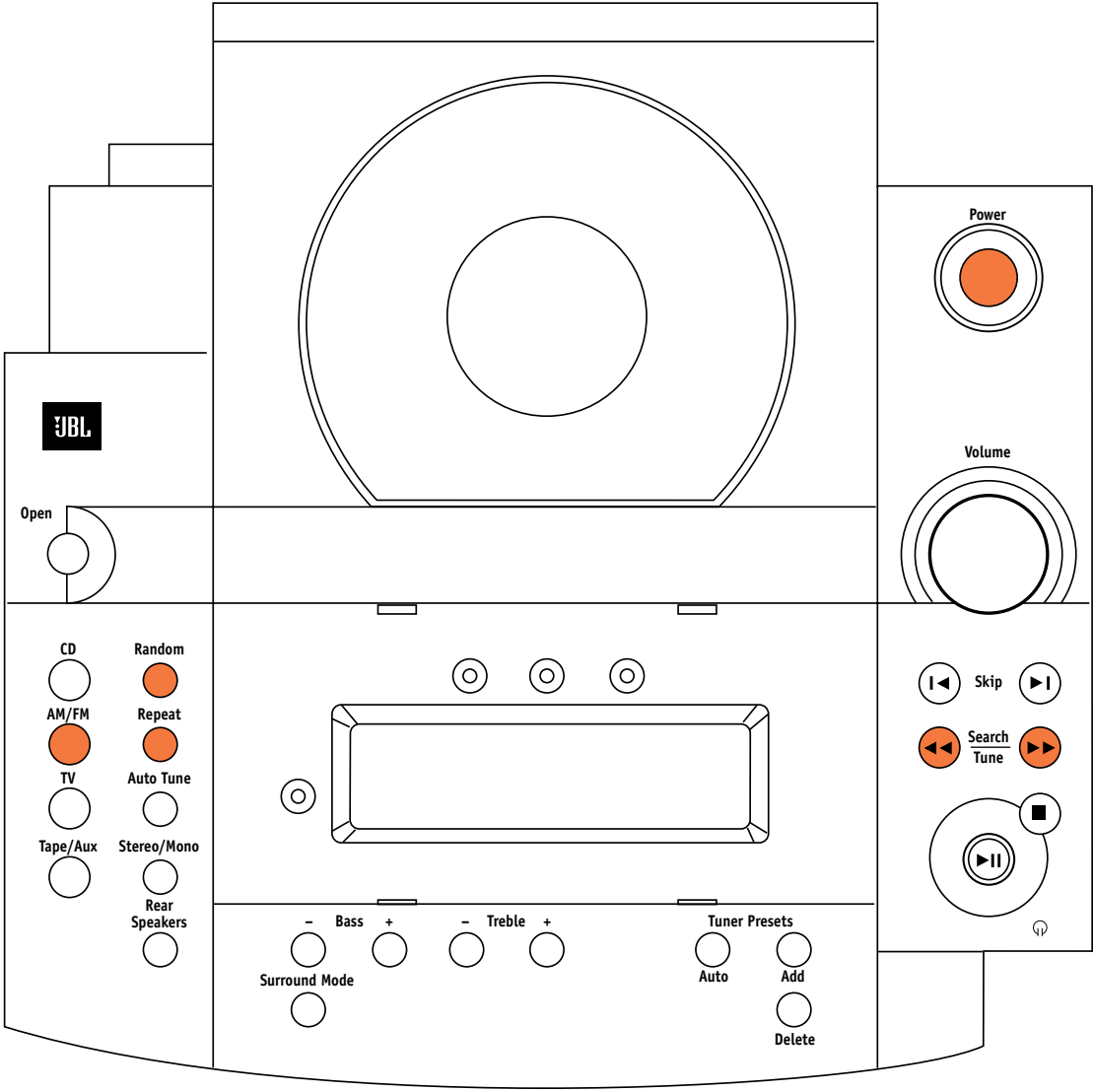
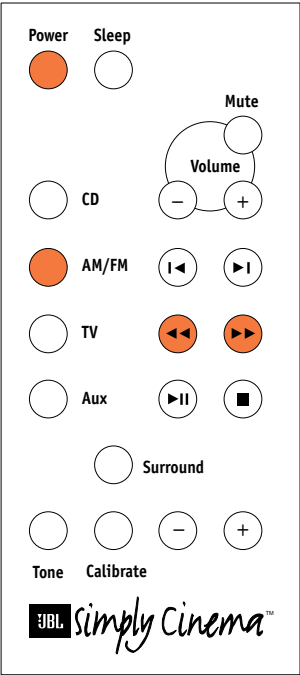

## If a Selected FM Station is a Little Noisy:

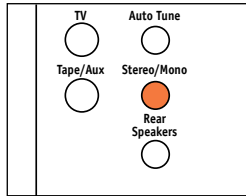

Push "Stereo/Mono" on The Source. This will play the selected station without any stereo separation, but there will be much less background noise.

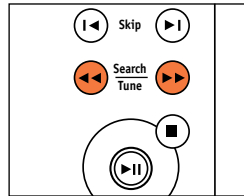

The "<<" or ">>" on The Source or

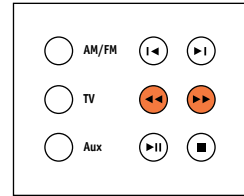

the remote control will tune up or down one frequency at a time.

## To Have the Tuner Search for the Next Strong Station:

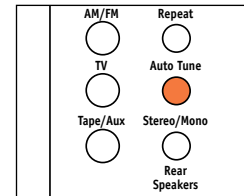

Push "Auto Tune" on The Source.

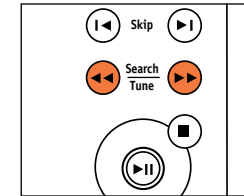

Then when you push "<<" or ">>" on The Source or

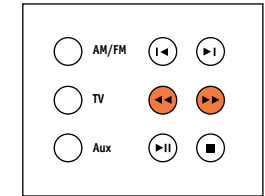

the remote the tuner will automatically advance to the next station with a strong signal.

## Preset Operation

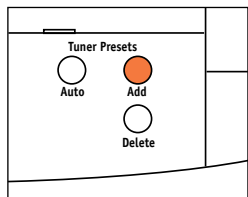

1. Tune to the station that you want to add into memory.
2. Push "Add" on The Source. That station is now added to your selection of stations in memory.

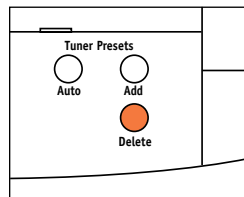

3. To delete a preset: Push "Delete" on The Source. That station is now removed from your selection of stations in memory.

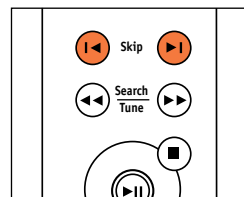

4. To skip between preset stations: Push "<<" or ">>" on The Source or

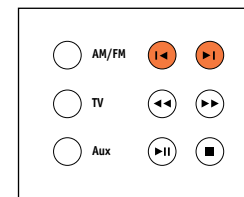

the remote control.

The Source has a unique feature that will automatically place up to 32 stations in memory. To activate this feature, push and hold the "Auto" button for one second. The tuner will search the dial and place the stations with a strong signal into memory.

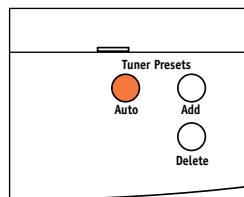

*Note:* Activating this feature will delete all stations that were previously stored in memory. To prevent this from accidentally occurring, the Auto button will only activate if held for a full second.



# The Source

## Remote Control

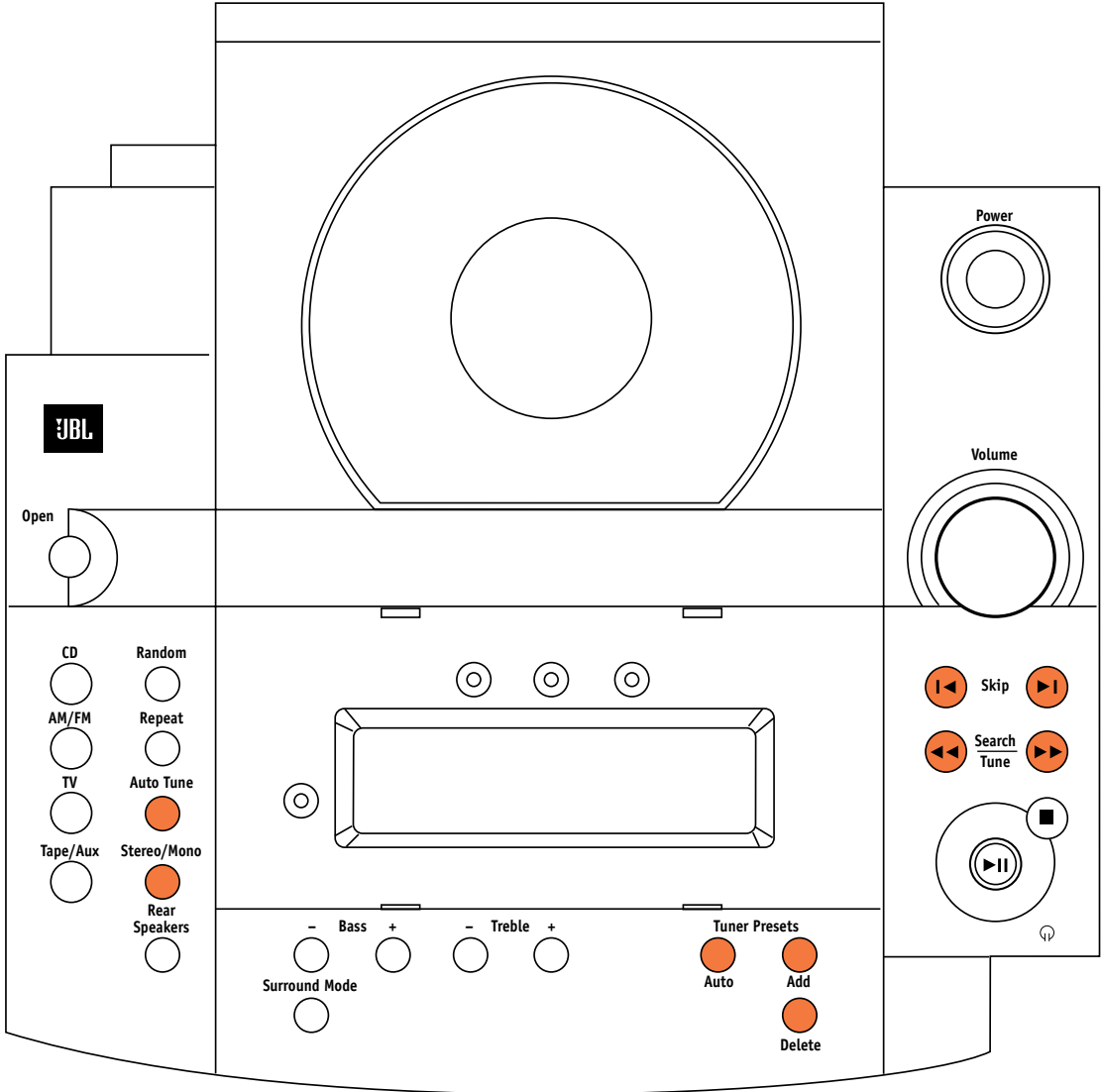
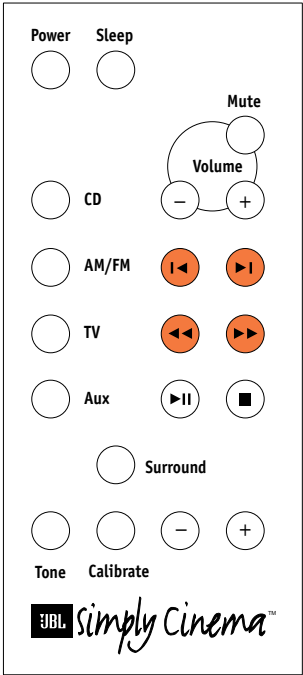



# The Source

## Remote Control

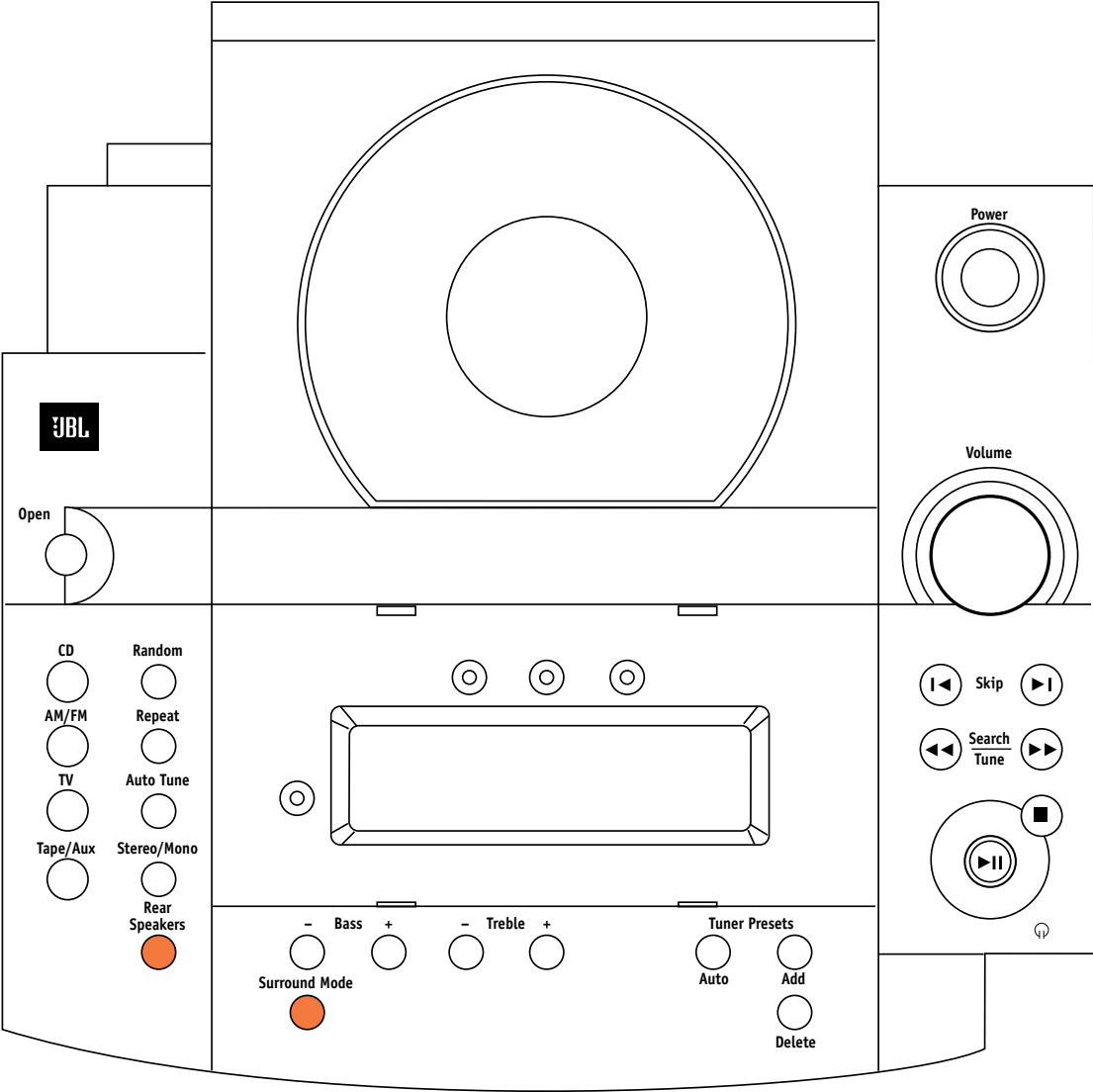
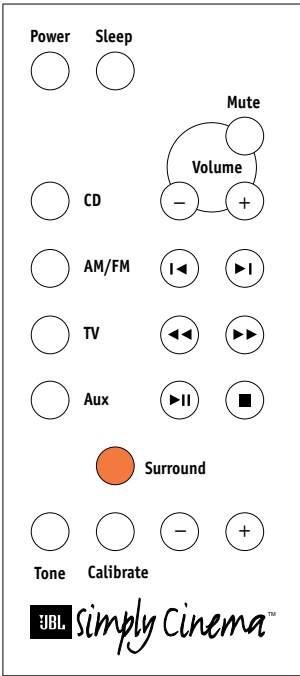



## Surround Mode Operation

### What is Dolby\* Pro Logic\*?

Dolby\* Pro Logic\* is an encode/decode process by which four channels of sound-track information are encoded into two channels for playback on VCRs, laser disc players, and some TV broadcasts, and then decoded back into four

channels for playback through five loudspeakers. Remember that a Dolby Pro Logic system consists of three channels of information for front left, center, and right speakers and one channel of mono surround information. The surround

channel is played back through two speakers. Dolby Pro Logic helps to re-create all of the impact and excitement of a movie theater in your home.

This system contains three surround modes.

1. Dolby Pro Logic – In this mode all five speakers are used.

2. Dolby Pro Logic Phantom – In this mode the center channel does not operate. This may be preferred when listening to a music source that was not recorded with surround channel information.

3. 2-channel – In this mode the program is played back in a traditional stereo form.

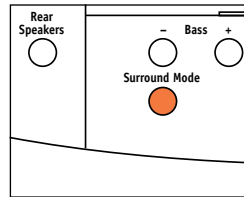

To switch between the three surround modes: Push "Surround Mode" on The Source or

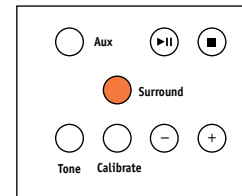

the remote control.

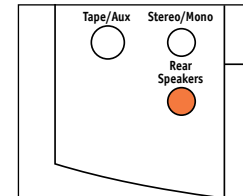

If you are listening to a program in the Dolby Pro Logic Normal or Phantom mode and you wish to turn off the surround speakers: Push "Rear Speakers" on The Source.

## Test Tone

For proper Dolby Pro Logic operation, a test tone is used to calibrate the volume settings of the speakers. A noise will be heard cycling, in order, from the front left, center, right, and both surround speakers.

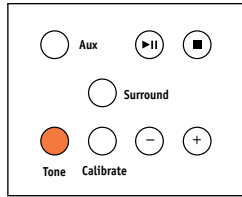

Using the remote control, push "Tone." Then adjust the Center and Surround levels until the volume of all the speakers is the same during the test. *Note:* The test tone is used to calibrate the performance of the system. When listening to an actual recording, the

volume level of the surround channels is generally much lower than that of the front channels. In fact, when listening to a movie, virtually all of the dialogue and a substantial number of the effects are reproduced through the center channel.

## Balance

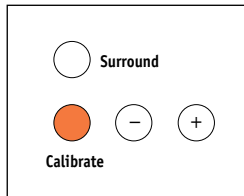

Push "Calibrate" on the remote control until "Balance" appears in the display.

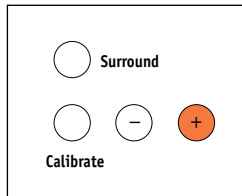

Push "+" on the remote control to adjust the balance toward the right speaker.

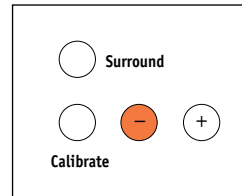

Push "-" on the remote control to adjust the balance toward the left speaker.

## Center Channel Volume

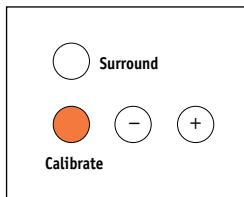

Push "Calibrate" on the remote control until "Center" appears in the display and the corresponding LED on top of the display is lit.

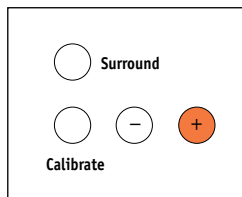

Push "+" on the remote control to increase the volume of the center channel.

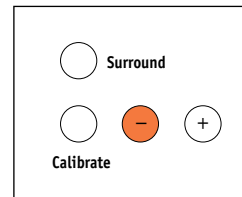

Push "-" on the remote control to decrease the volume of the center channel.



# The Source

## Remote Control

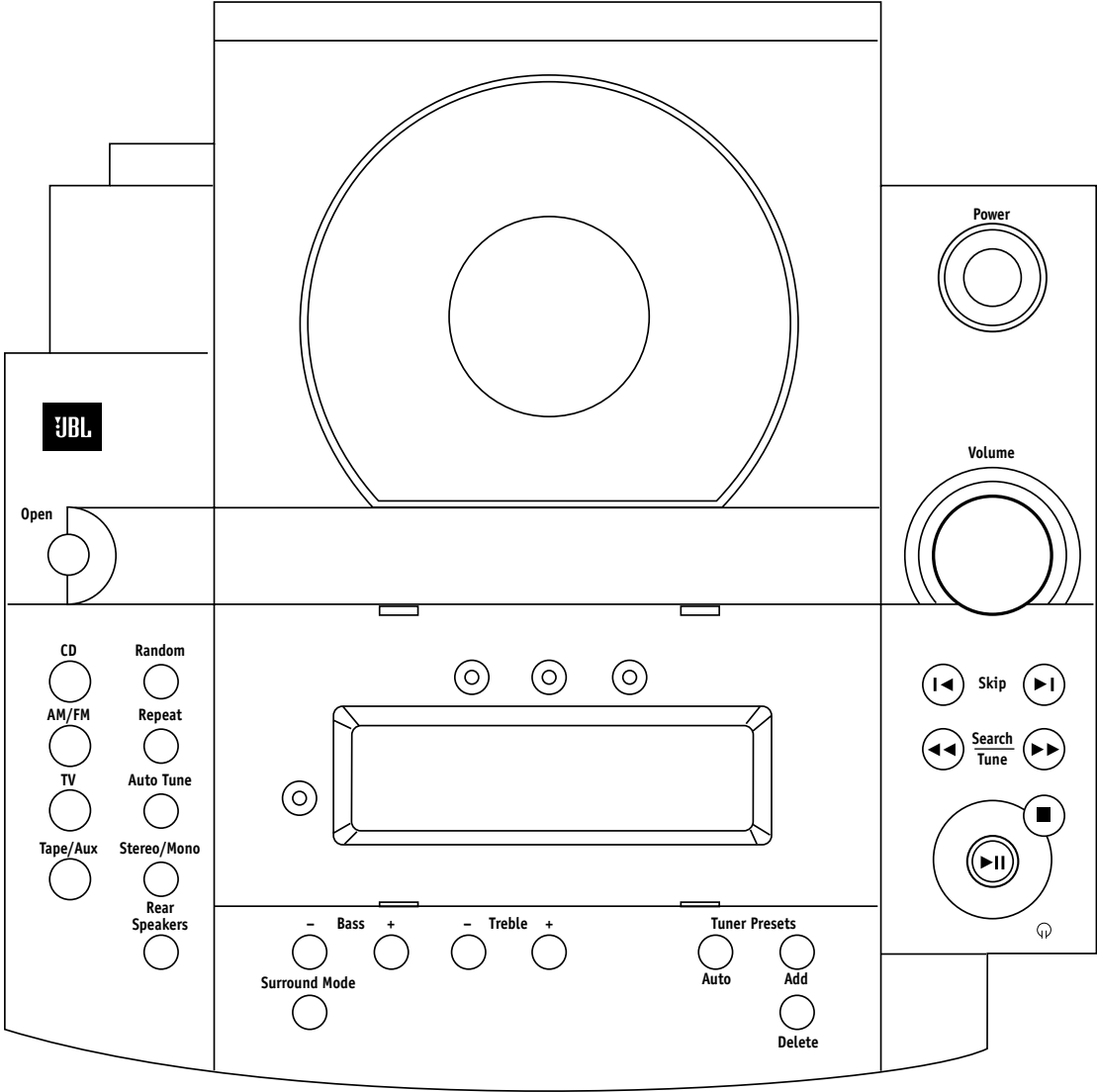
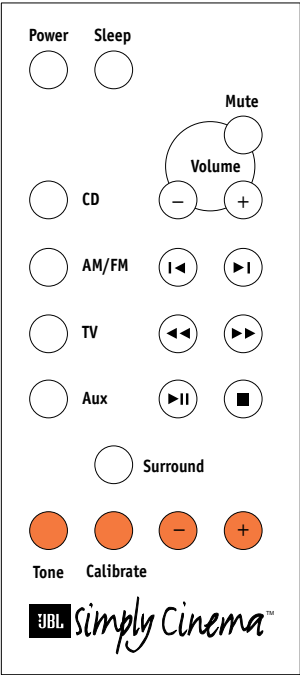

## Rear Channel Volume

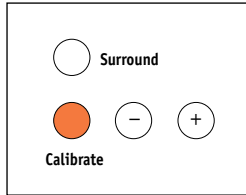

Push "Calibrate" on the remote control until "Rear" appears in the display and the corresponding LED on top of the display is lit.

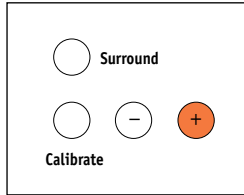

Push "+" on the remote control to increase the volume of the rear channels.

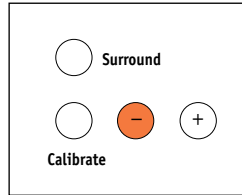

Push "-" on the remote control to decrease the volume of the rear channels.

## Delay Time

The delay control allows the user to set the surround delay between 15 and 30 milliseconds in 1 millisecond increments. The best setting will depend on the distance between the main listening

area and the front speakers as well as the distance between the main listening area and the rear speakers. The chart at the bottom shows the recommended settings.

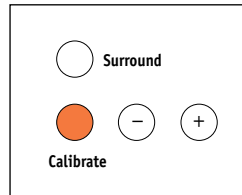

Push "Calibrate" on the remote control until "Delay" appears in the display and the corresponding LED on top of the display is lit.

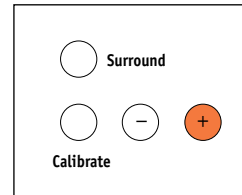

Push "+" on the remote control to increase the delay time.

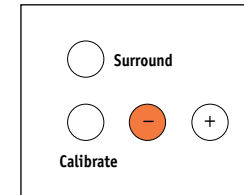

Push "-" on the remote control to decrease the delay time.

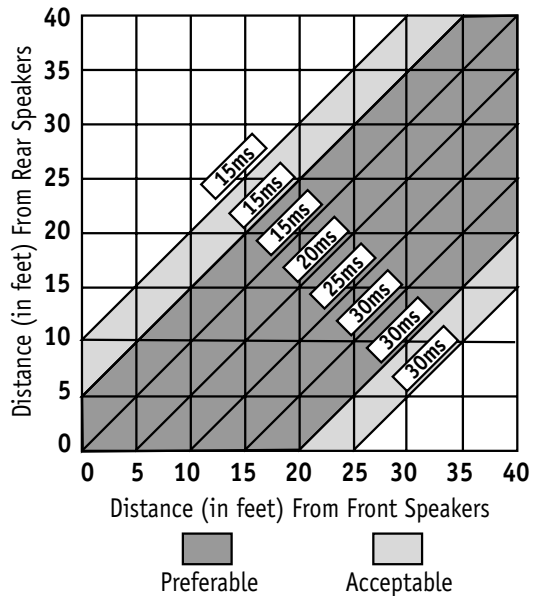



# The Source

## Remote Control

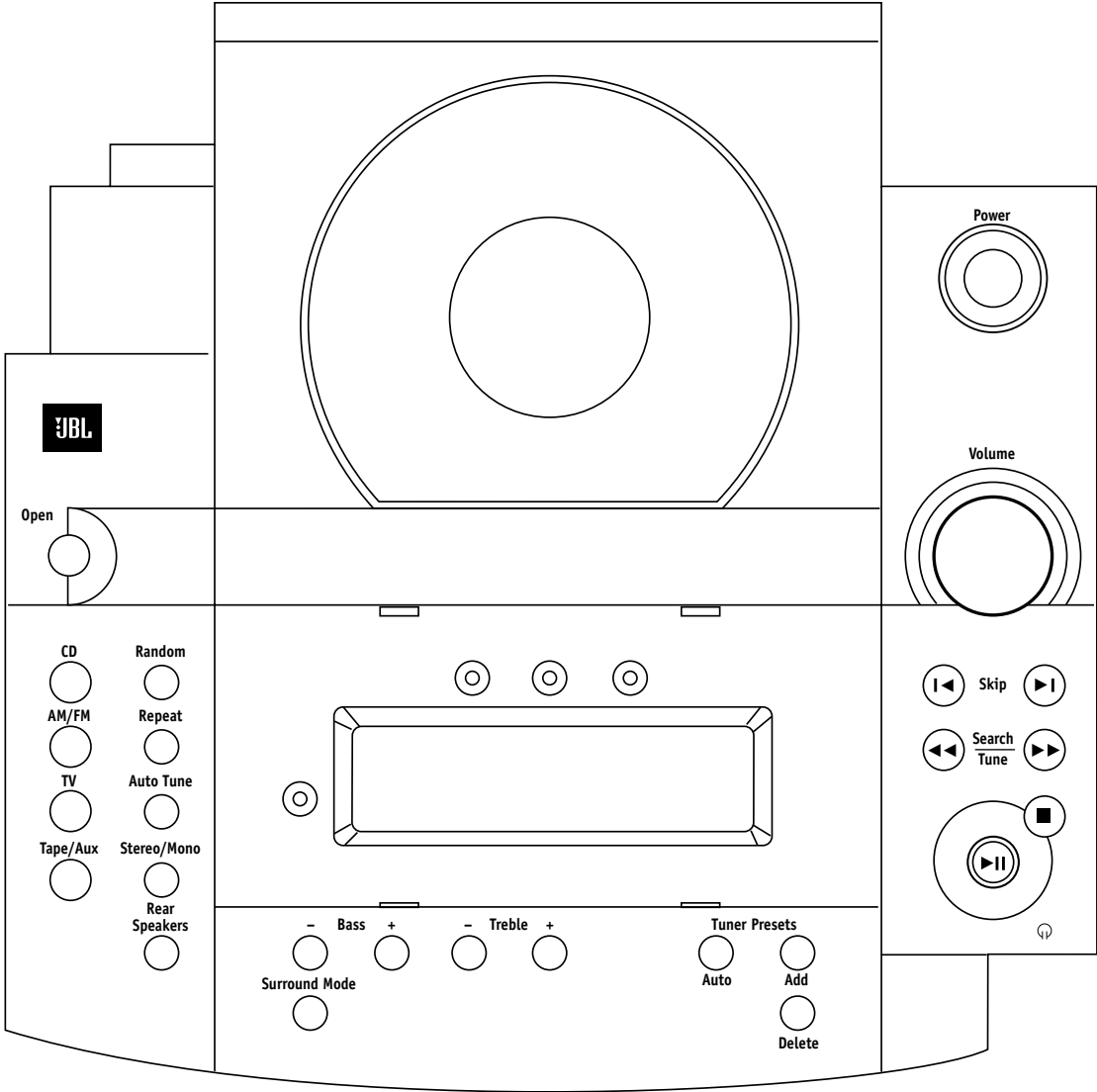
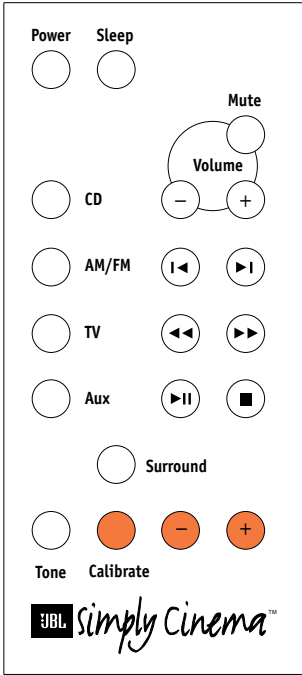

## Troubleshooting

**If there is no sound from any of the speakers, check the following:**

- Make sure the subwoofer is plugged into an active AC wall outlet.
- Make sure the Master Power Switch, located on the rear of the subwoofer, is in the "On/Standby" position.
- Make sure there is a source – for example, a VCR or television – hooked up to the TV or tape/aux input jacks on The Source.
- Make sure that the program material is playing.
- Recheck the hookup connections.

**If most of the sound comes from the center channel speaker, with little or no information from the surround channels, note the following:**

Although most of today's televisions are equipped with stereo audio output jacks, some stereo televisions have poor audio sections and are unable to provide a Dolby Pro Logic encoded signal. In the unlikely event that you experience this problem, connecting the audio outputs from your Hi-Fi VCR, laser disc player, DVD player, or satellite receiver directly to one of the inputs on The Source will provide a proper audio signal and allow you to enjoy true Dolby Pro Logic surround sound.

**If there is no sound from the surround speakers or it is very low, check the following:**

- Check all connections between amplifier and each of the speakers.
- Raise the surround volume from the remote control (see "Operation" section).
- Make sure the TV show or movie you are watching is recorded in Dolby Surround.

**If there is no sound from the center speaker, check the following:**

- Make sure that the processor is in the Pro Logic, or 3 Stereo mode. If it is in Phantom or Stereo mode, the center speaker will not play.
- Check the connections between the subwoofer and the center speaker.

**If you have low bass output, check the following:**

- Experiment with placement of the subwoofer. Remember, place the subwoofer in a corner to get maximum bass output from the system.
- Increase the level of bass, using the remote control.
- Adjust the level control on the rear of the subwoofer.

**If you are having trouble picking up radio stations, check the following:**

- Make sure the antenna is hooked up properly.
- Depending on your distance from the station's transmitter, you may need to install an FM antenna on the roof or in the attic.

# Specifications

## Components

### The Source

surround sound processor,  
CD player, AM/FM tuner

### Subwoofer

dual 6-1/2" drivers in a bass-  
reflex enclosure

### Satellite Speakers

3/4" titanium tweeters,  
3-1/2" neodymium midrange  
driver

### Surround Speakers

3-1/2" full-range neodymium  
drivers

### System Remote

credit-card-sized hand-held  
controller

## ESC550 System

### Amplifier

250 watts total  
system output;  
front channels:  
35 watts x 3 @ .1% THD;  
surround channels:

23 watts x 2 @ .1% THD;

subwoofer:

100 watts x 1 @ 1% THD

### System Frequency

### Response (-6dB)

35Hz - 20kHz

### Signal-to-Noise Ratio

90dB

### Input Impedance

20k ohms

### Input Sensitivity

1500mV

## The Source

### Dimensions (H x W x D)

4-5/8 x 10-1/4 x 9-3/4 inches  
117 x 260 x 248mm

### Weight

5 lbs/2.3 kg

## Subwoofer

### Dimensions (H x W x D)

15-3/4 x 8-1/2 x 20 inches  
400 x 216 x 508mm

### Weight

40 lbs/18.2 kg

## Satellites

### Dimensions (H x W x D)

6-1/2 x 3-3/4 x 4-1/4 inches  
165 x 95 x 108mm

### Weight

1.5 lbs/.7 kg

## Surround Speakers

### Dimensions (H x W x D)

6-1/2 x 3-3/4 x 4-1/4 inches  
165 x 95 x 108mm

### Weight

1.5 lbs/.7 kg

## System Remote

### Dimensions (H x W x D)

4-7/8 x 2-1/4 x 1/4 inches  
124 x 57 x 6mm

### Weight

.25 lbs/.11 kg

Occasional refinements may  
be made to existing products  
without notice, but will  
always meet or exceed  
original specifications unless  
otherwise stated.



JBL Consumer Products  
80 Crossways Park West, Woodbury, NY 11797  
8500 Balboa Boulevard, Northridge, CA 91329  
1-800-336-4JBL (4525) (USA only)  
[www.jbl.com](http://www.jbl.com)

© 1997 JBL, Incorporated. JBL and Simply Cinema are registered trademarks of JBL, Incorporated.

\*Trademarks of Dolby Laboratories.

Printed in USA 2/97 ♻️ Part No. ESC5500M

**H** A Harman International Company



## Free Manuals Download Website

<http://myh66.com>

<http://usermanuals.us>

<http://www.somanuals.com>

<http://www.4manuals.cc>

<http://www.manual-lib.com>

<http://www.404manual.com>

<http://www.luxmanual.com>

<http://aubethermostatmanual.com>

Golf course search by state

<http://golfingnear.com>

Email search by domain

<http://emailbydomain.com>

Auto manuals search

<http://auto.somanuals.com>

TV manuals search

<http://tv.somanuals.com>