

© 2005 GN Netcom A/S. All rights reserved. Jabra is a registered trademark, wholly owned by GN Netcom Inc., and MiniGels is a trademark of GN Netcom Inc. in the USA, and these trademarks may be registered in other countries. US and foreign patents pending. Design and specifications subject to change without notice. The Bluetooth® word mark and logos are owned by the Bluetooth SIG, Inc. and any use of such marks by the companies in the GN Netcom Group is under license.

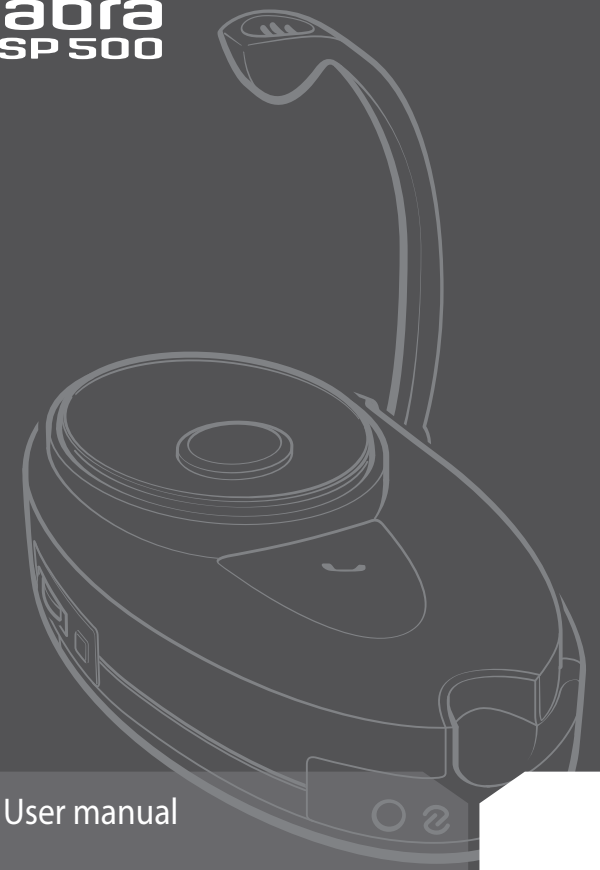

**Jabra**  
SP 500



[www.jabra.com](http://www.jabra.com)



User manual

User manual

RELEASE YOUR JABRA

**Jabra**

**Jabra**

[www.jabra.com](http://www.jabra.com)

Fig. 1

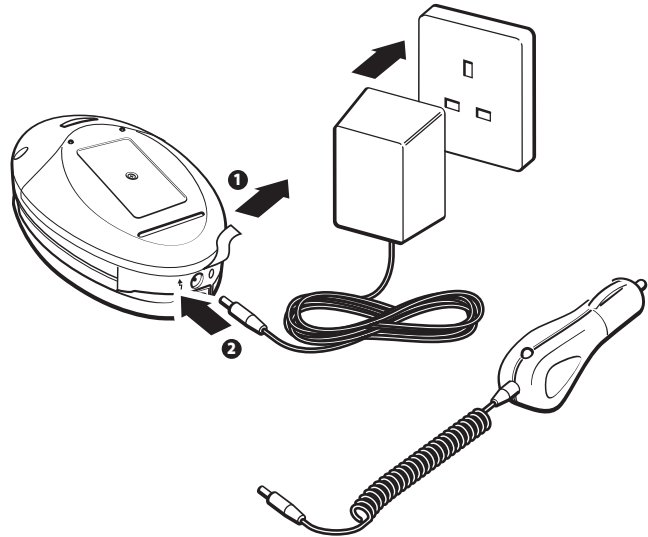

Fig. 2

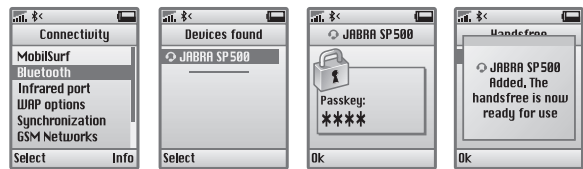

Fig. 3

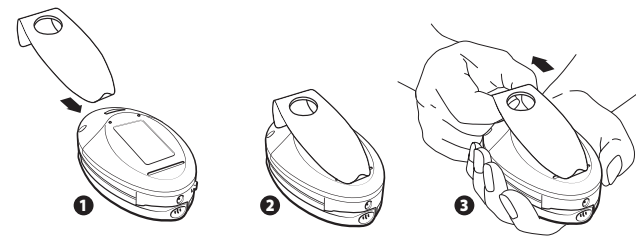

Fig. 4

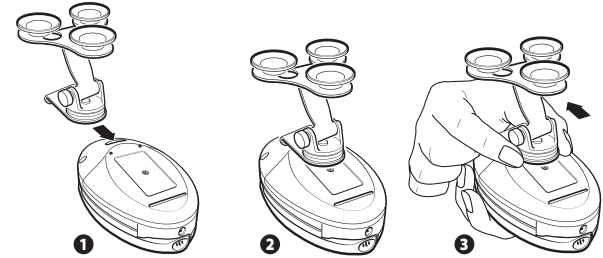
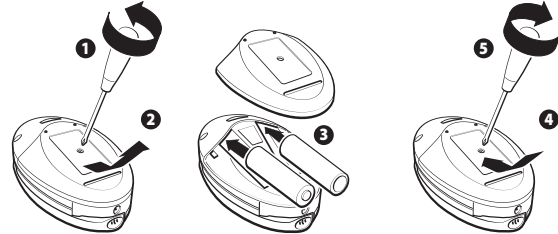

Fig. 5



English ..... 1  
 繁體中文 ..... 13  
 简体中文 ..... 25  
 日本語 ..... 37  
 중국어 ..... 49  
 Bahasa Malaysia ..... 61  
 ภาษาไทย ..... 73

# English

Thank you .....	2
1. Check for phone compatibility .....	3
2. Charge the batteries .....	3
3. Switching on the Jabra SP500 .....	3
4. "Pair" with your Bluetooth® mobile phone.....	4
5. Making a call .....	4
6. Ending a call.....	5
7. Answering a call .....	5
8. Muting a call .....	5
9. Call-waiting .....	5
10. Indicator light .....	5
11. Office mode .....	6
12. Choosing speakerphone placement.....	6
13. Replacing the batteries .....	7
14. Enhanced features (for Bluetooth mobile phones with hands-free profile) .....	7
15. Frequently asked questions .....	8
16. Storage of the Jabra SP500.....	8
17. Need more help? .....	9
18. Warranty .....	9
19. Certification and safety approvals .....	10
20. Glossary .....	11

## Thank you

Thank you for purchasing a Jabra SP500 the most versatile Bluetooth speakerphone on the market. Jabra has become the market leader in hands-free communication products through the innovation and performance of our products. The Jabra SP500 is designed to perform superbly in any location – in the car, the home or the office.

## ! Drive safely

Several studies have shown that cell phone usage while driving creates a distraction to the driver which may increase the likelihood of an accident. This distraction potential is not eliminated by the use of a hands-free phone. Hands-free phones have not been shown to be safer than hand-held phones with respect to driver distraction. When using the phone while driving, keep conversations short and resist any temptation to make notes or read documents. Before answering calls consider your circumstances. Pull off the road and park before making or answering calls when driving conditions require (e.g. bad weather, high traffic density, presence of children in the car, difficult junctions or manoeuvres.)

### Remember, driving comes first, not the call!

#### Abide by local laws.

Please check if the local laws where you live restrict the use of mobile phones while driving. It is the owner's responsibility to use this product in compliance with the laws of the place where you live.

## Jabra SP500 Overview

- 1 Multi-function Button
- 2 Indicator Light (Blue/Yellow/Red)
- 3 Volume Control
- 4 Mute Button
- 5 Microphone Boom
- 6 Pairing button
- 7 Charging Socket
- 8 Speaker

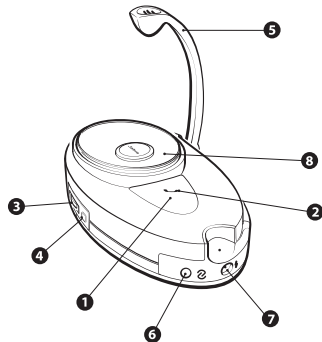

## BEFORE USING YOUR SPEAKERPHONE

### 1 Check for phone compatibility

The Jabra SP500 is compatible with most Bluetooth<sup>1</sup> (see **Glossary**) mobile phones. You can check whether your phone has Bluetooth capability by visiting your phone manufacturer's web site or Jabra's web site (<http://www.Jabra.com/JabraCMS/NA/EN/MainMenu/Products/ProductFinder.htm>) which has complete information on compatibility.

### 2 Charge the batteries

The Jabra SP500 comes complete with two 1.2-volt (AA 2000 mAh) rechargeable batteries that must be fully charged before you use the speakerphone for the first time.

1. Important: Remove the battery protection plastic sheet to activate the batteries. (*See fig. 1.1*)
  2. Plug the adaptor jack into the speakerphone and the AC adaptor or the vehicle power charger into a power socket. (*See fig. 1.2*)
  3. The red light will turn on when charging begins. After approximately 2 hours the red light will go out indicating that the Jabra SP500 is fully charged.
  4. Unplug the AC adaptor or the vehicle power charger lead from the speakerphone.
  5. You are now ready to "pair" the Jabra SP500 with your mobile phone. (*See Section 4*)
- ! WARNING:** Using another AC adaptor other than the one provided may damage or destroy the speakerphone. We recommend that you use the rechargeable batteries supplied but you can use other brands. **You can not use non rechargeable batteries in your Jabra SP500.**

### 3 Switching on the Jabra SP500

#### Switch on the Jabra SP500

1. Press and hold the multifunction button  until you hear the start up melody and the blue LED flashes three times. When the Speakerphone is in standby mode, the Blue LED flashes every three seconds.

*Please note that the Blue light will be automatically switched off after 1 min in order to save power and to not distract when driving at night. The light will be re-activated upon any key press.*

#### Switch off the Jabra SP500

1. Press and hold the multifunction button for approximately 5 seconds until you hear the shut down melody and the LED has been switched off completely.

## 4 "Pair"<sup>2</sup> with your Bluetooth mobile phone

1. Ensure SP500 is switched on. (*See section 3*)
  2. Press the Pairing button until you see a **solid blue** light (approximately 2 seconds), then **release**. Your Speaker phone is now in pairing mode.
  3. Set your Bluetooth phone to "discover" the speakerphone by following your phone's instruction guide. Typically, the steps involve going to a "setup", "connect", or "Bluetooth" menu **on your phone** and then selecting the option to "discover" a Bluetooth device\*. (*See example from a typical mobile phone in fig. 2*)
  4. Your phone should find the "Jabra SP500" speakerphone and ask if you want to pair with it. Confirm by pressing "yes" or "ok".
  5. Enter **passkey or PIN<sup>3</sup> = 0000 (4 zeros)**, then press "yes" or "ok"
- ❗ **IMPORTANT:** *If pairing was successful, the blue indicator light will briefly flash rapidly before going back to flashing blue every 3 seconds. You will also hear the confirmation melody. If unsuccessful, the light remains solid, and you'll need to re-attempt pairing. (See steps 3-5 above)*

## USING YOUR Jabra SP500

Before using your Jabra SP500, ensure that the batteries are charged and the Jabra SP500 is paired (see item 3) with your Bluetooth mobile phone and switched on.

The speakerphone can be used while being recharged from a wall socket or from the car charger.

## 5 Making a call

### Using your mobile phone's keypad

1. Dial number on keypad.
2. Press phone's "send" key.
3. The Jabra SP500 has automatic volume control and will automatically adjust the speaker volume based on the relevant background noise. In order to adjust the volume according to your own preferences, use the volume control wheel.



### Using voice-dialling (if supported by your phone)

1. Press and release  once. You'll hear one short beep while doing this.
  2. You'll then hear the voice-activation tone; say the name of the person you wish to call.
- ❗ **NOTE:** *Record voice tag via your mobile phone. If you have a Nokia phone you will be able to record the voice tags via your Speakerphone.*

## 6 Ending a call

- Press and release  once
- OR**
- End call from your mobile phone's keypad

## 7 Answering a call

- After you hear the ring tone, press and release  once.
- OR**
- Answer the call with your mobile phone's keypad. You may then need to transfer the call to the speakerphone by pressing and releasing  once (depending on your phone).

## 8 Muting a call

- To enable mute press the mute button for one second and you will hear a short beep. You'll see solid **yellow** light.  
To disable mute function press the **mute button** briefly.

## 9 Call-waiting

- It is recommended that you use your mobile phone's keypad which typically involves pressing the "send" button.
- OR**
- Press and hold  until you hear two beeps to answer the incoming call and switch between calls (some phones do not support call-waiting via this method).

## 10 Indicator light

To avoid the Jabra SP500's LED lights from distracting you when driving at night the LED lights will be switched off 1 min after an active call. It is also possible to prevent the LED from flashing by pressing and holding the mute button for 10 seconds until you hear a second beep. The Jabra SP500 will still function during this time. When you switch off the unit and then switch it back on again the LED lights will commence flashing again.

## 11 Office mode

Office mode creates the appropriate sound sensitivity to provide optimal performance of the Jabra SP500 in the office or home environment. It's recommended that you only use this mode in mentioned environment.

- By pressing and holding the mute button for 5 seconds you will see the blue LED flash rapidly and hear a short beep
- To return to normal mode, repeat the above action

**When Jabra SP500 is in office standby mode, blue LED flashes twice every 3 seconds.**

*For optimal performance during teleconferences, please ensure all participants face the microphone*

## 12 Choosing speakerphone placement

For optimal performance, place your Jabra SP500 in direct line of sight with your Bluetooth mobile phone. You will get better performance when there are no obstructions (including parts of your body) between the Jabra SP500 and your mobile phone. Ensure that the microphone is pointing towards your mouth for optimal sound clarity.

**The Jabra SP500 comes with two mounting options for your vehicle.**

- A clip for attaching to the sun visor (*See fig. 3*) and suction mount for use on the windscreen. (*See fig. 4*)

**To release the clip or suction mount – just pull the clip or suction mount outwards. (*See fig. 3.3 and 4.3*)**

- ⚠ **IMPORTANT:** *Ensure that the speakerphone does not obstruct your view of the road or other road users. It is the owner's responsibility to ensure that the Jabra SP500 does not create a safety hazard and that its positioning complies with E.U., country, and/or local laws. The Jabra SP500 should also be positioned such that it does not interfere with any vehicle safety equipment, including air bags. The Jabra SP500 should be positioned securely. Please be aware that in the event of a crash, loose objects may contribute to driver injury by becoming projectiles.*

## 13 Replacing the batteries

The Jabra SP500 comes complete with two 1.2-volt (AA) rechargeable batteries. You may have to eventually replace the batteries. Please use standard rechargeable 1.2 volt (AA 2000 mAh) NiMH batteries.





1. Remove the back cover from the speakerphone and replace both batteries as indicated. Re-attach the back cover to the speakerphone. (*See fig. 5*)

## 14 Enhanced features (for Bluetooth mobile phones with hands-free profile)

**Bluetooth profiles<sup>4</sup>** are protocols through which Bluetooth devices communicate with each other. Bluetooth phones support different sets of profiles – most support both headset and hands-free profile. In order for Bluetooth devices to talk to each other they need to support the same Bluetooth profile. Jabra SP500 supports both the headset and hands-free profiles.

Although the Jabra SP500 is compatible with Bluetooth phones with either Bluetooth profile, enhanced features are available for phones that support the hands-free Bluetooth profile. Check your phone's instruction guide or contact the phone manufacturer to find out if your phone supports the hands-free Bluetooth profile.

**Enhanced features:**

- **Last number redial** (when not on a call)  
While the speakerphone is on, press and hold  until you hear **2** short beeps, release immediately.
- **Rejecting an incoming call** (when not on a call)  
When your phone rings, press and hold  until you hear **2** short beeps, release immediately.
- **Call-waiting** (swapping between 2 calls)  
When your phone notifies you of another incoming call while you're on a call, press and hold  until you hear **2** short beeps, release immediately.
- **Putting a call on hold**  
While you're on a call, press and hold  until you hear **2** short beeps, release immediately. Repeat to retrieve the call.

## 15 Frequently asked questions

1. **How far away from my mobile phone will my Jabra SP500 work?**  
The operating range is typically up to 10 metres (approx. 30 feet).
2. **Will the Jabra SP500 work with laptops, PCs, and PDAs?**  
Jabra SP500 will work with Bluetooth version 1.1 and 1.2 (or higher specifications) compatible devices which support the headset and/or hands-free profile(s).
3. **Will the Jabra SP500 interfere with my car's electronics, radio, or computer?**  
Jabra SP500 produces significantly less power than a typical mobile phone. It also only emits signals that are in compliance with the strict international Bluetooth standard. Therefore, you should not expect any interference with standard consumer electronic equipment.
4. **How do I take care of the Jabra SP500?**  
To clean the speakerphone, use a clean, soft cloth that is slightly damp.
5. **Can I use my Jabra SP500 while it is recharging?**  
The speakerphone can be used while being recharged from a wall socket or from the car charger.
6. **Can I use my Jabra SP500 for voice dialling?**  
Yes, if your phone supports voice dialling. See section 5
7. **Why is there no light flashing?**  
See section 10
8. **Can I use standard AA batteries?**  
No this is not possible. See section 2.

## 16 Storage of the Jabra SP500

1. Always store the Jabra SP500 with power off and safely protected.
2. Avoid storage at high temperatures (above 45°C / 134°F) – such as direct sunlight. (Storage at high temperatures can degrade performance and reduce battery life).
3. Do not expose the speakerphone or any of its supplied parts to rain or other liquids.

## 17 Need more help?

1. Web: [www.Jabra.com](http://www.Jabra.com) (for the latest support info and online User Manuals)
2. Phone toll free Monday to Friday

### Toll Free No:

Australia:	1-800-083-140	(10:00 – 19:00)
China:	800-858-0789	(08:00 – 17:00)
Hong Kong:	800-968-265	(08:00 – 17:00)
Indonesia:	001-803-852-7664	(08:00 – 17:00)
Japan:	0034-800-400-594	(09:00 – 18:00)
Malaysia:	1800-812-160	(08:00 – 17:00)
New Zealand:	0800-447-982	(12:00 – 21:00)
Singapore:	800-860-0019	(08:00 – 17:00)
Taiwan:	0080-186-3013	(08:00 – 17:00)

## 18 Warranty

Jabra (GN Netcom) warrants this product against all defects in material and workmanship for a period of one year from the date of original purchase. The conditions of this warranty and our responsibilities under this warranty are as follows:

- The warranty is limited to the original purchaser.
- A copy of your receipt or other proof of purchase is required. Without proof of purchase, your warranty is defined as beginning on the date of manufacture as labeled on the product.
- The warranty is void if the serial number, date code label or product label is removed, or if the product has been subject to physical abuse, improper installation, modification, or repair by unauthorized third parties.
- The responsibility of Jabra (GN Netcom) products shall be limited to the repair or replacement of the product at its sole discretion.
- Any implied warranty on Jabra (GN Netcom) products is limited to one year from the date of purchase on all parts, including any cords and connectors.
- Specifically exempt from any warranty are limited-life consumable components subject to normal wear and tear, such as microphone windscreens, ear cushions, decorative finishes, batteries, and other accessories.
- Jabra (GN Netcom) is not liable for any incidental or consequential damages arising from the use or misuse of any Jabra (GN Netcom) product.
- This warranty gives you specific rights and you may have other rights which vary from area to area.

- Unless otherwise instructed in the User Manual, the user may not, under any circumstances, attempt to perform service, adjustments or repairs on this unit, whether in or out of warranty. It must be returned to the purchase point, factory or authorized service agency for all such work.
- Jabra (GN Netcom) will not assume any responsibility for any loss or damage incurred in shipping. Any repair work on Jabra (GN Netcom) products by unauthorized third parties voids any warranty.

## 19 Certification and safety approvals

### China

Conforms to the provisions on the Radio Regulations of China.

### Republic of Korea

Certified under the provisions of Regulations on Certification of Information and Communication Equipment by Director General of Radio Research Laboratory (Ministry of Information and Communication)

### Taiwan

Approved by The Directorate General of Telecommunications (Ministry of Transportation and Communications).

### Singapore

Approved by the Infocomm Development Authority of Singapore (IDA) for sale and use in Singapore.

### FCC

This device complies with part 15 of the FCC Rules. Operation is subject to the following two conditions: (1) This device may not cause harmful interference, and (2) this device must accept any interference received, including interference that may cause undesired operation.

### CE

This product is CE marked according to the provisions of the R & TTE Directive (99/5/EC).

### Bluetooth

The Bluetooth® word mark and logos are owned by the Bluetooth SIG, Inc. and any use of such marks by Jabra is under license. Other trademarks and trade names are those of their respective owners.

## 20 Glossary

- 1 **Bluetooth** is a radio technology developed to connect devices, such as mobile phones and headsets, without wires or cords over a short distance of approximately 10 metres (approx 30 feet). More information is available at [www.bluetooth.com](http://www.bluetooth.com)
- 2 **Pairing** creates a unique and encrypted communication link between two Bluetooth enabled devices and allows them to communicate with each other. Bluetooth devices will not work if the devices have not been paired with each other.
- 3 **Passkey or PIN** is a secret code that needs to be entered on the phone in order to pair the mobile phone with the Jabra SP500. When you have already paired your mobile phone with the speakerphone, the phone and the Jabra SP500 will recognize each other and the phone will bypass the discovery and authentication process and automatically accept the transmission.
- 4 **Bluetooth profiles** are protocols through which Bluetooth devices communicate with other devices. Bluetooth phones support different sets of profiles – most support the headset profile but some support the hands-free profile and others support both profiles. In order to support a certain profile, a phone manufacturer has to implement certain mandatory features within the phone's software.
- 5 **Active mode** is when the speakerphone has an active call in progress. Jabra SP500 will go from standby mode into active mode when you receive a call or when you make a call. When the speakerphone is in active mode, the blue light will flash every second.
- 6 **Standby mode** is when the Jabra SP500 is passively waiting for a call. When you "end" the call on your mobile phone, the speakerphone will go into standby mode. When Jabra SP500 is in standby mode, the blue light will flash every three seconds for one minute.



## Free Manuals Download Website

<http://myh66.com>

<http://usermanuals.us>

<http://www.somanuals.com>

<http://www.4manuals.cc>

<http://www.manual-lib.com>

<http://www.404manual.com>

<http://www.luxmanual.com>

<http://aubethermostatmanual.com>

Golf course search by state

<http://golfingnear.com>

Email search by domain

<http://emailbydomain.com>

Auto manuals search

<http://auto.somanuals.com>

TV manuals search

<http://tv.somanuals.com>