

# JVC DVD PLAYER

**XV-N420B**  
**XV-N422S**

## INSTRUCTIONS

**AV COMPU LINK**

GNT0060-001A[US]  
0105MOC-MW-S/C

©2005 Victor Company of Japan, Limited

**Region code of DVD VIDEO**

This player can play back DVD VIDEO discs whose region code numbers include "1."  
Examples of playable DVD VIDEO discs:

ALL	1	1.5	1.2 3.4	1.2 3.4 5.6
-----	---	-----	---------	-------------

The player's region code is printed on the rear of the player.

**Note of Color system format**

This player accommodates the NTSC system, and also can play back discs recorded with PAL system. (PAL video signals are converted to an NTSC signal and output.)

**Supplied accessories**

If anything is missing, consult your dealer immediately.

- Audio/video cable (Yellow/White/Red) (x 1)
- Remote control (x 1)
- R6(SUM-3)/AA(15F) battery (x 2)

• Manufactured under license from Dolby Laboratories. "Dolby" and the double-D symbol are trademarks of Dolby Laboratories.

• "DTS" and "DTS Digital Out" are trademarks of Digital Theater Systems, Inc.

• This product incorporates copyright protection technology that is protected by U.S. patents and other intellectual property rights. Use of this copyright protection technology must be authorized by Macrovision, and is intended for home and other limited viewing uses only unless otherwise authorized by Macrovision. Reverse engineering or disassembly is prohibited.

**For customer use**

Enter below the Model No. and Serial No. which are located either on the rear, bottom or side of the cabinet. Retain this information for future reference.

Model No. \_\_\_\_\_

Serial No.: \_\_\_\_\_

### Warnings, Cautions and Others

**CAUTION**  
RISK OF ELECTRIC SHOCK  
DO NOT OPEN

---

CAUTION:  
TO REDUCE THE RISK OF ELECTRIC SHOCK,  
DO NOT REMOVE COVER (OR BACK).  
NO USER SERVICEABLE PARTS INSIDE.  
REFER SERVICING TO QUALIFIED SERVICE PERSONNEL.

⚡

⚠

The lightning flash with arrowhead symbol, within an equilateral triangle is intended to alert the user to the presence of uninsulated "dangerous voltage" within the products enclosure that may be of sufficient magnitude to constitute a risk of electric shock to persons.

The exclamation point within an equilateral triangle is intended to alert the user to the presence of important operating and maintenance (servicing) instructions in the literature accompanying the appliance.

**WARNING: TO REDUCE THE RISK OF FIRE OR ELECTRIC SHOCK, DO NOT EXPOSE THIS APPLIANCE TO RAIN OR MOISTURE.**

**For U.S.A.**

This equipment has been tested and found to comply with the limits for a Class B digital device, pursuant to part 15 of the FCC Rules.

These limits are designed to provide reasonable protection against harmful interference in a residential installation. This equipment generates, uses and can radiate radio frequency energy and, if not installed and used in accordance with the instructions, may cause harmful interference to radio communications. However, there is no guarantee that interference will not occur in a particular installation. If this equipment does cause harmful interference to radio or television reception, which can be determined by turning the equipment off and on, the user is encouraged to try to correct the interference by one or more of the following measures:

- Reorient or relocate the receiving antenna.
- Increase the separation between the equipment and receiver. Connect the equipment into an outlet on a circuit different from that to which the receiver is connected.
- Consult the dealer or an experienced radio/TV technician for help.

**For Canada**

**CAUTION: TO PREVENT ELECTRIC SHOCK, MATCH WIDE BLADE OF PLUG TO WIDE SLOT, FULLY INSERT**

**For Canada**

THIS DIGITAL APPARATUS DOES NOT EXCEED THE CLASS B LIMITS FOR RADIO NOISE EMISSIONS FORM DIGITAL APPARATUS AS SET OUT IN THE INTERFERENCE-CAUSING EQUIPMENT STANDARD ENTITLED "DIGITAL APPARATUS," ICES-003 OF THE DEPARTMENT OF COMMUNICATIONS.

**CAUTION**

To reduce the risk of electrical shocks, fire, etc.:

1. Do not remove screws, covers or cabinet.
2. Do not expose this appliance to rain or moisture.

**Caution** — **STANDBY/ON button!**

Disconnect the mains plug to shut the power off completely. The **STANDBY/ON** button in any position does not disconnect the mains line. The power can be remote controlled.

**CAUTION**

THIS PRODUCT USES A LASER SYSTEM. USE OF CONTROLS OR ADJUSTMENTS OR PERFORMANCE OF PROCEDURES OTHER THAN THOSE SPECIFIED HEREIN MAY RESULT IN HAZARDOUS RADIATION EXPOSURE.  
DO NOT OPEN COVERS AND DO NOT REPAIR YOURSELF. REFER SERVICING TO QUALIFIED PERSONNEL.

CLASS 1 LASER PRODUCT  
REPRODUCTION OF LABELS  
WARNING LABEL INSIDE OF THE UNIT

**Playable discs**

- DVD VIDEO, Audio CD, Video CD, SVCD
- DVD-R/RW written in the DVD VIDEO format
- CD-R/RW written in the SVCD, Video CD or Audio CD format
- CD-R/RW written in MP3/WMA/JPEG in accordance with the "ISO 9660" format

**Supported Digital audio formats:**

Linear PCM, Dolby Digital, DTS (Digital Theater Systems)

**NOTES**

- If a disc gets dirty, scratched or warped, or due to the disc characteristics or recording conditions, the player may not be able to play back such discs.
- The player can play back audio signals recorded in MIX-MODE CD, CD-G, CD-EXTRA and CD TEXT.
- With some discs, operations may not be possible.
- \* To play back DTS-encoded DVD VIDEO or DTS-encoded Audio CD discs correctly, connect the player to an amplifier with a built-in DTS decoder. Otherwise, playback sound will be distorted.

**Unplayable discs**

If you try to play back discs listed below, noise may be generated and causes damage to speakers.

- DVD-RW written in the VR format
- DVD-ROM, DVD-RAM, DVD AUDIO, CD-ROM, PHOTO CD, SACD
- Unfinalized discs
- Discs of irregular shape or discs with tape, seals or paste on either the label side or playback side. Playing back these discs may damage the player.

**The Non-DVD side of a "DualDisc" does not comply with the "Compact Disc Digital Audio" standard. Therefore, the use of Non-DVD side of a DualDisc on this product may not be recommended.**

**Notes on installation**

- Select a place which is level, dry and neither too hot nor too cold between 5°C and 35°C (41°F and 95°F).
- Leave sufficient distance between the player and the TV.
- Do not install the player in a place subject to vibrations.
- Do not put heavy objects on the player.

**To prevent malfunction of the player**

- There are no user-serviceable parts inside. If anything goes wrong, unplug the power cord and consult your dealer.
- Do not insert any metallic objects, such as wires, hairpins, coins, etc. into the player.
- Do not block the vents. Blocking the vents may damage the player.

**To clean the cabinet**

- Use a soft cloth. Follow the relevant instructions on the use of chemically-coated cloths.
- Do not use benzene, thinner or other organic solvents and disinfectants. These may cause deformation or discoloring.

### Connections

**Before making connections:**

- Do not connect the AC power cord until all other connections have been made.
- Connect VIDEO OUT of the player directly to the video input of your TV. Connecting VIDEO OUT of the player to a TV via a VCR/an integrated TV/Video system may cause a monitor problem.

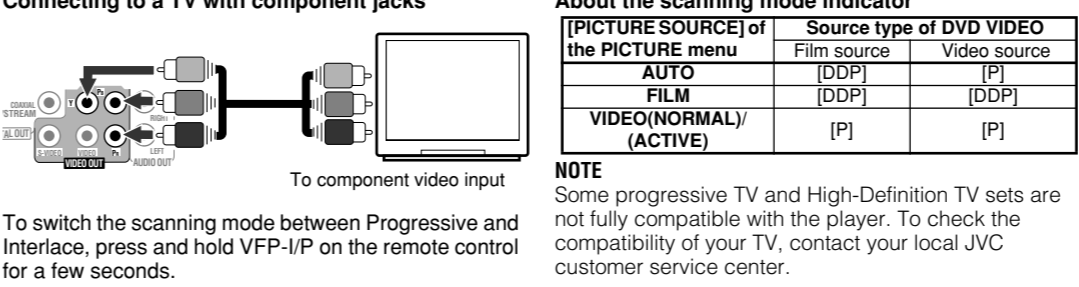
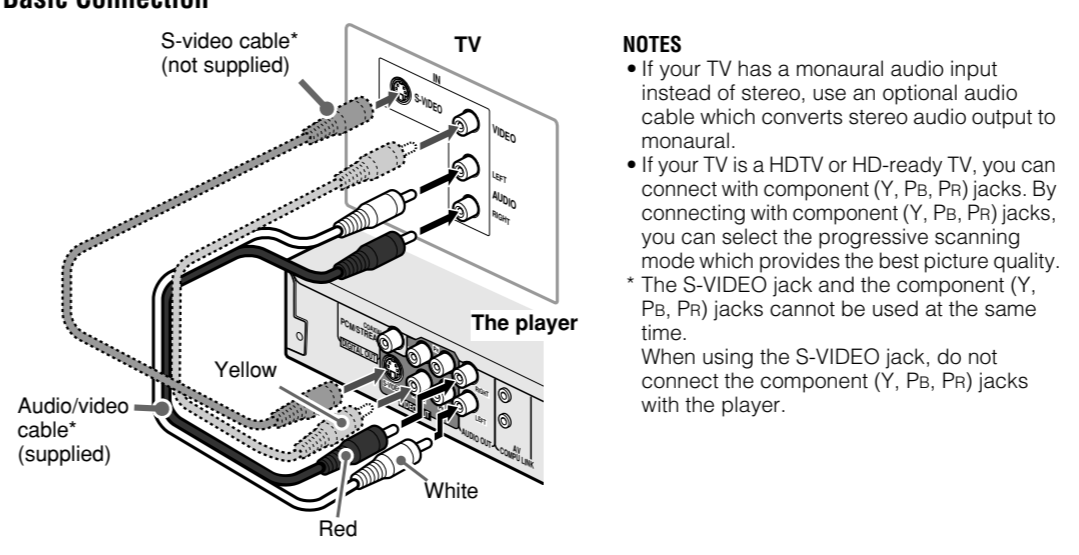

**Notes**

- Connect "Y" to "Y," "Pb" to "Pb(Cb)," "Pr" to "Pr(Cr)" correctly.
- When using component (Y, Pb, Pr) jacks, do not connect S-VIDEO jack with the player.

**About the scanning mode indicator**

[PICTURE SOURCE] of the PICTURE menu	Source type of DVD VIDEO	Film source	Video source
AUTO	[DP]	[P]	[P]
FILM	[DDP]	[DDP]	[DDP]
VIDEO(NORMAL)/(ACTIVE)	[P]	[P]	[P]

**NOTE**

Some progressive TV and High-Definition TV sets are not fully compatible with the player. To check the compatibility of your TV, contact your local JVC customer service center.

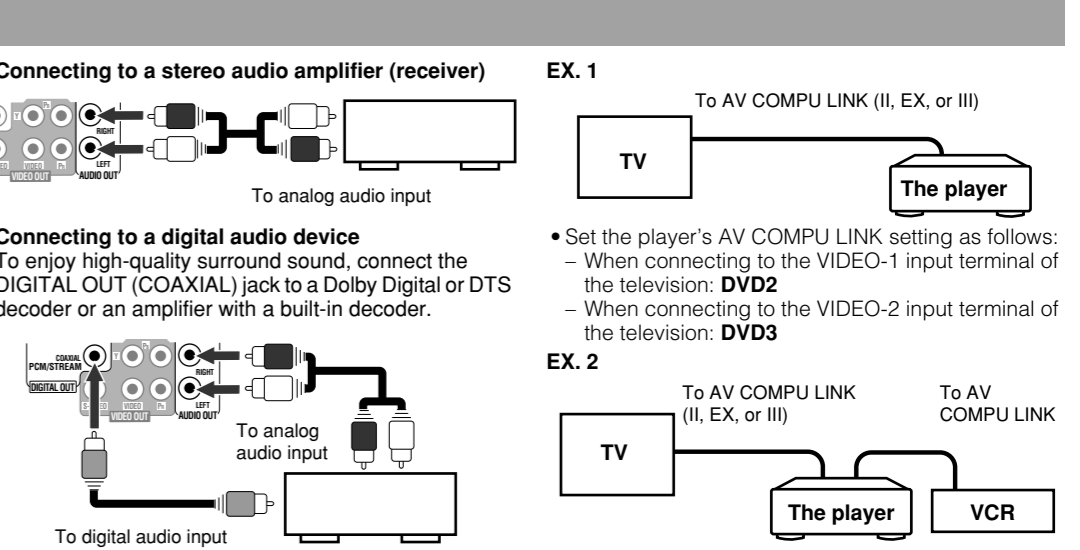

**Notes**

- If your TV has a monaural audio input instead of stereo, use an optional audio cable which converts stereo audio output to monaural.
- If your TV is a HDTV or HD-ready TV, you can connect with component (Y, Pb, Pr) jacks. By connecting with component (Y, Pb, Pr) jacks, you can select the progressive scanning mode which provides the best picture quality.
- \* The S-VIDEO jack and the component (Y, Pb, Pr) jacks cannot be used at the same time. When using the S-VIDEO jack, do not connect the component (Y, Pb, Pr) jacks with the player.

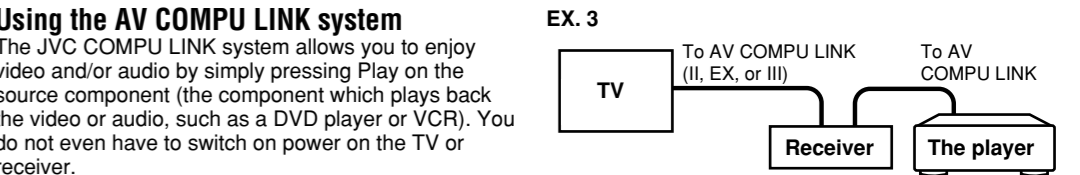

**Notes for connection**

- If you connect the player to a receiver via AV COMPU LINK in a system including a Dolby Digital decoder, some functions may not be performed automatically.
- Connect the AUDIO OUT jacks of the player to the audio input jacks of a receiver indicating "DVD."
- Otherwise, the system will not work correctly.

**Operation**

1. Turn on the main power of the television.
2. Insert a disc (or tape) into the source component.
3. Press **▶** of the source component.

The following actions are performed automatically:

- Turning on the television and/or receiver.
- Setting the source of the television to the external input (VIDEO-1 or VIDEO-2).
- Setting the source of the receiver to the component which has started playback.

### Turning on the power

**Inserting the AC power plug**

After all other connections have been made, insert the AC power plug to the wall outlet firmly.

**Installing the batteries in the remote control**

Open the compartment cover, and place the two supplied R6(SUM-3)/AA(15F) batteries in the remote control according to the polarity markings ("+" and "-") inside the compartment. Then replace the cover.

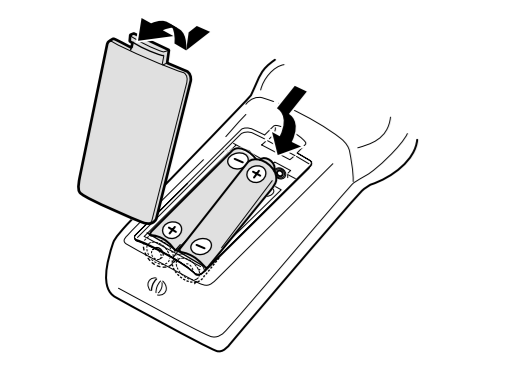

The batteries will last about six months with normal use. If the functions of the remote control become erratic, replace the batteries.

**Precautions of the safe use of batteries**

Observe the following precautions for the safe use of batteries. If they are used improperly their lives will be shortened, they may burst or their contents may leak.

- Remove the batteries from the remote control if it is not going to be used for a long period of time.
- Remove dead batteries and dispose of them properly.
- Never leave dead batteries lying around, take them apart, mix them with other refuse, or throw them into an incinerator.
- Never touch liquid that has leaked out of a battery.
- Do not mix new and old batteries, or batteries of different types, when placing them.

**Turning on and off the player**

Press **STANDBY/ON**.

### Initial setup

When you turn on the player for the first time after purchase, the following message appears on the TV screen.

EXECUTE DVD PLAYER SETUP?- BASIC PICTURE/AUDIO SETTING  
YES - PRESS ENTER NO - PRESS CANCEL

Before enjoying this player, make the initial settings as follows:

1 Press **ENTER**.

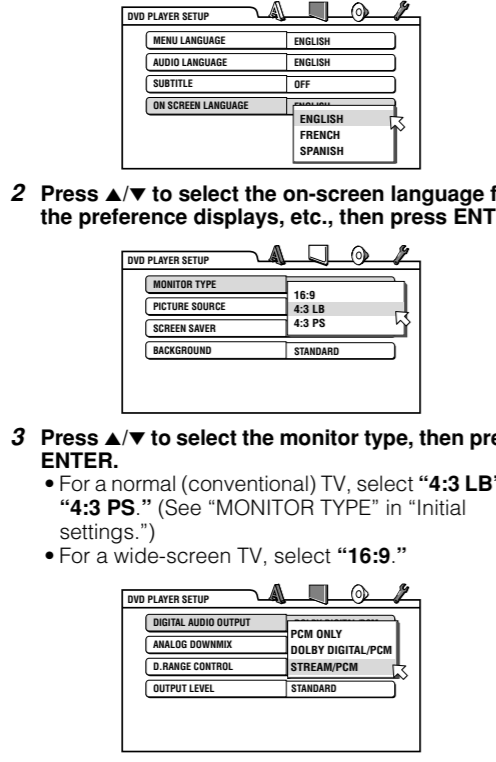

4 Press **▲/▼** to select a desired digital output signal type, then press **ENTER**.

Set this item correctly according to the logo on your receiver or decoder. (If you do not connect the player to such a device, press ENTER to finish the setting.)

- Receiver/decoder bearing Dolby Digital logo and no DTS, select "DOLBY DIGITAL/PCM."
- Receiver/decoder bearing both Dolby Digital and DTS logos, select "STREAM/PCM."
- Receiver/decoder bearing neither Dolby Digital nor DTS logo, or digital recorder, select "PCM ONLY."

**To bring up the DVD PLAYER SETUP display later**

Press SET UP for a few seconds until the DVD PLAYER SETUP display appears.

### Basic Operations

**Turning on and off the player**

**Insert a disc**

- 1 Press **▲** to open the disc tray.
- 2 Place a disc in the disc tray.
- 3 Press **▲** to close the disc tray.

With the label side up

Point toward the remote sensor directly as possible (the operating range is approx. 5 m.)

**Basic playback**

Buttons	To do
<b>▶</b>	Start/resume normal Playback
<b>■</b>	Stop • When RESUME MODE is ON or DISC RESUME, this player memorizes the position on the disc where you interrupted playback. – To resume playback, press <b>▶</b> . – To stop playback completely, press <b>■</b> again.
<b>⏸</b>	Pause • Each time you press <b>⏸</b> on the remote control, the still picture advances to the next frame.
<b>⏩/⏪</b>	Fast forward/backward (While paused) Slow-motion playback • Each time you press the button, the playback speed changes.
<b>⏭/⏮</b>	Skip chapter/track • If you press and hold the button during playback, playback is advance/reversed at 5 times normal speed.

**About On-screen guide icons**

**▶**: Playback.  
**⏸**: Pause.  
**⏩/⏪**: Slow-motion playback with the current speed.  
**⏭/⏮**: Fast forward/backward playback with the current speed.

- : At the beginning of a scene containing multi-angle views.
- : At the beginning of a scene containing multi-audio sounds.
- : At the beginning of a scene containing multi-subtitles.

You can change the setting so that the on-screen guide icons do not appear on the TV screen. (See "ON SCREEN GUIDE" in "Initial settings.")

**Changing the display brightness**

Press **DIMMER** to change the brightness of the display window.

### Turning on and off the player

**Open/close the disc tray**

**Changing the display window contents**

Each time you press **DISPLAY**, the display window contents changes.

**Locating the beginning of a scene or song**

You can select a title/chapter/track directly and start playback. For DVD Video: (While playing back) select chapter. For SVCD/VCD/CD: Select track.

To select 5: press 5.  
To select 23: press 2, then 3.  
To select 40: press 4, then 0.

• If you press TITLE/GROUP before entering the number, you can select the title instead of the chapter.

**Using the disc menu**

You can operate a disc—SVCD/VCD with Playback Control (PBC)—using the disc menu shown on the TV screen.  
\* A method of controlling disc play for SVCD/VCD by using the disc menu.

**For DVD**

- 1 Press **TOP MENU** or **MENU** to show the disc menu.
- 2 Press **▲/▼/◀/▶** to select a desired item, then press **ENTER** or **▶** (SELECT).

• With some discs, you can also select items by entering the number using the numeric buttons.

**For SVCD/VCD**

- 1 While stopped, press **TOP MENU** or **▶** (SELECT) to show the menu.
- 2 Press the numeric buttons to select a desired item.  
To select 5: press 5.  
To select 23: press 2, then 3.  
To select 40: press 4, then 0.

• To move to the next or previous page of the current menu, press **▶|** or **◀|**.

• To return to the previous menu, press **RETURN**.

**To play back without PBC**

While stopped, press the numeric buttons instead of **▶** (SELECT) to start playback.

**To reactivate PBC**

- Press **TOP MENU** or **MENU**.
- Press **■** to stop playback, then **▶** (SELECT).

### Advanced Operations

**Changing the language, sound and scene angle**

- 1 Press the button.
- 2 Press the button repeatedly or **▲/▼** to select the desired item.
- 3 Press **ENTER** to finish the setting.

Buttons	To do
AUDIO	For DVD Video: select audio languages. For SVCD/VCD: select the audio channel.
SUBTITLE	select the subtitle.
ANGLE	select the view-angle.

**Changing the Sound Field**

Each time you press **SOUND EFFECT**, the Sound Effect mode changes.

- As the value becomes bigger, the Sound Effect works stronger.

**Changing the picture tone (VFP)**

The VFP (Video Fine Processor) function allows you to adjust the picture character according to the type of programming, picture tone or personal preferences.

- 1 Press **VFP-I/P**.
- 2 Press **▶|◀|** to select the desired preset.

	Parameter
USER 1	Selected Preset
GAMMA	MID
BRIGHTNESS	+4
CONTRAST	-10
SATURATION	-10
TINT	+10
SHARPNESS	LOW
Y DELAY	+2
NORMAL	For watching TV in a general room.
CINEMA	For watching a movie software in a room with suppressed light.
USER1	You can adjust parameters that affect the picture character and store the settings as a user preset. See below.
USER2	

**To adjust the picture tone**

- 1 Select "USER1" or "USER2."
- 2 Press **▲/▼** to select a parameter, then press **ENTER**.

	Parameter
GAMMA	Adjust this if the neutral color is bright or dark. The brightness of dark and bright portion is maintained (LOW/MID/HIGH).
BRIGHTNESS	Adjust this if the picture is bright or dark on the whole (-16 (darkest) to +16 (brightest)).
CONTRAST	Adjust this if the far and near position is unnatural (-12 to +12).
SATURATION	Adjust this if the picture is whitish or blackish (-16 (blackest) to +16 (whitest)).
TINT	Adjust this if the appearance of flesh tone is unnatural (-16 to +16).
SHARPNESS	Adjust this if the picture is indistinct (LOW/HIGH).
Y DELAY	Adjust this if the picture looks separately/ overlapped (-2 to +2).

- 3 Press **▲/▼** to adjust the parameter, then press **ENTER**.
- 4 Repeat step 2 and 3 to adjust other parameters.
- 5 Press **VFP-I/P** to finish the setting.



## Free Manuals Download Website

<http://myh66.com>

<http://usermanuals.us>

<http://www.somanuals.com>

<http://www.4manuals.cc>

<http://www.manual-lib.com>

<http://www.404manual.com>

<http://www.luxmanual.com>

<http://aubethermostatmanual.com>

Golf course search by state

<http://golfingnear.com>

Email search by domain

<http://emailbydomain.com>

Auto manuals search

<http://auto.somanuals.com>

TV manuals search

<http://tv.somanuals.com>