

JVC



AV INTEGRATED AMPLIFIER

AV-INTEGRIERTER VERSTÄRKER
AMPLIFICATEUR INTEGRE AV
GEINTEGREERDE A/V- VERSTERKER
AMPLIFICADOR INTEGRADO DE AV
AMPLIFICATORE INTEGRATO A/V

AX-V55BK

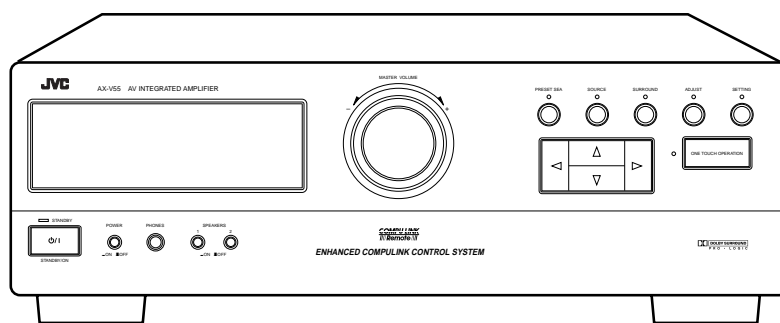

COMPU LINK
Remote

INSTRUCTIONS

*BEDIENUNGSANLEITUNG
MANUEL D'INSTRUCTIONS
GEBRUIKSAANWIJZING
MANUAL DE INSTRUCCIONES
ISTRUZIONI*

For Customer Use:

Enter below the Model No. and Serial No. which are located either on the rear, bottom or side of the cabinet. Retain this information for future reference.

Model No. _____

Serial No. _____

LVT0236-001A

[E]

Table of Contents

Switches, Buttons and Controls	2
Getting Started.....	3
Before Installation	3
Checking the Supplied Accessories	3
Connecting the Speakers	4
Connecting Audio/Video Components	6
Connecting Audio Components for the COMPU LINK-3 Remote Control System	7
Connecting the Power Cord	8
Putting Batteries in the Remote Control	8
Basic Operations	9
Turning the Power On and Off (Standby)	9
Selecting the Source to Play	9
Selecting the Front Speakers	10
Adjusting the Volume	10
Muting the Sound	10
Recording a Source	11
Listening with Headphones	11
Basic Settings	12
Adjusting the Front Speaker Output Balance	12
Listening at Low Volume (Loudness)	12
Using the Sleep Timer	12
Selecting the Center Speaker Size	13
One Touch Operation.....	14
About the One Touch Operation	14
Using the One Touch Operation	14
Using the Preset SEA Modes	15
Selecting Your Favorite SEA Mode	15
Using the Surround Processor	17
Using JVC's Hall Surround	17
Speaker Arrangements for Dolby Surround	19
Preparing for Dolby Surround	20
Using Dolby Surround	23
COMPU LINK Remote Control System	24
Using the Remote Control.....	25
Troubleshooting	27
Specifications	28

Become familiar with the buttons and controls on the amplifier before use.

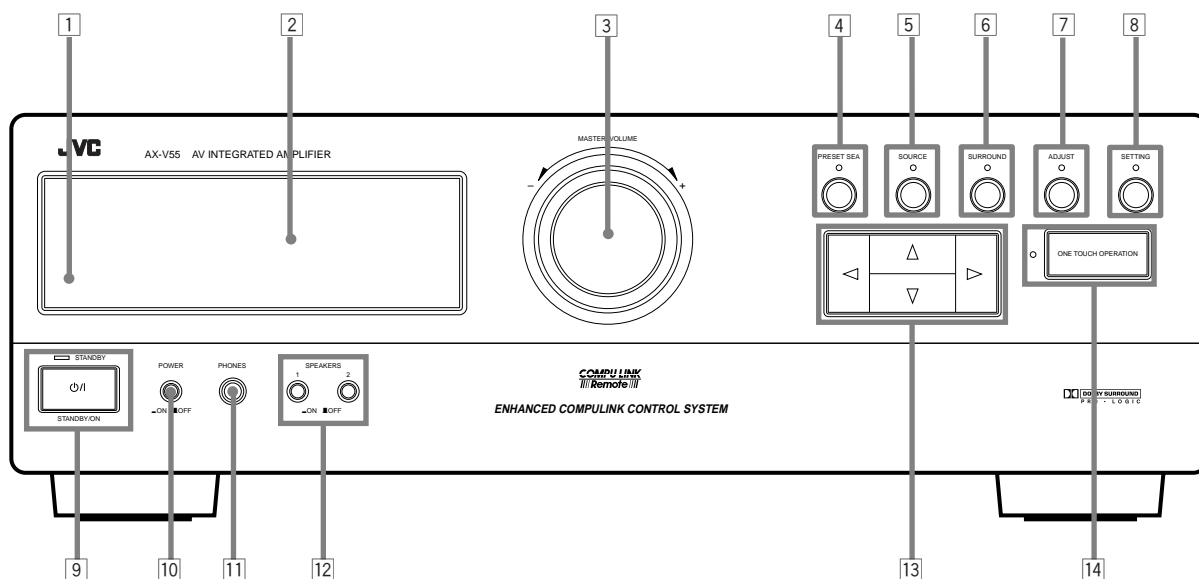

Refer to the pages in parentheses for details.

Front Panel

- 1 Remote sensor
- 2 Display (9)
- 3 MASTER VOLUME control (10)
- 4 PRESET SEA button and lamp (15)
- 5 SOURCE button and lamp (9)
- 6 SURROUND button and lamp (17, 20, 23)
- 7 ADJUST button and lamp (18, 20)
- 8 SETTING button and lamp (12)
- 9 STANDBY/ON \odot/I button and STANDBY lamp (9)
- 10 POWER switch (8)
- 11 PHONES jack (11)
- 12 SPEAKERS 1/2 buttons (10)
- 13 Control $\Delta / \nabla / \triangleleft / \triangleright$ buttons
- 14 ONE TOUCH OPERATION button and lamp (14)

Remote Control

- 15 TV/VIDEO button (26)
- 16 CH (+/-) buttons (26)
- 17 CD-DISC button (25)
- 18 AUDIO CONTROL button (16, 18, 22, 23)
- 19 Source buttons (CD, TAPE, TUNER, VCR, VIDEO, PHONO) (9, 25, 26)
- 20 VOLUME (+/-) buttons (10)
- 21 \odot/I (Standby/On) buttons (TV, VCR, AUDIO) (9, 26)
- 22 10 keys/Audio control buttons (16, 18, 22, 23, 25)
- 23 SEA ON/OFF button (16)
- 24 SURROUND ON/OFF button (18, 22, 23)
- 25 TV CONTROL buttons (TV, VOLUME (+/-)) (26)
- 26 ONE TOUCH OPERATION button (14)
- 27 Operating buttons for JVC audio/video components (25, 26)
- 28 MUTE button (10)

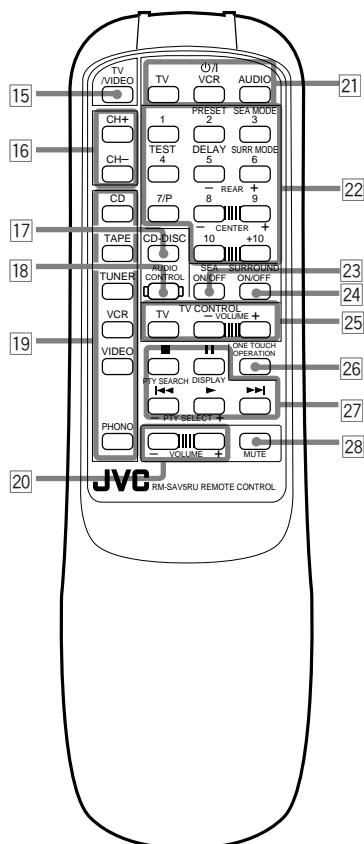

Getting Started

This section explains how to connect stereo components and speakers to the amplifier, and how to connect the power supply.

Before Installation

General

- Be sure your hands are dry.
- Turn the power off to all components.
- Read the manuals supplied with the components you are going to connect.

Locations

- Install the amplifier in a location that is level and protected from moisture.
- The temperature around the amplifier must be between -5° and 35° C (23° and 95° F).
- Make sure there is good ventilation around the amplifier. Poor ventilation could cause overheating and damage the amplifier.

Handling the amplifier

- Do not insert any metal object into the amplifier.
 - Do not disassemble the amplifier or remove screws, covers, or cabinet.
 - Do not expose the amplifier to rain or moisture.
-

Checking the Supplied Accessories

Check to be sure you have all of the following items, which are supplied with the amplifier. The number in the parentheses indicates quantity of the pieces supplied.

- Remote Control (1)
- Batteries (2)

If anything is missing, contact your dealer immediately.

Connecting the Speakers

You can connect the following speakers:

- Two sets of front speakers to produce normal stereo sound
- One set of rear speakers to enjoy the surround effect
- One center speaker to produce more effective surround effect (to make human voices outstanding)
- One subwoofer to enhance the bass

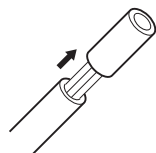

For each speaker (except for subwoofer), connect one end of the speaker signal cable (not supplied) to the speaker terminal on the rear panel and the other end to the speaker. (For connecting a subwoofer, see page 6).

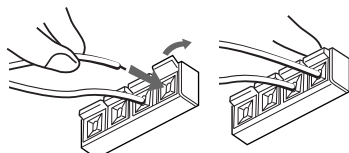

1. **Open each terminal.**
2. **Insert the end of the speaker signal cable as shown (be sure to remove the insulation at the end of each wire first).**
3. **Close the terminals to clamp the speaker signal cables firmly in place.**
4. **Connect the black (–) and red (+) terminals on the rear panel to the black (–) and red (+) terminals marked on the speakers.**

CAUTION:

When connecting speakers, use speakers with the same SPEAKER IMPEDANCE indicated by the speaker terminals.

Connecting the front speakers

Connect the front speakers to the FRONT SPEAKERS terminals.

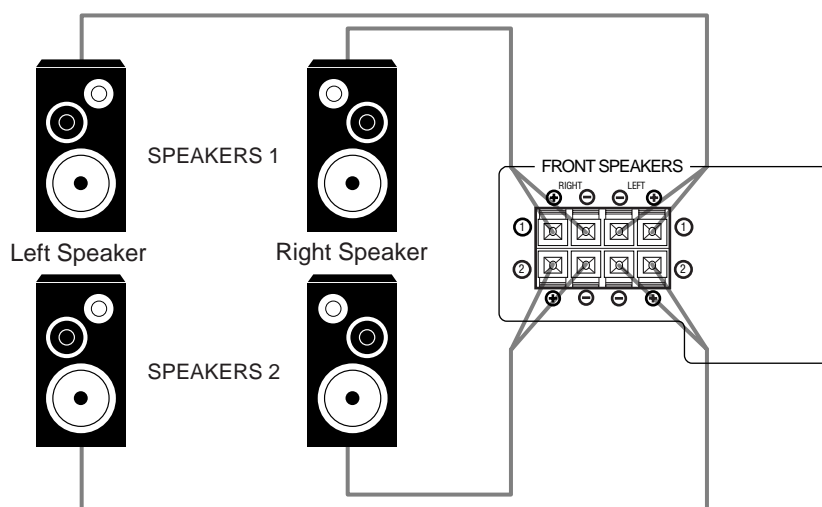

Connecting the rear and center speakers

Connect rear speakers to the REAR SPEAKERS terminals and a center speaker to the CENTER SPEAKER terminals.

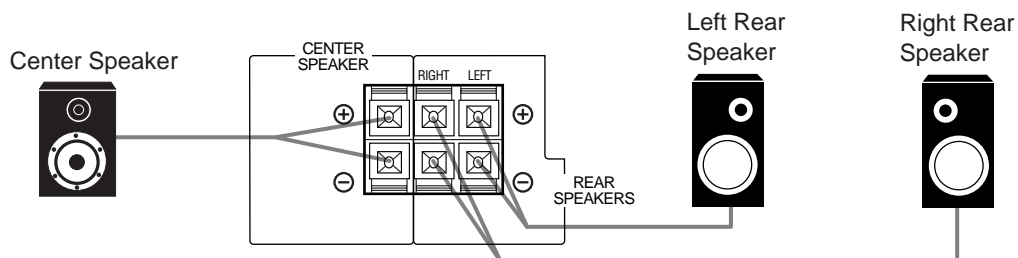

Note:

When you connect rear speakers, make sure that both left and right speakers are connected; otherwise, no sound will come out of the rear speakers.

About the speaker impedance of the speakers

CAUTION:
When connecting speakers, use speakers with the same **SPEAKER IMPEDANCE** indicated by the speaker terminals.

Notes:

- The required speaker impedance of the front speakers does not differ depending on whether both the **FRONT SPEAKERS ①** and **FRONT SPEAKERS ②** terminals are used or only one of them is used.
- The required speaker impedance of the front speakers differs depending on whether or not a center and/or rear speakers are connected at the same time. Since there are four possible speaker connections with the amplifier, check which one fits your case and use the speaker with the impedance described below.

CASE 1 When you connect only front speakers

Use front speakers with **4 — 16 ohm** impedance.

CASE 2 When you connect front speakers and a center speaker

Use the following speakers;

- Front speakers: **8 — 16 ohm** impedance
- Center speaker: **8 — 16 ohm** impedance

CASE 3 When you connect front and rear speakers

Use the following speakers;

- Front speakers: **8 — 16 ohm** impedance
- Rear speakers: **8 — 16 ohm** impedance

CASE 4 When you connect front and rear speakers as well as a center speaker

Use the following speakers;

- Front speakers: **8 — 16 ohm** impedance
- Rear speakers: **8 — 16 ohm** impedance
- Center speaker: **8 — 16 ohm** impedance

Connecting the subwoofer speaker

Connect the input jack of a powered subwoofer to the SUBWOOFER OUT jack on the rear panel, using a cable with RCA pin plugs.

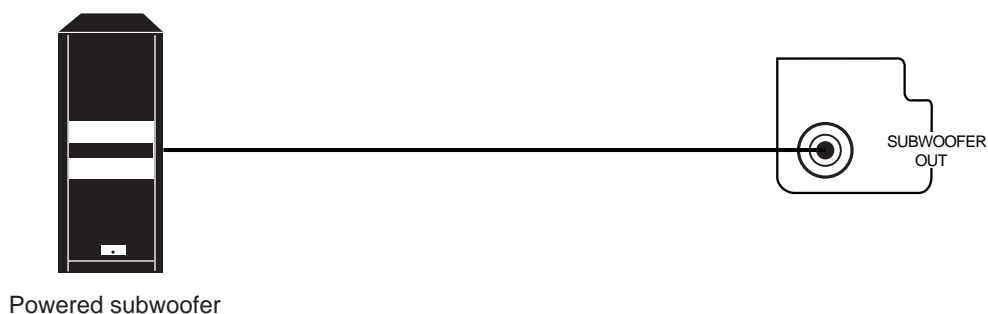

Connecting Audio/Video Components

You can connect the following components to the amplifier using cables with RCA pin plugs.

Audio Components	Video Components
• Turntable	• VCR
• CD player	• Video disc player
• Cassette deck	• TV
• Tuner	_____

Note:

Any turntables incorporating a small-output cartridge such as an MC (moving-coil type) must be connected to the amplifier through a commercial head amplifier or step-up transformer. Direct connection may result in insufficient volume.

Audio component connections

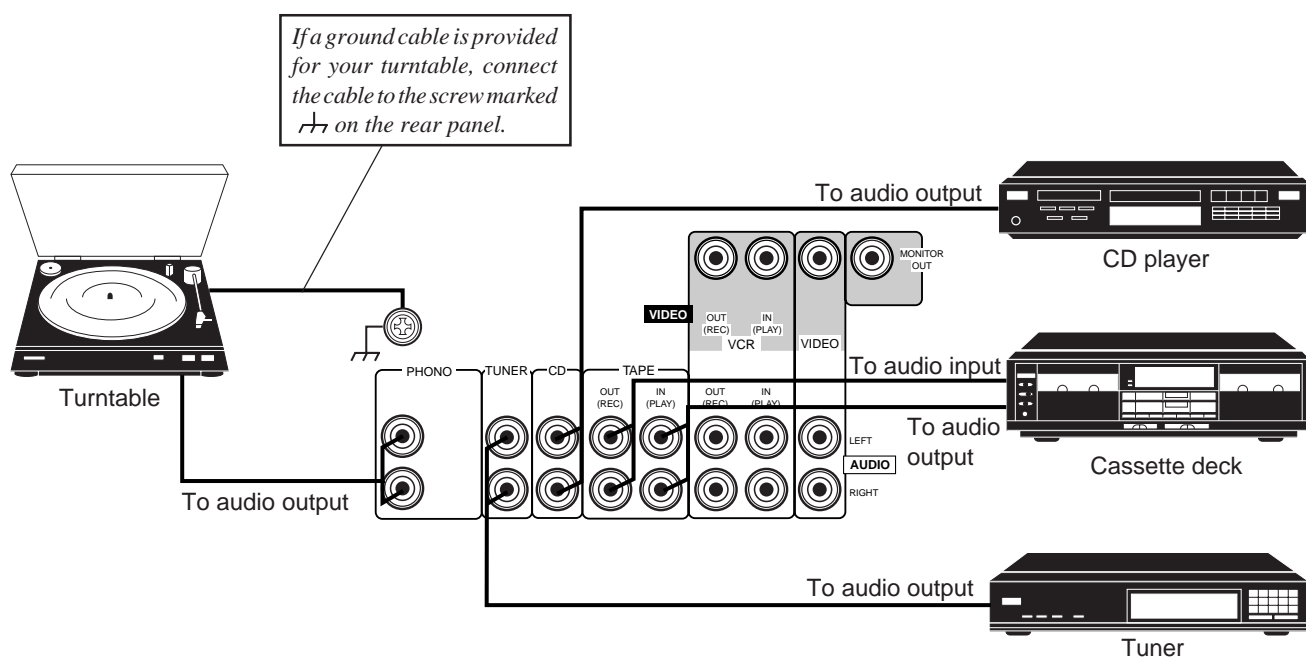

Video component connections

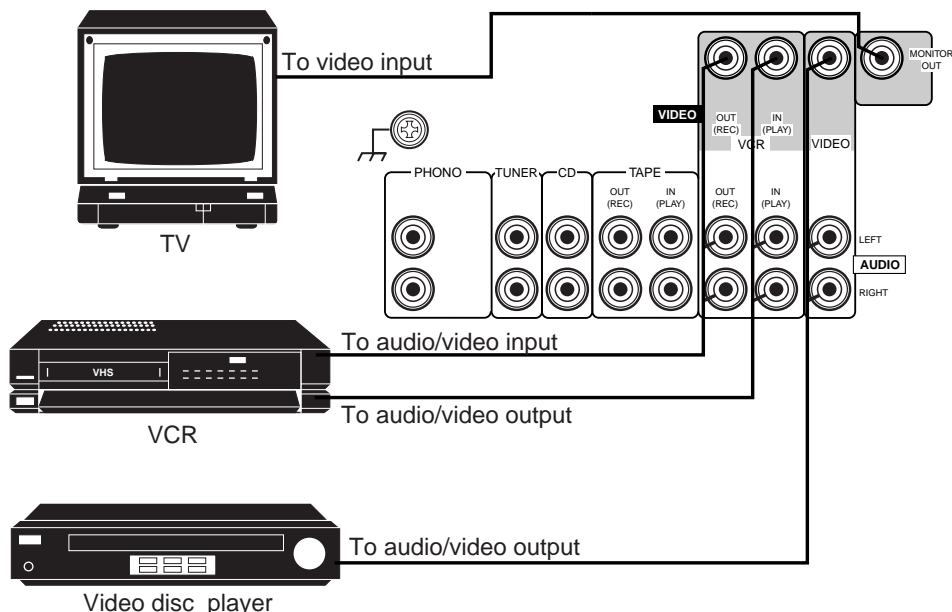

CAUTION:
 If you connect a sound-increasing device such as a graphic equalizer between the source components and the amplifier, the sound output through the amplifier may be distorted.

Connecting Audio Components for the COMPU LINK-3 Remote Control System

The COMPU LINK-3 remote control system allows you to control other JVC audio components from the amplifier or vice versa. To use this system, connect your JVC audio components and the amplifier with the cable (monaural mini-plug) supplied with those components.

If your audio component has two COMPU LINK-3 SYNCHRO jacks, you can use either one. If it has only one COMPU LINK-3 SYNCHRO jack, connect it so that it is the last item in the series of components. (for example, the turntable and the tuner in the diagram below)

Notes:

- The COMPU LINK-3 remote control system is the upgraded version of the COMPU LINK-1 and COMPU LINK-2. Even if your component has the COMPU LINK-1 or COMPU LINK-2 jacks, you can still connect it in the COMPU LINK-3 remote control system, but some functions may not work correctly.
- For more information about the COMPU LINK-3 (-1 and -2) remote control system, see page 24.

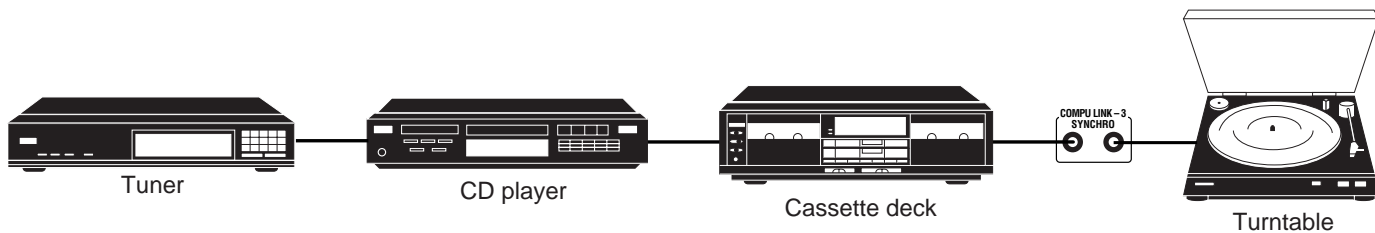

Connecting the Power Cord

Before plugging the amplifier into an AC outlet, make sure that all connections have been made.

1. Plug the power cord into an AC outlet.

2. Press POWER to set it in the **ON** position.

The STANDBY lamp lights up. A small amount of power is always consumed.



To shut off the power completely:

Press POWER to set it in the **OFF** position.

Keep the power cord away from the connecting cables for the TV, VCR, and antenna. The power cord may cause noise or screen interference.

The difference between the POWER switch and the STANDBY/ON button

- The POWER switch is the mains supply switch, allowing the amplifier to connect to the mains supply. To shut off the power completely, press the POWER switch to set it in the **OFF** position.
- The STANDBY/ON  button is a functional on/off (standby) switch, and does not disconnect the amplifier from the mains supply. A small amount of power is consumed even in standby mode for the amplifier to accept signals from the remote control.

Notes:

The preset settings such as sound adjustment may be erased in the following cases:

- When you press POWER to set it in the **OFF** position.
- When you unplug the power cord.
- When a power failure occurs.

CAUTIONS:

- Do not touch the power cord with wet hands.
- Do not pull on the power cord to unplug the amplifier. When unplugging the amplifier, always grasp the plug itself so as not to damage the cord.

Putting Batteries in the Remote Control

Before using the remote control, put the two supplied batteries in first. When using the remote control, aim the remote control directly at the remote sensor on the amplifier.

1. On the back of the remote control, press down on the battery cover and slide it out.

2. Insert batteries. Make sure to observe the proper polarity: (+) to (+) and (-) to (-).

3. Slide the cover.

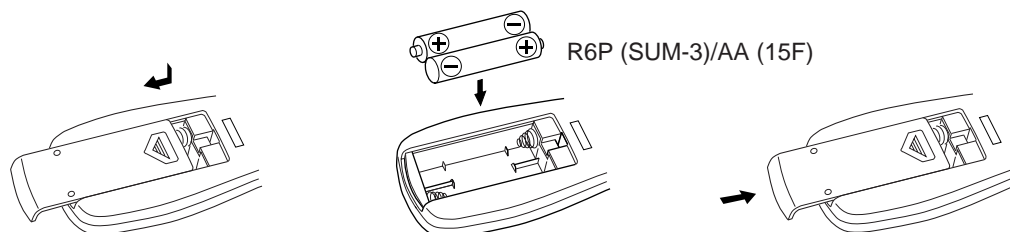

If the range or effectiveness of the remote control decreases, replace the batteries. Use two R6P (SUM-3)/AA (15F) type dry-cell batteries.

CAUTIONS:

Follow these precautions to avoid leaking or cracking cells:

- Place batteries in the remote control so they match the polarity indicated: (+) to (+) and (-) to (-).
- Use the correct type of batteries. Batteries that look similar may differ in voltage.
- Always replace both batteries at the same time.
- Do not expose batteries to heat or flame.

Basic Operations

The following operations are commonly used when you play any sound source.

Turning the Power On and Off (Standby)

On the front panel:

To turn on the power, press STANDBY/ON \odot/\mid .

The STANDBY lamp goes off. The name of the current source appears on the display.

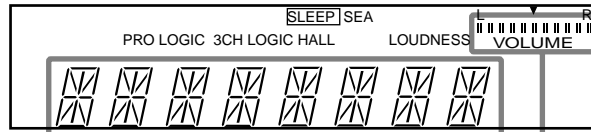
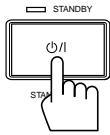

Current source name appears Current volume level is shown here

To turn off the power (into standby mode), press STANDBY/ON \odot/\mid again.

The STANDBY lamp lights up.

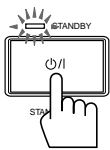

From the remote control:

To turn on the power, press AUDIO.

The STANDBY lamp goes off. The name of the current source appears on the display.

To turn off the power (into standby mode), press AUDIO again.

The STANDBY lamp lights up.



Note:

Pressing STANDBY/ON \odot/\mid again turns off the power (into standby mode) and lights the STANDBY lamp. A small amount of power is consumed in standby mode. To turn the power off completely, press POWER to set it in the OFF position on the front panel.

Selecting the Source to Play

On the front panel:

1. Press SOURCE so that Control Δ/∇ buttons work for selecting the source.

The lamp above the button lights up.

2. Press Control Δ/∇ until the source name you want appears on the display.

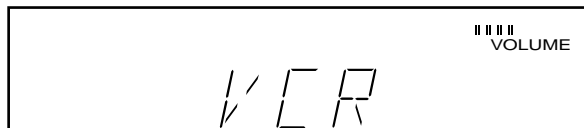
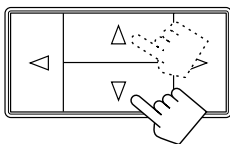

From the remote control:

Press one of the source button directly.

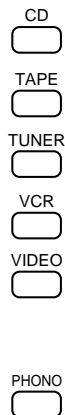

- CD* Listen to the CD player.
- TAPE* Listen to the cassette deck connected to the TAPE jacks.
- TUNER* Listen to the radio.
- VCR View the video component connected to the VCR jacks.
- VIDEO View the video component connected to the VIDEO jacks.
- PHONO* Listen to a record.

Note:

* When you press one of the source buttons on the remote control marked above with an asterisk, the amplifier automatically turns on.

Selecting different sources for picture and sound

You can watch picture from video equipment while listening to sound from audio equipment.
To listen to the sound from audio equipment while watching the picture from video equipment:

1. **Select the video equipment as the source (VIDEO or VCR).**
2. **Press one of the source buttons for the audio equipment (TUNER, TAPE, PHONO or CD) on the remote control.**

Selecting the Front Speakers

When you have connected two sets of front speakers, you can select which to use. Pressing SPEAKERS 1 or SPEAKERS 2 activates the respective set of speakers.

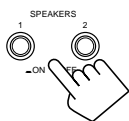

To use the set of speakers connected to the FRONT SPEAKERS ① terminals, press SPEAKERS 1 to set it in the **ON** position, and press SPEAKERS 2 to set it in the **OFF** position.

To use the set of speakers connected to the FRONT SPEAKERS ② terminals, press SPEAKERS 2 to set it in the **ON** position, and press SPEAKERS 1 to set it in the **OFF** position.

To use both sets of speakers, press both SPEAKERS 1 and 2 to set them in the **ON** position.

To use neither set of speakers, press both SPEAKERS 1 and 2 to set them in the **OFF** position.

Note:

When only one set of the front speakers is connected to either the FRONT SPEAKERS ① or ② terminals, do not press both SPEAKERS 1 and 2 to set them in the **ON** position. If you do, no sound comes out of the front speakers.

Adjusting the Volume

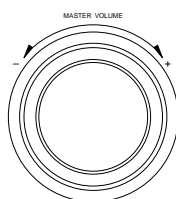

On the front panel

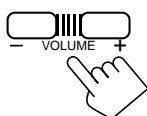

From the remote control

On the front panel:

To increase the volume, turn MASTER VOLUME clockwise.

To decrease the volume, turn it counterclockwise.

When you turn MASTER VOLUME **rapidly**, the volume level also changes **rapidly**.
When you turn MASTER VOLUME **slowly**, the volume level also changes **slowly**.

From the remote control:

To increase the volume, press VOLUME +.

To decrease the volume, press VOLUME -.

CAUTION:

Always set the volume to the minimum before starting any source. If the volume is set at its high level, the sudden blast of sound energy can permanently damage your hearing and/or ruin your speakers.

Muting the Sound



From the remote control *only*:

Press MUTE to mute the sound through all speakers and headphones connected.
“MUTE” appears on the display and the volume turns off.

To restore the sound, press MUTE again so that “OFF” appears on the display.

Turn MASTER VOLUME or pressing VOLUME +/- also restores the sound at the previous volume level.

Recording a Source

You can record any source playing through the amplifier to a cassette deck connected to the TAPE jacks and VCR connected to the VCR jacks at the same time.

While recording, you can listen to the selected sound source at whatever sound level you like, without affecting the sound levels of the recording.

Note:

The output volume level, preset SEA, and surround modes cannot affect the recording.

Listening with Headphones

A standard pair of headphones can be connected to the PHONES jack on the front panel. **Be sure to turn down the volume before connecting or putting on headphones, as high volume can damage both the headphones and your hearing.**

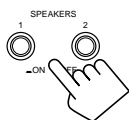

To listen with only headphones

Press both SPEAKERS 1 and 2 to set them in the **OFF** position.

Some of the following settings are required after connecting and positioning your speakers in your listening room, while others will make operations easier.

Adjusting the Front Speaker Output Balance

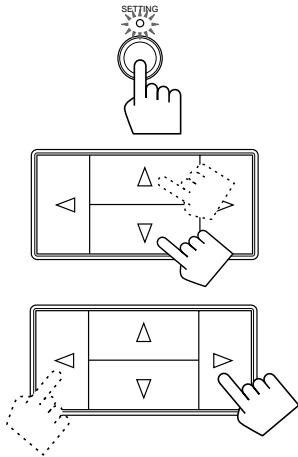

If the sounds you hear from the front right and left speakers are unequal, you can adjust the speaker output balance.

On the front panel only:

1. Press **SETTING** so that the Control $\Delta / \nabla / \triangleleft / \triangleright$ buttons work for adjusting the balance. The lamp above the button lights up.
2. Press Control Δ / ∇ until **"BALANCE"** appears on the display.
3. Press Control $\triangleleft / \triangleright$ to adjust the balance.
 - Pressing Control \triangleleft decreases the right channel output.
 - Pressing Control \triangleright decreases the left channel output.

Listening at Low Volume (Loudness)

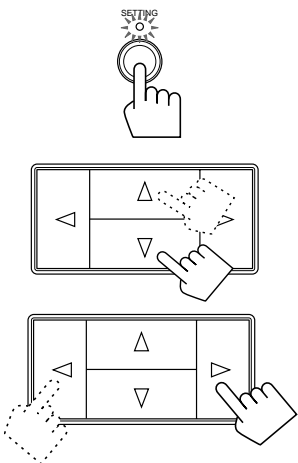

Human ears are not sensitive to bass at low volume. To compensate for this, the loudness function automatically boosts the bass level as you lower the volume.

On the front panel only:

1. Press **SETTING** so that the Control $\Delta / \nabla / \triangleleft / \triangleright$ buttons work for setting the loudness. The lamp above the button lights up.
2. Press Control Δ / ∇ until **"LOUDNESS"** appears on the display.
3. Press Control $\triangleleft / \triangleright$ to set the loudness function to **"ON"** or **"OFF."**
 - Select **"ON"** to activate the loudness function. The **LOUDNESS** indicator lights up on the display.
 - Select **"OFF"** to cancel it. The indicator goes off.

Using the Sleep Timer

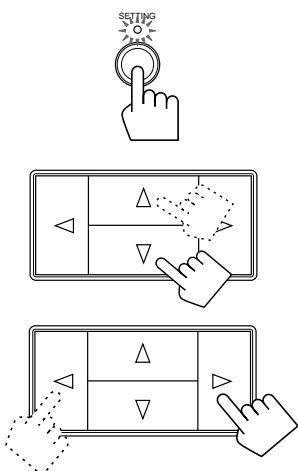

Using the Sleep Timer, you can fall asleep to music and know the amplifier will turn off by itself rather than play all night.

On the front panel only:

1. Press **SETTING** so that the Control $\Delta / \nabla / \triangleleft / \triangleright$ buttons work for setting the Sleep Timer. The lamp above the button lights up.
2. Press Control Δ / ∇ until **"<SLEEP>"** appears on the display.
3. Press Control $\triangleleft / \triangleright$ to set the shut-off time. Each time you press the button, the shut-off time on the display changes as follows, and the **SLEEP** indicator lights up on the display.

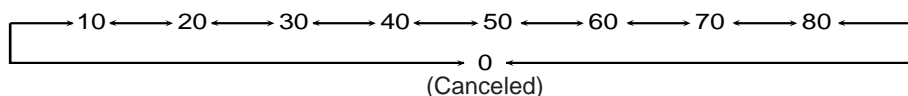

Continue to the next page

When the shut-off time comes, the amplifier turns off (into standby mode) automatically.

To check or change the time remaining until the shut-off time:

1. Press SETTING if necessary, so that the Control $\Delta / \nabla / \triangleleft / \triangleright$ buttons work for setting the Sleep Timer.
2. Press Control Δ / ∇ if necessary, until "<SLEEP>" appears on the display.
3. Press Control $\triangleleft / \triangleright$.
The remaining time until the shut-off time appears in minutes.
• To change the shut-off time, press Control $\triangleleft / \triangleright$ repeatedly.

To cancel the Sleep Timer, press Control $\triangleleft / \triangleright$ repeatedly in step 3 above until "0" appears on the display. (The SLEEP indicator goes off.)
Turning off the power (into standby mode) also cancels the Sleep Timer.

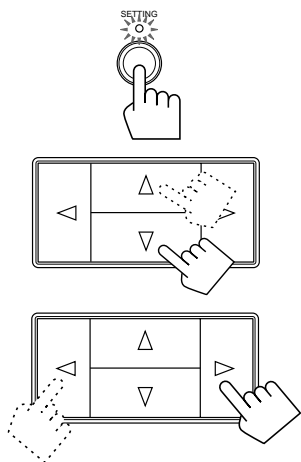

Selecting the Center Speaker Size

You can register the information about the center speaker after all connections are completed. If you do this registration first, you do not have to adjust the center speaker mode when you want to activate the surround sound. However, to register the information, first you have to set the surround mode either to "PROLOGIC" or "3CHLOGIC." (You cannot select the center speaker size when the surround mode is "OFF" or "HALL.")

On the front panel only:

1. Press SURROUND so that the Control Δ / ∇ buttons work for selecting the surround mode.
The lamp above the button lights up.
2. Press Control Δ / ∇ until "PROLOGIC" or "3CHLOGIC" appears on the display.
The indicator of the selected mode also lights up on the display.
3. Press SETTING so that the Control $\Delta / \nabla / \triangleleft / \triangleright$ buttons work for selecting the center speaker size.
The lamp above the button lights up.
4. Press Control Δ / ∇ until "CNTR SPK" (Center Speaker) appears on the display.
5. Press Control $\triangleleft / \triangleright$ to select the appropriate item about your center speaker.
Each time you press the button, the display changes to show the following:

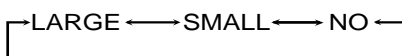

LARGE	Select this mode when the size of the center speaker is the same as that of the front speakers.
SMALL	Select this mode when the size of the center speaker is smaller than that of the front speakers.
NO	Select this mode when you do not use a center speaker. (This mode cannot be selected when you select "3CHLOGIC.")

Note:

This "center speaker size" setting is so related to the center mode setting for the Dolby Surround that changing this setting affects and changes the center mode to a relevant mode, and vice versa.
For example;

- If you select "LARGE," the center mode is automatically set to "WIDE," and vice versa.
- If you select "SMALL," the center mode is automatically set to "NORMAL," and vice versa.
- If you select "NO," the center mode is automatically set to "PHANTOM" for PRO LOGIC, and vice versa.

One Touch Operation

This amplifier can memorize the optimum sound setting for each playing source.

About the One Touch Operation

JVC's One Touch Operation function is used to assign and store different sound settings for each different playing source. By using this function, you do not have to change the settings every time you change the source. The stored settings for the newly selected source are automatically recalled.

The following can be stored for each source:

- Volume level (see page 10)
- Balance (see page 12)
- Loudness (see page 12)
- Preset SEA modes (see page 15)
- Surround mode settings (see page 17)

Using the One Touch Operation

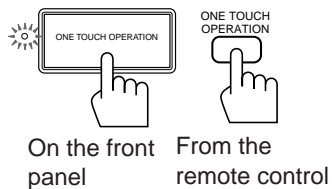

To store the sound settings:

1. Press ONE TOUCH OPERATION.

The ONE TOUCH OPERATION lamp lights up, then the previously memorized settings are recalled and appear on the display in turn.

2. Adjust the sound using the functions listed above.

The newly adjusted settings are memorized.

To recall the sound settings:

With the ONE TOUCH OPERATION lamp lit, the settings for the currently selected source is recalled, and appears on the display when the source is selected.

To cancel the One Touch Operation function:

Press ONE TOUCH OPERATION so that the lamp goes off. (Even though the One Touch Operation function is canceled, the recalled sound effects remain active.)

Using the Preset SEA Modes

The preset SEA (Sound Effect Amplifier) modes give you control over the way your music sounds.

Note:

The preset SEA mode cannot be used for recording.

Selecting Your Favorite SEA Mode

On the front panel:

1. Press PRESET SEA so that the Control Δ / ∇ / \triangleleft / \triangleright buttons work for preset SEA setting.

The lamp above the button lights up.

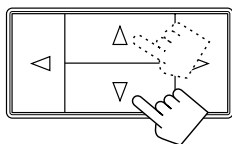

2. Press Control Δ / ∇ until the mode you want appears on the display.

The SEA indicator also lights up on the display.

Each time you press the button, the preset SEA modes change as follows:



Note:

When you turn on the preset SEA mode, the mode and its effect level previously selected is recalled at first.

3. Press Control \triangleleft / \triangleright to select the effect level.

Each time you press the button, the effect level changes as follows:

When "MOVIE" is selected:



When "SPORTS" is selected:



When "MUSIC" is selected:

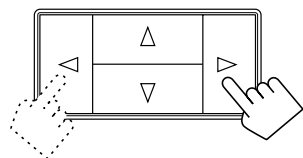
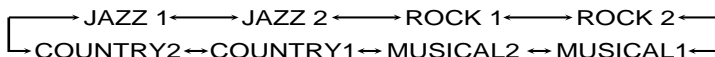

MOVIE	Adds breadth to sounds so you feel like you are in a movie theater.
SPORTS	Makes sound exciting.
MUSIC	Select one of the modes below: JAZZ: Gives a feeling of a live atmosphere. Good for acoustic music. ROCK: Gives a heavy sound. Both high and low frequencies are boosted. MUSICAL: Enhances the mid-frequency range, which the human voice is mostly made up of. COUNTRY: Enhance the high-frequency range so that instruments such the violin and banjo are emphasized.
OFF	No preset SEA mode is applied. (See below)

To cancel the preset SEA mode, select "OFF" in step 2 above.

The SEA indicator goes off from the display.

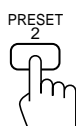
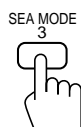
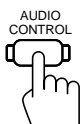

From the remote control:

1. Press SEA ON/OFF so that the SEA indicator lights up on the display.

The previously selected mode is recalled (at its previous effect level) and is shown on the display. Each time you press the button, the preset SEA mode turns on and off.

Note:

When selecting the preset SEA mode, the display will show the current effect level of the preset SEA mode selected.

2. Press AUDIO CONTROL so that 10 keys work for adjusting the sound.

3. Press SEA MODE until the mode you want appears on the display.

Each time you press the button, the three preset SEA modes change as follows:

Ex. → MOVIE 1 → SPORTS2 → JAZZ 2 →

4. Press PRESET to select the effect level.

Each time you press the button, the effect level changes as follows:

When “MOVIE” is selected:

→ MOVIE 1 → MOVIE 2 → MOVIE 3 →

When “SPORTS” is selected:

→ SPORTS1 → SPORTS2 → SPORTS3 →

When “MUSIC” is selected:

→ JAZZ 1 → JAZZ 2 → ROCK 1 → ROCK 2 →
COUNTRY2 ← COUNTRY1 ← MUSICAL2 ← MUSICAL1 ←

To cancel the preset SEA mode, press SEA ON/OFF so that the SEA indicator goes off from the display.

Each time you press the button, the preset SEA mode turns on and off.

Using the Surround Processor

The built-in surround processor provides three types of surround programs — Dolby Pro Logic, Dolby 3-Channel Logic, and JVC's Hall Surround.

What is surround?

The sound heard in a concert hall or a movie theater consists of direct sound and indirect sound: early reflections and reflections from behind. The reflected sounds are always delayed by the distances of the ceiling and walls from the listener. These reflections are some of the most important elements of the acoustic surround.

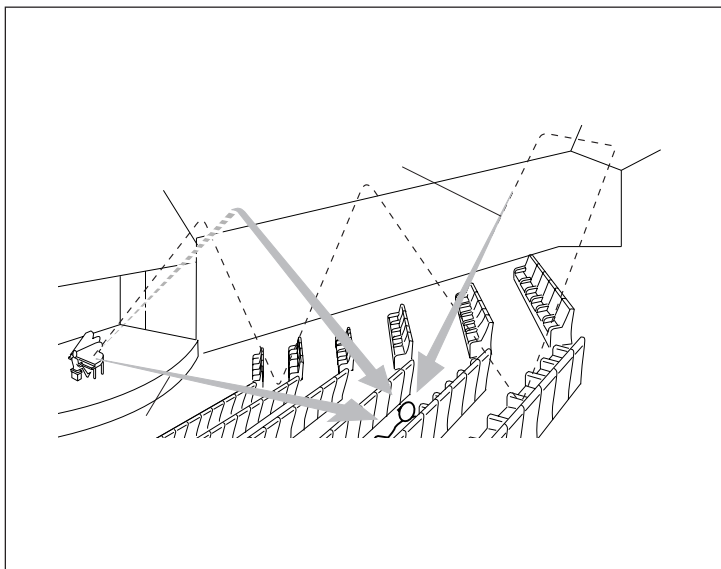

On JVC's Hall Surround

In order to reproduce a more realistic sound field in your listening room while playing an ordinary stereo source, JVC's Hall Surround has been designed to give you clear vocals and to create the feeling of a concert hall. The sound is reproduced through the front speakers and rear speakers.

On Dolby Surround

Dolby Surround has been also developed to reproduce the important elements of the acoustic surround at home.

To watch the soundtracks of video software bearing the mark  * which includes the same encoded surround information as found in Dolby Stereo films, the amplifier can provide you with 2 Dolby Surround programs (Dolby Pro Logic and Dolby 3ch Logic).

Dolby Pro Logic: Select this mode when the optional rear speakers are connected (as well as a center speaker).

Dolby 3ch Logic: Select this mode when a center speaker is connected without rear speakers.

* Manufactured under license from Dolby Laboratories Licensing Corporation. "Dolby," the double-D symbol, and "Pro Logic" are trademarks of Dolby Laboratories Licensing Corporation.

Notes:

- The surround processor has no effect on monaural sources.
- The surround processor cannot be used for recording.

Using JVC's Hall Surround

You need to connect one set of rear speakers to obtain the full effect. Once you have adjusted the Hall Surround, the amplifier memorizes the settings.

On the front panel:

1. Press SURROUND so that the Control Δ / ∇ / \triangleleft / \triangleright buttons work for selecting the surround modes.

The lamp above the button lights up.

2. Press Control Δ / ∇ until "HALL" appears on the display.

The HALL indicator also lights up on the display.

Each time you press the button, the surround modes change as follows:

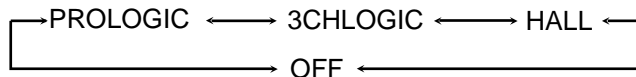

The indicator of the selected surround mode lights up in turn as you select the surround modes.

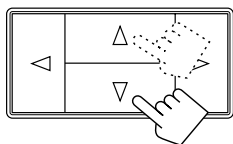

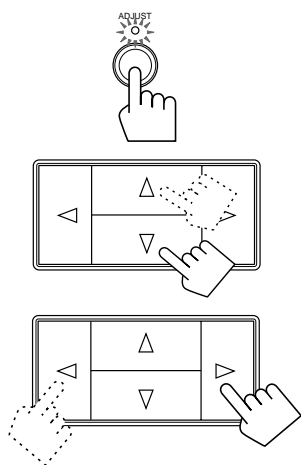

3. Press **ADJUST** so that the Control Δ / ∇ / \triangleleft / \triangleright buttons work for surround settings.
The lamp above the button lights up.
4. Press Control Δ / ∇ until “- REAR +” appears on the display.
5. Press Control \triangleleft / \triangleright to adjust the rear speaker output level.
 - Pressing Control \triangleleft decreases the output level up to -10 dB.
 - Pressing Control \triangleright increases the output level up to +10 dB.
6. Press Control Δ / ∇ until “-DELAY +” appears on the display.
7. Press Control \triangleleft / \triangleright to adjust the delay time of the rear speaker output.
Each time you press the button, the delay time changes as follows:





DELAY 1	Select this when the distance from you to your rear speakers is greater than that to the front speakers.
DELAY 2	Select this when the distance from you to your rear speakers is almost equal to that to the front speakers.
DELAY 3	Select this when the distance from you to your rear speakers is less than that to the front speakers.

To cancel the **Hall surround**, select “OFF” in step 2. The HALL indicator goes off.

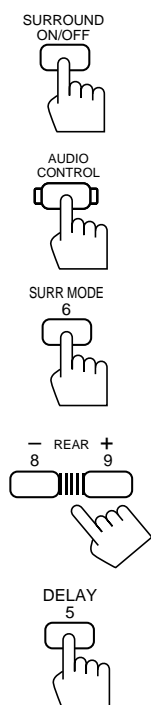
From the remote control:

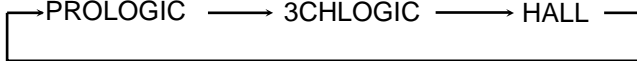

1. Press **SURROUND ON/OFF** so that one of the surround mode indicators (**PRO LOGIC**, **3CH LOGIC**, **HALL**) lights up on the display.
The previous mode is recalled (at its previous settings) and is shown on the display.
Each time you press the button, the surround mode turns on and off.
2. Press **AUDIO CONTROL** so that 10 keys work for adjusting the sound.
3. Press **SURR MODE** until “**HALL**” appears on the display.
The HALL indicator also lights up on the display.
Each time you press the button, the surround modes change as follows:
 

The indicator of the selected surround mode lights up in turn as you select the surround modes.
4. Press **REAR +/-** to adjust the rear speaker output level.
 - Pressing REAR - decreases the output level up to -10 dB.
 - Pressing REAR + increases the output level up to +10 dB.
5. Press **DELAY** to adjust the delay time.
Each time you press the button, the delay time changes as follows:
 

To cancel the **Hall Surround**, press SURROUND ON/OFF so that the HALL indicator goes off.
Each time you press the button, the surround mode turns on and off.

Speaker Arrangements for Dolby Surround

The following illustrations show how to obtain the optimum sound environment for various Dolby Surround settings. Try to find the speaker direction and location to create the optimum sound field.

CASE 1 When you have added a center speaker and rear speakers

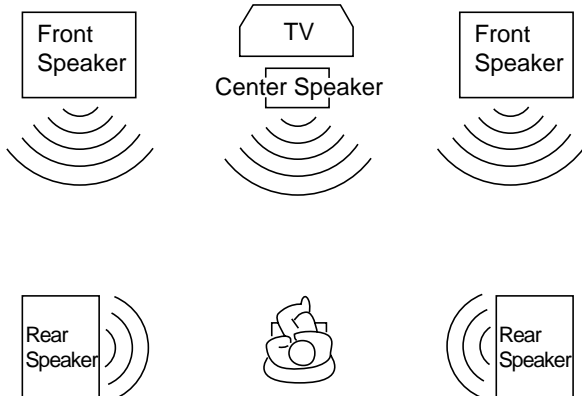

In this case:

1. Select "PROLOGIC."
2. Select "NORMAL" or "WIDE" for center mode.

See pages 20 to 22 for more details.

CASE 2 When you have added rear speakers (without a center speaker)

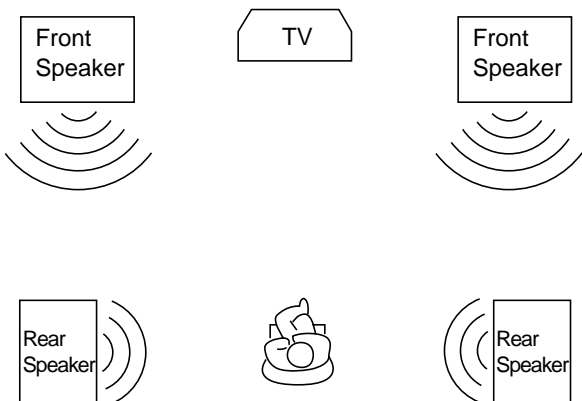

In this case:

1. Select "PROLOGIC."
2. Select "PHANTOM" for center mode.

See pages 20 to 22 for more details.

CASE 3 When you have added a center speaker (without rear speakers)

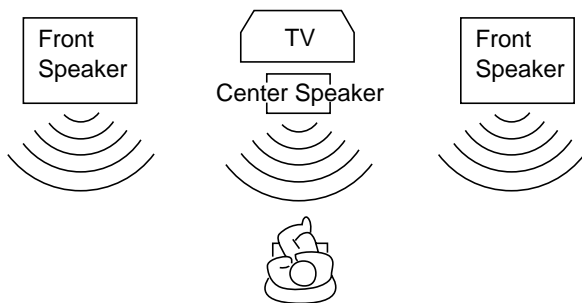

In this case:

1. Select "3CHLOGIC."
2. Select "NORMAL" or "WIDE" for center mode.

See pages 20 to 22 for more details.

The amplifier memorizes two sets of Dolby Surround adjustments; one for Pro Logic and the other for 3ch Logic.

On the front panel:

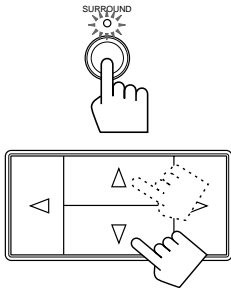

1. Press SURROUND so that the Control Δ / ▽ buttons work for selecting the surround modes. The lamp above the button lights up.
2. Press Control Δ / ▽ until "PROLOGIC" or "3CHLOGIC" whichever you want appears on the display. The PRO LOGIC or 3CH LOGIC indicator also lights up. Each time you press the button, the surround modes change as follows:

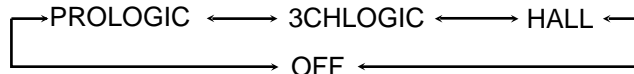

The indicator of the selected surround mode lights up in turn as you select the surround modes.

PROLOGIC	Select this mode when you use a center speaker and rear speakers.
3CHLOGIC	Select this mode when you use a center speaker without rear speakers.
HALL	This is JVC's original surround mode, and is different from Dolby Surround. To use this, see page 17.
OFF	Select this to turn off the surround mode.

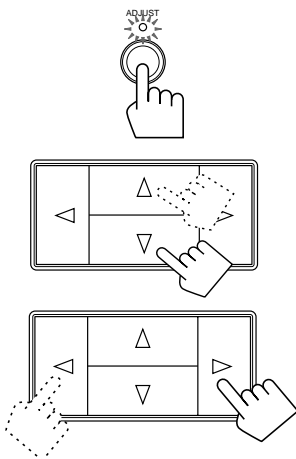

3. Press ADJUST so that the Control Δ / ▽ / ◀ / ▶ buttons work for adjusting the selected surround mode. The lamp above the button lights up.
4. Press Control Δ / ▽ until "CNT MODE" (Center Mode) appears on the display.
5. Press Control ◀ / ▶ to select the center mode. Each time you press the button, the center modes change as follows:

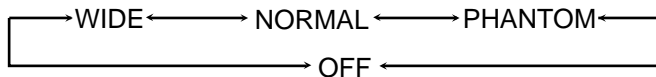

WIDE	Select this mode when the center speaker can reproduce the bass better than the front speakers. All signals of the center channel are output through the center speaker.
NORMAL	Select this mode when the center speaker cannot reproduce the bass better than the front speakers. The bass portions of the center channel signals are output through the front speakers.
PHANTOM	Select this mode when you do not use a center speaker. The center speaker channel signals are output through the front speakers.
OFF	Select this mode to turn off the center speaker channel.

Notes:

- If you have already set the center speaker size following the procedure described on page 13, you do not have to select the center mode in this procedure.
- When you have selected "3CHLOGIC," you cannot select "PHANTOM."

Continue to the next page

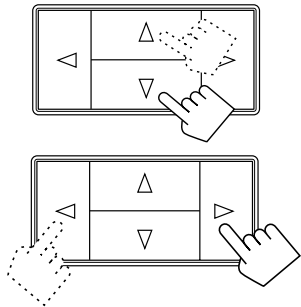

6. Press Control Δ / ∇ until “-DELAY +” appears on the display.

7. Press Control $\triangleleft / \triangleright$ to adjust the delay time of the rear speaker output.

Each time you press the button, the delay time changes as follows:

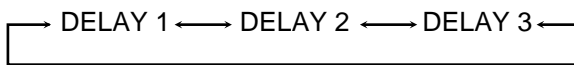

DELAY 1	Select this when the distance from you to your rear speakers is greater than that to the front speakers.
DELAY 2	Select this when the distance from you to your rear speakers is almost equal to that to the front speakers.
DELAY 3	Select this when the distance from you to your rear speakers is less than that to the front speakers.

Note:

When you have selected “3CHLOGIC,” you cannot adjust the delay time.

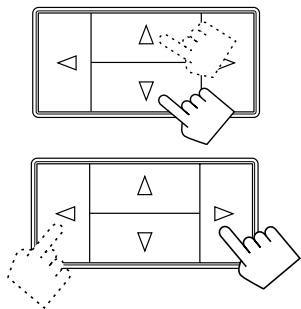

8. Press Control Δ / ∇ until “TEST” appears on the display, then press Control $\triangleleft / \triangleright$ to start checking the speaker output balance.

“TEST” starts flashing on the display, and a test tone comes out of the speakers in the following order:

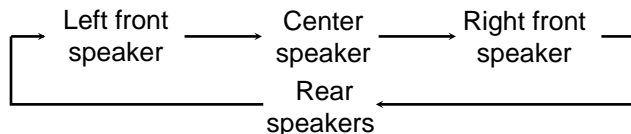

Notes:

- No test tone comes out of the rear speakers when you have selected “3CHLOGIC.”
- No test tone comes out of the center speaker when you select “PHANTOM” or “OFF” for the center mode.

9. If necessary, adjust the speaker output balance as follows:

- To adjust the rear speaker output level, press Control Δ / ∇ until “- REAR +” appears on the display, then press Control $\triangleleft / \triangleright$.
- To adjust the center speaker output level, press Control Δ / ∇ until “-CENTER+” appears on the display, then press Control $\triangleleft / \triangleright$.

Notes:

- The sound levels of the left and right rear speakers will be the same.
- You cannot set the sound level of the rear speakers when you have selected “3CHLOGIC.”
- You cannot set the sound level of the center speaker when you select “PHANTOM” or “OFF” for the center mode.

10. Press Control Δ / ∇ until “TEST” appears on the display, then press Control $\triangleleft / \triangleright$ to stop the test tone.

From the remote control:

If you have already set the center speaker size following the procedure described on page 13, you can use the remote control for Dolby Surround preparation.



1. Press **SURROUND ON/OFF** so that one of the surround mode indicators (**PRO LOGIC**, **3CH LOGIC**, **HALL**) lights up on the display.

The previous mode is recalled (at its previous settings) and is shown on the display. Each time you press the button, the surround mode turns on and off.



2. Press **AUDIO CONTROL** so that 10 keys work for adjusting the sound.

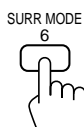

3. Press **SURR MODE** until “**PROLOGIC**” or “**3CHLOGIC**” whichever you want appears on the display.

Each time you press the button, the surround modes change as follows:

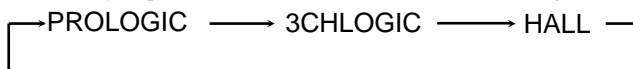

The indicator of the selected surround mode lights up in turn as you select the surround modes.

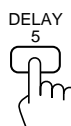

4. Press **DELAY** to adjust the delay time of the rear speaker output.

Each time you press the button, the delay time changes as follows:

**Note:**

When you have selected “**3CHLOGIC**,” you cannot adjust the delay time.

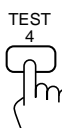

5. Press **TEST** to start checking the speaker output balance.

“**TEST**” starts flashing on the display, and a test tone comes out of the speakers in the following order:

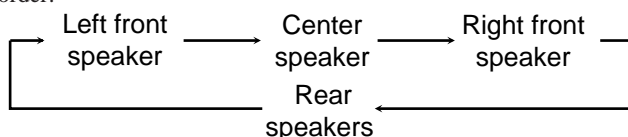
**Notes:**

- No test tone comes out of the rear speakers when you have selected “**3CHLOGIC**.”
- No test tone comes out of the center speaker when you select “**PHANTOM**” or “**OFF**” for the center mode.

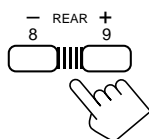

6. If necessary, adjust the speaker output balance as follows:

- To adjust the rear speaker output level, press **REAR +/-**.
- To adjust the center speaker output level, press **CENTER +/-**.

Pressing **-** decreases the output level up to **-10 dB**.

Pressing **+** increases the output level up to **+10 dB**.

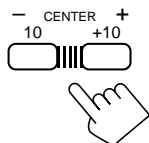
**Notes:**

- The sound levels of the left and right rear speakers will be the same.
- You cannot set the sound level of the rear speakers when you have selected “**3CHLOGIC**.”
- You cannot set the sound level of the center speaker when you select “**PHANTOM**” or “**OFF**” for the center mode.

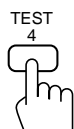

7. Press **TEST** again to stop the test tone.

Using Dolby Surround

Once you have set the Dolby Surround adjustments, you can use the same adjustments every time you want to enjoy Dolby Surround.

On the front panel:

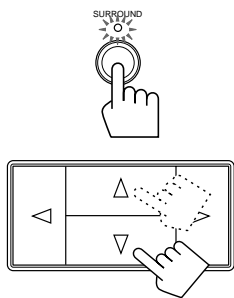

1. **Press SURROUND** so that the Control Δ / ∇ buttons work for selecting the surround modes.
The lamp above the button lights up.
2. **Press Control Δ / ∇ until “PROLOGIC” or “3CHLOGIC” whichever you want appears on the display.**
The PRO LOGIC or 3CH LOGIC indicator also lights up.
Each time you press the button, the surround modes change as follows:

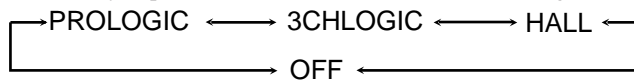

The indicator of the selected surround mode lights up in turn as you select the surround modes.

3. **Select and play a sound source which was processed with Dolby Surround and is labeled with  mark.**

To cancel Dolby Surround, select “OFF” in step 2 above. The indicator of the selected mode goes off.

From the remote control:

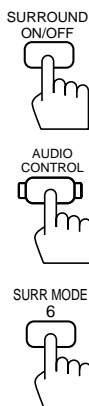

1. **Press SURROUND ON/OFF** so that one of the surround mode indicators (PRO LOGIC, 3CH LOGIC, HALL) lights up on the display.
The previous mode is recalled (at its previous settings) and is shown on the display.
Each time you press the button, the surround mode turns on and off.
2. **Press AUDIO CONTROL** so that 10 keys work for adjusting the sound.
3. **If necessary, press SURR MODE** until “PROLOGIC” or “3CHLOGIC” whichever you want appears on the display.

Each time you press the button, the surround modes change as follows:

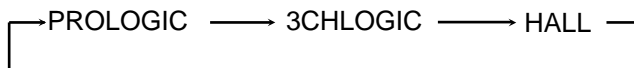

The indicator of the selected surround mode lights up in turn as you select the surround modes.

4. **Select and play a sound source which was processed with Dolby Surround and is labeled with  mark.**

To cancel Dolby Surround, press SURROUND ON/OFF so that the indicator of the selected mode goes off.

Each time you press the button, the surround mode turns on and off.

The COMPU LINK remote control system allows you to operate JVC audio components through the remote sensor on the amplifier.

To use this remote control system, you need to connect JVC audio components through the COMPU LINK-3 SYNCHRO jacks with the cables (monaural mini-plug supplied with those components). For details, see page 7.

Notes:

- Without connecting the audio components with RCA pin plugs as described on page 6, the COMPU LINK remote control system cannot operate the components.
- Refer also to the manuals supplied with your audio components.

This remote control system allows you to use the four functions listed below.

■ Remote Control through the Remote Sensor on the Amplifier

You can control JVC audio components through the remote sensor on the amplifier using this remote control. Aim the remote control directly at the remote sensor on the amplifier. For details, see page 25.

■ Automatic Source Selection

When you start playing on a connected component, the amplifier automatically turns on and changes its source to the component. On the other hand, if you select a new source on the amplifier or the remote control, the selected component begins playing immediately.

In both cases, the previously selected source continues playing without sound for a few seconds.

■ Automatic Power On/Off (Standby) (only possible with the COMPU LINK-3 connection)

The audio components (tuner, CD player and cassette deck) connected to the amplifier automatically turn on and off (into standby mode) with the amplifier.

When you turn on the amplifier, one of the connected components will turn on automatically, depending which component has been previously selected.

When you turn off the amplifier (into standby mode), these components connected will turn off (into standby mode).

■ Synchronized Recording

Synchronized recording means the cassette deck starts recording as soon as a CD or record begins playing.

To use synchronized recording, follow these steps:

- 1 Put a tape in the cassette deck, and a disc in the CD player (or a record on the turntable).**
- 2 Press the record (●) button and the pause (II) button on the cassette deck at the same time.**
This puts the cassette deck into recording pause.

Note:

If you do not press the record (●) button and pause (II) button at the same time, the synchronized recording feature will not operate.

- 3 Press the play (▶) button on the CD player or on the turntable.**

The source changes on the amplifier, and as soon as play starts, the cassette deck starts recording. When the play ends, the cassette deck enters recording pause, and stops 4 seconds later.

Notes:

- During synchronized recording, the selected source cannot be changed.
- If your CD player is playing in program mode, a 4-second blank is recorded between tracks so that the music scan feature of your cassette deck can be used on the recorded tape.
- If the power of any component is shut off during synchronized recording, the COMPU LINK remote control system may not operate properly. In this case, you must start again from the beginning.
- Refer also to the manuals supplied with your CD player and cassette deck.

Using the Remote Control

You can operate JVC audio and video components with the amplifier's remote control, since control signals for JVC components are preset in the remote control.

To operate these components with the remote control, first select a source with the source buttons on the remote control. Then, operate that source using the remote control.

IMPORTANT:

To operate JVC audio components using this remote control:

- You need to connect JVC audio components through the COMPU LINK-3 SYNCHRO jacks (see page 7) in addition to the connections using cables with RCA pin plugs (see page 6).
- Aim the remote control directly at the remote sensor on the amplifier.

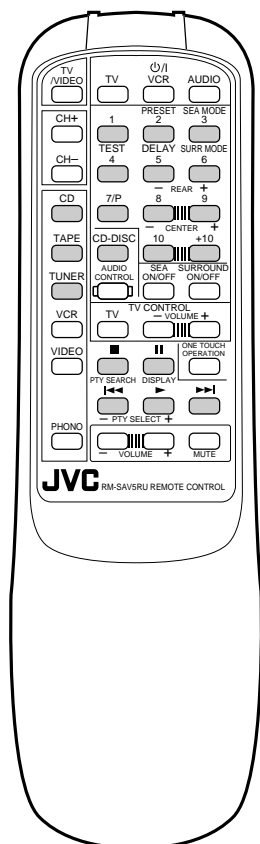

After pressing TUNER, you can perform the following operations:

- 1 — 10, +10 Selects a preset channel number directly
- For channel number 5, press 5.
- For channel number 15, press +10, then 5.
- For channel number 20, press +10, then 10.
- For channel number 30, press +10, +10 then 10.

RDS operating buttons

- PTY SEARCH Starts and ends searching a broadcast using the RDS.
- PTY SELECT +/- Selects a program type.
- DISPLAY Changes the RDS display mode.

After pressing CD, you can perform the following operations on a CD player:

- ▶ Starts playing
- ◀◀ Returns to the beginning of the current (or previous) track
- ▶▶ Skips to the beginning of the next track
- Stops playing
- ⏸ Pauses. To resume playing, press ▶.
- 1 — 10, +10 Selects a track number directly
- For track number 5, press 5.
- For track number 15, press +10, then 5.
- For track number 20, press +10, then 10.
- For track number 30, press +10, +10, then 10

After pressing CD-DISC, you can perform the following operations on a CD player-changer:

- 1 — 6, 7/P Select the number of a disc installed in a CD player-changer. Then continue to operate the CD player as described above.

After pressing TAPE, you can perform the following operations on a cassette deck:

- ▶ Starts playback
- ◀◀ Fast winds a tape from right to left
- ▶▶ Fast winds a tape from left to right
- Stops operation
- ⏸ Pauses. To resume playing, press ▶.

IMPORTANT:

To operate JVC video components using this remote control:

- Aim the remote control directly at the remote sensor on the VCR or TV, not on the amplifier.

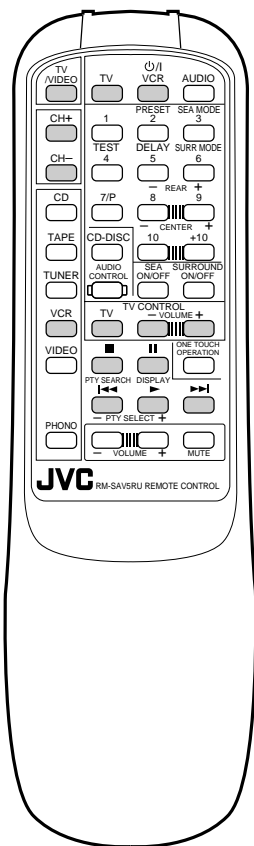

After pressing VCR, you can perform the following operations on a VCR:

- ▶ Starts playback
- ◀◀ Rewinds a video tape
- ▶▶ Fast winds a video tape
- Stops operation
- || Pauses. To resume playing, press ▶.
- CH+/- Changes channels on a VCR

Without pressing VCR, you can always perform the following:

- VCR (in the $\cup/|$ (Standby/On) section)
Turns on/off the VCR

After pressing TV (in the TV CONTROL section), you can perform the following operations on TV:

- CH+/- Changes TV channels

Without pressing TV (in the TV CONTROL section), you can always perform the following :

- TV/VIDEO Sets input mode (either to TV or to VIDEO)
- VOLUME +/- (in the TV CONTROL section)
Adjusts the volume
- TV (in the $\cup/|$ (Standby/On) section)
Turns on/off the TV

Troubleshooting

Use this chart to help you solve daily operational problems. If there is any problem you cannot solve, contact your JVC service center.

PROBLEM	POSSIBLE CAUSE	SOLUTION
The display does not light up	The power cord is not plugged in or the POWER switch is pressed to set in the ■OFF position	Plug the power cord into an AC outlet and press POWER to set it in the ■ON position
No sound from speakers	Speaker signal cables are not connected	Check speaker wiring and reconnect if necessary
	The SPEAKERS 1 and 2 are not set correctly	Press SPEAKERS 1 and 2 correctly
	An incorrect source is selected	Select the correct source
Sound from one speaker only	Speaker signal cables are not connected properly	Check speaker wiring and reconnect if necessary
	The balance is set to one extreme	Adjust the balance properly (see page 12)
Howling during record playing	Your turntable is too close to speakers	Move speakers away from the turntable
Remote control does not work	There is an obstruction in front of the remote sensor on the amplifier	Remove the obstruction
	Batteries are weak	Replace batteries

Specifications

Amplifier

Output Power	At Stereo Operation Front Channels	55 watts per channel, min. RMS, driven into 4 ohms at 1 kHz with no more than 0.9% total harmonic distortion. (IEC268-3/DIN)
		40 watts per channel, min. RMS, driven into 8 ohms at 1 kHz with no more than 0.9% total harmonic distortion. (IEC268-3/DIN)
	At Surround Operation Front Channels	40 watts per channel, min. RMS, driven into 8 ohms, 40 Hz to 20 kHz with no more than 0.8% total harmonic distortion.
	Center Channel	50 watts per channel, min. RMS, driven into 8 ohms at 1 kHz with no more than 0.8% total harmonic distortion.
	Rear Channels	50 watts per channel, min. RMS, driven into 8 ohms at 1 kHz, with no more than 0.8% total harmonic distortion.
Total Harmonic Distortion (8 ohms, 1 kHz)		0.8 %* at 40 watts output (* Measured by JVC Audio Analysis System)
Frequency Response (8 ohms)	PHONO TUNER, CD, TAPE, VCR, VIDEO	20 Hz to 20 kHz (± 1 dB) 20 Hz to 20 kHz (± 1 dB)
Audio Input Sensitivity/ Impedance (1 kHz)	PHONO (MM) TUNER, CD, TAPE, VCR, VIDEO	2.5 mV/47 k ohms 200 mV/47 k ohms
Audio Output Level	TAPE, VCR	200 mV
Signal-to-Noise Ratio (μ 66 IHF/DIN)	PHONO TUNER, CD, TAPE, VCR, VIDEO	70 dB/66 dB 87 dB/67 dB
RIAA Phono Equalization		± 0.5 dB (20 Hz to 20 kHz)
Loudness (Volume Control at -40 dB)		$+5 \pm 2$ dB at 100 Hz
Video Input Sensitivity/ Impedance	VCR, VIDEO	1 Vp-p/75 ohms
Video Output Level	VCR, MONITOR OUT	1 Vp-p (at 1 Vp-p input)
Synchronization		negative
Signal-to-Noise Ratio		45 dB

General

Power Requirements	AC 230V \sim , 50 Hz
Power Consumption	240 watts 2 watts (in standby mode)
Dimensions (W x H x D)	435 x 146 x 403 mm (17 $\frac{3}{16}$ x 5 $\frac{3}{4}$ x 15 $\frac{7}{8}$ inches)
Mass	8.0 kg (17.7 lbs)

Design & specifications are subject to change without notice

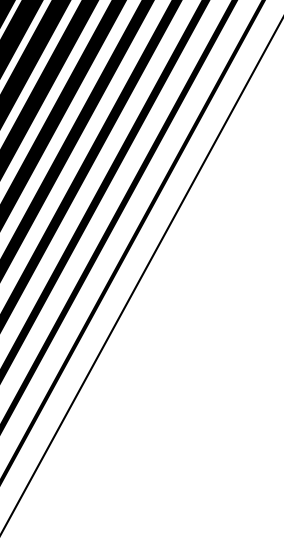

Free Manuals Download Website

<http://myh66.com>

<http://usermanuals.us>

<http://www.somanuals.com>

<http://www.4manuals.cc>

<http://www.manual-lib.com>

<http://www.404manual.com>

<http://www.luxmanual.com>

<http://aubethermostatmanual.com>

Golf course search by state

<http://golfingnear.com>

Email search by domain

<http://emailbydomain.com>

Auto manuals search

<http://auto.somanuals.com>

TV manuals search

<http://tv.somanuals.com>