

Preventing Accidental Operation (Hold mode)

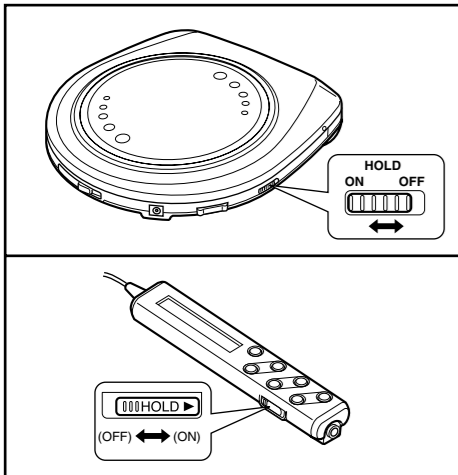

This function causes the unit to ignore accidental button presses.

Hold mode prevents the following:

- Powering on the unit accidentally (which can cause the batteries to go dead).
- Play being cut off unexpectedly.

The HOLD switch on the unit sets the unit in Hold mode. The HOLD switch on the remote control sets the remote control in Hold mode.

To use the Hold mode

- To prevent the unit from powering on accidentally, set the HOLD switch to the ON position.
- To prevent the unit from unexpected operation during play, set the HOLD switch to the ON position after you start playing the disc.

“”

Power on : “” stays lit when the remote control is set in Hold mode.
Power off : “” lights up for a few seconds when **▶||** is pressed in Hold mode.

To release the function

Set the HOLD switch to OFF position.

Note:

When the HOLD switch on the unit is set to the ON position, you cannot turn on the unit with the **▶||** on the unit. On the other hand, when the HOLD switch on the remote control is set to the ON position, you cannot turn on the unit with the **▶||** on the remote control.

Specifications

Portable CD player

Type : Compact disc player
Signal detection system : Non-contact optical pickup (semiconductor laser)
Pickup system : 3 beam laser
Number of channels : 2 channels (stereo)
Frequency response : 20 Hz to 20 000 Hz
Wow & flutter : Unmeasurable
Output : Headphones (3.5 mm dia. stereo × 1)
9 mW/ch at 10 % THD/16 Ω matching impedance (16 Ω to 1 kΩ)

Duration of battery : Approx. 3 hours when using two rechargeable batteries (with Anti-Shock Protection EX OFF)
Approx. 20 hours when using two alkaline batteries (LR6)

Power requirements : DC 3 V (“AA” size battery × 2)
DC 2.4 V (rechargeable battery × 2)
DC IN 4.5 V

Dimensions (W×H×D) : 134 mm × 22 mm × 144 mm (Excluding buttons and controls)

Mass : 250 g (without batteries)

AC adaptor

Input power source : AC 230 V, 50 Hz
Output voltage : DC 4.5 V, 600 mA

★ Design and specifications are subject to change without notice.

Troubleshooting

Problem	Check this
Does not turn on.	<ul style="list-style-type: none">Are the batteries charged?Is the AC adaptor securely connected?Is the HOLD switch set to OFF position?
Cannot close cover.	Is the disc properly secured in place?
Cannot play discs.	<ul style="list-style-type: none">Is the disc properly secured in place?Is there moisture condensation on the lens? (Wait for about an hour and then try again.)
Cannot hear music—too noisy.	<ul style="list-style-type: none">Are the headphone plug and the remote control plug inserted all the way?Is the plug dirty? (Wipe away dirt on the plug.)
TV picture is distorted. Radio reception is noisy.	Are you using the unit body too near a TV or tuner? (If the TV or tuner is connected to a simple indoor antenna, connect it to an outdoor antenna.)
“diSC” or “Er” is displayed when a disc is in the player.	<ul style="list-style-type: none">Is the disc damaged?Is the disc playable on this player?Has the disc been inserted upside down?

If the remedies indicated in the chart do not solve the problem, refer to the directory of Authorized Service Centers (enclosed with this unit) to locate a convenient service center, or consult your dealer.

Concerning Compact Discs

Only compact discs bearing this mark can be used with this unit.



However, continued use of irregular shape CDs (heart-shape, octagonal, etc.) can damage the unit. CD-R and CD-RW discs recorded with the audio CD format can be played back, though some may not be played back because of the disc characteristics or recording condition.

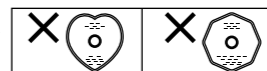

How to remove a disc from its case

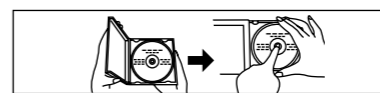

How to store the disc in its case



How to hold a disc

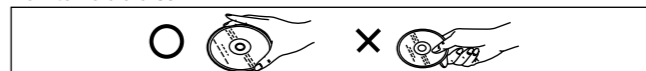

If the disc surface is dirty

Wipe it with a damp cloth and then wipe dry. Wipe from the center toward the outer edge.

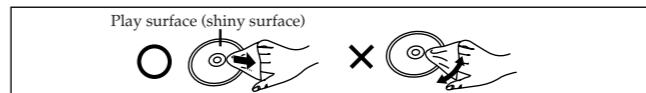

If moisture has formed on a disc

When moisture has formed because the disc was brought suddenly into a warm room from a cold environment, wipe off the moisture using a soft dry cloth.

When storing discs

Avoid locations which are

- Exposed to direct sunlight.
- Susceptible to high levels of humidity or dust.
- Directly exposed to heat from a heating appliance.
- On top of a car dashboard or near the rear window.

Handling precautions

- On the label side (the side with writing) Do not write anything using a pencil, ball-point pen, etc. Do not use adhesive paper or labels.
- On the disc (shiny) side Handle this side carefully to keep it free from fingerprints or scratches. Do not use record cleaners, solvents, etc.
- Do not attach labels or stickers to CDs.
- Do not use CDs with exposed adhesive from tape or left over peeled off stickers.
- Do not use scratch-proof protectors or covers other than those specified for use with this unit.

Maintenance

Unit

Wipe the unit with a soft cloth. Remove stubborn dirt using a cloth which has been dipped in water or soapy water and wrung out, and then wipe dry.

- If you intend to use a chemically treated cleaning cloth, read its directions first.
- Do not use alcohol or paint thinners.

Lens

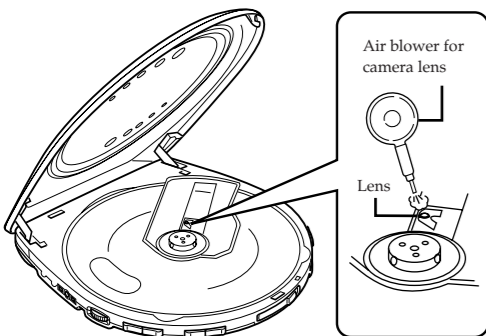

Cautions

Rechargeable batteries

- Only the BN-R1211 battery can be recharged.
- If the power delivered by the batteries lasts for a very short time after recharging, it means that the batteries' service life is over. Do not use them any more.
- Recharging already charged batteries will shorten their service life.
- When recharging batteries for the first time or when they have not been used for a long period of time, the play time may be shorter than usual. In a case like this, repeatedly recharge and discharge the batteries. This will restore them to their regular state.
- Do not allow any metal objects to touch the terminals of rechargeable batteries since this may cause short-circuiting which is dangerous.
- Do not peel off the plastic covering on the rechargeable batteries. Short-circuiting may occur which is dangerous.

Dry cell batteries / rechargeable batteries

- To prevent damage to the batteries and electrolyte leakage, heed the following points.
- Align the ⊕ and ⊖ polarities properly when inserting the batteries.
 - Do not mix different types or makes of batteries or old and new batteries.
 - Remove the batteries if you do not plan to use the unit for a long period of time.
 - Do not throw batteries into a fire, and do not short-circuit, disassemble or subject them to excessive heat.
 - Do not attempt to recharge dry cell batteries.

Carrying dry cell batteries / rechargeable batteries around

When putting dry cell or rechargeable batteries in a pocket or bag, ensure that no other metal objects such as a necklace are placed together with them. Contact with metal may cause short-circuiting which, in turn, may cause a fire.

When purchasing rechargeable batteries

As a safety precaution, the portable CD players made by JVC have a construction designed to make it impossible to recharge ordinary batteries.

To use rechargeable batteries, be absolutely sure to purchase the rechargeable Ni-Cd batteries designed especially for this unit.

Special rechargeable Ni-Cd batteries:

BN-R1211 (set of 2)

For details, check with your dealer.

Special rechargeable batteries

Ordinary dry cell batteries/rechargeable batteries

Notice about the rechargeable battery

The battery is designated recyclable. Please follow your local recycling regulations.

AC adaptor

- Handle the AC adaptor carefully. Improper handling is dangerous.
 - Do not touch it with wet hands.
 - Do not place heavy objects on top of it.
 - Do not forcibly bend it.
- Be sure to connect only the AC adaptor provided with the unit.
- Disconnect the AC adaptor from the power outlet if the unit is not going to be used for a long time.

Unit

No altering or remodeling

This can cause malfunctioning.

No dropping or strong impacts

This may damage the unit.

Locations to be avoided

Avoid using the unit in the following locations since they can cause malfunctioning.

- Bathrooms and other moisture-prone places.
- Warehouses and other dusty places
- Very hot places near heating appliances, etc.

Do not leave the unit exposed to direct sunlight for long periods of time

This may deform or discolor the cabinet and may also cause malfunctioning.

Listening Precautions

- Do not play your headphones at a high volume. Hearing experts advise against continuous extended play.
- If you experience a ringing in your ears, reduce volume or discontinue use.
- Do not use while operating a motorized vehicle. It may create a traffic hazard and is illegal in many areas.
- You should use extreme caution or temporarily discontinue use in potentially hazardous situations.
- Even if your headphones is an open-air type designed to let you hear outside sounds, don't turn up the volume so high that you can't hear what's around you.

Precautions

CAUTION!

THIS PRODUCT UTILIZES A LASER. USE OF CONTROLS OR ADJUSTMENTS OR PERFORMANCE OF PROCEDURES OTHER THAN THOSE SPECIFIED HEREIN MAY RESULT IN HAZARDOUS RADIATION EXPOSURE. DO NOT OPEN COVERS AND DO NOT REPAIR YOURSELF. REFER SERVICING TO QUALIFIED PERSONNEL.

WARNING:

TO REDUCE THE RISK OF FIRE OR ELECTRIC SHOCK, DO NOT EXPOSE THIS APPLIANCE TO RAIN OR MOISTURE.

Marking sign is located on bottom of the unit.

DANGER	INVISIBLE LASER RADIATION WHEN OPEN AND INTERLOCK DEFEATED. AVOID DIRECT EXPOSURE TO BEAM.
ADVARSEL	USYNLIG LASERSTRÅLING VED ÅBNING. NÅR SIKKERHEDSAFBRYDERE ER I USE #F FUNKTION. UNDGÅ UDSÆTTELSE FOR STRÅLING.
VARO!	AVATTAKESSA JA SUOJALUKITUS ÖHTEETÄESSÄ OLET ALLTTAINA NÄKYMÄTÖNTÄ LASERSÄTELELLE. ÄLÄ KATSO SÄTEESEEN!
WARNING	ÖSYNLIG LASERSTRÅLNING NÄR DENNA DEL ÄR ÖPPNAD OCH SPÄRREN ÄR URKOPPLAD. BETRÄKTA EJ STRÅLEN.
ADVARSEL	USYNLIG LASERSTRÅLING NÄR DEKSEL ÅPNES OG SIKKERHEDSLÅS BRYTES. UNNGÅ EKSPONERING FOR STRÅLEN.
VORSICHT	UNSICHTBARE LASERSTRAHLUNG, WENN ABDECKUNG GEÖFFNET UND SICHERHEITSVERGELUNG ÜBERBRÜCKT. NICHT DEM STRAHM AUSSETZEN.

(Bottom of product)

(Påsat under apparatet)

(Tuotten pohjassa)

(Apparatens undersida)

(Produktets underside)

(Underside des Gerätes)

JVC

PORTABLE CD PLAYER XL-PG59SL



INSTRUCTIONS

Supplied Accessories

Check the packing carton for these accessories.

Stereo headphones 1 pc.
AC adaptor (AA-R4515) 1 pc.
Remote control 1 pc.
Rechargeable Ni-Cd batteries (BN-R1211) 2 pcs.

Use numbers in parentheses when asking for replacement parts.

Thank you for purchasing this JVC product. Please read these instructions carefully before starting operation to be sure to obtain optimum performance and a longer service life from the unit.

LVT0979-004A [B]



0403SKMCREORI

©2003 VICTOR COMPANY OF JAPAN, LIMITED

CLASS 1
LASER PRODUCT

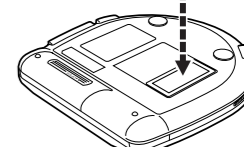

Bottom of the unit

CAUTION:

- Do not block the ventilation opening or holes. (If the ventilation openings of holes are blocked by a newspaper or cloth, etc., the heat may not be able to get out.)
- Do not place any naked flame sources, such as lighted candles, on the apparatus.
- When discarding batteries, environmental problems must be considered and local rules or laws governing the disposal of these batteries must be followed strictly.
- Do not expose this apparatus to rain, moisture, dripping or splashing and that no objects filled with liquids, such as vases, shall be placed on the apparatus.

Power Supply Preparations

Using rechargeable batteries (supplied)

Be sure to recharge the rechargeable batteries before using them.

Recharging procedure

1 Insert the rechargeable batteries.

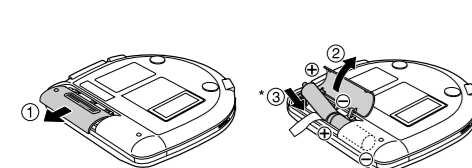

* Insert the battery as you push it in the indicated direction.

Caution:

Do not forcibly open the battery lid too wide.

2 Connect the AC adaptor (supplied).

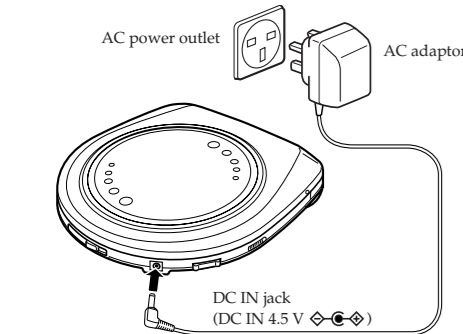

Recharging will be completed after 10 hours.

3 When recharging is complete, unplug the AC adaptor from the AC power outlet and the DC IN jack.

Location of Controls

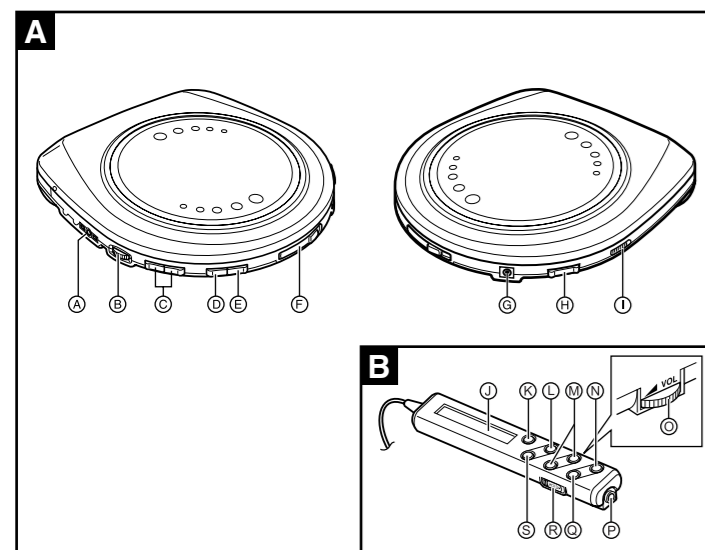

Portable CD player **A**

- Ⓐ Headphones / remote control jack (Ⓜ / REMOTE)
- Ⓑ Volume control (VOLUME)
- Ⓒ Skip / search buttons (◀▶)
- Ⓓ Stop / power off button (■)
- Ⓔ Play / pause button (▶/||)
- Ⓕ Lid open switch (OPEN ▶)
- Ⓖ DC in jack (DC IN 4.5 V)
- Ⓗ ASP (Anti-Shock Protection EX) button
- Ⓘ Hold switch (HOLD)

Remote control **B**

- Ⓚ Display
- Ⓛ Hyper-Bass Sound button (H.B.S.)
- Ⓜ Program button (PROG)
- Ⓝ Skip / search buttons (◀▶)
- Ⓞ Play / pause button (▶/||)
- Ⓟ Volume control (◀▶ VOL)
- Ⓠ Headphones jack
- Ⓡ Stop / power off button (■)
- Ⓢ Hold switch (HOLD ▶)
- Ⓣ Mode button (MODE)

Using dry-cell batteries (not supplied)

After disconnecting the AC adaptor, insert two "AA" (LR6) alkaline batteries.

The procedure for inserting and removing dry-cell batteries is identical to that for rechargeable batteries.

Battery indicator

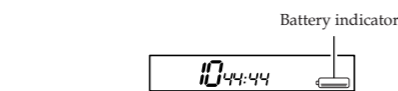

This indicator flashes on and off when the batteries are almost out of power. Power will be cut off a short while later.

Note:

Turning off the Anti-Shock Protection EX will save the battery power more or less. For details, see "Anti-shock Protection EX" on page 4.

If the unit malfunctions or freezes during use, disconnect the power source (the AC adaptor and batteries) once. Then, re-connect the power source and continue operation.

Basic Play

Unless otherwise noted, the remote control unit's buttons are used in the following explanation. Note that the unit's button with the same mark works equally to the remote control's button.

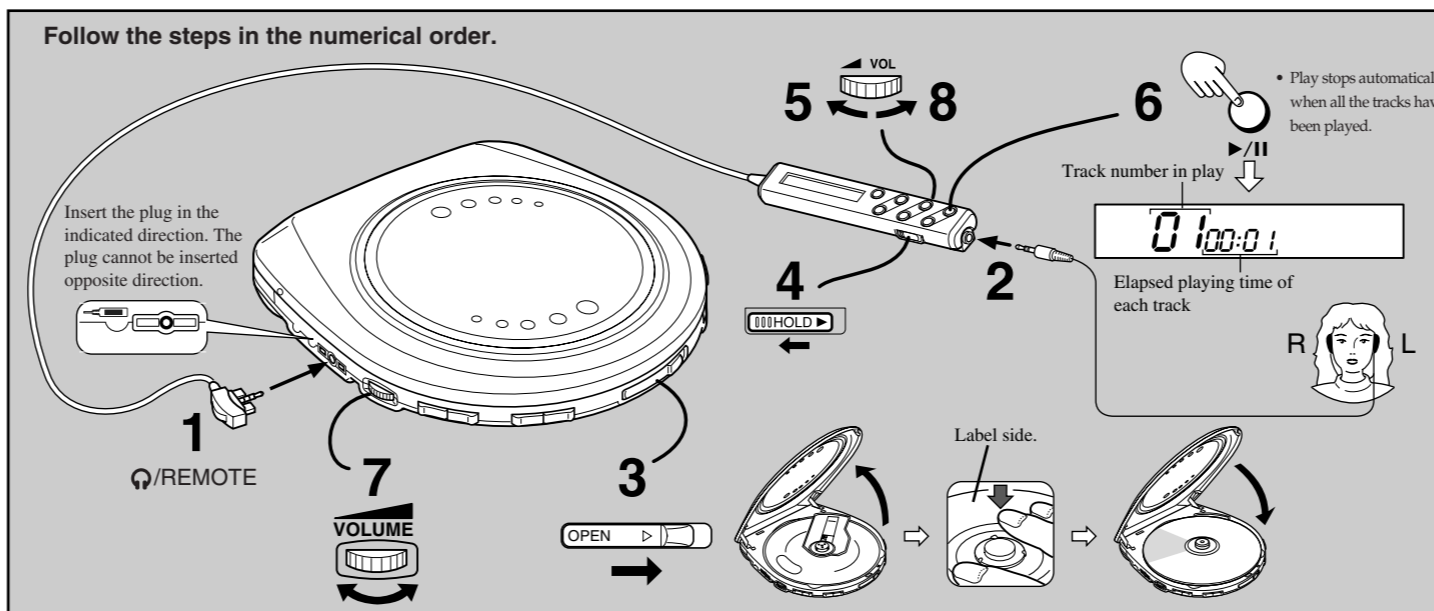

Note:

In step 1, firmly connect the plug into the jack. Otherwise, the display may not show the correct contents.

Operation	Button	Display/reference
To pause play	▶/	07:00:18 Press again to resume play.
To stop play Stop mode	■	Total number of tracks 1044:48 Total playing time.
To turn off the unit	■	88:88:88 ALL PROG. HBS 12 INTRO RANDOM
Fast forward/reverse	Reverse Forward	<ul style="list-style-type: none"> • To skip back to the previous track, quickly press ◀ twice. • During Program play, the button is used to fast forward or back through the programmed sequence of tracks. • During Random play, the skip button cannot be used to skip back to tracks that were played previously in the random sequence.
Search function	Keep depressed during play.	

For your reference:

"d 15f"
This indication appears if ▶/|| is pressed when no disc is loaded in the unit or if the disc is not properly seated.

"- -"
• Preparation period before playing the track
Flashes for several seconds after pressing ▶/|| to play the disc.

"OP EF"
This indication appears when the lid is open.

Removing discs

Turn off the unit and, after the disc has stopped rotating, remove the disc as shown below:

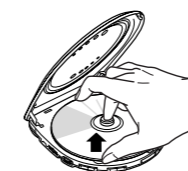

Auto power off function

If the unit is left in stop mode for 30 seconds, the unit turns itself off automatically to prevent the batteries from running down.

Other Play Methods

Random play

You can play all tracks in a random order. After playing all tracks, the unit stops.

During playback,

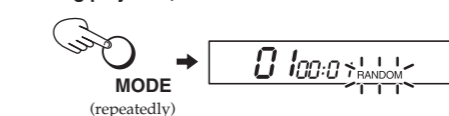

To cancel

Press MODE until "RANDOM" goes out, or press ■ to stop the disc.

Notes:

- You can also select Random play in stop mode.
- During Program play, you can not select Random play.

Program play

You can program up to 20 tracks in any desired order including the same tracks.

1 During playback or in stop mode,

Track number to be programmed
00: Not programmed yet.

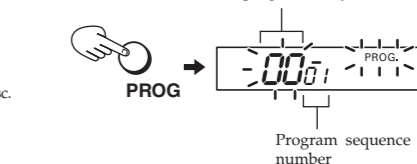

2 Select the desired track.

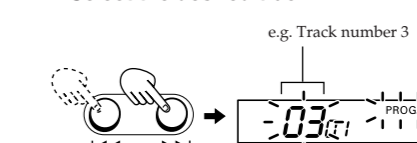

The track is registered.

4 Repeat steps 2 and 3 to program other tracks.

When you program exceeding 20 tracks, the program sequence number returns to "01" and will overwrite the previous setting.



The tracks are played in the programmed order.

• To confirm the program

In stop mode, press PROGRAM repeatedly. The programmed track number will successively appear together with the program sequence number. At this time, you can change the program, if required.
If the programmed tracks are less than 20, track number "00" appears for the youngest programmable sequence number, enabling further programming.

• To delete the entire program

Turn off the unit, or set the track number to 00 for the first program sequencer number, "01".

Repeat Play

You can repeat one track or all tracks.

During playback,

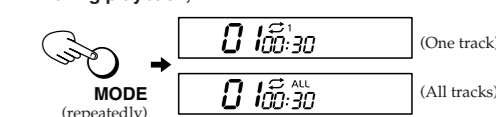

To cancel

Press MODE repeatedly until the repeat indicator goes out.

Notes:

- You can also select Repeat play in stop mode.
- You can also select Repeat play during Program play.

Intro play

You can successively play the first 10 seconds of every track. Intro play stops after playing the last track.

1 During playback,

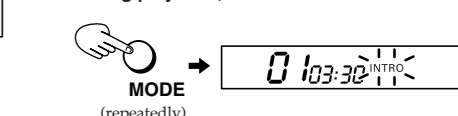

Intro play will start from the first track.

Pressing ▶/|| instead of ▶/|| will start Intro play from the next track. Pressing ◀▶ will start Intro play from the current track. When no button is pressed, Intro play will start from the next track after the current track has finished.

To cancel

Press MODE repeatedly until "INTRO" goes out.

To normally play the track being played

Press ▶/|| during Intro play.

Notes:

- You can also select Intro play in stop mode.
- You can also select Intro play during Program play.

Hyper-Bass Sound effect

You can enjoy powerful bass sound.

To get or cancel the Hyper-Bass Sound effect



The display changes as follows.

HBS 1 → HBS 2 → (cancelled)
HBS 2 provides more effect.

Notes:

- During Anti-Shock Protection EX operation, the disc rotates at a higher rate than usual in order to collect extra audio data. This may cause the batteries to run out faster and could result in a slight increase in disc rotation noise.
- The Anti-Shock Protection EX function can be switched ON and OFF during playback. However, this may cause a slight interruption in the sound because the disc's rotational speed changes.

Anti-Shock Protection EX

This function has been developed to achieve excellent performance against sound interruption caused by vibrations. You will be able to enjoy listening to music during jogging (not vigorous jogging). This function is achieved by utilizing the high-performance servo circuit and audio data that has been stored in the memory ahead of time (up to 45 seconds worth). Normally, the "ANTI SHOCK" indicator lights up on the display and the Anti-Shock Protection EX is in effect.

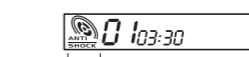

ANTI SHOCK indicator

When the disc is played, as the audio data gradually stored in the memory, the "ANTI SHOCK" indicator changes as follows:



To cancel

Press the ASP button.
The "ANTI SHOCK" indicator goes out on the display.

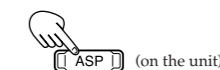

To activate again

Press the ASP button.

Free Manuals Download Website

<http://myh66.com>

<http://usermanuals.us>

<http://www.somanuals.com>

<http://www.4manuals.cc>

<http://www.manual-lib.com>

<http://www.404manual.com>

<http://www.luxmanual.com>

<http://aubethermostatmanual.com>

Golf course search by state

<http://golfingnear.com>

Email search by domain

<http://emailbydomain.com>

Auto manuals search

<http://auto.somanuals.com>

TV manuals search

<http://tv.somanuals.com>