

JVC®

The Perfect Experience / —

FIXED COLOR DOME CAMERA

TK-C205VPU(A)

(AC 24V/DC 12V)

Simple to Install Dome Camera with Vandal-Resistant Structure, 540 TVL Resolution and Easy Day/Night Function

◆ **0.7 Super LoLux™**
lx (B&W Mode)

◆ **0.9 Super LoLux™**
lx (Color Mode)



540 TV Lines Easy Day/Night



- Outdoor-ready vandal-resistant structure (complies with IP66) built to withstand shock, rain or extreme temperatures
- Simple to install with built-in ceiling mechanism
- 1/4" High resolution IT CCD with 380,000 effective pixels
- 540 TV lines of horizontal resolution
- Easy day/night function: Chroma on/off
- Super LoLux sensitivity: 0.9 lx F1.2 (Color mode), 0.7 lx F1.2 (B&W mode)
- Signal-to-Noise ratio: 50dB
- Revolutionary integrated 10-bit digital signal processor
- All normal adjustments accessible on face of camera with front cover removed
- Built-in variable focal length auto iris lens (f = 2.6 mm to 6.0 mm)
- Full featured security camera
 - Additional monitor video output (RCA) for easy camera setup
 - Automatic gain control (AGC) on/off
 - Auto tracking white balance (ATW) and manual modes: 2,300K to 10,000K
 - Easy focus adjustment
 - Backlight compensation on/off
 - Sync systems INT/Line lock
 - AC 24 V/DC 12 V power supply
- New inner cover to mask the direction of the camera
- Optional heater allowing you to use in various weather conditions

Vandal-resistant dome camera with 540 TVL resolution and Lolux sensitivity

More reliable than ever, this rugged high resolution dome camera features a tough vandal-resistant housing and new inner cover to mask the direction of the camera, plus optionally available heater to prevent condensation. Add convenient features such as Easy day/night function and Easy focus adjustment, and you've got a versatile surveillance camera ideal for service indoors or outdoors.

Outdoor-ready vandal-resistant* structure (complies with IP66) built to withstand shock, rain or extreme temperatures

With a solid die-cast aluminum base and silicon processed dome cover, this camera's enclosure is based on an original JVC design that meets the most rigorous standards for protection. Designed to handle just about anything, this durable enclosure can withstand a hard hit from a hammer with barely a scratch and its IP66 rating means it can be safely installed outdoors without worrying about the weather. So, from accidental shocks to deliberate assaults or extreme weather, this rugged camera is ready for anything.

*Vandal-resistant: The rugged die-cast aluminum body has the shock absorption capability necessary to absorb a standard level shock wave.

Built-in revolutionary digital signal processor (DSP)

JVC's innovative Digital Signal Processor automatically adjusts camera parameters to ensure sharp and natural pictures with 540 TV lines of horizontal resolution and high performance.

1/4" High resolution IT CCD with 380,000 effective pixels

TK-C205VPU(A) comes with a 1/4" interline transfer CCD for accurate color reproduction and signal-to-noise ratio of 50 dB (AGC off).

Easy day/night function

TK-C205VPU(A) automatically uses color mode when the subject is bright, and B&W mode when it is very dark. In B&W mode, AGC is always active to achieve high performance even in low light situations.

Automatic gain control (AGC)

With super LoLux sensitivity, as ambient light level falls, automatic gain control (AGC) increases the camera's sensitivity to 0.9 lx (Color mode).

Manual or automatic white balance (ATW)

For flexibility of operation in a wide range of environments the white balance can be set manually or can be automatically adjusted in real time by the Automatic tracking white balance (ATW) function over a range of 2,300K to 10,000K.

Easy focus adjustment

When the focus adjustment switch [FOCUS ADJ. - ON/OFF] is set to ON, focus adjustment is possible in extreme environments with the iris opened. Enhanced focusing accuracy enables optimum focus to be obtained even in the dark.

Controls, connectors and indicators

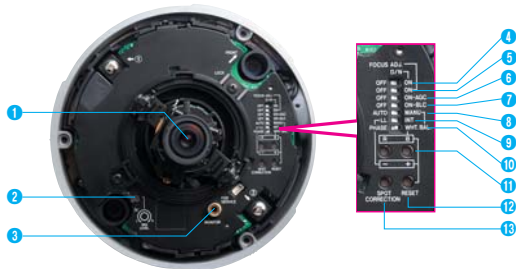

- 1 Camera head/lens
- 2 [IRIS LEVEL] Iris level adjustment volume
- 3 MONITOR terminal (RCA pin)
- 4 [D/N - ON/OFF] Easy day/night switch
- 5 [FOCUS ADJ. - ON/OFF] Focus adjustment switch
- 6 [AGC - ON/OFF] Auto gain control switch
- 7 [BLC - ON/OFF] Backlight compensation switch
- 8 [AUTO/MANU] Auto/Manual selection switch for white balance
- 9 [INT/LL] Synchronization system selection switch
- 10 [WHT.BAL/PHASE] Adjustment selection switch
- 11 [R/B, +/-] Adjustment button
- 12 [RESET] Reset button
- 13 [SPOT CORRECTION] White spot correction button

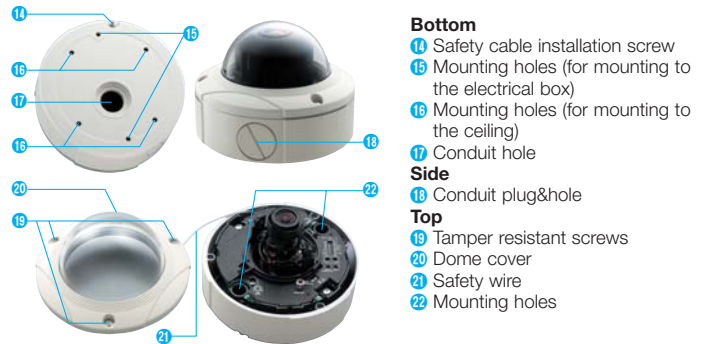

- Bottom**
- 14 Safety cable installation screw
- 15 Mounting holes (for mounting to the electrical box)
- 16 Mounting holes (for mounting to the ceiling)
- 17 Conduit hole
- Side**
- 18 Conduit plug&hole
- Top**
- 19 Tamper resistant screws
- 20 Dome cover
- 21 Safety wire
- 22 Mounting holes

KA-H205U Heater unit (option)



KA-H205U Heater unit (option) prevents condensation when operating at temperatures below freezing. When using the optional heater, the TK-C205VPU(A) must be powered from AC 24 V.

Specifications

CAMERA	
Signal system	NTSC
Image device	1/4" IT CCD
Number of effective pixels	380,000 pixels, 768 (H) x 494 (V)
Sync system	Internal, Line lock
Video S/N	50 dB (AGC off, typical)
Horizontal resolution	540 TV lines (typical)
Minimum illumination (Typical)	Color mode 0.9 lx F1.2, AGC on, 25IRE (25% video level) 2.0 lx F1.2, AGC on, 50IRE (50% video level) B&W mode 0.7 lx F1.2, AGC on, 25IRE (25% video level), Easy D/N 1.3 lx F1.2, AGC on, 50IRE (50% video level), Easy D/N
White balance	ATW/Manual (switchable)
ATW	Color temperature range (2,300K to 10,000K)
Backlight compensation	ON/OFF (switchable)

LENS	
Focal length	2.6 mm to 6 mm (variable)
Max. aperture ratio	F1.2 to F1.8
Angle of vision	f = 2.6 mm, 82° (H) x 59° (V) f = 6 mm, 35° (H) x 26° (V)
Angle adjustment range	Horizontal: 350°, Vertical: +80°, -50° Tilt: ±15°

GENERAL	
Power supply	AC 24 V (50/60 Hz), DC 12 V
Power consumption	4.2 W, 19.2 W (when using optional heater)
Weight	2.9 lbs. (1.3 kg)
Operating temperature	14° F to 122° F (-10° C to 50° C) 32° F to 104° F (0° C to 40° C) (recommended) 40° F to 122° F (-40° C to 50° C) with optional heater -22° F to 104° F (-30° C to 40° C) with optional heater (recommended)
Weather resistance	IP66, NEMA4
Regulatory standards	FCC Part 15, Class A, ICES-003, UL2044
Dimensions	ø6-5/16" x 4-9/16" (H) (ø160 mm x 115.2 mm (H))
Accessories	Instructions x 1, Instruction precautions x 1, Warranty card x 1, Service information card x 1, Wrench x 1, Silica gel x 1, Template x 1

Dimensions

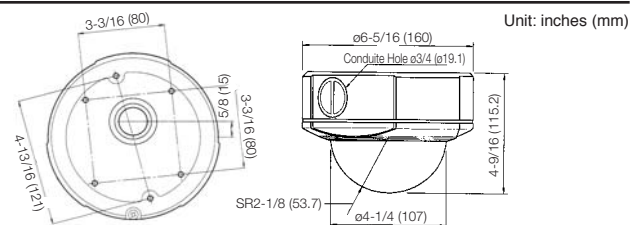

JVC®

DISTRIBUTED BY

Design and specifications subject to change without notice.

Free Manuals Download Website

<http://myh66.com>

<http://usermanuals.us>

<http://www.somanuals.com>

<http://www.4manuals.cc>

<http://www.manual-lib.com>

<http://www.404manual.com>

<http://www.luxmanual.com>

<http://aubethermostatmanual.com>

Golf course search by state

<http://golfingnear.com>

Email search by domain

<http://emailbydomain.com>

Auto manuals search

<http://auto.somanuals.com>

TV manuals search

<http://tv.somanuals.com>