

JVC**MICRO COMPONENT SYSTEM****UX-SG5B**

—consists of CA-UXSG5B and SP-UXSG5B

INSTRUCTIONS**MP3/WMA**LVT2114-015A[US/UB/A/UJ]
0310YAMMDWDAT

©2010 Victor Company of Japan, Limited

CAUTION: Proper Ventilation

To avoid risk of electric shock and fire, and to prevent damage, locate the apparatus as follows:

1. Front: No obstructions and open spacing.
2. Sides/Top/Back: No obstructions should be placed in the areas indicated by the dimensions in the illustration.
3. Bottom: Place on the level surface. Maintain an adequate air path for ventilation by placing on a stand with a height of 10 cm or more.

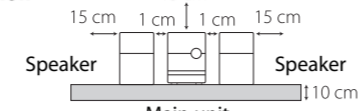
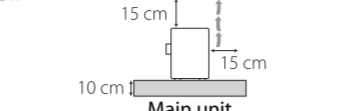
Front view**Side view****Maintenance**

To get the best performance of the System, keep your discs and the mechanism clean.

Handling discs

- Remove the disc from its case by holding it at the edge while pressing the center hole lightly.
- Do not touch the shiny surface of the disc, or bend the disc.
- Put the disc back in its case after use.
- Be careful not to scratch the surface of the disc when placing it back in its case.
- Avoid exposure to direct sunlight, temperature extremes, and moisture.

To clean the disc:

Wipe the disc with a soft cloth in a straight line from center to edge.

Cleaning the System

- Stains should be wiped off with a soft cloth. If the System is heavily stained, wipe it with a cloth soaked in water-diluted neutral detergent and wrung well, then wipe clean with a dry cloth.
- Since the System may deteriorate in quality, become damaged or get its paint peeled off, be careful about the following:
 - DO NOT wipe it hard.
 - DO NOT wipe it with thinner or benzine.
 - DO NOT apply any volatile substances such as insecticides to it.
 - DO NOT allow any rubber or plastic to remain in contact for a long time.

Specifications**Main unit (CA-UXSG5B)**

General
 • Power source: AC 110 V – 240 V, 50 Hz/60 Hz
 • Power consumption (in operation): 16 W
 • Power consumption (on standby): 1.00 W or less
 • Dimensions (W × H × D) [including projecting parts]: 165 mm × 250 mm × 226 mm

• Mass: 2.3 kg
 Audio output
 • Analog sound output:
 Speakers × 2
 Output power (IEC 268-3): 40 W (20 W + 20 W) at 6 Ω (10% THD)
 Fitting impedance: 6 Ω – 16 Ω

Audio input
 • Sound input:
 AUDIO IN × 1
 NORMAL: 500 mV/47 kΩ
 HIGH: 250 mV/47 kΩ
 iPod × 1: DC 5 V ≐ 500 mA
 USB

Compatible with USB 2.0 Full-Speed
 Compatible device: USB mass storage class device
 Compatible file system: FAT16, FAT32
 Output power: DC 5 V ≐ 500 mA

Tuner
 • FM tuner:
 Receiving frequency: 87.50 MHz to 108.00 MHz
 Antenna: 75 Ω - unbalanced type

Speaker (SP-UXSG5B)

• Type: Bass-reflex type
 • Speaker: Full range: 10 cm
 • Power handling capacity: 20 W
 • Impedance: 6 Ω
 • Dimensions (W × H × D) [including projecting parts]: 140 mm × 250 mm × 134 mm

• Mass (1 speaker): 1.3 kg

Supplied accessories

See "Supplied accessories" in "Getting started."

Design and specifications are subject to change without notice.

Getting started**Supplied accessories**

After unpacking, check to make sure that you have all the following items:

- Remote control (× 1)
- Lithium coin battery CR2025 (× 1)
 – The battery has been installed in the remote control when shipped from the factory.
- FM antenna (× 1)
- Composite video cord (× 1)
- AC plug adaptor (× 1) (not supplied for Australian and Hong Kong models)

If anything is missing, consult your dealer immediately.

In this manual...

- The remote control buttons are used for explaining the operations unless mentioned otherwise. However, if the System has the same or similar button names, they can also be used for the operations.
- "File" and "track" are used interchangeably.

Prepare the remote control

When you use the remote control for the first time, pull out the insulation sheet.

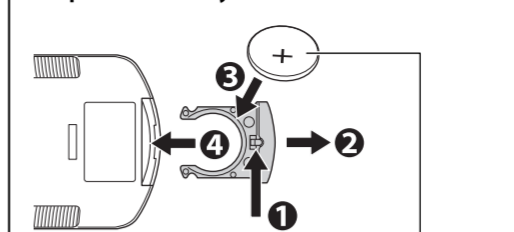
To replace the battery in the remote controlLithium coin battery
(product number: CR2025)**NOTES:**

- Store the battery in a place where children cannot reach. If a child accidentally swallows the battery, consult a doctor immediately.
- To prevent the battery from overheating, cracking, or starting a fire:
 - Do not recharge, short, disassemble or heat the battery or dispose of it in a fire.
 - Do not leave the battery with other metallic materials.
 - Wrap the battery with tape and insulate when throwing away or saving it.
 - Do not poke the battery with tweezers or similar tools.
- Dispose of battery in the proper manner, according to federal, state, and local regulations.
- The battery (battery pack or battery installed) shall not be exposed to excessive heat source such as sunshine, fire or the like.

CAUTION:

Danger of explosion if battery is incorrectly replaced. Replace only with the same or equivalent type.

Precautions**Notes on the power cord**

- When you go away for an extended period of time, remove the plug from the wall outlet.
- When unplugging the System from the wall outlet, always pull the plug, not the power cord.
- Do not handle the power cord with wet hands.
- Disconnect the power cord before cleaning the System or moving the System.
- Do not alter, twist or pull the power cord, or put anything heavy on it, which may cause fire, electric shock, or other accidents.

Avoid moisture, water, dust, and high temperatures

- Do not place the System in moist or dusty places.
- If water gets inside the System, turn off the power and remove the plug from the wall outlet, then consult your dealer. Using the System in this state may cause a fire or electrical shock.
- Do not expose the System to direct sunlight or place it near a heating device.

Notes on installation

- Select a place which is level, dry and neither too hot nor too cold—between 5°C and 35°C.
- Do not install the System in a place subject to vibrations.
- Do not put heavy objects on the System.

To prevent malfunction or damage to the System

- Do not insert any metallic objects, such as wires, hairpins, coins, etc. into the System.
- Do not block the vents.

There are no user-serviceable parts inside. If anything goes wrong, unplug the power cord and consult your dealer.

Do not connect the AC power cord until all other connections have been made.**Connections****NOTES:**

- Make sure the antenna conductors do not touch any other terminals, connecting cords or the power cord. Also, keep the antennas away from metallic parts of the System, connecting cords, and the AC power cord. Otherwise, it could cause poor reception.
- When connecting the speaker cords, match the polarities of the speaker terminals: red to (+) and black to (-).
- DO NOT connect more than one speaker to each terminal.
- Use only speakers with the same speaker impedance as indicated by the speaker terminals on the rear of the System.
- DO NOT allow the conductor of the speaker cords to come into contact with the metallic parts of the System.

Do not unplug the AC power cord before turning off the System. Some of the settings you have made will be lost if you do so.

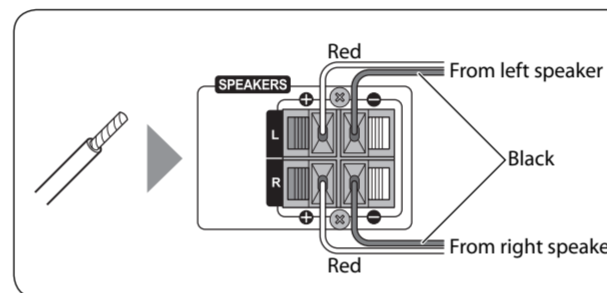

To a wall outlet
 • If a wall outlet does not match the AC plug, use the supplied AC plug adaptor (not supplied for Australian and Hong Kong models).

FM antenna (supplied): Extend it so that you can obtain the best reception.

For better FM reception
 Disconnect the supplied FM antenna, and connect to an outdoor FM antenna (not supplied) using a 75 Ω wire with coaxial type connector.

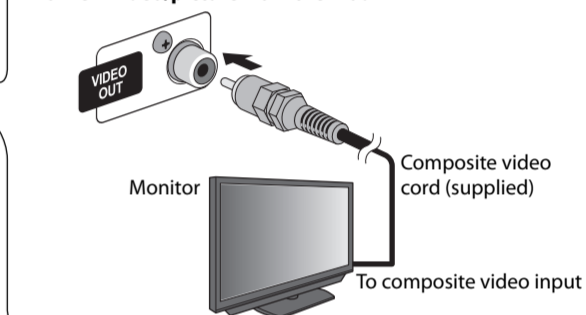
To view video/picture from the iPod**Compatible iPod models**

iPod model	Audio	Video
iPod nano	✓	–
iPod nano (2nd Generation)	✓	–
iPod nano (3rd Generation)	✓	✓
iPod nano (4th Generation)	✓	✓
iPod nano (5th Generation)	✓	✓
iPod mini	✓	–
iPod mini (2nd Generation)	✓	–
iPod (4th Generation)	✓	–
iPod classic	✓	✓
iPod photo (4th Generation)	✓	✓*
iPod video (5th Generation)	✓	✓
iPod touch	✓	✓
iPod touch (2nd Generation and Fall '09)	✓	✓

* Only for still picture

If iPod does not play correctly, update iPod software to the latest version.
 • For details about updating iPod, check on the Apple web site <<http://www.apple.com>>.

Playable disc/file types

- This System can play back...
 - Audio CD and CD-R/CD-RW in Audio CD format
 - MP3/WMA files on a CD-R/CD-RW (ISO 9660 format) or USB mass storage class device (maximum data transfer rate: 2 Mbps)
- This System cannot play "packet write" discs.
- This System can recognize up to 99 groups and 999 tracks on a disc and USB mass storage class device.
- For MP3/WMA playback...
 - Some MP3/WMA files may not be played back due to their recording conditions.
 - This System can play only discs of ISO 9660 Level 1 or Level 2.
 - It is recommended to record each file at a sampling rate of 44.1 kHz and at a data transfer rate of 128 kbps.
 - This System cannot play back files made at a bit rate of less than 64 kbps.
 - This System can show the Tag data.
- For playback of files on a USB mass storage class device...
 - You cannot play back files larger than 2 GB.
 - This System may not play back some USB mass storage class devices and does not support DRM (Digital Rights Management).

Troubleshooting

If you are having a problem with your System, check this list for a possible solution before calling for service.

General	
Power does not come on.	⇒ Power plug is not inserted securely. Plug it in securely.
Adjustments or settings are suddenly canceled before you finish.	⇒ There is a time limit. Start the procedure again.
Unable to operate the System from the remote control.	⇒ The path between the remote control and the remote sensor on the System is blocked. ⇒ The battery is exhausted.
No sound is heard.	⇒ Speaker connections are incorrect or loose. ⇒ Headphones are connected.
FM radio	
Hard to listen to broadcasts because of noise.	⇒ Antenna connection is incorrect or loose. ⇒ The FM antenna is not properly extended and positioned. ⇒ Electrostatic discharge from your body may cause noise. If this happens, turn the System off then on again.
iPod	
The iPod does not play, but "CONNECT" appears on the display.	⇒ The iPod battery is low or exhausted. Charge the iPod battery.
"PLEASE IPOD CHECK" appears on the display.	⇒ The iPod is not connected properly.
Disc/USB	
The disc/USB mass storage class device does not play.	⇒ The disc is placed upside down. Place the disc with the label side facing up. ⇒ The disc is recorded using "packet writing (UDF file system)." ⇒ The USB mass storage class device is not connected properly.
"NO FILE" appears on the display.	⇒ MP3/WMA files are not recorded on the disc or USB mass storage class device.
Groups and tracks are not played back as you expect.	⇒ Playing order is determined when the groups and tracks are recorded. It depends on the writing application.
The disc/USB mass storage class device sound is discontinuous.	⇒ The disc is scratched or dirty. ⇒ MP3/WMA files have not been properly recorded onto the USB mass storage class device.
Sound from the USB mass storage class device is interrupted.	⇒ Noise and static electricity may stop the sound. In this case, disconnect and connect the USB mass storage class device again after turning off the System.
The disc tray does not open or close.	⇒ The AC power cord is not plugged in. ⇒ Disc ejection is prohibited. "LOCKED" appears (see "Prohibiting disc ejection" in "Disc/USB" on page 2).
Timers	
Daily Timer does not work.	⇒ The System was turned on when the on-time came. The timer starts working only when the System is turned off. ⇒ When you unplug the AC power cord or if a power failure occurs, the timer will be canceled. You need to set the clock first, then the timer again. (See "Setting the clock" in "Initial settings" and "Daily Timer" in "Timers" on the right.)

- If the System does not work correctly, disconnect the AC power cord from the wall outlet, wait for a while, then connect the cord again.
- JVC bears no responsibility for any loss of data in USB mass storage class device or iPod while using this System.

Initial settings**Canceling the display demonstration**

When you plug in and turn on the System, the display demonstration starts automatically if no operation is done for about 2 minutes.

To cancel the display demonstration

(On the main unit)

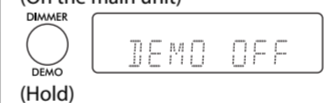
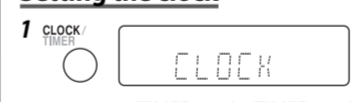
**Setting the clock**

Exit from the setting ← CLOCK ADJUST

"CLOCK" and "ADJUST" appear alternately.

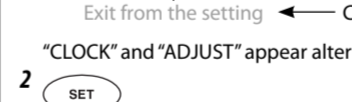

• To go back to the previous step, press CANCEL.

• The clock is not shown on the display until you set it.

• The clock may gain or lose 1 to 2 minutes per month. You may need to readjust the clock periodically.

Display settings**Display/illumination brightness**

You can dim the display window and illumination.

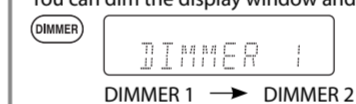
**Display information**

You can change the information shown on the display.

Ex.: During playback of a CD...

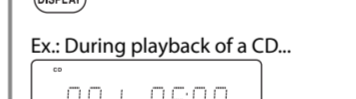

Current track's elapsed time ↔ Clock

• The information shown on the display differs depending on the source.

Sound adjustments**Fade muting**

To drop the volume in a moment

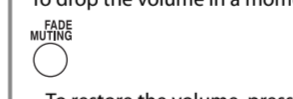

• To restore the volume, press again or adjust the volume level.

Sound Turbo

To emphasize the sound

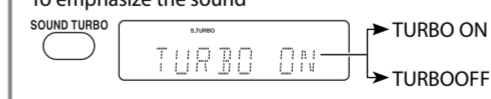

• To reinforce the bass sound

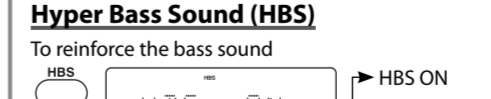

• To reinforce the bass sound

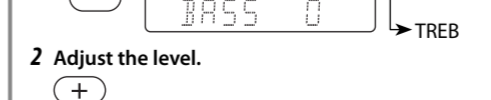

1 Adjust the level.

**Timers****Sleep Timer**

Specify the time (in minutes).



SLEEP 10 → SLEEP 20 → SLEEP 30 → ...

← SLEEPOFF ← SLEEP180 ←

• To check the remaining time until the System shuts off, press SLEEP once.

• To check the remaining time until the System shuts off, press SLEEP once.

• The STANDBY lamp starts flashing.

• While on standby, the timer indicator (⊙) is not displayed.

Daily Timer

By using Daily Timer, you can wake up with your favorite music.

• Set the clock before using Daily Timer (see "Setting the clock" in "Initial settings").

• You can store three Daily Timer settings.

• Tune into a station, insert a disc, or connect a USB mass storage class device/iPod to the System beforehand.

• The timer indicator is turned off.

• The timer contents are kept.

• Press TIMER repeatedly to exit from the setting.

1 Select a Daily Timer number.



Exit from the setting ← CLOCK ADJUST

2 SET

3 Set the timer contents.



– Hour and minute for the on-time and off-time

– Playback source

• For "TUNER FM": Select a preset number. (To preset stations, see "Presetting stations" in "FM radio" on page 2).

• For "CD" or "USB": Select a track number. (For MP3/WMA: Select a group, then a track number.)

– Volume

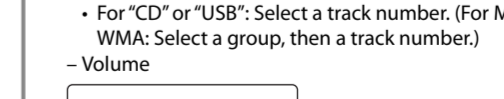

• To correct a misentry during the process, press CANCEL. You can return to the previous step.

4 Press TIMER repeatedly to exit from the setting.

5 Turn off the System.

The STANDBY lamp starts flashing.

• While on standby, the timer indicator (⊙) is not displayed.

• The timer indicator is turned off.

• The timer contents are kept.

• Press TIMER repeatedly to exit from the setting.

• Press TIMER repeatedly to exit from the setting.

• Press TIMER repeatedly to exit from the setting.

• Press TIMER repeatedly to exit from the setting.

• Press TIMER repeatedly to exit from the setting.

• Press TIMER repeatedly to exit from the setting.

• Press TIMER repeatedly to exit from the setting.

• Press TIMER repeatedly to exit from the setting.

• Press TIMER repeatedly to exit from the setting.

• Press TIMER repeatedly to exit from the setting.

• Press TIMER repeatedly to exit from the setting.

• Press TIMER repeatedly to exit from the setting.

• Press TIMER repeatedly to exit from the setting.

• Press TIMER repeatedly to exit from the setting.

• Press TIMER repeatedly to exit from the setting.

• Press TIMER repeatedly to exit from the setting.

• Press TIMER repeatedly to exit from the setting.

• Press TIMER repeatedly to exit from the setting.

• Press TIMER repeatedly to exit from the setting.

• Press TIMER repeatedly to exit from the setting.

• Press TIMER repeatedly to exit from the setting.

• Press TIMER repeatedly to exit from the setting.

• Press TIMER repeatedly to exit from the setting.

• Press TIMER repeatedly to exit from the setting.

• Press TIMER repeatedly to exit from the setting.

• Press TIMER repeatedly to exit from the setting.

• Press TIMER repeatedly to exit from the setting.

• Press TIMER repeatedly to exit from the setting.

• Press TIMER repeatedly to exit from the setting.

• Press TIMER repeatedly to exit from the setting.

• Press TIMER repeatedly to exit from the setting.

• Press TIMER repeatedly to exit from the setting.

• Press TIMER repeatedly to exit from the setting.

• Press TIMER repeatedly to exit from the setting.

• Press TIMER repeatedly to exit from the setting.

Basic operation

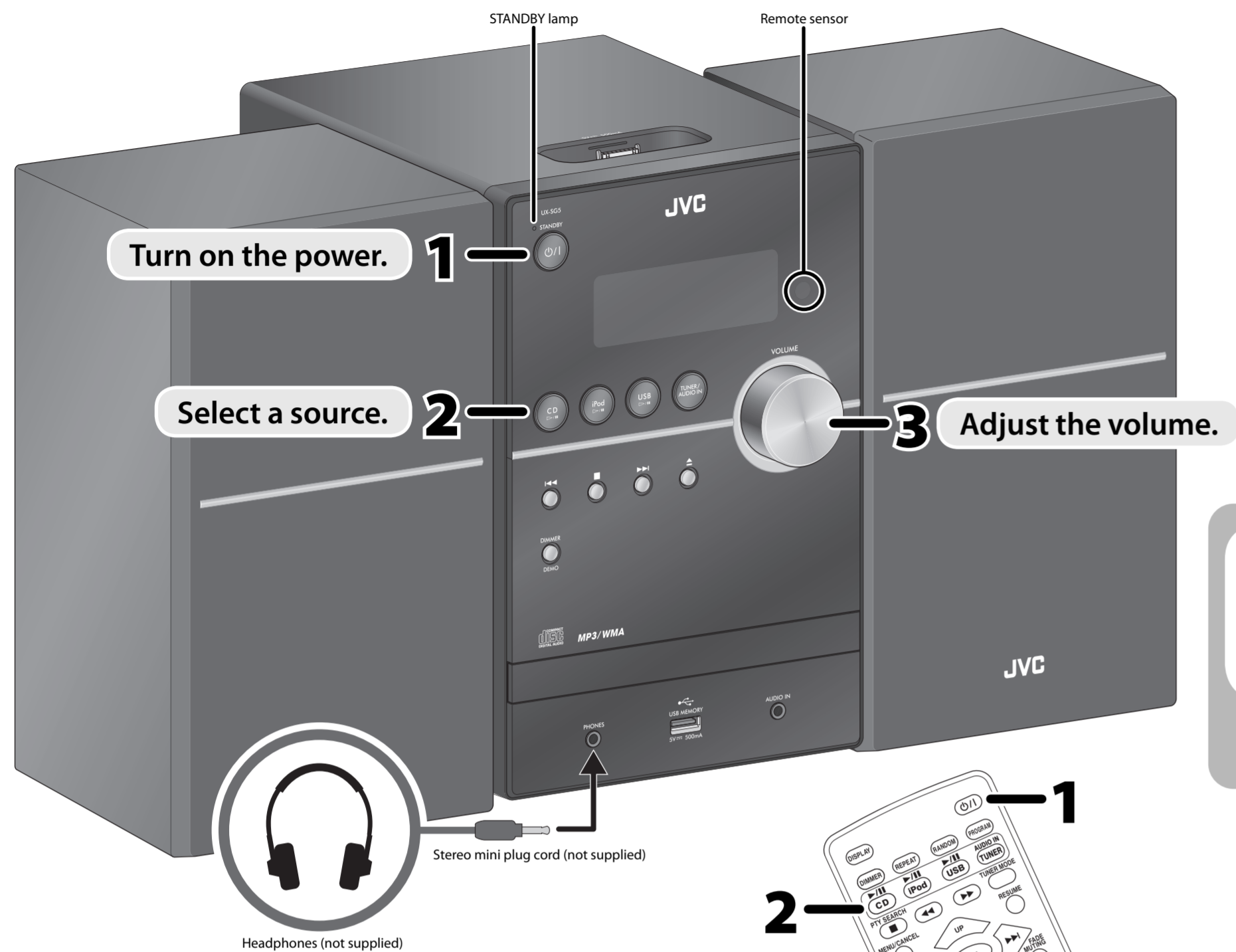

The HP indicator lights up when headphones are connected to the System.
 • Be sure to turn down the volume before connecting or putting on the headphones.

DO NOT turn off the System with the volume set to an extremely high level; otherwise, the sudden blast of sound may damage your hearing, speakers, and headphones when you turn on the System or start playback.

FM radio

Searching for stations

- 1** AUDIO IN (TUNER) TUNER FM TUNER FM ↔ AUDIO IN
- 2** (Hold) (Hold)

The station search stops when a station of sufficient signal strength is found.

- To manually stop the search, press ►► or ◀◀.
- When you press ►► or ◀◀ repeatedly, the frequency changes step by step.
- When an FM program is broadcast in stereo, the S (stereo) indicator lights up.

Improving the reception

To improve the reception

TUNER MODE MONO STEREO

MONO ↔ STEREO

- When the monaural mode is activated, the stereo effect is lost.

Presetting stations

You can preset up to 30 FM stations.

While listening to a target station...

- 1** SET 01-87.50
- 2** Select a preset number. UP DOWN
- 3** SET

To erase a preset station

- 1** Tune in to a preset station (see below).
- 2** MENU/CANCEL 01-87.50
- 3** SET

Tuning in to a preset station

UP DOWN

iPod

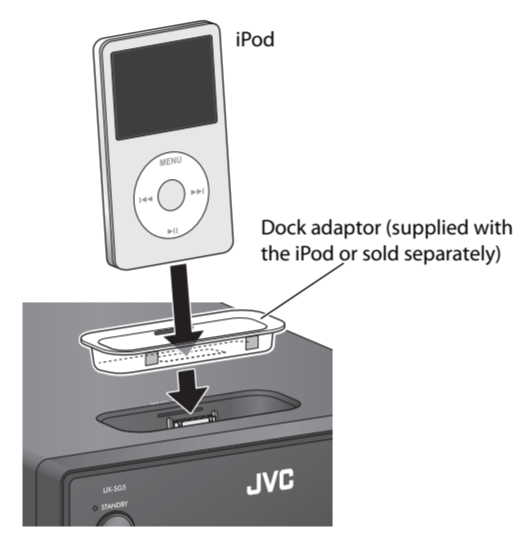

Notes on iPod connection

- When detaching the dock adaptor from the dock, pull up the dock adaptor with your fingernail or sharp pointed tool using the slot.
- Be careful not to injure your fingertips or damage the terminal of the direct dock.
- DO NOT connect or disconnect the iPod when the System is turned on.
- Be sure to reduce the volume on the System to the minimum level before connecting iPod. Adjust the volume after starting playback.
- You cannot send any data to the iPod from the System.
- Do not carry the System with iPod connected. It might cause damage to the dock or you might drop the iPod.
- Do not touch or hit the iPod terminal pins or connector pins in the dock for iPod directly. Doing so might cause damage to the connector pins.
- iPod is charged through the dock when the System is turned on.

Before viewing a video/picture from your iPod on your monitor:
 Make the appropriate video setting on iPod. For details of the setting, see the instruction manual for iPod.

Playback operations

►/|| (iPod) IPOD

* Information shown on the display differs depending on the type of the iPod.

To play back/pause iPod
 Press iPod ►/||.

To select a track
 Press ►► or ◀◀.

To fast-forward a track
 Press and hold ►►.

To fast-reverse a track:
 Press and hold ◀◀.

To play back at random
 Press RANDOM repeatedly.

To play back repeatedly
 Press REPEAT repeatedly.

To put iPod in sleep mode
 Press and hold iPod ►/||.

Menu operations

To display the menu/to go back to the previous menu
 MENU/CANCEL

To select an item on the menu
 UP DOWN SET

Notes:

- Operate iPod touch itself in the following cases:
 - When operating the home button.
 - When selecting application icons on the home screen.
 - When dragging the slider.
- Sound distortion may occur when playing back audio sources with high recording levels. If distortion occurs, it is recommended to turn off the equalizer of iPod. For information on operating the iPod, see the instruction manual for iPod.

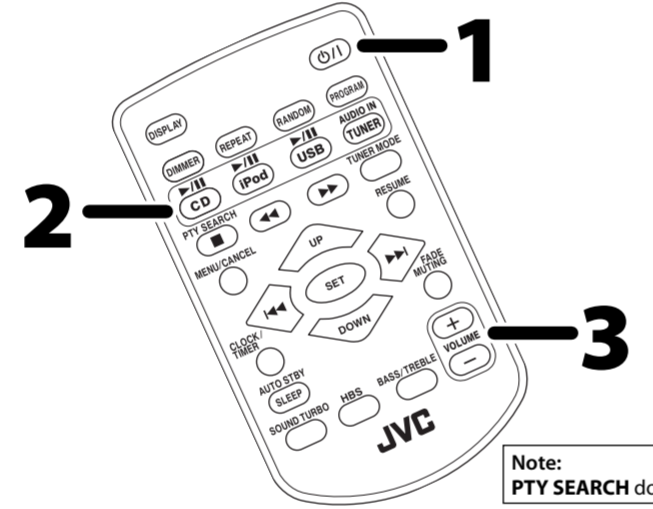

External device

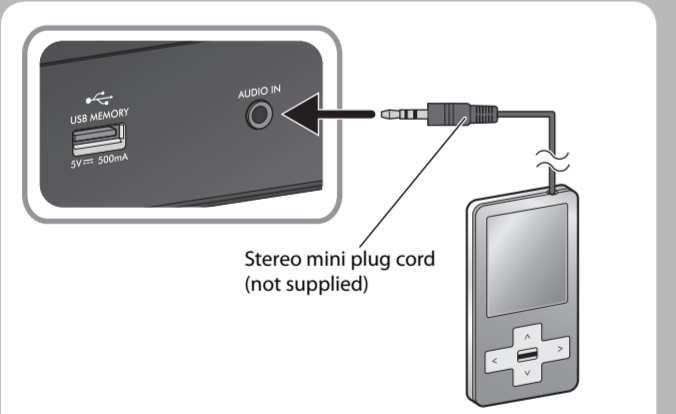

Playback operation

- 1** AUDIO IN (TUNER) AUDIO IN TUNER FM ↔ AUDIO IN
- 2** Start playback of the external device.

Adjusting the audio input level

You can change the audio input level through the AUDIO IN jack.

SET HIGH NORMAL

HIGH ↔ NORMAL

- This function affects only the sound coming out through the speakers.

Disc/USB

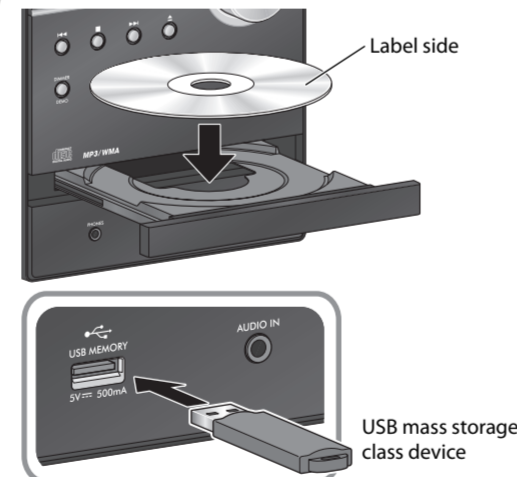

Notes on USB mass storage class device connection

- Connect a USB mass storage class device when the System is turned off to prevent malfunction.
- Do not use a USB hub.
- When connecting with a USB cable, use a USB 2.0 cable whose length is less than 1 m.
- The USB mass storage class device is charged through the USB MEMORY terminal when "USB" is selected as the source.
- You cannot connect a computer to the USB MEMORY terminal of the System.
- Electrostatic shock at connecting a USB mass storage class device may cause abnormal playback of the device. In this case, disconnect the USB mass storage class device then reset the System and the USB mass storage class device.
- While playing back a file on a USB mass storage class device, do not disconnect the device. Doing so may cause malfunction on both the System and the device.

Playback operations

►/|| CD CD

►/|| USB USB

To open the disc tray
 Press ▲ on the main unit.

To play back/pause a disc
 Press CD ►/||.

To play back/pause a USB mass storage class device
 Press USB ►/||.

To select a track
 Press ►► or ◀◀.

To fast-forward a track
 Press and hold ►►.

To fast-reverse a track
 Press and hold ◀◀.

To select a group
 Press UP or DOWN.

To stop playback
 Press ■.

Repeat Play

REP TRK	1	Repeats the current track.
REP GRP	ALL	Repeats all tracks in the current group (MP3/WMA only).
REP ALL	ALL	Repeats all tracks.
REP OFF	Off	Cancels.

Random Play

RND GRP	RND	Plays tracks in the current group in a random order (MP3/WMA only).
RND ALL	RND ALL	Plays all tracks in a random order.
RND OFF	Off	Cancels.

Program Play

While playback is stopped...

- 1** (PROGRAM) P-01
- 2** Select a track number (up to 32 tracks). ◀◀ ►► SET
- 3** ►/|| (CD) or ►/|| (USB)

- To cancel, press CANCEL.
- To check the programmed contents, press ◀◀ or ►►.
- To erase the entire program, press and hold CANCEL. The PRGM indicator is turned off.
- To exit from Program Play, press ■. The PRGM indicator is turned off. The stored program is kept.

Resume Play

This System stores the beginning of the stopped track.

RESUME RESUME RESUME

When you start playback again, it starts from the beginning of the stored track.

- To clear the stored position, perform one of the following operations:
 - Press ■ twice.
 - Open the disc tray.
 - Disconnect the USB mass storage class device.
- This function cannot be used for Program Play.

Prohibiting disc ejection

You can lock the disc tray.

While the System is on standby...

(On the main unit)

LOCKED UNLOCKED

(While holding...)

Free Manuals Download Website

<http://myh66.com>

<http://usermanuals.us>

<http://www.somanuals.com>

<http://www.4manuals.cc>

<http://www.manual-lib.com>

<http://www.404manual.com>

<http://www.luxmanual.com>

<http://aubethermostatmanual.com>

Golf course search by state

<http://golfingnear.com>

Email search by domain

<http://emailbydomain.com>

Auto manuals search

<http://auto.somanuals.com>

TV manuals search

<http://tv.somanuals.com>