

Bagless Vacuum Cleaner

Aspirador sin bolsa

USK VC 2
120V~ 1200W

OPERATING INSTRUCTIONS

IMPORTANT SAFEGUARDS

When using your appliance, basic safety precautions should always be followed, including the following:

READ ALL INSTRUCTIONS

WARNING: To reduce the risk of fire, electric shock or injury:

1. Do not leave appliance when plugged in. Unplug from outlet when not in use and before servicing.
2. Check that your mains voltage corresponds to that stated on the rating plate of the appliance before using the appliance.
3. Do not use outdoors or on wet surfaces.
4. Do not allow to be used as a toy. Close supervision is necessary when used by or near children.
5. Use only as described in this manual. Use only manufacturer's recommended attachments.
6. Do not use with damaged cord or plug. If appliance is not working as it should, has been dropped, damaged, left outdoors, or dropped into water, return it to a service center.
7. Do not pull or carry by the cord, use the cord as a handle, close a door on the cord, or pull the cord around sharp edges or corners. Do not run the appliance over the cord. Keep the cord away from heated surfaces.
8. Do not unplug by pulling on the cord. To unplug, grasp the plug, not the cord.
9. Do not handle the plug or appliance with wet hands.
10. Do not put any object into openings. Do not use with any opening blocked; keep free of dust, lint, hair, and anything that may reduce airflow.
11. Keep hair, loose clothing, fingers, and all parts of body away from openings and moving parts.

12. Do not pick up anything that is burning or smoking, such as cigarettes, matches, or hot ashes.
13. Do not use the vacuum cleaner without filters or dust container in place.
14. Turn off all controls before unplugging.
15. Use extra care when cleaning on stairs.
16. Do not use to pick up flammable or combustible liquids such as gasoline or use in areas where they may be present.
17. Keep the end of the hose, wands and other openings away from your face and body.
18. Always unplug this appliance before connecting or disconnecting the hose.
19. Hold the plug when rewinding onto the cord reel. Do not allow the plug to whip when rewinding.
20. Store the vacuum cleaner indoors. Put the vacuum cleaner away after use to prevent tripping accidents.
21. Use only on dry, indoor surfaces.

SAVE THESE INSTRUCTIONS

POLARIZED PLUG INSTRUCTIONS

This appliance has a polarized plug (one blade is wider than the other). To reduce the risk of electric shock, this plug will fit into the polarized outlet only one way. If the plug does not properly fit into the outlet at first, reverse it. If it still does not fit, contact a competent qualified electrician. **Do not attempt to modify the plug in any way.**

PARTS

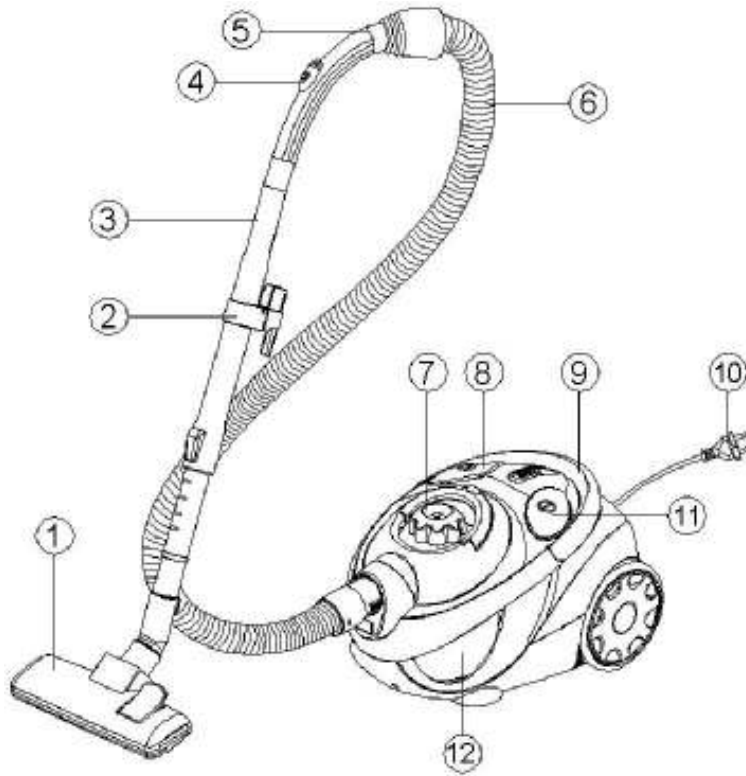

1. Floor brush
2. Tool holder
3. Telescopic tube
4. Wind force adjuster
5. Handle
6. Hose
7. Dust level indicator
8. Cord rewind button
9. Carrying handle
10. Power cord
11. ON/OFF switch
12. Dust container

ASSEMBLING THE VACUUM CLEANER

- Unpack the appliance and its accessories.
- Insert the connection piece of the flexible hose into hose connection inlet on the front part of the appliance. Press until it clicks.



- To remove the hose, unplug the appliance first. Press the release buttons on the hose connection piece and pull the hose out of the connection inlet.
- Fit the handle to the telescopic tube

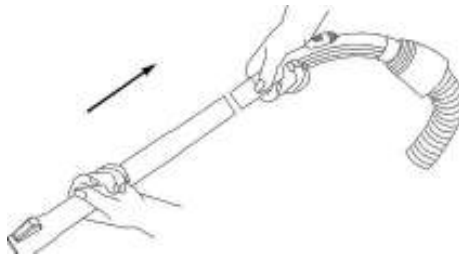

- Fit the floor brush to the other end of the telescopic tube.

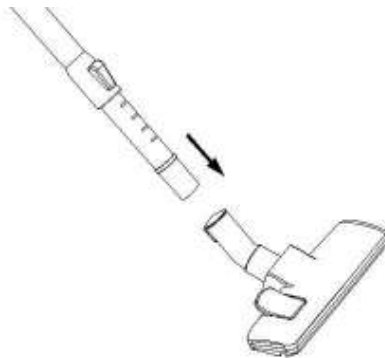

Crevice tool and small brush

Free Manuals Download Website

<http://myh66.com>

<http://usermanuals.us>

<http://www.somanuals.com>

<http://www.4manuals.cc>

<http://www.manual-lib.com>

<http://www.404manual.com>

<http://www.luxmanual.com>

<http://aubethermostatmanual.com>

Golf course search by state

<http://golfingnear.com>

Email search by domain

<http://emailbydomain.com>

Auto manuals search

<http://auto.somanuals.com>

TV manuals search

<http://tv.somanuals.com>