

KAMBROOK

THE SMARTER CHOICE



**Hot Cup
Rapid Boil**

Suits all KQK600 models

2400W

Rapid Boil

KAMBROOK RECOMMENDS SAFETY FIRST

At Kambrook, we believe that safe performance is the first priority in any consumer product, so that you, our valued customer can confidently use and trust our products. We ask that any electrical appliance that you use be operated in a sensible fashion with due care and attention placed on the following important operating instructions.

IMPORTANT SAFEGUARDS FOR YOUR KAMBROOK HOT CUP

- Carefully read all instructions before operating the Kambrook HOT CUP for the first time and save for future reference.
- Remove and safely discard any packaging material and promotional labels before using the kettle for the first time.
- To eliminate a choking hazard for young children, remove and safely discard the protective cover fitted to the power plug of this appliance.
- The appliance should always be placed on a firm level surface where normal access from persons (including children) with reduced physical, sensory or mental capabilities is restricted.
- This kettle has been designed specifically for the purpose of boiling drinking quality water only. Under no circumstances should this product be used to boil any other liquids or foodstuffs.
- Do not place the kettle near the edge of a bench or table during operation. Ensure that the surface is level, clean and free of water and other substances.
- Do not operate the Hot Cup on a sink drain board.
- Do not place the Hot Cup on or near a hot gas burner, electric element or where it could touch a heated oven.
- Keep the Hot Cup clear of walls, curtains and other heat or steam sensitive materials. Minimum 20cm distance.
- Always ensure the Hot Cup is properly assembled before use. Follow the instructions provided in this book.
- The Hot Cup must be used only with the power base supplied.
- The Hot Cup is not intended to be operated by means of an external timer or separate remote control system.
- Do not touch hot surfaces. Use the handle for lifting and carrying the kettle.
- Do not place anything on top of the lid.
- Always switch the power off at the power outlet and remove the power plug from the power outlet before attempting to move the appliance, when the appliance is not in use and before cleaning and storing.
- Do not place hand under the spout of the kettle during operation.
- Use caution when hot water is flowing out from the spout of the kettle, as boiling water and steam will scald.
- This kettle dispenses 250ml of hot water continuously per operation.
- It is not possible to interrupt and stop the hot water flowing out from the dispensing spout once one cup of water (250ml) has boiled. Therefore, you **MUST** ensure that a vessel/cup is capable of holding a minimum of 280ml capacity and is placed under the dispensing spout of the kettle on the drip tray. Do not overfill the cup as the water is very hot.
- It is recommended that a vessel/cup capable of accommodating a minimum of 280ml of very hot water is placed under the dispensing spout at all times to capture the dispensed water should the unit be inadvertently turned on.
- To protect against electric shock, do not immerse the Hot Cup base, power base, power cord or power plug in water or allow moisture to come in contact with these parts.
- Do not remove the Hot Cup from the power base during operation. Ensure the kettle has switched off after the water has boiled before removing the kettle from the power base.

- Do not move the Hot Cup while it is switched on.
- Do not open the lid during operation.
- Keep the Hot Cup clean. Follow the cleaning instructions provided in this book.

IMPORTANT SAFEGUARDS FOR ALL ELECTRICAL APPLIANCES

- Fully unwind the power cord before use.
- Do not let the power cord hang over the edge of a bench or table, touch hot surfaces or become knotted.
- To protect against electric shock do not immerse the power cord, power plug or appliance in water or any other liquid.
- This appliance is not intended for use by persons (including children) with reduced physical, sensory or mental capabilities, or lack of experience and knowledge, unless they have been given supervision or instruction concerning use of the appliance by a person responsible for their safety.
- Children should be supervised to ensure that they do not play with the appliance.
- It is recommended to regularly inspect the appliance. To avoid a hazard do not use the appliance if power cord, power plug or appliance becomes damaged in any way. Return the entire appliance to the nearest authorised Kambrook Service Centre for examination and/or repair.
- Any maintenance other than cleaning should be performed at an authorised Kambrook Service Centre.
- This appliance is for household use only. Do not use this appliance for anything other than its intended use. Do not use in moving vehicles or boats. Do not use outdoors. Misuse may cause injury.
- The installation of a residual current device (safety switch) is recommended to provide additional safety protection when using electrical appliances. It is advisable that a safety switch with a rated residual operating current not exceeding 30mA be installed in the electrical circuit supplying the appliance. See your electrician for professional advice.

⚠ DO NOT OPERATE THE HOT CUP ON AN INCLINED SURFACE. DO NOT MOVE THE KETTLE WHILE IT IS SWITCHED ON.

KNOW YOUR KAMBROOK RAPID BOIL



- 1 Illuminated power ON/OFF switch
- 2 Lid release button
- 3 Water chamber
- 4 1.5L capacity
- 5 2400 Watt concealed element boils 250ml of water in under 60 seconds.
- 6 Removable drip tray and cover
- 7 Dispensing spout
- 8 Power base

OPERATING INSTRUCTIONS

OPERATING YOUR KAMBROOK HOT CUP

BEFORE FIRST USE

Remove any packaging material and promotional labels before using your kettle for the first time.

IT IS RECOMMENDED WITH DUE CARE AND ATTENTION PLACED ON THE FOLLOWING PRECAUTIONS BEFORE OPERATING THE HOT CUP.

⚠ WARNING: THIS KETTLE DISPENSES 250ML OF HOT WATER CONTINUOUSLY PER OPERATION.

IT IS NOT POSSIBLE TO INTERRUPT AND STOP THE HOT WATER FLOWING OUT FROM THE DISPENSING SPOUT ONCE ONE CUP OF WATER (250ML) HAS BOILED. THEREFORE, YOU MUST ENSURE THAT A VESSEL/CUP IS CAPABLE OF HOLDING A MINIMUM OF 280ML CAPACITY AND IS PLACED UNDER THE DISPENSING SPOUT OF THE KETTLE ON THE DRIP TRAY. DO NOT OVERFILL THE CUP AS THE WATER IS VERY HOT.

THE APPLIANCE SHOULD ALWAYS BE PLACED ON A FIRM LEVEL SURFACE WHERE NORMAL ACCESS FROM PERSONS (INCLUDING CHILDREN) WITH REDUCED PHYSICAL, SENSORY OR MENTAL CAPABILITIES IS RESTRICTED.

IT IS RECOMMENDED THAT A VESSEL/CUP CAPABLE OF ACCOMMODATING A MINIMUM OF 280ML OF VERY HOT WATER IS PLACED UNDER THE DISPENSING SPOUT AT ALL TIMES TO CAPTURE THE DISPENSED WATER SHOULD THE UNIT BE INADVERTENTLY TURNED ON.

It is recommended that before the first use to fill the kettle to the maximum level with cold tap water, carry out several boil cycles discarding the water each time from a vessel/cup capable of holding a minimum of 280ml capacity. Then, discard the water inside the water chamber as following.

EMPTYING YOUR RAPID BOIL

1. After the Hot Cup has completely cooled down, unplug it from the mains supply socket.
2. Press the lid release button.
3. Hold your kettle sideways over a sink.
4. Then, tip the Hot Cup upside down.
5. Still holding the Hot Cup over the sink, turn it the right side up and allow any water to drain out of the spout.

6. Repeat steps 3, 4 and 5 until the water has been emptied from the Hot Cup.

Your kettle will only operate when positioned on the power base with the ON/OFF switch in the ON position. The kettle will automatically switch off once the water has boiled.

Note: The maximum capacity of the Kettle is 1.5L.

OPERATION OF YOUR KETTLE

1. To fill the kettle with water, remove it from the power base and open the lid by pressing the lid release button. The lid will automatically open.
2. Fill with the desired amount of water. Do not operate the kettle without water. Always fill the kettle between the minimum and the maximum marks on the water window. Too little water will result in the kettle switching off.
3. Ensure that the lid is closed and locked firmly into place before placing the kettle on the power base. Place the kettle firmly onto the power base. Plug the power cord into 230/240V power outlet and switch 'ON'.
4. Press the ON/OFF switch to the 'ON' position. The power 'ON' light will illuminate.

Note: In choosing the size of vessel/cup, it is recommend the capacity is not less than 280ml, make sure the vessel/cup is positioned in place before using. Do not overfill the cup.

5. The kettle will switch off automatically once one cup of water (250ml) has boiled.
6. The hot water will flow out from the spout under 60 seconds. Before removing cup, make sure the water flow has ceased.

Note: The water flowing out from spout is hot and contact with the hot water may result in scalding. Therefore, this appliance should not be used by children.

If you want to boil water again, simply press the power ON/OFF switch to 'ON' position again.

If further heating of the kettle is not required, switch off at the power outlet, unplug the power cord and empty the water from the kettle. Replace the kettle onto the power base and close the lid.

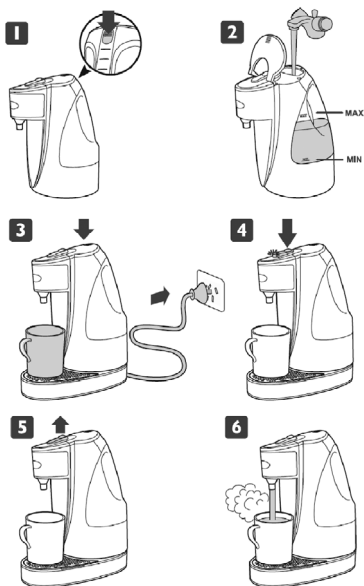

SAFETY BOIL DRY PROTECTION

The Hot Cup is fitted with a safety device, which protects against overheating should the appliance be operated with insufficient water. If this occurs the Hot Cup will stop heating and the illuminated light on the power on/off switch will go out. Switch off at the power outlet and allow the kettle to cool before refilling. Remove the Hot Cup from the power base and add cold water. Return the Hot Cup to the power base. The safety device will then automatically reset.

⚠ IMPORTANT: IF YOUR HOT CUP WILL NOT BE USED FOR AN EXTENDED PERIOD (E.G. IF YOU ARE ON HOLIDAY), WE RECOMMEND THAT YOU FIRST EMPTY IT. FOLLOW THE EMPTYING YOUR RAPID BOIL ON PAGE 5 BEFORE USING THE HOT CUP AGAIN, CARRY OUT SEVERAL BOIL CYCLES DISCARDING THE WATER EACH TIME. THIS SHOULD PREVENT ANY BAD SMELL OR TASTE FROM WATER THAT MAY HAVE RESIDED IN THE UNIT OVER THE EXTENDED PERIOD OF NON USE.

NOTE: Never operate the Hot Cup dry - too little water will result in the Hot Cup switching "OFF". Do not overfill the Hot Cup - filling above the maximum mark on the water window may result in water splashing from the kettle.

NOTE: The Hot Cup must only be used with the power base supplied.

NOTE: Do not remove the Hot Cup from the power base during operation. Ensure the Hot Cup has switched to 'OFF' position after the water flow has ceased before removing the vessel/cup.

⚠ CAUTION: THIS APPLIANCE IS DESIGNED FOR THE BOILING OF DRINKING QUALITY WATER ONLY, NEVER USE IT TO HEAT OR BOIL ANY OTHER LIQUIDS OR FOODSTUFFS. THE LID SHOULD ALWAYS BE FIRMLY IN PLACE AND LOCKED CLOSED BEFORE USE.

CARE AND CLEANING

Always switch off at the power outlet, and then unplug the appliance from the power outlet before cleaning.

Note: Ensure the kettle and water have cooled down before attempting to clean the kettle.

REMOVAL OF MINERAL DEPOSITS

Mineral deposits in tap water may cause the interior and water gauge to discolour over time. This may be removed by the following way.

1. Fill the Hot Cup until $\frac{2}{3}$ full with 1 part vinegar and 2 parts water. Mix them in a vessel before pouring into the water chamber of the Hot Cup. Boil and allow to stand overnight.
2. Empty the solution from the Hot Cup. Fill with clean water, bring to boil and discard the water. Repeat and the Hot Cup will be ready for use.

TO CLEAN THE EXTERIOR

The outside of the Hot Cup may be wiped over with a damp cloth and polished with a soft, clean dry cloth.

Empty the drip tray. Wash the drip tray and drip tray cover in warm soapy water. Rinse and dry thoroughly before placing them back to the power base.

Note: Do not use kettle descaler, chemical, steel wool, or abrasive cleaners to clean the inside or outside of the Hot Cup.

STORAGE

Ensure the kettle is switched off, cleaned and dried before storing. Ensure that the lid is closed and locked securely into place. Wrap the power cord around the cord storage under the power base. Stand the kettle upright on the power base. Do not store anything on top.

⚠ WARNING: TO PREVENT DAMAGE TO THE APPLIANCE, DO NOT USE ALKALINE CLEANING AGENTS WHEN CLEANING. USE A SOFT CLOTH AND MILD DETERGENT.

⚠ WARNING: NEVER IMMERSE THE HOT CUP BASE, SWITCH AREA, POWER BASE OR POWER SUPPLY CORD IN WATER, OR ALLOW MOISTURE TO COME IN CONTACT WITH THESE PARTS.



KAMBROOK 12 MONTH REPLACEMENT WARRANTY

Kambrook warrants the purchaser against defects in workmanship and material for a period of 12 months from the date of purchase (3 months commercial use).

Guarantee and purchase receipt for this product are to be retained as proof of purchase and must be presented if making a claim under the Kambrook guarantee.

Kambrook reserves the right to replace or repair the appliance within the warranty period.

Warranty does not apply to any defect, deterioration, loss, injury or damage occasioned by, or as a result of the misuse or abuse, negligent handling or if the product has not been used in accordance with the instructions. The guarantee excludes breakages and consumable items such as kneading blades.

This warranty is void if there is evidence of the product being tampered with by unauthorised persons.

If the product includes one or a number of accessories only the defective accessory or product will be replaced. In the event of Kambrook choosing to replace the appliance, the guarantee will expire at the original date, i.e. 12 months from the original date of purchase.

In Australia, this KAMBROOK Guarantee is additional to the conditions and guarantees which are mandatory as implied by the Trade Practises Act 1974 and State and Territory legislation.

For service, spare parts or product information in Australia, please call KAMBROOK on the Customer Service Line; 1300 139 798.

For service, spare parts or product information in New Zealand, please call KAMBROOK on the Customer Service Line; 0800 273 845 or 09 271 3980.

If claiming this guarantee the product must be returned freight prepaid.

KAMBROOK 12 MONTH REPLACEMENT WARRANTY

YOUR PURCHASE RECORD (Please complete)

Attach a copy of the purchase receipt here.

DATE OF PURCHASE

MODEL NUMBER

SERIAL NUMBER

PURCHASED FROM

(Please don't return purchase record until you are making a claim)

Register your warranty at www.kambrook.com.au/service.asp



Kambrook - Australia

Building 2, Port Air Industrial Estate
1A Hale Street
Botany NSW 2019
Australia
Customer Service Line 1300 139 798
Customer Service Fax 1800 621 337

Kambrook - New Zealand

Private Bag 94411
Botany, Manukau
Auckland 2163
New Zealand
Customer Service Line/Spare Parts 0800 273 845
or 09 271 3980
Customer Service Fax 0800 288 513

Due to continual improvement in design or otherwise, the product you purchase may differ slightly from the illustration in this book. Issue 1/09

Free Manuals Download Website

<http://myh66.com>

<http://usermanuals.us>

<http://www.somanuals.com>

<http://www.4manuals.cc>

<http://www.manual-lib.com>

<http://www.404manual.com>

<http://www.luxmanual.com>

<http://aubethermostatmanual.com>

Golf course search by state

<http://golfingnear.com>

Email search by domain

<http://emailbydomain.com>

Auto manuals search

<http://auto.somanuals.com>

TV manuals search

<http://tv.somanuals.com>