

Kawasaki™

8" BENCH DRILL PRESS

INSTRUCTION MANUAL

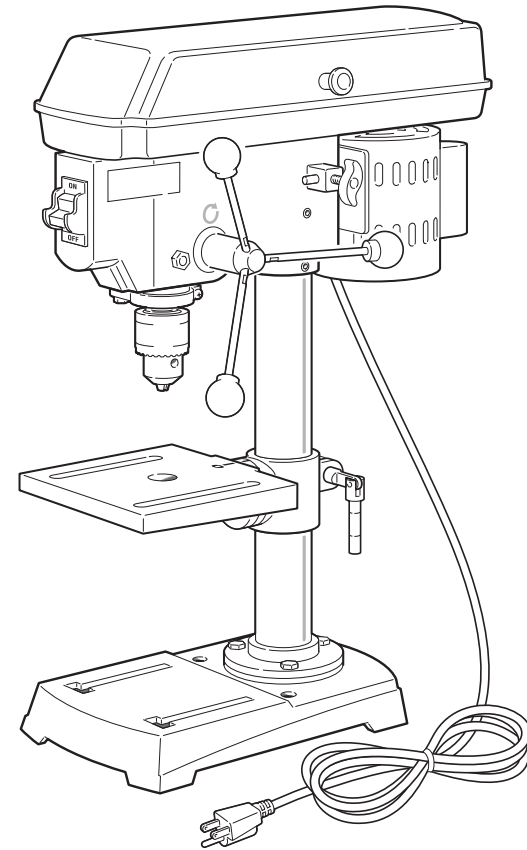

THIS MANUAL CONTAINS IMPORTANT INFORMATION REGARDING SAFETY, OPERATION, MAINTENANCE AND STORAGE OF THIS PRODUCT. BEFORE USE, READ CAREFULLY AND UNDERSTAND ALL CAUTIONS, WARNINGS, INSTRUCTIONS AND PRODUCT LABELS. FAILURE TO DO SO COULD RESULT IN SERIOUS PERSONAL INJURY AND/OR PROPERTY DAMAGE.

IF YOU SHOULD HAVE ANY QUESTIONS OR EXPERIENCE A PROBLEM WITH YOUR ALLTRADE PRODUCT, DO NOT RETURN THIS PRODUCT TO THE STORE. PLEASE CALL OUR CUSTOMER SERVICE DEPARTMENT AT **1-800-590-3723**. BEFORE YOU CALL, HAVE THE FOLLOWING INFORMATION AVAILABLE: MODEL No., DATE PURCHASED AND STORE LOCATION. AN ALLTRADE REPRESENTATIVE CAN RESOLVE YOUR PROBLEM OVER THE PHONE. IF YOU WOULD LIKE TO MAKE A SUGGESTION OR COMMENT, GIVE US A CALL OR EMAIL US AT: INFO@ALLTRADETOOLS.COM. YOUR FEEDBACK IS VITAL TO US.

Kawasaki™

Kawasaki Motors Corp., U.S.A.

OFFICIAL • LICENSED • PRODUCT

57-1904-00957

KAWASAKI™ IS A TRADEMARK LICENSED BY KAWASAKI™ MOTORS CORP., U.S.A., WHICH DOES NOT MANUFACTURE OR DISTRIBUTE THIS PRODUCT. CONSUMER INQUIRES SHOULD BE DIRECTED TO:

©COPYRIGHT 2005 ALLTRADE TOOLS, LLC.

1431 VIA PLATA
LONG BEACH, CA 90810-1462 USA

840116 - 8" Bench Drill Press_Rev 11/13/06

FOR CUSTOMER SERVICE
POUR LE SERVICE APRÈS VENTE
OU DU CONSOMMATEUR
PARA EL SERVICIO
PARA EL CONSUMIDOR
1-800-590-3723

Printed in China

TABLE OF CONTENTS

CONGRATULATIONS!	2
INTENDED USE	2
SECTION ONE	
RECOGNIZE SAFETY SYMBOLS, WORDS AND LABELS	2-3
IMPORTANT SAFEGUARDS	3
SECTION TWO	
GENERAL SAFETY RULES – FOR ALL ELECTRIC POWER TOOLS	4-5
GROUNDING INSTRUCTIONS	5-6
EXTENSION CORD USAGE	6
IMPORTANT SAFETY RULES FOR DRILL PRESSES	7-10
SYMBOLS	10
SECTION THREE	
FUNCTIONAL DESCRIPTION	11
ASSEMBLY	12-16
INSTALLING THE COLUMN ASSEMBLY TO THE BASE	13
INSTALLING THE WORK TABLE	13
INSTALLING THE DRILL PRESS HEAD	13
INSTALLING HANDLES	14
INSTALLING DRILL CHUCK	14-15
REMOVING AND INSTALLING DRILL BITS	15
MOUNTING THE DRILL PRESS	16
LASER GUIDE	16-18
LASER SAFETY	16-17
OPERATING THE LASER	17-18
OPERATING THE DRILL PRESS	19-25
OPERATING THE ON/OFF SWITCH	19
ADJUSTING THE WORKTABLE	20
TILTING THE WORKTABLE	21
ADJUSTING THE DRILL PRESS SPINDLE SPEED	21-22
DRILLING HOLES TO SPECIFIED DEPTHS	22-23
ADJUSTING THE SPINDLE RETURN SPRING	23-24
CORRECT DRILLING SPEEDS	24
WORKING WITH WOOD	24
DRILLING METAL	25

SECTION FOUR

MAINTENANCE AND CLEANING	25
ACCESSORIES	25-26
SPECIFICATIONS	26
OTHER CONSUMER DO-IT-YOURSELF (DIY) TOOLS	27

SECTION FIVE

2 YEAR LIMITED WARRANTY	27-30
-------------------------------	-------

CONGRATULATIONS!

Thanks for choosing this product. At Alltrade, our aim is to provide you with quality products at an affordable price, and we want you to be totally satisfied with your product and our Customer Service. If any help and advice is needed, please contact us at 1-800-590-3723. Properly cared for, this product will give you many years of satisfaction.

INTENDED USE

This product is intended for consumer use only. This tool is not designed for professional use. The power cord should only be used in approved electrical outlets as described in this manual. Failure to use the proper power cords and/or extension cords may result in fire or possible damage to the drill press.

RECOGNIZE SAFETY SYMBOLS, WORDS AND LABELS



WARNING **READ AND UNDERSTAND ALL INSTRUCTIONS.** Failure to follow all instructions in this manual may result severe in personal injury or death. Keep this manual and refer to it for Safety Instructions, Operating Procedures and Warranty.

The safety instructions provided in this manual are not intended to cover all possible conditions and practices that may occur when operating, maintaining and cleaning power tools.

Always use common sense and pay particular attention to all the **DANGER**, **WARNING**, **CAUTION** and **NOTE** statements of this manual.



This is the safety alert symbol. It is used to alert you to potential personal injury hazards. Obey all safety messages that follow this symbol to avoid possible injury or death.



DANGER indicates an imminently hazardous situation which, if not avoided, will result in death or serious injury.

⚠ WARNING

WARNING indicates a potentially hazardous situation which, if not avoided, could result in death or serious injury.

⚠ CAUTION

CAUTION indicates a potentially hazardous situation which, if not avoided, may result in minor or moderate injury.

CAUTION

CAUTION used without the safety alert symbol indicates a potentially hazardous situation which, if not avoided, may result in property damage.

NOTE

NOTE provides additional information that is useful for proper use and maintenance of this tool. If a NOTE is indicated make sure it is fully understood.

IMPORTANT SAFEGUARDS

⚠ DANGER

People with electronic devices, such as pacemakers, should consult their physician(s) before using this product. Operation of electrical equipment in close proximity to a heart pacemaker could cause interference or failure of the pacemaker.

WARNING: Some dust created by power sanding, sawing, grinding, drilling and other construction activities contains chemicals known to the State of California to cause cancer, birth defects or other reproductive harm.

Some examples of these chemicals are:

- Lead from lead-based paints.
- Crystalline silica from bricks and cement and other masonry products, and arsenic and chromium from chemically-treated lumber.

Your risk from these exposures varies, depending on how often you do this type of work. To reduce your exposure to these chemicals: work in a well ventilated area, and work with approved safety equipment, such as dust masks that are specially designed to filter out microscopic particles.

WARNING: Handling the power cord on corded products may expose you to lead, a chemical known to the State of California to cause cancer and birth defects or other reproductive harm. *Wash hands after handling.*

SAVE THESE INSTRUCTIONS FOR FUTURE REFERENCE.

GENERAL SAFETY RULES – FOR ALL ELECTRIC POWER TOOLS

⚠ WARNING

READ AND UNDERSTAND ALL INSTRUCTIONS. Failure to follow all instructions listed below may result in electric shock, fire and/or serious personal injury.

KEEP GUARDS IN PLACE AND IN WORKING ORDER.

REMOVE ADJUSTING KEYS AND WRENCHES. Form a habit of checking to see that keys and adjusting wrenches are removed from the tool before turning it on.

KEEP WORK AREA CLEAN. Cluttered areas and benches invite accidents.

DO NOT USE TOOL IN A DANGEROUS ENVIRONMENT. Do not use power tools in damp or wet locations, or expose them to rain. Keep work area well lit.

KEEP CHILDREN AWAY. All visitors should be kept a safe distance from the work area.

MAKE YOUR WORKSHOP CHILD PROOF, with padlocks, master switches, or by removing starter keys.

DO NOT FORCE TOOL. The correct tool will do the job better and safer at the rate for which it is designed.

USE THE CORRECT TOOL FOR YOUR APPLICATION. Do not force tool or attachment to do a job for which it was not designed.

ALWAYS USE SAFETY GLASSES. Also use a face mask or dusk mask if cutting operation is dusty. Everyday eyeglasses only have impact lenses, they are **NOT** safety glasses.

SECURE WORK. Use clamps or other practical ways to secure and support the workpiece to a stable platform. Holding the work by hand or against your body is unstable and may lead to loss of control.

DO NOT OVERREACH. Keep proper footing and balance at all times. Proper footing and balance enables better control of the power tool in unexpected situations.

MAINTAIN TOOLS WITH CARE. Keep tools sharp and clean for best and safest performance. Follow instructions for lubricating and changing accessories.

NEVER LEAVE TOOL RUNNING UNATTENDED. TURN POWER OFF. Don't leave tool until it comes to a complete stop.

DISCONNECT TOOLS before servicing and when changing accessories, such as blades, bits, cutters and the like.

⚠ WARNING

REDUCE THE RISK OF UNINTENTIONAL STARTING. Be sure switch is in the "OFF" position before plugging in.

USE RECOMMENDED ACCESSORIES. Consult the owners manual for recommended accessories. The use of improper accessories may cause cause risk of injury.

NEVER STAND ON TOOL. Serious injury could occur if the tool is tipped or if the cutting tool is unintentionally contacted.

CHECK DAMAGED PARTS. Before further use of the tool, a guard or other part that is damaged should be carefully checked to determine that it will operate properly and perform its intended function. Check for alignment of moving parts, binding of moving parts, breakage of parts, mounting and any other conditions that may affect its operation. A guard or other part that is damaged should be properly repaired or replaced.

DIRECTION OF FEED. Only feed work into a blade or cutter against the direction of rotation of the blade or cutter.

GROUNDING INSTRUCTIONS

⚠ WARNING NEVER use appliances or equipment that have motors with automatic reset overload protective devices. These protective devices can cause unexpected startups that can cause property damage, severe personal injury, or death.

The electrical power source for this drill press **MUST** be grounded in order to prevent possible electric shock or even death should the tool malfunction or break down. Grounding provides a path of least resistance for electric current thus reducing the risk of electrical shock. **The power source must also use a minimum 20A service.** Multiple power tools should never be used on the same circuit at the same time.

⚠ WARNING Failure to properly ground this drill press could result in burns, severe electrical shock, and even death. This is especially true if used in damp or wet locations or near metallic plumbing. The reaction from electrical shock could possibly cause your hands to make contact with the cutting tools.

⚠ CAUTION Not all outlets are properly grounded, regardless of the type of receptacle they have. If you are not sure if the receptacle is properly grounded or not, consult a certified electrician. The AC receptacle must be protected by a dual element time delay or a circuit breaker.

This drill press is equipped with a grounded 3-wire power cord with a 3-prong plug. If the power cord will not fit into the wall plug, an approved adapter can be used as long as it is connected to the center screw in the wall plate. See Figure 1 and the steps below to use an AC grounding adapter:

1. Remove the cover plate mounting screw.
2. Insert the AC grounding adapter into the bottom receptacle so the green grounding lug fits over the screw hole.
3. Install the mounting screw back into the cover plate securely affixing the adapter to the receptacle.

⚠ WARNING Never modify the electrical adapter by cutting off the grounding prong so it will fit into unapproved, un-grounded electrical receptacles. Failure to follow this procedure could result in burns, severe electrical shock, or even death.

If you have questions about connecting the drill press, contact a certified electrician to install the proper circuitry needed for this and other power tools you use.

Repair or replace any damaged electrical wiring **IMMEDIATELY.**

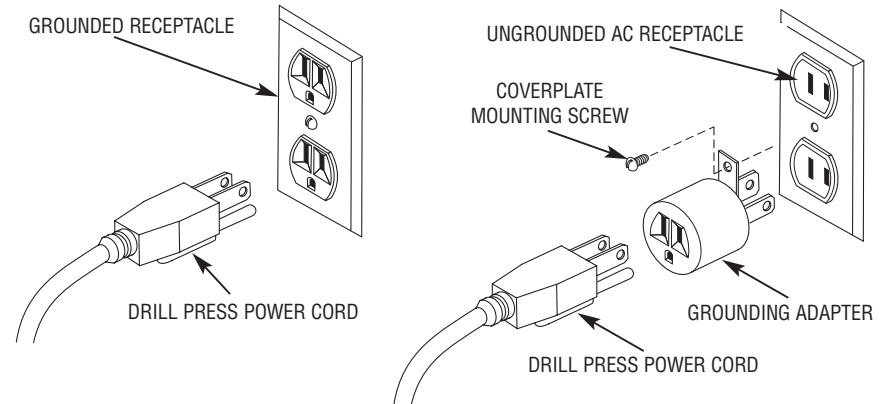

FIGURE 1. CONNECTING THE DRILL PRESS TO THE AC POWER RECEPTACLE

EXTENSION CORD USAGE

Extension cords are not recommended for use with this drill press. Extension cords, if used, must be properly grounded with a 3-prong plug on one and a 3-hole receptacle on the other. **DO NOT use grounding adapters with an extension cord.** Extension cords must be UL listed and use a minimum of 18 A.W.G. wiring. Extension cords should never exceed 25 feet in length. Extension cords, that are too long, cause a voltage drop over the extra distance causing the grinder motor to run slower with the possibility of causing damage to the motor. Using extension cords with smaller than the recommended wire gauge run the risk of getting too hot, melting, and/or causing fires. See table, "Extension Cord Specifications", on page 25-26.

IMPORTANT SAFETY RULES FOR DRILL PRESSES

WARNING

READ AND UNDERSTAND ALL INSTRUCTIONS. If there are instructions in this manual that are not completely understood, seek the advice of a trained professional or contact Alltrade Customer Service at 1-800-590-3723 before attempting to perform the procedures. Failure to follow all instructions listed in this manual may result in property damage, damage to the tool, or serious personal injury or even death.

DO NOT OPERATE THIS DRILL PRESS until it is completely assembled according to the instructions in this manual. Failure to adhere to these instructions could result in serious and/or permanent injury to the operator.

FOLLOW ALL WIRING CODES. Use only properly grounded three-hole grounded receptacles. **DO NOT** cut the third prong off the power cord. When using an extension cord, use only UL Listed extension cords with minimum 16 AWG wiring and a maximum length of 25 feet. See **ELECTRICAL SAFETY** section in this manual.

MAKE SURE APPROVED EYE PROTECTION IS BEING WORN and properly adjusted and secured at all times the drill press is in use. Everyday eyeglasses only have impact resistant lenses and **ARE NOT** safety glasses. Safety glasses must conform to **ANSI Z87.1** requirements. Approved safety glasses and goggles will have Z87 printed or stamped on them.

KEEP BYSTANDERS, CHILDREN, AND VISITORS at a safe distance from the drill press while it is in operation. Distractions can cause inadvertent misuse resulting in possible injury to the bystanders or to the operator.

WEAR PROPER APPAREL. Do not wear loose clothing, gloves, neckties, rings, bracelets, or other apparel that could possibly become caught in the moving parts of the drill press. When working in a shop environment around power tools, wear nonslip footwear. Use protective hair covering to contain long hair.

KEEP THE WORK AREA CLEAN AT ALL TIMES. Cluttered areas around the drill press can cause unexpected accidents if the debris comes in contact with the moving parts of the drill press.

MAINTAIN A PROPER WORK ENVIRONMENT. Do not operate the drill press in damp or wet locations or expose it to rain. Water can cause the electrical components to malfunction resulting in damage to the drill press and/or serious injury or death to the operator.

ALWAYS USE APPROVED TABLE CLAMPS AND VICES to clamp work pieces to the drill press table to prevent breakage, damage to the drill press, the work piece, and possible severe injury to the operator. **Contact Alltrade Customer Service at 1-800-590-3723 (toll free) for authorized accessories.**

WARNING

USE ONLY DRILL BITS, SANDING DRUMS, AND OTHER ACCESSORIES that are designed for the various speeds of this drill press. The drill bits, sanding drums and other accessories should have a shank size **1/2" OR SMALLER**. Unsuitable drill bits can break without warning throwing fragments outward at high speeds possibly causing severe injuries. Contact Alltrade Customer Service at 1-800-590-3723 (toll free) for authorized drill bit specifications.

USE RECOMMENDED SPEED for drill accessory and workpiece material.

DO NOT FORCE THE TOOL. The drill press will do a better job and be safer if drilling operations are performed at the proper speeds as expressed in this manual.

USE ONLY THE CHUCK KEY THAT IS PROVIDED with the drill press or a duplicate of it to reliably secure the drill bit inside the chuck.

REMOVE CHUCK KEYS AND OTHER ADJUSTMENT TOOLS from the areas around the drill press before turning the power switch to the "ON" position.

DO NOT USE A DRILL BIT THAT WOBBLER OR VIBRATES. Visually inspect the drill bits before they contact the work piece ensuring there are no side-to-side movements. Should the drill bit wobble from side-to-side or if the tip appears broken, **replace them immediately**. If the vibration still exists, check the bearings and the motor shaft and repair or replace them as soon as possible. **EXCESSIVE VIBRATION** can cause severe damage to both the work piece and the drill press.

ADJUST THE TOOL TABLE BEFORE EACH USE. The tool table should be tightened and placed at the proper angle for the drilling job before the drill press is put into use. If not properly adjusted, the work piece can unexpectedly move causing the drill bit to seize resulting in damage to it or possible severe injury to the operator.

DO NOT STAND DIRECTLY IN FRONT OF THE DRILL PRESS when it is first turned on. Loose fragments could fly off at high speeds possibly causing injury.

PROPERLY SUPPORT EXTRA LONG OR EXTRA WIDE WORK PIECES. Work pieces that are too long or too wide can tip and cause the drill bit to seize resulting in a sudden whipping motion resulting in damage to the work piece and drill press as well as possible severe injury to the operator.

NEVER START THE DRILL PRESS WITH THE WORK PIECE IN CONTACT WITH THE DRILL BIT. The sudden start-up of the drill bit could cause it to seize resulting in a sudden, rapid spinning motion that could damage the work piece, the drill press, and/or serious injury to the operator.

⚠ WARNING

DISCONNECT THE DRILL PRESS POWER CORD FROM THE AC OUTLET before making adjustments to the worktable, clamps, vises, work pieces, changing drill bits, or changing the speed of the drill motor preventing the tool from accidentally turning on. Failure to adhere to this step could result in damage to both the work piece and the drill press as well as possible severe injury to the operator.

THOROUGHLY CLEAN THE DRILL PRESS before changing types of work pieces. Combining wood and metal dust can result in an explosion or fire. **CONSULT EXPERT** advice before drilling in work pieces made of magnesium. The friction generated by the drill bit could the magnesium to ignite resulting in a very intense fire that could cause severe burns to the operator and/or seriously damage the drill press.

NEVER PERFORM DRILLING OPERATIONS NEAR FLAMMABLE GAS OR LIQUIDS. The resulting fire and/or explosion could cause permanent serious injuries to the operator and damage to the drill press and surrounding work area.

ALWAYS KEEP ARMS, HANDS, AND FINGERS away from the work piece while it is on the table and the drill press is turned on. Severe injury could result.

ALWAYS CLAMP THE WORK PIECE FIRMLY AGAINST THE WORK TABLE. Never attempt to hold the workpiece by hand. The drill bit can seize in the work piece causing it to spin rapidly. This will cause loss of control of the work piece resulting in severe injuries or damage to the work piece and drill press.

NEVER APPLY A COOLANT directly to the work piece while it is in contact with the drill bit. Coolant can weaken the makeup of the drill bits causing them to fail.

NEVER PERFORM LAYOUT OR ASSEMBLY to work pieces in front of the drill press while it is still running. A sudden slip could bring hands in contact with the moving parts of the drill press resulting in injury to the operator.

REDUCE THE RISK OF UNINTENTIONAL STARTING. Ensure the “ON/OFF” switch is set to the “OFF” position before plugging the power cord into the AC outlet.

TURN THE ON/OFF SWITCH on the drill press to the “OFF” position and unplug the power cord from the electrical receptacle when the drilling operations are finished. Thoroughly clean the area surrounding the drill press making it ready for the next use.

NEVER LEAVE THE DRILL PRESS RUNNING UNATTENDED. when finished with a drilling operation, turn “off” the drill press and wait until it comes to a complete stop.

⚠ WARNING





SECURE THE ELECTRICAL POWER CORD when the drill press is not in use to prevent unauthorized use of the tool and/or to prevent children from accidentally turning it on.

ADDITIONAL INFORMATION about the proper use of bench-mounted drill presses is available from the Power Tool Institute, 1300 Sumner Avenue, Cleveland, OH 44115-2851 (www.powertoolinstitute.com). Information is also available from the National Safety Council, 1121 Spring Lake Drive, Itasca, IL 60143-3201. Additionally, you can refer to the American National Standards Institute (ANSI) 01.1 Safety Requirements for Woodworking Machines and the U.S. Department of Labor OSHA 1910.213 Regulations.

USE COMMON SENSE WHEN OPERATING THIS DRILL PRESS OR OTHER POWER TOOLS. Never try to perform drilling operations on work pieces that are too large to be clamped to the worktable or vises. Keep this manual and refer to it often to ensure proper operation and prevent unnecessary accidents or injuries.

SYMBOLS

IMPORTANT: Some of the following symbols may be used on your tool. Please study them and learn their meaning. Proper interpretation of these symbols will allow you to operate the tool better and safer.

SYMBOL	NAME	EXPLANATION
V	Volts	Voltage (Potential)
A	Amperes	Current
Hz	Hertz	Frequency (Cycles per Second)
W	Watt	Power
Kg	Kilograms	Weight
	Alternating Current	Type of Current
	Direct Current	Type of Current
	Alternating or Direct Current	Type of Current
	Earthing Terminal	Grounding Terminal
	Class II Construction	Denotes Double Insulation
min	Minutes	Time
s	Seconds	Time
φ	Diameter	Size of Drill Bits, Grinding Wheels, etc.
n_0	No load speed	No-load Rotational Speed
.../min	Revolutions per Minute	Revolutions, Surface Speed, Strokes, etc. per Minute
1,2,3, ...	Ring Selector Settings	Speed, Torque or Position Settings

FUNCTIONAL DESCRIPTION

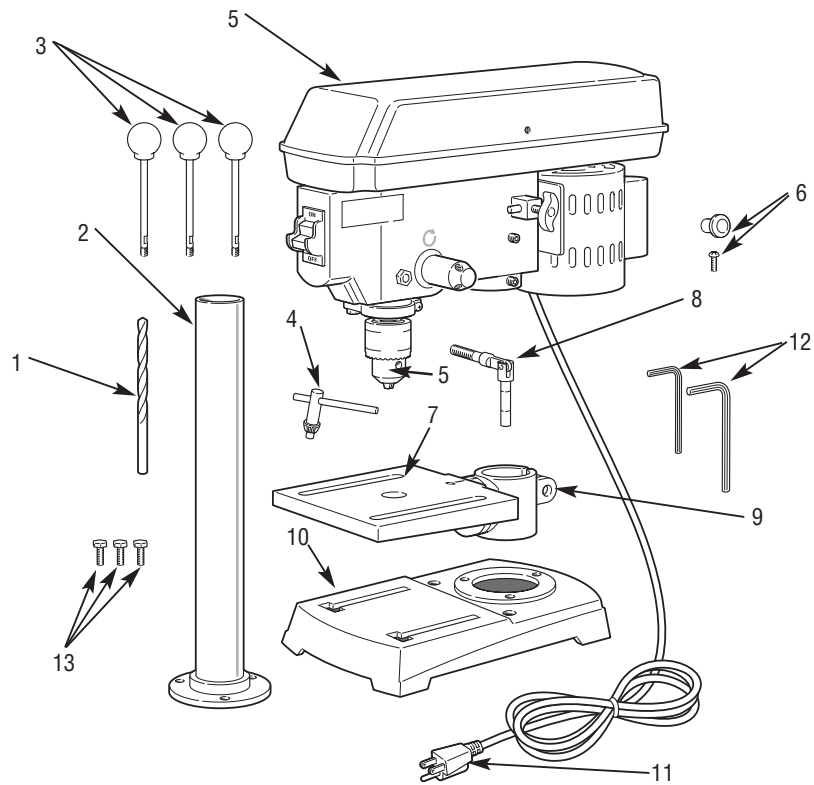

CONTROLS AND COMPONENTS:

- | | |
|----------------------------|----------------------------------|
| 1. Drill Bit | 8. Table Support Lock Assembly |
| 2. Column Assembly | 9. Work Table Clamp |
| 3. Feed Handles | 10. Column Base |
| 4. Chuck Key | 11. Grounded Power Cord |
| 5. Drill Chuck | 12. Hex Wrenches |
| 5. Head Assembly | 13. Column Assembly mtg Hardware |
| 6. Knob (and mtg Hardware) | |
| 7. Work Table | |

ASSEMBLY

⚠ CAUTION

Do not begin assembly of Bench-mounted Drill Press if the AC power cord is plugged into an AC power receptacle.

Do not begin assembly of Bench-mounted Drill Press if power switch on the front of the base is switched to the "ON" position.

INSPECTION: Carefully inspect each individual part of the drill press to ensure there are no cracked, broken, or bent components.

1. Carefully choose a location for the bench-mounted drill press. If mounted on a workbench, ensure there is adequate room all around the drill press for safe operation. The area must be level and clear of other power tools and/or power tool cords that could interfere with operation of the drill press.
2. If the drill press is installed on a universal tool stand (available at larger hardware stores), ensure there is plenty of unobstructed space around the drill press as not to interfere with safe operation on the tool.
3. Use clamps or a vise to hold workpiece securely in place.
4. The drill press should be installed in a place that is away from outside elements and close to an approved power receptacle so that an extension cord will not be needed. Should an extension cord be needed, refer to Page 25 in this manual for choosing the proper length and wire gauge needed for safe operation of the drill press.
5. Do not assemble and/or use the drill press in an area that may be contaminated with oily rags. Keep flammable materials such as gasoline, paint thinner or solvents. Sparks from normal drilling operations can ignite these compounds resulting in moderate to severe burns to the operator.

INSTALLING THE COLUMN ASSEMBLY TO THE BASE

1. Place the base (1) on a firm level surface.
2. Secure the column assembly (2) to the base (A) using the three hex-head screws (3) provided. See Figure 2.

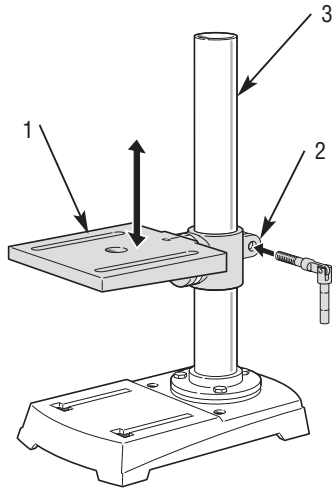
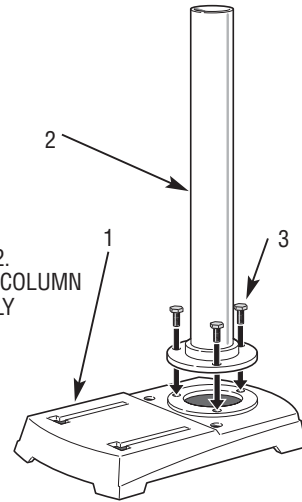

FIGURE 3.
INSTALLING THE WORK TABLE

FIGURE 2.
ATTACHING THE COLUMN ASSEMBLY



INSTALLING THE WORK TABLE

1. Slide the worktable (1) and table clamp bracket (2) onto the column assembly (3).
2. Install the support lock handle (4) into the clamp bracket (2).
3. Position the worktable to the desired height and tighten the support lock handle (4).

INSTALLING THE DRILL PRESS HEAD

1. Place the drill press head (1) onto the column assembly (2). Press the drill press head (1) downward on the column assembly (2) as far as it will go.
2. Align the drill press head (1) with the worktable (3) and the base.
3. Tighten the two head locking screws (4) as shown in Figure 4, with the hex-wrench (5) supplied.

FIGURE 4.
INSTALLING THE DRILL PRESS AND MOTOR

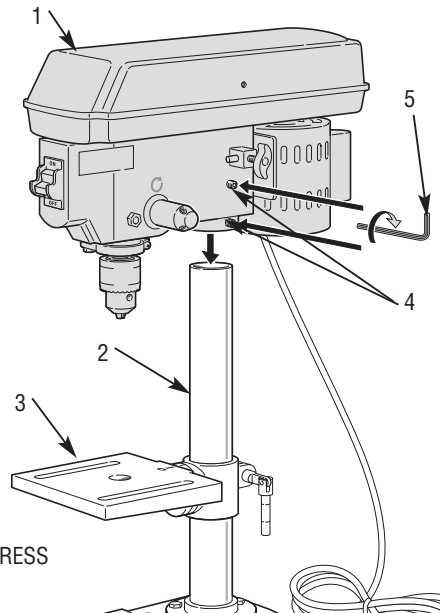

13

CAUTION

Ensure the spindle taper (Q) and the tapered hole in the drill chuck (R) are clean and free of any grease, lacquer, or rust preventative coatings. These compounds can cause the drill chuck (R) to seize when installed on the spindle shaft (Q).

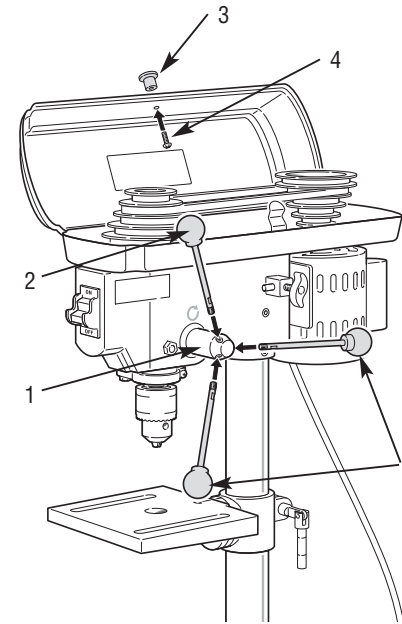

FIGURE 5.
INSTALLING HANDLES

INSTALLING HANDLES

1. Insert the three drill press feed handles (2) into the tapped holes on the pinion shaft (1). See Figure 5.
2. Using a Phillips screwdriver, insert screw (4) into knob (3) and install it on the drill press cover.

INSTALLING THE DRILL CHUCK

1. Open the jaws of the drill chuck (1) as wide as possible by turning the chuck sleeve (2).
2. Holding the drill chuck (1) on the tapered end of the spindle shaft, use a soft tip (rubber) hammer (3) or a block of wood and a hammer.
3. Tap the drill chuck (1) onto the spindle shaft. See Figure 6.

FIGURE 6.
INSTALLING THE DRILL CHUCK

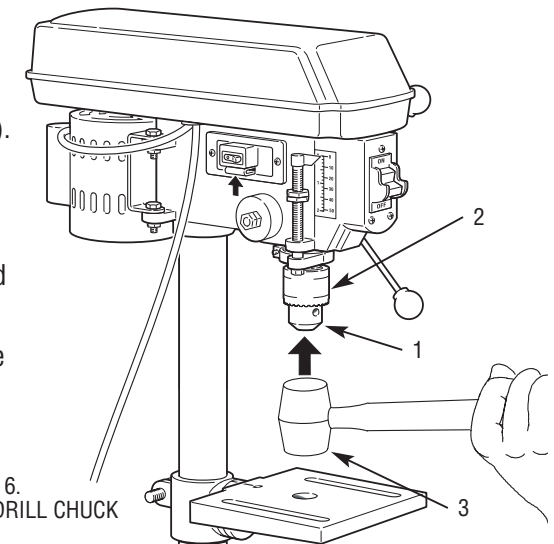

14

CAUTION To avoid damage to the drill chuck and the spindle shaft, do not drive the chuck onto the spindle shaft with a metal hammer. Damage to the Drill Chuck will occur.

REMOVING AND INSTALLING DRILL BITS

WARNING Disconnect drill press from AC power source and ensure the "ON/OFF" switch is in the "OFF" position. Failure to adhere to this warning could cause severe, permanent injury to the operator.

Use only the chuck key provided by the manufacturer with the drill press.

1. Use the chuck key (1) to loosen the drill chuck (2). See Figure 7.
2. Insert the smooth end of the drill bit (3) into the drill chuck (2) as far as it will go.
3. Back the drill bit (3) out approximately 1/16" or up to the flutes for smaller bits.
4. Ensure the drill bit (3) is centered in the drill chuck jaws before tightening.
5. Use the chuck key (1) and tighten the drill chuck (2) locking the drill bit (3) in place.

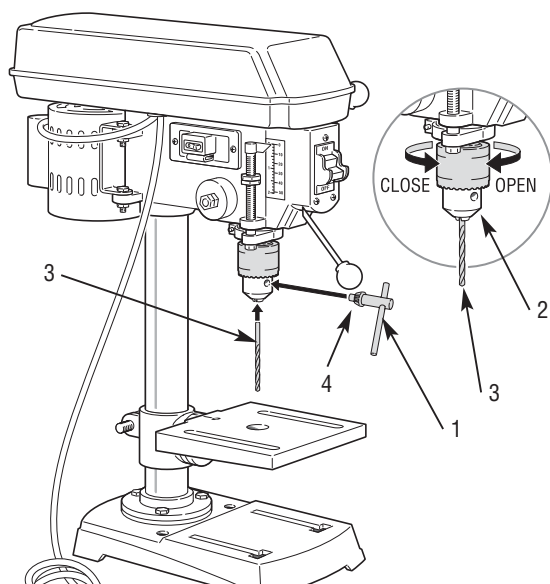

FIGURE 7.
INSTALLING DRILL BITS

IMPORTANT: Lock all three jaws in the drill chuck bit to ensure proper tightening and so it doesn't slip while drilling.

6. Ensure the check key (1) is removed from the drill chuck BEFORE applying power to the drill press.
7. The chuck key is equipped with a self-ejecting pin (4) that helps minimize the hazard of the key being inadvertently left in the drill chuck.

MOUNTING THE DRILL PRESS

During operation of the drill press, there may be instances where the tool could tip over, slide, or walk on the supporting surface. To secure the drill press:

1. Place the drill press (1) on the workbench (2) as desired.
2. Secure the drill press (1) to the workbench (2) using two carriage bolts (3), flat washers (4), and nuts (5) through the holes in the drill press base. See Figure 8.

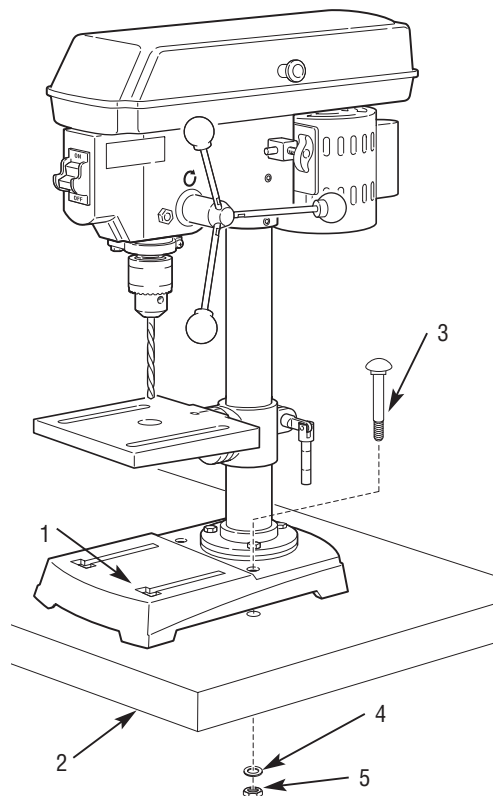

FIGURE 8.
MOUNTING THE DRILL PRESS

LASER GUIDE

CAUTION Use of controls or procedures, or performance of procedures other than those specified herein may result in hazardous radiation exposure.

LASER SAFETY

WARNING

NEVER LOOK INTO THE LASER BEAM. Any contact with the eyes by the beam could cause injury. Do not use the laser when cutting reflective materials.

DO NOT AIM THE LASER BEAM AT ANYONE OR AT REFLECTIVE SURFACES. CLASS 2M LASER PRODUCT. Any contact with the eyes by the beam could cause injury. Ensure the laser beam is turned on only when the tool is on a non-reflective workpiece and as such it is aimed only at the work surface. Metals and other materials like steel which can be highly reflective should only be cut without the use of the laser.

⚠ WARNING

STORE OUT OF REACH OF CHILDREN. Equipment should be in a high location or locked up to keep out of reach of children. It is not a toy.

DO NOT TAMPER WITH THE LASER OUTPUT. Changing the performance of the laser to increase its output is prohibited. Any claim for damages or injuries resulting from not following these instructions will be refused.

OPERATION ACCESSIBLE FIELDS:

Wavelength	636-660nm
Laser Power for Classification	<1mW CW

NEVER OPERATE LASER IF THE UNIT IS DEFECTIVE OR THE COVER OR SEAL IS DAMAGED.

DO NOT SERVICE LASER. The laser unit must be returned to the factory for any service or repair. Service or repair must be handled by authorized factory trained technicians.

Do not open the laser unit except to change batteries.

REMOVE BATTERIES IF THE LEVEL IS TO BE STORED FOR ANY LENGTH OF TIME. Batteries may leak and damage the laser if it is stored idle for more than 3 months.

Be careful with this tool. Striking or jarring it, especially on the laser housing, can affect its accuracy.

Other than batteries, there are no user-serviceable parts in the laser device.

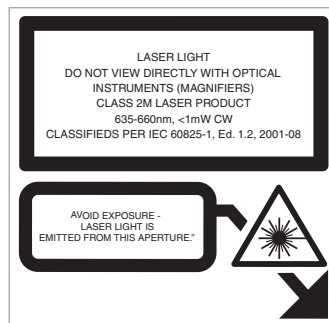

LASER RADIATION
CAUTION LABEL

OPERATING THE LASER

⚠ WARNING

Do not stare directly into the Laser beam, aperture or into a reflection from a mirror-like surface.

The laser runs on two AAA batteries which are located beneath the "ON/OFF" switch. When the laser light begins to dim, change both batteries. NEVER mix old batteries with new.

TO CHANGE LASER BATTERIES:

1. Turn off the laser.
2. Press the tab (1) located below the laser switch (2) and lift up the laser switch cover.
3. Insert two "AAA" batteries in the laser battery compartment (3).
4. Close the laser switch cover.

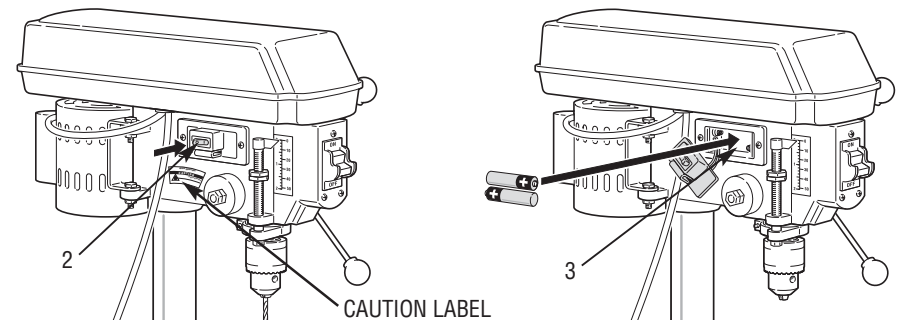
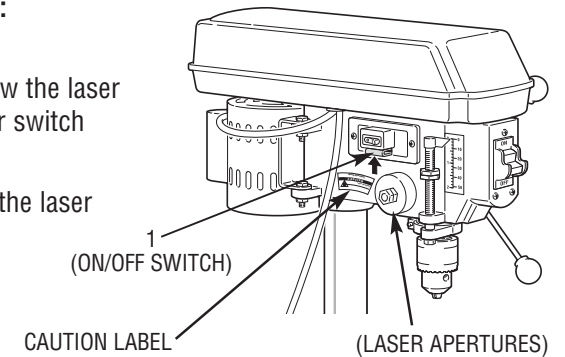
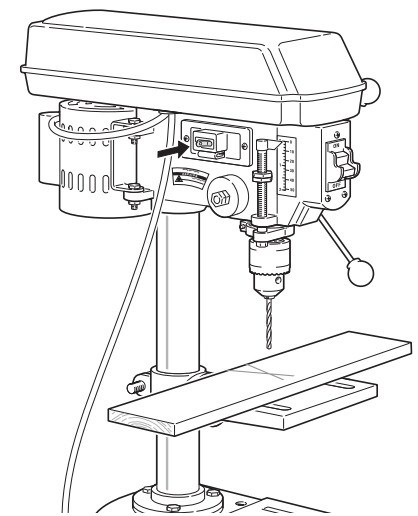

FIGURE 9.
INSTALLING LASER BATTERIES

USING THE LASER LIGHT:

1. Place the workpiece on the table.
2. Turn the laser switch to the ON position.
3. Lower the drill bit to meet the workpiece. The two laser lines should cross where the drill meets the workpiece.
4. If the drill needs to be adjusted:
 - Using a 3mm hex key, turn the laser adjustment set keys counter-clockwise.
 - Rotate the laser light housing until the two laser lines intersect where the drill meets the workpiece. DO NOT stare directly at the laser lines.
5. Re-tighten the adjustment set screws.



OPERATING THE DRILL PRESS

The drill press is designed to use drill bits with a shank of 1/2" or less. The following will give the inexperienced operator practice with common drilling operations. Always use scrap material and do test procedures before working on the actual workpiece. These test runs will decrease as experience and confidence with the drill press increase.

CAUTION

When the workpiece is long enough, place it on the worktable so that one end rests against the drill press column. This is usually the left side as you look to the rear of the drill press. In case the drill bit seizes in the workpiece, the drill press support will prevent the workpiece from spinning out of control. FAILURE to adhere to this step could result in possible severe injury to the operator.

OPERATING THE ON/OFF SWITCH

The drill press "ON/OFF" switch is located on the front of the drill press head. To turn the drill press "ON," move the rocker-style switch **up** to the "ON" position. To turn the drill press "OFF," move the rocker-style switch **down** to the "OFF" position.

CAUTION

Ensure the "ON/OFF" switch is in the "OFF" position before plugging the power cord into the AC power source. Ensure there are no tools or work pieces in contact with the drill bits, cutting tools, or sanding drum when the drill press is turned "ON." Failure to observe these procedures could result in damage to the drill press, tools, work pieces, and/or serious personal injury to the operator or bystanders.

LOCKING THE "ON/OFF" SWITCH IN THE "OFF" POSITION

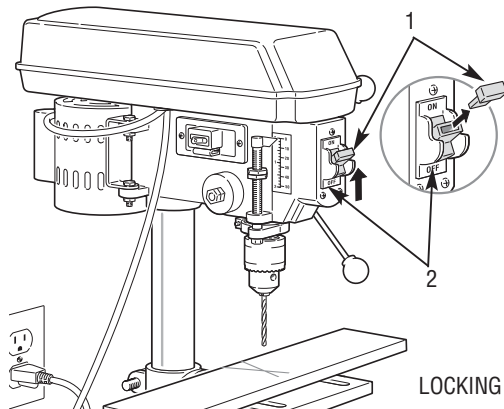

FIGURE 11.
LOCKING THE "ON/OFF" SWITCH

Anytime the drill press is not being used, the "ON/OFF" should be locked to prevent any unauthorized use.

1. To LOCK the "ON/OFF" switch, grasp the switch toggle (1) and remove it from the "ON/OFF" switch (2). See Figure 11.

CAUTION

Ensure that the switch toggle, when removed, is kept in a secure place. Once removed, the drill press will not start without it.

ADJUSTING THE WORK TABLE

1. The worktable (1) can be raised or lowered on the drill press column (2) by loosening the table clamp (3). See Figure 12.
2. After the table is positioned at the desired height, LOCK the table in place by tightening the table clamp (3). NOTE: Final positioning of the table should always be made from the bottom to the top position.
3. The worktable (1) can be rotated 360 degrees around the column (2) by loosening the table clamp (3). Rotate the table to the desired position and LOCK the table in place by tightening the table clamp (3). See Figure 12.

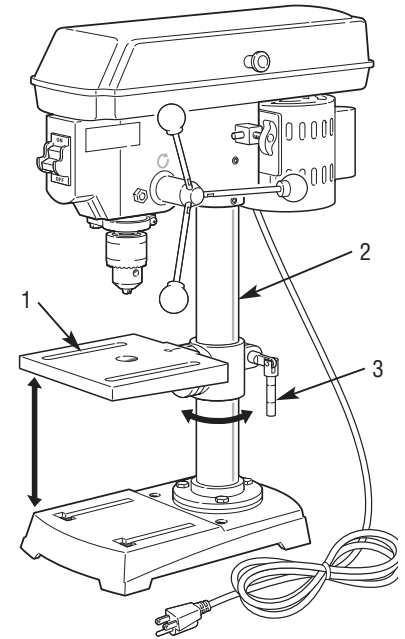

FIGURE 12. ADJUSTING THE WORK TABLE

TILTING THE WORKTABLE

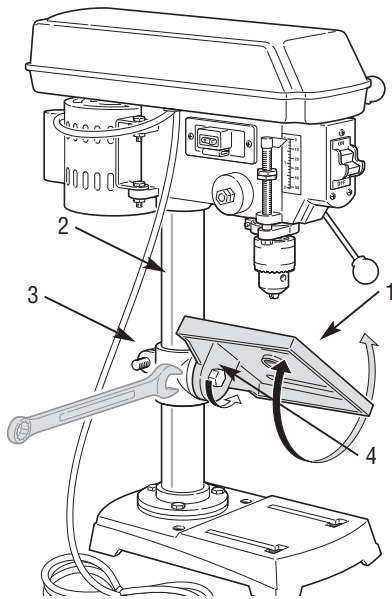
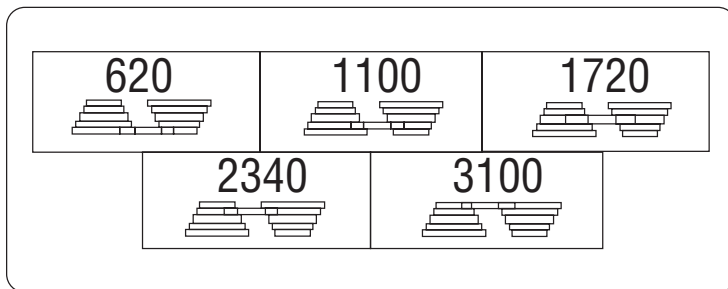

FIGURE 13.
TILTING THE WORK TABLE

1. The worktable (1) can be tilted to the left or right by loosening the pivot bolt (4) mounted beneath the worktable. See Figure 13.
2. Tilt the worktable (1) to the desired position and tighten the pivot bolt (4).
3. When returning the table to the level position, line up the register mark on the table with the tilt scale. This ensures the table surface is positioned 90 degrees to the spindle.
4. A tilt scale (K) is provided on the table bracket casting (L) to indicate the degree of tilt.
5. A witness line and zero mark (1) are provided on the table to ensure proper alignment with the tilt scale (2).

ADJUSTING THE DRILL PRESS SPINDLE SPEED

A spindle speed and pulley/belt arrangement chart is posted inside the pulley cover. See the chart below. Refer to this chart whenever spindle speeds need to be changed.



⚠ WARNING Disconnect drill press from AC power source and ensure the “on/off” switch is in the “OFF” position. Failure to adhere to this warning could cause severe, permanent injury to the operator.

1. Lift up the pulley cover (1).
2. Release the belt tension by loosening the tension lock knob (2) located on the side of the drill press head. Loosen the tension lock knob (2) by turning it counterclockwise.
3. Pivot the motor (3) towards the front of the drill press.
4. While holding the motor pivoted to the front of the drill press, position the belt (4) on the desired step of the motor pulley (5) and the spindle pulley (6). See Figure 14.
5. After attaining the desired spindle speed, pivot the motor (3) to the rear of the drill press and securely tighten the tension lock knob (2) by turning it clockwise.
6. The belt (4) should be tight enough to prevent any slippage. If the belt is overtightened, the life of the belt will be noticeably reduced.
7. Close the pulley cover (1).

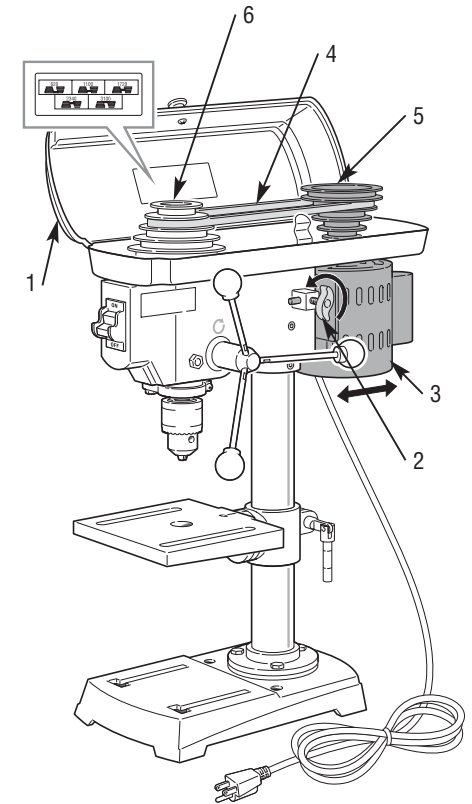

FIGURE 14.
ADJUSTING DRILL PRESS SPEED

DRILLING HOLES TO SPECIFIED DEPTHS

⚠ WARNING Disconnect drill press from AC power source and ensure the “ON/OFF” switch is in the “OFF” position. Failure to adhere to this warning could cause severe, permanent injury to the operator.

A depth stop (1) is provided on the pinion shaft, allowing multiple holes to be drilled to a specific depth. See Figure 15.

1. Insert drill bit (2) into drill chuck.
2. Lower the spindle (3) until the pointer (4) is in line with the mark on the scale (5).
3. Tighten the lock screw (6).
4. Return the spindle (3) to the up position.
5. Place the workpiece on the drill press table and securely clamp it in place.
6. Raise the drill press table until the workpiece just touches the end of the drill bit (2).
7. Drill a test hole and check the depth. Make any adjustments as necessary.

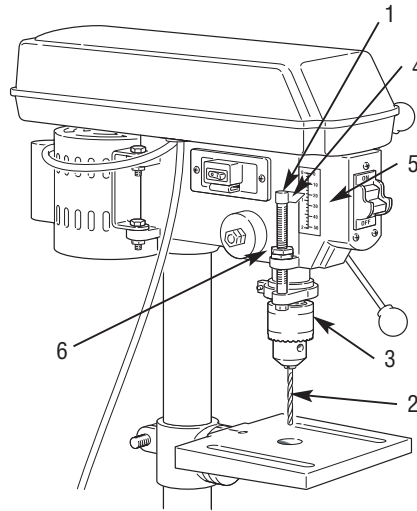

FIGURE 15.
DRILLING HOLES TO SPECIFIED DEPTHS

ADJUSTING THE SPINDLE RETURN SPRING

⚠ WARNING Disconnect drill press from AC power source and ensure the “ON/OFF” switch is in the “OFF” position. Failure to adhere to this warning could cause severe, permanent injury to the operator.

The spindle return spring (1) is automatically returned to its upper position when the pinion shaft handles (2) are released. It is recommended that the pinion shaft handles (B) be allowed to return to the upper position slowly. DO NOT LET GO OF THE HANDLES after the hole has been drilled. This action will cause excessive wear and tear on spindle return spring. To adjust the spindle return spring, See Figure 15 and follow the steps below:

1. Loosen the two nuts (3 and 4). Ensure the housing stays engaged with the head casting.
2. While **firmly holding** the spring housing (5), pull out the housing until the boss is engaged with the next notch on the housing.

3. Turn the spring housing (5) counter-clockwise to increase the spring tension or clockwise to decrease the spring tension.
4. Turn nut (4 - inside) until it contacts the spring housing (5). Back nut (4) out 1/4 turn and tighten it against nut (3 - outside) to hold the spring housing in place.
5. **IMPORTANT: The inside nut (4) should not touch the spring housing (5) after it has been tightened.**

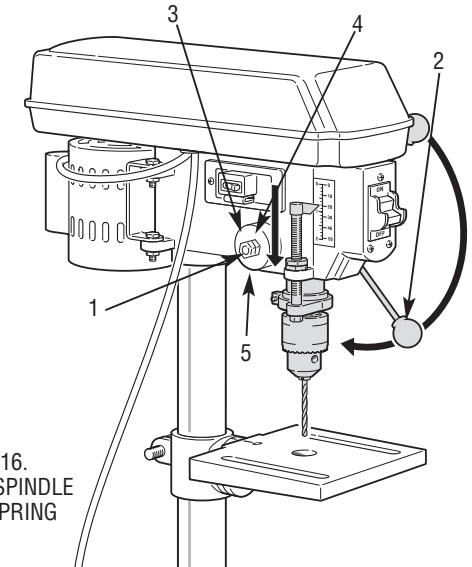

FIGURE 16.
ADJUSTING SPINDLE
RETURN SPRING

CORRECT DRILLING SPEEDS

The correct drilling speed is determined by type of material being drilled, the size of the hole, the type of the drill bit or cutter, and the desired quality of the hole.

⚠ WARNING Always use the recommended speed for the drill bit and for the type of materials the workpiece is made of. If you have any questions as to the proper speeds or types of materials, contact Alltrade customer service at 1-800-590-3723.

WORKING WITH WOOD

Twist drills, although designed for drilling metal, can also be use for drilling wood. However, it is recommended that machine spur bits or wood-boring bits be used for wood projects. These bits cut a flat bottom hole and are designed to remove to easily remove wood chips. DO NOT USE hand bits designed for a hand-operated drill brace. These bits have screw tips and at the speeds used by the drill press, they would rapidly engage the workpiece and spin it around violently.

For through boring, line up the spot where the hole is to drilled with the hole in the worktable. This permits the drill bit to pass cleanly through the workpiece without damaging the worktable. Scribe a vertical line on the front of the column and matching marks on the table bracket and the drill press head so that the table and drill press can be clamped in the center position at any height.

To prevent splintering on the bottom of the workpiece, clamp a scrap piece of wood beneath the workpiece and allow the drill bit to enter it resulting in a clean hole on the workpiece. This also protects the point of the drill bit.

DRILLING METAL

⚠ WARNING Always use clamps or a vise when drilling metal. The workpiece should never be held in place by hand.

The drill bit could seize in the metal at any time, especially when breaking through the backside of the workpiece. This could cause the workpiece to spin out of the operator's hand. The drill bit will be broken when the workpiece strikes the column. Failure to observe this precaution could result in damage to the workpiece, the drill press, and severe or permanent injury to the operator.

CONSULT EXPERT ADVICE BEFORE DRILLING IN WORK PIECES MADE OF MAGNESIUM. The friction generated by the drill bit could cause the magnesium to ignite resulting in a very intense fire that could cause severe burns to the operator and/or seriously damage the drill press.

The workpiece must be clamped firmly while drilling. Tilting, twisting, or shifting not only results in a rough-drilled hole, but increases the risk of breaking the drill bit.

For flat work, place the workpiece on a piece of scrap wood and clamp tightly to the worktable to prevent it from turning. If the shape of the workpiece is irregular and cannot be placed flat on the table, it should be securely blocked and clamped before attempting to use the drill press.

MAINTENANCE AND CLEANING

LASER MAINTENANCE

For the best laser performance, perform the following maintenance regularly:

1. **Disconnect machine from power source.**
2. Carefully clean sawdust from each laser lens. Do not use solvents of any kind since they may damage the lens. Dust build-up can block the laser and prevent it from accurately indicating the line of drilling.

ACCESSORIES

Optional accessories for the drill press can include wire-brush wheels that can be used for cleaning and layered cloth wheels that can be used for polishing and buffing. Contact **ALLTRADE Customer Service** at **1-800-590-3723 (toll free)** to find out what accessories are available for the drill press.

⚠ WARNING Only use accessories that are designed to fit your particular drill press. These accessories should be specifically labeled to match the speed and arbor size of the drill. Failure to use the proper accessories could result in property damage, damage to the grinder, and serious personal injury to the operator.

Always attach grounded (3-prong) extension cords to grounded (3-hole) outlets. If the drill press must be used outside, use an extension cord labeled "W-A" or "W." These extension cords are rated for outdoor use and reduce the chances of electrical shock. **If you must use an extension cord, be sure that the gauge is large enough to carry the amount of current necessary for your power tool.** If not, your tool may experience a loss of power, excessive voltage drop or overheating. The smaller the gauge number, the heavier the cord (see table below).

RECOMMENDED SIZES OF EXTENSION CORDS 120 VOLT AC 60 HZ TOOLS

TOOL CURRENT RATING	CONDUCTOR SIZE IN A.W.G			
	10FT.	25FT.	50FT.	100FT.
3-6	18	18	18	18
6-8	18	18	18	16
8-10	18	18	18	14
10-12	16	16	14	14
12-16	14	12	12	-
16-20	12	12	12	-

SPECIFICATIONS

SPECIFICATIONS	
Voltage	120V ~ 60 Hz
Rated Current	1.8 A
No-Load Speed (motor)	1700 RPM
Max. Distance From Spindle Axis To Surface Of Column:	4 1/8" (105mm)
Max. Distance From Spindle End To Surface Of Table:	7" (178mm)
Distance: Spindle axis to column	4.0" (102mm)
Spindle Travel:	2" (51mm)
Chuck Capacity	1/2" (13mm)
Range of Spindle Speeds (60Hz)	620-3100 RPM
Laser Beam	Class II, Diode Laser
Laser Beam Maximum Power	1mw
Laser Beam Wavelength	650nm

OTHER CONSUMER DO-IT-YOURSELF (DIY) TOOLS

Alltrade offers a full range of Kawasaki™ tools that make DIY jobs easy. If you would like further information on the following products, please contact Alltrade Customer Service Department at 1-800-590-3723.

- Cordless Drills/Screwdrivers
- Impact Wrenches
- Sanders
- Jigsaws
- Circular Saws
- Angle Grinders
- Reciprocating Saws
- Routers
- Rotary Tools
- Corded and Cordless Multi-Purpose Tools
- Wide Range of Accessories and more

2 YEAR LIMITED HOME USE WARRANTY

Express and Exclusive Limited Home Use Warranty to Original Retail Buyer

Alltrade Tools LLC (hereinafter "Alltrade") expressly warrants to the original retail purchaser of the accompanying KAWASAKI™ portable power tool and no one else all parts of the product (except those parts referred to below which are specifically excluded from such warranty (see Exclusions)) to be free from defects in materials and workmanship for a period of two years from original date of purchase.

SPECIAL WARRANTY NOTE TO CONTRACTORS AND COMMERCIAL USERS: This Kawasaki™ portable power tool is offered as a home use tool and carries a **HOME USE WARRANTY**. This tool is made for home use in the execution of projects and repairs in and around the home. Use of the tool for **COMMERCIAL PURPOSES OR ON A JOBSITE** is not covered under this warranty.

The date of purchase shall be the date of shipment to the original purchaser, or the date the original purchaser took possession, custody or control of the product, whichever occurred first. This warranty shall be null and void if the product or any component thereof is modified, altered or used for any commercial purpose or on a jobsite. This warranty does not apply to any other product and/or component thereof manufactured or distributed by Alltrade, and does not apply to products and/or components thereof designed, manufactured and/or assembled by others, for which Alltrade makes no warranties whatsoever. **THERE ARE NO WARRANTIES WHICH EXTEND BEYOND THE DESCRIPTION ON THE FACE HEREOF.**

Warranty Performance

By purchasing the product, purchaser expressly acknowledges and agrees that their sole and exclusive remedy under this warranty shall be strictly limited to the repair or replacement of any covered nonconforming items or parts thereof provided that any such nonconforming item and/or part is promptly returned to Alltrade's facility postage pre-paid and insured (address: ALLTRADE Warranty Claims & Repair, 1431 Via Plata, Long Beach, CA 90810, Attn: Customer Service #1-800-590-3723) within the applicable warranty period, with a written request by purchaser that Alltrade repair and/or replace the nonconforming item and/or part. We recommend that you keep the original product packaging in the event you need to ship the unit. We suggest the package be insured against loss or in transit damage. When sending your product include your name, address, phone number, dated proof of purchase (or copy), and a statement about the nature of problem. Warranty coverage is conditioned upon purchaser furnishing Alltrade with adequate written proof that they are the original purchaser and of the original purchase date. Parts returned, freight prepaid and insured, to Alltrade's facility (see above address) will be inspected and, at Alltrade's option, repaired and/or replaced free of charge if found to be defective and subject to warranty. Alltrade retains the sole discretion to determine whether any item or part is nonconforming and, if so, whether the item and/or part will be repaired and/or replaced. If the unit is repaired, new or reconditioned replacement parts may be used. If Alltrade chooses to replace the product, it may replace it with a new or reconditioned one of the same or comparable design. The repaired or replaced unit will be warranted under the terms of the remainder of the warranty period. Typically, a defective product that is returned within the first 30 days after the purchase date will be replaced; for items returned after the first 30 days and within the warranty period, covered defective parts not subject to normal wear and tear or other exclusions will be repaired or replaced, at Alltrade's option. During the warranty period, Alltrade will be responsible for the return shipping charges. Alltrade's repair and/or replacement of any nonconforming item and/or part thereof shall constitute fulfillment of all obligations to the purchaser. Alltrade shall not be responsible or liable for any expense, including freight charges, or repairs made outside Alltrade's facility, unless expressly agreed to by Alltrade in writing. Under no circumstances shall Alltrade bear any responsibility for loss of the unit, loss of time or rental, inconvenience, commercial loss or consequential damages.

Exclusions

This warranty does not cover parts damaged due to normal wear, abnormal conditions, misapplication, misuse, abuse, accidents, operation at other than recommended pressures or temperatures, improper storage or freight damage. Parts damaged or worn by operation in dusty environments are not warranted. Failure to follow recommended operating and maintenance procedures also voids warranty.

This limited warranty does not apply to accessory items such as drill bits, screwdriving bits, circular saw blades, jigsaw blades, grinding wheels, sanding sheets and other related items.

DAMAGE TO THE PRODUCT RESULTING FROM TAMPERING, ACCIDENT, ABUSE, NEGLIGENCE, FAILURE TO FOLLOW INSTRUCTIONS, UNAUTHORIZED REPAIRS OR ALTERATIONS, DAMAGE WHILE IN TRANSIT TO OUR SERVICE FACILITY, USE OF UNAPPROVED OR IMPROPER ATTACHMENTS OR ACCESSORIES, COMMERCIAL AND RENTAL APPLICATIONS OR OTHER CAUSES UNRELATED TO PROBLEMS WITH MATERIAL OR WORKMANSHIP ARE NOT COVERED BY THIS WARRANTY.

Alltrade will not be liable for the following: labor charges, loss or damage resulting from improper operation, maintenance or repairs made by other persons; pre-delivery services such as assembly, oil or lubricants, and adjustment; maintenance services that are normally required to maintain the product.

The use of other than genuine Alltrade Repair Parts will void warranty.

Warranty Disclaimers

EXCLUSION AND DISCLAIMER OF ALL OTHER EXPRESS WARRANTIES, GUARANTIES AND/OR REPRESENTATIONS. EXCEPT FOR THE LIMITED WARRANTY PROVIDED ABOVE, ALL OTHER EXPRESS WARRANTIES, GUARANTIES AND/OR REPRESENTATIONS BY ALLTRADE AND/OR ITS REPRESENTATIVE(S) REGARDING THE DESIGN, MANUFACTURE, PURCHASE, USE AND/OR OPERATION OF THE PRODUCT OR ANY COMPONENT THEREOF SOLD HEREUNDER, REGARDLESS OF WHETHER ANY SUCH WARRANTY, GUARANTY AND/OR REPRESENTATION, WRITTEN OR ORAL, ARISES BY OPERATION OF LAW AND/OR EQUITY AND/OR BY ANY ACT OR OMISSION OF ALLTRADE AND/OR ITS REPRESENTATIVE(S), OR THE BUYER, ARE HEREBY EXPRESSLY EXCLUDED AND DISCLAIMED BY ALLTRADE AND/OR ITS REPRESENTATIVES. PURCHASER KNOWINGLY AND WILLINGLY WAIVES ANY AND ALL SUCH WARRANTIES AND RIGHTS, CLAIMS AND/OR CAUSES OF ACTION ARISING THEREFROM OR BASED THEREON. PURCHASER'S SOLE AND EXCLUSIVE REMEDY IS AS STATED ABOVE.

EXCLUSION AND DISCLAIMER OF ALL IMPLIED WARRANTIES, INCLUDING THE IMPLIED WARRANTIES OF MERCHANTABILITY AND FITNESS FOR A PARTICULAR PURPOSE. NO WARRANTY, ORAL OR WRITTEN, OTHER THAN THE ABOVE WARRANTY IS MADE WITH REGARD TO THIS PRODUCT. ALL EXPRESS AND/OR IMPLIED WARRANTIES, GUARANTIES AND/OR REPRESENTATIONS BY ALLTRADE AND/OR ITS REPRESENTATIVE(S) REGARDING THE DESIGN, MANUFACTURE, PURCHASE, USE AND/OR OPERATION OF THE PRODUCT OR ANY COMPONENT THEREOF SOLD HEREUNDER, REGARDLESS OF WHETHER ANY SUCH WARRANTY, GUARANTY AND/OR REPRESENTATION, WRITTEN OR ORAL, ARISES BY OPERATION OF LAW AND/OR EQUITY AND/OR BY ANY ACT OR OMISSION OF

ALLTRADE AND/OR ITS REPRESENTATIVE(S), OR THE PURCHASER, INCLUDING BUT NOT LIMITED TO THE IMPLIED WARRANTY OF MERCHANTABILITY AND THE WARRANTY OF FITNESS FOR A PARTICULAR PURPOSE, ARE HEREBY EXPRESSLY EXCLUDED AND DISCLAIMED BY ALLTRADE AND/OR ITS REPRESENTATIVES. PURCHASER KNOWINGLY AND WILLINGLY WAIVES ANY AND ALL SUCH WARRANTIES AND RIGHTS, CLAIMS AND/OR CAUSES OF ACTION ARISING THEREFROM OR BASED THEREON. PURCHASER'S SOLE AND EXCLUSIVE REMEDY IS AS STATED ABOVE.

Limitation Of Liability

IN NO EVENT SHALL ALLTRADE AND/OR ITS REPRESENTATIVE(S) BE LIABLE FOR INDIRECT, INCIDENTAL, SPECIAL AND/OR CONSEQUENTIAL DAMAGES OF ANY KIND ARISING OUT OF OR RELATED TO, DIRECTLY OR INDIRECTLY, ANY BREACH OF ANY PROVISION OF ANY AGREEMENT BETWEEN ALLTRADE AND/OR ITS REPRESENTATIVE(S) AND PURCHASER, ANY WARRANTY HEREUNDER, AND/OR THE EXISTENCE, DESIGN, MANUFACTURE, PURCHASE, USE AND/OR OPERATION OF ANY ITEM(S) SOLD HEREUNDER EVEN IF ALLTRADE AND/OR ITS REPRESENTATIVE(S) HAS BEEN ADVISED OF THE POSSIBILITY OF ANY SUCH DAMAGES. IN NO EVENT, WHETHER AS A RESULT OF A BREACH OF CONTRACT, WARRANTY, TORT (INCLUDING NEGLIGENCE) OR OTHERWISE, SHALL ALLTRADE'S AND/OR ITS REPRESENTATIVE(S)' LIABILITY EXCEED THE PRICE OF THE PRODUCT. ANY AND ALL LIABILITY CONNECTED WITH THE USE OF THIS PRODUCT SHALL TERMINATE UPON THE EXPIRATION OF THE WARRANTY PERIODS SPECIFIED ABOVE.

Limitations on Warranty Disclaimers

Some states do not allow limitations on how long an implied warranty lasts and some states do not allow the exclusion or limitation of the incidental or consequential damages, so part or all of the above limitations or exclusions may not apply to you. This warranty gives you specific legal rights, and you may also have other rights which vary from state to state.

If your product is not covered by this warranty, please call our Customer Service Department toll free at 1-800-590-3723 for general repair information and charges.

Free Manuals Download Website

<http://myh66.com>

<http://usermanuals.us>

<http://www.somanuals.com>

<http://www.4manuals.cc>

<http://www.manual-lib.com>

<http://www.404manual.com>

<http://www.luxmanual.com>

<http://aubethermostatmanual.com>

Golf course search by state

<http://golfingnear.com>

Email search by domain

<http://emailbydomain.com>

Auto manuals search

<http://auto.somanuals.com>

TV manuals search

<http://tv.somanuals.com>