

Setting up your Kenwood KVS Speakers

KVS-50 Center Speaker KVS-60 Surround Speakers



Introduction

Your Kenwood KVS speakers were designed to meet the demands of today's high-quality film soundtracks.

Your new speakers:

- Deliver wide dynamic range
- Sonically match other speakers in the KVS series
- Feature quality-built acoustically-optimized enclosures
- Were designed, engineered, and assembled in the USA.

Installing the speakers isn't difficult, but please read and follow all of the instructions in this manual to get maximum performance from your new speakers. And be sure to read the manual for the receiver, power amplifier, or pre-amplifier to which you're connecting these speakers.

Unpacking

Unpack your new speakers carefully and examine them for shipping damage. If they are damaged or fail to operate, notify your dealer immediately. If your speakers were shipped to you directly, notify the shipping company without delay.

Only the person or company who originally received the unit can file a claim against the carrier for shipping damage. Keep the original carton and packing materials in case you need to transport or ship your speakers.

In this box

This box should contain either:

- KVS-50 Center Speaker (1)
- KVS-60 Surround Speakers (2)

If you bought the KVS-50/60 Center/Surround Speaker Package, you should receive 2 boxes with all 3 speakers.

About speaker wire

We ask you to buy the wire separately, since we don't know how much wire you will need. We suggest that you buy wire that is at least 18-gauge or thicker. Remember, the smaller the number, the thicker the wire, so 18 gauge wire is thicker than 20 gauge wire.

Before you run out to buy speaker wire, read the 'Placing the speakers' section. You'll need to know where your speakers will go to determine how much wire to buy.

For your records

Record the serial number (it's on the back of the speaker) on the warranty card, and in the space below. If you need to call your dealer for information or service, you'll need these numbers. And be sure to save your original receipt.

Model

KVS-50

Serial Number

Model

KVS-60

Serial Numbers

KENWOOD

Safety First

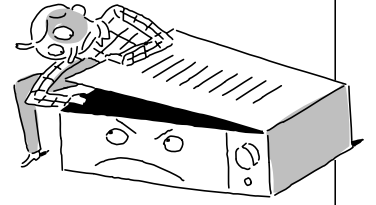

Please read these safety instructions carefully. They can help prevent electrical shock, fire, and damage to the unit.



Safety Precautions

For all units

- 1 Dispose of the packaging materials properly. After you take the unit out of its shipping bag, dispose of the bag, keeping it out of the reach of children and animals. Be aware that the bag could cause suffocation.
- 2 Protect your unit from moisture. Don't place your unit near water—for example, a bathtub, kitchen sink, laundry tub, wet basement or near a swimming pool.

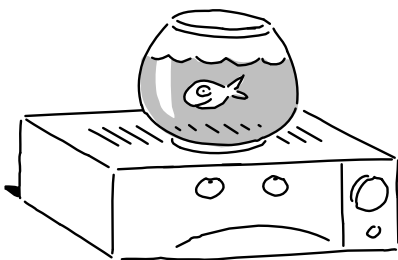

- 3 Keep your unit out of extreme hot and cold. Your unit may not work properly if it is used at extremely low or freezing temperatures. Don't place your unit near radiators, heat registers, stoves or other heat sources.

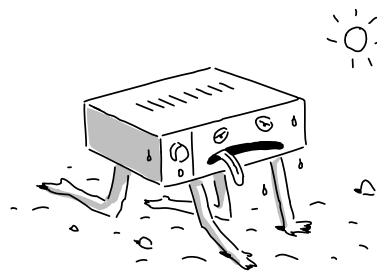

- 4 Don't put objects or liquids into the unit! NEVER permit children to put anything into the unit.
- 5 NEVER try to open the unit or take it apart.
- 6 To clean, use a clean, dry cloth. To avoid damage, NEVER use volatile solvents such as alcohol, paint thinner, gasoline, benzene, etc. to clean the cabinet. If this is an electrically-powered unit, unplug it before cleaning.

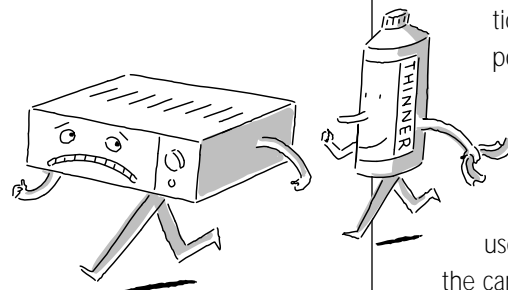

- 7 Do NOT attempt to service this unit. You should take the unit to qualified service personnel for repair when:

- Objects have fallen, or liquids have been spilled into the unit.
- The unit has been exposed to moisture.
- The unit doesn't appear to operate normally or exhibits a marked change in performance.
- The unit has been dropped or the case has been damaged.

- 8 To prevent distortion (and in some cases, discoloration of TV pictures), keep the unit away from sources of magnetic fields, such as TVs, radios, motorized toys, or magnetized objects. If the unit is magnetically-shielded (the manual will state this), it is not subject to these problems.

- 9 Do NOT place the unit on an unstable cart, shelf, stand, tripod, bracket, or table. If you mount the unit, follow the instructions in the manual and, if possible, use a mounting bracket recommended for the unit. If you place the unit on a moveable cart, use caution when moving the cart to avoid overturning it.

Placing the speakers

Important

Please wait until you've connected all of the cables before plugging the receiver or amplifier into the AC wall outlet and turning it on.

KVS-50 Center Speaker

We designed the KVS-50 Center Speaker with both a flat side with an adjustable leg, and an angled side. You can place the speaker on either side (following the instructions below).

- Place the speaker directly above or below the middle of the TV screen (the speaker is magnetically shielded, so you don't have to worry about picture discoloration).
- Place the speaker as close as possible (within 2 feet) to the same height as the left and right front speakers.
- If you place the speaker on the floor, place it on its angled side, aiming it up toward the listeners at seated ear level. In this case, you'll probably want to reverse the speaker grille so that the lettering is right side up.

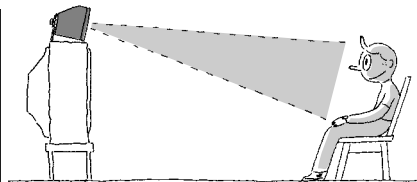
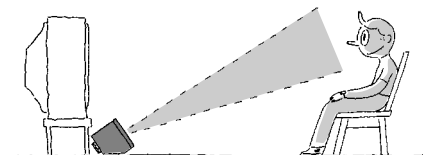

- If you place the speaker on top of the TV, place it on its flat side, and use the adjustable leg on the back to aim it down toward the listeners at seated ear level.

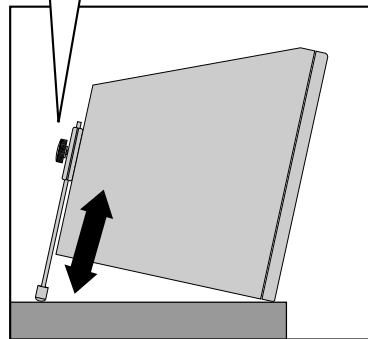
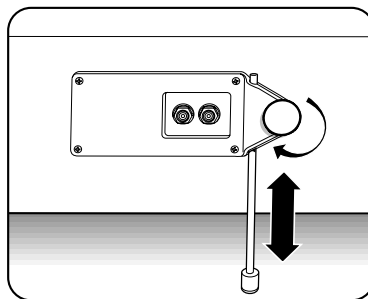

KVS-60 Surround Speakers

- Mount the speakers on the wall using picture hangers (40 lb test), or place them on shelves. (Attach the speaker wire first; see the instruction below).
- Place the speakers directly to the sides of the listening position, with the large grille covers pointing at the listeners.

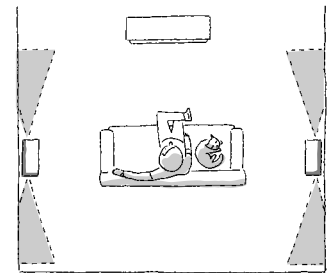

- If the listening area has more than 1 row of seats, place the speakers in the middle of the listening area.
- Place the speakers at least 2 feet above the listener's heads, with the back of the cabinet flush against the wall.

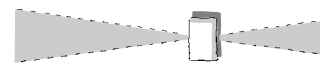

- Place both speakers so that the directional arrows on the back of the cabinet point toward the TV. You'll need to place one speaker upside-down to do this. (There is mounting hardware on both ends of the speaker). This will not affect its sound. You may want to reverse its grille so that the lettering is right side up.

Connecting speaker wire

Important

- Make sure your receiver or amplifier's power cord is unplugged from the wall outlet before making any connections.
- Make sure you connect the positive connections of the speakers to the positive connections of the receiver or amplifier, and the negative connections of the speakers to the negative connections of the receiver or amplifier. If these connections are mismatched, you'll get poor bass performance and weak sound-placement characteristics.
- Check to make sure that no strands from one wire touch any other wire.

Preparing bare wire

- 1 Strip 1/2" of the plastic cover from the ends of the wire.
- 2 Twist the wire to get rid of the loose strands.

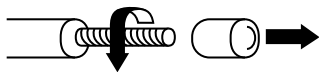

Connecting speaker wire to the KVS-60

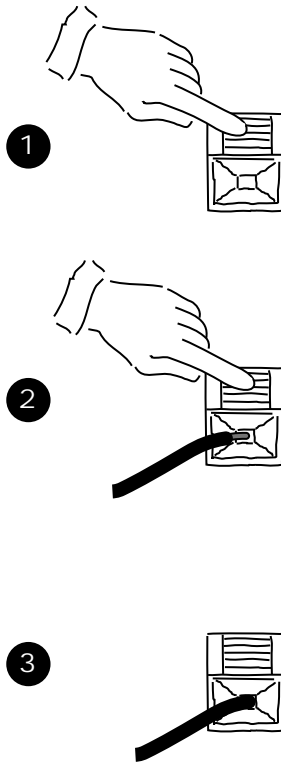

Connecting speaker wire to the KVS-50

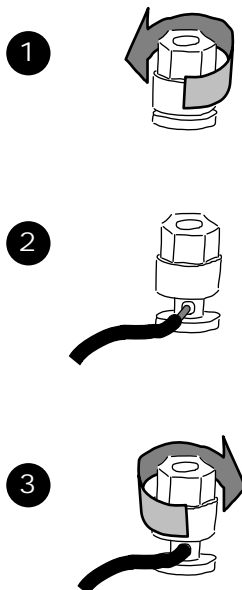

Connecting banana or dual-banana plugs to the KVS-50

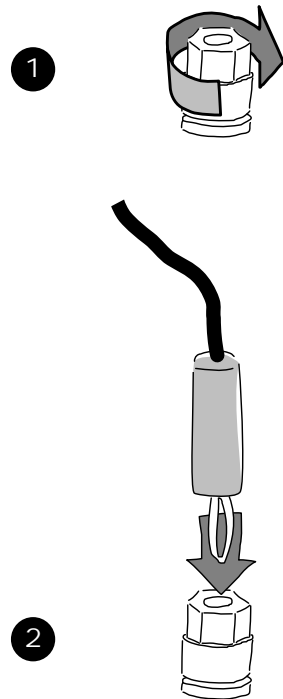

Connecting spade lugs to the KVS-50

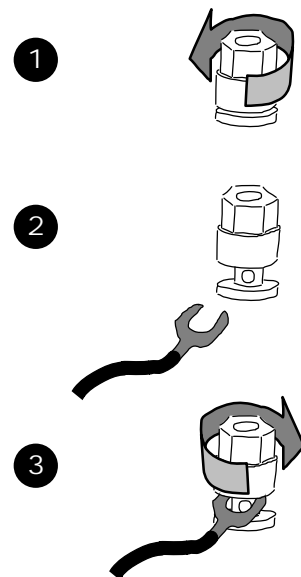

If the lug is too narrow, insert one prong through the hole in the post, making sure that the positive and negative prongs don't touch each other.

Connecting your KVS-50 and KVS-60 speakers

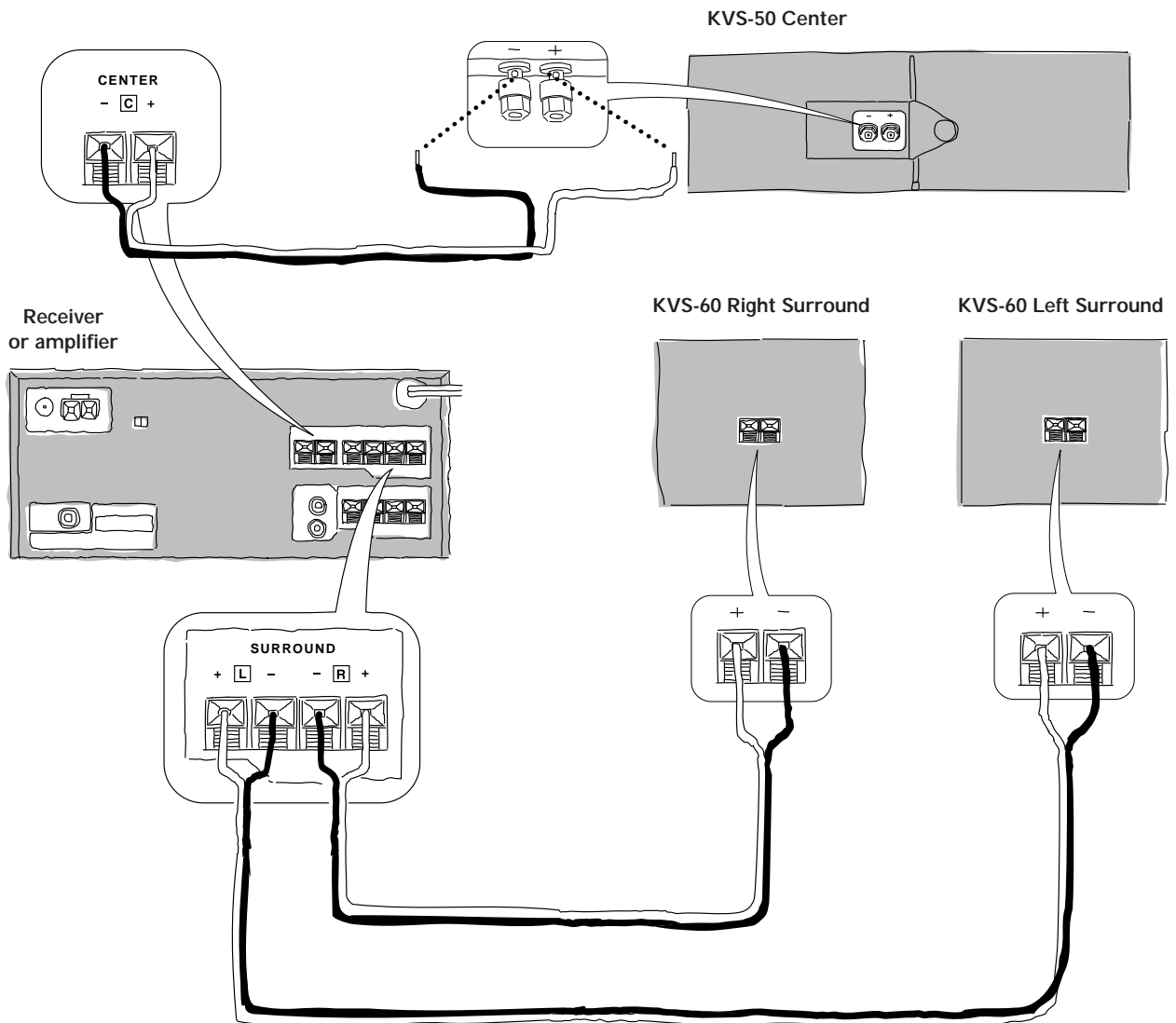

Specifications

Important

Due to product upgrades, specifications may be changed without notice.

KVS-50 Center Speaker

Enclosure: Acoustic suspension
Woofers: 5-in polypropylene cone type (2)
Tweeter: 3/4-in dome type
Crossover frequency: 3.5 kHz
Nominal impedance: 8 ohm
Power handling: 110 watts
Sensitivity: 88 dB
Frequency response: 80 Hz – 20 kHz
Dimensions
Width: 20 in
Height: 7 in
Depth: 6-3/8 in (including leg bracket)
Net weight: 11.1 lbs
Enclosure finish: Particle board laminated with PVC sheet

KVS-60 Surround Speakers

Enclosure: Acoustic suspension
Woofer: 5-in polypropylene cone type
Midrange/Tweeters: 3-in cone type (2 in dipolar configuration)
Crossover frequency: 500 Hz
Nominal impedance: 8 ohm
Power handling: 50 watts
Sensitivity: 87 dB
Frequency response: 100 Hz – 20 kHz
Dimensions
Width: 8 in
Height: 10-5/8 in
Depth: 5-1/2 in
Net weight: 8 lbs
Enclosure finish: Particle board laminated with PVC sheet

KENWOOD USA CORPORATION
PO Box 22745
Long Beach, California 90801-5745

1-800-KENWOOD

www.kenwoodusa.com



Printed on recycled paper using
10% post-consumer waste.

Free Manuals Download Website

<http://myh66.com>

<http://usermanuals.us>

<http://www.somanuals.com>

<http://www.4manuals.cc>

<http://www.manual-lib.com>

<http://www.404manual.com>

<http://www.luxmanual.com>

<http://aubethermostatmanual.com>

Golf course search by state

<http://golfingnear.com>

Email search by domain

<http://emailbydomain.com>

Auto manuals search

<http://auto.somanuals.com>

TV manuals search

<http://tv.somanuals.com>