

KENWOOD

OVERHEAD CONSOLE WITH 8" LCD SCREEN

LZH-81TJ4

INSTRUCTION MANUAL

Kenwood Corporation

Safety precautions

▲ WARNING

To prevent injury or fire, take the following precautions:

- To prevent a short circuit, never put or leave any metallic objects (such as coins or metal tools) inside the unit.
- Do not touch the liquid crystal fluid if the LCD is damaged or broken due to shock. The liquid crystal fluid may be dangerous to your health or even fatal.

If the liquid crystal fluid from the LCD contacts your body or clothing, wash it off with soap immediately.

▲ CAUTION

To prevent damage to the machine, take the following precautions:

- Make sure to ground the unit to a negative 12V DC power supply.
- Do not install the unit in a spot exposed to direct sunlight or excessive heat or humidity. Also avoid places with too much dust or the possibility of water splashing.
- Do not use your own screws. Use only the screws provided. If you use the wrong screws, you could damage the unit.
- If smoke or abnormal odor is detected, turn off the unit immediately and contact the dealer. Using the unit continuously can result in fire or other accidents.
- Be sure to have the unit repaired by the dealer. If you repair the unit, fire or other accidents can result.

Notes

- The illustrations of the display and the panel appearing in this manual are examples used to explain more clearly how the controls are used. Therefore, what appears on the display in the illustrations may differ from what appears on the display on the actual equipment, and some of the illustrations on the display may represent something impossible in actual operation.

Cleaning the Unit

If this unit is stained, wipe it with a dry soft cloth such as a silicon cloth.

If this unit is stained badly, wipe the stain off with a cloth moistened with neutral cleaner, then wipe it again with a clean soft dry cloth.



- Applying spray cleaner directly to the unit may affect its mechanical parts. Wiping this unit with a hard cloth or using a volatile liquid such as thinner or alcohol may scratch the surface or erase characters.

Screen brightness during low temperatures

When the temperature of the unit falls such as during winter, the liquid crystal panel's screen will become darker than usual. Normal brightness will return after using the monitor for a while.

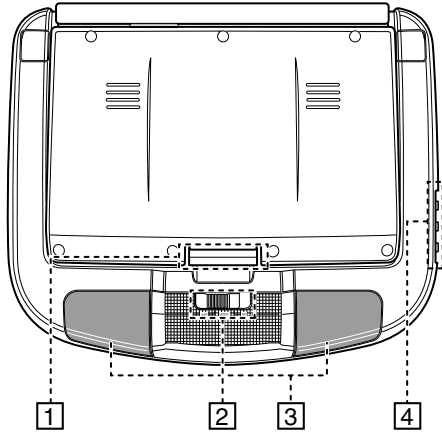

1 Monitor release knob

Unlock the motor.

2 Dome light switch

"ON": The light goes on.

"DOOR": The light goes on/out with the opening/closing of vehicle doors.

"OFF": The light goes out.

3 IR transmitter

4 Audio/Visual input 2 terminal

- Visual input (Yellow)
- Audio left input (White)
- Audio right input (Red)



- The picture input to the Audio/Visual input 2 terminal can be displayed by selecting "AV-IN2" as described in <Video Source Selection> (page 4).

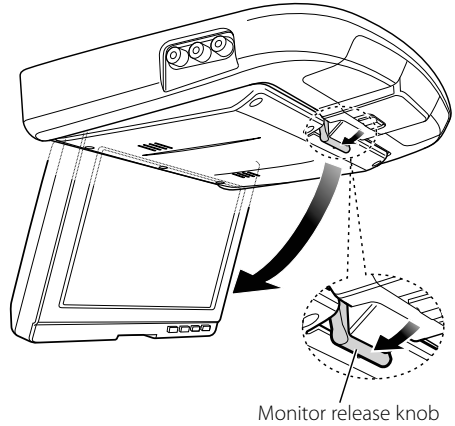

1 Unlock the monitor

Press the monitor release knob.

2 Open the monitor

Press the monitor downward.



- Do not press the LCD of the monitor when opening the monitor. The LCD can damage.
- When closing the monitor, press its back until it locks. If the monitor is not closed completely, the monitor is held powered.

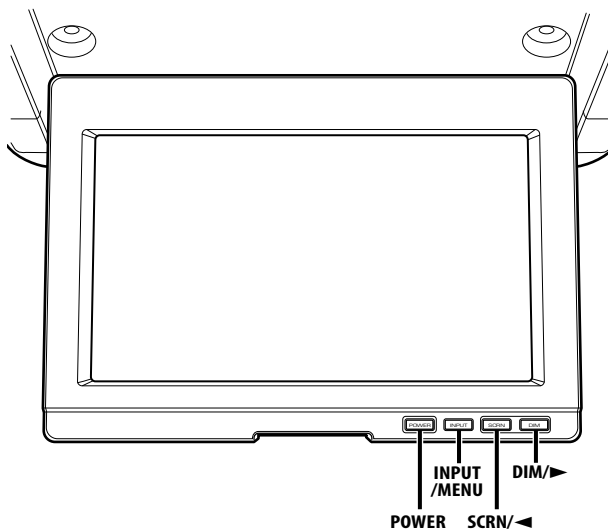

Power

Turns power ON or OFF

Press the [POWER] button.

Video Source Selection

Press the [INPUT] button.

Each time the button is pressed, the video source switches as follows:

Display	Setting
"AV-IN1"	Select the AV1 INPUT source.
"AV-IN2"	Select the AV2 INPUT source.

Display information

When you press the [INPUT] button, the status of the monitor is displayed.



- 1 Screen mode Display
- 2 IR headphones output frequency display
- 3 Video source Display



- The information display is cleared automatically after approximately 5 seconds.

Picture Quality setting

You can adjust the picture quality control of the monitor.

1 Enter Picture Quality setting mode

Press the [MENU] button for at least 2 seconds.

2 Select the screen for brightness ("BRT") setting

Press the [SCRN] or [DIM] button for at least 2 seconds.

Pressing the button for at least 2 seconds toggles between the "Day" screen (for daytime brightness setting) and the "Night" screen (for nighttime brightness setting).

3 Select the adjusting item

Press the [MENU] button.

Each time the button is pressed, the adjusting item switches.



4 Adjust the item

Press the [◀] or [▶] button.

Item	Button	Setting
"BRT"	[▶]	Brighter screen
	[◀]	Darker screen
"TIN"	[▶]	Stronger red level
	[◀]	Stronger green level
"COL"	[▶]	Deeper color
	[◀]	Paler color
"CONT"	[▶]	Stronger contrast
	[◀]	Less contrast
"BLK"	[▶]	Less black level
	[◀]	Stronger black level

5 Exit Picture Quality setting mode

Press the [MENU] button for at least 2 seconds.



- The "TIN" can be adjusted when NTSC video signal is input.
- The screen select can be set for each source.
- If you make no operation for 15 seconds, this mode is automatically canceled.

Selection of Screen Brightness Setting

You can switch between the daytime screen brightness and nighttime screen brightness adjusted in the Picture Quality setting mode.

Press the [DIM] button.

Pressing the [DIM] button toggles between the daytime screen brightness and nighttime screen brightness adjusted in the Picture Quality setting mode.

Switching Screen mode

Press the [SCRN] button.

Each time the button is pressed, the screen mode switches as follows:

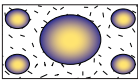
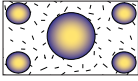
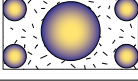
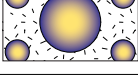
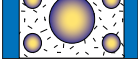
Display	Setting
"Full" 	Full picture mode.
"Just" 	Justify picture mode.
"Cinema" 	Cinema picture mode.
"Zoom" 	Zoom picture mode.
"Normal" 	Normal picture mode.

IR Headphones frequency setting

You can select the IR Headphones frequency you wish.

Press the [SCRN] button for at least 2 seconds.

Each time the button is pressed for at least 2 seconds, the frequency output switches as follows:

Display	Setting
"2 MHz"	The output frequency of IR Headphones is set to 2 MHz.
"3 MHz"	The output frequency of IR Headphones is set to 3 MHz.

Specifications

Specifications subject to change without notice.

Monitor Unit

- Screen size
 - : 8 inches wide
- Display system
 - : Transparent TN LCD panel
- Drive system
 - : TFT active matrix system
- Number of pixels
 - : 336,960 pixels (480 H × 234 V × RGB)
- Effective pixels
 - : 99.99 %
- Pixel arrangement
 - : RGB striped arrangement
- Back lighting
 - : Cold cathode tube
- IR Transmitter output
 - : (2MHz) L ch: 2.3 MHz/ R ch: 2.8 MHz
 - : (3MHz) L ch: 3.2 MHz/ R ch: 3.8 MHz
- Colour system
 - : NTSC/PAL
- External video input level (RCA jacks)
 - : 1 ± 0.1 Vp-p/ 75 Ω
- External audio input level (RCA jacks)
 - : 1 V/ 100 K Ω
- Audio output level (RCA jacks)
 - : 1 V/ 100 Ω

General

- Operating voltage
 - : 14.4 V DC (11 - 16 V)
- Current consumption
 - : 1500 mA
- Consumed Power
 - : 22 W
- Operational temperature range
 - : -10 °C to +60 °C
- Storage temperature range
 - : -30 °C to +85 °C
- Dimensions (W × H × D)
 - : 280 × 237 × 42 mm
- Weight
 - : 1.4 kg

Dome Lamp Unit

- Operating voltage
 - : 14.4 V DC (11 - 16 V)
- Current consumption
 - : 200 mA
- Consumed Power
 - : 2.9 W

Although the effective pixels for the liquid crystal panel is given as 99.99% or more, 0.01% of pixels may not light or may light incorrectly.

KENWOOD

Free Manuals Download Website

<http://myh66.com>

<http://usermanuals.us>

<http://www.somanuals.com>

<http://www.4manuals.cc>

<http://www.manual-lib.com>

<http://www.404manual.com>

<http://www.luxmanual.com>

<http://aubethermostatmanual.com>

Golf course search by state

<http://golfingnear.com>

Email search by domain

<http://emailbydomain.com>

Auto manuals search

<http://auto.somanuals.com>

TV manuals search

<http://tv.somanuals.com>