



USER GUIDE

KRK MODEL V-88 VIDEO SHIELDED BI-AMPLIFIED STUDIO MONITOR



KRK SYSTEMS, LLC.
5452 BUSINESS DRIVE
HUNTINGTON BEACH, CA. 92649
TEL: (714) 373-4600 FAX: (714) 373-0421
WEB SITE: WWW.KRKSYS.COM
EMAIL: SALES@KRKSYS.COM

Contents

	Page
Introduction/ Features Overview	1
System Controls	2
Connecting Your System	3
Installing and Positioning Your Monitors	4~6
Design Goals and System Highlights	7
Troubleshooting	8~9
Specifications	10

Introduction

Congratulations on your KRK purchase! And welcome to the growing family of KRK owners.

Growing demands on music recording industry professionals have created the need for better monitor performance at more affordable prices. The V-Series class of Powered Studio Monitors was created to address these needs. Please take a few moments to review the information in this guide.

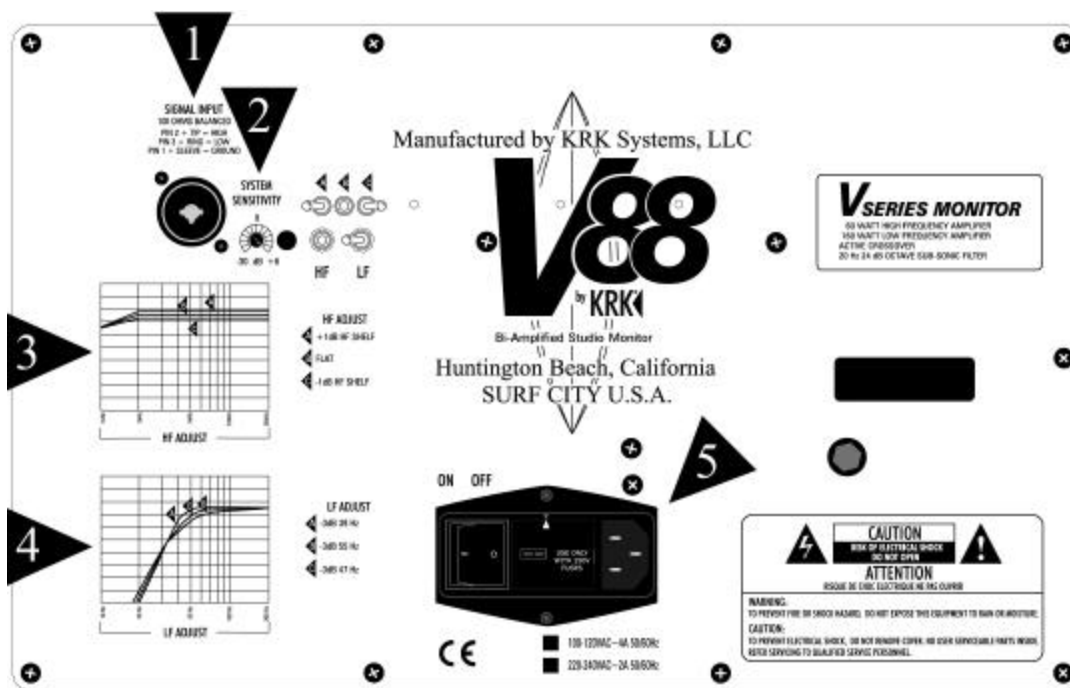

FEATURES OVERVIEW

1. Neutrik® Combo Connector accepts XLR, ¼" phone and TRS connectors
2. System Gain control adjusts overall input sensitivity of the monitor
3. High Frequency Adjustment allows 3-step adjustment of high frequencies
4. Low Frequency Adjustment allows 3-step adjustment of low frequencies
5. IEC Power Entry Module contains the following 3 parts:
 - ⚡ On/Off Switch
 - ⚡ Fuse Block/Voltage Selector

Systems Controls

SYSTEM GAIN



Input sensitivity is adjusted (counterclockwise reduces sensitivity) through a rear panel mounted trim control. Adjustment range is from -30dB to +6dB. Factory preset gain is +6dB, which should suffice for most conditions. Normally adjustments would only be made if you're using your V-88 in a surround system and you need to balance levels or if your monitor send is too hot and not adjustable. If an adjustment is necessary, you'll need a small flathead screwdriver and some measuring equipment. (E.g. tone or filtered noise generator and SPL meter)

HF ADJUSTMENT

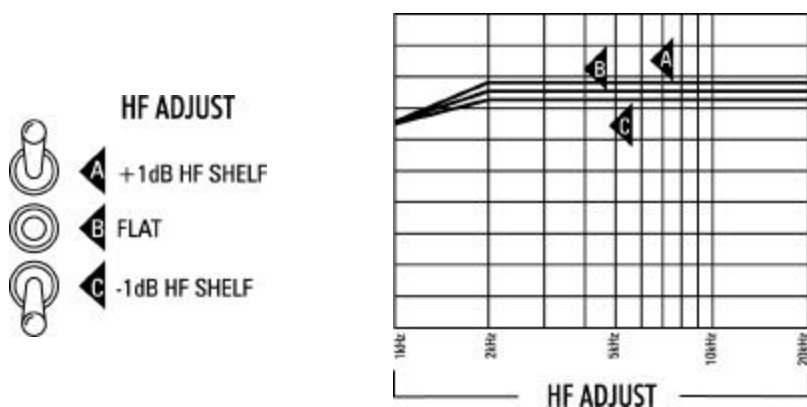

High Frequency Adjustment is through a rear panel mounted 3-position toggle switch. Range of control is +1dB, Flat, or -1dB shelving above 1 kHz. Factory setting for your V-88 is flat (toggle switch is in middle position). Room acoustics may dictate which type of adjustment you need to make to retain a flat frequency response from the monitor. (See additional information in *Installing Your Monitors* section on page 4.)

LF ADJUSTMENT

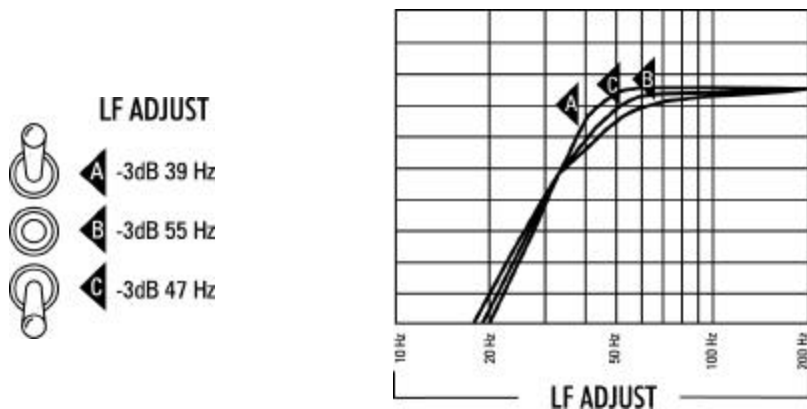

Low Frequency turnover is set to 39Hz, 47Hz, or 55Hz by a rear panel mounted 3-position toggle switch. Rear panel response curve graphics assist you in selecting the appropriate setting. Factory setting for your V-88 is -3dB @ 39 Hz (toggle switch is in up position). Room acoustics may dictate which type of adjustment you need to make to retain a flat frequency response from the monitor. (See additional information in *Installing Your Monitors* section on page 4.)

Connecting Your System

POWERING ON

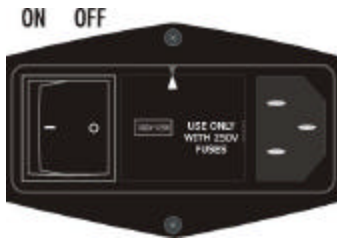

All connections should be made, all faders and controls should be set at their minimum levels, and all other equipment should be powered on prior to powering on your V-88 monitors.

The power On/Off switch is located on the rear panel and is internationally marked to indicate the operational status. (—) = ON and (O) = OFF. A yellow LED illuminates the trademarked KRK Triangle on the front baffle when power is applied.

NOTE: MAKE SURE THAT THE VOLTAGE INDICATOR FOUND IN THE MIDDLE PORTION OF THE IEC MAINS CONTROL IS SET TO THE CORRECT VOLTAGE SETTING FOR YOUR VOLTAGE.

CHANGING VOLTAGE

To change the voltage, remove the power cord, pry off the fuse block with a small flathead screwdriver (look for indent on the left inside of the power cord insert). Slide the circuit board out of the fuse block, rotate 180° and reinstall the fuse block. **Please note when making fuse changes, the fuses will have to be replaced. (see Changing Fuses section below) Make sure and align the white arrow with the raised arrow located on the power entry module before reinstalling.** Check to see if the correct voltage can be read from left to right in the voltage window before powering up.

CHANGING FUSES

Under normal operation the fuses should not blow. A blown fuse usually indicates an overload or fault condition. To change the fuse, remove the power cord, pry off the fuse block with a small flathead screwdriver (look for indent on the left inside of the power cord insert) and change the blown fuses.

- 100-120VAC use 4 amp 250V 5mm x 20mm fuses
- 220-240VAC use 2 amp 250V 5mm x 20mm fuses

If the fuses blow immediately upon power up, this indicates a fault condition and the monitor should be returned to KRK for repair.

NEUTRIK® COMBO CONNECTOR



The Neutrik® Combo connector accommodates ¼" phone plugs, XLR, TRS. Please note that PIN 2 is hot! If you are using an unbalanced connection make sure and wire PIN 1 and PIN 3 together at the source end.

Installing Your Monitors

The close-field monitor, by definition, reduces room interaction. This can be compared to the conventional stereo configuration or the large monitor arrangement in a recording studio where sounds emanating from the monitor or reflecting off ceilings, walls, and floors greatly affect the sound quality. By shortening the path to the ear, the close-field monitor offers a tremendous amount of flexibility, allowing the sound to become less susceptible to differing room conditions. The ability to adjust the high and low frequency characteristics is equally important to help compensate for room irregularities and achieve the highest sound accuracy. (See *HF Adjustments* and *LF Adjustments* sections on page 2.)

A room that is heavily dampened would typically require a high frequency boost. Likewise, reducing the high frequencies can alter a reverberant room. The low frequency can be adjusted to compensate for the first reflection (bounce) off the woofer, whether it comes from the floor, as in the typical stereo setup, or from the surface of the mixing board (when the monitor is placed atop the meter bridge).

Placing the monitor close to a rear wall, sidewall, or a corner will reinforce the low frequencies. Generally speaking, if you move them two to three feet away from walls and corners, you'll hear less low frequency interaction (excluding any interaction with the mixing console). But when ideal positioning isn't practical, low frequency control is the solution. Lets say you have two different studios in your facility; in one room the V-88's are close to the wall, in the other they're further away from the wall. Simply adjust the low frequency on each monitor and you'll have the same sound in each room. This comes in handy if you're tracking in room A and mixing down in room B.

Positioning Your Monitors

Positioning your monitors correctly in the studio is critical to their performance. Typically, they should be placed so that that the listening position is fully "covered" with all monitors resting on the same horizontal plane. A great way to test a monitor for its imaging capability is to play back a CD or DVD recorded acoustically in stereo (or one recorded in surround sound if you have a surround sound set-up). We recommend acoustic music because it represents the spectrum of sound.) You can adjust the angle of each monitor by listening for dead spots. Keep in mind, changing the angle or position of a monitor will change the sound.

2-CHANNEL SET-UP

Close-Field Configuration - In a control room situation, the monitors are often times placed on the meter bridge or in a close-field listening position. Initial placement starts by measuring out a simple equilateral triangle (all three sides equal in length) with the apex at the center of the listening position (as shown in *Figure 1*) as an "overlay" for the stereo installation. In this configuration, the Left and Right monitors are each placed at a 60° angle equidistant from the listening position.

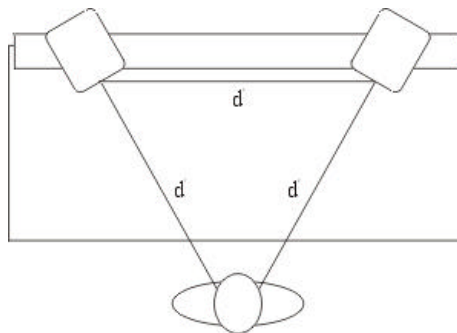

Listening Position

Figure 1

Mid-Field Configuration - This configuration is basically the same as the Close-Field set-up. (see *Figure 2*) It is normally used with larger monitors or when the monitors are too large or heavy for the meter bridge. This set-up has the potential for a larger sweet spot and better spatial imaging. Make sure that the height of the woofer is above height of the console.

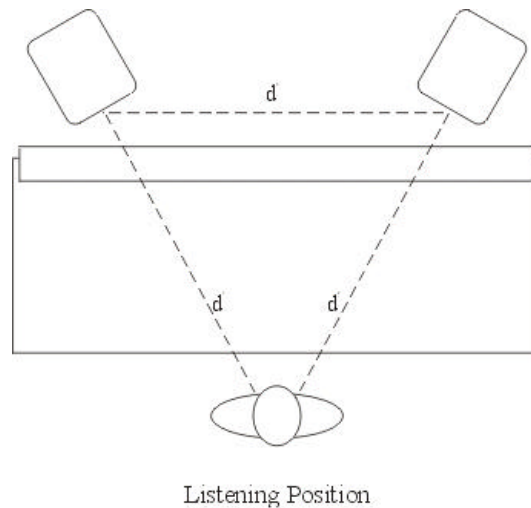

Figure 2

SUBWOOFER SET-UP

Begin by determining the best location for your subwoofer. If possible, the optimum set-up would look like the set-up in *Figure 3*. This set-up may not be practical or possible in your room. Once you have set up your monitors. Listen to some program material that you know has low frequency information recorded on it. Different locations may create a phase misalignment. Most Subwoofers have a phase switch on them. Flip the phase switch. The bass response volume will either increase or decrease in volume. Whichever setting gives you the loudest response from your seating position is in phase. After you have the proper phase setting you will need to adjust the output level of the Subwoofer to a level that provides a smooth blend of the bass volume with that of your monitors.

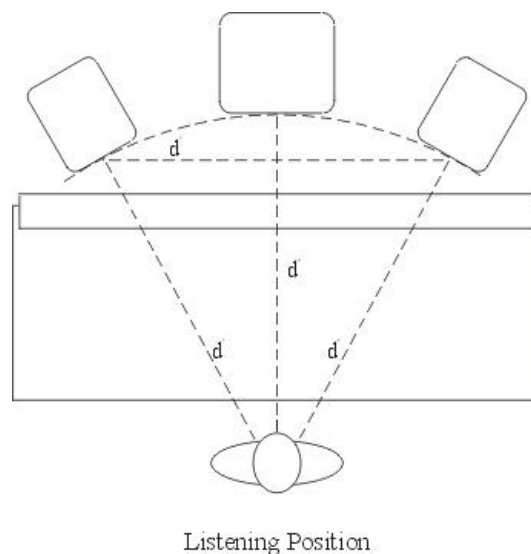

Figure 3

5.1 CHANNEL SURROUND SET-UP

Begin set-up by placing the Left and Right front channels 30° degrees from the Center channel and equidistant to the listening position (*Figure 4*). The Left Surround (Rear) and Right Surround (Rear) channels should be placed 110° degrees from the Center channel. Their location should also be equidistant from the listening position. The subwoofer (Low Frequency Effects) channel is most effective when situated directly below the Center channel (as shown in *Figure 4*). If this is not possible place the subwoofer just to the right or left side and below the Center channel. Make sure that the woofers are above the height of the console.

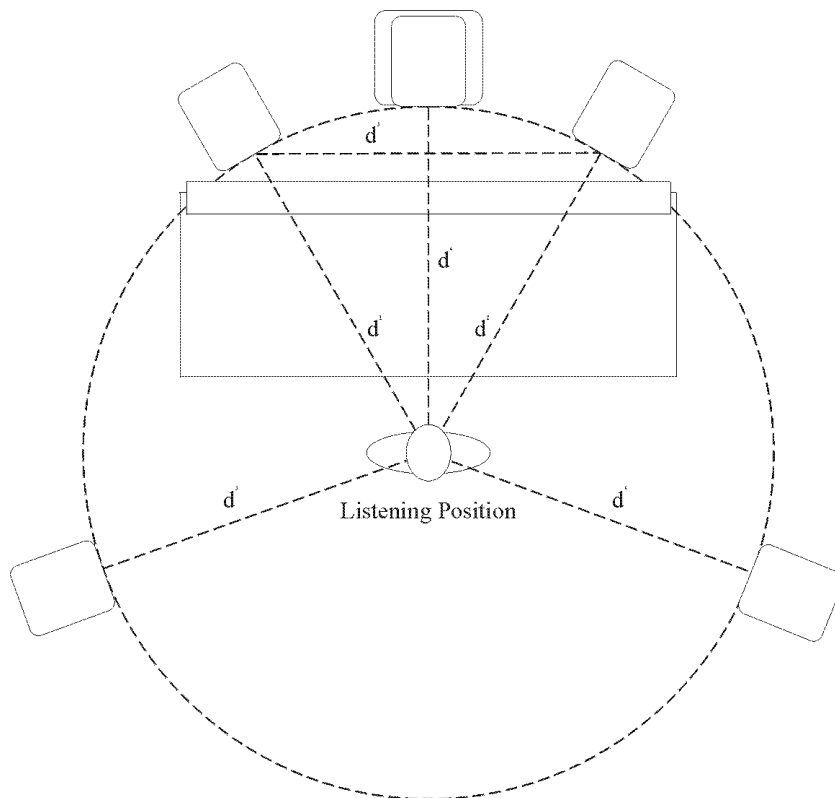

Figure 4

Once the monitors have been placed, you need to adjust the SYSTEM GAIN pots (see page 2) for each monitor so that all channels have exactly the same SPL output at the listening position. Although this can be done simply by listening to each channel one at a time and adjusting for relative levels, we recommend using an SPL meter and filtered noise (pink noise) to test each channel independently. Simply take a reading from each monitor, and then adjust all the monitors to match your lowest SPL reading. Your system levels should now be balanced for multi-channel surround.

The most significant thing to remember is that each room presents its own set of acoustic variables. You'll want to experiment a bit to arrive at the best possible sound for your room.

IMPORTANT NOTE: Your V-88 was originally packaged in a specially designed carton and included special packing materials. Please save these items. They should be used when transporting or shipping your V-88.

Design Goals

KRK's design goal for your V-88 was to create a monitor capable of accurately reproducing sound with clarity and accuracy. Other monitors in the marketplace tend to modify, extend, or "tilt" their response above 1 kHz to sound more "spatial, exciting and impressive". What is not mentioned is this practice tends to make you incorrectly balance your mixes to compensate for this effect, leading to poor "translation".

Your V-88 was designed to reproduce the signal with a minimal of frequency enhancement. Rather than attempting to defy physics, your V-88 delivers unaltered high frequencies and excellent low frequency response with exceptional accuracy from dual 8" woofers in a reasonably small cabinet.

System Highlights

Ability to Translate - An often-repeated phrase that we hear at KRK about our monitors' performance is their ability to translate. A mix made on your V-88's will translate to other environments and other monitors with no surprises. They will perform flawlessly for years in the professional and non-professional environment alike.

Flexibility - Your V-88 monitor contains an active input circuit specifically designed for balanced or unbalanced input signals. The audio input connector accepts XLR and ¼" phone or TRS connectors.

Active Filter Crossovers - Each monitor cabinet contains three active filters. (Subsonic, low-pass and high-pass filter) These three filters work together to deliver superior linear frequency response. Active filter crossovers generate less heat resulting in no signal drift or component variations to provide a more stable image.

Balanced Power - KRK's amplifier construction is proven, durable and straightforward. Output wattage is balanced to match LF and HF driver sensitivities and power handling. Your V-88 monitor uses a toroidal power transformer for lowest possible hum and minimum noise artifacts.

No Compression - Your V-88 contains no signal compression, which artificially limits the dynamic range of the program source found in some competing products. Although signal compression is often used to make monitors sound louder, fuller, and to control unwanted characteristics of the raw drivers, the result is a compromised mix. Your V-88 design is uncomplicated without extras between you and your mix.

Furniture-Grade Construction - The cabinetry of your V-88 is constructed from ¾" medium density fiberboard with a robust 1" thick front baffle. It is internally braced to minimize cabinet resonance. All cabinet edges and port openings are heavily radiused to reduce edge diffractions and port flutter. Cabinet finish is a neutral fingerprint proof gray Zolatone®.

Custom Made Drivers - KRK is renowned for using the highest performance drivers available in our products. Your V-88 carries on this tradition. A woven Kevlar® LF driver was custom-designed specifically for this cabinet volume with one goal in mind, "minimal compromises, no surprises". Kevlar® is one of the strongest, lightest, most rigid materials that can be used in modern speaker cone construction.

Troubleshooting

Problem: *If there is no power, check to see if...*

- The power cord is plugged into both the IEC socket on the rear panel of the unit and into the AC mains
- The AC mains voltage is matched to the operating voltage requirements (See *Changing Voltage* in the *Connecting the System* section on page 3). If the AC mains voltage is higher than the V-8's selected voltage it is possible that the fuse needs to be replaced. (See *Changing Fuses* in the *Connecting the System* section on page 3).
- The power light is illuminated on the front panel of the V-88. If not, turn the power switch OFF and check the A/C mains fuse(s). NEVER USE A LARGER AMPERAGE FUSE THAN IS SPECIFIED! Turn the power switch back on. The power light should illuminate.
- If a fuse change was needed and upon powering the monitor back up the fuse(s) blow again, the monitor needs to be returned to the dealer you purchased it from or to KRK for servicing.

Problem: *If you can't hear any sound...*

- Repeat steps in the previous troubleshooting section above before continuing to the next steps.
- Check to see if all other audio devices using the same AC outlet are still operating.
- Make sure that:
 - The audio source cable is plugged into both the source output and the monitor input.
 - The System Gain pot is turned up fully clockwise (+ 6 dB).
 - The signal source (E.g. mixing console, work station, CD player, etc.) is turned up to a level that can properly send a signal to the monitors.
 - If one of the monitors is working. Exchange the audio input cable from the non-working monitor to the working unit. This will determine whether it's really the monitor, a faulty cable, or some other glitch in the audio chain.
- If the monitor is still not responding, it should be returned to the dealer that you purchased it from or to KRK for servicing.

Problem: *If the monitor suddenly stops working...*

- Turn the monitor send down or off.
- Repeat steps in the troubleshooting sections above before continuing to the next steps.
- Carefully check to see if the amplifier's back plate is hot! If the monitor has been running at highest power output for an extended period of time, it could be that the unit has become overheated and the protection circuitry has shut the system down momentarily. The V-88 provides maximum circuitry protection against AC power surges, amplifier overdrive, and overheating of the amplifiers. Turn the monitor off then wait 30 minutes to allow the back plate to cool down. Turn the power switch back on.
- Increase the volume to check for normal operation.
- If the monitor is still not responding, it should be returned to the dealer that you purchased it from or to KRK for servicing.

Problem: *The sound quality changes...*

- Repeat steps in the previous troubleshooting section above before continuing to the next steps.
- Disconnect the signal cable at the input of the monitor. With power on, place your ear close to each driver (tweeter/woofer) and listen for noise (i.e., a slight hiss or hum). If there's absolutely no sound whatsoever, it could be that one or more of the drivers (woofer or tweeter or both) is at fault. It's also possible that the problem lies somewhere in the electronics.

- Play some non-distorted source material at a low volume. Carefully cover the tweeter (to block the sound) without touching the diaphragm. Is the woofer producing a clean sound? If there is not a clear tonal quality or any sound at all then the woofer probably needs to be replaced.
- Cover the woofer so you can hear mostly the tweeter. Is the tweeter producing a clear sound? If there is not a clear tonal quality or any sound at all then the tweeter probably needs to be replaced.
- Once you have a better idea of what may be at fault then call us and speak with someone in the service department. They will help you determine the best solution to correct your monitors. The service department can be reached at (714) 373-4600 ext. # 21.

Problem: *The monitor hisses, hums or makes other loud noises...*

Here are some suggestions that will help you eliminate these undesirables from your system:

- Make sure that the power cord is plugged snugly into the IEC socket on the rear of the monitor.
- Check the connections between the signal source and the monitor. The V-88's Neutrik® Combo connector is a completely balanced system. If you're connecting an unbalanced output to the monitor, be sure that you're using PIN 2 for signal and have PIN 1 and PIN 3 tied together at the source end.
- Refer to the *Connecting the System* section on page 4 of this manual to ensure that the AC mains is matched to the operating voltage requirements.
- All audio equipment should use the same ground point. Check all other devices using the same AC output in the building like dimmers, neon signs, TV screens, and computer monitors. These devices should not be using the same circuit.

For updated Troubleshooting information please visit our Web Site www.krksys.com .

Please read the warranty card that was included in the shipping carton of your monitor prior to shipping it back to KRK Systems, LLC. All products in need of repair can be returned to the dealer where it was purchased or to KRK Systems, LLC. at the following address:

**KRK SYSTEMS, LLC.
5452 BUSINESS DRIVE
HUNTINGTON BEACH, CA 92649
(714) 373-4600
ATTENTION: SERVICE DEPARTMENT**

- For the safest possible return to KRK, please use the shipping carton and packaging that your V-88 was originally shipped in.
- KRK cannot be responsible for any damages incurred during the shipping process due to poor packing. Make sure to insure your shipment.
- If your monitor is out of warranty and you would like a quotation prior to servicing your product, please include a note with your contact information on it and we will contact you with a service quote. Service will be performed once your method of payment has been established and approved.
- Replacement carton and packaging can be purchased from KRK Systems, LLC. for \$26.50 each.
- For replacement part quotes call (714) 373-4600 ext. #21.

Specifications

THE V-88 POWERED STUDIO MONITOR

Frequency Response	39Hz -23kHz \pm 2dB
High Frequency Driver	Shielded 1-1/4" (33mm) Polymer Dome with Elliptical Wave Guide
Low Frequency Driver	Two (2) shielded 8" (203.2mm) Woven Kevlar [®] , High Sensitivity Voice Coil
Cabinet	55 liter bass reflex 1" (25mm) and 3/4" (19mm) MDF construction, 50/50 Black / Gray Zolatone [®] Finish
Dimensions	20" W x 13-5/8" H x 16-3/4" D (279mm W x 406mm H x 425mm D)
Net Weight	50 lbs. ea. (17.27 kg)

THE V-88 AMPLIFIER

Power Rating	60 Watt HF Amplifier 160 Watt LF Amplifier
Signal to Noise	>90dB
T.H.D	<.05% at full output 1khz
Input Impedance	10k Ohms Balanced Input
Input Sensitivity	+6dB to -30dB
Gain	26dB (Fixed)
Power Consumption	160 VA

THE V-88 CROSSOVER

Crossover Frequency	2.3kHz
Crossover Slope	HF -12dB/Octave Butterworth LF -12dB/Octave Butterworth
Subsonic Filter	12dB/Octave -3dB @ 21Hz

FEATURES

- Neutrik[®] Combo Connector accepts XLR and 1/4" phone and TRS connectors
- IEC Mains Connector
- System Gain Control
- 3-Stage Selectable HF Gain Trim +1.0dB, Flat, -1.0dB
- 3-Stage Selectable LF Turnover Frequency -3dB @ 39Hz, 47Hz or 55Hz.
- LED Power Indicator
- Power On/Off Muting and Delay

KRK and V-88 are registered trademarks of KRK Systems, LLC.

Safety Instructions: English



This symbol is intended to alert the user of important operating and maintenance (servicing) instructions in the literature provided with the equipment.



This symbol is intended to alert the user of the presence of un-insulated "dangerous voltage" within the products enclosure that may present a risk of electric shock.



Caution: To prevent the risk of shock, do not remove the cover (or open the speaker enclosure). There are no user serviceable parts inside. Refer servicing to qualified service personnel.

CAUTION

Retain Instructions: The Safety instructions should be kept for future reference.

WARNING

Power Sources: This equipment should be operated only from power source indicated on the product. This equipment is intended to be used with a main power system with a grounded (neutral) conductor. The third (grounding pin) is a safety feature, do not attempt to bypass or disable.

Servicing: Refer all Servicing to qualified personnel. Do not attempt to remove covers or disassemble monitor enclosure because opening or removing covers may expose you to dangerous voltage or hazards.

This monitor is capable of producing very loud sound pressure levels. Caution should be taken to protect your ears with OSHA approved noise suppression devices to avoid permanent hearing loss.

Explanation of graphical symbols



The lightning flash with arrowhead symbol, within an equilateral triangle, is intended to alert the user to the presence of uninsulated “dangerous voltage” within the product’s enclosure that may be of sufficient magnitude to constitute a risk of electric shock to humans.



The exclamation point within an equilateral triangle is intended to alert the user to the presence of important operating and maintenance (servicing) instructions in the literature accompanying the product.

CAUTION: To reduce the risk of electric shock, do not remove the cover. No user-serviceable parts inside. Refer servicing to qualified service person.

WARNING: To prevent fire or electric shock, do not expose this equipment to rain or moisture.

Consignes de Securite: Francais



Ce symbole sert à avertir l'utilisateur que la documentation fournie avec le matériel contient des instructions importantes concernant l'exploitation et la maintenance (rèparation)



Ce symbole sert à avertir l'utilisateur de la présence dans le boîtier de l'appareil de "tensions dangereuses" non isolées posant des risques d'électrocution.



Attention: Afin d'éviter tout danger d'électrocution, ne pas enlever le couvercle(ni ouvrir le boîtier). Aucun des éléments internes ne peut être réparé par l'utilisateur. S'adresser à un technicien de maintenance qualifié

Attention

Lire les instructions- Prendre connaissance de toutes les consignes de sécurité et d'exploitation avant d'utiliser le matériel.

Avertissement

Alimentations Ne faire fonctionner ce matériel qu'avec la source d'alimentation indiquée sur l' appareil. Ce matériel doit être utilisé avec une alimentation principale comportant un fil de terre (neutre). Le troisième contact (de mise à la terre) constitue un dispositif de sécurité: n'essayez pas de la contourner ni de la désactiver.

Réparation-maintenance Faire exécuter toutes les interventions de réparation-maintenance par un technicien qualifié. L'utilisateur ne doit pas essayer de procéder lui-même à ces opérations car l'ouverture ou le retrait des couvercles risquent de l'exposer à de hautes tensions et autres dangers.

Explication des symboles graphiques



Le symbole "éclair" avec flèche à l'intérieur d'un triangle équilatéral est utilisé pour alerter l'utilisateur de la présence à l'intérieur du coffret de "voltage dangereux" non isolé d'ampleur suffisante pour constituer un risque d'électrocution.



Le symbole d'exclamation à l'intérieur d'un triangle équilatéral est employé pour alerter les utilisateurs de la présence d'instuctions importantes pour le fonctionnement et l'entretien (service) dans le livret d'instructions accompagnant l'appareil.

ATTENTION: Pour éviter les risques de choc électrique, ne pas enlever le couvercle. Aucun entretien de pièces intérieures par l'usager. Confier l'entretien au personnel qualifié.

AVIS: Pour éviter les risques d'incendie ou d'électrocution, n'exposez pas cet article à la pluie ou à l'humidité.

Free Manuals Download Website

<http://myh66.com>

<http://usermanuals.us>

<http://www.somanuals.com>

<http://www.4manuals.cc>

<http://www.manual-lib.com>

<http://www.404manual.com>

<http://www.luxmanual.com>

<http://aubethermostatmanual.com>

Golf course search by state

<http://golfingnear.com>

Email search by domain

<http://emailbydomain.com>

Auto manuals search

<http://auto.somanuals.com>

TV manuals search

<http://tv.somanuals.com>