

www.krups.com

E  
F



# KRUPS

# IMPORTANT SAFEGUARDS

When using electrical appliances, basic safety precautions should always be followed to reduce the risk of fire, electric shock and/or injury to persons, including the following:

- 1 - Read all instructions prior to first use.
- 2 - Do not touch hot surfaces. Use handles or knobs.
- 3 - To protect against fire, electric shock and injury to persons, do not immerse cord, plugs or machine in water or other liquid, keeps hands and utensils out of the bean container while grinding and when the machine is plugged in.
- 4 - Do not put water into the coffee bean container and/or under the servicing flap.
- 5 - Not intended for use by children.
- 6 - Close supervision if necessary when any machine is used near children. Keep machine out of reach of children.
- 7 - Burns can occur from touching hot plate, hot water or steam. Exercise caution.
- 8 - Exercise caution when using the steam nozzle as steam can cause scalding.
- 9 - Unplug machine from outlet as soon as you stop using it over a prolonged period and when you clean it. Allow to cool before putting on or taking off parts, before cleaning the machine and before storing.
- 10-All machines are subject to stringent quality control. Practical tests using machines taken at random are conducted and this may explain any slight marks or coffee residue showing prior to use.
- 11-Do not operate any machine with a damaged cord or plug or after the machine malfunctions, or has been damaged in any manner. Return machine to the KRUPS Service Center for examination, repair or adjustment .
- 12-To reduce the risk of injury do not drape cord over the counter top or table top where it can be pulled on by children or tripped over unintentionally.
- 13-Do not let cord hang over edge of table or counter or touch hot surfaces.
- 14-The use of accessory attachments not recommended by KRUPS may result in fire, electric shock or injury to persons.
- 15-Do not use outdoors.
- 16-Do not place on or near a hot gas or electric burner, or in a heated oven.

## English

- 17-To disconnect the machine, turn the control to “OFF”, then remove plug from wall outlet. Do not yank cord, instead grasp plug and pull to disconnect.
  - 18-Do not use appliance for other than intended use.
  - 19-Do not pour liquids other than water and descaling solutions specified in this manual into the water tank.
  - 20-Protect the machine against humidity and freezing.
  - 21-This machine is for household use only.
  - 22-This appliance is not intended for use by persons (including children) with reduced physical, sensory or mental capacities, or lack of experience and knowledge, unless they have been given supervision or instruction concerning use of the appliance by a person responsible for their safety. Children should be supervised to ensure that they do not play with the appliance.
  - 23- Appliance for household use only, do not immerse in water.
- ◆ **Appliance with Glass carafe:**
- A. The carafe is designed for use only with this appliance. It must never be used on a range top.
  - B. Do not set a hot carafe on a wet or cold surface.
  - C. Do not use a cracked carafe or a carafe having a loose or weakened handle.
  - D. Do not clean carafe with harsh cleansers, steel wool pads, or other abrasive materials.
  - E. Do not use the carafe over an open flame, on an electric stovetop or in an oven (micro-wave or not).

# SAVE THESE INSTRUCTIONS

## CAUTION

This machine is for household use only. Any servicing other than cleaning and user maintenance should be performed by the nearest authorized Krups Service Center. Visit our website at [www.krups.com](http://www.krups.com) or contact our Consumer Service department for the service center nearest to you.

To reduce the risk of fire or electric shock, do not dismantle the machine. Repairs should be done by an authorized KRUPS Service Center only.

Do not operate the interlock lid while the appliance brewing or grinding.

# SHORT CORD INSTRUCTIONS

- A. We do not recommend using an extension cord with this device.**
- B. If an extension cord is absolutely necessary :**
  - 1 - the marked electrical rating of the extension cord should be at least as great as the electrical rating of the machine.**
  - 2 - the longer cord should be arranged so that it will not drape over the counter top or table top where it can be pulled on by children or tripped over.**
- C. This appliance has a polarized plug (one blade is wider than the other). To reduce the risk of electric shock, this plug is intended to fit into a polarized outlet only one way. If the plug does not fit fully in the outlet, reverse the plug. If it still does not fit, contact a qualified electrician. Do not attempt to modify the plug in any way.**

**In the interest of improving products, Krups reserves the right to change specifications without prior notice.**

## English

## DESCRIPTION

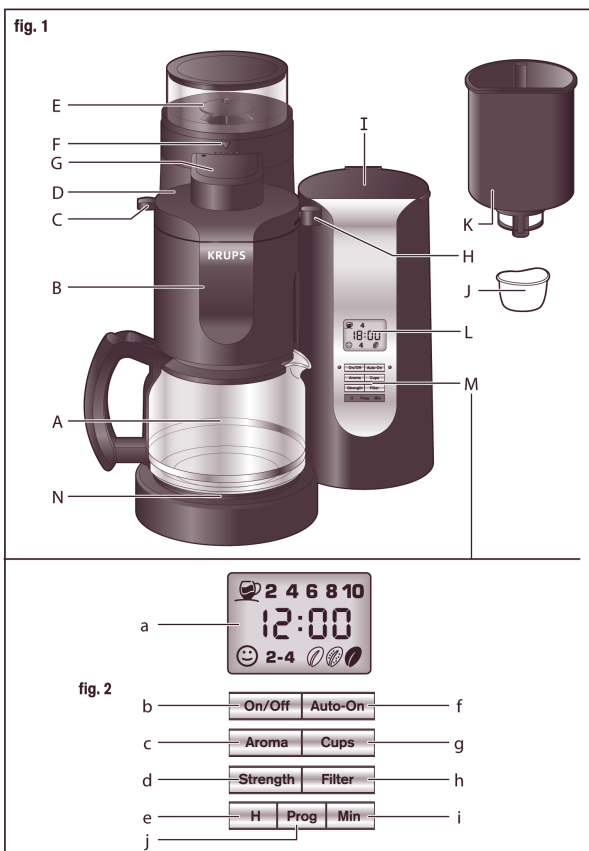

- A** Carafe
- B** Swivel filter holder
- C** Brew basket cover return lever
- D** Swivel brew basket cover
- E** Coffee bean compartment
- F** Fineness of grind adjustment
- G** Ground coffee supply channel with clear lid
- H** Brew basket cover latch release
- I** Water tank with lid
- J** Duo Filter
- K** Water filtration insert
- L** Display
- M** Adjustment and programming buttons
- N** Warming plate

**Control panel (figure 2)**

- a** Display: time (or programmed time), number of cups, coffee strength, filter check, aroma function indicator
- b** On/Off button
- c** Aroma selector
- d** Adjustment of the strength of the coffee
- e** Adjustment of hours and programming of hours
- f** Activation of programmed start-up
- g** Selector for the number of cups
- h** Water filter check
- i** Adjustment of minutes and programming of minutes
- j** Programming the start-up time

## BEFORE USING FOR THE FIRST TIME

- When it is first plugged in the display blinks “12:00” you must set the correct time to continue. Use the hour and minute buttons then press program.
- Before brewing coffee for the first time, run one cycle with 10 cups (full carafe) of cold water with no coffee filter, no coffee and without the “Duo Filter” in place.
- With the water tank full and the filter holder (B) locked in place press the On/Off button.
- When the brew cycle is complete dispose of the water.

## THE WATER

The water is a critical factor in the taste of your brewed coffee. Filtered water is normally the best choice. Never use hot water. Never pour milk, prepared coffee, tea, etc... into the water tank.

### Your coffee maker can be fitted with a “Duo Filter”:

- **The “Duo Filter” is an anti-chlorine and anti-scale filter.**

The filter’s **anti-chlorine** action brings out the most delicate aromas of the coffee. Tap water often has a level of chlorine which prevents the full aromas of the coffee from developing.

The **anti-scale** action of the filter helps prevent minerals in the water from collecting on the heating element and in the hot water tubes. Scale eventually will slow the performance of the machine if not kept in check. Change your “Duo Filter” after 70 cycles and when the machine begins to brew too slowly.

The components of the “Duo Filter” (non-polluting activated carbon of plant origin and anti-scale resin) meet all currently applicable food-related legislation. It contains silver salts that act as a bacteriostat, which protects the consumer. This filter has been successfully tested by approved laboratories.

### Installing the “Duo Filter”:

- Take the “Duo Filter” (**figure 1/J**) out of its plastic bag. Rinse it under the tap for 1 minute.

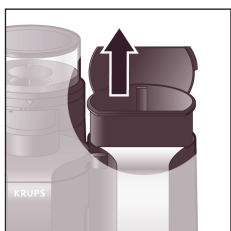

- Lift the lid of the water compartment and remove the water filtration insert.

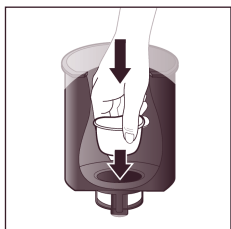

- Fit the filter into place.

## English

- Place the filter holder back in the coffee maker: the coffee maker is ready to be used. Please remember that the “Duo Filter” must be replaced after 70 uses (or after 2 months), in order to ensure the filtration is as effective as possible. The old “Duo Filter” cannot be cleaned or recycled. It must be replaced by a new one. The “Duo Filter” can be thrown away with household waste.

### Important:

- The “Duo Filter” must only be used with drinking water. Remove it when descaling the machine.
- Rinse the “Duo Filter” under running tap water if the coffee maker has not been used for over a month.
- It is recommended that the “Duo Filter” is not left in place for more than 5 months.

### Replacing the “Duo Filter”:

The machine can be set to remind you after 70 brew cycles that it is time to replace the “Duo Filter”.

- Press the **Filter** button and the symbol ☺ is displayed. After 70 cycles, at the latest after 2 months, the symbol begins to flash indicating that it is time to replace the “Duo Filter”.
- Replace the filter then press the **Filter** button for more than 3 seconds. This resets the cycle counter to zero and displays the ☺ symbol to indicate the filter is within its recommended service life.

**Note:** The counter is reset each time the **Filter** button is pressed. If you wish to disable the cycle counter, press the **Filter** button briefly: the ☺ symbol disappears.

## BREWING COFFEE

### Using the conical burr grinder:

**Note:** The grinding program can be activated only when the filter basket holder (**figure 1/B**) is in place beneath the coffee channel (**figure 1/G**) and the cover (**figure 1/D**) is locked into the open position.

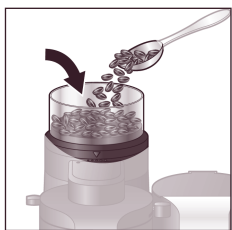

1) Add beans to the grinder.

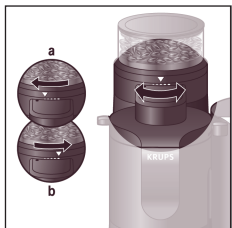

2) Check the grinder setting, start with the coarse setting and adjust to match the beans and your preferred taste.



- 3) Swivel the filter out (figure 1/B).  
Insert #4 paper filter or permanent filter into the brew basket.  
Push the swivel filter holder back into place.



- 4) Fill the tank. Cups are measured as 5 oz each.

- 5) Set number of cups to match the water in the tank using the **Cups** button.

**Aroma Function:** For small batches of 2-4 cups use the aroma function **Aroma**. Small amounts of water and coffee tend to brew too quickly for proper extraction of flavor. The aroma function heats and dispenses water in timed intervals to extend the cycle to its ideal duration.

- 6) Set the desired strength setting using the **Strength** button.  
Start with medium strength and adjust subsequent cycles to match the beans and your preferred taste. Mild, medium and strong brew cycles are indicated on the display with the symbols **000**.



Place the carafe (**figure 1/A**) with its lid onto the warming plate (**figure 1/N**).

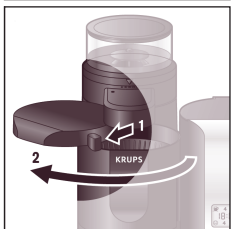

Swivel the cover using the lever until it locks.

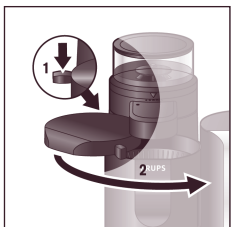

The cover can be closed manually with the release lever (**figure 1/C**).  
The grinder is deactivated when the cover is closed.



## English

### To brew immediately:

- Press the **(On/Off)** button. The grinder will run for a set amount of time.
- The brew basket cover swings shut automatically and the brew cycle begins.

## AUTO-ON FUNCTION

The machine can be set to automatically brew at any time in the following 24 hours. This feature can be used with or without the grinder.

- Press the program button quickly **(Prog)**: the green light flashes.
- Program the start-up time using the **(H)** and **(Min)** buttons. You can continue to program the cycle start-up time for as long as the green light is flashing. If the light has already stopped flashing before you have finished setting the time, press the program button again.
- Around 3 seconds after the last button is pressed, the green light stops flashing. The data that was entered is then memorized. The current time and settings are displayed.

Follow the preparation instruction listed above then press **(Auto-On)** instead of **(On/Off)**. The **(Auto-On)** is active when the green light is on. To deactivate press **(Auto-On)**.

At the start-up time, the grinder will run automatically for a set amount of time, and the brew basket cover (**figure 1/D**) swings short automatically and the brew cycle will begin.

### Anti-drip valve - stop and serve:



You can remove the carafe during the brew cycles to pour an early cup. Keep in mind that this will change the taste you would normally get from a full pot in a complete cycle. Be sure to replace the carafe quickly to avoid overflow during the brew cycle.

## AUTO-OFF FUNCTION

The heating plate will maintain the temperature in the carafe for up to 2 hours after which the machine shuts off automatically. This is for safety and convenience. For best results brew only as much coffee as you will drink within 30-60 minutes, or transfer the coffee to a thermal carafe immediately after brewing.

## THE COFFEE

Choose your beans wisely. It is best to use premium whole beans from a trusted brand or roaster. Arabica beans provide the best flavors and have less caffeine and while Robusta beans are easier to grow and less expensive, they have less flavor and higher caffeine content. Robusta beans are sometimes used in blends to add a particular bitterness to the brew.

Beans can be roasted very lightly to provide a smooth aromatic taste or roasted dark to provide stronger flavors, and anywhere in between.

A good roaster will be able to describe the flavors that the beans will impart to your brewed coffee.

**Note:** Experiment with different beans and different roasts to identify one or several that suit your tastes.

## THE RATIO

The amount of ground coffee must be carefully measured against the volume of water for each brew cycle. It is important to use enough coffee to avoid over extraction. A small amount of coffee would be overwhelmed by a large volume of hot water. The carafe measures "cups" as 5 oz each. Maximum capacity is slightly more than 50 oz total water volume before brewing. The volume of brewed coffee will be slightly less because the ground coffee will absorb a certain amount. Always use fresh cold water. Filtered water is preferable. Never put any liquid other than water in the water tank. The machine will freshly grind whole beans as part of the automatic programmed cycle. Experiment with your favorite beans to find the settings that produce your perfect cup.

**Note:** Different roasts move through the grinder at different rates

- Light roasts: grind quickly, adding more coffee per cup
- Dark roasts: grind more slowly, adding less coffee per cup at the same setting.

The STRENGTH settings (**figure 2/d**) control the grinding time for each cup setting (2-4)(2-10) see coffee strength section, page 12, for more info.

**Note:** For best results the ground coffee supply channel (**figure 1/G**) should be full before brewing.

## THE GRIND

The method of grinding has significant impact on the resulting taste of the brewed coffee. The professional grinder in this machine is one of the best methods for grinding coffee beans. The conical steel burrs turn slowly to reduce heat that can damage the delicate oils and aromas in the beans. The grinder also produces grounds with consistent particle size. This effect allows uniform extraction and a smoother, more balance taste in the cup.

### Adjusting the grind :

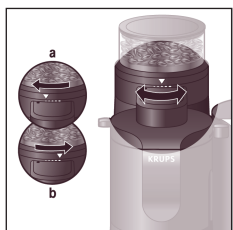

The grinder has 5 settings to allow adjustments from fine to coarse.

The range of settings is limited to those that are appropriate for drip brewed coffee.

Start by using the most coarse grind setting which we have set for use with most coffees, and in particular for medium to dark roasts.

For a slightly stronger taste choose a lower setting to grind finer.

Try these settings with lighter roasted beans.

### Adding beans:

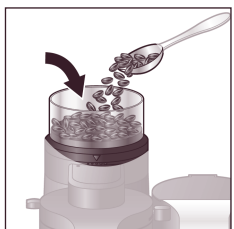

When brewing full pots you will need to add beans to the grinder before every cycle.

Other factors, smaller batches and dark, oily beans will not use the beans as quickly.

Always check that you have enough beans for the current brew cycle.

The bean compartment has a total capacity of approximately 125 grams.

Be sure that the water tank lid is well closed to avoid a coffee bean falling in the water tank and clogging it.

## English

### Storing beans:

Whole beans maintain freshness for up to a year in a vacuum sealed or nitrogen flushed bag. Good quality bags have a one-way valve that allows gas and heat (from roasting) to escape but no air to enter the bag. Once freed from their quality packaging the clock begins ticking.

The greatest dangers to roasted coffee beans are air, moisture, and light.

Store unused beans in an air tight, opaque container, away from direct sunlight or extreme temperatures. Beans kept in a freezer can collect moisture from the freezing and thawing process and worse could absorb flavors from the foods stored around it.

## ONLY WHEN USING THE GRINDER

### Number of cups:

Use the **Cups** button (**figure 2/g**) to tell the machine how much water you have added to the tank. There are settings for 2-4-6-8 and 10 cups. The machine automatically grinds the coffee based on number of cups and coffee strength chosen.

### Coffee strength:

Use the **Strength** button (**figure 2/d**) to choose mild, medium or strong coffee. Experiment with your particular beans starting with medium setting. By adjusting the next brew cycle to mild or strong you can grind more or less coffee for the same number of cups.

### To brew very strong coffee:

If you have brewed on the STRONG setting but still would prefer a stronger result set the machine to a higher cup setting than the actual amount of water with the strength setting on STRONG.

For example :  
 Press the **Cups** button to the maximum 10 cups  
 Press the **Strength** button to the STRONG setting  
 Add only 8 cups of water to the tank.

**Note:** Dark roasted coffees often provide a bolder taste. If you prefer very strong coffee you might try a darker roast.

## STOPPING THE APPLIANCE

Turn the machine off using the **On/Off** button (**figure 2/b**).

## USING ALREADY GROUND COFFEE

You can make your coffee using already ground coffee, either immediately (normal mode), or by programming a scheduled start (auto mode).

When using ground coffee, the coffee strength and cup number settings are not operational. You therefore do not need to adjust or modify them.

### Immediate preparation of coffee (normal mode):



- Fill the water compartment with cold water using the carafe.

## English



- Swivel the filter holder out.
- Check that no ground coffee is in filter basket, then place #4 coffee filter in filter holder.

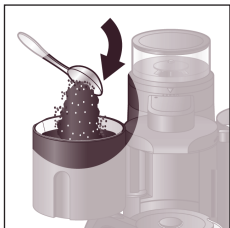

- Pour in the ground coffee. Push the swivel filter holder back into place.
- We advise you 5 to 7 grams per cup, respectively for mild, medium or strong coffee.



- Place the carafe with its lid onto the warming plate.

- Then press the **On/Off** button. The red light comes on and the brewing cycle begins.
- As long as the red **On/Off** button light is on, this is the only button that can be used.

**To program an auto-on time, see page 8 for the section titled AUTO-ON FUNCTION**

## CLEANING

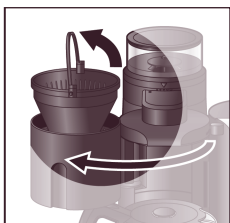

- Used ground coffee and the paper filter can be disposed in the trash or compost. Do this soon after brewing. Do not let wet coffee sit in the machine overnight.

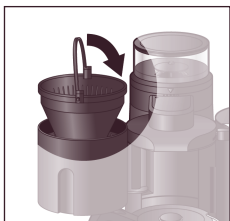

- The filter basket holder has a handle to allow easy disposal of the grounds.
- The filter basket holder should be cleaned regularly with soap and water. To properly seat the filter basket use the handle to drop it into place then lower the handle until it locks into position. The filter holder will not swivel unless the filter basket handle is seated properly.

## English

The coffee channel has a clear cover that can be removed using a pointed object such as a ball point pen. Periodically remove the cover to clean any heavy residue that may collect, especially from grinding dark, oily beans. If left to collect these oils can eventually lend a stale taste to the coffee or clog the channel and effect the performance of the machine.

### Proceed as follows :

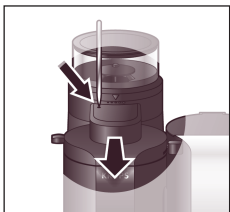

- Unplug the device.
- Unlock the clear cover of the grinder channel using a sharp object (for example a ballpoint pen), and remove the lid by pulling it forward.

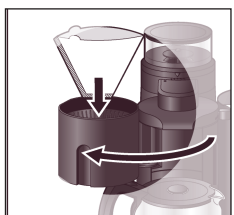

- Swivel the brew basket out.
- Place a coffee filter paper in the brew basket. Push the swivel basket back into place.

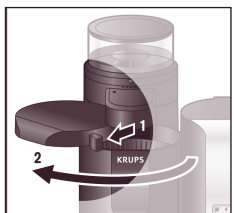

- Swivel the brew basket cover using the lever until it locks.

- Using a brush, clean out the remains of coffee (including in the rear section of the channel). You can also use a vacuum cleaner to remove the remains of the coffee.
- Wipe the grinder channel using a dry cloth.
- Throw away the coffee filter paper.

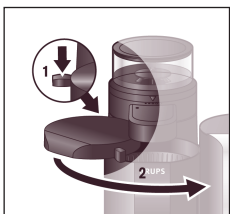

- Press down on the return lever in order to bring the brew basket cover back to its initial position.

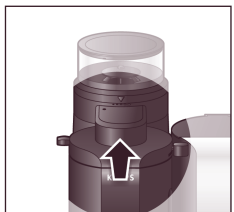

- Put the clear cover back on the channel by sliding it back until it clicks. Press the locking system down. Check that the lid is in position correctly.
- The appliance is ready to be used again.

## English

Using strongly roasted, oily beans means that the grinder channel has to be cleaned out more often than with lightly roasted beans.

To prevent the grinder channel from becoming blocked:

- Do not use frozen coffee beans.
- Keep the coffee bean compartment closed at all times.
- Regularly clean the coffee bean compartment (**figure 1/E**) using a dry cloth, in order to remove the oily residues.

To clean the outside of the machine unplug it first, then wipe with damp cloth or sponge.

Avoid using any harsh cleaning agents that can damage the surface or affect the taste of your coffee.

## DESCALING

Your coffee machine should be descaled periodically or whenever the brew cycle has slowed noticeably.

Normally it should not take more than 10 minutes to brew a full pot. It is recommended to descale at least every 3 months using a descaling solution designed for use in coffee machines.

Visit Krups website [www.Krupsonlinestore.com](http://www.Krupsonlinestore.com) for approved descaling products.

- Before descaling remove the "Duo Filter" from the water tank and remove the permanent filter (if applicable) from the brew basket:

- \* Fill the water tank and add the descaling powder to the water.
- \* Press ON and let 1/2 the water run through and into the carafe, then turn the machine off.
- \* Let the solution sit in the machine for 20-30 minutes.
- \* Turn the machine ON again and let the rest of the water run through.
- \* Discard the water and run another cycle with clean water to rinse the system.

## CORD STORAGE

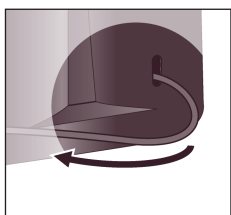

Your coffee maker has a cord storage compartment for the power cord. The cord can be adjusted to the length needed by pushing it back into the machine.

## ACCESSORIES

- Paper filters : item 983
- Gold Tone Filter : item 049
- Anti-scale, anti-chlorine water filter : item 472-00 (2 per box)
- Descaling kit : item 42821 (3 per box)

These items are available at your local Krups retailer or for home delivery in the US [www.Krupsonlinestore.com](http://www.Krupsonlinestore.com)

## English

### IN THE EVENT OF A PROBLEM

PROBLEM	POSSIBLE SOLUTIONS
Coffee is very weak	<ul style="list-style-type: none"> <li>- Use more ground coffee (see "The ratio" page 9)               <ul style="list-style-type: none"> <li>* when using the grinder :                   <ul style="list-style-type: none"> <li>. use medium or strong strength setting</li> <li>. be sure the ground coffee supply channel is full before grinding and brewing</li> </ul> </li> </ul> </li> <li>- Try a darker roast bean.</li> </ul>
Coffee brews too slowly (more than 10 minutes)	<ul style="list-style-type: none"> <li>- Descal the machine (see "Descaling" page 13)</li> <li>- Clean the brew basket and drip stop valve of coffee residue. Also clean the permanent filter if applicable.</li> <li>- Check that there are no issues with the power supply.</li> <li>- Use a different quality coffee paper.</li> <li>- Check that any coffee bean is not clogging the tank bottom.</li> </ul>
Brew basket will not swivel closed	<ul style="list-style-type: none"> <li>- The filter holder must sit down into the brew basket, and the handle click into place.</li> <li>- Use the handle to seat the filter holder then fold the handle down and press until it locks into place.</li> </ul>
Problems with programming the Auto-on or the clock.	<ul style="list-style-type: none"> <li>- Turn the machine off and unplug it from the power source. Wait 1 minute and reconnect. This can allow the electronics to reinitialize to factory settings.</li> </ul>
The stop-drip does not work	<ul style="list-style-type: none"> <li>- Clean the valve under running water, manually activating the stop-drip.</li> </ul>
The coffee-grinder is excessively noisy (non-coffee objects in the grinding mechanism).	<ul style="list-style-type: none"> <li>- Make sure there is no stone, wood, etc. that may have been introduced through your supply of coffee-beans.</li> <li>- Check if, during following preparations, the noise persist.</li> <li>- Contact the Krups Service Center.</li> </ul>
The grinder is obstructed	<ul style="list-style-type: none"> <li>- Make sure there is no stone, wood, etc. that may have been introduced through your supply of coffee-beans.</li> <li>- Don't use caramelized or treated with additives sugar based, coffee beans.</li> <li>- Don't use too oily coffee beans.</li> </ul>

English

## LIMITED WARRANTY

This Krups' product is warranted for 1 year from the date of purchase against defects in material and workmanship. During this period, the Krups' product that, upon inspection by Krups, is proved defective, will be repaired or replaced, at Krups' option, without charge to the customer. If a replacement product is sent, it will carry the remaining warranty of the original product. This warranty does not apply to any defect arising from a buyer's or user's misuse of the product, negligence, failure to follow Krups' instructions, use on current or voltage other than that stamped on the product, wear and tear, alteration or repair not authorized by Krups, or use for commercial purposes, or appliances not descaled as specified.

THE WARRANTIES SET FORTH HEREIN ARE EXCLUSIVE AND NO OTHER WARRANTIES, EXPRESS OR IMPLIED, INCLUDING BUT NOT LIMITED TO ANY WARRANTY OF MERCHANTABILITY OR FITNESS FOR A PARTICULAR PURPOSE OR USE, ARE MADE BY KRUPS OR ARE AUTHORIZED TO BE MADE WITH RESPECT TO THE PRODUCT.

Some states do not allow limitations on how long an implied warranty lasts or do not allow the exclusion of incidental or consequential damages, so the above limitations may not apply to you.

This warranty gives you specific legal rights, and you may also have other rights, which vary from state to state.

If you believe your product is defective, take the product (or send it postage prepaid) along with proof of purchase to the nearest authorized Krups Service Center. (To find the nearest authorized Krups Service Center visit the Krups website or contact the Krups Consumer Service in your country indicated below).

If you send the product, please include a letter explaining the nature of the claimed defect.

Krups Service Centre locations can be found by visiting the website :

[www.krupsUSA.com](http://www.krupsUSA.com) in the USA or

[www.krups.ca](http://www.krups.ca) in Canada.

When shipping the product to the service center please include a note explaining the issue, a copy of the sales receipt and provide a valid return address on the outside of the shipping box (no PO Boxes).

If the product is out of warranty or warranty can't be validated, the service center will send an estimate of repair for your approval.

### CONSUMER SERVICE

If you have additional questions, please call our Consumer Service Department. It is helpful to have the product available at the time of your call and to know the reference number that can generally be found on the base of the product.

#### USA :

Phone 1-800-526-5377

Hours\* Monday – Friday from 8:00 a.m. – 6:30 p.m. (EST)

Letters should be addressed to :

#### **Krups**

196 Boston Avenue

Medford, MA 02155

Only letters can be accepted at this address. Packages without a return authorization number will be refused.

#### CANADA :

Phone 1-800-418-3325

Hours\* Monday – Friday 8:30 a.m. – 4:30 p.m. (EST)

Letters should be addressed to

#### **Groupe SEB Canada Inc.**

455 Finchdene Square

Scarborough, Ontario M1X 1B7

\*Please note hours are subject to change.



# PRÉCAUTIONS IMPORTANTES

Lors de l'utilisation d'appareils électriques, les règles de sécurité élémentaires doivent toujours être respectées pour réduire les risques d'incendie, de choc électrique et de blessures, y compris les suivantes :

- 1 - Lire attentivement toutes les directives avant d'utiliser la machine.
- 2 - Ne pas toucher les surfaces chaudes. Utiliser les poignées et les boutons.
- 3 - Pour prévenir les risques d'incendie, de choc électrique et de blessures, ne pas immerger le cordon d'alimentation, la prise ou la machine dans l'eau ni dans tout autre liquide, ne pas insérer les mains ou des ustensiles dans le contenant à grains de café lorsqu'il fonctionne et lorsque la machine est branchée.
- 4 - Ne pas verser de l'eau dans le contenant à grains de café ni dans la porte de service.
- 5 - Cette machine n'est pas destinée à être utilisée par des enfants.
- 6 - Une surveillance étroite est nécessaire lorsque la machine est utilisée à proximité des enfants. La garder hors de la portée des enfants.
- 7 - Des blessures peuvent survenir suite au contact avec la plaque chauffante, l'eau chaude ou la vapeur. Utiliser avec précaution.
- 8 - Faire preuve de prudence lors de l'utilisation de la buse à vapeur car cette dernière peut ébouillanter.
- 9 - Débrancher la machine de la prise murale si elle n'est pas utilisée pendant une période prolongée et avant de la nettoyer. Laisser la machine refroidir avant d'ajouter ou de retirer des pièces, avant de la nettoyer et de la ranger.
- 10-Toutes nos machines sont soumises à un rigoureux contrôle de la qualité. Des tests pratiques ont été effectués sur des machines sélectionnées au hasard et cela peut expliquer qu'il y ait de petites traces de café ou de résidus avant la première utilisation.
- 11-Ne pas utiliser une machine dont le cordon ou la prise est endommagé, ou si la machine fonctionne mal ou si elle a été endommagée de quelque manière que ce soit. La retourner au centre de service agréé KRUPS le plus près pour qu'elle soit examinée, réparée ou ajustée.
- 12-Pour réduire les risques de blessures, ne pas laisser le cordon pendre d'une table ou d'un comptoir, où elle pourrait être tirée par un enfant ou faire trébucher quelqu'un accidentellement.
- 13-Ne pas laisser le cordon pendre d'une table ou d'un comptoir, ni entrer en contact avec les surfaces chaudes.

## Free Manuals Download Website

<http://myh66.com>

<http://usermanuals.us>

<http://www.somanuals.com>

<http://www.4manuals.cc>

<http://www.manual-lib.com>

<http://www.404manual.com>

<http://www.luxmanual.com>

<http://aubethermostatmanual.com>

Golf course search by state

<http://golfingnear.com>

Email search by domain

<http://emailbydomain.com>

Auto manuals search

<http://auto.somanuals.com>

TV manuals search

<http://tv.somanuals.com>