

DVD VCD CD MP3

Lanzar[®]



DVD

**Operating
Instructions**

**Half Din DVD/CD/MP3 Player
SD.51N**



Download from [Www.Somanuals.com](http://www.Somanuals.com). All Manuals Search And Download.

Thank you for purchasing 1/2 DIN DVD player. Please read this manual carefully before operating and reserve it for future reference. It will be helpful to you if you encounter any operational problem.

WARNING: TO REDUCE THE RISK OF FIRE OR ELECTRIC SHOCK, DO NOT EXPOSE THIS APPLIANCE TO RAIN OR MOISTURE, DRIPPING OR SPLASHING AND THAT NO OBJECTS FILLED WITH LIQUIDS, SUCH AS VASES, SHALL BE PLACED ON THE APPARATUS. DANGEROUS HIGH VOLTAGES ARE PRESENT INSIDE THE ENCLOSURE. DO NOT OPEN THE CABINET. REFER SERVICING TO QUALIFIED PERSONNEL ONLY.

ATTENTION: TO PREVENT ELECTRIC SHOCK, MATCH WIDE BLADE OF PLUG TO WIDE SLOT, FULLY INSERT.

Keypad in the main unit



1 Power button

Power on/off the unit

2 Stop button

Press this to stop play mode

3 Play/Pause/On button

Press this to play disc. When press this in the play mode, pause mode is set. Press again to resume playback.

4 IR

Remote control incept window

5 Previous/Next buttons

Using these buttons to scan forward or backward through the tracks or chapters.

6 Eject button

Press this button to eject the disc when a disc is in the main unit

8 Remote sensor

Remote control incept the induce jack. When the remote control connect the inductor. It's can receive the IR signal from the remote control.



7 Power

DC 12V, 1.5A input

Notes:

Red wire: REM

Yellow wire: DC 12V

Black wire: GND

9 Audio output R

10 Audio output L

11 Video output

12 OPTCAL output

CONNECTING THE PLAYER TO OTHER COMPONENTS

3

Before connecting

Turn off the power of the player and the devices to be connected.

Connecting to a TV set

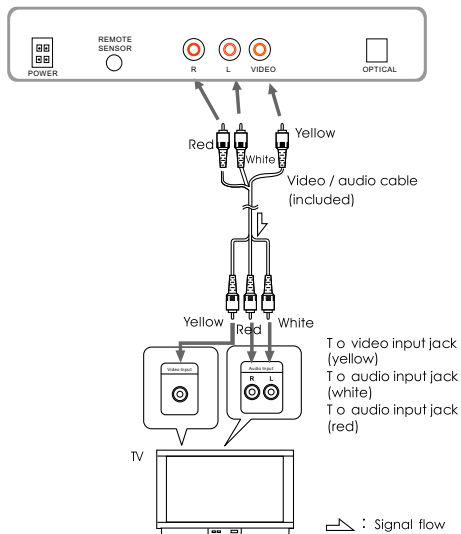

CONNECTING THE PLAYER TO OTHER COMPONENTS

4

Connecting to a digital amplifier that is not Dolby Digital / DTS / MPEG compatible

Notes:

Do not play DVDs when the audio settings are not correct. Or may cause strong noise and damage your speakers.

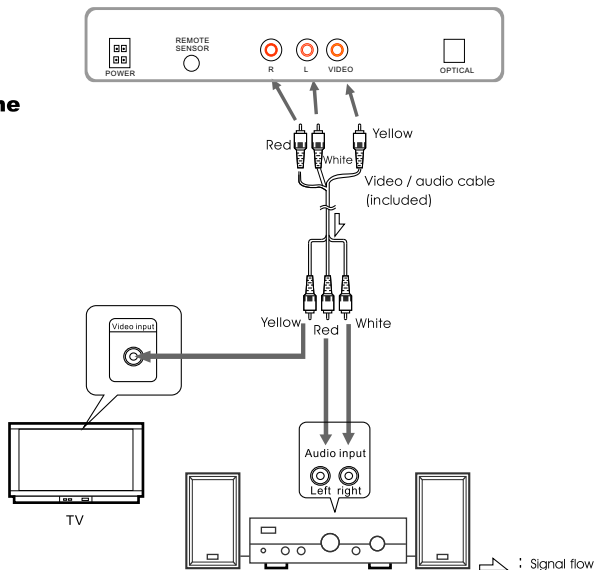

Connecting to active speaker systems

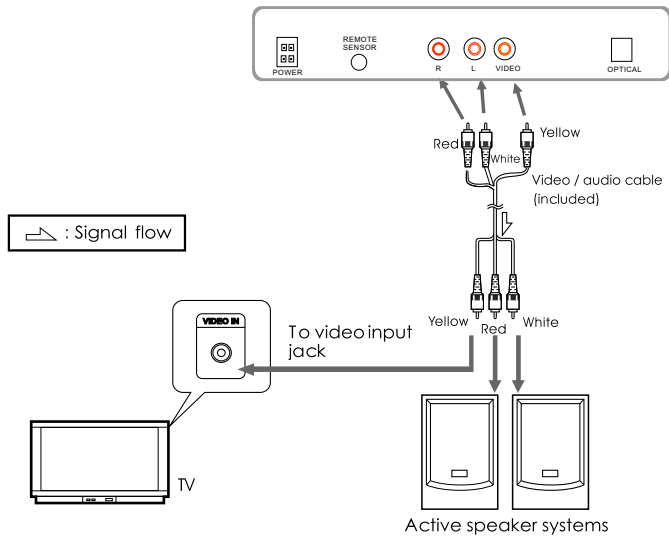

Remote control unit

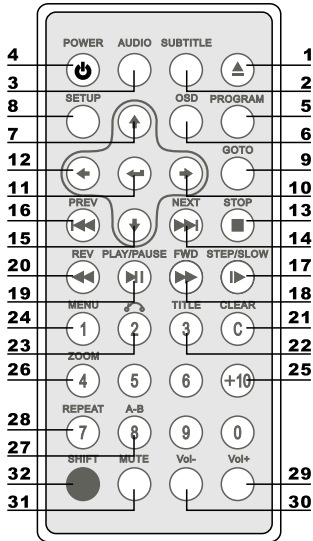

1 EJECT

Eject the disc

2 SUBTITLE

Selecting sub-title

3 AUDIO

DVD: selecting audio language

VCD or CD: Selecting the audio channel

4 POWER

Power on/off the unit

5 PROGRAM

Programming the play sequence

6 OSD

Press this buttons to display the disc and playing information in the LCD

7 ↑

Moving cursor Up

8 SETUP

Set up menu when the unit in play mode

9 GOTO

Selecting the Title/Chapter/Time to play

10 →

Moving cursor Right

Remote control unit

- | | | |
|---|--|--|
| <p>11 ←
this to confirm settings</p> | <p>20 REV
Press this to fast backward play when the unit in play mode</p> | <p>28 REPEAT
DVD: repeat play the title, chapter VCD,CD: repeat the track or whole disc</p> |
| <p>12 ←
Moving cursor left</p> | <p>21 CLEAR
Clearing the digit that is just input</p> | <p>29 VOL+
Increasing the volume</p> |
| <p>13 STOP
Stop playing disc</p> | <p>22 TITLE
Displaying DVD title</p> | <p>30 VOL-
Decreasing the volume</p> |
| <p>14 NEXT
Skip next track/chapter</p> | <p>23 ↶
Return to menu.</p> | <p>31 MUTE
Switch off the speakers or earphone</p> |
| <p>15 ↓
Moving cursor down</p> | <p>24 MENU
Menu play</p> | <p>32 SHIFT
Switching the Digit or Function for the multi-function key</p> |
| <p>16 PREV
Skip previous track/chapter</p> | <p>25 DIGIT INPUT</p> | |
| <p>17 STEP/SLOW
Press this to enter slowing play when the unit in play mode
Press this to step one frame when the unit in pause mode</p> | <p>26 ZOOM
Zooming the picture</p> | |
| <p>18 Forward
Press this to fast forward play when the unit in play mode</p> | <p>27 A-B
Press this to set A point, press again to set B point, then the unit playing from A to B repeated.
Press 3rd to cancel the A-B play.</p> | |
| <p>19 PLAY/PAUSE
Press this to play or pause</p> | | |

Replacing the battery

- 1 Insert your finger nails into A and B on the diagram below, press A according to the direction, then pull out the battery holder.

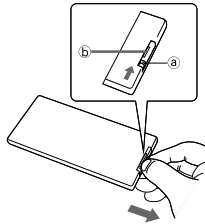

- 2 Remove the old battery, then insert the new battery into the battery holder with the + side facing upwards.

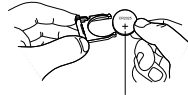

Lithium battery (Cr2025)

- 3 Fit the battery holder back to its place.

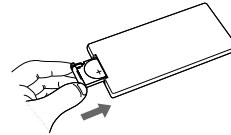

Note:

To prevent leakage of fluid from the lithium battery, remove the battery when not using the remote control unit for long periods of time (one month or more). If the battery leaks fluid, carefully wipe it out of the battery case, then change to a new lithium battery.

Free Manuals Download Website

<http://myh66.com>

<http://usermanuals.us>

<http://www.somanuals.com>

<http://www.4manuals.cc>

<http://www.manual-lib.com>

<http://www.404manual.com>

<http://www.luxmanual.com>

<http://aubethermostatmanual.com>

Golf course search by state

<http://golfingnear.com>

Email search by domain

<http://emailbydomain.com>

Auto manuals search

<http://auto.somanuals.com>

TV manuals search

<http://tv.somanuals.com>