

Wynn

**CD CLOCK STEREO RADIO WITH DUAL
ALARM**

MODEL: MMG-CR2900

**BEFORE OPERATING THIS PRODUCT,
PLEASE READ THESE INSTRUCTIONS COMPLETELY.**

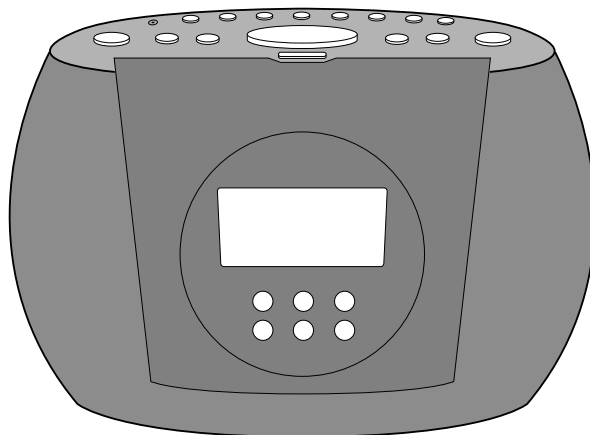

OPERATING INSTRUCTIONS

SAFETY PRECAUTIONS



CAUTION

**RISK OF ELECTRIC SHOCK
DO NOT OPEN**



CAUTION: TO REDUCE THE RISK OF ELECTRIC SHOCK, DO NOT REMOVE COVER (OR BACK). NO USER-SERVICEABLE PARTS INSIDE. REFER SERVICING TO QUALIFIED SERVICE PERSONNEL.

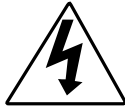

DANGEROUS VOLTAGE: The lightning flash with arrowhead symbol, within an equilateral triangle is intended to alert the user to the presence of uninsulated 'dangerous voltage' within the product's enclosure that may be of sufficient magnitude to constitute a risk of electric shock to persons.



ATTENTION: The exclamation point within an equilateral triangle is intended to alert the user to the presence of important operating and maintenance (servicing) instructions in the literature accompanying the appliance.

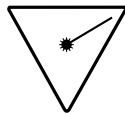

DANGER: Invisible and hazardous laser radiation when open and interlock failed or defeated. Avoid direct exposure to beam.

FCC WARNING:

This equipment may generate or use radio frequency energy. Changes or modifications to this equipment may cause harmful interference unless the modifications are expressly approved in the instruction manual. The user could lose the authority to operate this equipment if an unauthorized change or modification is made.

LASER SAFETY: This unit employs a laser. Only qualified service personnel should attempt to service this device due to possible eye injury.

CAUTION: USE OF CONTROLS, ADJUSTMENTS OR PERFORMANCE PROCEDURE HEREIN MAY RESULT IN HAZARDOUS RADIATION EXPOSURE.

SURGE PROTECTORS:

It is recommended to use a surge protector for AC connection. Lightning and power surges ARE NOT covered under warranty for this product.

INFORMATION:

This equipment has been tested and found to comply with the limits for a Class B digital device, pursuant to Part 15 of the FCC Rules. These limits are designed to provide reasonable protection against harmful interference in a residential installation. This equipment generates, uses, and can radiate radio frequency energy and, if not installed and used in accordance with instructions, may cause harmful interference to radio communications. However, there is no guarantee that interference will not occur in a particular installation. If this equipment does cause harmful interference to radio or television reception, which can be determined by turning the equipment off and on, the user is encouraged to try to correct the interference by one or more of the following measures:

- Reorient or relocate the receiving antenna.
- Increase the separation between the equipment and receiver.
- Connect the equipment into an outlet on a circuit different from that to which the receiver is connected.
- Consult the dealer or an experienced radio/TV technician for help.

IMPORTANT SAFETY INSTRUCTIONS

Before using the unit, be sure to read all operating instructions carefully. Please note that these are general precautions and may not pertain to your unit. For example, this unit may not have the capability to be connected to an outdoor antenna.

1. READ INSTRUCTIONS

All the safety and operating instructions should be read before the product is operated.

2. RETAIN INSTRUCTIONS

The safety and operating instructions should be retained for future reference.

3. HEED WARNINGS

All warnings on the product and in the operating instructions should be adhered to.

4. FOLLOW INSTRUCTIONS

All operating and use instructions should be followed.

5. CLEANING

Unplug this product from the wall outlet before cleaning. Do not use liquid cleaners or aerosol cleaners. Use a damp cloth for cleaning.

6. ATTACHMENTS

Do not use attachments not recommended by the product's manufacturer as they may cause hazards.

7. WATER AND MOISTURE

Do not use this product near water- for example, near a bathtub, washbowl, kitchen sink, or laundry tub, in a wet basement, or near a swimming pool.

8. ACCESSORIES

Do not place this product on an unstable cart, stand, tripod, bracket, or table. The product may fall, causing serious injury and serious damage to the product. Use only with a cart, stand, tripod, bracket, or table recommended by the manufacturer or sold with the product. Any mounting of the product should follow the manufacturer's instructions, and should use a mounting accessory recommended by the manufacturer.

8A. An appliance and cart combination

should be moved with care. Quick stops, excessive force, and uneven surfaces may cause the appliance and cart combination to overturn.

PORTABLE CART WARNING
(symbol provided by RETAC)

**9. VENTILATION**

Slots and openings in the cabinet and in the back or bottom are provided for ventilation and to ensure reliable operation of the product and to protect it from overheating. These openings must not be blocked or covered. The openings should never be blocked by placing the product on a bed, sofa, rug, or other similar surface. This product should never be placed near or over a radiator or heat source. This product should not be placed in a built-in installation such as a bookcase or rack unless proper ventilation is provided or the manufacturer's instructions have been adhered to.

IMPORTANT SAFETY INSTRUCTIONS (CONTINUED)

10. POWER SOURCES

This product should be operated only from the type of power source indicated on the marking label. If you are not sure of the type of power supply to your home, consult your appliance dealer or local power company. For products intended to operate from battery power, or other sources, refer to the operating instructions.

11. GROUNDING OR POLARIZATION

This product is equipped with a polarized alternating-current line plug (a plug having one blade wider than the other). This plug will fit into the power outlet only one way. This is a safety feature. If you are unable to insert the plug fully into the outlet, try reversing the plug. If the plug should still fail to fit, contact your electrician to replace your obsolete outlet. Do not defeat the safety purpose of the polarized plug.

12. POWER-CORD PROTECTION

Power-supply cords should be routed so that they are not likely to be walked on or pinched by items placed upon or against them, paying particular attention to cords at plugs, convenience receptacles, and the point where they exit from the appliance.

13. LIGHTNING

To protect your product from a lightning storm, or when it is left unattended and unused for long periods of time, unplug it from the wall outlet and disconnect the antenna or cable system. This will prevent damage to the product due to lightning and power-line surges.

14. POWER LINES

An outside antenna system should not be located in the vicinity of overhead power lines or other electric light or power circuits, or where it can fall into such power lines or circuits. When installing an outside antenna system, extreme care should be taken to keep from touching such power lines or circuits as contact with them might be fatal.

15. OVERLOADING

Do not overload wall outlets and extension cords as this can result in a risk of fire or electric shock.

16. OBJECT AND LIQUID ENTRY

Never push objects of any kind into this product through openings as they may touch dangerous voltage points or short out parts that could result in fire or electric shock. Never spill or spray any type of liquid on the product.

17. SERVICING

Do not attempt to service this product yourself as opening or removing covers may expose you to dangerous voltage or other hazards. Refer all servicing to qualified service personnel.

18. REPLACEMENT PARTS

When replacement parts are required, be sure the service technician uses replacement parts specified by the manufacturer or those that have the same characteristics as the original part. Unauthorized substitutions may result in fire, electric shock or other hazards.

19. SAFETY CHECK

Upon completion of any service or repairs to this product, ask the service technician to perform safety checks to determine that the product is in proper operating condition.

20. WALL OR CEILING MOUNTING

The product should be mounted to a wall or ceiling only as recommended by the manufacturer.

21. DAMAGE REQUIRING SERVICE

Unplug the product from the wall outlet and refer servicing to qualified service personnel under the following conditions:

- a. When the power-supply cord or plug is damaged.
- b. If liquid has been spilled, or objects have fallen into the product.
- c. If the product has been exposed to rain or water.
- d. If the product does not operate normally by following the operating instructions. Adjust only those controls that are covered by the operating instructions, as an adjustment of other controls may result in damage and will often require extensive work by a qualified technician to restore the product to its normal operation.
- e. If the product has been dropped or the cabinet has been damaged.
- f. When the product exhibits a distinct change in performance - this indicates a need for service.

22. HEAT

The product should be situated away from heat sources such as radiators, heat registers, stoves, or other products (including amplifiers) that produce heat.

23. NOTE TO CATV SYSTEM INSTALLER

This reminder is provided to call the CATV system installer's attention to Article 820-40 of the NEC that provides guidelines for proper grounding and, in particular, specifies that the cable ground shall be connected to the grounding system of the building, as close to the point of cable entry as practical.

24. NONUSE PERIODS

The power cord of the appliance should be unplugged from the outlet when left unused for a long period of time.

Dear Customer:

Selecting fine audio equipment such as the unit you've just purchased is only the start of your musical enjoyment. Now it's time to consider how you can maximize the fun and excitement your equipment offers. This manufacturer and the Electronic Industries Association's Consumer Electronics Group want you to get the most out of your equipment by playing it at a safe level. One that lets the sound come through loud and clear without annoying blaring or distortion and, most importantly, without affecting your sensitive hearing. Sound can be deceiving. Over time your hearing "comfort level" adapts to higher volumes of sound. So what sounds "normal" can actually be loud and harmful to your hearing. Guard against this by setting your equipment at a safe level BEFORE your hearing adapts.

To establish a safe level:

- Start your volume control at a low setting.
- Slowly increase the sound until you can hear it comfortably and clearly, and without distortion.

Once you have established a comfortable sound level:

- Set the dial and leave it there.

Taking a minute to do this now will help to prevent hearing damage or loss in the future. After all, we want you listening for a lifetime.

We Want You Listening For A Lifetime

Used wisely, your new sound equipment will provide a lifetime of fun and enjoyment. Since hearing damage from loud noise is often undetectable until it is too late, this manufacturer and the Electronic Industries Association's Consumer Electronics Group recommend you avoid prolonged exposure to excessive noise. This list of sound levels is included for your protection.

Decibel

<u>Level</u>	<u>Example</u>
30	Quiet library, soft whispers
40	Living room, refrigerator, bedroom away from traffic
50	Light traffic, normal conversation, quiet office
60	Air conditioner at 20 feet, sewing machine
70	Vacuum cleaner, hair dryer, noisy restaurant
80	Average city traffic, garbage disposals, alarm clock at two feet

THE FOLLOWING NOISES CAN BE DANGEROUS UNDER CONSTANT EXPOSURE:

90	Subway, motorcycle, truck traffic, lawn mower
100	Garbage truck, chain saw, pneumatic drill
120	Rock band concert in front of speakers, thunderclap
140	Gunshot blast, jet engine
180	Rocket launching pad

Information courtesy of the Deafness Research Foundation.



LOCATION OF CONTROLS

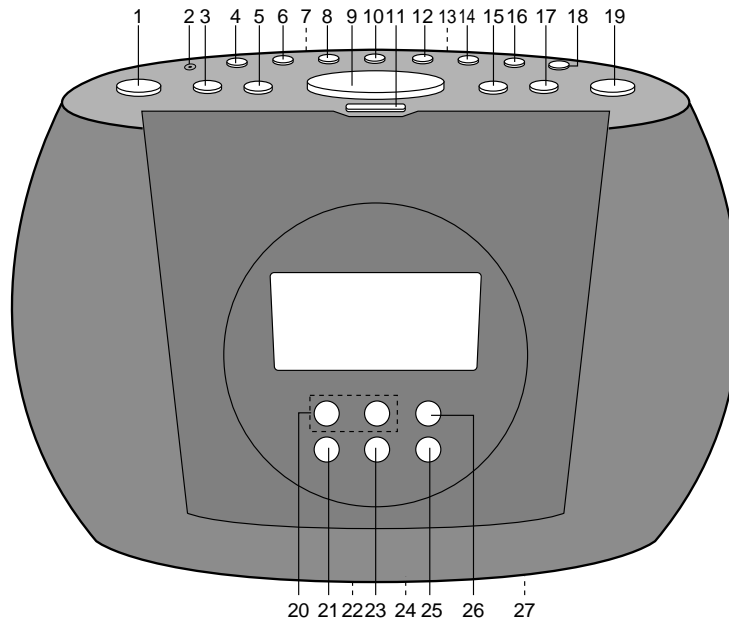

- | | |
|--|--|
| 1. POWER OFF Button | 15. VOLUME – Button |
| 2. PHONES (Headphones) Jack | 16. TIMER Button |
| 3. RECALL Button | 17. VOLUME + Button |
| 4. WAKE 1 Button | 18. SLEEP Button |
| 5. RADIO SET Button | 19. RADIO ON/BAND Button |
| 6. RESET Button | 20. TUNE/SKIP ◀◀/▶▶ Buttons |
| 7. TIMER Switch (Rear of Unit) | 21. PLAY/PAUSE (▶) Button |
| 8. WAKE 2 Button | 22. AC Cord (Rear of Unit) |
| 9. SNOOZE Button | 23. STOP (■) Button |
| 10. REV (Reverse) Button | 24. Battery Compartment (Bottom of Unit) |
| 11. OPEN/CLOSE Button | 25. WAKE TRACK Button |
| 12. SET Button | 26. REPEAT/Random Button |
| 13. FM RADIO (STEREO/MONO) Switch (Rear of Unit) | 27. FM Antenna Wire (Rear of Unit) |
| 14. FF (Fast Forward) Button | |

INSTALLATION

Unravel the AC cord and connect it to a conveniently located AC outlet having 120V and 60Hz only. The Clock Display will illuminate and "12:00" will blink in the window.

NOTE: If the AC plug does not fit into a nonpolarized outlet, do not file or cut the wide blade.

If the AC cord is disconnected or if there is a power failure, this electronic clock is designed to continue operating internally (without showing the time on the Clock Display) with a 9 volt battery (not included). To install the battery, connect the battery to the terminals of the battery snap inside the compartment (use of an alkaline battery is recommended).

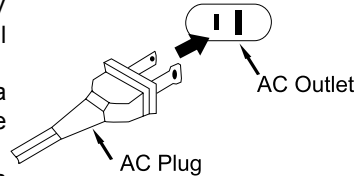

Be sure to check the condition of the battery periodically by disconnecting the AC cord and connecting it again two or three minutes later. The preset times should continue operating. If the present time does not appear, it indicates the battery is dead or not connected properly. The 9 volt battery will keep the internal times accurately for approximately 30 minutes. If the power is restored after 30 minutes, the times may need to be reset.

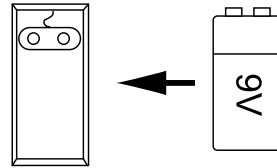

BATTERY PRECAUTIONS

Follow these precautions when using batteries in this device:

1. Use only the size and type of batteries specified.
2. Be sure to follow the correct polarity when installing the batteries as indicated in the battery compartment. Reversed batteries may cause damage to the device.
3. If the device is not to be used for a long period of time, remove the batteries to prevent damage or injury from possible battery leakage.
4. Do not try to recharge batteries not intended to be recharged; they can overheat and rupture. (Follow battery manufacturer's directions.)

OPERATION

TO SET OR RESET THE ACTUAL TIME

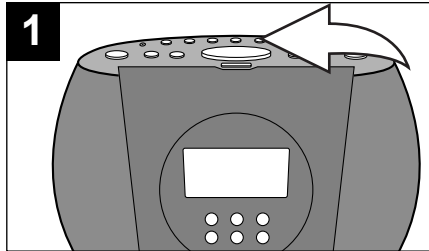

1 Press the SET button once; “⊙” will appear in the display.

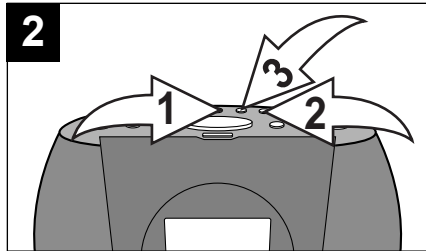

2 Press the REV ❶ or FF ❷ button to set the time. Press the SET button ❸ three times to exit the Clock Set mode.

TO SET THE COUNTDOWN TIMER

The Countdown Timer will allow you to set a countdown time in minutes and seconds and then beep when the time has elapsed.

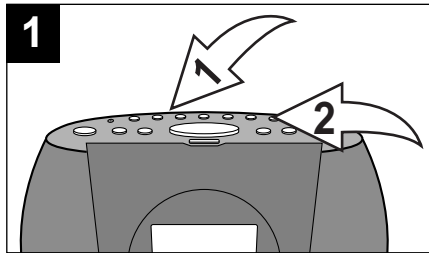

1 Slide the TIMER switch ❶ on the rear of the unit to the COUNTDOWN position. Press the TIMER button ❷; TIMER will blink and “1:00”, indicating 1 minute and 00 seconds, will appear in the display.

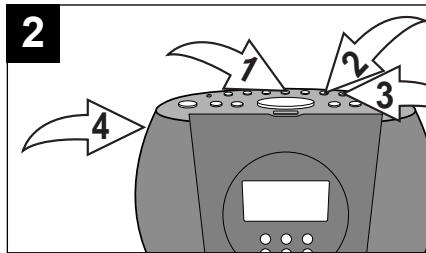

2 Press the REV ❶ or FF ❷ button to set the desired Countdown time, in minutes and seconds. Press the TIMER button ❸ again; TIMER will appear in the display and the timer will countdown the preset time, then beep. Press the TIMER button ❹ to turn off the beeping.

NOTE: The maximum Countdown time is 29 minutes, 59 seconds.

TO CANCEL THE COUNTDOWN TIMER

While the Countdown timer is counting down, simply press the TIMER button again to cancel.

OPERATION (CONTINUED)

TO SET THE NAP TIMER

The NAP Timer will allow you to set a NAP time in hours and minutes and then beep when the time has elapsed.

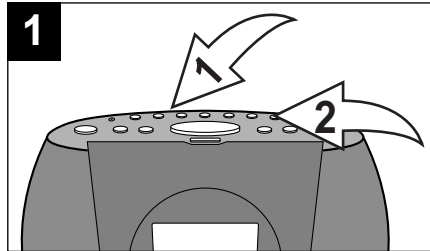

Slide the **TIMER switch 1** on the rear of the unit to the **NAP** position. Press the **TIMER button 2**; **TIMER** will blink and “:20”, indicating 20 minutes, will appear in the display.

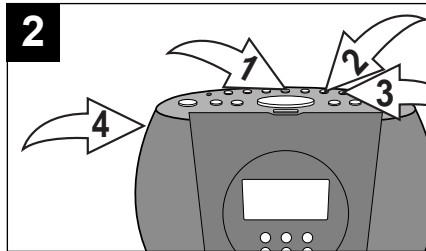

Press the **REV 1** or **FF 2** button to set the desired NAP time, in hours and minutes. Press the **TIMER button 3** again; **TIMER** and the Clock will appear in the display. When the desired NAP time has elapsed, the unit will beep. Press the **TIMER button 3** to turn off the beep.

TO CANCEL THE NAP TIMER

While the countdown timer is counting down, slide the **TIMER** switch to the **COUNTDOWN** position to cancel.

NOTES:

- To check the NAP Timer time remaining, press the **TIMER** button; the NAP Timer timer will appear briefly.
- After pressing the **SET** or **TIMER** button, another button must be pressed within five seconds, or the display will revert to the **Clock** mode.
- The maximum NAP time is 2 hours.

HEADPHONES JACK:

For private listening, insert headphones into this jack. The speakers will be disconnected when the headphones are plugged in.

BACK LIGHT

The back light in the display will light when radio or CD are playing. To light when the unit is off, press any button; the back light will then come on for 10 seconds.

OPERATION (CONTINUED)

TO LISTEN TO THE RADIO

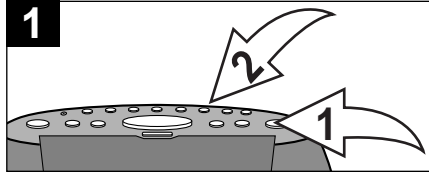

Press the RADIO ON/BAND button ❶ once to turn the unit on and select radio. Repeatedly press to select the desired band (AM, FM). Slide the FM RADIO switch ❷ on the rear of the unit to the STEREO or MONO position as desired. Sound present in Stereo broadcasts can be reduced by sliding this switch to the MONO position.

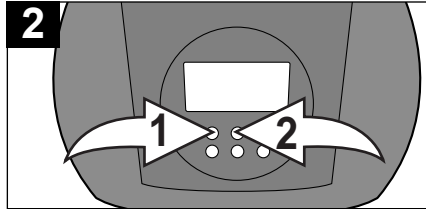

Tune a station by pressing the TUNE/SKIP |◀◀ ❶ or ▶▶ ❷ button. Press and hold the TUNE/SKIP |◀◀ ❶ or ▶▶ ❷ button and the unit will scan and stop on the next strong station.

SETTING RADIO PRESETS (TOTAL 10 PRESETS FOR AM/FM)

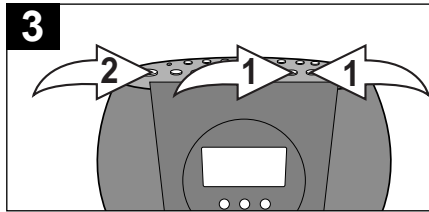

Adjust the volume using the VOLUME +/- buttons ❶. Press the POWER OFF button ❷ to turn the unit off.

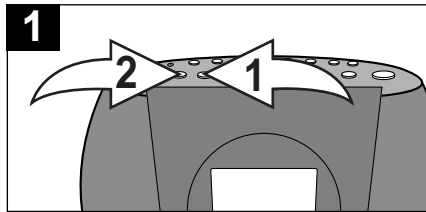

Tune a station as described in step 2 above, then press the RADIO SET button ❶ once; the MEMO indicator will blink. Press the RECALL button ❷ to select a radio preset number, then press the RADIO SET button ❶ again to confirm and the radio preset will be set. To set the alarm station ("AL" will appear), see page 14.

Antennas

FM: Extend the FM Antenna wire for better FM reception.

AM: Turn the unit for better AM reception.

OPERATION (CONTINUED)

TO RECALL RADIO PRESETS

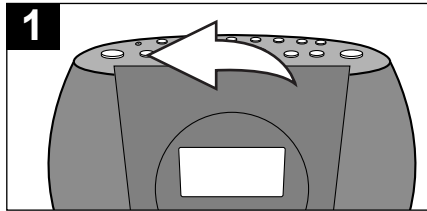

To recall a Radio Preset, press the RECALL button repeatedly until the desired Radio Preset appears in the display.

TO CHANGE A RADIO PRESET

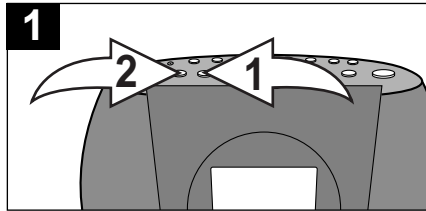

To change a Radio Preset, simply tune a radio station as described on the previous page, then press the RADIO SET button ❶; "MEMO" will blink in the display. Repeatedly press the RECALL button ❷ until the desired Radio Preset appears in the display, then press the RADIO SET button ❶ again to memorize.

NOTE: Once a radio frequency is selected, the display will revert to the time display after 10 seconds.

TO INSERT A CD

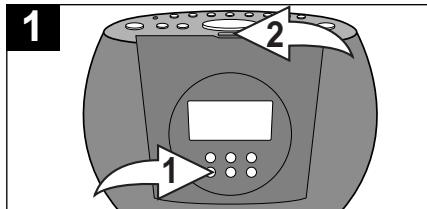

Press the PLAY/PAUSE (▶||) button ❶ to turn the unit on. Open the CD compartment door by pressing the OPEN/CLOSE button ❷. Gently press a disc, label side up, onto the spindle and press the OPEN/CLOSE button ❷ again to close the CD compartment door.

TO REMOVE A CD

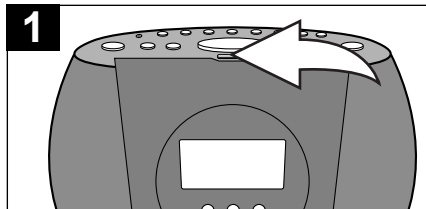

Make sure the CD has stopped and open the CD compartment door by pressing the OPEN/CLOSE button. Hold the edge of the CD and pick it up.

IMPORTANT: The power must be on to open and close the CD Compartment door.

OPERATION (CONTINUED)

TO PLAY A CD

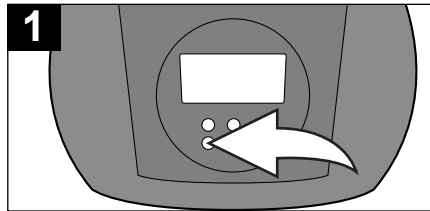

1 Press the PLAY/PAUSE button to turn the unit on and insert a CD as described on the previous page; the total number of tracks will appear in the display.

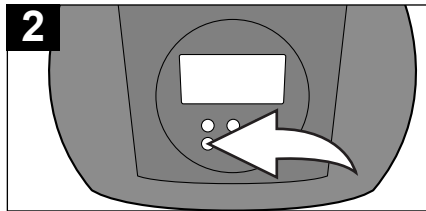

2 Press the PLAY/PAUSE (▶||) button to start playback. **TO PAUSE PLAYBACK**, press the PLAY/PAUSE (▶||) button again; "TRACK" will blink in the display. Press again to resume playback.

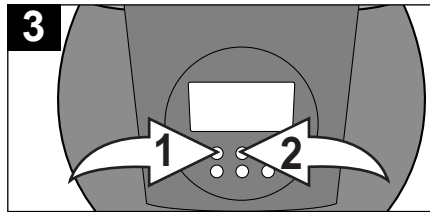

3 To **skip** forward or backward through the tracks on the disc, press the TUNE/SKIP ◀▶ ❶ or ▶▶ ❷ button. To **search** forward or backward through the musical passage on the disc, press and hold the TUNE/SKIP ◀▶ ❶ or ▶▶ ❷ button.

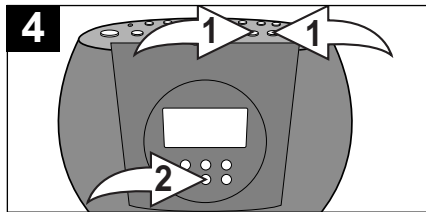

4 Adjust the volume using the VOLUME +/- buttons ❶ as desired. When the disc is through playing, it will stop. Press the STOP (■) button ❷ to stop the disc before it is finished.

FAQS: *Do I need an adapter to play 3" singles?*
No, simply insert the 3" single into the groove.
What is the maximum time for a CD in this unit?
The maximum time is 74 minutes.

NOTES:

- If a disc is inserted incorrectly, dirty, damaged or not present at all, the track display will show "00".
- To remove the CD, press the OPEN/CLOSE button and remove the CD.

OPERATION (CONTINUED)

TO REPEATEDLY PLAY BACK ONE TRACK

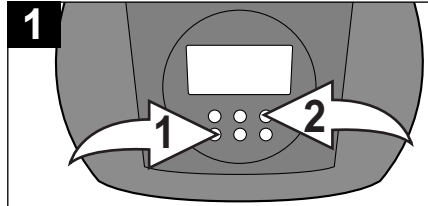

1 Press the PLAY/PAUSE (▶||) button ❶ to turn the unit on and insert a CD as described on page 10. Press the REPEAT/Random button ❷ once; "REP" will blink in the display.

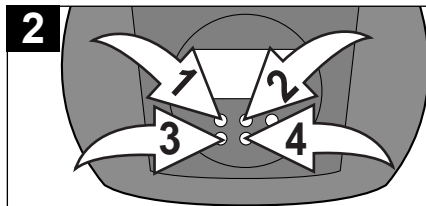

2 Press the TUNE/SKIP |◀❸ or ▶❹| button ❷ to select a track. Press the PLAY/PAUSE (▶||) button ❸ to start playback and the unit will play the same track over and over until the STOP (■) button ❹ is pressed.

TO REPEATEDLY PLAY BACK ALL TRACKS ON A CD

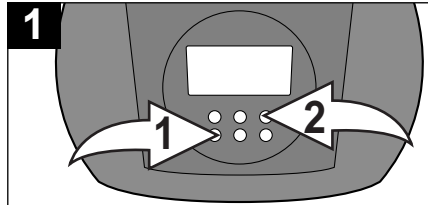

1 Press the PLAY/PAUSE (▶||) button ❶ to turn the unit on and insert a CD as described on page 10. Press the REPEAT/Random button ❷ twice; "REP" will appear in the display.

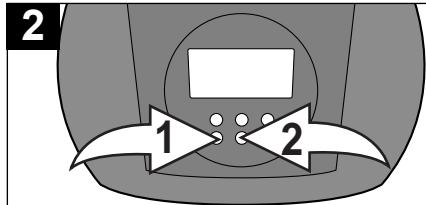

2 Press the PLAY/PAUSE (▶||) button ❶ to start playback and the unit will then play all the tracks on the CD over and over until the STOP (■) button ❷ is pressed.

OPERATION (CONTINUED)

TO RANDOMLY PLAY BACK TRACKS ON A CD

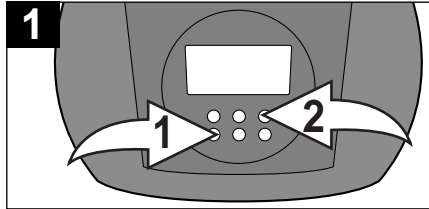

1 Press the PLAY/PAUSE (▶||) button ① to turn the unit on and insert a CD as described on page 10. Press the REPEAT/Random button ② three times; "REP RAN" will appear in the display.

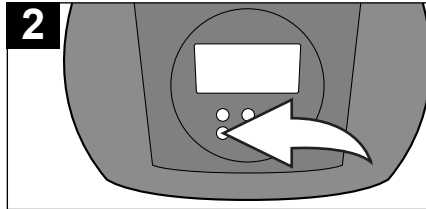

2 Press the PLAY/PAUSE (▶||) button to begin playback. The unit will play all the tracks in random order. When all the tracks have been played, the unit will stop.

TO SET OR RESET THE ALARM TIME(S)

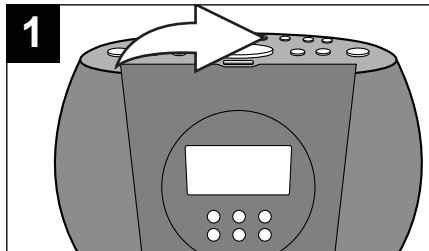

1 Press the SET button twice to set Alarm 1, or three times to set Alarm 2; "WAKE1" or "WAKE2" will appear in the display.

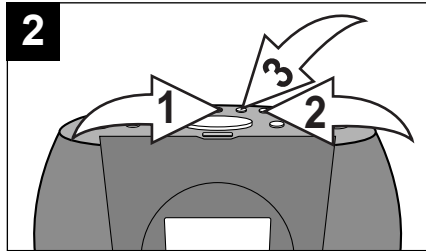

2 Press the REV ① or FF ② button to set the desired alarm time. Press the SET button ③ until the WAKE indicator disappears from the display to set Alarm 1 or 2.

OPERATION (CONTINUED)

TO SET THE ALARM TO WAKE TO RADIO

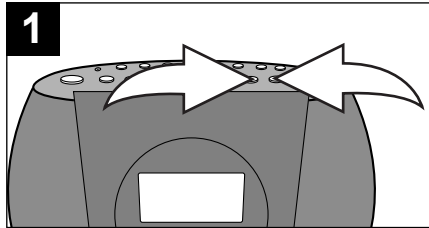

1
Set the alarm time as previously instructed. Press the VOLUME +/- buttons to set a desired wake up volume.

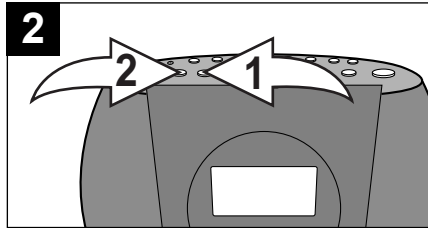

2
Tune a station and then press the RADIO SET button ❶. Press the RECALL button ❷ repeatedly until "AL" appears in the display. Press the RADIO SET button ❶ again to confirm and the alarm radio preset will be set. This is the station the unit will turn on to when the alarm time matches the actual time.

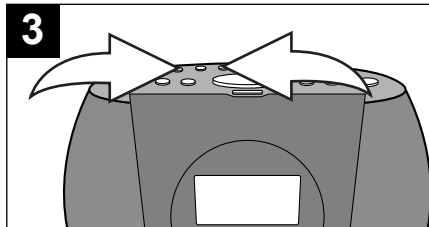

3
Press the desired WAKE button (WAKE 1 or WAKE 2) until "☐" or "☒" appears in the display. The alarm is now set to wake to radio and when the alarm time matches the actual time, the unit will turn on to the preset station.

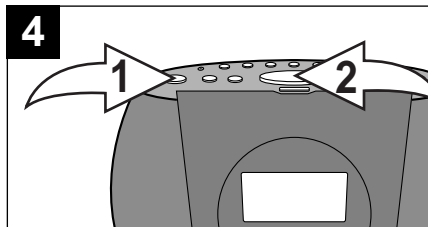

4
To shut the alarm off, press the POWER OFF button ❶ once and the alarm time will be reset for the next day. The alarm can be temporarily turned off manually by pressing the SNOOZE button ❷; the alarm will turn back on automatically nine minutes later. It can be repeated endlessly.

OPERATION (CONTINUED)

TO SET THE ALARM TO WAKE TO CD

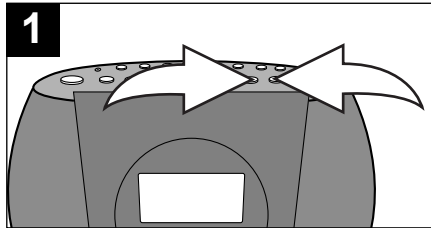

1 Set the alarm time as previously instructed. Press the VOLUME +/- buttons to set a desired wake up volume.

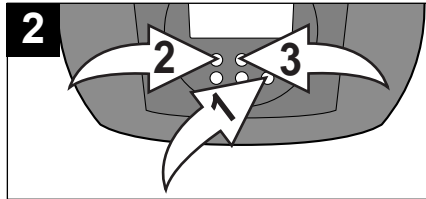

To set the Wake Track the unit will start playing when the alarm time matches the actual time, press and hold the WAKE TRACK button **1**, then press the TUNE/SKIP **2** or **3** button to select the track.

NOTES:

- The unit will automatically be in the Repeat All mode.
- If you cannot select the Wake Track, press the POWER OFF button or the RADIO ON/BAND button. After doing so, you can now press the WAKE TRACK button as desired.

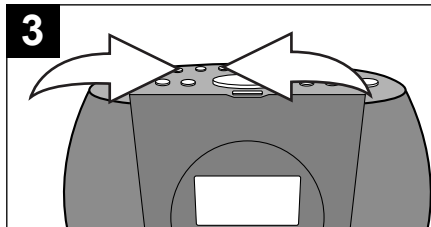

3 Press the desired WAKE button (WAKE 1 or WAKE 2) until "1" or "2" appears in the display. The alarm is now set to wake to CD and when the alarm time matches the actual time, the unit will play the preset track, followed by the remaining tracks on the CD.

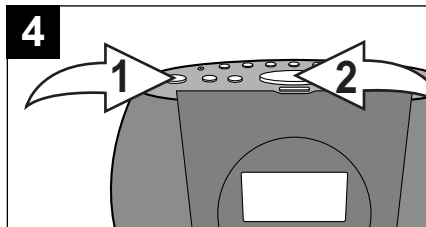

4 To shut the alarm off, press the POWER OFF button **1** once and the alarm time will be reset for the next day.

The alarm can be temporarily turned off manually by pressing the SNOOZE button **2**; the alarm will turn back on automatically nine minutes later. It can be repeated endlessly.

OPERATION (CONTINUED)

TO SET THE ALARM TO WAKE TO BUZZER

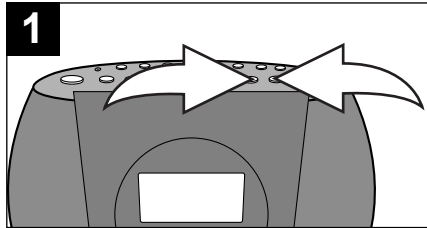

1
Set the alarm time as previously instructed. Press the VOLUME +/- buttons to set a desired wake up volume.

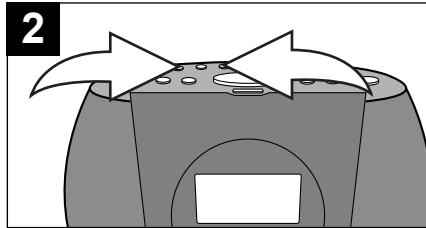

2
Press the desired WAKE button (WAKE 1 or WAKE 2) until "1" or "2" appears in the display. The alarm is now set to wake to buzzer and when the alarm time matches the actual time, the unit buzzer will sound.

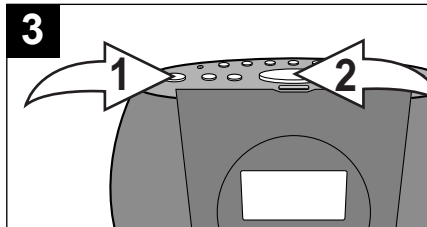

3
To shut the alarm off, press the POWER OFF button ❶ once and the alarm time will be reset for the next day.
The alarm can be temporarily turned off manually by pressing the SNOOZE button ❷; the alarm will turn back on automatically nine minutes later. It can be repeated endlessly.

OPERATION (CONTINUED)

TO CANCEL THE ALARM

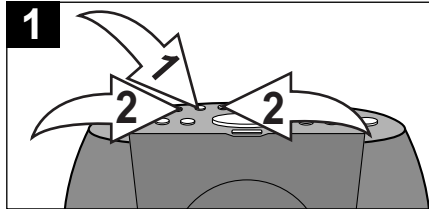

To cancel the alarm so it does not sound when the alarm time is reached, press the RESET button ❶, followed by the desired WAKE 1 or WAKE 2 button ❷.

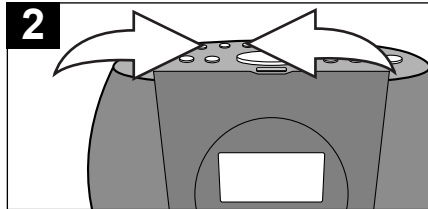

The Alarm indicator will disappear, but the alarm time will remain in memory. To activate, press the desired WAKE 1 or WAKE 2 button again.

TO USE THE SNOOZE FEATURE

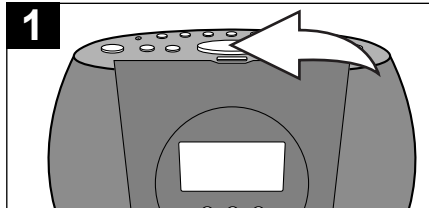

The alarm can be temporarily turned off manually by pressing the SNOOZE button; the alarm will turn back on automatically nine minutes later. It can be repeated endlessly.

OPERATION (CONTINUED)

TO ACTIVATE THE SLEEP FUNCTION

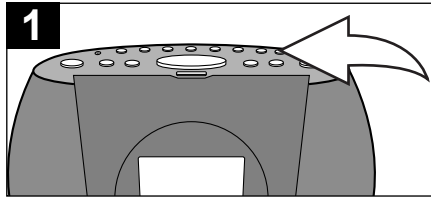

1
Tune the desired radio station or insert a CD as previously instructed. Press and hold the SLEEP button and “:59” will appear on the clock display, then release the button.

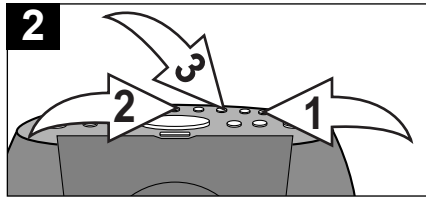

2
To adjust the sleep time, while pressing and holding the SLEEP button ❶, press the REV ❷ or FF ❸ button until the desired sleep time appears in the display.

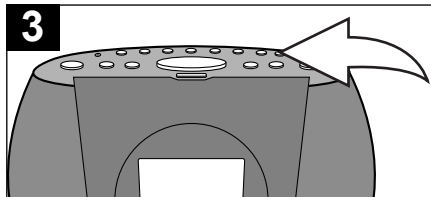

3
Release the SLEEP button. When the sleep time has elapsed, the unit will turn off.

NOTE:
To check the sleep time, simply press the SLEEP button at any time.

FOR ADDITIONAL SET-UP OR OPERATING ASSISTANCE, PLEASE VISIT OUR WEBSITE AT WWW.MEMCORPINC.COM OR CONTACT CUSTOMER SERVICE AT 1-800-919-3647.

PLEASE KEEP ALL PACKAGING MATERIAL FOR AT LEAST 90 DAYS IN CASE YOU NEED TO RETURN THIS PRODUCT TO YOUR PLACE OF PURCHASE OR MEMOREX.

FOR PARTS AND ACCESSORIES, CONTACT FOX INT'L AT 1-800-321-6993.

CARE AND MAINTENANCE

Caring for Compact Discs

- Treat the compact disc carefully. Handle the compact disc only by its edges. Never allow your fingers to come in contact with the shiny, unprinted side of the disc.
- Do not attach adhesive tape, stickers, etc. to the compact disc label.
- Clean the compact disc periodically with a soft, lint-free, dry cloth. Never use detergents or abrasive cleaners to clean the disc. If necessary, use a CD cleaning kit.
- If a compact disc skips or gets stuck on a section of the compact disc, it is probably dirty or damaged (scratched).
- When cleaning the compact disc, wipe in straight lines from the center of the compact disc to the outer edge of the compact disc. Never wipe in circular motions.

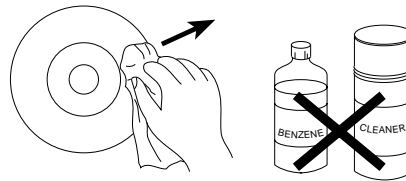
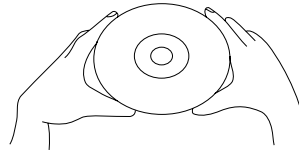

- This unit is designed to play only compact discs bearing the identification logo as shown here. Other discs may not conform to the CD standard and may not play properly.
- Compact Discs should be stored in their cases after each use to avoid damage.
- Do not expose compact discs to direct sunlight, high humidity, high temperatures, or dust, etc. Prolonged exposure or extreme temperatures can warp the disc.
- Do not stick or write anything on either side of the disc. Sharp writing instruments, or the ink may damage the surface.



Cleaning the unit

- To prevent fire or shock hazard, disconnect your unit from the AC power source when cleaning.
- The finish on your unit may be cleaned with a dust cloth and cared for as other furniture. Use caution when cleaning and wiping the plastic parts.
- Mild soap and a damp cloth may be used on the front panel.

TROUBLESHOOTING GUIDE

If you experience a problem with this unit, check the chart below before calling for service.

SYMPTOM	CAUSE	SOLUTION
Unit will not turn on.	AC cord not connected.	Check AC cord connection.
Disc will not play.	CD compartment not closed.	Close CD compartment door.
	Disc inserted incorrectly.	Reinsert disc correctly.
	Dirty or defective CD.	Try another disc.
	Moisture condensation on disc.	Wipe disc with soft cloth.
No sound.	VOLUME is set to minimum.	Increase volume.
	Defective disc.	Try another disc.
Erratic playback.	Dirty or defective disc.	Clean or replace disc.
Time reset to "12:00".	Battery connected improperly, not connected or dead.	Check the battery.
	Clock not set.	Set the clock.
Alarm does not turn on.	Desired WAKE button was not pressed.	Press desired WAKE button.
	Clock is not set.	Set the clock.
	Alarm is not set.	Set the Alarm.
AM or FM, no sound.	Power is not on.	Press the RADIO ON/BAND button to turn the unit on.
	VOLUME is set to minimum.	Increase volume.

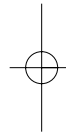
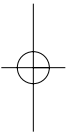

Memcorp, Inc.
Weston, FI
Printed in Hong Kong

Visit our website at www.memcorpinc.com

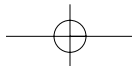

Free Manuals Download Website

<http://myh66.com>

<http://usermanuals.us>

<http://www.somanuals.com>

<http://www.4manuals.cc>

<http://www.manual-lib.com>

<http://www.404manual.com>

<http://www.luxmanual.com>

<http://aubethermostatmanual.com>

Golf course search by state

<http://golfingnear.com>

Email search by domain

<http://emailbydomain.com>

Auto manuals search

<http://auto.somanuals.com>

TV manuals search

<http://tv.somanuals.com>