

CONTENTS

Contents	1	• Skip.....	26
Important Safety Instructions	2	• Search.....	26
Features	4	• Pause and Step.....	26
Precautions	5	• Slow.....	26
Power Source	5	• Top Menu Button.....	27
Location of Controls	6	• Title/Menu Button.....	27
• Front.....	6	• Pop Menu.....	27
• Rear.....	6	• Time Search.....	28
• Remote.....	7	• Info-Title/Chapter Search.....	28
Remote Control	8	• Repeat Playback.....	28
• Battery Installation.....	8	• PIP (Picture in Picture).....	28
• Effective Distance of the Remote Control Transmitter.....	8	• Zoom.....	29
Connection	9	• Angle.....	29
• Connecting the Player to a TV Using the Audio/Video Output Jacks.....	9	• Subtitle.....	29
• Connecting the Player to a TV using the S-Video Output Jack.....	9	• Audio.....	29
• Connecting the Player to a TV Using the Y/PB/PR Jacks.....	10	MP3/WMA Operation	30
• Progressive (Y, PB, PR) Video Output.....	10	• Playback of an MP3 Disc.....	30
• 525 Line Digital Progressive-scan Component Video Output.....	10	• Selecting Folders/Tracks Using the SKIP Buttons.....	32
• Connecting the Player to a TV using the HDMI Output Jack.....	11	• Repeat Play.....	32
• Connecting the Player to a TV using a DVI Cable.....	12	• MP3 FAQs.....	32
• Connecting the Player to a Home Theater System (via Coaxial Jack).....	13	CD Operation	33
• Connecting the Player to a Home Theater System (via 5.1 Channel Output Jacks).....	14	• Playback of a CD.....	33
About Discs	15	• Selecting Tracks/Files Using the Number Buttons.....	34
Setup Menu	17	• Selecting Tracks/Files Using the SKIP Buttons.....	34
• General Setup Menu.....	17	• Forward/Reverse Search.....	34
• Video Setup Menu.....	18	• Repeat/Random.....	34
• Audio Setup Menu.....	19	Data CD/USB Operation	35
• Language Setup Menu.....	21	• Playback of a Data CD/USB.....	35
• Setting the Parental Control Options.....	22	Troubleshooting Guide	37
Basic Operation	24	Care and Maintenance	39
• Mute.....	24	Specifications	40
• Color Buttons.....	24		
• Video Resolution.....	24		
BD/DVD Operation	25		
• Playback of a Blu-Ray disc or a DVD.....	25		

IMPORTANT SAFETY INSTRUCTIONS



CAUTION

**RISK OF ELECTRIC SHOCK
DO NOT OPEN**



The lightning flash with arrowhead symbol within an equilateral triangle is intended to alert the user to the presence of uninsulated dangerous voltage within the product's enclosure that may be of sufficient magnitude to constitute a risk of electric shock to persons.



The exclamation point within an equilateral triangle is intended to alert the user to the presence of important operating and maintenance (servicing) instructions in the literature accompanying the appliance.

CAUTION: TO REDUCE THE RISK OF ELECTRIC SHOCK, DO NOT REMOVE THE COVER (OR BACK). NO USER-SERVICEABLE PARTS ARE INSIDE. REFER SERVICING TO QUALIFIED SERVICE PERSONNEL.
This Caution Marking is located at the rear enclosure of the unit.



The symbol for class II
(Double Insulation)

CAUTION:

THIS DIGITAL VIDEO DISC PLAYER EMPLOYS A LASER SYSTEM.

TO ENSURE PROPER USE OF THIS PRODUCT, PLEASE READ THIS OWNER'S MANUAL CAREFULLY AND RETAIN FOR FUTURE REFERENCE. SHOULD THE UNIT REQUIRE MAINTENANCE, CONTACT AN AUTHORIZED SERVICE LOCATION-SEE SERVICE PROCEDURE.

USE OF CONTROLS, ADJUSTMENTS OR THE PERFORMANCE OF PROCEDURES OTHER THAN THOSE SPECIFIED HEREIN MAY RESULT IN HAZARDOUS RADIATION EXPOSURE.

TO PREVENT DIRECT EXPOSURE TO LASER BEAM, DO NOT TRY TO OPEN THE ENCLOSURE. VISIBLE LASER RADIATION MAY BE PRESENT WHEN THE ENCLOSURE IS OPENED. DO NOT STARE INTO BEAM.

WARNING:

TO REDUCE THE RISK OF FIRE OR ELECTRIC SHOCK, DO NOT EXPOSE THIS PRODUCT TO RAIN OR MOISTURE.

WARNING:

TO REDUCE THE RISK OF FIRE OR ELECTRIC SHOCK, AND ANNOYING INTERFERENCE, USE THE RECOMMENDED ACCESSORIES ONLY.

SURGE PROTECTORS:

It is recommended to use a surge protector for AC connection. Lightning and power surges ARE NOT covered under warranty for this product.

LASER WARNING:

This unit employs a laser. Only qualified service personnel should attempt to service this device due to possible eye injury.

FCC NOTICE:

This equipment has been tested and found to comply with the limits for a Class B digital device, pursuant to part 15 of the FCC Rules.

These limits are designed to provide reasonable protection against harmful interference in a residential installation. This equipment generates, uses and can radiate radio frequency energy and, if not installed and used in accordance with the instructions, may cause harmful interference to radio communications.

However, there is no guarantee that interference will not occur in a particular installation. If this equipment does cause harmful interference to radio or television reception, which can be determined by turning the equipment off and on, the user is encouraged to try to correct the interference by one or more of the following measures:

- Reorient or relocate the receiving antenna.
- Increase the separation between the equipment and receiver.
- Connect the equipment into an outlet on a circuit different from that to which the receiver is connected.
- Consult the dealer or an experienced radio/TV technician for help.

FCC CAUTION:

To assure continued compliance, follow the attached installation instructions and use only shielded cables when connecting to other devices. Also, any changes or modifications not expressly approved by the party responsible for compliance could void the user's authority to operate the equipment.

This Class B digital apparatus complies with Canadian ICES-003.

Cet appareil numérique de la classe B est conforme à la norme NMB-003 du Canada.

ATTENTION:

POUR ÉVITER LES CHOC ÉLECTRIQUES, INTRODUIRE LA LAME LA PLUS LARGE DE LA FICHE DANS LA BORNE CORRESPONDANTE DE LA PRISES ET POUSSER JUSQU'AU FOND.

Manufactured under license from Dolby Laboratories.

Dolby and the double-D symbol are registered trademarks of Dolby Laboratories.

Manufactured under license under U.S. Patent #'s:

5,451,942; 5,956,674; 5,974,380; 5,978,762; 6,487,535 & other U.S. and worldwide patents issued & pending. DTS is a registered trademark and the DTS logos, Symbol, DTS-HD and DTS-HD Advanced Digital Out are trademarks of DTS, Inc. © 1996-2008 DTS, Inc. All Rights Reserved.

IMPORTANT SAFETY INSTRUCTIONS (CONTINUED)

Read these operating instructions carefully before using the unit. Follow all the safety instructions listed below. Keep these operating instructions handy for future reference.

1. Read these instructions.
2. Keep these instructions.
3. Heed all warnings.
4. Follow all instructions.
5. Do not use this apparatus near water.
6. Clean only with dry cloth.
7. Do not block any ventilation openings. Install in accordance with the manufacturer's instructions.
8. Do not install near any heat source such as radiators, heat registers, stoves or other apparatus (including amplifiers) that produce heat.
9. Do not defeat the safety purpose of the polarized or grounding-type plug. A polarized plug has two blades with one wider than the other. A grounding-type plug has two blades and a third grounding prong. The wide blade or third prong are provided for your safety. If the provided plug does not fit into your outlet, consult an electrician for replacement of the obsolete outlet.
10. Protect the Power cord from being walked on or pinched, particularly at plugs, convenience receptacles, and the point where they exit from the apparatus.
11. Only use attachments/accessories specified by the manufacturer.
12. Use only with the cart, stand, tripod, bracket, or table specified by the manufacturer or sold with the apparatus. When a cart is used, use caution when moving the cart/apparatus combination to avoid injury from tip-over.
13. Unplug this apparatus during lightning storms or when unused for long periods of time.
14. Refer all servicing to qualified service personnel. Servicing is required when the apparatus has been damaged in any way, such as the power-supply cord or plug is damaged, liquid has been spilled on or objects have fallen into the apparatus, the apparatus has been exposed to rain or moisture, does not operate normally, or has been dropped.
The apparatus shall not be exposed to dripping or splashing, and no objects filled with liquids such as vases shall be placed on the apparatus. Maintain well-ventilated conditions around the product. Do not place on a bed, sofa, or anything that blocks ventilation.
Where the main plug is used as the disconnect device, the disconnect device shall remain readily operable.

PORTABLE CART WARNING
(symbol provided by RETAC)



FEATURES

This unit has many features, some are outlined below. Please read the owner's manual to take full advantage of all the features this unit has to offer.

- **BD-ROM Playback**

BD-ROM is a next generation optical disc format in the HD era. Featuring massive storage capacity of 25 to 50 GB (five times larger than a DVD) and a high-speed transfer rate of up to 54 Mbps, this format offers not only uncompromised HD quality video*†, but also enables rich bonus content on a single disc and HD quality audio up to 8ch, and interactive operability.

* A compatible HD display device is necessary to enjoy the same quality.

† Some discs allow viewing only with an HDMI connection.

- **24p True Cinema**

Movies shot with a film camera consist of 24 frames per second. Since conventional televisions (both CRT and flat panels) display frames either at 1/60 or 1/50 second intervals, the 24 frames do not appear at an even pace.

When connected to a TV with 24p capabilities, the player displays each frame at 1/24 second intervals — the same interval originally shot with the film camera, thus faithfully reproducing the original cinema image.

- **BD-J application**

The BD-ROM format supports Java for interactive functions. "BD-J" offers content providers almost unlimited functionality when creating interactive BD-ROM titles. Java and all Java-based trademarks and logos are trademarks or registered trademarks of Sun Microsystems, Inc. in the U.S. and other countries.

- **Support of uncompressed multi-channel Linear PCM**

In combination with a compatible AV amplifier, the player can output up to 8ch Linear PCM surround sound.* With a non-compatible amplifier, the player can output 5.1ch analog signals from its 5.1CH OUTPUT jack for high quality audio enjoyment.

* Note that the DIGITAL OUTPUT (COAXIAL or OPTICAL) jack does not output 8ch signals. You will need an HDMI cable and an HDMI compatible device that support 8ch signals.

- **Support of "Dolby TrueHD" and "DTS-HD" - 7.1 Channel Surround Sound**

The player supports the bitstream output functionality of Dolby TrueHD, Dolby Digital Plus, and DTS-HD High Resolution Audio bitstream via HDMI. It also supports the decoding functionality of Dolby TrueHD, Dolby Digital Plus, and DTS-HD High Resolution Audio to multi-channel Linear PCM via HDMI.

- **HDMI (High-Definition Multimedia Interface) digital interface**

When connected to an HDMI-equipped display device using a single HDMI cord, the player can output both SD to HD video and multi-channel audio signals, in digital form without degradation. The HDMI specification supports HDCP (High-bandwidth Digital Content Protection), a copy protection technology that incorporates coding technology for digital video signals.

- **Library function for recorded files (For JPEG image, MP3 audio and WMV9 files only)**

With DATA-DVDs and DATA-CDs, three separate Audio/Video/Picture/All Title List-browsers allow for easy sorting, searching and playback.

PRECAUTIONS

NOTES ON HANDLING:

- When shipping the player, always use the original shipping carton and packing materials. For maximum protection, repack the unit as it was originally packed at the factory.
- Do not use volatile liquids, such as insect spray, near the player. Do not leave rubber or plastic products in contact with the player for a long time. They will leave marks on the finish.
- The top and rear panels of the player may become warm after a long period of use. This is normal and not a malfunction.
- When the player is not in use, be sure to remove the disc and turn off the power.
- If you do not use the player for a long period, the unit may not function properly in the future. Turn on and use the player occasionally.

NOTES ON LOCATING THE PLAYER:

- When you place this player near a TV, radio or VCR, the playback picture may become poor and the sound may be distorted. In this case, move the player away from the TV, radio or VCR.

NOTES ON CLEANING:

Use a soft, dry cloth for cleaning.

- For stubborn dirt, soak the cloth in a weak detergent solution, wring well and wipe. Use a dry cloth to wipe it dry. Do not use any type of solvent, such as thinner or benzene, as it may damage the surface of the player.
- If you use a chemical-saturated cloth to clean the unit, follow that product's instructions.

Warning: Cleaning and adjustment of lenses and/or other components of playback mechanism should be performed by a qualified service technician.

TO OBTAIN A CLEAR PICTURE:

The player is a high technology, precision device. If the optical pick-up lens and disc drive parts are dirty or worn down, the picture quality becomes poor. To obtain a clear picture, we recommend regular inspection and maintenance (cleaning or parts replacement) every 1,000 hours of use depending on the operating environment. For details, contact your nearest dealer.

NOTES ON MOISTURE CONDENSATION:

Moisture condensation damages the player. Please read the following carefully.

- Moisture condensation occurs, for example, when you pour a cold drink into a glass on a warm day. Drops of water form on the outside of the glass. In the same way, moisture may condense on the optical pick-up lens inside this unit, one of the most crucial internal parts of the player.

Moisture condensation occurs during the following cases:

- When you bring the player directly from a cold place to a warm place.
- When you use the player in a room where you just turned on the heater, or a place where the cold wind from the air conditioner directly hits the unit.
- In summer, when you use the player in a hot and humid place just after you moved the unit from an air conditioned room.
- When you use the player in a humid place.

Do not use the player when moisture condensation may occur.

- If you use the player in such a situation, it may damage discs and internal parts. Remove the disc, connect the power cord of the player to the wall outlet, turn on the player and leave it "ON" for two or three hours. After two or three hours, the player will have warmed up and evaporated any moisture. Keep the player connected to the wall outlet and moisture condensation will seldom occur.

POWER SOURCE

Insert the AC plug (with the 2 blades) into a conveniently located AC outlet having 120V, 60Hz.

NOTE: The AC plug supplied with the unit is polarized to help minimize the possibility of electric shock. If the AC plug does not fit into a nonpolarized AC outlet, do not file or cut the wide blade. It is the user's responsibility to have an electrician replace the obsolete outlet.

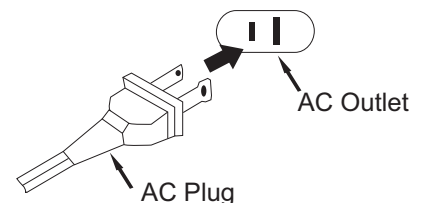

LOCATION OF CONTROLS

FRONT

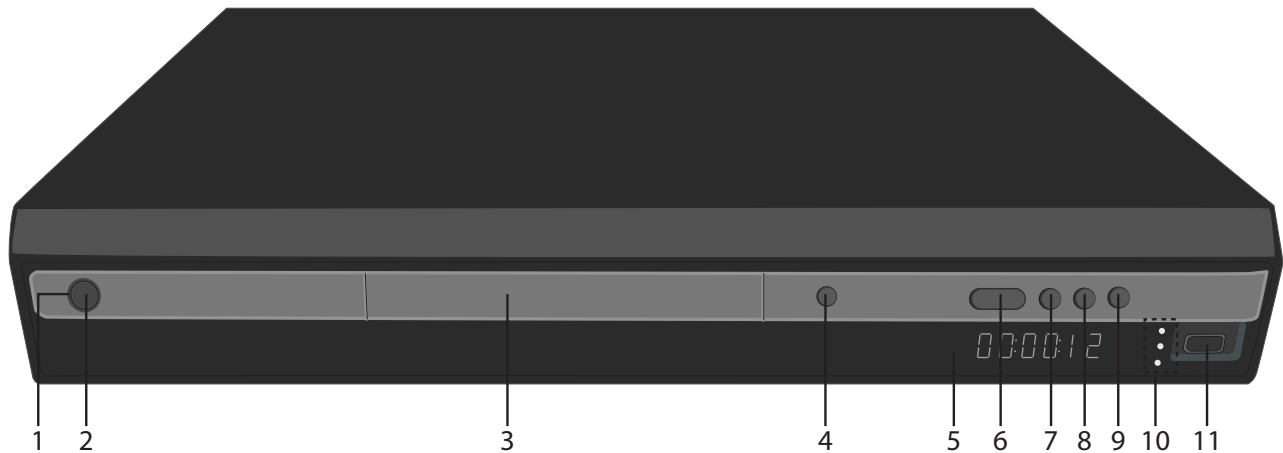

- | | |
|----------------------------|---------------------------|
| 1. Power/Standby Indicator | 7. STOP (■) Button |
| 2. POWER/STANDBY Button | 8. Skip (⏮) Button |
| 3. Disc Compartment | 9. Skip (⏭) Button |
| 4. OPEN/CLOSE Button | 10. Resolution Indicators |
| 5. Display | 11. USB Jack |
| 6. PLAY (▶) Button | |

REAR

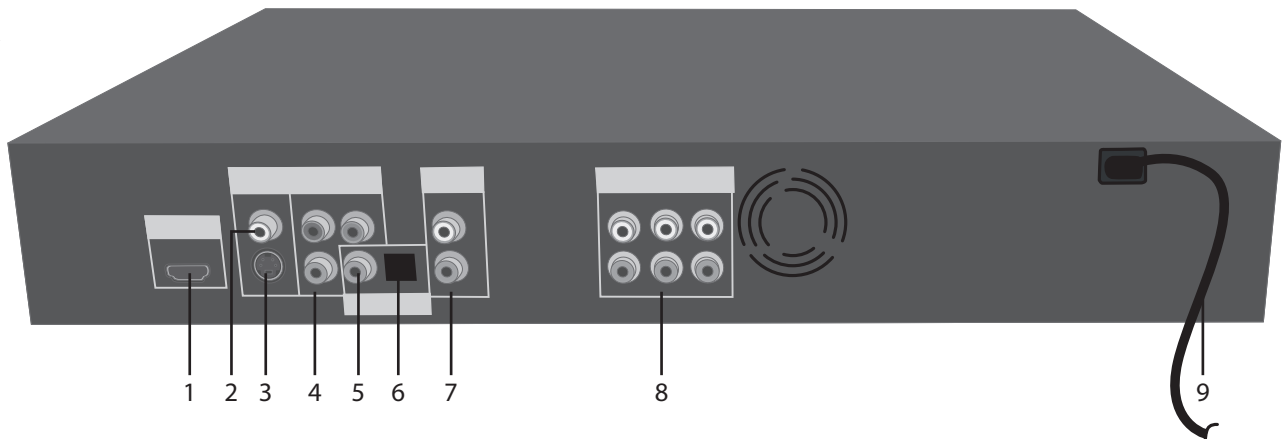

- | | |
|---|---|
| 1. HDMI Jack | 6. OPTICAL Output Jack |
| 2. Video Output Jack | 7. Stereo Audio Left/Right Output Jacks |
| 3. S-Video Output Jack | 8. 5.1 Channel Audio Output Jacks |
| 4. Component Video (Y, PB, PR) Output Jacks | 9. AC Power Cord |
| 5. COAXIAL Output Jack | |

LOCATION OF CONTROLS (CONTINUED)

REMOTE

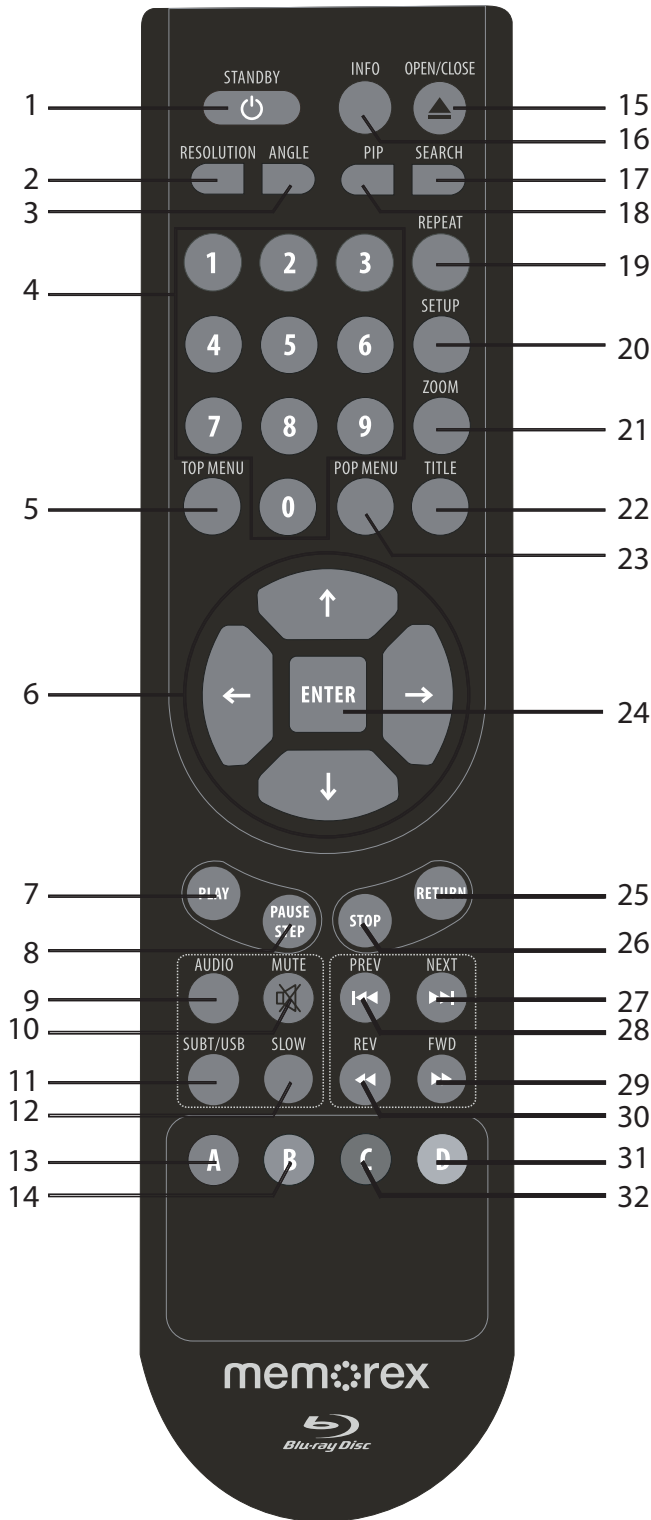

1. STANDBY Button
2. RESOLUTION Button
3. ANGLE Button
4. Number (0–9) Buttons
5. TOP MENU Button
6. Navigation (◀, ▶, ▼, ▲) Buttons
7. PLAY Button
8. PAUSE/STEP Button
9. AUDIO Button
10. MUTE Button
11. SUBTITLE/USB Button
12. SLOW Button
13. Red (A) Button
14. Green (B) Button
15. OPEN/CLOSE Button
16. INFO Button
17. SEARCH Button
18. PIP Button
19. REPEAT Button
20. SETUP Button
21. ZOOM Button
22. TITLE Button
23. POP MENU Button
24. ENTER Button
25. RETURN Button
26. STOP Button
27. Skip/NEXT (▶▶) Button
28. Skip/PREVIOUS (◀◀) Button
29. SEARCH/FORWARD ▶▶ Button
30. SEARCH/REVERSE ◀◀ Button
31. Yellow (D) Button
32. Blue (C) Button

REMOTE CONTROL PART NO. 13RE1-180002-00R*
 BATTERY COVER PART NO. 13RE1-180002-00R-CV*
 A/V RCA Cable - PART NO. 13WE1-311200-10R*

*Consumer Replaceable Part (See page 38 to order.)

REMOTE CONTROL

BATTERY INSTALLATION

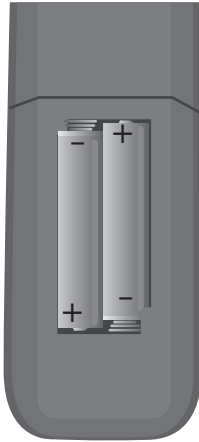

1. Remove the Battery Compartment cover by sliding the cover off.
2. Install two (2) "AAA" batteries, paying attention to the polarity diagram in the battery compartment.
3. Replace the Battery Compartment cover.

BATTERY PRECAUTIONS

Follow these precautions when using batteries in this device:

1. Use only the size and type of batteries specified.
2. Be sure to follow the correct polarity when installing the batteries as indicated in the Battery Compartment. A reversed battery may cause damage to the device.
3. Do not mix different types of batteries together (e.g. Alkaline, Rechargeable, and Carbon-zinc) or old batteries with fresh ones.
4. If the device is not to be used for a long period of time, remove the batteries to prevent damage or injury from possible battery leakage.
5. Do not try to recharge a battery not intended to be recharged; it can overheat and rupture. (Follow battery manufacturer's directions.)

EFFECTIVE DISTANCE OF THE REMOTE CONTROL TRANSMITTER

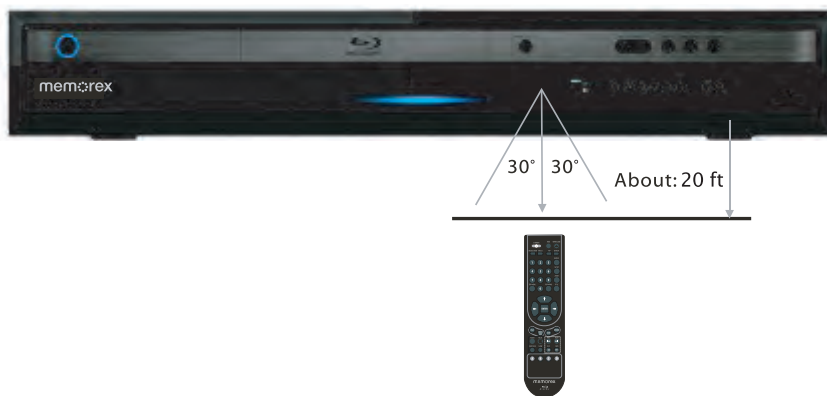

NOTES:

- When there is an obstacle between the Player and the transmitter, the transmitter may not operate.
- When direct sunlight, an incandescent lamp, fluorescent lamp or any other strong light shines on the REMOTE SENSOR of the Player, the remote operation may be unstable.

CONNECTION

CONNECTING THE PLAYER TO A TV USING THE AUDIO/VIDEO OUTPUT JACKS

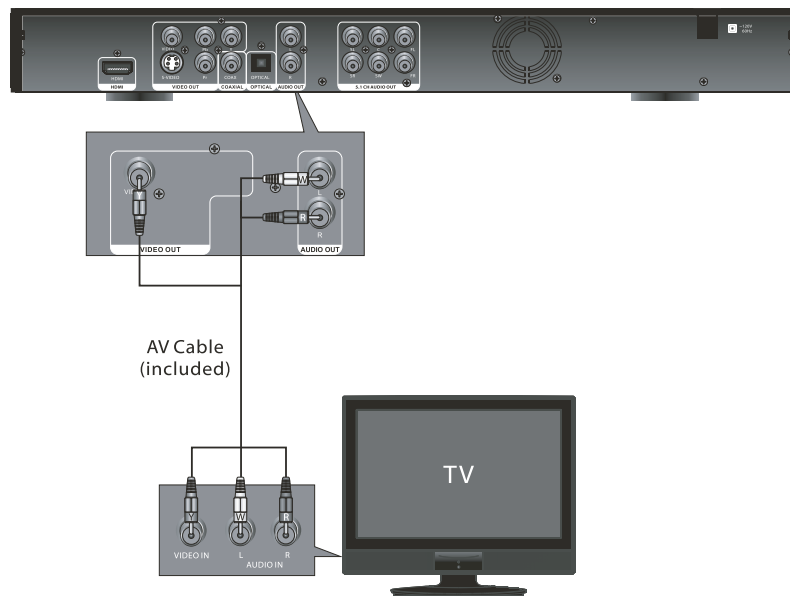

CONNECTING THE PLAYER TO A TV USING THE S-VIDEO OUTPUT JACK

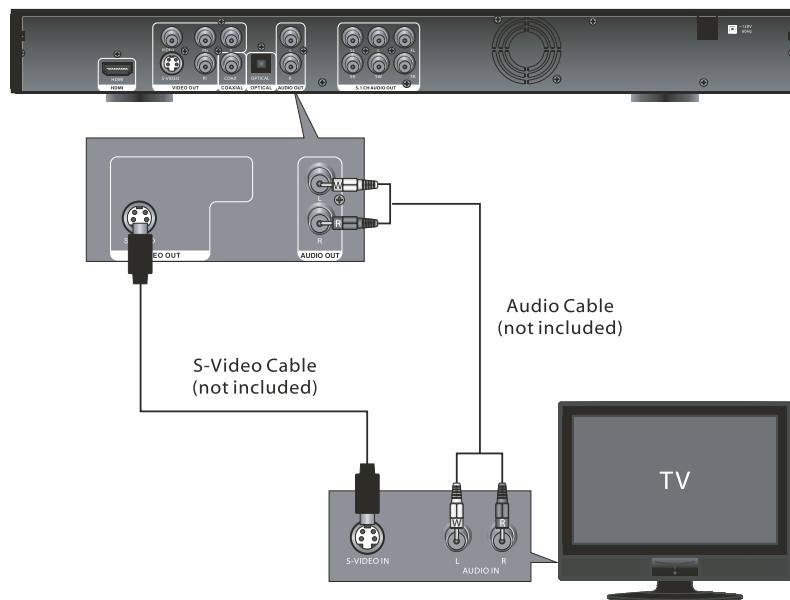

NOTES:

- If your TV has an HDMI input, connect the player with the HDMI cable for best results, otherwise use the Component, S-Video or Video OUT jack on the player.
- Set the TV's TV/VIDEO button or switch to the VIDEO setting.
- When connecting the Player, refer to the owner's manual of the TV, as well as this manual.
- When connecting the Player to the TV, make sure the power is off and both units are unplugged before making any connections.
- If your TV only has one audio input, the use of a "Y" connector may be necessary. Visit your local electronics supply store.
- Connect the player to your TV directly. If you connect the player through a VCR, the playback picture will be distorted because video discs are copy protected.
- The video source is always output in 480i resolution, regardless of the setup menu settings.

CONNECTION (CONTINUED)

CONNECTING THE PLAYER TO A TV USING THE Y/PB/PR JACKS

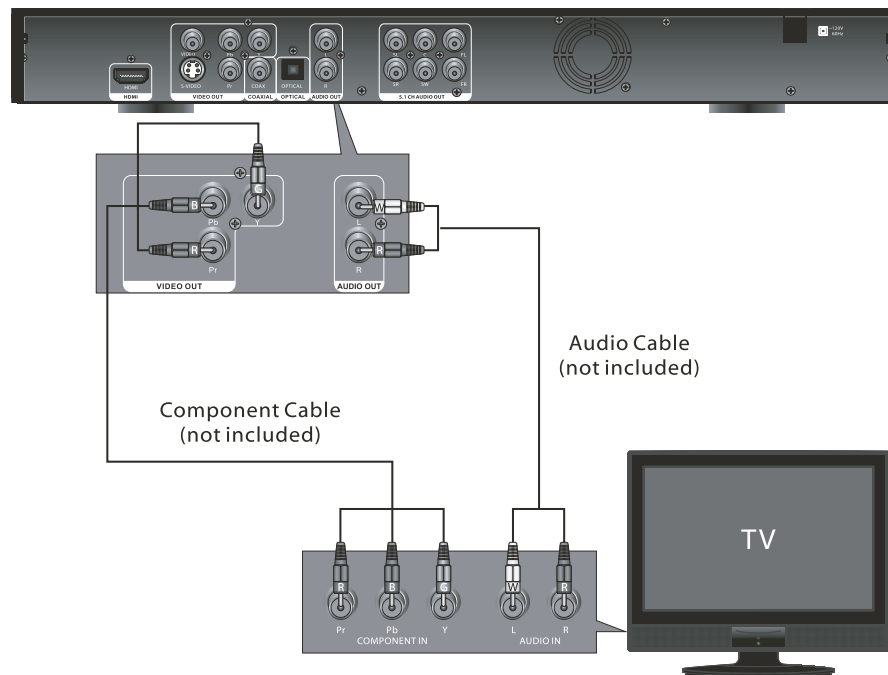

NOTES FOR CONNECTING TO A TV:

- If your TV has an HDMI input, connect the player with the HDMI cable for best results, otherwise use the Component, S-Video or Video OUT jack on the player.
- TV must have Y, PB and PR input jacks.
- Set the TV's TV/VIDEO button or switch to the VIDEO setting.
- When connecting the Player, refer to the owner's manual of the TV, as well as this manual.
- When connecting the Player to the TV, make sure the power is off and both units are unplugged before making any connections.
- Connect the player to your TV directly. If you connect the player through a VCR, the playback picture will be distorted because video discs are copy protected.
- If using a TV with a blue screen option, turn the option off, on the TV for best results.
- When using the component jacks as your source, setup the HD resolution in the Video menu as described on page 18.

PROGRESSIVE (Y, PB, PR) VIDEO OUTPUT:

Use these jacks to connect to a TV with progressive video input jacks. Progressive scan is a video scanning system that displays all lines in a frame in one pass, as opposed to the traditional system, interlaced scan. This connection provides optimum quality. To ensure maximum picture quality, use three video-grade cables for connections. Note that it is essential to match the color-coded connectors with a compatible TV.

525 LINE DIGITAL PROGRESSIVE-SCAN COMPONENT VIDEO OUTPUT

Compared to standard interlaced video, progressive scan effectively doubles the amount of video information fed to your TV or monitor. The result is a stable, flicker-free image. (Check your TV/monitor for compatibility with this feature.) For the very highest picture quality, try watching a movie on DVD-Video on a progressive-scan compatible TV.

NOTES:

- CONSUMERS SHOULD NOTE THAT NOT ALL HIGH DEFINITION TELEVISION SETS ARE FULLY COMPATIBLE WITH THIS PRODUCT AND MAY CAUSE ARTIFACTS TO BE DISPLAYED IN THE PICTURE. IN CASE OF 525 PROGRESSIVE SCAN PICTURE PROBLEMS, IT IS RECOMMENDED THAT THE USER SET THE VIDEO SETTING TO 480i OR 1080i INTERLACE SETTINGS, SEE PAGE 18.

CONNECTION (CONTINUED)

CONNECTING THE PLAYER TO A TV USING THE HDMI OUTPUT JACK

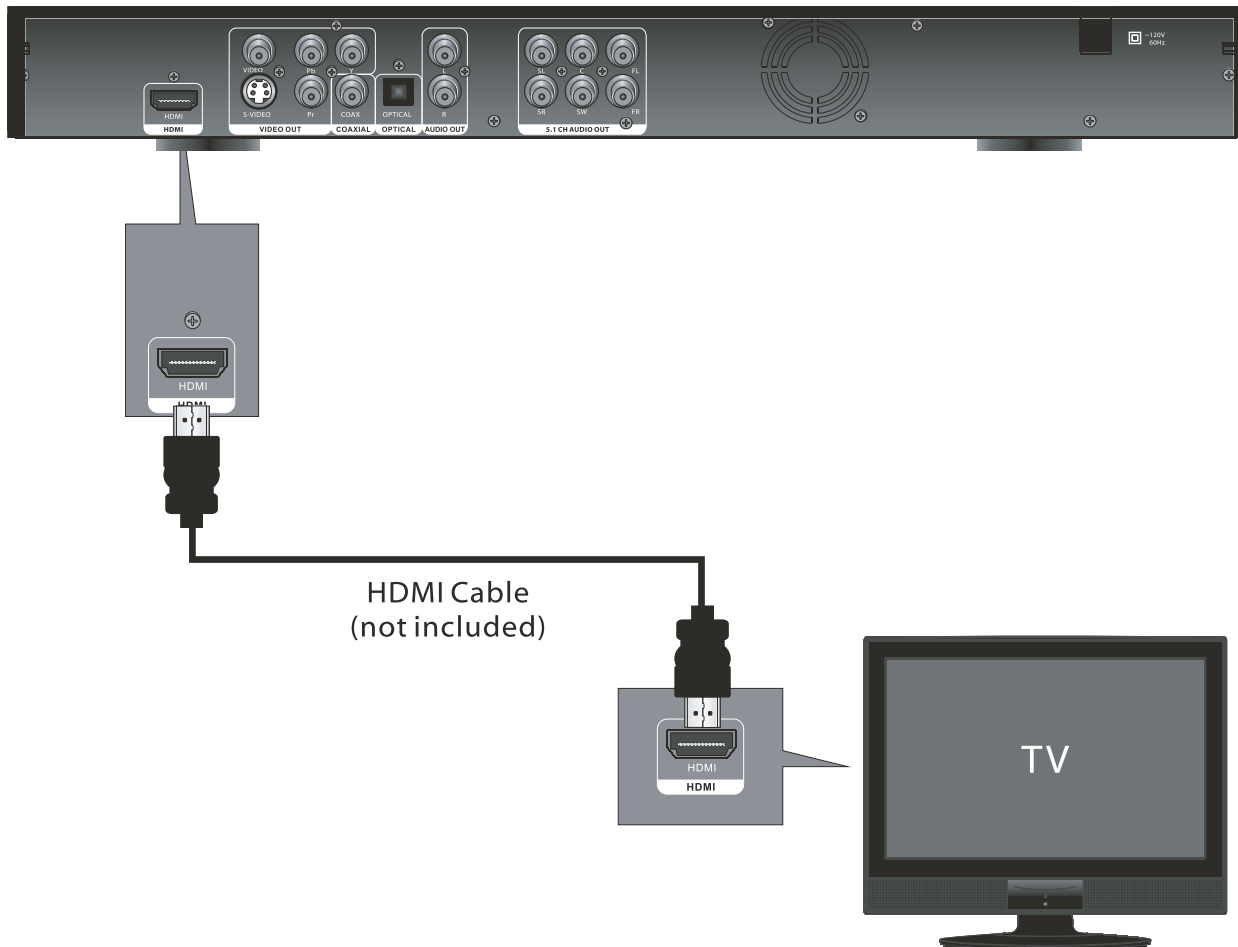

NOTES:

- If your TV has an HDMI input, connect the player with the HDMI cable for best results, otherwise use the Component, S-Video or Video OUT jack on the player.
- Set the TV's TV/VIDEO button or switch to the VIDEO setting.
- When connecting the Player, refer to the owner's manual of the TV, as well as this manual.
- When connecting the Player to the TV, make sure the power is off and both units are unplugged before making any connections.
- Connect the player to your TV directly. If you connect the player through a VCR, the playback picture will be distorted because video discs are copy protected.
- When using HDMI as your source, setup the HD resolution in the Video menu as described on page 18 and the Digital Output in the Audio menu as described on page 19.
- The player's video output will automatically change to HDMI when the HDMI cable is connected and the power is on.
- When you connect the HDMI cable to a TV for the first time, the HDMI output resolution will be automatically set to the highest provided by the TV.

CONNECTION (CONTINUED)

CONNECTING THE PLAYER TO A TV USING A DVI CABLE

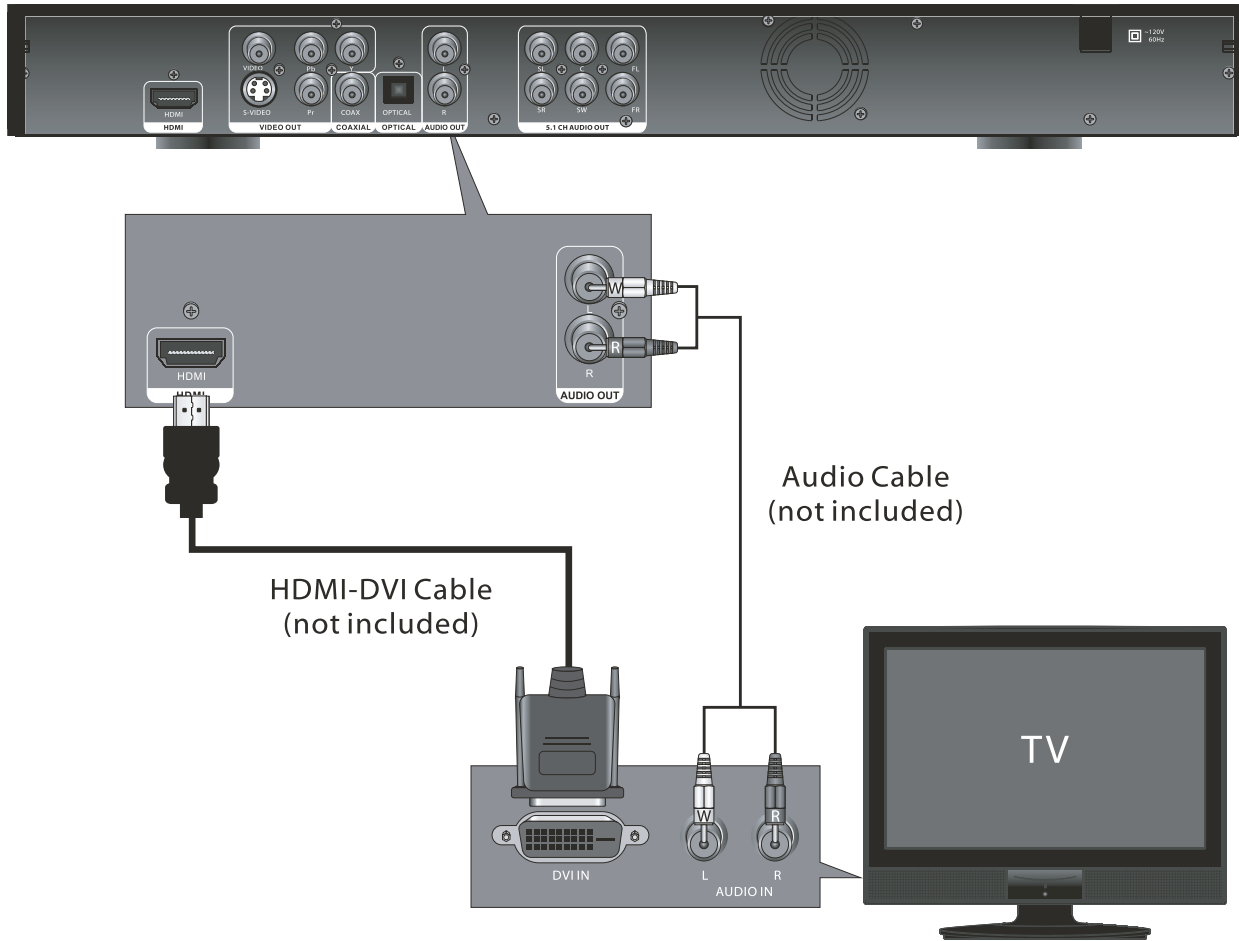

NOTES:

- Set the TV's TV/VIDEO button or switch to the VIDEO setting.
- When connecting the Player, refer to the owner's manual of the TV, as well as this manual.
- When connecting the Player to the TV, make sure the power is off and both units are unplugged before making any connections.
- Connect the player to your TV directly. If you connect the player through a VCR, the playback picture will be distorted because video discs are copy protected.
- When using HDMI as your source, setup the HD resolution in the Video menu as described on page 18.
- The player's video output will automatically change to HDMI when the HDMI cable is connected and the power is on.
- When you connect the HDMI cable to a TV for the first time, the HDMI output resolution will be automatically set to the highest provided by the TV.

CONNECTION (CONTINUED)

CONNECTING THE PLAYER TO A HOME THEATER SYSTEM (VIA COAXIAL JACK)

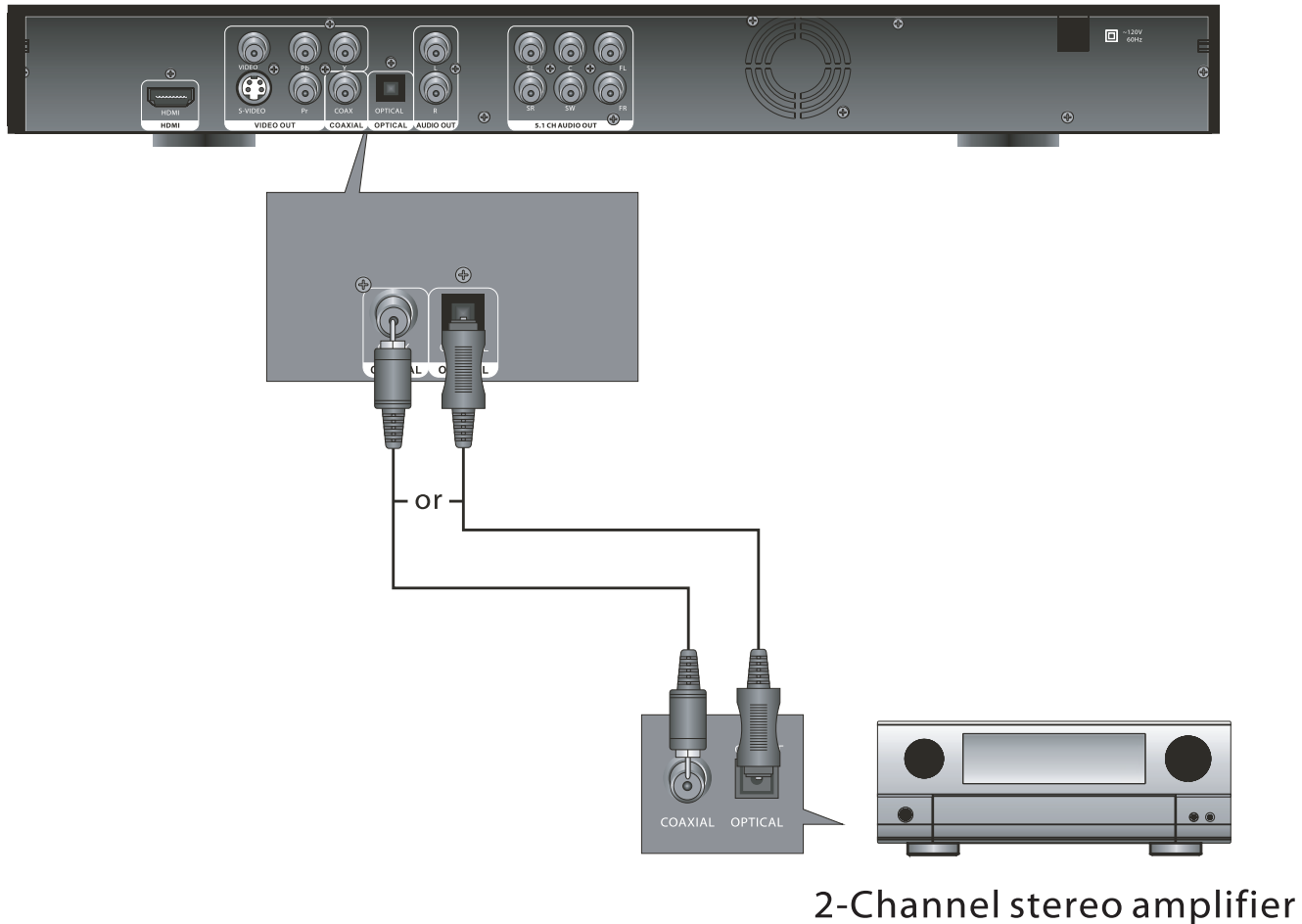

NOTES FOR CONNECTING TO A TV:

- If your TV has an HDMI input, connect the player with the HDMI cable for best results, otherwise use the Component, S-Video or Video OUT jack on the player.
- Set the TV's TV/VIDEO button or switch to the VIDEO setting.
- When connecting the Player, refer to the owner's manuals for the TV and the audio system, as well as this manual.
- When connecting, make sure the power is off and all units are unplugged before making any connections.
- Connect the player to your TV directly. If you connect the player through a VCR, the playback picture will be distorted because video discs are copy protected.
- If using a TV with a blue screen option, turn the option off, on the TV for best results.
- If you place the player near a tuner, the radio broadcast sound might be distorted. In this case, move the player away from the tuner.
- When using this connection, Blu-Ray discs with an LPCM audio soundtrack will only be heard over the front two channels.

CONNECTION (CONTINUED)

CONNECTING THE PLAYER TO A HOME THEATER SYSTEM (VIA 5.1 CHANNEL OUTPUT JACKS)

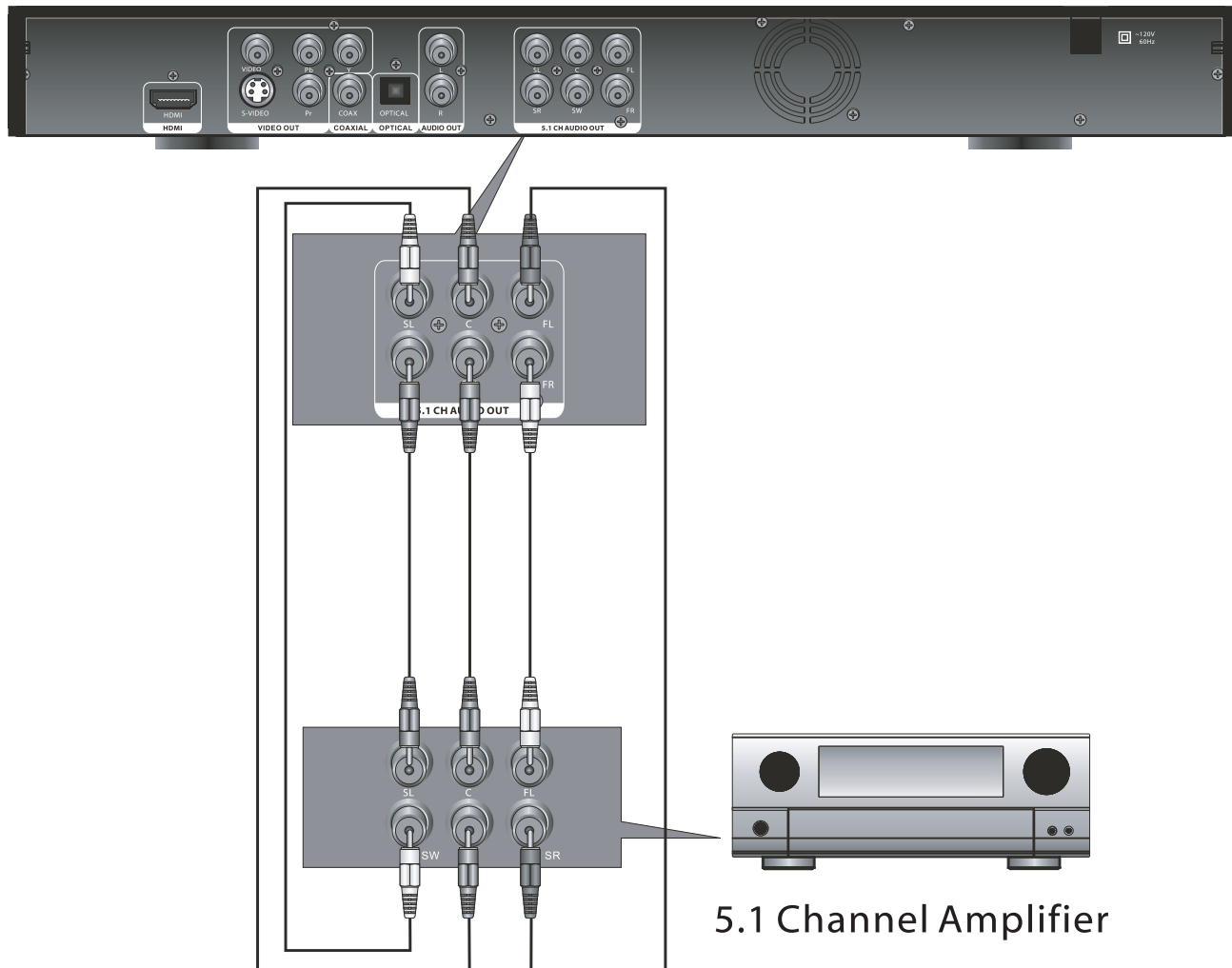

NOTES FOR CONNECTING TO A TV:

- If your TV has an HDMI input, connect the player with the HDMI cable for best results, otherwise use the Component, S-Video or Video OUT jack on the player.
- Set the TV's TV/VIDEO button or switch to the VIDEO setting.
- When connecting the Player, refer to the owner's manuals for the TV and the audio system, as well as this manual.
- When connecting, make sure the power is off and all units are unplugged before making any connections.
- Connect the player to your TV directly. If you connect the player through a VCR, the playback picture will be distorted because video discs are copy protected.
- If using a TV with a blue screen option, turn the option off, on the TV for best results.
- If you place the player near a tuner, the radio broadcast sound might be distorted. In this case, move the player away from the tuner.

ABOUT DISCS

The region/BD-ROM codes for this player are listed on the back of the player. See the following page for information regarding region/BD-ROM codes.

PLAYABLE DISCS:

The following discs can be played back on this player:



MP3

When playing an MP3, the total number of files will appear in the display, and the TV screen will list the folders/tracks. MP3 is the abbreviation of "MPEG1 Audio Layer 3". MPEG Audio is a format that compresses the audio portion only.

IMPORTANT NOTES:

Due to many variables, including recording condition, type of disc, writing software, etc., this unit does not guarantee playback of all MP3 discs.

DISC TYPES:

DVD/BD

Data on most discs is divided into sections called "titles" and then into subsections called "chapters", each of which is given a title or chapter number. Some features of this player will not operate with some discs as they are preset. If a function you selected does not run as desired, refer to the manual accompanying the disc.

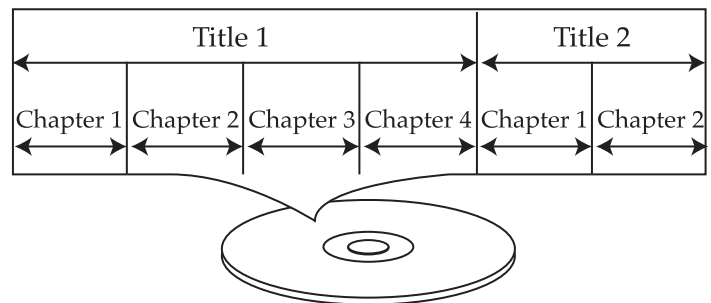

AUDIO CD

Data on an audio CD is divided into sections called "tracks", each of which is given a track number.

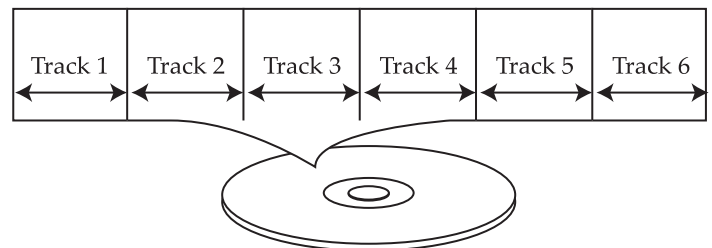

KODAK PICTURE CD

Data on a Kodak picture CD is usually not divided into separate folders, and should appear in the root directory.

ABOUT DISCS (CONTINUED)

DVD-R/RW

This disc can be played in this player once it has been finalized by the recording unit.

IMPORTANT:

It is important that you read the manual that accompanies the disc, as there are features that are on the player that cannot be used with certain discs. There are also extra features on the disc that are different for each disc, so they are not explained in this owner's manual.

This player conforms to the NTSC and PAL color systems. However, if you are in the USA, leave this setting on NTSC. If incorrectly set to PAL, the TV picture will roll vertically. In this case, simply turn the Player off, and then back on.

Notes on Copyright:

It is forbidden by law to copy, broadcast, show, broadcast on cable, play in public and rent copyrighted material without permission. Video discs are copy protected, and any recordings made from these discs will be distorted. This product incorporates copyright protection technology that is protected by method claims of certain U.S. patents and other intellectual property rights owned by Macrovision Corporation and other rights owners. Use of this copyright protection technology must be authorized by Macrovision Corporation, and is intended for home and other limited viewing uses only, unless otherwise authorized by Macrovision Corporation. Reverse engineering or disassembly is prohibited.

Region Management Information:

This Player is designed and manufactured to respond to the Region Management Information that is recorded on a disc. If the Region number described on the disc does not correspond to the Region number of this player, this player cannot play that disc. You may not be able to play back some video discs on this player if they were purchased from outside your geographic area or made for business purposes.

SETUP MENU

GENERAL SETUP MENU:

To enter the General Setup menu, press the SETUP button, select General using the Navigation (▲, ▼) buttons and then press the Navigation (▶) button.

RESET SETTINGS

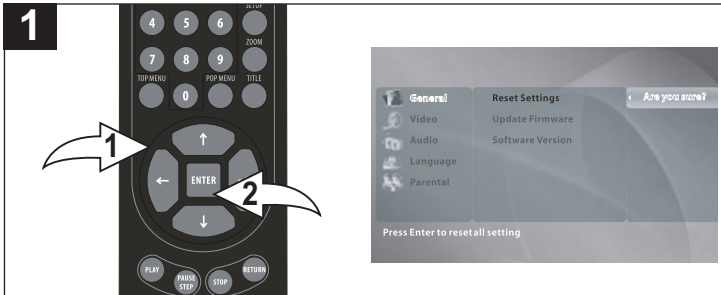

Use this option to reset all the settings to their original factory settings.

Select the General menu as shown above. Select Reset Settings using the Navigation (▲, ▼) buttons ❶, then press the Navigation (▶) button ❶; “Are you sure?” will appear. Press the ENTER button ❷, then select YES using the Navigation (◀, ▶) buttons ❶ and press the ENTER button ❷ again to reset the settings.

UPDATE FIRMWARE

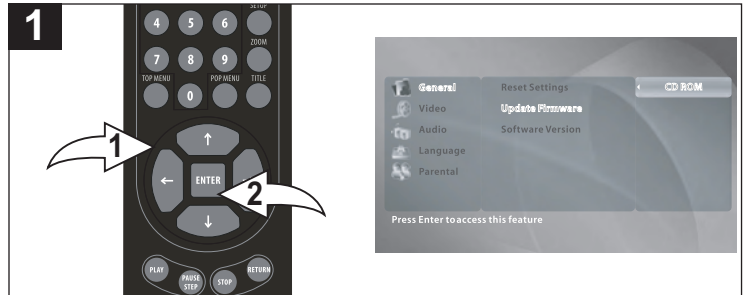

Information may offer upgrades to your player's firmware in the future. To upgrade, go to www.memorexelectronics.com and download the latest firmware, then load on a CD. Select the General menu as shown above. Select Update Firmware using the Navigation (▲, ▼) buttons ❶, then press the Navigation (▶) button ❶; “CD ROM” will appear. Press the ENTER button ❷, then select YES using the Navigation (◀, ▶) buttons ❶ and press the ENTER button ❷ again. Insert the CD and the updated firmware will install.

SOFTWARE VERSION

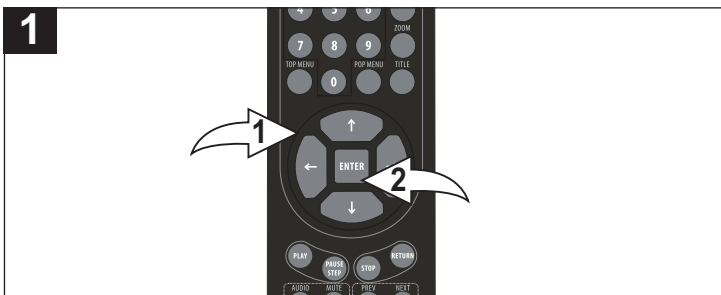

Use this option to view the Software version.

Select the General menu as shown above. Select Software Version using the Navigation (▲, ▼) buttons ❶, then press the Navigation (▶) button ❶; “View” will appear. Press the ENTER button ❷ to view the software version and firmware version.

NOTES:

- Press the SETUP button to exit the Setup menus.
- Press the RETURN button to return to the previous setting.

SETUP MENU (CONTINUED)

VIDEO SETUP MENU:

To enter the Video Setup menu, press the SETUP button, select Video using the Navigation (▲, ▼) buttons and then press the Navigation (▶) button.

TV ASPECT

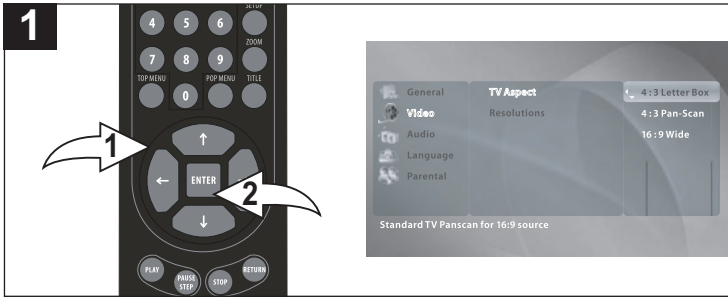

Use this option to set the desired TV Aspect. Select the Video menu as shown above. Select TV ASPECT using the Navigation (▲, ▼) buttons ❶, then press the Navigation (▶) button ❷; the TV ASPECT options will appear. Select one of the options (described below) using the Navigation (▲, ▼) buttons ❶, then press the ENTER button ❷.

4:3 PAN-SCAN: Select when the unit is connected to a conventional TV. Video material formatted in the Pan Scan style is played back in that style (the left and right edges are cut off).

4:3 LETTERBOX: Select when the unit is connected to a conventional TV. Wide-screen images are shown on the screen with a black band at the top and/or bottom.

16:9 WIDE: Select when the unit is connected to a wide-screen TV.

RESOLUTIONS

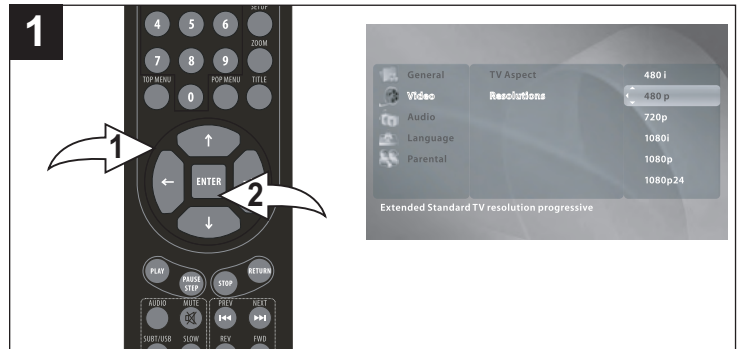

Use this option to set the desired resolution when connected to the component video output, or HDMI output. The true output resolution depends on the connection used and the TV's resolution.

Select the Video menu as shown above. Select Resolutions using the Navigation (▲, ▼) buttons ❶, then press the Navigation (▶) button ❷; the Resolution options will appear. Select one of the options (480i, 480p, 720p, 1080i, 1080p, 1080p24) using the Navigation (▲, ▼) buttons ❶, then press the ENTER button ❷.

See charts below for resolutions.

NOTES:

- Some movies will be displayed in 4:3 pillar box format (black bars on the sides of the picture), even if 16:9 Wide is selected in TV Aspect menu option.
- To use the 1080p24 (MovieFrame 24 Frames Per Second), the Blu-Ray disc must have this feature.
- The corresponding Resolution indicator will light up when the video signal outputted is 720p, 1080i, or 1080p.
- Press the SETUP button to exit the Setup menus.
- Press the RETURN button to return to the previous setting.

BD PLAYBACK RESOLUTION

Setup \ Output	HDMI	Component	VIDEO/S-Video
1080p	1080P@60F	1080i	480i
1080p24	1080P@24F	1080i	480i
1080i	1080i	1080i	480i
720P	720P	720P	480i
480P	480P	480P	480i
480i	480P	480i	480i

DVD PLAYBACK RESOLUTION

Setup \ Output	HDMI	Component	VIDEO/S-Video
1080p	1080P@60F	480P	480i
1080i	1080i	480P	480i
720P	720P	480P	480i
480P	480P	480P	480i
480i	480P	480i	480i

SETUP MENU (CONTINUED)

AUDIO SETUP MENU:

To enter the Audio Setup menu, press the SETUP button, select Audio using the Navigation (▲, ▼) buttons and then press the Navigation (▶) button.

DIGITAL OUTPUT

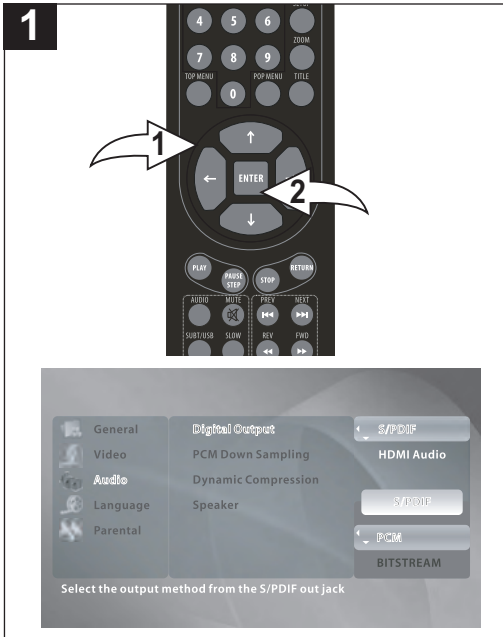

Use this option to set the Digital Output. See the chart below for specific outputs. Select the Audio menu as shown above. Select Digital Output using the Navigation (▲, ▼) buttons ❶, then press the Navigation (▶) button ❶; the Digital Output options will appear. Select one of the options (described below) using the Navigation (▲, ▼) buttons ❶, then press the ENTER button ❷.

S/PDIF: Select this when your equipment is connected via Optical/Coaxial cable. Select as follows:

PCM: Decodes using the internal decoder and outputs the audio in PCM form from the S/PDIF output jack(s).

BITSTREAM: Outputs the original bit stream directly from the S/PDIF output jacks.

HDMI AUDIO: Select this when your equipment is connected via HDMI cable. Select as follows:

PCM: Decodes using the internal decoder and outputs the audio in PCM form from the HDMI output jack.

BITSTREAM: Outputs the original bit stream directly from the HDMI output jack.

SETUP MENU (CONTINUED)

PCM DOWN SAMPLING

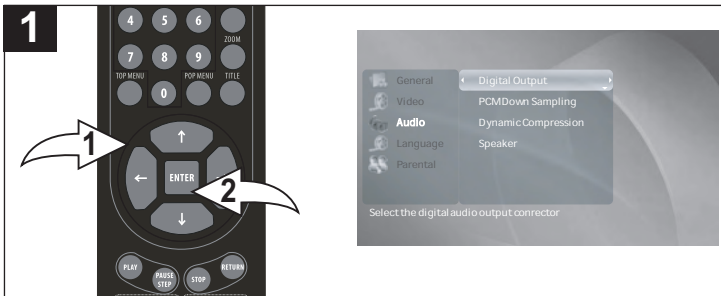

Use this option to turn the PCM down sampling On or Off. Some amplifiers cannot support the high sampling rate of the PCM signal. In this case, turn this option ON and the player will output at 48kHz.

Select the Audio menu as shown on the previous page. Select PCM DOWN SAMPLING using the Navigation (▲, ▼) buttons ❶, then press the Navigation (▶) button ❶; “ON” and “OFF” will appear. Select ON to turn on this option or OFF to turn off this option using the Navigation (▲, ▼) buttons ❶, then press the ENTER button ❷.

NOTE: Even when PCM down sampling is set to OFF, some discs will show output down sampled audio through the coaxial and optical digital outputs.

DYNAMIC COMPRESSION

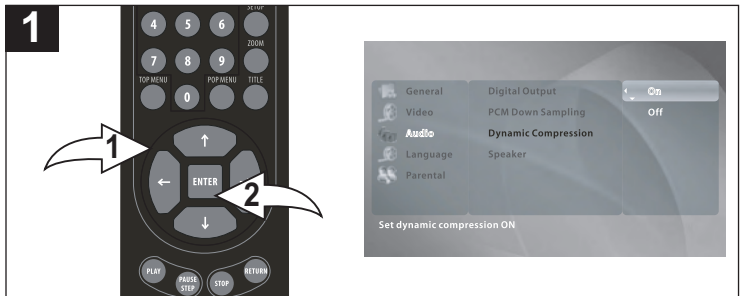

Use this option to turn the Dynamic Compression On or Off. Dynamic compression means reducing the gap between the loudest and softest sounds. This means you can listen at lower levels.

Select the Audio menu as shown on the previous page. Select Dynamic Range using the Navigation (▲, ▼) buttons ❶, then press the Navigation (▶) button ❶; “ON” and “OFF” will appear. Select ON to turn on this option or OFF to turn off this option using the Navigation (▲, ▼) buttons ❶, then press the ENTER button ❷.

NOTE: This option is effective only when the soundtrack is encoded as Dolby Digital.

SPEAKER

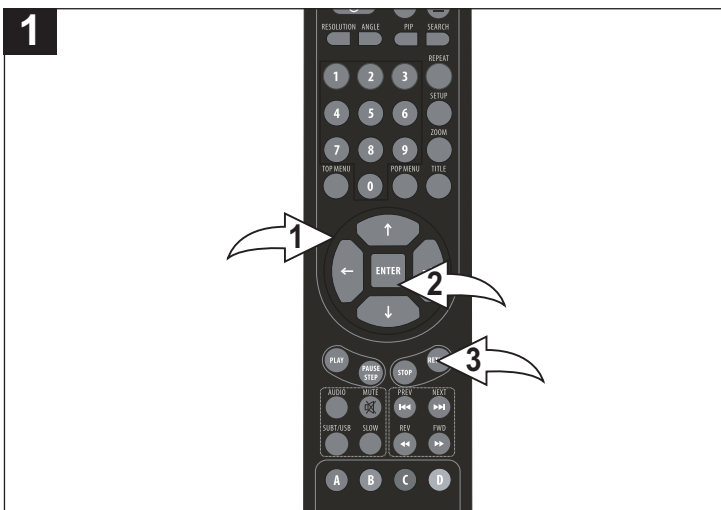

Use this option to turn on a speaker and to set the speaker distances from the user.

Select the Audio menu as shown on the previous page. Select Speaker using the Navigation (▲, ▼) buttons ❶, then press the Navigation (▶) button ❶; the Digital Output options will appear. Select one of the speakers ({C} Center, {L/R} Left/Right, {SL/SR} Surround Left/Surround Right, {LFE} Lower Frequency Effect) using the Navigation (▲, ▼) buttons ❶, then press the ENTER button ❷ to select. Press ENTER button again to disable this function or use Navigation (▲, ▼) buttons ❶ to highlight different speaker setting option. Adjust the distance from the desired seating area using the Navigation (◀, ▶) buttons ❶. When done, press the RETURN button ❸.

NOTES:

- Press the SETUP button to exit the Setup menus.
- Press the RETURN button to return to the previous setting.

SETUP MENU (CONTINUED)

LANGUAGE SETUP MENU:

To enter the Language Setup menu, press the SETUP button, select Language using the Navigation (▲, ▼) buttons and then press the Navigation (▶) button.

OSD (On Screen Display)

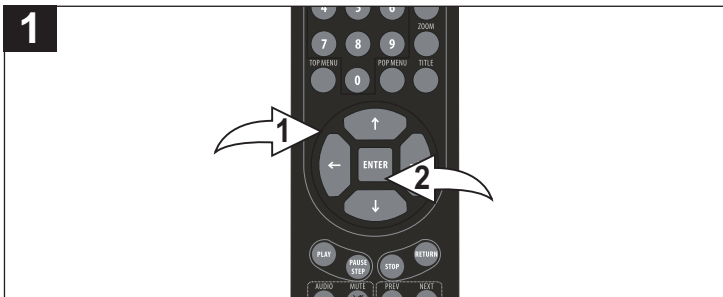

Use this option to select the desired language for the On-Screen display to display text.

Select the Language menu as shown above. Select OSD using the Navigation (▲, ▼) buttons ❶, then press the Navigation (▶) button ❷; the Language options will appear. Select the desired language using the Navigation (▲, ▼) buttons ❸, then press the ENTER button ❹.

AUDIO

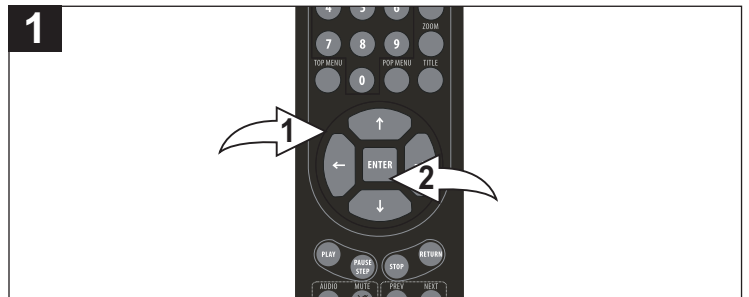

Use this option to select the language the disc will be played back in.

Select the Language menu as shown above. Select Audio using the Navigation (▲, ▼) buttons ❶, then press the Navigation (▶) button ❷; the Language options will appear. Select the desired language using the Navigation (▲, ▼) buttons ❸, then press the ENTER button ❹.

The disc must be recorded in the selected language, otherwise the default language of the disc will be played.

SUBTITLE

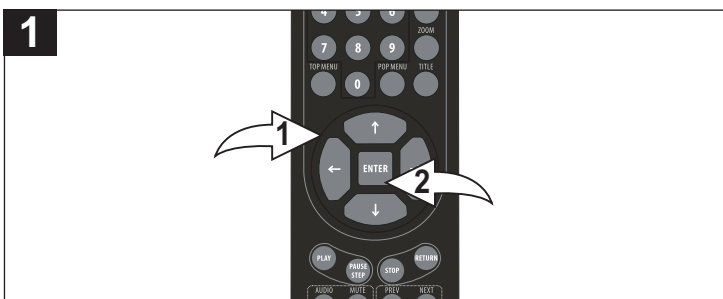

Use this option to select the language the Subtitle will be in. Select the Language menu as shown above. Select Audio using the Navigation (▲, ▼) buttons ❶, then press the Navigation (▶) button ❷; the Language options will appear. Select the desired language using the Navigation (▲, ▼) buttons ❸, then press the ENTER button ❹.

The disc must be recorded in the selected language, otherwise the default language of the disc will be shown.

NOTE: You can also use the SUBTITLE button to perform this function.

DISC MENU

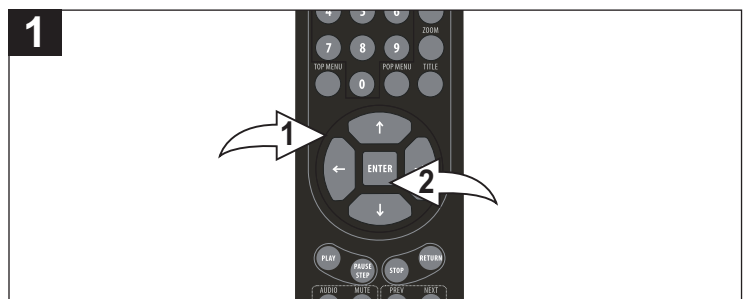

Use this option to select the language the Disc Menu will be in.

Select the Language menu as shown above. Select Audio using the Navigation (▲, ▼) buttons ❶, then press the Navigation (▶) button ❷; the Language options will appear. Select the desired language using the Navigation (▲, ▼) buttons ❸, then press the ENTER button ❹.

The disc must be recorded in the selected language, otherwise the default language of the disc will be shown.

NOTES:

- Press the SETUP button to exit the Setup menus.
- Press the RETURN button to return to the previous setting.

SETUP MENU (CONTINUED)

SETTING THE PARENTAL CONTROL OPTIONS

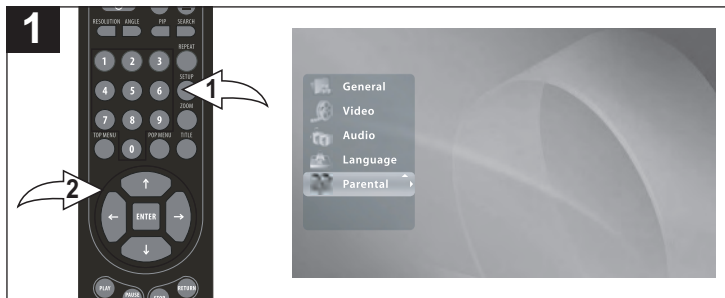

Press the SETUP button ❶, select Parental using the Navigation (▲, ▼) buttons ❷ and then press the Navigation (▶) button ❷.

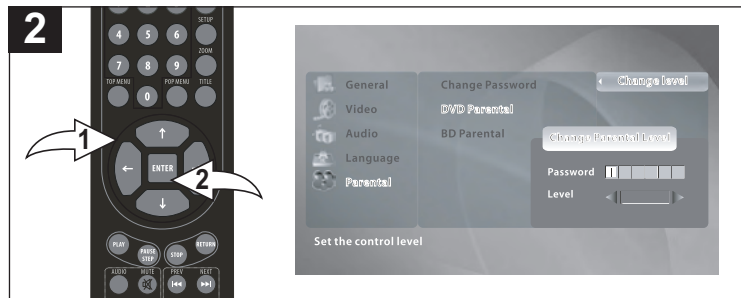

TO SET PARENTAL CONTROL:

Using the Navigation (▲, ▼) buttons ❶, select DVD Parental and then press the Navigation (▶) button ❶; "Change Level" will appear. Press the ENTER button ❷; the Password screen will appear.

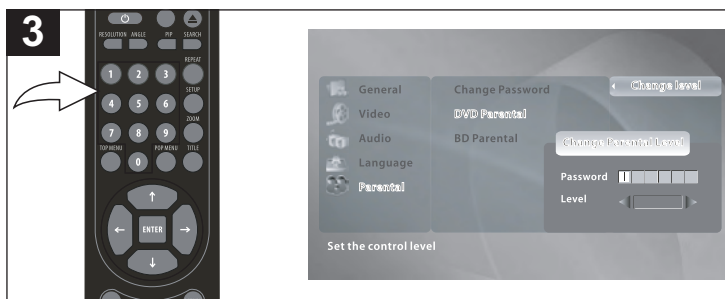

Enter the six-digit password using the Number (0-9) buttons. The default password is "000000", but it can be changed as per the instructions on the next page. The Disc Level Option will appear.

NOTE: If you enter the password incorrectly, just re-enter the password correctly.

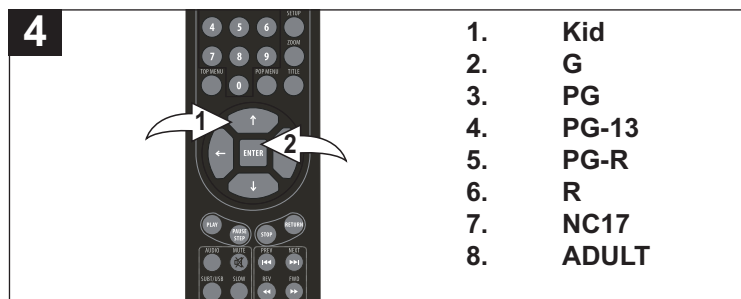

Using the Navigation (◀, ▶) buttons ❶, select the desired rating level for disc from 1-8 with 1 allowing most movies and 8 restricting the most. Select OFF to allow all movies. For example, if you select "6", discs that are level 7 or 8 cannot play.

When done, press the ENTER button ❷.

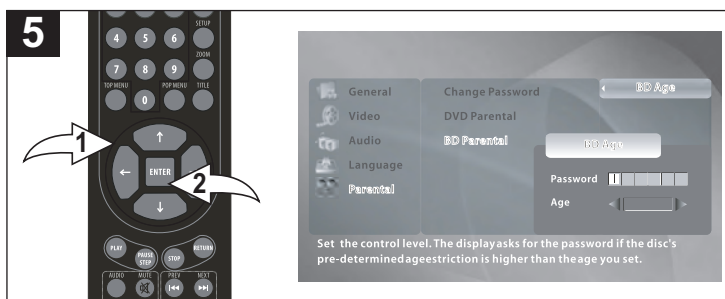

TO SET BLU-RAY DISC PARENTAL:

Using the Navigation (▲, ▼) buttons ❶, select BD Parental and then press the Navigation (▶) button ❶; "BD age" will appear. Press the ENTER button ❷; the Password screen will appear.



Enter the six-digit password using the Number (0-9) buttons. The default password is "000000", but it can be changed as per the instructions on the next page. The BD AGE Option will appear.

NOTE: If you enter the password incorrectly, just re-enter the password correctly.

CONTINUED ON THE NEXT PAGE

SET UP MENU (CONTINUED)

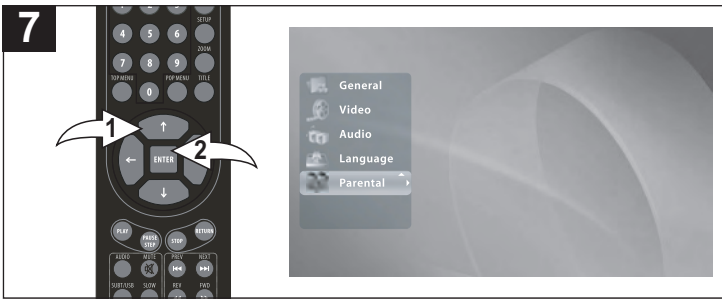

Using the Navigation (◀, ▶) buttons ❶, select the desired BD AGE for BD discs. Discs with ages over the selected setting will require a password to play. When done, press the ENTER button ❷.

NOTE: You can also select the BD AGE using the Number buttons (0-9).

CHANGING THE PASSWORD

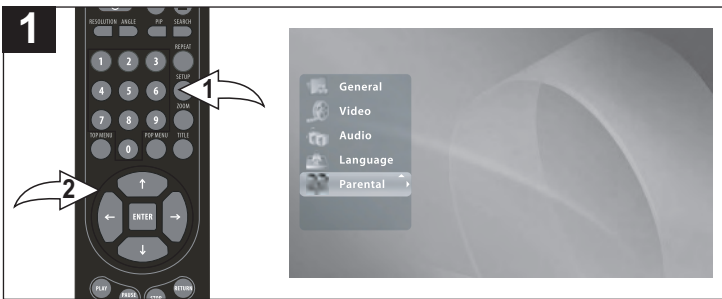

Press the SETUP button ❶, select Parental using the Navigation (▲, ▼) buttons ❷ and then press the Navigation (▶) button ❷.

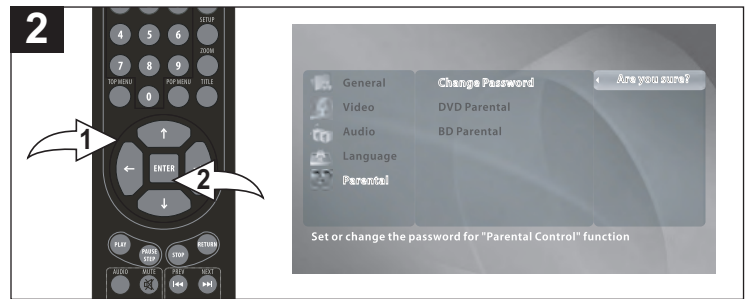

Using the Navigation (▲, ▼) buttons ❶, select Change Password and then press the Navigation (▶) button ❶; "Are you sure?" will appear. Press the ENTER button ❷.

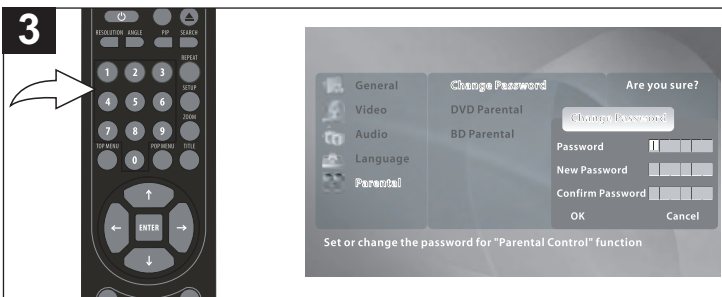

Enter the existing six-digit password using the Number (0-9) buttons. The default password is "000000".

Using the Number (0-9) buttons, enter a new password and then enter it again.

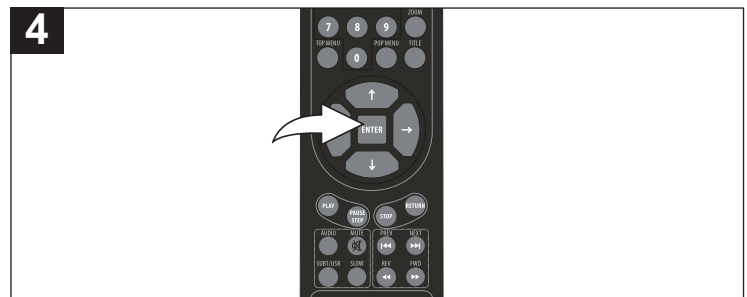

Press the ENTER button when OK is highlighted to confirm the new password.

BASIC OPERATION (GENERAL)

IMPORTANT:

When “INVALID KEY” appears while pressing a button, this means that the corresponding function cannot be performed either on the disc inserted, or in the selected mode.

MUTE

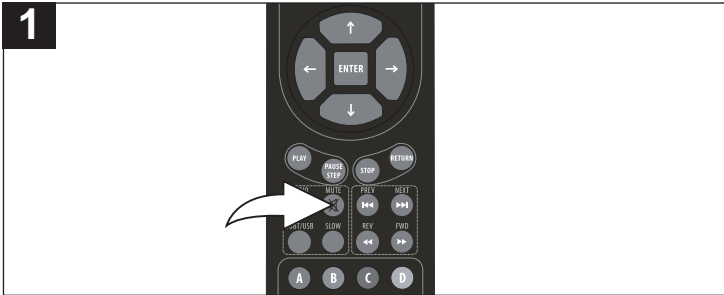

Press the MUTE button once to mute the sound, the Mute indicator will appear on the TV screen. Press the MUTE button again to restore the sound; the Mute indicator will disappear.

COLOR BUTTONS (A,B,C,D)

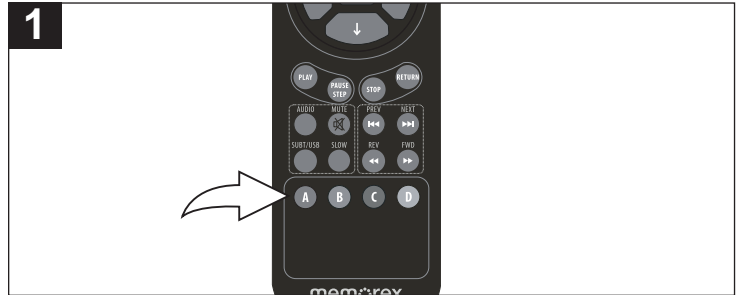

These buttons are used as shortcuts for some on-screen items when viewing Blu-ray discs (can also be used for BD's Java interactive operations).

VIDEO RESOLUTION

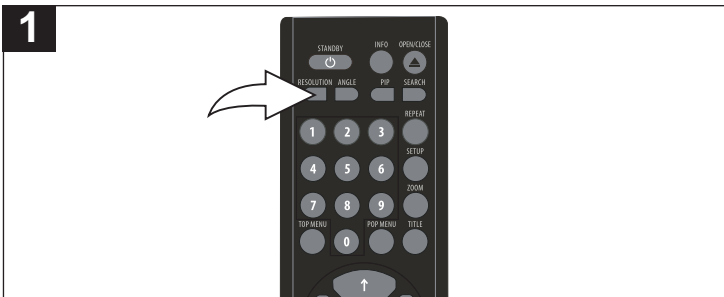

While there is no disc, press this button to change the output resolution. The output resolution quality depends on the video output jacks you are using, and the TV's video capabilities. The Resolution indicators will light according to the output. The corresponding Resolution indicator will light up when the video signal outputted is 720p, 1080i, or 1080p.

IMPORTANT NOTES:

- After plugging in, the unit will be in the Standby mode. Press the POWER/STANDBY button to turn on the unit; the opening screen "Memorex" will load, which could take up to a minute.
- If a disc is inserted incorrectly, is dirty and/or damaged “Unknown Disc” will appear on the TV screen.
- Always hold the disc without touching either of its surfaces. When inserting a disc, position it with the printed title side facing up, align it with the guides and place it in its proper position.
- It is important that you read the manual that accompanies the disc as there are features that are on this player that cannot be used with certain discs. There are also extra features that are different for each disc, so they are not explained in this owner's manual.

BD/DVD OPERATION

PLAYBACK OF A BLU-RAY DISC OR A STANDARD DVD



Press the POWER/STANDBY button to turn on the unit. The Power indicator light will go on.



Press the OPEN/CLOSE button to open the disc tray, "OPEN" will appear on the screen. Insert a disc with the label side facing up on the disc tray.

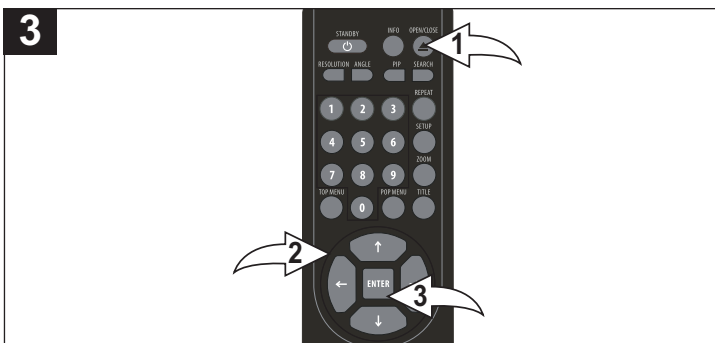

Press the OPEN/CLOSE button ❶ to close the disc tray. "Detecting Disc" will appear on the screen. After loading, the menu screen of the disc should appear. Use the Navigation (◀, ▶, ▲, ▼) buttons ❷ to select the desired option and the ENTER button ❸ to select it.

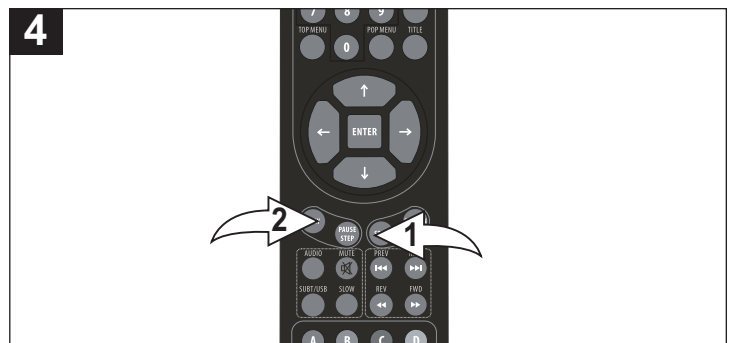

To stop playback, press the STOP button ❶; "Press [Stop] again to confirm. Press [Play] to resume" will appear on the TV screen. Because the unit will remember where you stopped, simply press the PLAY button ❷ to resume playback where you left off (resuming playback). If the STOP button ❶ is pressed again, the unit will enter the Stop mode.

NOTES:

- If a Menu appears on the TV screen, press the Navigation (◀, ▶, ▲, ▼) buttons to select the desired option/item, then press the ENTER button. Please make sure to refer to the disc's jacket or case for additional information.
- Resuming playback may not work on all discs.

BD/DVD OPERATION (CONTINUED)

SKIP

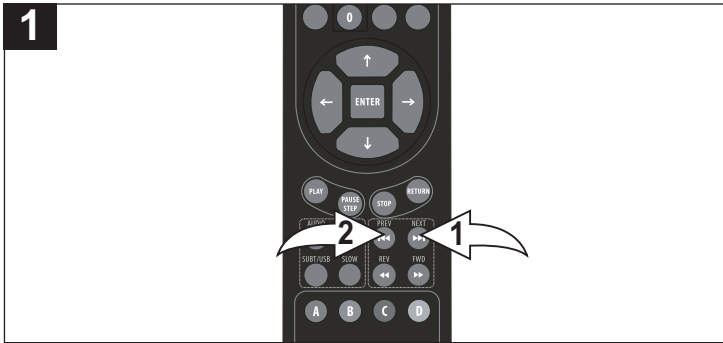

Press the SKIP **FWD** button **1** to advance the disc to the beginning of the next chapter.

Press the SKIP **REV** button **2** to move the disc to the beginning of the previous chapter.

SEARCH

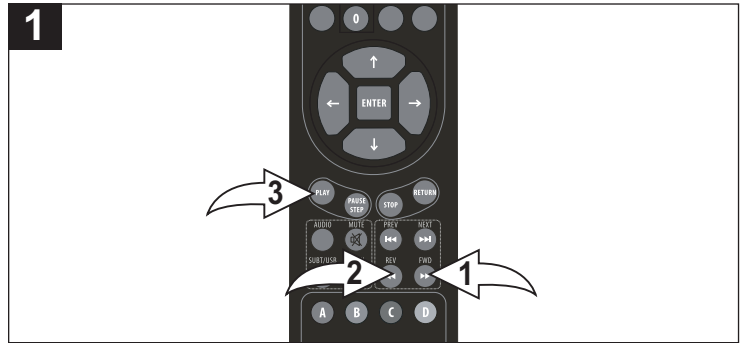

During playback, press either the Search/FWD **FWD** **1** or Search/REV **REV** **2** button to move the disc forward or backward at double (x2) speed to locate a specific section. Repeatedly press these buttons and the speed will increase to x4, x16 and resume normal playback. You can also resume normal playback by pressing the PLAY button **3**.

PAUSE AND STEP

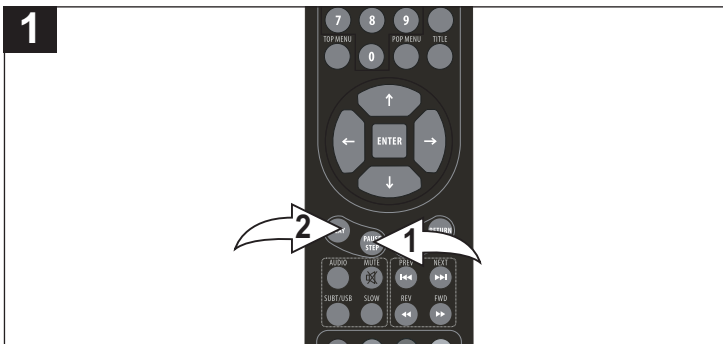

Press the PAUSE/STEP button **1** to pause the picture.

Repeatedly press the PAUSE/STEP button **1** to play the disc one frame at a time.

Press the PLAY button **2** to resume normal playback.

SLOW

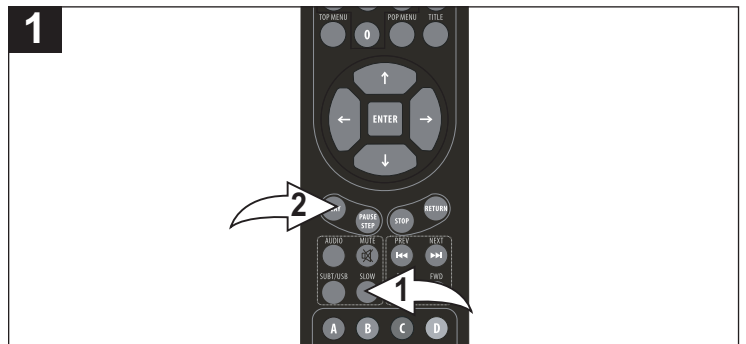

During playback, repeatedly press the SLOW button **1** to move the disc forward in slow motion speeds of 1/2, 1/4, 1/8 and resume normal playback. The sound will be muted. You can also resume normal playback by pressing the PLAY button **2**.

BD/DVD OPERATION (CONTINUED)

TOP MENU BUTTON

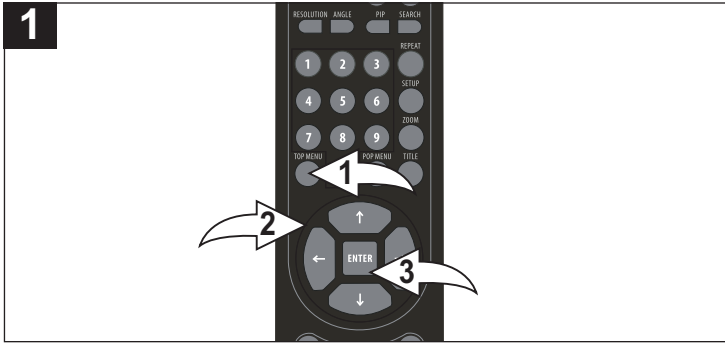

1 While playing a BD Disc, press the TOP MENU button ❶ to go to the disc's root menu. Use the Navigation (◀, ▶, ▲, ▼) buttons ❷ to select the desired option and the ENTER button ❸ to select it. The top menu will differ from disc to disc. Depending on the disc, the Top Menu may not be available.

TITLE MENU BUTTON

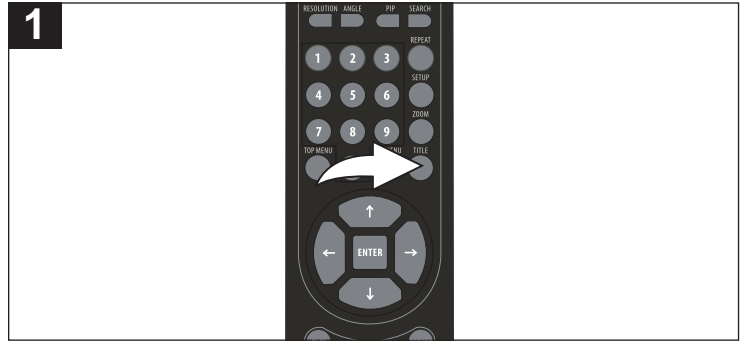

1 While playing a BD Disc, press the TITLE MENU button to go to the title menu.

Depending on the disc, the Title Menu may not be available.

POP MENU BUTTON

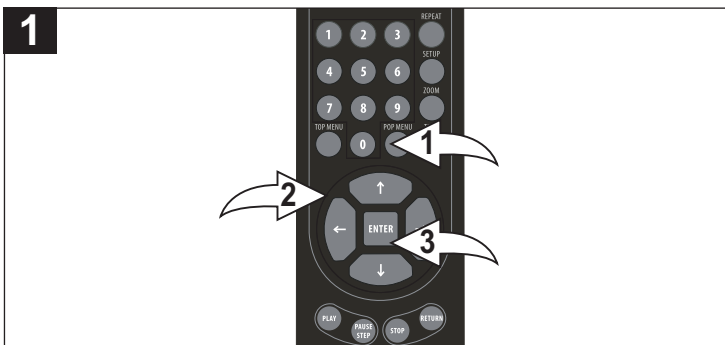

1 **DB-DVD:** Press the POP MENU button ❶ to display the pop menu while the BD disc is playing back. You can select various functions from this pop menu. Use the Navigation (◀, ▶, ▲, ▼) buttons ❷ to select the desired option and the ENTER button ❸ to select it.

DVD: Press this button to go to the disc's root menu.

Depending on the disc, the Pop Menu may not be available.

BD/DVD OPERATION (CONTINUED)

TIME SEARCH

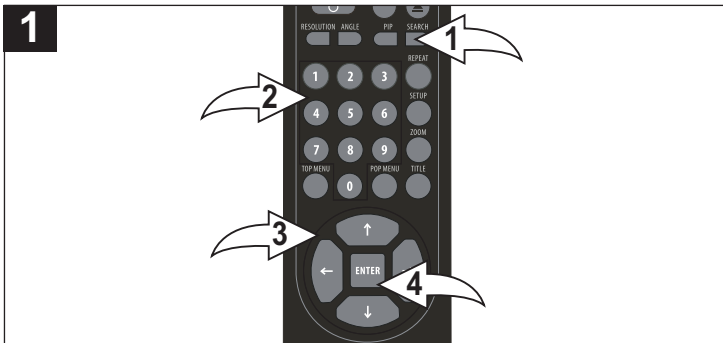

Press the SEARCH button ❶ once; the Time Search will appear. Using the Number buttons ❷, enter the hours, then press the Navigation (▶) button ❸. Using the Number buttons ❷, enter the minutes (two digits), then press the Navigation (▶) button ❸. Using the Number buttons ❷, enter the seconds, then press the Navigation (▶) button ❸; Search will be highlighted. Press the ENTER button ❹ to search or select Cancel to cancel the search.

INFO-TITLE/CHAPTER SEARCH

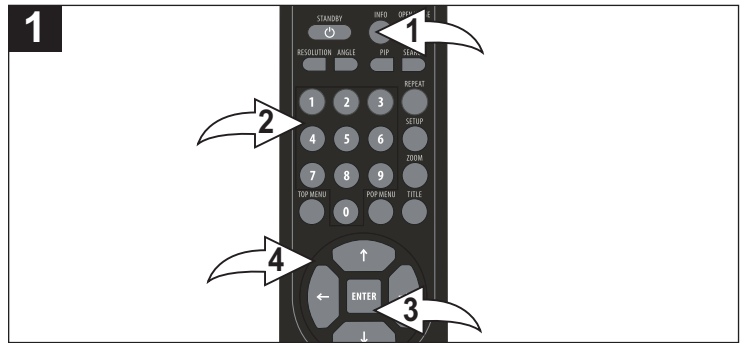

Press the INFO button ❶ to view the Play Mode, Disc, Frequency, HDMV (Elapsed Time), Title, Chapter, and Bit Rate.

The title number will be highlighted in red. To go to a different title, select a title number using the Number buttons (0-9) ❷, followed by the ENTER button ❸.

To go to a specific Chapter, press the Navigation (▼) button ❹ to highlight the Chapter in red. Select a chapter number using the Number buttons (0-9) ❷, followed by the ENTER button ❸.

REPEAT PLAYBACK



While in the Playback mode, press the REPEAT button once; "Repeat Title" will appear on the screen for a few seconds and the currently playing Title will repeat continuously. Press the REPEAT button a second time; "Repeat Chapter" will appear on the screen for a few seconds and the currently playing Chapter will repeat continuously. Press the REPEAT button again to cancel all Repeat modes; "Repeat Off" will appear on the screen temporarily.

This is not available on all discs.

PIP (PICTURE IN PICTURE)

Some BD discs have Picture in Picture capability.

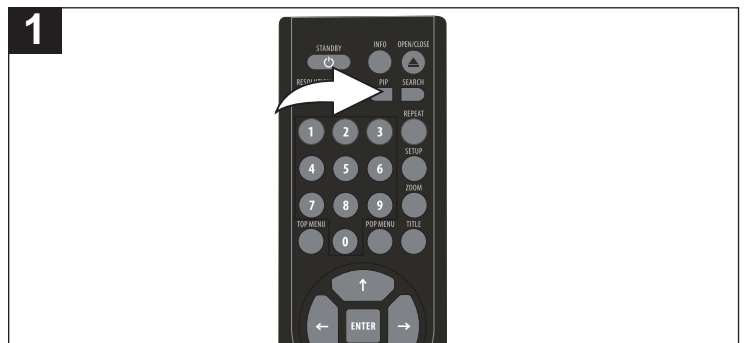

While viewing a disc (Blu-ray only) that has PIP capability, press the PIP button to view the picture in picture. Press again to disable.

BD/DVD OPERATION (CONTINUED)

ZOOM

The image on the screen can be magnified as follows:

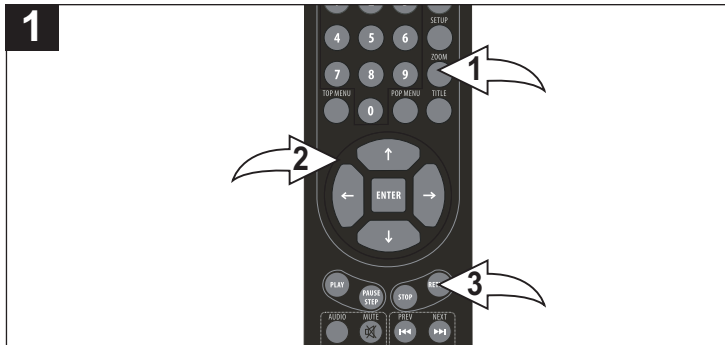

Press the ZOOM button ❶ once during Normal, Slow or Still playback modes, and the unit will zoom in. Repeatedly press to zoom in more. Use the Navigation (◀, ▶, ▲, ▼) buttons ❷ to move the image on the TV screen. Press the ZOOM button ❶ once more to cancel the zoom function or press the Return button ❸.

This is not available on all discs.

ANGLE

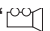
Some discs may contain scenes which have been shot simultaneously from a number of different camera angles. This feature only works on discs with more than one camera angle. The jacket will be marked with “”.

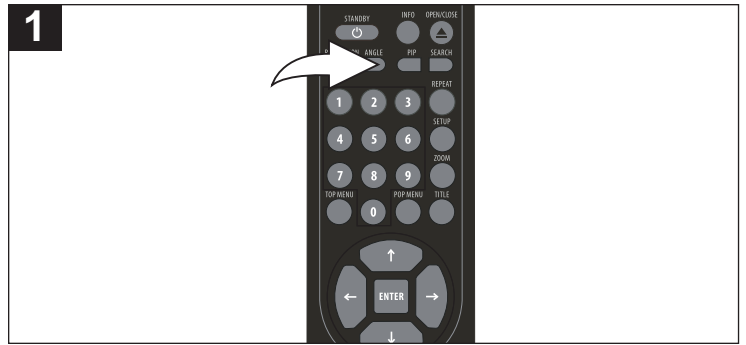

While in the Playback mode, press the ANGLE button; the total number of angles will appear on the screen. Repeatedly press the ANGLE button to select the desired angle; the angle will change in one to two seconds. This is not available on all discs.

SUBTITLE

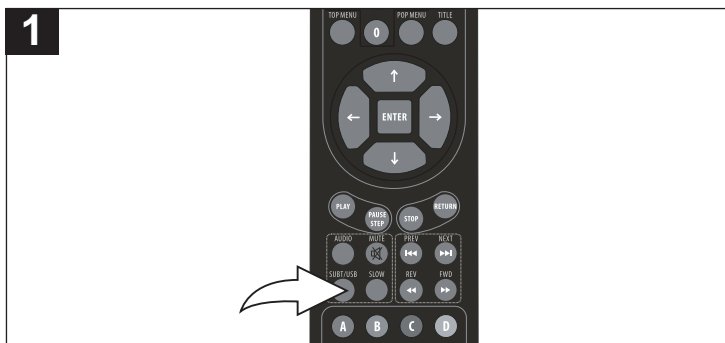

Press the SUBTITLE button repeatedly to select a subtitle language, and to turn the subtitle menu on/off. This feature is not available on all discs.

AUDIO

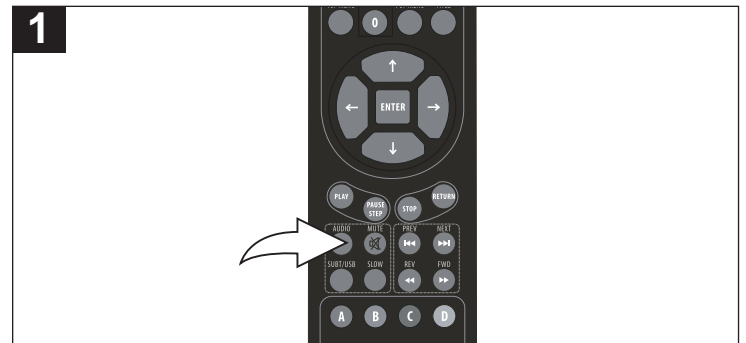

Press the AUDIO button repeatedly to change the audio language. This feature is not available on all discs.

MP3/WMA OPERATION

PLAYBACK OF AN MP3/WMA DISC



Press the POWER/STANDBY button to turn on the unit. The Power indicator light will go on.



Press the OPEN/CLOSE button to open the disc tray, "OPEN" will appear on the screen. Insert a disc with MP3/WMA files with the label side facing up on the disc tray.

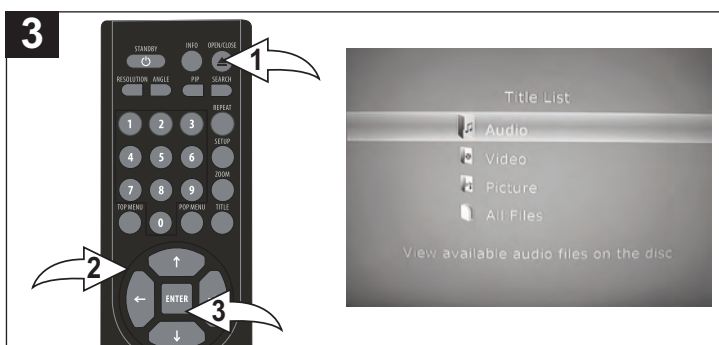

Press the OPEN/CLOSE button ❶ to close the disc tray. "Detecting Disc" will appear on the screen. After loading, the Title List screen of the disc will appear. Use the Navigation (▲, ▼) buttons ❷ to select Audio and then press the ENTER button ❸.

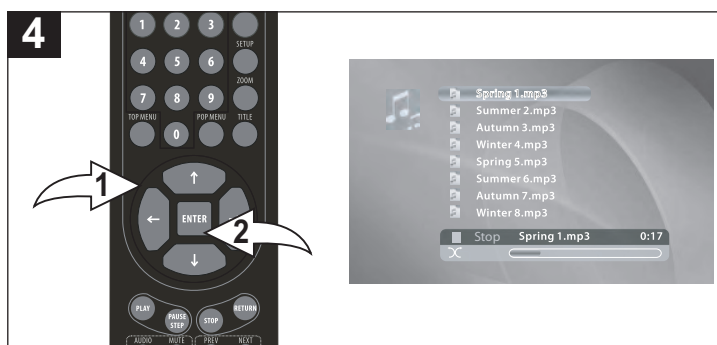

The list of files on the disc will appear. (If the disc has folders, then a list of folders will appear.) Use the Navigation (▲, ▼) buttons ❶ to select the desired MP3/WMA or folder and then press the ENTER button ❷ to start playback or enter the folder. Use Navigation (▲) button ❶ to go to the top file and press the ENTER button ❷ to go to the previous folder. To open the Title List menu with the desired MP3/WMA, press the Navigation ► button ❶.

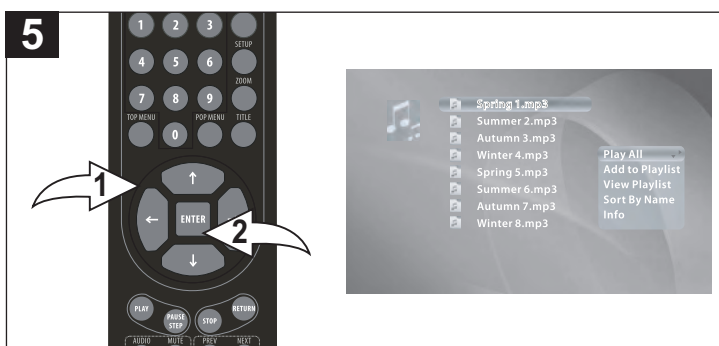

PLAY ALL: Select PLAY ALL from the Title List menu using the Navigation (▲, ▼) buttons ❶, then press the ENTER button ❷; the player will then play all of the files on the disc.

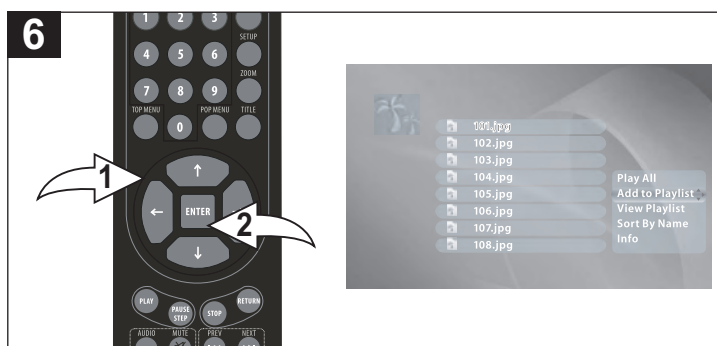

ADD TO PLAYLIST: Select ADD TO PLAYLIST from the Title List menu using the Navigation (▲, ▼) buttons ❶, then press the ENTER button ❷; the song will be added to the playlist.

MP3/WMA OPERATION (CONTINUED)

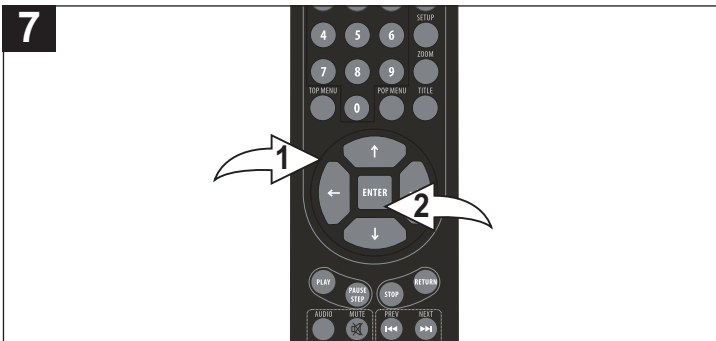

7 **VIEW PLAYLIST:** Select VIEW PLAYLIST from the Title List menu using the Navigation (▲, ▼) buttons ❶, then press the ENTER button ❷; the playlist will appear. You can then press the ENTER button ❷ again to start playback of your playlist.

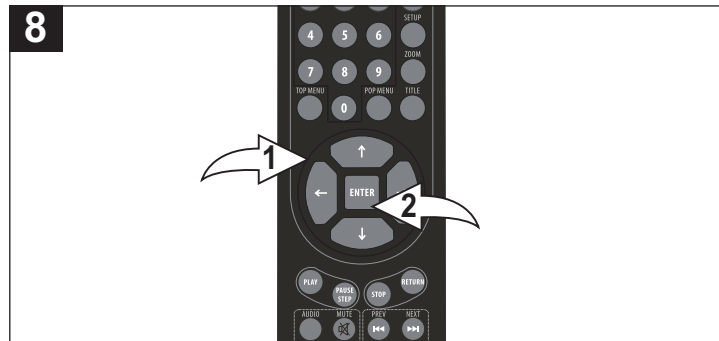

8 **SORT BY NAME:** Select SORT BY NAME from the Title List menu using the Navigation (▲, ▼) buttons ❶, then press the ENTER button ❷; the playlist will sort in alphabetical order.

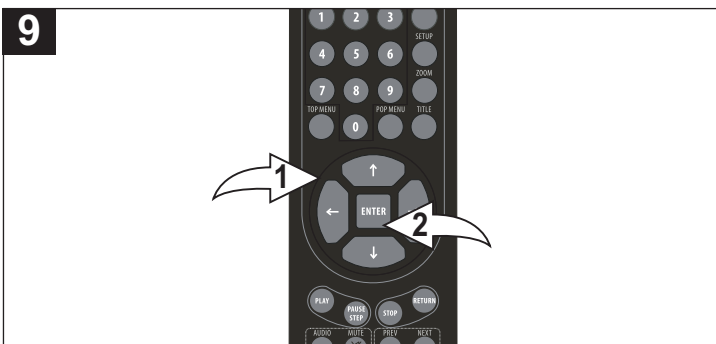

9 **INFO:** Select INFO from the Title List menu using the Navigation (▲, ▼) buttons ❶, then press the ENTER button ❷; the information of the selected file will appear.

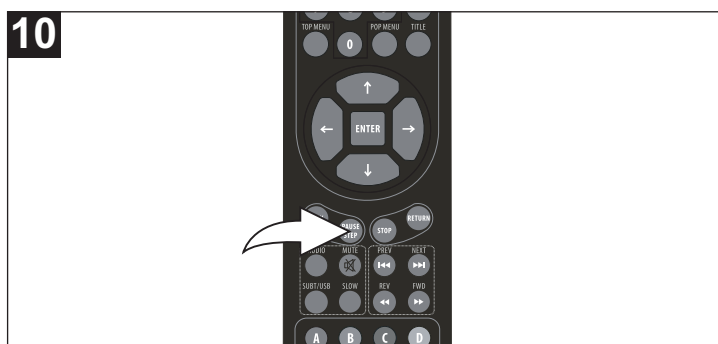

10 Press the PAUSE/STEP button ❶ to pause playback. Press the PLAY button ❷ to resume playback.

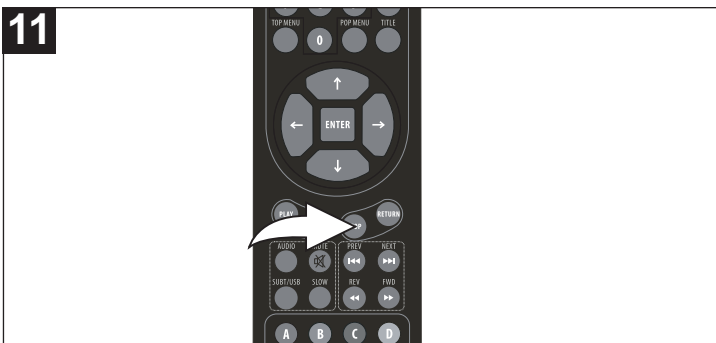

11 Press the STOP button to stop playback.



NOTES:

- Press the RETURN button to return to the Title List screen.
- The Skip, Search, Pause, Repeat and Zoom will operate as described previously, depending on the type of files played.
- Press RETURN button repeatedly to return to the main menu and press the PLAY button to play the disc, if inserted.

MP3/WMA OPERATION (CONTINUED)

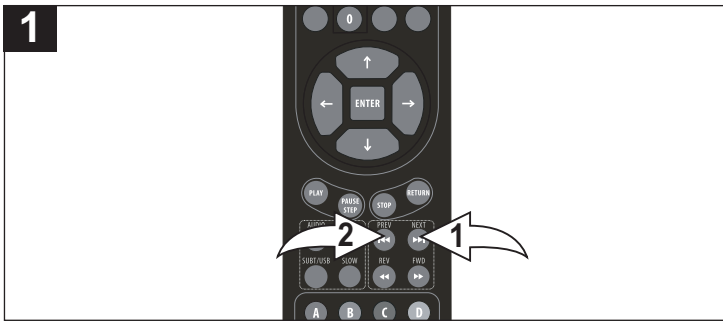
SELECTING FOLDERS/TRACKS USING THE SKIP OR BUTTON



During playback, simply press the SKIP  ① or  ② button to select a file to be played.

REPEAT PLAY

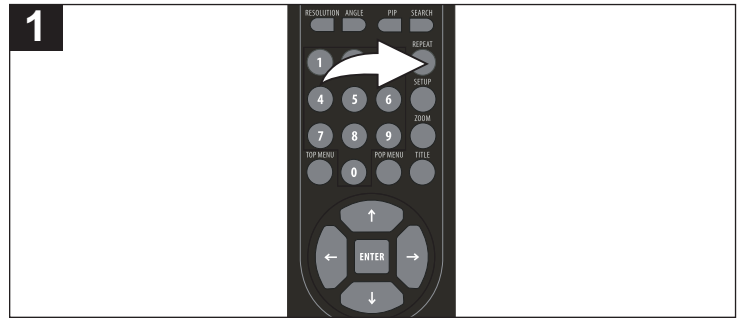

To repeat the folder or playlist, press the REPEAT button. Press again to stop repeat playback and press REPEAT button again to cancel repeat function.

MP3 FAQs (Frequently Asked Questions)

Please read before playing an MP3 CD.

What is an MP3 file?

An MP3 file is a computer format that makes a usually large music file into a smaller one which is more convenient to download and share.

Can I record my own MP3 CDs?

Yes, but you need a CD recorder, which is available from your local computer store.

Where can I find MP3 files?

MP3 files are available on the Internet.

Can this unit read regular music CDs?

Yes, it can. However, you cannot mix MP3s and WAV files on the same CD. If you do this, the unit will play only the MP3 files.

Can I use the MP3 extension for non-audio data files?

No, this may result in serious malfunction and harmful noise interference.

Can I mix MP3 files with other file types on the CDR?

Yes, but the unit will ignore those files and read only the MP3 files on the CDR.

Does this unit support subdirectories (subfolders)?

Yes, it can read MP3 files from subfolders.

CD OPERATION

PLAYBACK OF A CD



Press the POWER/STANDBY button to turn on the unit. The Power indicator light will go on.



Press the OPEN/CLOSE button to open the disc tray, "OPEN" will appear on the screen. Insert a music CD with the label side facing up on the disc tray.



Press the OPEN/CLOSE button to close the disc tray. "Detecting Disc" will appear on the screen. After loading, the Title List screen of the disc should appear and Track 1 will automatically start playing.

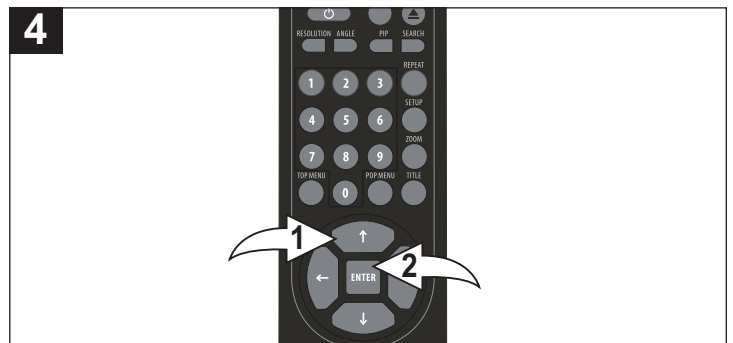

Use the Navigation (▲, ▼) buttons ❶ to select a different track, then press the ENTER button ❷ to begin playback.

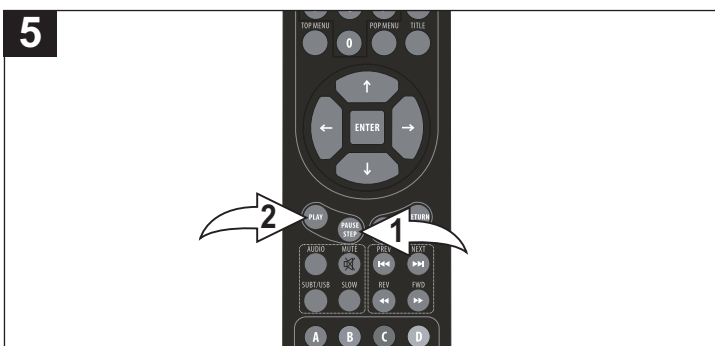

Press the PAUSE/STEP button ❶ to pause playback. Press the PLAY button ❷ to resume playback.

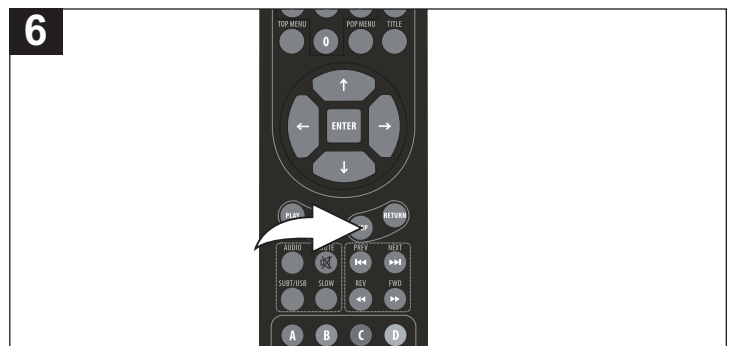

Press the STOP button to stop playback.

CD OPERATION (CONTINUED)

SELECTING TRACKS/FILES USING THE NUMBER BUTTONS

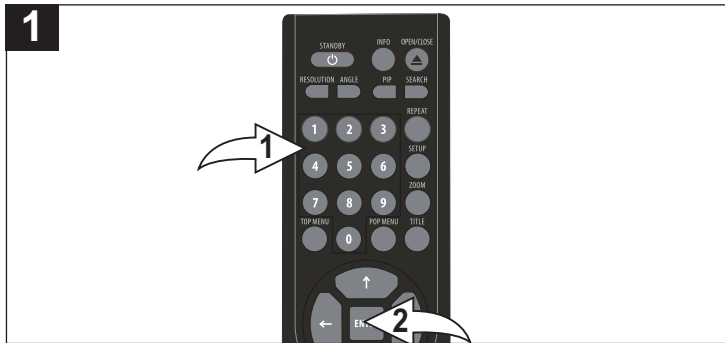

Press the Number buttons **1** corresponding to the track number you would like to play, then press the ENTER button **2** and the unit will playback the desired track automatically.

SELECTING TRACKS/FILES USING THE SKIP **⏮** OR **⏭** BUTTON

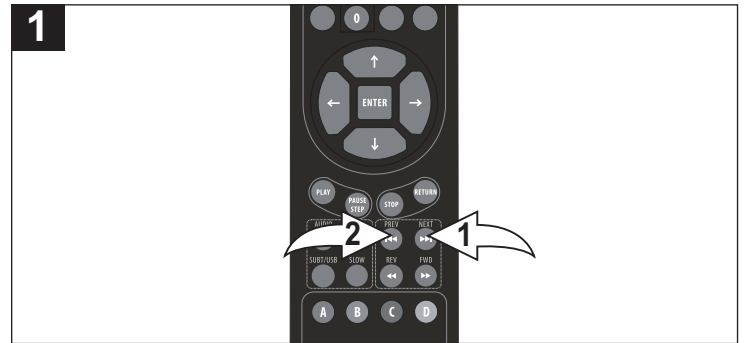

During playback, press the SKIP **⏭** **1** or **⏮** **2** button to select the next or previous track to be played.

FORWARD **⏭** / REVERSE **⏮** SEARCH

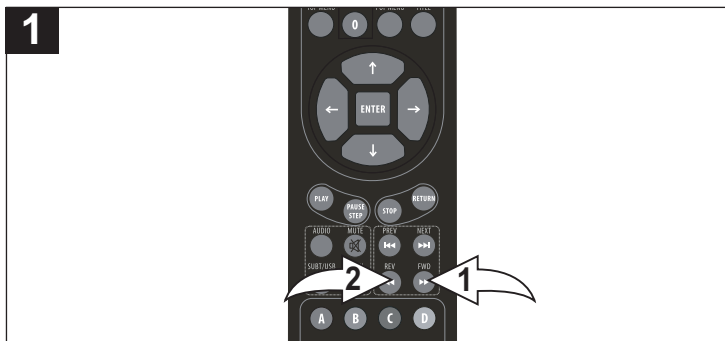

Each press of the SEARCH **⏭** **1** or **⏮** **2** button will increase the search as follows:

- 1st press: x 2
- 2nd press: x 4
- 3rd press: x 16
- 4th press: Resume Normal Playback

REPEAT/RANDOM



To repeat play a track, simply select the track as described previously, then press the REPEAT button once and the unit will repeat all the tracks on the disc, press twice and the unit will selected track continuously. Press the REPEAT button a third time and the unit will randomly repeat all the tracks on the disc. To cancel Repeat play, press the REPEAT button a fourth time.

DATA CD/USB OPERATION

PLAYBACK OF A DATA (PICTURE, AUDIO, VIDEO) CD/USB



Press the POWER/STANDBY button to turn on the unit. The Power indicator light will go on.

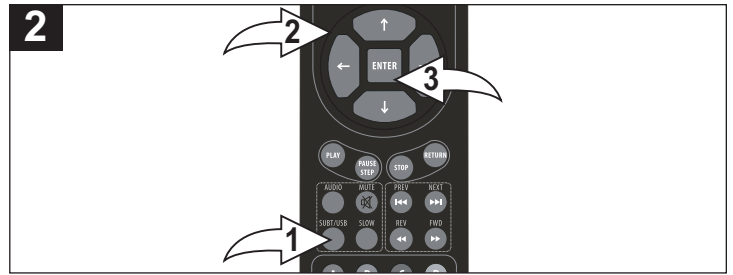

While the disc is in Stop mode (press the Stop button twice) or no disc, insert the USB device with data files and press the SUBTITLE/USB button ❶ to select USB, then select the desired USB device. Or insert a disc with data files. Data files can be movies, audio files or pictures. See the specifications for details on the file formats allowed. After loading, the Title List screen of the disc will appear. Use the Navigation (▲, ▼) buttons ❷ to select a format and then press the ENTER button ❸.

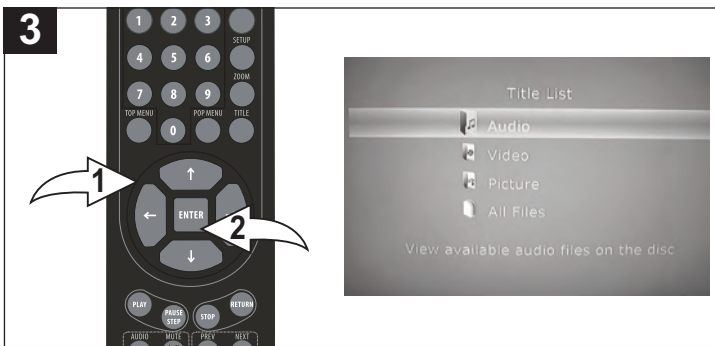

The list of files on the disc will appear. (If the disc has folders, then a list of folders will appear.) Use the Navigation (▲, ▼) buttons ❶ to select the desired file or folder and then press the ENTER button ❷ to start playback or enter the folder. Use Navigation (▲) button ❶ to go to the top file and press the ENTER button ❷ to go to the previous folder. To open the Title List menu with the desired MP3/WMA, press the Navigation ► button ❶.

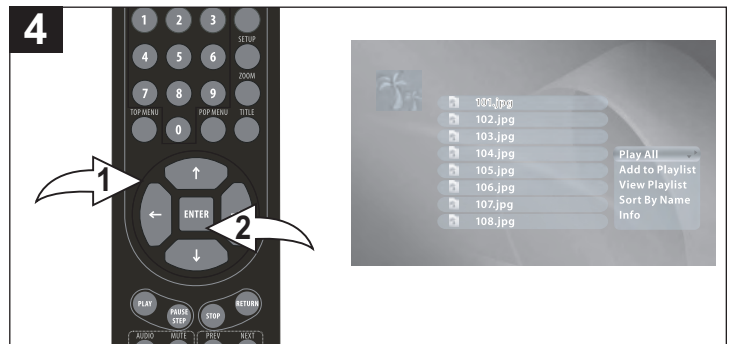

PLAY ALL: Select PLAY ALL from the Title List menu using the Navigation (▲, ▼) buttons ❶, then press the ENTER button ❷; the player will then play all of the files on the disc.

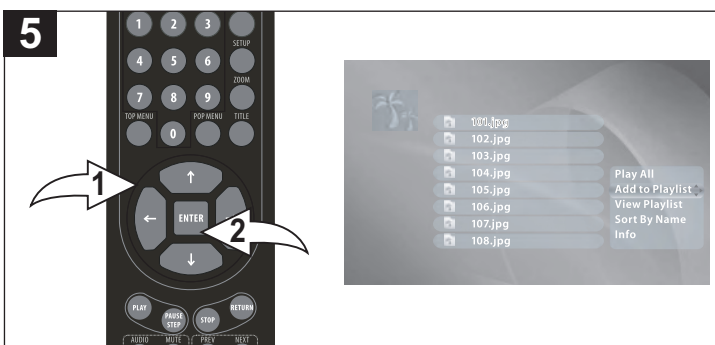

ADD TO PLAYLIST: Select ADD TO PLAYLIST from the Title List menu using the Navigation (▲, ▼) buttons ❶, then press the ENTER button ❷; the file will be added to the playlist.

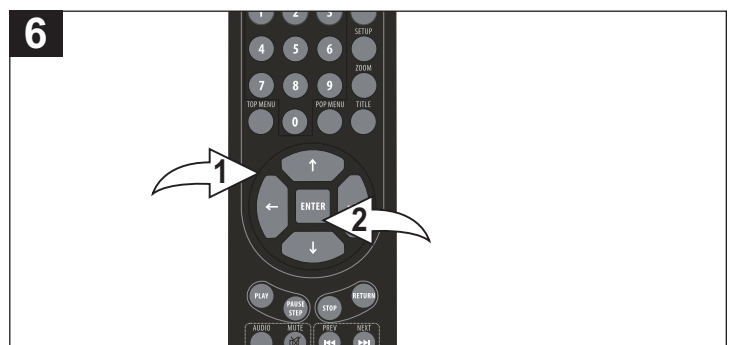

VIEW PLAYLIST: Select VIEW PLAYLIST from the Title List menu using the Navigation (▲, ▼) buttons ❶, then press the ENTER button ❷; the playlist will appear. You can then press the ENTER button ❷ again to start playback of your playlist.

DATA CD/USB OPERATION (CONTINUED)

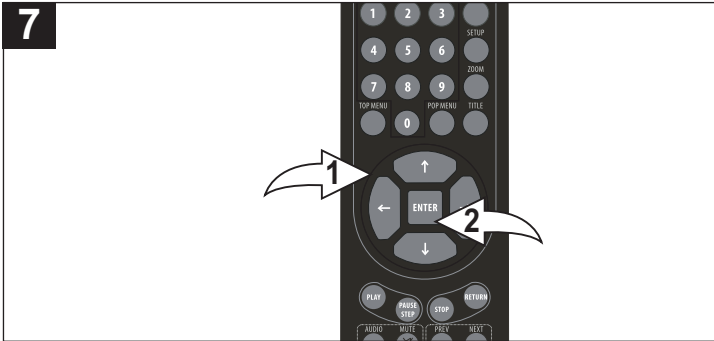

7 **SORT BY NAME:** Select SORT BY NAME from the Title List menu using the Navigation (▲, ▼) buttons ①, then press the ENTER button ②; the playlist will sort in alphabetical order.

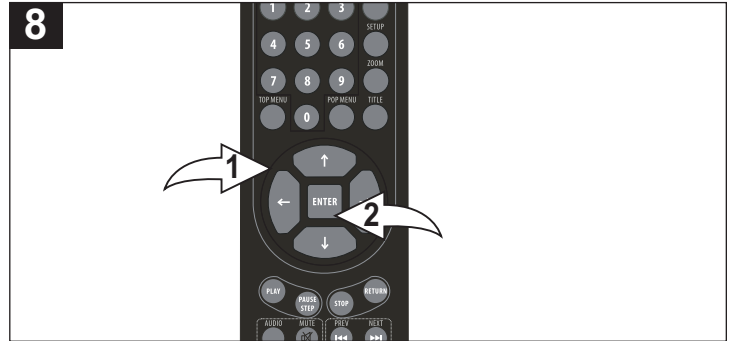

8 **INFO:** Select INFO from the Title List menu using the Navigation (▲, ▼) buttons ①, then press the ENTER button ②; the information of the selected file will appear.

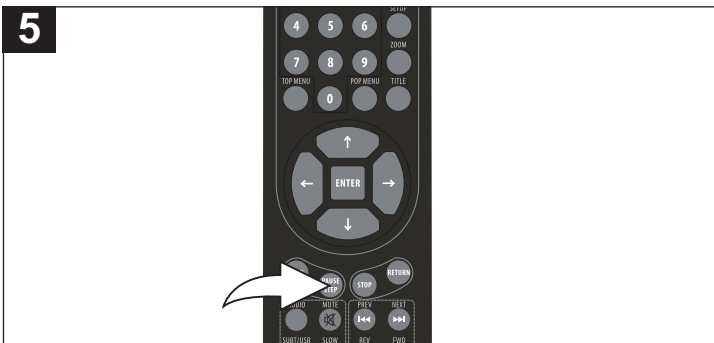

5 Press the PAUSE/STEP button to pause playback. Press again to resume playback.

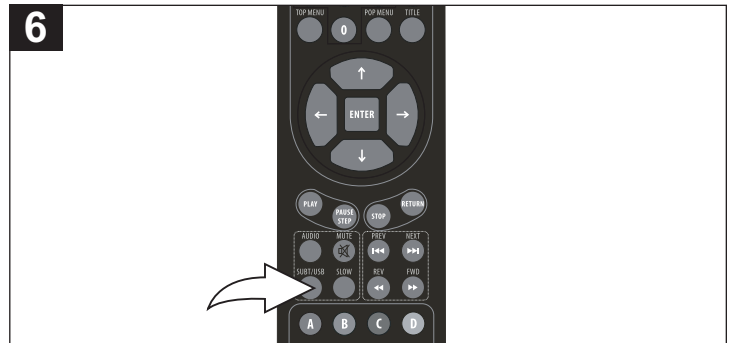

6 Press the STOP button to stop playback.

NOTES:

- Press the RETURN button to return to the Title List screen.
- The Skip, Search, Pause, Repeat and Zoom will operate as described previously, depending on the type of files played.

TROUBLESHOOTING GUIDE

Check the following before requesting service:

SYMPTOM	POSSIBLE CAUSE	POSSIBLE SOLUTION
GENERAL		
No power.	AC cord unplugged.	Plug in the AC cord to an AC outlet.
Power on, but unit not functioning properly.	Condensation has formed.	Unplug the unit and wait about one to two hours to allow the player to dry.
	Wrong type of disc inserted.	This unit cannot play discs, other than those listed on page 15.
	Unit needs to be reset.	Press the POWER/STANDBY button, then unplug the power cord. Wait one minute and then plug the unit back in.
	The disc is dirty or inserted incorrectly.	Clean disc and insert label side-up.
	Some features and functions are not available on all discs.	This is normal; try another function.
No picture.	The equipment is not connected properly.	Connect the equipment according to the instructions in this manual.
	The INPUT of the TV is not set to receive the disc signal output.	Select the appropriate video input mode, usually VIDEO or AV.
	The video cables are not securely connected.	Connect the video cables securely.
	The connected TV power is off.	Turn the TV on.
No sound.	The equipment is not connected properly.	Connect the equipment according to the instructions in this manual.
	The equipment connected with the audio cable is not set to receive the disc signal input.	Select the appropriate audio input mode.
	The audio cables are not securely connected.	Connect the audio cables securely.
	The connected receiver's power is off.	Turn the audio receiver on.
Playback picture rolls.	Unit needs to be reset to NTSC.	Turn unit off and then back on to auto set it.
The playback picture is poor.	The disc is dirty.	Clean the disc.
The Search feature is not working.	Some discs have sections that do not allow searching.	This is normal on some discs.
The picture is not fitting properly.	Wrong menu option is selected in the Setup menu.	Select the correct TV type (PS, LB, WIDE) which matches the TV you are using.
The remote control is not working.	The batteries are weak or dead.	Install fresh batteries.
	The batteries are not installed properly.	Install batteries according to the diagram.
	The remote is not aimed at the sensor.	Aim the remote at the sensor.
	Distance is too far or there is too much light in the room.	Operate within 20 ft, or reduce the light in the room.
	There is an obstacle in the path of the beam.	Move the obstacle.
The Preferences menu cannot be accessed (it is dimmed) in the Setup menu.	There is a disc in the disc tray.	Remove the disc from the disc tray, as there cannot be any disc inserted when setting the preferences.

TROUBLESHOOTING GUIDE (CONTINUED)

SYMPTOM	POSSIBLE CAUSE	POSSIBLE SOLUTION
DISCS		
The unit does not start playback.	Disc not inserted, or inserted upside-down.	Insert Disc correctly.
	A non-playback disc is inserted.	Make sure to insert a playable disc as shown on page 15.
	The disc is not placed in the guide.	Place the disc on the disc tray correctly inside the guide.
	The disc is dirty.	Clean the disc.
Some functions do not operate as stated.	Some features and functions are not available on all discs.	This is normal; try another function.
Selected language is not being shown in the subtitles, or spoken.	If the audio or subtitle language does not appear on the disc, then the initial setting will not be seen/heard.	This is normal; try another disc.
Subtitles are not working properly.	Subtitles appear only when the discs contain them.	This is normal; try another disc.
	Subtitles not turned on.	Turn the subtitles on.
Angle cannot be changed.	Angles may not be recorded on the disc (see disc jacket/case), or they may only be recorded on certain scenes.	Try another disc, or wait for a scene which allows a different camera angle.

**FOR ADDITIONAL SET-UP OR OPERATING ASSISTANCE, PLEASE VISIT OUR WEBSITE AT:
WWW.MEMOREXELECTRONICS.COM**

FOR CONSUMER REPLACEABLE PART(S), SEE PART NUMBER(S) ON PAGE 7, AND THEN CONTACT FOX INTERNATIONAL AT: 1-800-321-6993.

CARE AND MAINTENANCE

Caring for Discs

- Treat the disc carefully. Handle the disc only by its edges. Never allow your fingers to come in contact with the shiny, unprinted side of the disc.

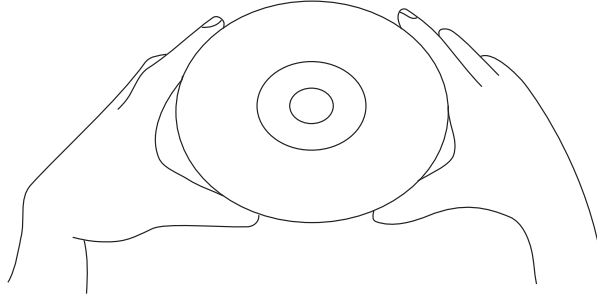

- Do not attach adhesive tape, stickers, etc. to the disc label.
- Clean the disc periodically with a soft, lint-free, dry cloth. Never use detergents or abrasive cleaners to clean the disc. If necessary, use a CD cleaning kit.
- If a disc skips or gets stuck on a section of the disc, it is probably dirty or damaged (scratched).
- When cleaning the disc, wipe in straight lines from the center of the disc to the outer edge of the disc. Never wipe in circular motions.

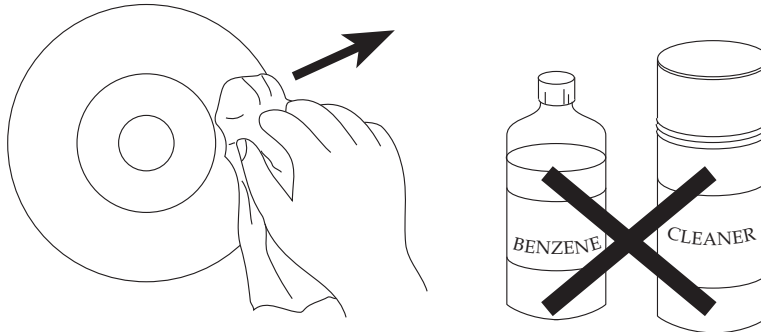

- Discs should be stored in their cases after each use to avoid damage.
- Do not expose discs to direct sunlight, high humidity, high temperatures or dust, etc. Prolonged exposure or extreme temperatures can warp the disc.
- Do not stick or write anything on either side of the disc. Sharp writing instruments, or the ink, may damage the surface.

Cleaning the Unit

- To prevent fire or shock hazard, disconnect your unit from the AC power source when cleaning.
- The finish on your unit may be cleaned with a dust cloth and cared for as other furniture. Use caution when cleaning and wiping the plastic parts.
- Mild soap and a damp cloth may be used on the front panel.

SPECIFICATIONS

Power Requirements.....AC120V, 60Hz
Power Consumption.....<25W (approx. 1W when set to Standby mode)
Weight.....9.24 Lbs
Dimensions16.9 (W) x 13.6 (D) x 2.9 (H) inches
Weight and dimensions are approximate.
Operating Temperature5°C to 35°C
Operating Humidity Range.....10% to 75% (no condensation)

Format

Disc Support.....BD (405nm), DVD (650nm), CD (780nm)

Video Output

Composite.....(75Ω Load) 1 channel: 1.0 Vp-p
Blu-ray 480i
DVD: 480i
Component (75Ω Load) Y: 1.0Vp-p, Pr: 0.70Vp-p, Pb: 0.70Vp-p
Blu-ray 1080i, 720p, 480p, 480i
DVD: 480i, 480p
S-Video (75Ω Load) Luminance Signal 1.0Vp-p
(75Ω Load) Chrominance Signal 0.3Vp-p
Blu-ray 480i
DVD: 480i

Audio/Video Output

HDMI1080p, 1080p24, 1080i, 720p, 480p, 480i
PCM Multichannel Audio, Bitstream Audio, PCM Audio

Audio Output

2 Channel.....L, R
5.1 ChannelFL, FR, C, SW, SL, SR
Digital Audio Output.....Optical/Coaxial
Frequency Response48kHz Sampling: 4Hz to 22kHz / 96kHz Sampling 4Hz to 22kHz
S/N Ratio95dB
Dynamic Range.....85dB
Total Harmonic Distortion0.01%

Specifications are subject to change without notice.

Free Manuals Download Website

<http://myh66.com>

<http://usermanuals.us>

<http://www.somanuals.com>

<http://www.4manuals.cc>

<http://www.manual-lib.com>

<http://www.404manual.com>

<http://www.luxmanual.com>

<http://aubethermostatmanual.com>

Golf course search by state

<http://golfingnear.com>

Email search by domain

<http://emailbydomain.com>

Auto manuals search

<http://auto.somanuals.com>

TV manuals search

<http://tv.somanuals.com>