



INSTALLATION INSTRUCTIONS FOR PART 95-7868B

APPLICATIONS ACURA CL 2001-2003 TL 1999-2003

95-7868B

KIT FEATURES

- Double DIN Radio Provision
- Stacked ISO Mount Units Provision



KIT COMPONENTS

- A) Double DIN Radio Housing
- B) Double DIN Brackets
- C) Double DIN Trim Plate
- D) (2) Phillips Screws

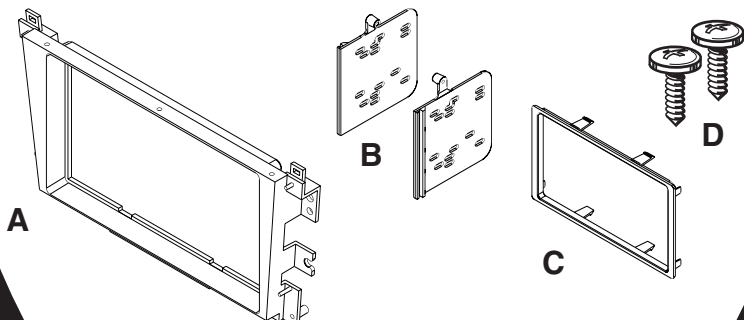

TOOLS REQUIRED:

- Phillips Screwdriver
- Socket Set



1-800-221-0932



www.metraonline.com

© COPYRIGHT 2009 METRA ELECTRONICS CORPORATION



95-7868B

TABLE OF CONTENTS

Dash Disassembly

- ACURA CL 2001-2003/TL 1999-2003..... 1,2

Kit Assembly

- Double DIN Radio Provision/ Stacked ISO Mount Units Provision 3

Final Assembly 4

***Note:**

Refer also to the instructions included with the aftermarket radio.



KNOWLEDGE IS POWER

Enhance your installation and fabrication skills by enrolling in the most recognized and respected mobile electronics school in our industry.

Log onto www.installerinstitute.com or call 800-354-6782 for more information and take steps toward a better tomorrow.

ACURA CL 2001-2003 / TL 1999-2003

- 1 Disconnect the negative battery terminal to prevent an accidental short circuit.
- 2 Unclip and remove wood trim from both sides of center console. (Figure A)
- 3 Open armrest and remove (2) Phillips screws inside and (2) Phillips at front edge of rear of console and pull rearward. (Figure B)
- 4 Open fuse access and remove (1) Phillips screw then unclip and remove panel below steering column. (Figure C)
- 5 Remove (3) Phillips screws per center console side panel and unclip and remove panels (driver's side and passenger side). (Figure D)

Continued on page 2.

A

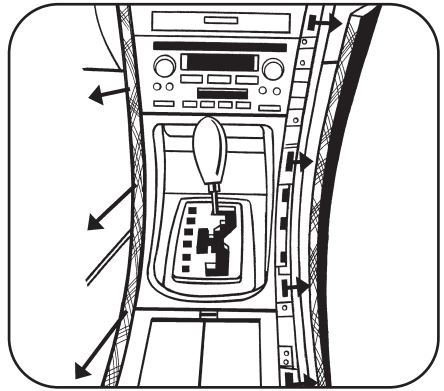

B

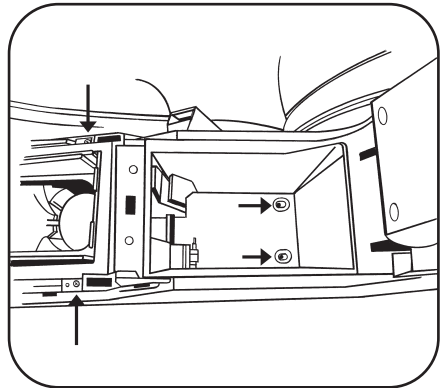

C

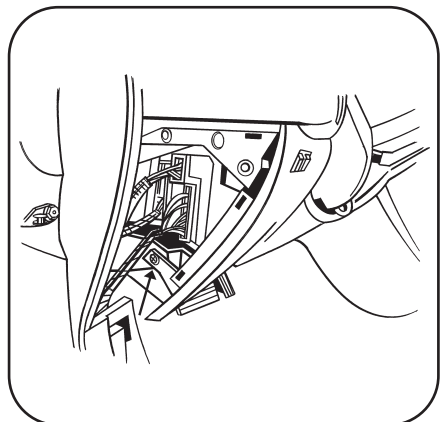

D

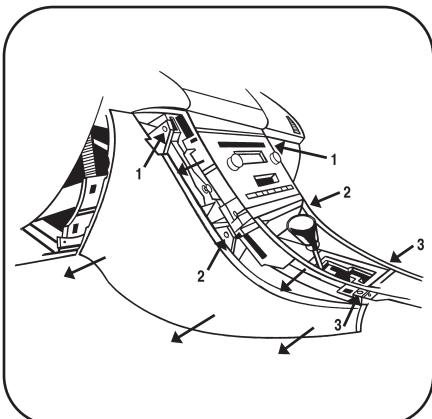

ACURA CL 2001-2003 / TL 1999-2003

- 6 Unclip and remove seat heater switch trim panel to access (2) Phillips screws and remove screws. (Figure E)
- 7 Unclip bottom of A/C control trim panel and pull away (no need to completely remove). (Figure F)
- 8 Remove (3) Phillips screws and (1) push pin per side of radio to remove radio. (Figure G)
- 9 Remove (2) Phillips screws from storage pocket assembly above radio to separate. (The storage pocket assembly will have to be attached to the radio housing in the kit assembly next)

Continue to kit assembly.

E

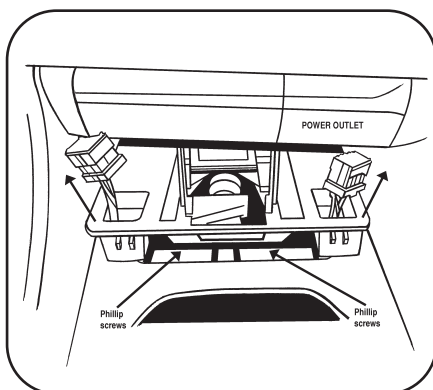

F

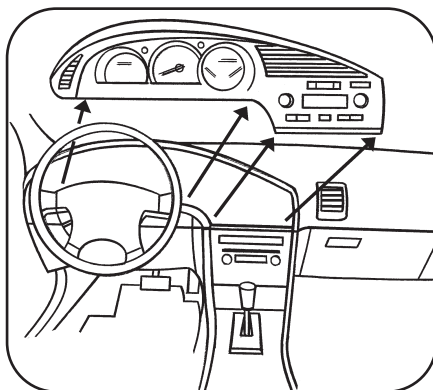

G

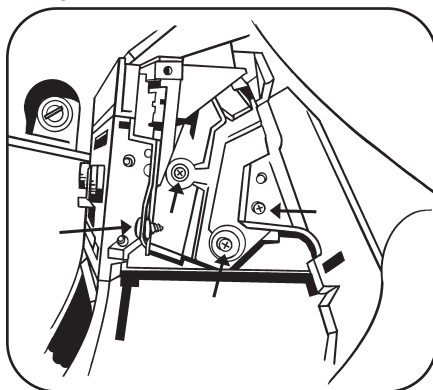

DOUBLE DIN RADIO PROVISION/ STACKED ISO MOUNT RADIO PROVISION

**Note: Refer also to the instructions included with the aftermarket radio.*

- 1 Snap the Double DIN brackets to the inside edge of the Double DIN radio housing. (Figure A)
- 2 Slide the Double DIN head unit or stacked ISO head units into the bracket/radio housing assembly and secure the Double DIN head unit or stacked ISO head units to the assembly using the screws supplied with the radio. (Figure B)
- 3 Align holes in top of radio housing with the guide pins on the bottom of the storage pocket assembly and secure the pocket assembly to the legs with the (2) screws provided. (Figure C)
- 4 Attach the double DIN trimplate to the double DIN radio housing/bracket assembly. (Figure C)

Continue to final assembly.

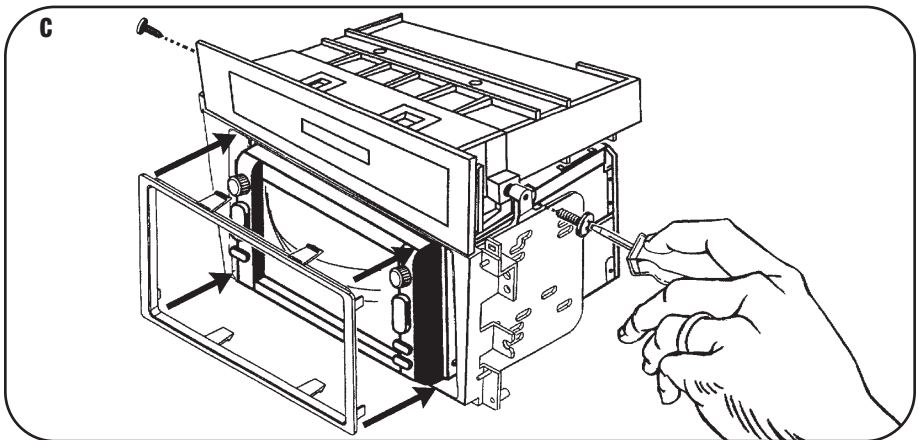
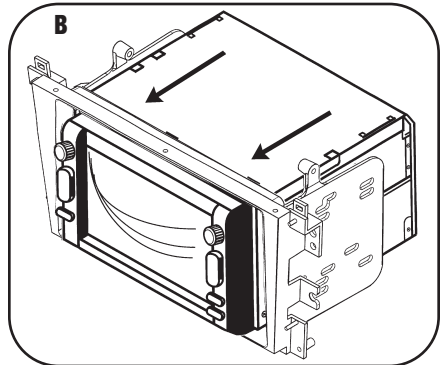
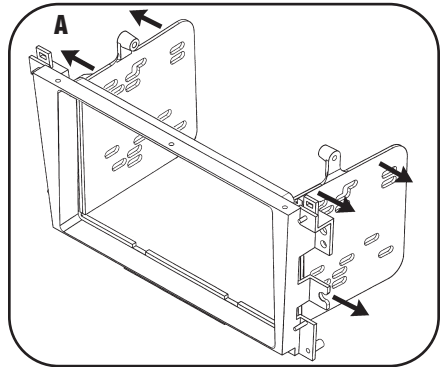

FINAL ASSEMBLY

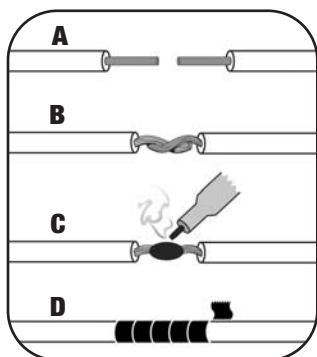

(A) Strip wire ends back 1/2"

B) Twist ends together

C) Solder

D) Tape

- 1** Locate the factory wiring harness in the dash. Metra recommends using the proper mating adapter and making connections as shown. (Isolate and individually tape off the ends of any unused wires to prevent electrical short circuit.)
- 2** Re-connect the negative battery terminal and test the unit for proper operation.
- 3** Reassemble radio and dash assemblies in reverse order of disassembly.

FINAL WIRING CONNECTIONS

Make wiring connections using the EIA color code chart shown below and the instructions included with the head unit. Metra recommends making connections as shown below; Strip, Splice, Solder, Tape. Isolate and individually tape off ends of any unused wires to prevent electrical short circuit.

METRA / EIA WIRING CODE

12V Ignition / Acc. Red

12V Batt / Memory. Yellow

Ground. Black*

Power Antenna. Blue

Amp Turn-On Blue / White

Amp Ground. Black / White

Illumination Orange

Dimmer Orange / White

Right Front (+) Gray

Right Front (-). Gray/ Black

Left Front (+) White

Left Front (-). White / Black

Right Rear (+) Violet

Right Rear (-). Violet / Black

Left Rear (+) Green

Left Rear (-). Green / Black

***NOTE:** When a Black wire is not present, ground radio to vehicle chassis.

All colors may not be present on all leads due to manufacturer's specifications.

[illegible]

95-7868B INSTRUCTIONS



1-800-221-0932



www.metraonline.com

REV. 03/02/09 © COPYRIGHT 2009 METRA ELECTRONICS CORPORATION INST95-7868B

Free Manuals Download Website

<http://myh66.com>

<http://usermanuals.us>

<http://www.somanuals.com>

<http://www.4manuals.cc>

<http://www.manual-lib.com>

<http://www.404manual.com>

<http://www.luxmanual.com>

<http://aubethermostatmanual.com>

Golf course search by state

<http://golfingnear.com>

Email search by domain

<http://emailbydomain.com>

Auto manuals search

<http://auto.somanuals.com>

TV manuals search

<http://tv.somanuals.com>