

**GEARS!
GEARS!
GEARS!**

Old McGear's Farm™

Building Set

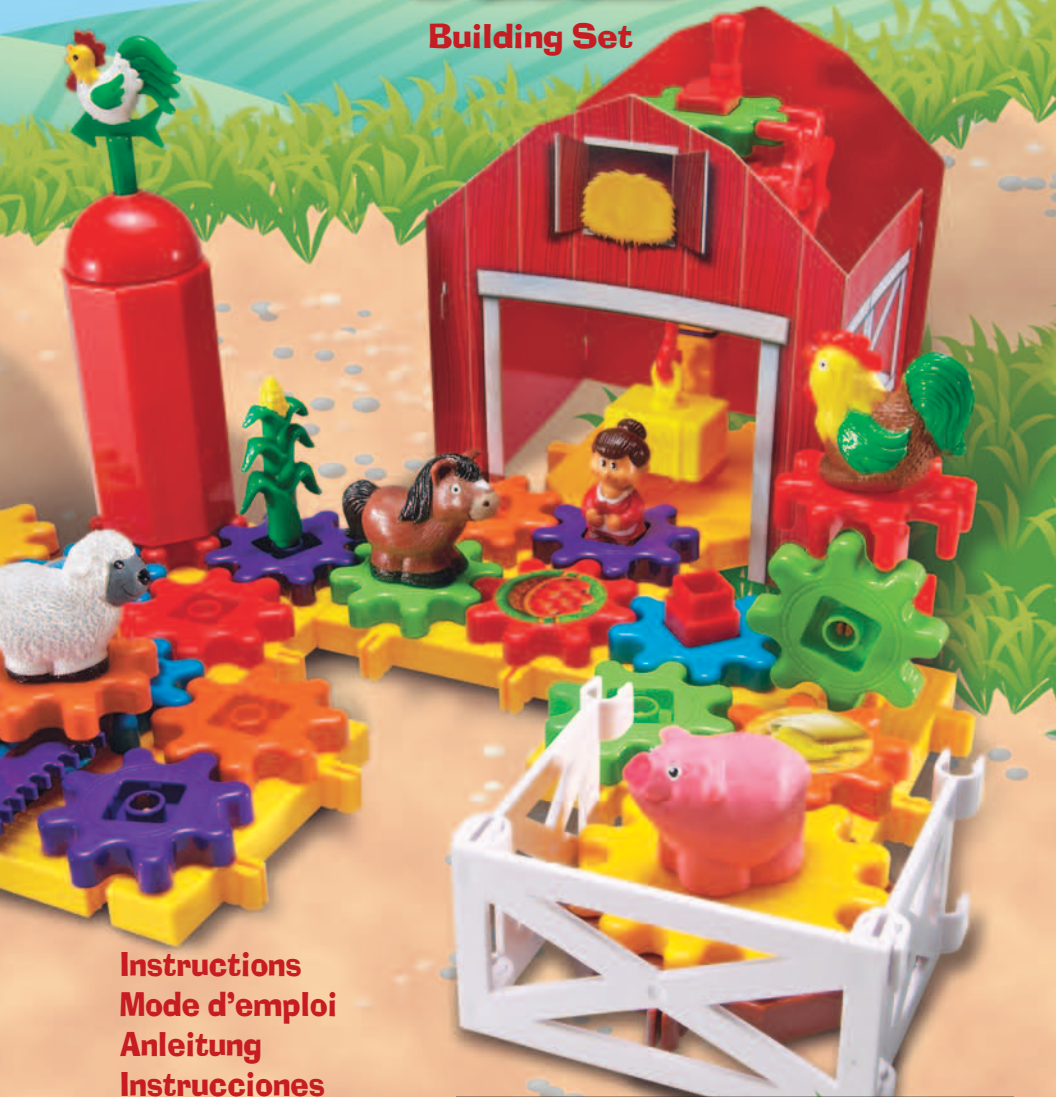

**Instructions
Mode d'emploi
Anleitung
Instrucciones**

**LR LEARNING
RESOURCES®**

⚠ WARNING:
CHOKING HAZARD - Small parts.
Not for children under 3 years.

N SUFF C T N. Petites
pièces. Pas pour les enfants en dessous de 3 ans.
ST CKUN S F . Kleine Teile.
Nicht geeignet für Kinder unter 3 Jahren.
PELIGRO DE AHOGO. Partes pequeñas.
No recomendado para niños menores de 3 años.

Building Instructions:

Welcome to the Gears Fun Friendly Farm! Build your own whirling and twirling farm complete with your own heard of animals. Join the farmer's for a fun day on the farm!

To begin, learn some basic building tips by following the color-coded instructions. Attach the crank to the center of a Gear and turn it to set the farm in motion. While you are building, turn the Gears every so often to make sure everything is working. The building possibilities are endless, so let your imagination go!

Instrucciones de construcción:

¡Bienvenido a la divertida y simpática granja Gears! Construye tu propia granja giratoria con tu propio rebaño de animales. ¡Convértete en granjero para pasar un día divertido en la granja!

Antes de empezar, lee las siguientes instrucciones codificadas por colores para aprender algunos consejos de construcción básicos. Encaja la manivela en el centro de una pieza Gear y hazla girar para poner la granja en movimiento. Verifica el funcionamiento de tu granja mientras la estás construyendo haciendo girar de vez en cuando las piezas Gears. Las posibilidades de construcción son infinitas, por lo que, ¡deja volar tu imaginación!

Instructions de construction :

Bienvenue à la ferme Gears, accueillante et amusante ! Construis ta propre ferme pivotante et tourbillonnante avec ton propre troupeau d'animaux. Rejoins le fermier pour passer une journée amusante à la ferme !

Pour commencer, apprends quelques petits trucs utiles et fondamentaux pour la construction en suivant les instructions codifiées par couleurs. Fixe la manivelle sur le centre d'un engrenage et tourne la pour mettre la ferme en marche. En cours de construction, tourne les engrenages de temps à autre pour vérifier que tout fonctionne bien. Les possibilités de construction sont infinies, alors donne libre cours à ton imagination !

Bauanleitung:

Willkommen auf dem Gears Fun Friendly Bauernhof! Baue deinen eigenen aktiven und lebendigen Bauernhof mit deiner eigenen Tierherde. Begleite den Bauern und erlebe einen tollen Tag auf dem Bauernhof!

Zunächst solltest du dich jedoch mit einigen grundlegenden Tipps vertraut machen, indem du die farblich gekennzeichneten Anweisungen beachtest. Verbinde die Kurbel mit dem Mittelpunkt des Zahnrads und bringe den Bauernhof durch Drehen in Bewegung. Während des Bauens solltest du die Zahnräder so oft wie möglich drehen, um sicherzustellen, dass alles funktioniert. Die Gestaltungsmöglichkeiten sind endlos - also lass deiner Phantasie freien Lauf!



Orange Gear (4)



Green Gear (3)



Blue Gear (4)



Red Gear (3)



Purple Gear (3)

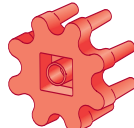

Red Crown Gear (2)

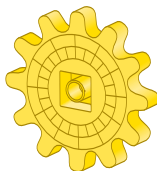

Medium Gear (2)

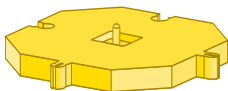

Large Octagonal Base (1)



Medium Octagonal Base (2)

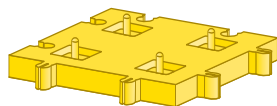

Square Base (4)

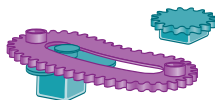

Toothed Gear (1) & Loop Gear (1)



Large Pillar (4)



Small Pillar (11)



Peg Adapter (3)



Pillar Connector (3)



T-Pillar (2)



Haystack (1)

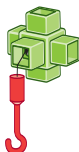

Pulley with Hook (2)



Crank (2)



Large Wheel with Tread (2)



Small Wheel with Tread (2)



Chair (1)



6-Way Axle (3)



Farmer (1)



Farmer's Wife (1)



Sheep (1)



Cow (1)



Pig (1)



Horse (1)



Dog (1)



Rooster (1)

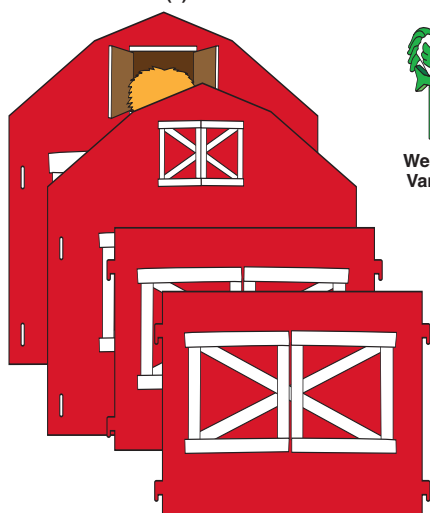

Barn (4)



Weather Vane (1)



Corn Stalk (1)

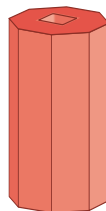

Silo (1)



Silo Top (1)

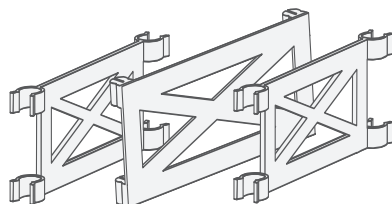

Fence (3)

1 Sheet of Stickers. See front of box for placement.

Old McGear's Farm

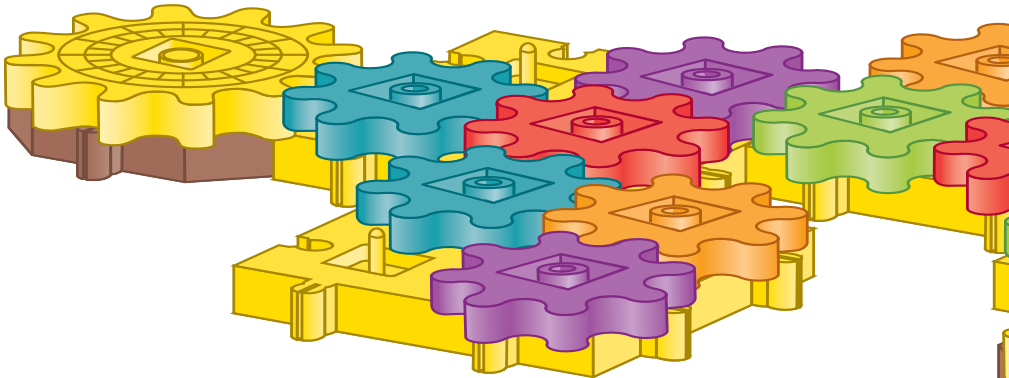

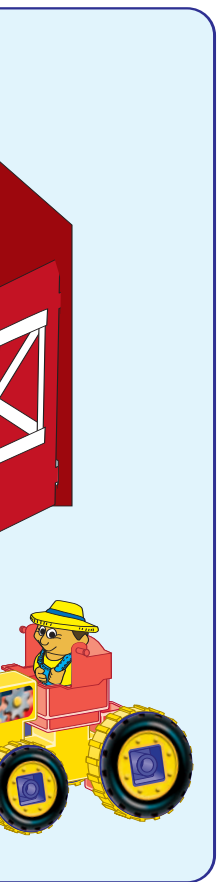

STEP 1

Assemble the base pieces as shown.

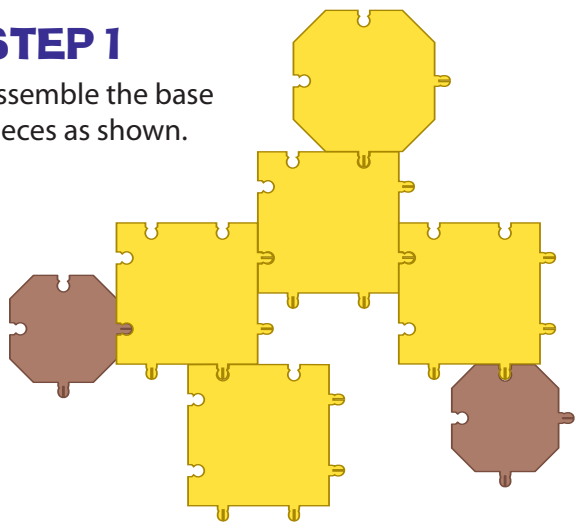

STEP 2

Add the gears.

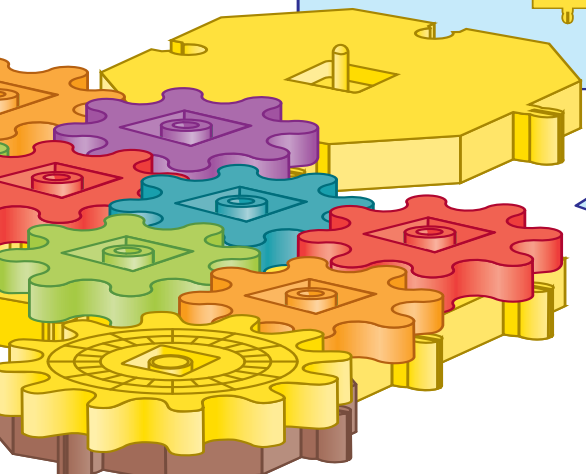
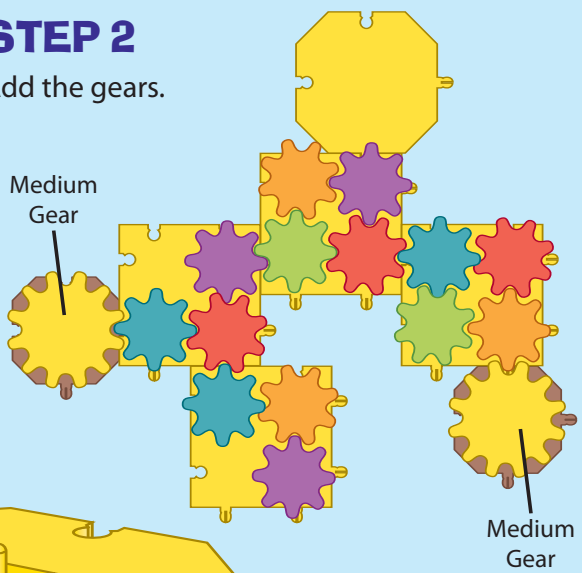

STEP 3

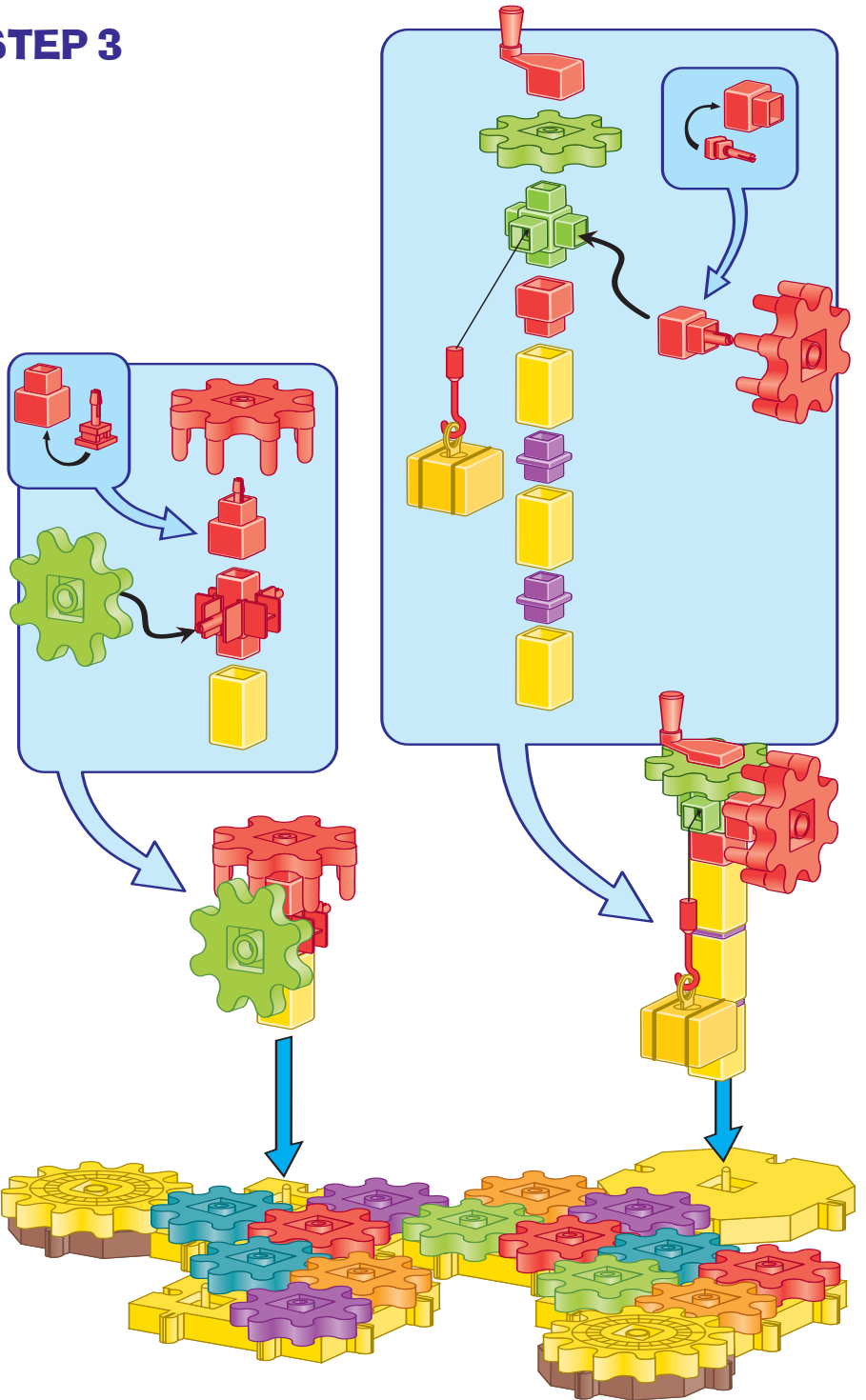

STEP 4

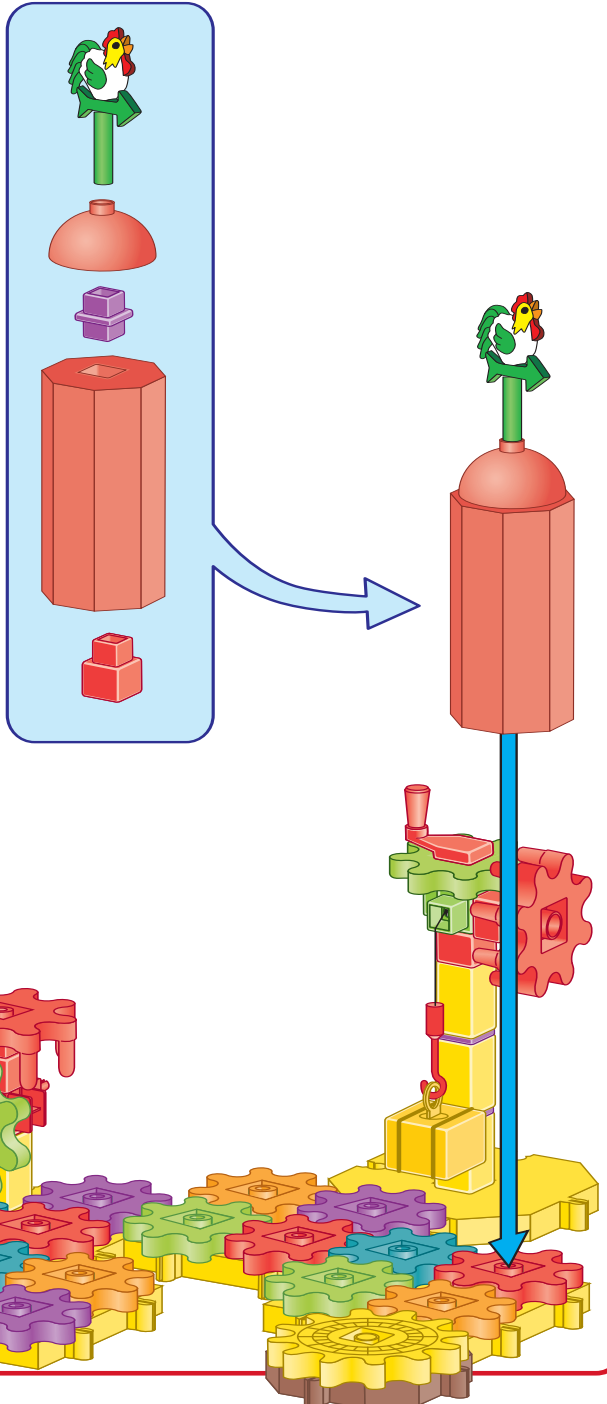

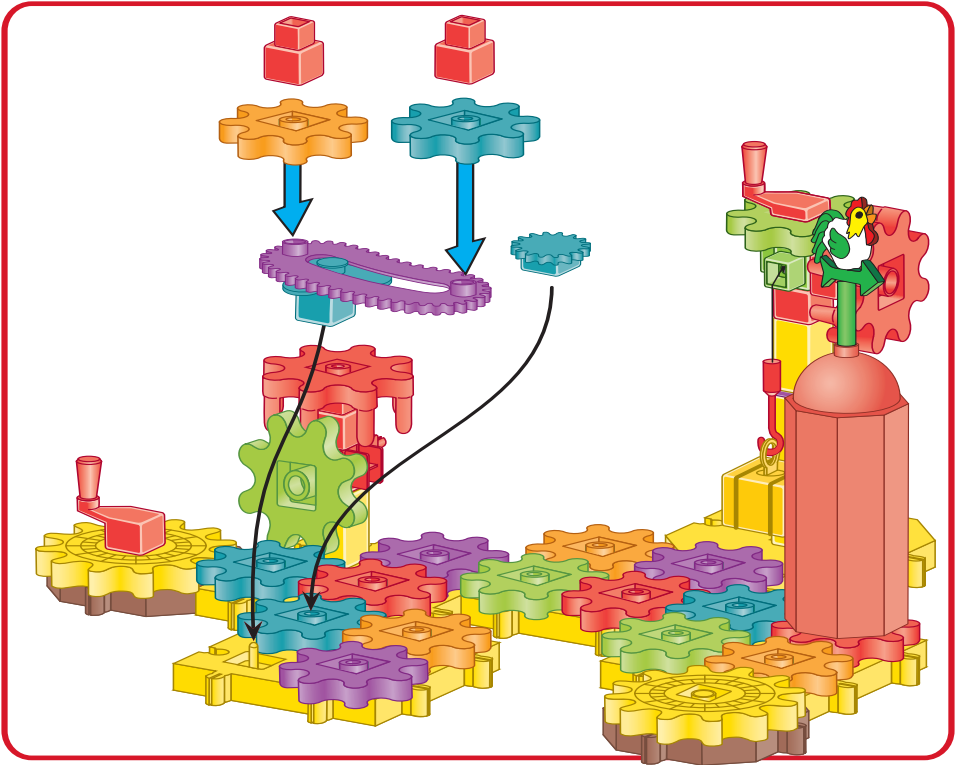

STEP 6

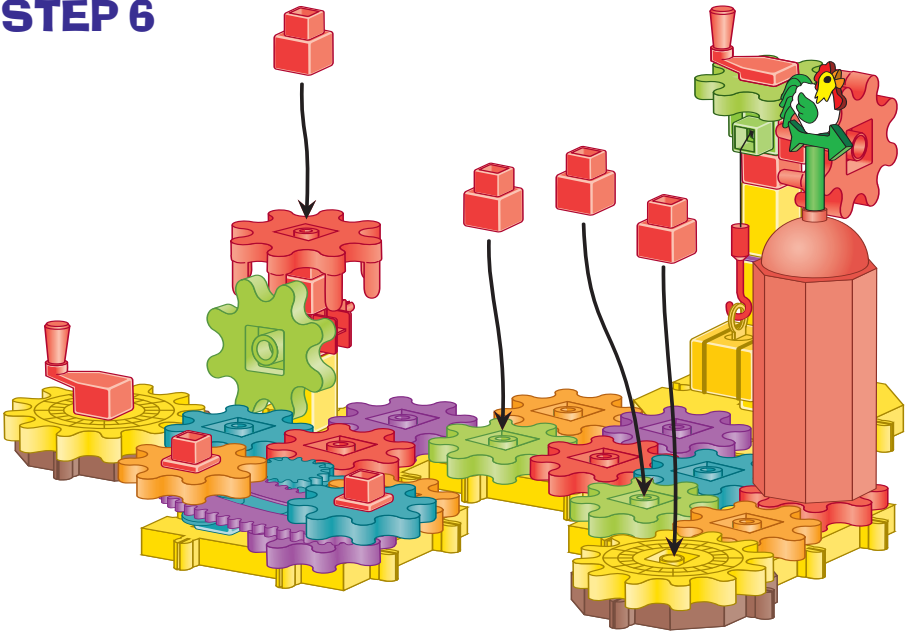

STEP 7

Add the farm animals.

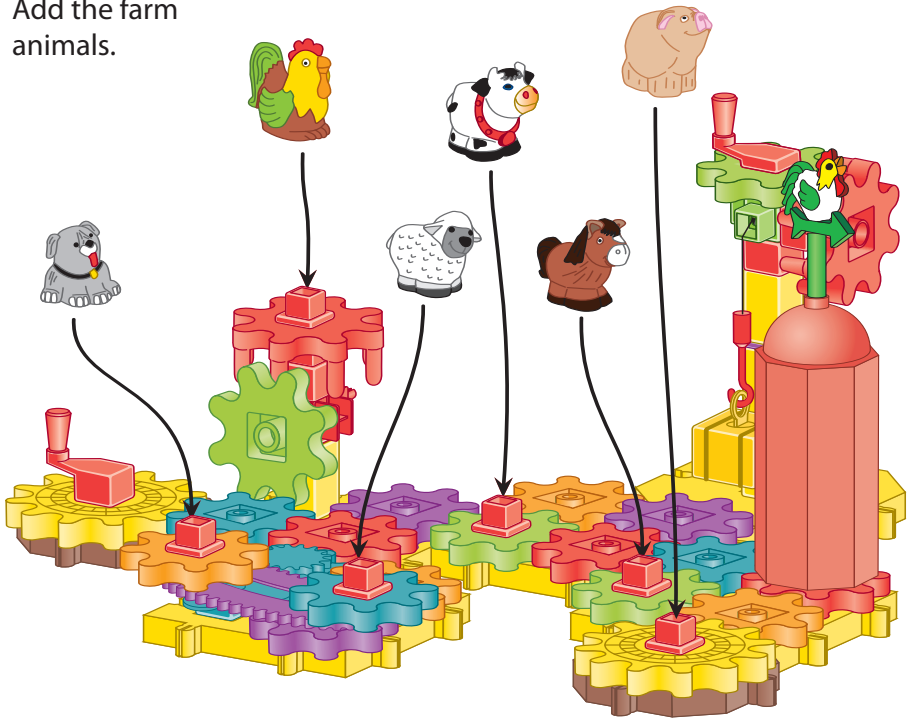

STEP 8



STEP 9

Build the barn.

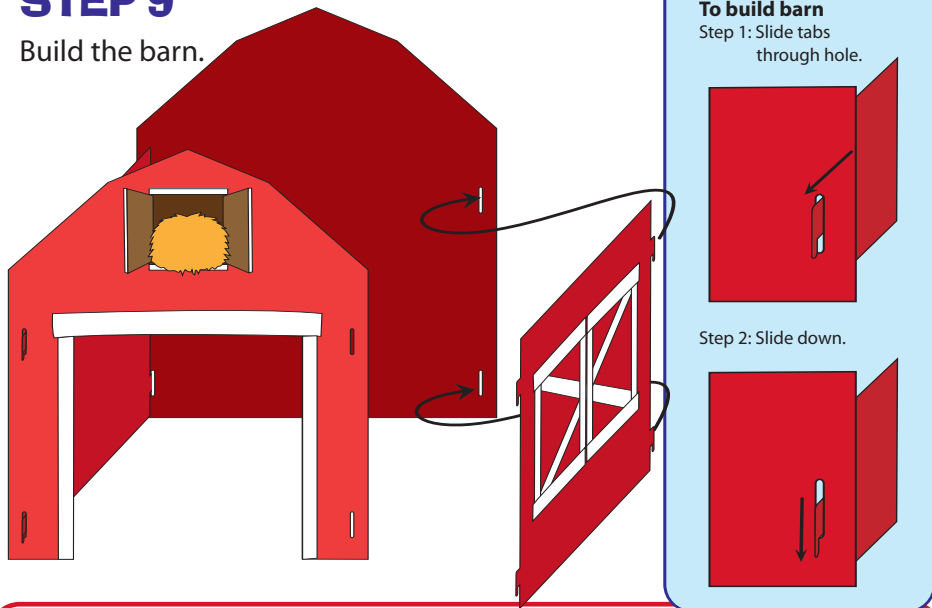

STEP 10

Build the tracker.

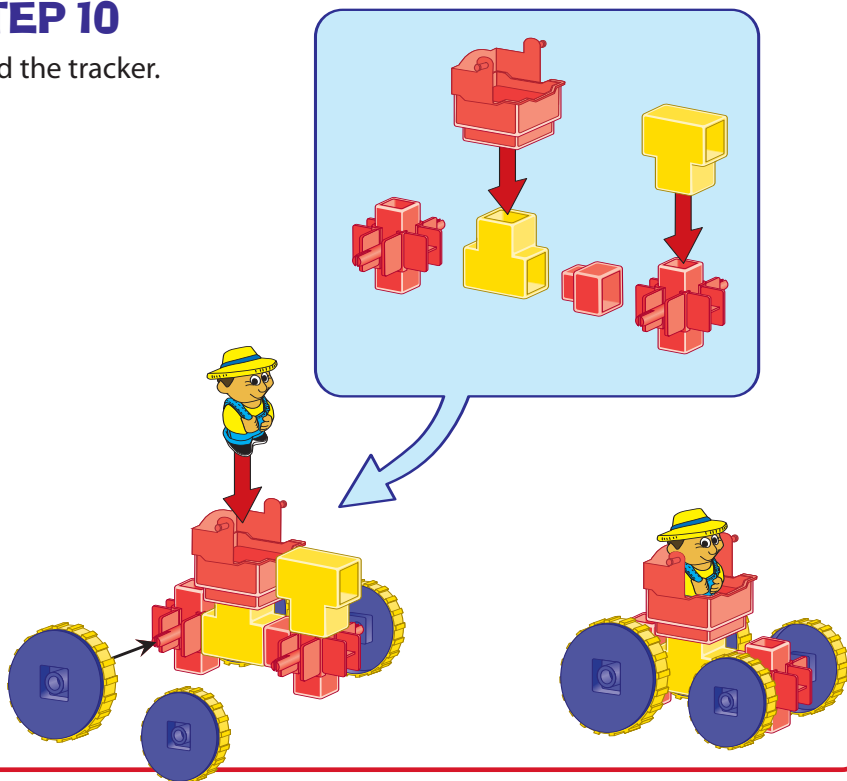

STEP 11

Build the Fence.

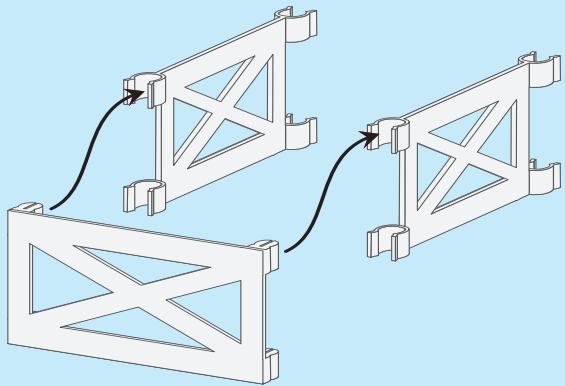

FINISHED!



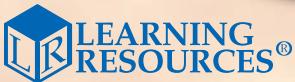

For a dealer near you, call:
(847) 573-8400 (U.S. & Int'l)
(800) 222-3909 (U.S. & Canada)
+44 (0)1553 762276 (U.K. & Europe)



© Learning Resources, Inc., Vernon Hills, IL (U.S.A.)
Learning Resources Ltd., King's Lynn, Norfolk (U.K.)
Please retain our address for future reference.
Made in Korea. LPK9211-TG

www.LearningResources.com

Free Manuals Download Website

<http://myh66.com>

<http://usermanuals.us>

<http://www.somanuals.com>

<http://www.4manuals.cc>

<http://www.manual-lib.com>

<http://www.404manual.com>

<http://www.luxmanual.com>

<http://aubethermostatmanual.com>

Golf course search by state

<http://golfingnear.com>

Email search by domain

<http://emailbydomain.com>

Auto manuals search

<http://auto.somanuals.com>

TV manuals search

<http://tv.somanuals.com>