

---

# **PagePro™ 1350W Warranty Exchange Guide**

---

**1760669-001A**

## **Trademarks**

KONICA MINOLTA and the KONICA MINOLTA logo are trademarks or registered trademarks of KONICA MINOLTA HOLDINGS, INC.

PagePro is a trademark or registered trademark of KONICA MINOLTA BUSINESS TECHNOLOGIES, INC. All other trademarks are the property of their respective owners.

## **Copyright Notice**

Copyright © 2005 KONICA MINOLTA PRINTING SOLUTIONS U.S.A., INC., One Magnum Pass, Mobile, AL 36618, USA. All Rights Reserved. This document may not be copied, in whole or part, nor transferred to any other media or language, without written permission of KONICA MINOLTA BUSINESS TECHNOLOGIES, INC.

## **Manual Notice**

KONICA MINOLTA BUSINESS TECHNOLOGIES, INC. reserves the right to make changes to this manual and to the equipment described herein without notice. Considerable effort has been made to ensure that this manual is free of inaccuracies and omissions. However, KONICA MINOLTA BUSINESS TECHNOLOGIES, INC. makes no warranty of any kind including, but not limited to, any implied warranties of merchantability and fitness for a particular purpose with regard to this manual. KONICA MINOLTA BUSINESS TECHNOLOGIES, INC. assumes no responsibility for, or liability for, errors contained in this manual or for incidental, special, or consequential damages arising out of the furnishing of this manual, or the use of this manual in operating the equipment, or in connection with the performance of the equipment when so operated.

# Introduction

Thank you for contacting a technical support representative to obtain information about returning your printer for warranty exchange. Follow these instructions very carefully.

If you need additional assistance, refer to the *General Information Guide* (included with the original printer) or [printer.konicaminolta.com](http://printer.konicaminolta.com) for worldwide sources of service and support.

## Attention

---

**Failure to follow these instructions could result in voiding your warranty.**

---

## Exchange Procedure

Each of these steps is explained in detail in this guide.

<b>1</b>	Unpack the exchange printer.	See page 2.
<b>2</b>	Prepare the original printer—turn it off, unplug the power cord, and remove the interface cables and media.	See page 3.
<b>3</b>	Move the imaging cartridge from the original printer to the exchange printer.	See page 4.
<b>4</b>	Finish setting up the exchange printer—fill the tray with media, plug it in, attach the interface cables, and turn it on.	See page 6.
<b>5</b>	Repack the original printer, and call the shipper for pickup.	See page 8.

# Unpack the Exchange Printer

## Attention

Use caution when unpacking the exchange printer, so the packaging (including the tape) can be used to repack the printer to be returned.

Exchange

1 Unpack the exchange printer.

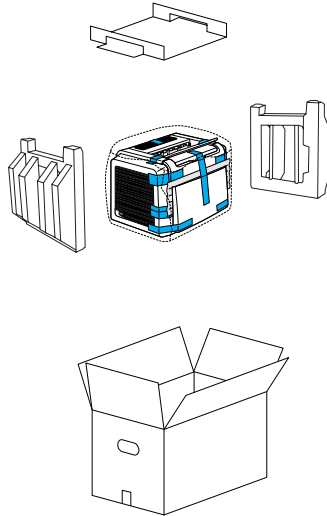

Exchange

2 Remove the tape from the outside of the exchange printer.

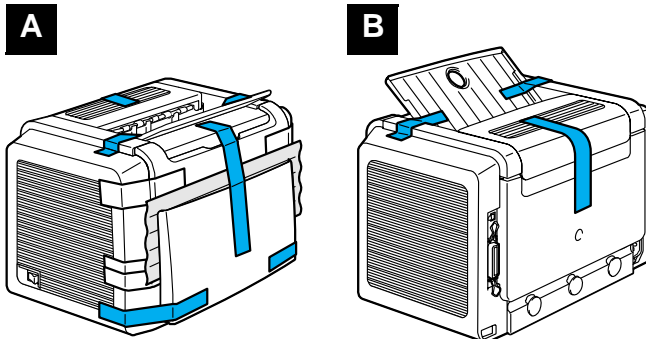

- 3 Open the media tray on the exchange printer and remove the remaining tape and packing materials.

A

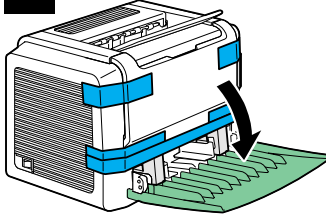

B

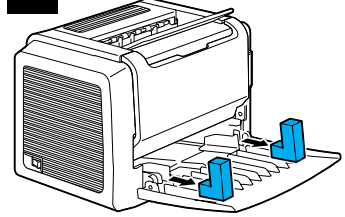

## Prepare the Original Printer

- 1 Turn off the original printer, unplug the power cord, and remove the interface cable(s).

A

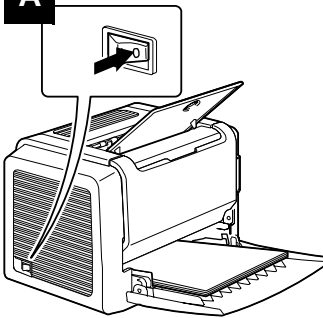

B

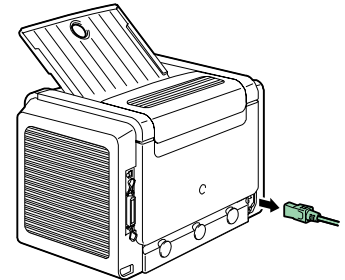

C

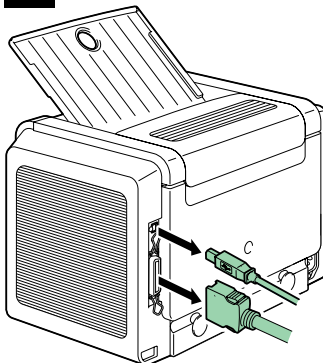

- 2 Remove the media from the original printer's tray and then slide in the output tray.

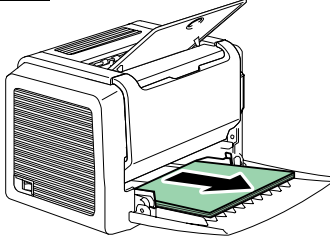
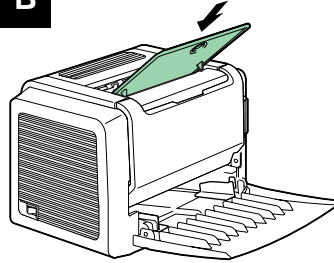
**A****B**

## Move the Imaging Cartridge

- 1 Remove the imaging cartridge (which includes both the toner cartridge and the drum cartridge) from the original printer.

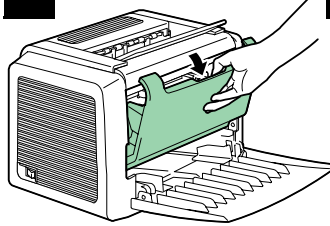
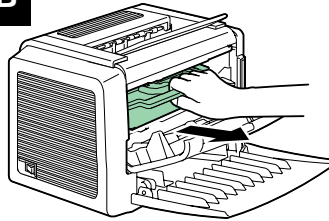
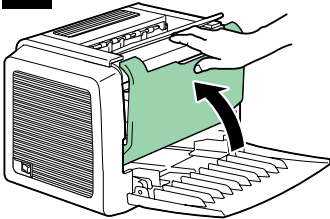
**A****B****C**

2 Insert the imaging cartridge in the exchange printer.

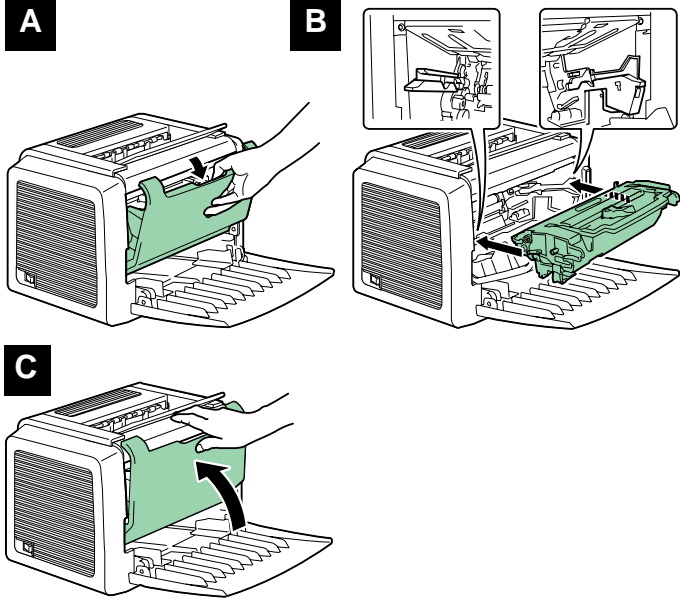

# Finish Setting Up the Exchange Printer

Exchange

1 Fill the media tray with paper and then pull out the output tray.

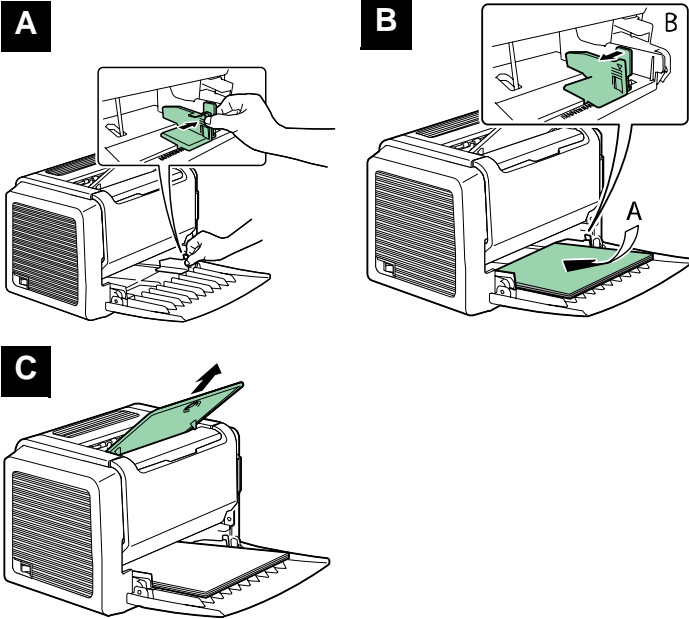



2 Plug in the power cord, connect the interface cable(s), and then turn on the printer.

**A**

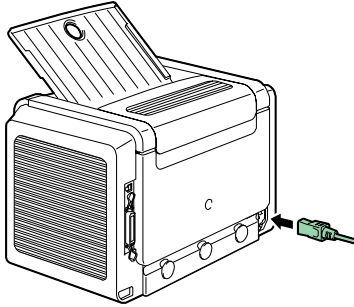

**B**

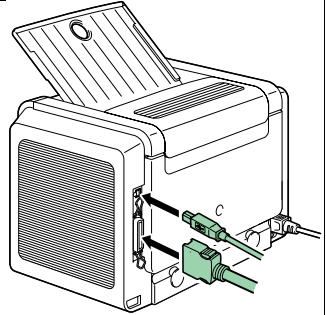

**C**

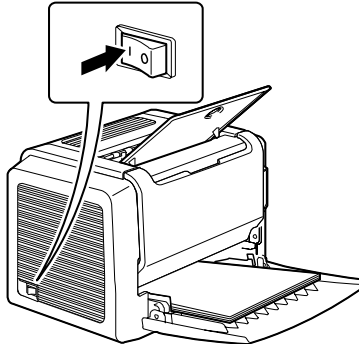

# Repack the Original Printer

Original

- 1 Insert the packing materials inside the original printer.



*After inserting the packing materials, slide the media guides against them to hold them in place.*

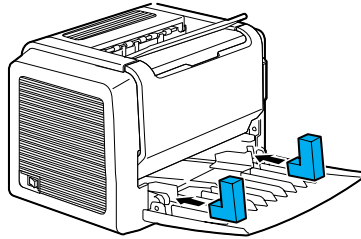

Original

- 2 Replace the packing tape on the front of the original printer, and then close the media tray.

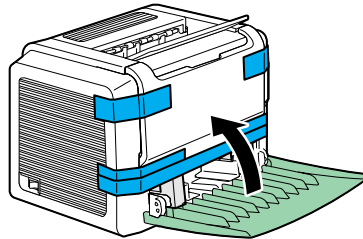

Original

- 3 Replace the packing tape on the outside of the original printer.

**A**

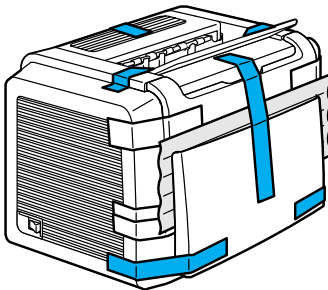

**B**

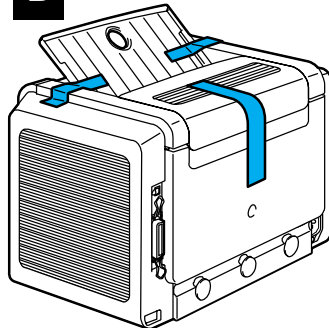

- 4 Repack the original printer in the carton in which the exchange printer was shipped.

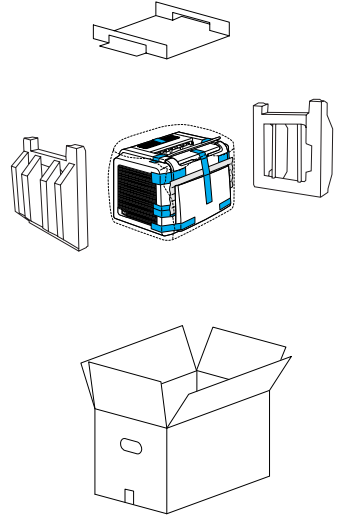

- 5 Securely tape the top flaps of the shipping carton closed.

- 6 In the Americas, clearly write the RMA (Return Merchandise Authorization) number you received from your customer support representative on the outside of the carton before calling the shipper for pickup.



*If the RMA number is not prominently visible on the outside of the return carton, we will not accept receipt.*

- 7 Ship the printer, using the shipper and shipping label provided with the exchange printer.



## Free Manuals Download Website

<http://myh66.com>

<http://usermanuals.us>

<http://www.somanuals.com>

<http://www.4manuals.cc>

<http://www.manual-lib.com>

<http://www.404manual.com>

<http://www.luxmanual.com>

<http://aubethermostatmanual.com>

Golf course search by state

<http://golfingnear.com>

Email search by domain

<http://emailbydomain.com>

Auto manuals search

<http://auto.somanuals.com>

TV manuals search

<http://tv.somanuals.com>