

## Unpack

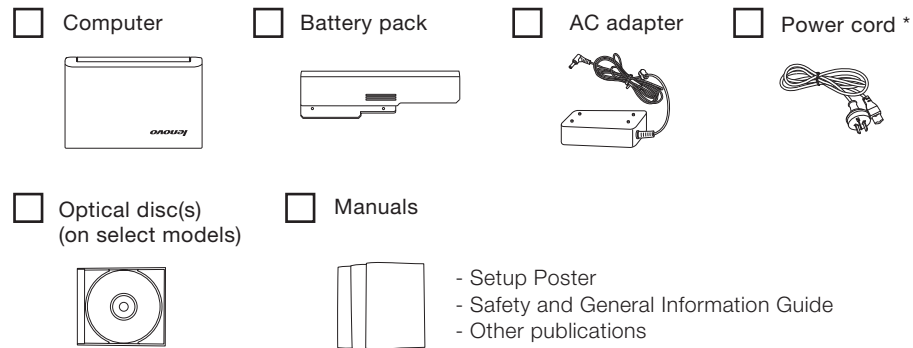

\* Power cord varies by country/region.

- ① Some models may contain items that are not listed.  
② If any item is missing or damaged, please contact your retailer.

## Finding information

To find detailed information about your computer, refer to the following documentation:

**User Guide** - User Guide provides operating instructions and troubleshooting information for your computer. User Guide is preloaded electronically as a PDF file on your computer and can be accessed by clicking the User Guide icon on the desktop.

**Safety and General Information Guide** - The Safety and General Information Guide provides safety precautions, use & care information for your computer.

**Flyers** - The flyers that came with your computer provide warranty, certification, and specification information for your computer.

The above documentation is also available online at <http://consumersupport.lenovo.com/>.

Lenovo, the Lenovo logo, and OneKey are trademarks of Lenovo in the United States, other countries, or both.  
Other company, product, or service names may be trademarks or service marks of others.

© Copyright Lenovo 2011.



P/N:148500480  
Printed in China

**lenovo**

# Lenovo B460e

Setup Poster v1.0



Read the safety notices and important tips in the included manuals before using your computer.

## Initial setup instructions

### 1 Install the battery pack

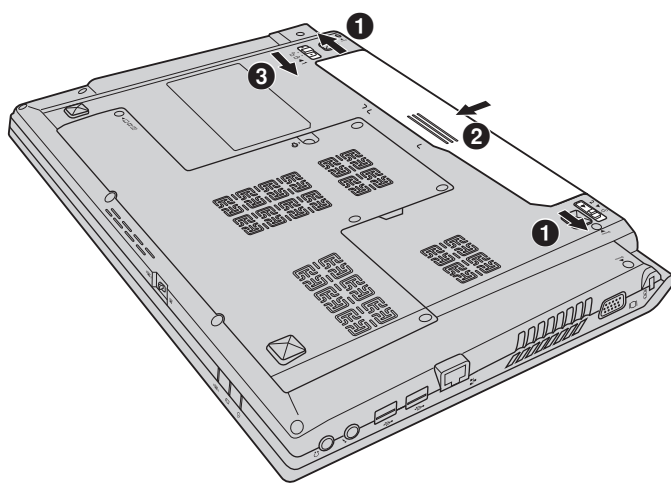

### 2 Connect to the power

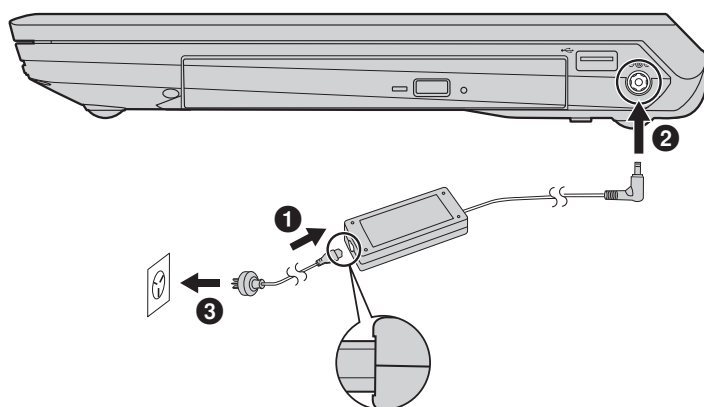

ⓘ **Attention:**  
Connect the power cord to the AC adapter firmly, poor connections may result in damages to the AC adapter.

### 3 Press the power button

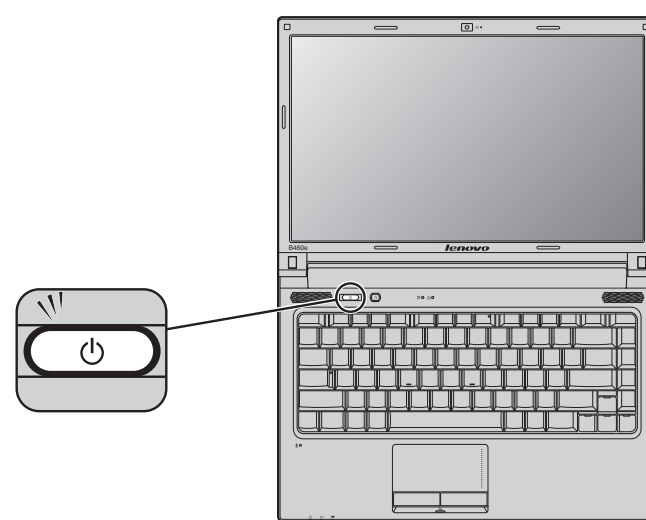

### 4 Configure the operating system following the on-screen instructions

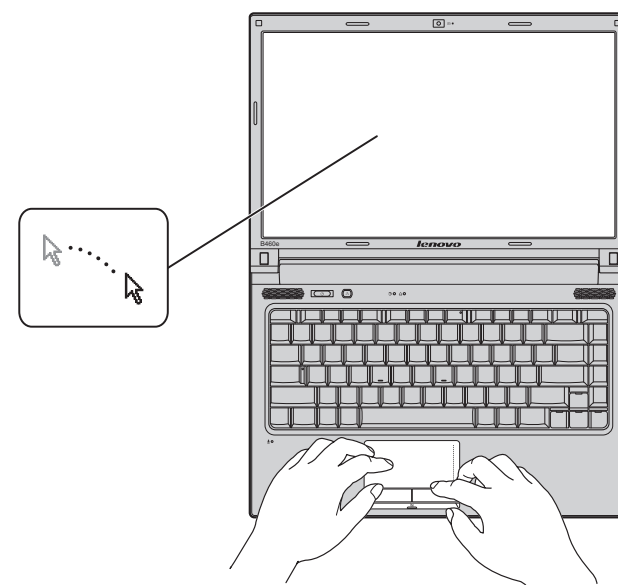

## Buttons and functions

- 1 Integrated camera**
- 2 Speakers**
- 3 Power button**
- 4 OneKey Rescue system button**  
When the computer is powered off, press this button to start OneKey Rescue system.
- 5 Wireless radio switch**  
Slide this switch to turn on/off the wireless radio of all wireless devices on the computer.

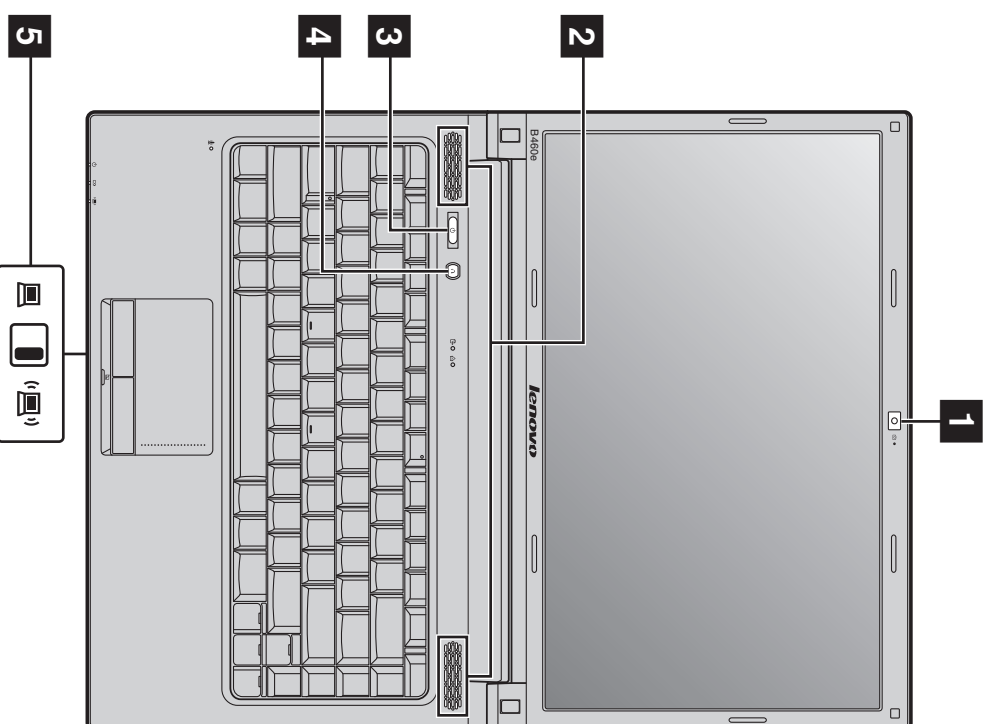

## External devices connection

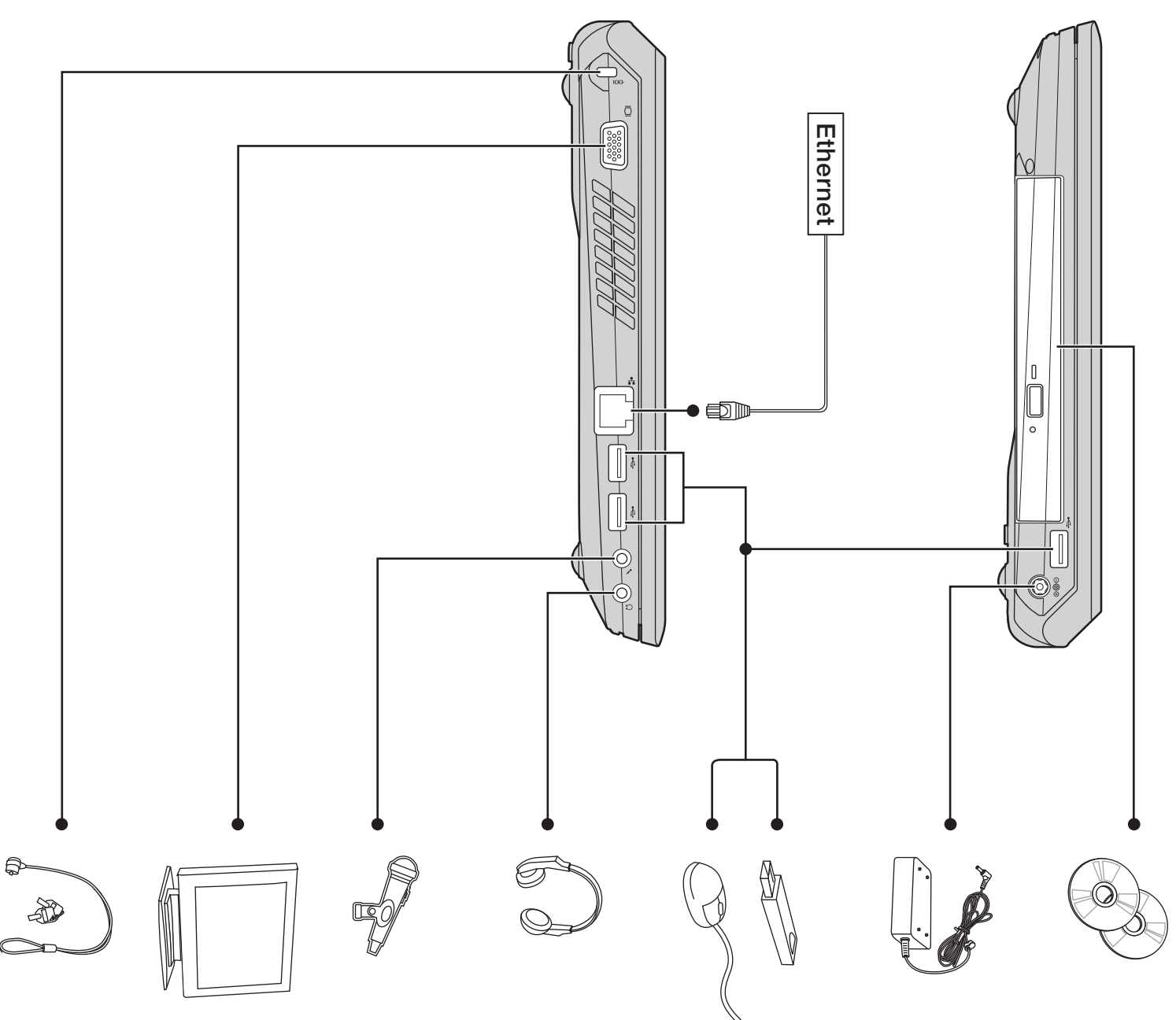

**Notes:**  
The illustration is for reference only. You are responsible for evaluating the quality and compatibility when purchasing external devices. Function of all external devices is not guaranteed. Follow the instructions shipped with the devices when connecting them to your computer.

CE

## Free Manuals Download Website

<http://myh66.com>

<http://usermanuals.us>

<http://www.somanuals.com>

<http://www.4manuals.cc>

<http://www.manual-lib.com>

<http://www.404manual.com>

<http://www.luxmanual.com>

<http://aubethermostatmanual.com>

Golf course search by state

<http://golfingnear.com>

Email search by domain

<http://emailbydomain.com>

Auto manuals search

<http://auto.somanuals.com>

TV manuals search

<http://tv.somanuals.com>