

Lenox Sound[®]

**10 SECOND ANTI-SKIP (ANTI-SHOCK)
PROGRAMMABLE COMPACT DISC PLAYER
WITH CAR ADAPTOR KIT
MODEL CD-78
OPERATING INSTRUCTIONS**

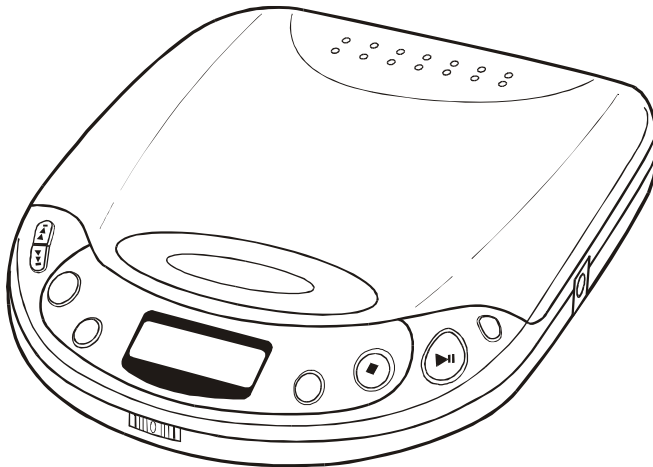

- **PLAYS ALL MUSIC COMPACT DISCS**
- **BASS BOOST SWITCH**
- **6 DIGIT LCD VISUAL DISPLAY**
- **TRACK REPEAT & DISC REPEAT**
- **10 SECOND ANTI-SKIP MEMORY**
- **AC ADAPTOR INCLUDED**
- **DELUXE STEREO HEADPHONES INCLUDED**
- **CAR POWER CORD AND CASSETTE ADAPTOR INCLUDED**
- **USES 2 SIZE "AA" BATTERIES (NOT INCLUDED)**
- **LINE OUT JACK - CONNECTS TO YOUR STEREO SYSTEM
(PATCH CORD NOT INCLUDED)**

PLEASE READ CAREFULLY BEFORE USE

INTRODUCTION

Your new Lenoxx Sound model CD-78 portable compact disc player, uses the latest technology to give you crisp clean sound from all your compact discs.

Please read these operating instructions completely to take advantage of all the features of this set.

ACCESSORIES INCLUDED

AC ADAPTOR

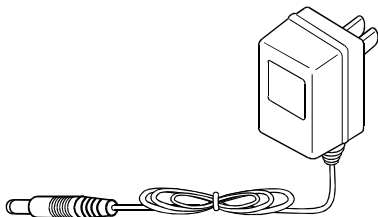

STEREO HEADPHONES



CAR CASSETTE ADAPTOR

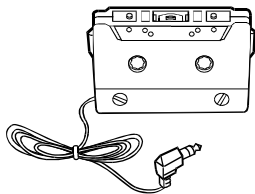

CAR CIGARETTE LIGHTER ADAPTOR

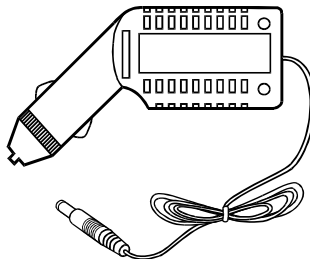

NOTE: Adaptor may look slightly different from above illustration.

POWER SOURCES

Your CD player requires 2 size “AA” alkaline batteries (not included), or use the AC Adaptor (included), or in a car you may use the Car Cigarette Lighter Adaptor.

BATTERY OPERATION

1. Apply slight downward thumb pressure on Battery Door (marked “OPEN”), and gently slide it in an outward direction to open the door.
2. Insert 2 size “AA” fresh alkaline batteries according to + and - polarity markings inside the battery compartment. For longer operating life, heavy duty alkaline batteries are recommended (also see TIPS ON BATTERY USE as listed below).
3. Close the Battery Door, make sure it is snapped into place.

NOTE: If you will not use your set for one week or more, remove the batteries and unplug the AC Adaptor from the wall outlet.

TIPS ON BATTERY USE

- Reversing polarities will damage the batteries and possibly your set. Be sure to follow + and - markings as indicated.
- Do not mix different types together (Alkaline, Carbon-Zinc, Nickel-Cadmium etc.), or old batteries with new ones.
- When not in use for an extended period of time, or while internal batteries will not be used, remove them to prevent possible acid leakage or corrosion resulting in damage to your player.
- Bear in mind that battery life expectancy is based upon volume and bass listening levels and if anti-skip circuitry is used. Using the anti-skip feature consumes more power. Maximum battery power consumption happens at maximum settings. Typical life for 2 size “AA” alkaline batteries is about 8 hours of continuous use. If the set fails to switch tracks, or if it shuts off, your batteries are weak. Replace both batteries, or use the AC Adaptor (or Car Adaptor).
- When the batteries have become discharged, they must be disposed of in a safe manner that complies with all applicable laws.
- Installation of batteries should only be done by an adult (for safety).

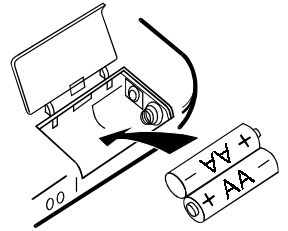

BATTERY REPLACEMENT

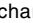
If the alkaline batteries are weak and discharged, this symbol “” shows in the display, then the power automatically turns off. If this occurs, replace the alkaline batteries (also if display does not show anything, the batteries are dead).

- This set can be used without batteries as long as the AC Adaptor (or Car Adaptor) is used.

TECHNICAL NOTE: Because of the special integrated circuits and servomotor in this set, this set will not work with weak batteries, it will automatically shut off if the batteries get too weak for proper operation.

BATTERY RECOVERY

When batteries get weak and cause the set to stop, if you wait about 30 minutes, the batteries will regain a small amount of capacity and play for a few more minutes. This does not mean the set is defective. Replace the weak batteries or use the AC Adaptor (or Car Adaptor).

AC ADAPTOR OPERATION

Your player may be powered from any household 120V AC outlet, using the AC adaptor included. Insert the adaptor's small connector plug into the DC 4.5V Jack marked \ominus \rightarrow \oplus on player (on the right side of the set), and plug the adaptor into an AC outlet.

NOTE: If the AC Adaptor is connected when regular batteries are installed, the player automatically switches to the AC Adaptor power and the batteries are not used.

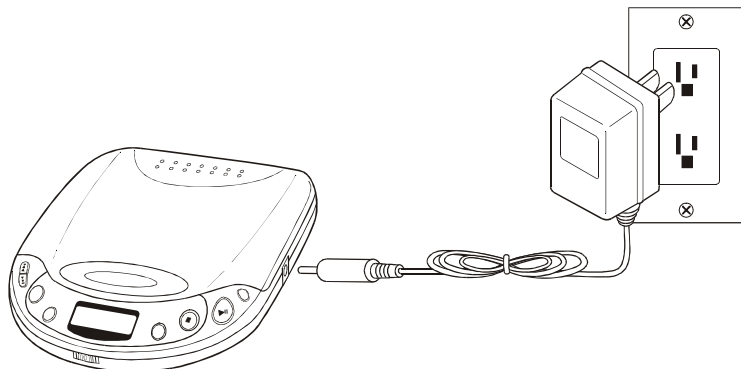

CAUTION:

To prevent electric shock, do not use this AC Adaptor with an extension cord or outlet, unless it can be fully inserted without exposing any part of the blades. Do not use any other adaptor to power this set or you may damage your set.

LOCATION OF CONTROLS

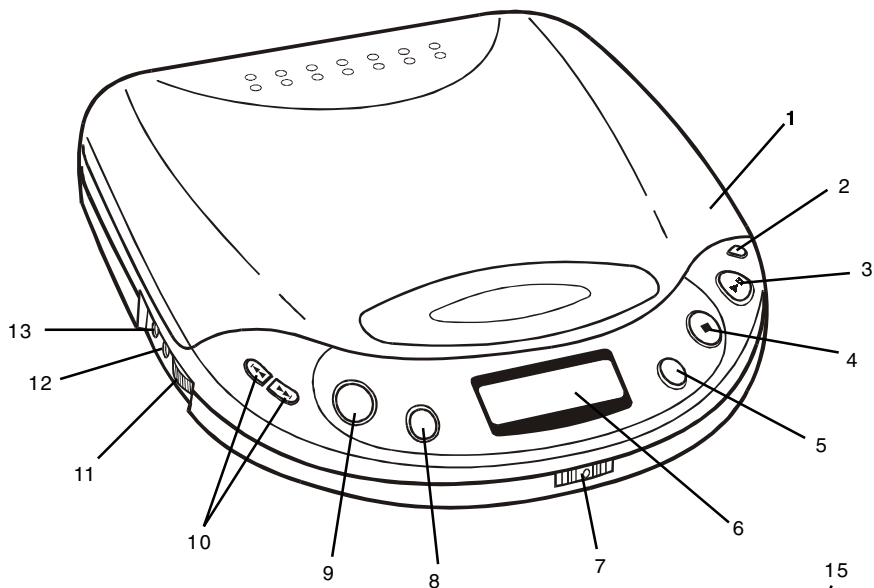

1. CD DOOR
2. CD DOOR OPEN BUTTON
3. PLAY/PAUSE BUTTON AND POWER ON
4. STOP BUTTON AND POWER OFF
5. PROGRAM BUTTON
6. LCD VISUAL DISPLAY
7. BASS BOOST SWITCH
8. REPEAT/RANDOM BUTTON
9. ANTI-SKIP (ANTI-SHOCK) BUTTON
10. SEARCH BUTTONS (◀▶ & ▶▶)
11. VOLUME CONTROL
12. LINE OUT JACK (for home stereo connection)
13. PHONES JACK (headphone jack)

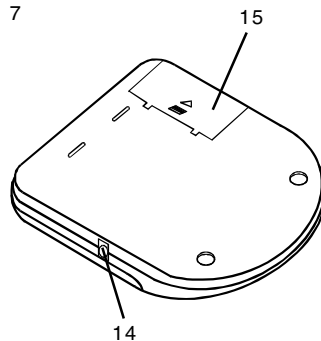

CONNECTIONS

LISTENING WITH HEADPHONES

Connect the plug of the stereo headphones into the Phones Jack (on the left side of the set).

DO NOT PLUG THE HEADPHONES INTO THE LINE OUT JACK!

CAUTION:

Hearing experts advise against exposure to continuous extended play at loud volume levels while using headphones, possible hearing loss may result. If you experience a ringing in the ears, reduce volume or discontinue use. We want you to listen for a lifetime.

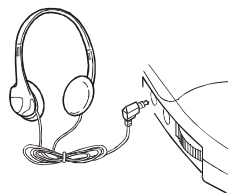

TO PHONES JACK

HANDLING COMPACT DISCS

This set is designed to play only compact discs bearing this identification logo  (logo must say DIGITAL AUDIO).

Other discs may not conform to the CD standard and may not play properly.

- Dirty, scratched or warped discs may cause skipping or noise.
- Handle the disc only by the edges. To keep clean, do not touch its surface.
- Discs should be stored in their cases after use to avoid scratches.
- Do not expose discs to direct sunlight, high humidity, high temperatures, or dust, etc. Prolonged exposure to extreme temperatures can warp the disc (such as leaving the discs in your car during summertime).
- Do not stick or write anything on either side of disc. Sharp writing instruments, or the inks used in some felt-tip pens, may damage its surface.

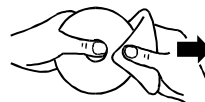

CLEANING DISCS

- Fingerprints should be carefully wiped from the surface of disc with a soft cloth. Unlike conventional records, compact discs have no grooves to collect dust and microscopic dirt, so gently wiping them with a soft cloth should remove most particles. Wipe in a straight motion from the center to the edge.
- Never use thinner, benzine, record cleaner or antistatic spray on a compact disc. Such chemicals can damage its plastic surface.

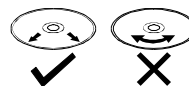

TO REMOVE THE DISC

Open the CD Door by pressing the Door Open Button, hold the disc by the edge while slightly pressing on the center spindle as illustrated, then lift it from the edge to release and remove.

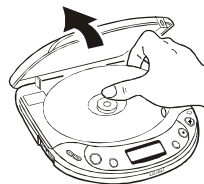

NOTE

Always press Stop Button and wait for the disc to stop rotating before pressing the Door Open Button to remove the disc.

PLAYING A DISC

1. Plug the cord from the headphones into the **Phones Jack** on the left side of set.

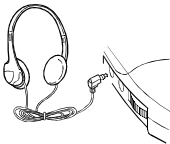

IMPORTANT: Do not plug the headphones into the Line Out Jack. If you do, the sound will be very low and the Volume Control will not work.

2. Press the Door Open Button to open the CD Door.

3. Hold the disc with the **LABEL SIDE UP** and press it onto the spindle until it "clicks" into place.



4. Close the CD Door (it will latch shut), press the Play Button (Power On), the disc will begin to spin, the display will show " - - - " flashing and then the total tracks and total playing time, then it will begin playing track number 1 (song #1) and the display will show " 01".



12 38:28

0 100:02

TOTAL NUMBER OF TRACKS TOTAL PLAYING TIME ON THE DISC

TRACK NUMBER CURRENTLY PLAYING ELAPSED PLAYING TIME OF THE CURRENT TRACK

NOTE:

1. If the Display shows " 15C ", the compact disc is upside down or missing.
2. When the symbol " " shows in the display, your batteries are weak and need replacement.

5. Adjust the Volume Control as desired.
6. Slide the Bass Boost Switch **ON** for more bass, **OFF** for less bass (BASS means low frequency sounds like a bass drum).
7. If you are using your set in a car or bumpy location, press the Anti-Skip Button (see page 8). This is not needed if your set will sit on a table or night stand.

ANTI-SKIP



8. To stop temporarily, press the Play/Pause Button.
 - The elapsed playing time **FLASHES** in the Display.



- Press the Play/Pause Button again to resume playing.

9. To stop play, press the Stop Button. Total tracks and playing time appear in the Display and after about 30 seconds the power turns off automatically. To shut the power off quickly, press the Stop Button twice.



- NOTE:**
- The power turns off automatically after all tracks on a disc have been played.
 - The power turns off immediately when the Door Open Button is pressed and the CD Door is opened.
 - The power turns off when the Stop Button is pressed twice.

POWER ON

Close the Door and press the Play Button.

POWER OFF

Press the Stop Button twice or open the Door.

NOTE: If the time display flashes, your set is in the Pause mode, press Play Button again to play the disc.

BACK AND FORWARD TRACK SEARCH (or changing songs)

Press the Search Button (◀◀ or ▶▶) during play to go to the desired track (song).

Search ◀◀ BACKWARD

Search ▶▶ FORWARD

- Press the Search (▶▶) Button to skip to the next track on the disc.
- Press the Search (◀◀) Button to rewind to the beginning of the track currently playing. Press this button twice or more to skip to previous tracks.

Press **and hold** the Search Button (◀◀ or ▶▶) during play to scan the disc at higher speed. When the desired music section of the disc is found, release the button, normal play will resume.

- If you press and hold the Search Button (▶▶) while the last track is playing, and the end of the track is reached, the player stops.



BASS BOOST SWITCH

This switch enhances the low frequency (bass) sounds at low listening levels. Switch this ON or OFF to suit your taste. During bass boost on setting, sometimes, you may hear some distortion, adjust the Volume Control to a lower level when using the bass boost feature.



AUTO POWER OFF FUNCTION

The power turns off automatically when all tracks on a disc have been played or 30 seconds after the Stop Button is pressed to stop play.

The power turns off immediately after the CD Door is opened (The display will show " - - " for 30 seconds and then shut off).

IF BUTTONS DO NOT WORK

If operating buttons do not work normally when pressed:

- 1.Remove the batteries or AC Adaptor and wait a few seconds. The circuits will reset themselves.
- 2.Replace the batteries or AC Adaptor.
- 3.If the buttons still do not work, your batteries are weak, replace them or use the AC Adaptor or Cigarette Lighter Adaptor.

REMEMBER

- If the symbol " ■ " shows in the display, your batteries are weak, replace them or use the AC Adaptor or Car Cigarette Lighter Adaptor.
- If the Display is blank - no numbers show when Play/Pause Button is pushed, the batteries are dead. Replace them, or use AC Adaptor, or Cigarette Lighter Adaptor (Also check if you inserted the batteries according to the + and - as shown on set).

DIGITAL ANTI-SKIP MEMORY FUNCTION

The digital anti-skip function uses semiconductor memory to prevent the sound from skipping or stopping when the set is shaken, shocked or vibrated during play.

PRESS ANTI-SKIP BUTTON TO TURN ANTI-SKIP ON
PRESS IT AGAIN TO TURN ANTI-SKIP OFF

When the Anti-Skip Button is pressed during play, music will stop for a few seconds, and the “□” indicator appears in the display and the digital anti-skip function turns on. The digital data equivalent to approximately 10 seconds of music is stored in “read-ahead” memory buffer before it is decoded and played.

The “□” mark changes to the “▣” mark, indicating that the data buffer is full.

- When the set is subjected to shock during play, the data stored in memory continues to be decoded and played. This gives the pickup time to stabilize and continue reading new music. As the data is read from memory, the indicator changes from “▣” to “□”.

Once the pickup returns to its original position, new data is stored in memory and the display changes back to the “▣” mark.

- If the set is subjected to repeated shocks and all the data stored in memory is used up, the “□” mark is displayed and the sound will skip or stop for a brief period until the memory basket fills up again.
- Press the Anti-Skip Button again to turn the digital anti-skip function off.
- Keep the digital anti-skip function off when using the set in a stable - no vibration area, where it will not receive shocks. The batteries will last longer when the anti-skip function is turned off.

NOTE:

When the digital anti-skip function is switched on or off, the sound will be interrupted for 1 or 2 seconds. This is normal (the blank time is used to fill the memory).

ANTI-SKIP



X 1



DISPLAY WITH EMPTY MEMORY



DISPLAY WITH FULL MEMORY



SOME MEMORY USED WHEN
SET IS SHOCKED

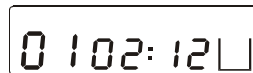

ALL MEMORY USED

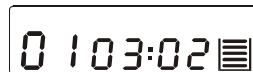

ANTI-SKIP MEMORY FULL

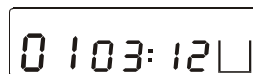

ANTI-SKIP MEMORY EMPTY

REPEAT, INTRO AND RANDOM PLAY

REPEAT PLAY - SINGLE TRACK REPEAT

Plays one song over and over till you press Stop.

During play, press the Repeat/Random Button once, the symbol **REPEAT ONE** appears in the display.

The song currently playing will repeat over and over, until you press Stop.

To resume normal play, press the Repeat/Random Button four times.

REPEAT / RANDOM



REPEAT ONE

0 100:03

REPEAT ONE --> REPEAT ALL --> INTRO --> RND (RANDOM) --> NORMAL PLAY MODE

REPEAT PLAY - ALL TRACKS REPEAT

Repeats all songs in order, till you press Stop.

During play, press the Repeat/Random Button twice, the symbol **REPEAT ALL** will show in the display.

All songs will keep playing in sequence 1, 2, 3, etc. and all songs will repeat and when finished, will start all over again until you press the Stop Button.

To resume normal play, press the Repeat/Random Button three times.

REPEAT / RANDOM



REPEAT ALL

0 100:08

INTRO PLAY

This plays the first 10 seconds of songs in sequential order.

1. During play, press the Repeat/Random Button three times, the word **INTRO** will flash in the Display.
2. Press the Search Button **◀◀** (or **▶▶**), the word **INTRO** will stop flashing and the first 10 seconds of **each** song from the currently playing song (or from the next song) on the CD will play in sequential order.
3. When you find a song you like, press the Play Button, normal play will be resumed, that song (and the following songs) will play **NORMALLY**.

REPEAT / RANDOM



SEARCH



0 100:06 **INTRO**

RANDOM PLAY

This plays the songs on the disc in a random order.

1. During play, press Repeat/Random Button four times the word **RND** will flash during play.
2. Press one of the Search Buttons, this will play all of the songs in random order selected by the CD player. The word **RND** will stop flashing.
3. Press the Search Button **▶▶**, to skip to the next random song.

To resume normal play, press the Repeat/Random Button another time.

REPEAT / RANDOM



SEARCH



0300:06 **RND**

PROGRAMMING YOUR PLAYING SEQUENCE

PROGRAMMED PLAY

- The tracks (songs) on the disc can be programmed (arranged in advance) to play in any order you prefer (up to 20 tracks can be programmed).

Programming Example:

Program Number	1	2	3	4	5	6	7	8	etc.
Track Number (song number)	3	5	8	1	2	4	1	1	etc.

- During programming, the word **PROG** flashes in the display. To program songs to play in your preferred order, follow steps below:

- Press the Program Button once during play or in stop mode.



The word **PROG** will flash in the Display.

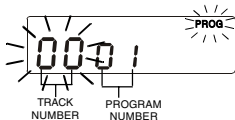

- Press the Search Button (◀◀ or ▶▶) to select track number 3 (example).

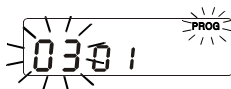

- Press the Program Button. Track 3 is now programmed.



Program # 2 will now show in the display, ready for your next selection of track.

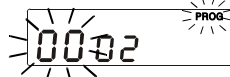

- Repeat steps 2 and 3 to program other tracks till you finish (up to 20 selections).

NOTE: Do this quickly to avoid the set shutting itself off.

- After programming is finished, press Play to begin programmed play. "PROG" stops flashing (but continues to show in the display) and music begins.



NOTE:

- The player will stop automatically after all programmed tracks have been played.
- To quit programmed play, press Stop Button once. Then you may press Play Button to restart normal play.

Your programming will be lost:

- If the CD Door is opened.
- When the alkaline batteries are exhausted or removed or the AC Adaptor is disconnected.
- When you press Stop twice.

CONNECTING TO HOME STEREO SYSTEMS

The Line Out Jack is made to accept a stereo mini plug (3.5mm). By using a commercially available audio line cable (not included), simply connect the cable's mini plug to the Line Out Jack on your player, and the other appropriate end usually RCA JACKS to the CD/AUX **INPUTS** of your home stereo.

NOTE: Always switch the power off before making any connections between the player and any other set.

NOTE: The Volume Control of your player becomes inoperable whenever Line Out Jack is used. Adjustments are made on your audio system.

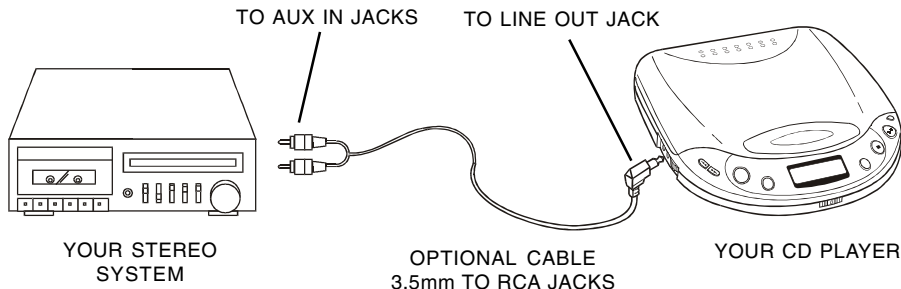

CLEANING THE CABINET

Wipe with a soft cloth. If the cabinet is very dirty, dampen (not dripping wet) the cloth with a weak solution of soapy water, and then wipe clean.

CLEANING THE LENS

A dirty lens will cause sound skipping. If the lens is very dirty, the player may not work. We suggest using a special cleaning disk (not included) available in most music and Hi-Fi stores. However, if you do not have one, you may use the instructions below.

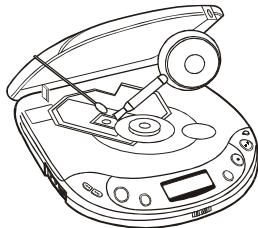

You may use a cotton swab very slightly dampened with alcohol to clean the lens (start in the middle and work you way out).

CAR ADAPTOR KIT

COMPACT DISC CASSETTE ADAPTOR

The Car Cassette Adaptor allows you to use your CD player with your car stereo cassette system or portable audio cassette system. Position the Car Cassette Adaptor Cord so the cord extends out from the cassette player when the cassette is inserted (direction depending on your tape player).

1. If you need to reposition the cord, remove the top plate by removing 2 screws with a dime (see Fig. 1).
2. Reposition the cord to come out of the other side (see Fig. 2).
3. Replace the cover.
4. Replace the screws.

Insert the Car Cassette Adaptor in the same direction as you would insert an audio cassette tape. If the Car Cassette Adaptor Cord is on the wrong side of the tape, reposition the cord to the opposite corner of the channel.

Insert the Car Cassette Adaptor Stereo Plug into the Line Out Jack on the left side of the CD player. Turn on the cassette player. Press Play on the cassette player. Press Play on the CD player. Set the volume of the CD player to a mid-level. Adjust the volume on your cassette player.

NOTE:

- When done, leave the cassette player on and first eject the adaptor, then turn off cassette player.
- The Car Cassette Adaptor has the play head on one side only. If you insert the cassette and no sound is heard, press the reverse button to change direction or reverse the adaptor.

CIGARETTE LIGHTER ADAPTOR

Use the Cigarette Lighter Adaptor to supply power to your CD-78 and conserve battery life when using the CD player in a car (no batteries are needed).

- Plug the adaptor into the car cigarette lighter. Insert firmly, and the Cigarette Lighter Indicator will light.
- Plug the other end into the DC 4.5V Jack on the right side of the CD player.
- If there is no power, your fuse may have blown. To change fuse on Cigarette Lighter Adaptor, unscrew the tip. Replace only with same 1A 250V fuse.

CAUTIONS ON THE CIGARETTE LIGHTER ADAPTOR

- Use this set only with the supplied Cigarette Lighter Adaptor. Use with other Cigarette Lighter Adaptors could damage the set.
- When the inside of the cigarette lighter socket is dirty with ashes, the plug section may become hot due to poor contact. Be sure to clean your car cigarette lighter socket before use.
- After use, disconnect the Cigarette Lighter Adaptor plugs from both the set and the cigarette lighter socket.
- The Cigarette Lighter Adaptor may cause interference with reception to the car radio. If this happens, disconnect the Cigarette Lighter Adaptor from the cigarette lighter socket.
- Do not leave the Cigarette Lighter Adaptor plugged in without your car's motor running, your car's battery may be drained in some models of cars that supply power to the Cigarette Lighter Plug even with the car's keys removed.

CAR CASSETTE PLAYER

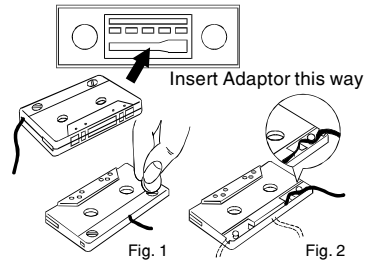

Remove two large screws with a dime or screwdriver to reposition cord

Move cord to desired position (three cord positions)

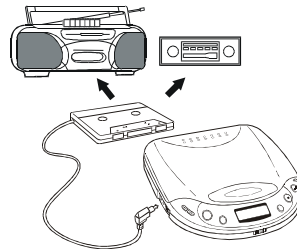

Cigarette Lighter Indicator

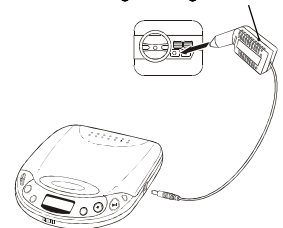

SAFETY PRECAUTIONS

Do not take the set apart. The laser beam used in the set may harm your eyes. Refer servicing to qualified service personnel only.

Do not insert pins or coins, clips, or any objects inside the set.

This set is equipped with a safety device which automatically turns the laser beam off when the disc door is opened.

Do not drop the set or subject it to strong shocks. Doing so could result in damage.

Do not place the set in locations where the temperature is high, or in humid or dusty locations, or locations with long heavy vibrations, or tilted surfaces. The anti-skip feature prevents short duration skipping or stopping of music.

The set's cabinet may warp or the set may otherwise be damaged if it is placed in direct sunlight, near heaters (where the temperature is 140°F/60°C or higher) or in cars with the windows closed. In the summer, the temperature may get as high as 212°F /100°C or more.

Use the set within a temperature range of 41°F/ 5°C to 95°F / 35°C.

Use ONLY the AC Adaptor provided, others may damage your set. Disconnect the Adaptor from the wall outlet when the set is not to be used for an extended period of time (3 days or more).

When cleaning your set, use a soft dry cloth. Do not use solvents or commercially available cleaners, as they may damage or discolor the finish.

Do not wear headphones while operating a motor vehicle. This could create a traffic hazard and is illegal in many areas. Do not use this set when bicycling or running.

The headphones supplied with your set provide superb stereo listening while allowing you to hear some outside sounds when listening at normally low volume levels. Listening at extremely high volume levels minimizes the intrusion of outside noise/sounds. In the interest of safety, it is strongly advised against the use while engaging in activities where the exclusion of external sounds (whistles, horns, sirens, traffic, etc.) could be hazardous. Also loud volume can hurt your ears. If you notice that the sound has become weak or distorted or if tracks do not change, this is an indication that your batteries are low. Replace both batteries at the same time (see BATTERY OPERATION).

Your CD-78 is identified by a serial number located in the Battery Compartment. Record this number in the space provided below.

Model CD-78

Serial No.

Date Purchased:

This booklet contains detailed information on its safety and use. Please read it carefully so that you may take full advantage of its many features, and ensure a safe reliable operation. Keep this booklet for future reference.

CONDENSATION

If cold water is poured into a glass, water droplets form on the outside of the glass. This is called condensation. Condensation may occur on internal operating parts of the lens.

Condensation occurs:

When the set is brought from the cold outdoors into a warm room, or if it is in a cold room to a room which is heated, or in the summer, if the set is moved from an air-conditioned room or car to a hot or humid location. Should condensation occur, the set may not operate properly.

Open the CD Door and wait for about 20 minutes (to allow the internal parts to adjust to the surrounding temperature) before using the set.

IMPORTANT INFORMATION REQUIRED BY THE FCC

Since the CD circuitry may cause interference to other radios nearby, switch this set off when not in use or move it away from the affected radios.

This device complies with Part 15 of the FCC Rules. Operation is subject to the following two conditions: (1) This device may not cause harmful interference, and (2) This device must accept any interference received, including interference that may cause undesirable operation.

NOTE: This equipment has been tested and found to comply with the limits for a Class B digital device, pursuant to Part 15 of the FCC Rules. These limits are designed to provide reasonable protection against harmful interference in a residential installation. This equipment generates, uses and can radiate radio frequency energy and, if not installed and used in accordance with the instructions, may cause harmful interference to radio communications. However, there is no guarantee that interference will not occur in a particular installation. If this equipment does cause harmful interference to radio or television reception, which can be determined by turning the equipment off and on, the user is encouraged to try to correct the interference by one or more of the following measures:

- Reorient or relocate the receiving antenna.
- Increase the separation between the equipment and receiver.
- Connect the equipment into an outlet on a circuit different from that to which the receiver is connected.
- Consult the dealer or an experienced radio/TV technician for help.

SAFETY CERTIFICATION

This Compact Disc Player is made and tested to meet safety standards of the FCC requirements and compliance with safety performance of the U.S. Department of Health and Human Services, and also with FDA Radiation Performance Standards 21 CFR Subchapter J.

WARNING

- To prevent fire or shock hazard, do not expose this appliance to rain or moisture.
- Unauthorized recording of copyrighted material may violate laws. Do not copy songs without permission of the copyright holder.

LASER SAFETY

THIS SET EMPLOYS AN OPTICAL LASER BEAM SYSTEM IN THE CD MECHANISM, DESIGNED WITH BUILT-IN SAFEGUARDS. DO NOT ATTEMPT TO DISASSEMBLE. EXPOSURE TO THIS INVISIBLE LASER LIGHT BEAM MAY BE HARMFUL TO HUMAN EYES. THIS IS A CLASS-1 LASER PRODUCT. USE OF ADJUSTMENTS OTHER THAN THOSE SPECIFIED HEREIN, MAY RESULT IN HAZARDOUS LASER LIGHT BEAM EXPOSURE. THIS COMPACT DISC PLAYER SHOULD NOT BE ADJUSTED OR REPAIRED BY ANYONE EXCEPT QUALIFIED SERVICE PERSONNEL. THE LASER MECHANISM IN THE SET CORRESPONDS TO THE STYLUS (NEEDLE) OF A RECORD PLAYER. ALTHOUGH THIS PRODUCT USES A LASER PICK-UP LENS, IT IS COMPLETELY SAFE WHEN OPERATED ACCORDING TO DIRECTIONS.

TROUBLE SHOOTING GUIDE

Check the following guide before calling customer service.

SYMPTOMS	CAUSES	SOLUTIONS
Tracks do not change or set does not play normally.	Batteries are too weak (they may test OK on tester but they are weak).	Replace both batteries with fresh alkaline batteries. Battery life with fresh batteries is about 8 hours (rechargeable batteries have 1/2 of that life).
CD Player will not turn on.	Dead or weak batteries.	Replace both batteries with fresh ones.
	AC Adaptor not connected properly.	Check AC Adaptor connection at AC outlet and the right side of set.
Disc will not play.	Disc inserted incorrectly.	Re-insert disc with label side facing up.
	Defective compact disc.	Try another compact disc.
	CD Door not closed.	Close lid securely.
	Moisture has formed inside the CD deck.	Take out the CD and leave the CD Door open for about 20 minutes to dry the moisture condensation.
No sound from headphones.	Headphone plug not inserted properly.	Re-insert headphone plug into Phones Jack (not Line Out).
	Volume Control set to minimum.	Increase the volume.
	Weak batteries.	Replace with fresh batteries or use AC Adaptor.
	Defective compact disc.	Try another compact disc.
Volume Control has no function	Headphones plugged into Line Out Jack.	Plug headphones into Phones Jack . (NOT THE LINE OUT JACK)
Sound is skipping or sound stops.	The compact disc or lens is dirty or CD is scratched.	Clean or replace the compact disc or clean the lens.
	Strong vibrations.	Place the CD player on a level surface that is stable or press Anti-Skip Button.
	Anti-Skip is off.	Turn on anti-skip function.
Sound is distorted.	Music is too loud.	Lower Volume Control.
	Bass Boost Switch is ON .	Slide Bass Boost Switch to OFF.
	Weak batteries.	Replace both batteries or use AC Adaptor or Cigarette Lighter Adaptor.
Buttons do not work.	Electronic or static error caused circuitry to lock.	Remove batteries and Adaptors. Wait a few seconds and re-insert. Make sure batteries are fresh or Adaptor has power.
Cassette Adaptor ejects from radio	Your car may have special cassette player.	Try switching the Direction Button to play the other side or call customer service.
Cigarette Lighter Adaptor has no power. Cigarette Lighter Indicator does not light up.	Poor contact.	Insert Adaptor firmly and fully (make sure socket is clean).
	Fuse is blown.	Unscrew Adaptor tip and replace fuse inside the Adaptor. Also check the Car's fuse.

TECHNICAL SPECIFICATIONS

CD PLAYER SECTION

Frequency response	20Hz-20KHz
Wow and flutter	Below measurable limits
Sampling frequency	44.1KHz
D/A converter	1-bit
Error correction method	CIRC
Pickup	Optical 3-beam semiconductor laser (780 nm wavelength)

Laser diode material GaAlAs
Laser output less than 44.6mW

GENERAL

Maximum output (stereo headphones)	15mW + 15mW
Power Supply	
AC adaptor	120V/60Hz
DC	3V: Using 2 size "AA" batteries

Cigarette Lighter Adaptor supplied fits all 12 volt negative ground cigarette lighter sockets.

Set Dimensions (approximate)

Width	5 1/8"
Depth	5 3/4"
Height	1 1/8"

Weight (approximate) 9.5oz. (270g) (set only)

Because the products are subject to continuous improvement, Lennox reserves the right to modify product designs and specifications without notice and without incurring any obligation.

SPECIAL NOTE ABOUT BATTERIES

Fresh alkaline batteries will work for about 8 hours of continuous play.

If your set does not switch tracks or shuts down by itself, this means your batteries are weak and cannot supply enough current.

Either replace both batteries with fresh alkaline batteries or use the AC Adaptor (or car cord).

This set has a built-in Low Battery indicator. When this symbol "  " shows in your Display, both batteries need to be replaced (the batteries may still have some life in them, but too low for use by a CD player).

NOTE: You may use rechargeable batteries on this set. However, because rechargeable batteries generally have lower voltage (1.2 volts instead of 1.5 volts). Your playing time will be much less than normal fresh alkaline batteries.

LIMITED WARRANTY

We warrant this product to be free from defects in material and workmanship under normal use for a period of 90 days after purchase and we will repair it free of charge or replace it at no charge, should it become defective under this warranty, providing you submit proof of purchase sales slip with the set.

During the initial 90 day period after original purchase, we will service the set that is returned to LENOXX ELECTRONICS CORP., prepaid, at no charge. After the initial 90 day period expires, and for a period of 12 months from original purchase, we will exchange at no charge any part that is defective, but will charge for the cost of labor, return postage paid by Lenoxx.

This warranty does not apply to any products which have been subject to misuse, neglect or accident. This warranty does not cover broken headphones or cabinet. UNDER NO CIRCUMSTANCES WILL LENOXX ELECTRONICS CORP. BE LIABLE FOR ANY INCIDENTAL OR CONSEQUENTIAL DAMAGES. Some states do not allow the exclusion or limitation of incidental or consequential damages, so the above limitations or exclusions may not apply to you.

This warranty gives you specific legal rights, and you may also have other rights which vary from state to state. The following charges apply to repairs beyond the warranty period: \$20.00. Be sure to pack carefully and return postage paid insured together with your money order (personal checks will not be accepted) and proof of purchase date to :

LENOXX ELECTRONICS CORP. 2 GERMAK DRIVE, CARTERET N.J. 07008

For customer service, dial 1-800-315-5885 (MONDAY - FRIDAY 09:00 - 17:00 EST)

© 1999 LENOXX ELECTRONICS CORP.
2 GERMAK DRIVE
CARTERET, N.J. 07008
MADE & PRINTED IN CHINA
<http://www.lenoxx.com>

QUICK INSTRUCTIONS

MODEL CD-78

POWERING UP

Power your CD player by connecting the AC Adaptor or by inserting 2 size "AA" fresh alkaline batteries, or you may use your Car Adaptor Kit.

AC ADAPTOR OPERATION

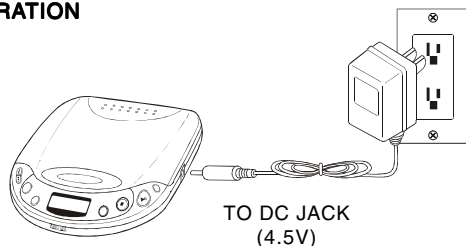

AC OUTLET

BATTERY OPERATION

1. Open the Battery Door.
2. Insert 2 size "AA" fresh alkaline batteries as shown.

NOTE: Player will not work, and batteries will be drained, if not inserted as shown inside the Battery Compartment.

3. Close the Battery Door.

NOTE: If the symbol "■" shows in the display, your batteries are weak and need replacement.

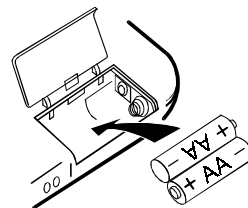

2 SIZE "AA"
BATTERIES

PLUGGING IN

Plug the headphones into the Phones Jack on the left side of the player, and put on the headphones.

VOLUME CONTROL

Adjust this Volume Control to your preference.

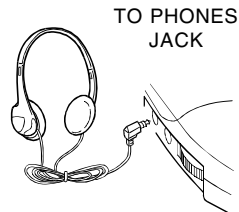

BASS BOOST

Slide this Switch to ON to give you more low frequency tones (like a bass drum makes).

QUICK INSTRUCTIONS

BASIC FEATURES

PLAYING A DISC

You can play compact discs that have this logo:



1. Press the Open Button to open the CD Door.
2. Place a disc on the center post with the label facing up, and then gently push down on the center of the disc until it clicks in.
3. Close the CD Door, press the Play Button, the Display tells you how many tracks are on the disc and total playing time on the disc, then the set starts playing.



PAUSE

Pressing Play/Pause Button while a disc is playing will pause play (the number will flash). Press Play/Pause again to continue play.

STOP (or POWER OFF)

Press the Stop Button once to stop play and shut off power after about 30 seconds delay, or twice for instant power off.

REPEAT

During play, press the Repeat/Random Button once to repeat one song over and over, "REPEAT ONE" will show. That song will play and repeat again and again till you press Stop.

To repeat all songs, press the Repeat/Random Button twice. "REPEAT ALL" will show.

Press the Repeat Button a few more times to return to normal play mode.

REPEAT ONE --> REPEAT ALL --> INTRO --> RND (RANDOM) --> NORMAL PLAY MODE

SEARCH (◀◀ or ▶▶)

During play, press and hold the Search Buttons ◀◀ or ▶▶ while the disc is playing to search backward or forward through a particular track (or song).

Press several times to skip to a later or earlier song, or to get back to the beginning of the song.

ANTI - SKIP

Press the Anti-Skip Button if your set is on the move or subject to vibrations. Your music will not skip or stop when the set is shaken or vibrated for brief periods (after memory basket fills). Press this button again to turn off the Anti-Skip function.

PROGRAMMING

To arrange the songs to play in a special sequence (1, 5, 2, 3, etc.) you can program the set to your taste.

Press Program Button, then press Search Button (◀◀ or ▶▶) to select the track you want. Repeat pressing Program Button and Search Button (◀◀ or ▶▶) till you finish programming, then press Play.

FOR OTHER FEATURES INCLUDING DETAILED PROGRAMMING INSTRUCTIONS, RANDOM AND INTRO PLAY INSTRUCTIONS, PLEASE READ THE OPERATING INSTRUCTIONS BOOKLET.

Free Manuals Download Website

<http://myh66.com>

<http://usermanuals.us>

<http://www.somanuals.com>

<http://www.4manuals.cc>

<http://www.manual-lib.com>

<http://www.404manual.com>

<http://www.luxmanual.com>

<http://aubethermostatmanual.com>

Golf course search by state

<http://golfingnear.com>

Email search by domain

<http://emailbydomain.com>

Auto manuals search

<http://auto.somanuals.com>

TV manuals search

<http://tv.somanuals.com>