

**LifeSource**<sup>TM</sup>  
*Your source for a lifetime of health*

## Ear Thermometer

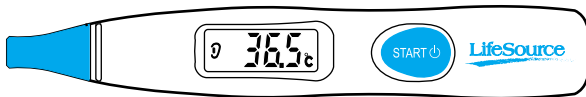

**Bilingual Instruction Guide - MODEL UT-101**

# LifeSource™

*Your source for a lifetime of health*



*Congratulations. You have purchased the LifeSource Ear Thermometer. This reliable and easy to use thermometer offers safe, accurate and quick temperature measurement on persons of all ages from the ear canal.*

*LifeSource has been manufacturing quality healthcare products for more than 20 years. Rest assured that we are committed to providing you and your family with monitoring devices specifically designed for high accuracy and ease of use. LifeSource – your source for a lifetime of health.*

## TABLE OF CONTENTS



|  |          |
|--|----------|
| <b>WHAT DISPLAY SYMBOLS MEAN .....</b> | <b>3</b> |
| <b>COMPONENTS .....</b>                | <b>4</b> |



|   |          |
|---|----------|
| <b>HOW THE LIFESOURCE EAR THERMOMETER WORKS .....</b> | <b>5</b> |
|---|----------|



|                               |          |
|-------------------------------|----------|
| <b>BEFORE YOU START .....</b> | <b>6</b> |
|-------------------------------|----------|



|   |           |
|---|-----------|
| <b>HOW TO INSERT THE THERMOMETER INTO THE EAR .....</b> | <b>7</b>  |
| <b>HOW TO TAKE A TEMPERATURE READING .....</b>          | <b>8</b>  |
| <b>SWITCHING THE UNIT OF MEASURE .....</b>              | <b>10</b> |
| <b>REPLACING THE BATTERIES .....</b>                    | <b>11</b> |
| <b>CARE AND CLEANING .....</b>                          | <b>12</b> |





|   |           |
|---|-----------|
| <b>FREQUENTLY ASKED QUESTIONS .....</b> | <b>13</b> |
| <b>PRECAUTIONS .....</b>                | <b>14</b> |
| <b>PRODUCT SPECIFICATIONS .....</b>     | <b>15</b> |



|  |           |
|--|-----------|
| <b>LIMITED ONE YEAR WARRANTY .....</b> | <b>16</b> |
| <b>CONTACT INFORMATION .....</b>       | <b>18</b> |

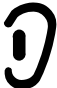

## WHAT DISPLAY SYMBOLS MEAN

| Symbols   | Function / Meaning   | Treatment   |
|---|--|---|
|  | <b>LOW BATTERY mark</b><br>Appears when the batteries are drained.<br>(Begins to flash when the battery voltage has become low. Even so, about ten measurements can be performed.) | Replace all batteries with new ones.  |
|  | <b>READY mark</b><br>Appears when the device is ready to measure.<br>Flashes for about ten seconds after measurement while the result is displayed.                                | _____   |
|  | <b>MEMORY mark</b><br>Previous measurement stored in memory.   | _____   |
| <b>E1</b>   | Appears if the measuring room temperature is over 40°C/104°F.  | Leave the thermometer in a room with a stable temperature between 10°C/50°F and 40°C/104°F for an hour. Then measure again. |
| <b>E2</b>   | Appears if the measuring room temperature is less than 10°C/50°F.  |   |
| <b>E3</b>   | Appears if the measurement is not correct.   | Insert the thermometer into the ear properly and measure again.   |
| <b>Lo</b>   | Appears if the reading is less than 34°C/93.2°F.   | Measure again. See “HOW TO TAKE A TEMPERATURE READING” on pages 8-9.  |
| <b>HI</b>   | Appears if the reading is 42.3°C/108.1°F or over.  |   |

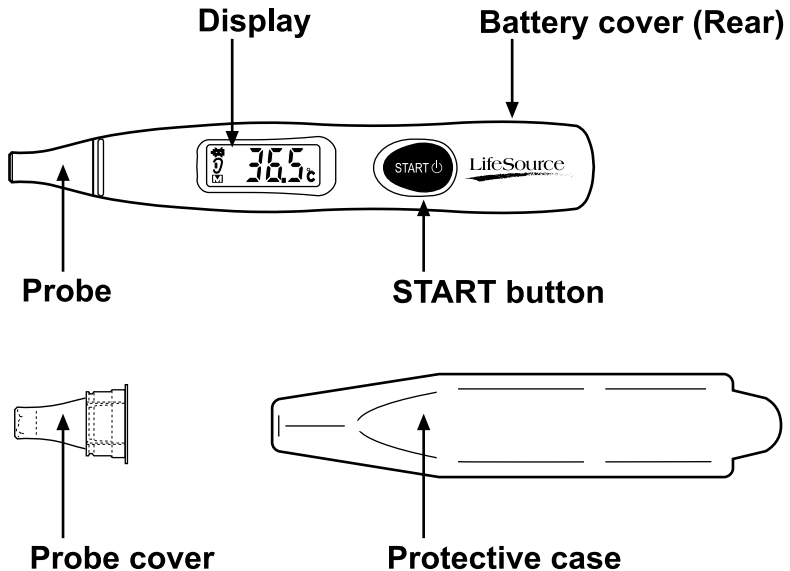

Install on the probe  
before measurement.  
11 covers are included  
in the package.



## HOW THE LIFESOURCE EAR THERMOMETER WORKS

The LifeSource Ear Thermometer utilizes infrared thermo scanning principles to scan the temperature of the human eardrum. The eardrum is located beneath the human body's surface and not easily influenced by the environment's changing temperature.

The LifeSource Ear Thermometer is faster, safer and easier to use. Measurements can even be taken while your child is sleeping. For adults, the LifeSource Ear Thermometer offers fast, comfortable, accurate readings in seconds.

### Why the ear?

Research indicates that the ear is an ideal site for taking body temperature. The eardrum shares blood vessels with the hypothalamus, the part of the brain that controls the body temperature. Therefore, the ear is an accurate indicator of internal body temperature. An ear temperature, unlike an oral temperature, is unaffected by factors such as talking, eating or drinking.

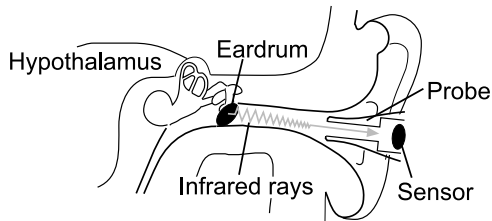

We recommend that you practice with the LifeSource Ear Thermometer on yourself and family members when you are healthy. This way you know how the thermometer works and can feel more confident of the measurements you take when a family member is ill.



Please read this instruction manual completely before using your LifeSource Ear Thermometer. This product is intended for household use only. If you have questions about the meaning of a specific temperature, please talk to your physician.

Use the thermometer at a room temperature between 10°C/50°F and 40°C/104°F. If the thermometer is stored in an environment with the temperature out of the above range or the temperature of the storage area differs greatly from that of the measuring area, allow the thermometer to equalize to the room temperature before use.

■ **DO NOT measure temperature if:**

- Your ear is cold, wet or blocked with ear wax.
- It is within 30 minutes after eating, taking a bath or physical exercise.
- You are suffering from an ear infection.

Always use the thermometer with its probe tip clean. A dirty probe tip may cause an inaccurate measurement. Clean the probe tip with a dry, soft cloth or cloth moistened with alcohol before use. When cleaned, wait for a few minutes before measuring temperature.



## HOW TO INSERT THE THERMOMETER INTO THE EAR

1. Pull the ear lightly backward to straighten the ear canal. While pulling on the ear, insert the probe tip gently into the ear canal. Never force the thermometer into the ear. If the ear canal is very small, as with a baby, lightly press the probe tip to the ear canal with just enough force to seal the opening around the probe.



2. Hold the thermometer so that the probe faces straight in the direction of the eardrum. Always insert the thermometer into the same ear with the same direction and depth.

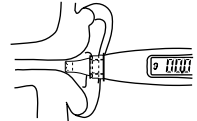

3. When measuring your own temperature, raise and hold your left hand as shown to the right to pull on your ear. Hold the thermometer in your right hand and insert it into your right ear. (Reverse this when measuring your temperature in the left ear.)



4. When measuring a child's temperature, hold the child's head so that it will not move. To measure a baby's temperature, lay the baby down with his/her ear facing upward. Hold the baby's head so that it will not move.





## HOW TO TAKE A TEMPERATURE READING



1. Install the probe cover on the probe.  
(A probe cover was installed at time of purchase.)  
Mate the probe cover groove with the protrusions on the thermometer.



2. Press the START button. The display indicates all the symbols, the previous reading, and finally “00.0°C” with the READY mark  on. Now the thermometer is ready to measure temperature.

**NOTE: Do not keep pressing the START button. Press and release it immediately.**

3. Insert the thermometer gently into the ear. Always insert the thermometer into the same ear with the same direction and depth. (See “HOW TO INSERT THE THERMOMETER INTO THE EAR” on page 7.)

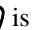
After seconds, you hear the beep sound that tells you the end of measurement. Gently remove the thermometer from the ear. Read the measurement on the LCD panel. At this time, the READY mark  is flashing.

4. After about ten seconds, the READY mark  turns off. To measure again, press the START button once. You may take a second reading immediately.

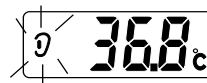
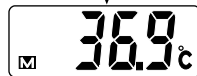



## HOW TO TAKE A TEMPERATURE READING

5. The thermometer automatically powers off after 30 seconds. To protect the ear thermometer, replace the thermometer in its protective case. Store the thermometer in a dry place at room temperature.

■ **Before measuring, check the following:**

- Has one probe cover been installed?
- Is the probe tip clean?

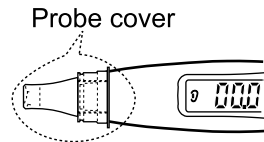

**NOTES:**

- **When a measurement is to be taken at a room temperature greater than 34°C/ 93.2°F , insert the thermometer into the ear, THEN press the START button.**
- **Do not keep the thermometer inserted into the ear for a long period of time. Do not measure more than five times consecutively.**
- **We recommend taking three readings and using the highest reading.**
- **When consulting a physician, be sure to tell the physician that this is ear temperature. The normal range of ear temperature is similar to the familiar oral scale.**

## SWITCHING THE UNIT OF MEASURE



With the LifeSource Ear Thermometer, two units of measure are available for use, Celsius and Fahrenheit. The displayed unit can be changed using the following steps.

1. Complete a measurement. The display shows your measurement in °F or °C .
2. Wait for about ten seconds until the flashing READY mark  turns off.
3. Press and hold the START button for about seven seconds.

Now the displayed unit has changed.

### NOTES:

- Press the **START** button again to use the new unit of measure.
- While Celsius is in place, the display shows “00.0”at start up. And “- .-“ is displayed when Fahrenheit is used.



## REPLACING THE BATTERIES

The LifeSource Ear Thermometer includes two 1.5-volt alkaline LR44 batteries already installed. Approximate battery life is 3,000 measurements. If the **LOW BATTERY** mark  appears on the display, or the thermometer does not function at all, immediately replace all the batteries with new ones. Do not mix old and new batteries.

1. Using a Phillips screwdriver, loosen the screw holding the battery cover and remove the battery cover.
2. Replace the batteries with two new LR44 alkaline button batteries, taking care to place the negative and positive terminals correctly.
3. Re-install the battery cover and secure it with the screw.

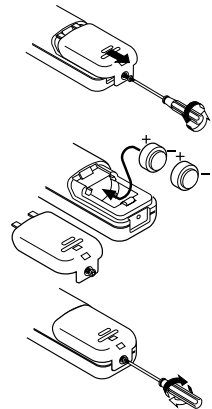

**CAUTION:** ONLY REPLACE THE 1.5-VOLT LR44 BATTERIES. USE OF OTHER TYPES OF BATTERIES MAY PRESENT A RISK OF FIRE OR EXPLOSION.

**CAUTION:** BATTERY MAY EXPLODE IF MISTREATED. DO NOT RECHARGE, DISASSEMBLE, HEAT ABOVE 100°C (212°F), OR INCINERATE. KEEP BATTERY OUT OF THE REACH OF CHILDREN.



To ensure accurate measurements, keep the probe tip and probe covers clean and free of scratches. Fingerprints, ear wax or dirt will impede the accuracy of the thermometer. The probe may be gently cleaned with a dry soft cloth. Do not use a paper towel. The fibers in the paper towel will scratch the probe tip. Allow the safety probe lens to dry completely before replacing the thermometer in its protective storage case.

Use a soft dry cloth to clean the body of the thermometer. Never clean the thermometer with an abrasive cleanser, thinner, benzene or submerge the thermometer into water or other liquids. Do not expose the thermometer to extreme temperatures, humidity, direct sunlight or shock. Store in a clean, dry place at room temperature.

After cleaning, place the thermometer in the protective case and store it at room temperature, avoiding direct sunlight, high temperature, high humidity, liquid spills, dust, fire, vibration and shock.

The thermometer is not water resistant. Protect it from liquid spills. Do not wash it in water.

### ■ Replacing the Probe Cover

Replace the probe cover with a new one when the probe cover is damaged or has been used 30 times or more.



## FREQUENTLY ASKED QUESTIONS

**Q. The reading is different each time I measure my temperature. Why is that?**

**A. The following may be the cause:**

- You insert the probe into the ear in a different way (direction, depth or different ear) each time.
- The probe tip is not clean.
- Your ear is blocked with ear wax.

Insert the thermometer in the same direction, same depth and into the same ear. Keep the probe tip and ear clean.

**Q. Why is the reading taken in the right ear different from that taken in the left ear?**

**A. Basically the temperature is the same in both ears, but the values may differ because the shape and cleanness of each ear interior is different. Also, the way of inserting the probe affects readings.**

**Q. Can I use this thermometer to measure an animal's temperature?**

**A. No. This thermometer has been designed exclusively for people, taking the human ear construction and human body temperature into consideration.**

**NOTE: If the actions described above do not solve the problem, call LifeSource Health Line at 1-888-726-9966. DO NOT attempt to repair the device yourself.**



- This thermometer is designed to take a temperature through the ear canal. DO NOT use it at any other site or for any other purpose.
- Precision components were used in the construction of this device. Extremes in temperature, humidity, direct sunlight, shock or dust should be avoided.
- Clean the device with a dry, soft cloth or cloth moistened in alcohol. Never use thinner, benzene or cleaner with abrasives.
- This device is not water resistant. Protect it from liquid spills.
- Measurements may be impaired if the device is used close to a television, microwave oven, cellular telephone, X-ray or other devices with strong electrical fields.
- Keep this device out of the reach of children. A child may swallow the probe cover or the battery while playing with it. If a child should swallow them, seek medical treatment immediately.
- DO NOT self-diagnose your condition using the measured result. Consult your doctor if your temperature is higher than the normal temperature.
- Used equipment, parts and batteries are not treated as ordinary household waste and must be disposed of according to the applicable regulations.
- DO NOT use the ear thermometer if there is blood or drain in the external ear canal.
- DO NOT use the ear thermometer in an infected ear.
- DO NOT force probe tip into the ear canal.
- DO NOT disassemble the ear thermometer.



## PRODUCT SPECIFICATIONS

|                                   |   |
|-----------------------------------|---|
| <b>Temperature sensor</b> .....   | Thermopile sensor   |
| <b>Measurement range</b> .....    | 34°C to 42.2°C/93.2°F to 108°F  |
| <b>Measurement accuracy</b> ..... | ±0.1°C/±0.1°F (In the temperature range from<br>36°C to 39°C/96.8°F to 102.2°F) |
| <b>Display</b> .....              | 3 digits with a unit (°C or °F), resolution 0.1°C/<br>0.1°F                     |
| <b>Power supply</b> .....         | 2 x 1.5V alkaline button batteries (LR44)                                       |
| <b>Battery life</b> .....         | Approx. 3,000 measurements  |
| <b>Operating condition</b> .....  | +10°C to +40°C/+50°F to +104°F<br>30%RH to 85%RH                                |
| <b>Storage condition</b> .....    | -10°C to +60°C/+14°F to +140°F<br>30%RH to 95%RH                                |
| <b>Dimensions</b> .....           | Approx. 143 [L] x 23 [W] x 18.5 [D] mm  |
| <b>Weight</b> .....               | Approx. 35g including batteries   |



## LIMITED ONE YEAR WARRANTY



LifeSource warrants to the purchaser (“Customer”) that this Ear Thermometer (the “Product”) will be free from defects in material and workmanship, under normal use, for one year from the date of purchase. This warranty is valid only in the country where this Product was purchased. To obtain warranty service, return the Product, freight prepaid and packaged appropriately for safe shipment (insurance recommended), together with proof of date and country of purchase (such as copy of sales Receipt) to:

**For US residents:**  
**LifeSource**  
**A division of A&D Engineering, Inc.**  
**1555 McCandless Drive**  
**Milpitas, CA 95035**  
**Attn: Dept. LW**

**For Canada residents:**  
**AUTO CONTROL MEDICAL INC.**  
**206A boul. Brunswick**  
**Pointe-Claire, Quebec**  
**H9R 5P9 Canada**

Except where prohibited by local law (e.g. California), Customer in the US must include a check for \$6.50 to cover return shipping and handling. Customers in Canada are asked to call Auto Control Medical toll free at 800-463-5414 for appropriate shipping costs. LifeSource’s sole obligation under this express warranty shall be, at LifeSource’s option, to repair or replace any Product found to be defective during the warranty period and return it to you. If neither repair nor replacement is reasonably available, LifeSource may, in its sole discretion, refund to Customer the purchase price paid for the Product. Replacement products of parts may be new or refurbished. LifeSource warrants any replaced or repaired product or part for sixty (60) days from shipment, or the remainder of the initial warranty period, whichever is longer. All Products or parts that are replaced become the property of LifeSource. This warranty will not apply if the defect or malfunction results from: subjecting the Product to any but the specified voltage; modification, alteration or repairs of the Product by persons not authorized by LifeSource; misuse, abuse, damage during transit or lack of reasonable care with respect to the Product; or failure to follow the written instructions enclosed with the Product. Responsibility for loss or damage does not transfer to LifeSource until the returned item is received by LifeSource. Repaired or replacement products will be shipped to Customer not later than 30 days after LifeSource receives the defective Product.



## LIMITED ONE YEAR WARRANTY

**EXCLUSIVE WARRANTY:** TO THE FULL EXTENT ALLOWED BY LAW, THE WARRANTY AND REMEDY PROVIDED ABOVE ARE EXCLUSIVE AND IN LIEU OF ALL OTHER WARRANTIES, TERMS, OR CONDITIONS, EXPRESS OR IMPLIED, EITHER IN FACT OR BY OPERATION OF LAW, STATUTORY OR OTHERWISE, INCLUDING WARRANTIES, TERMS OR CONDITIONS OF MERCHANTABILITY, FITNESS FOR A PARTICULAR PURPOSE, SATISFACTORY QUALITY, CORRESPONDENCE WITH DESCRIPTION, AND NON-INFRINGEMENT, ALL OF WHICH ARE EXPRESSLY DISCLAIMED.

**LIMITATION OF LIABILITY:** IN NO EVENT SHALL LIFESOURCE BE LIABLE FOR ANY LOSS, OR INCIDENTAL, CONSEQUENTIAL, INDIRECT, SPECIAL, OR PUNITIVE DAMAGES OF ANY KIND RESULTING FROM THE FAILURE OF THE PRODUCT OR THE USE OR INABILITY TO USE THE PRODUCT, WHETHER RESULTING FROM BREACH OF WARRANTY OR ANY OTHER LEGAL THEORY, EVEN IF LIFESOURCE HAS BEEN ADVISED OF THE POSSIBILITY OF SUCH DAMAGES OR LOSS. LIFESOURCE LIMITS ITS LIABILITY TO REPAIR, REPLACEMENT, OR REFUND OF THE PURCHASE PRICE PAID, AT LIFESOURCE'S OPTION.

**DISCLAIMER:** Some countries, states, or provinces do not allow the exclusion or limitation of implied warranties or the limitation of incidental or consequential damages, so that the above limitations and exclusions may not apply to you. When the implied warranties are not allowed to be excluded in their entirety, they will be limited to the duration of the applicable written warranty. This warranty gives you specific legal rights, that may vary depending on local law.

**GOVERNING LAW:** This Limited Warranty shall be governed by the laws of the State of California, U.S.A., and by the laws of the United States, excluding their conflicts of laws principles. The United Nations Convention on Contracts for the International Sale of Goods is hereby excluded in its entirety from application to this Limited Warranty.

## CONTACT INFORMATION



For more information regarding usage, care or service of your Ear Thermometer, please contact:

LifeSource

A division of A&D Engineering, Inc.

1555 McCandless Drive

Milpitas, CA 95035

LifeSource Health Line (Toll-Free): 1-888-726-9966

[www.LifeSourceOnline.com](http://www.LifeSourceOnline.com)

For Canada Residents, please contact :

Auto Control Medical

206A boul. Brunswick

Pointe-Claire, Quebec

H9R 5P9 Canada

(Toll-Free): 1-800-463-5414

**Visit our website at [www.LifeSourceOnline.com](http://www.LifeSourceOnline.com)  
for warranty registration.**

©2001 LifeSource

Specifications subject to change without notice.

**LifeSource Health Line (Toll-Free): 1-888-726-9966**

**18**

# Need Help?

Call Toll-Free  
LifeSource Health Line:

**1-888-726-9966**

or visit

**[www.LifeSourceOnline.com](http://www.LifeSourceOnline.com)**

**LifeSource™**



A division of A&D Engineering, Inc.  
1555 McCandless Drive  
Milpitas, CA95035  
[www.LifeSourceOnline.com](http://www.LifeSourceOnline.com)

UT-101 Printed in China 07/01

## Free Manuals Download Website

<http://myh66.com>

<http://usermanuals.us>

<http://www.somanuals.com>

<http://www.4manuals.cc>

<http://www.manual-lib.com>

<http://www.404manual.com>

<http://www.luxmanual.com>

<http://aubethermostatmanual.com>

Golf course search by state

<http://golfingnear.com>

Email search by domain

<http://emailbydomain.com>

Auto manuals search

<http://auto.somanuals.com>

TV manuals search

<http://tv.somanuals.com>